

RECEIVED
AUG 11 2003
WATER RESOURCES DEPT.
SALEM, OREGON

CITY OF ASHLAND

MAP NO. 2

AREA OF BENEFICIAL USE

T 39 SOUTH, R 1 EAST
JACKSON COUNTY, OR

SCALE: 1 Inch = 800 Feet
0 0.05 0.1 0.2 0.3 0.4 0.5 Miles

CITY OF ASHLAND
PUBLIC WORKS DEPT.
ENGINEERING DIV.
REVISED 08/06/03

KEY

IRRIGATION FEATURES:

- Canal Maintenance
- City of Ashland section
- TID section
- TID Irrigated Areas
- Limit of Beneficial Use

1/4 Sections

City Limits

City Streets

Water Bodies

Streams

Pipeline to Filter Plant

County Roads

Drinking Water Reservoirs

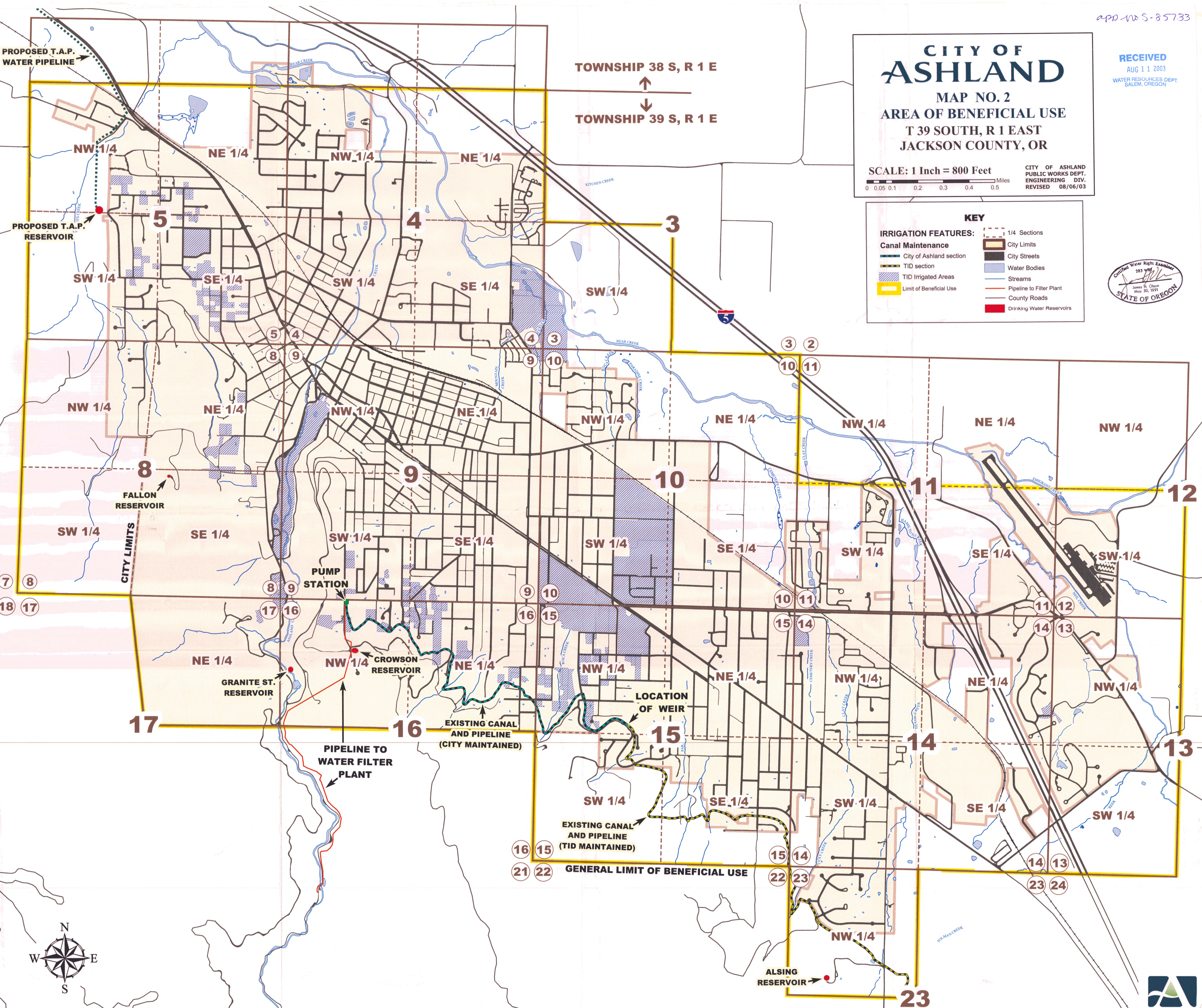
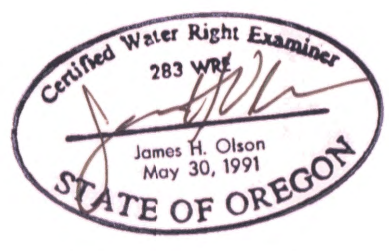

CITY OF ASHLAND

MAP NO. 2
AREA OF BENEFICIAL USE
T 39 SOUTH, R 1 EAST
JACKSON COUNTY, OR

RECEIVED

AUG 11 2003

WATER RESOURCES DEPT.
SALEM, OREGON

App No S-85733

SCALE: 1 Inch = 800 Feet

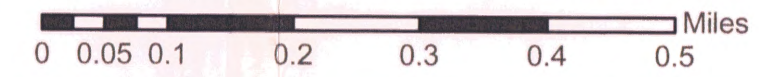

CITY OF ASHLAND
PUBLIC WORKS DEPT.
ENGINEERING DIV.
REVISED 08/06/03

KEY	
1/4 Sections	City Limits
City of Ashland section	City Streets
TID section	Water Bodies
TID Irrigated Areas	Streams
Limit of Beneficial Use	Pipeline to Filter Plant
	Drinking Water Reservoirs

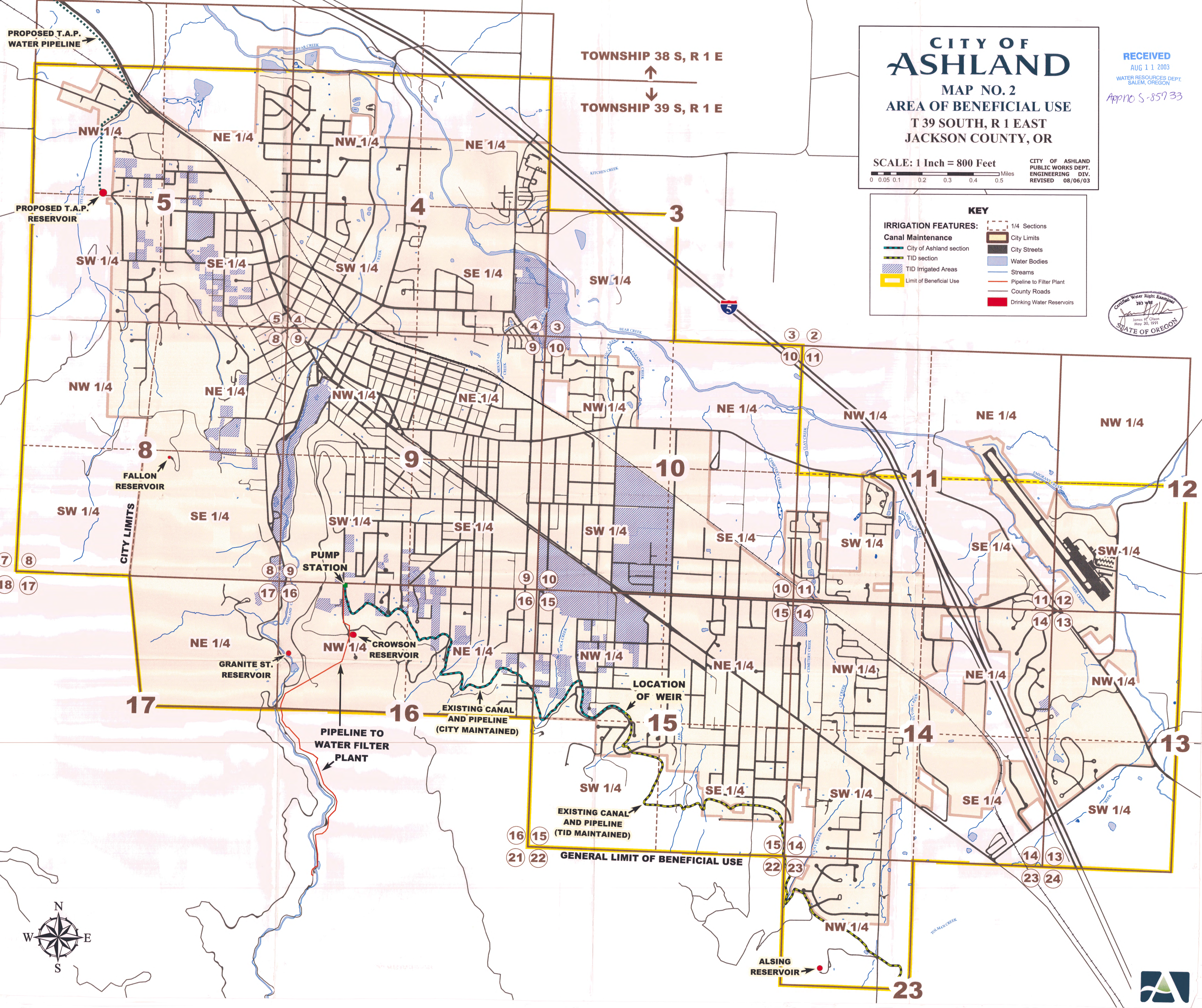

CITY OF ASHLAND

MAP NO. 2 AREA OF BENEFICIAL USE T 39 SOUTH, R 1 EAST JACKSON COUNTY, OR

SCALE: 1 Inch = 800 Feet
0 0.05 0.1 0.2 0.3 0.4 0.5 Miles

CITY OF ASHLAND
PUBLIC WORKS DEPT.
ENGINEERING DIV.
REVISED 08/06/03

KEY

IRRIGATION FEATURES:

- Canal Maintenance
 - City of Ashland section
 - TID section
 - TID Irrigated Areas
 - Limit of Beneficial Use
- 1/4 Sections
- City Limits
- City Streets
- Water Bodies
- Streams
- Pipeline to Filter Plant
- County Roads
- Drinking Water Reservoirs

