

Confederated Tribes of the Warm Springs Application for an Alternate Review Reservoir named "McHaley Pond"

RECEIVED BY OWRD

APR 18 2014

SALEM, OR

RECEIVED BY OWRD
MAR 19 2014

SALEM, OR

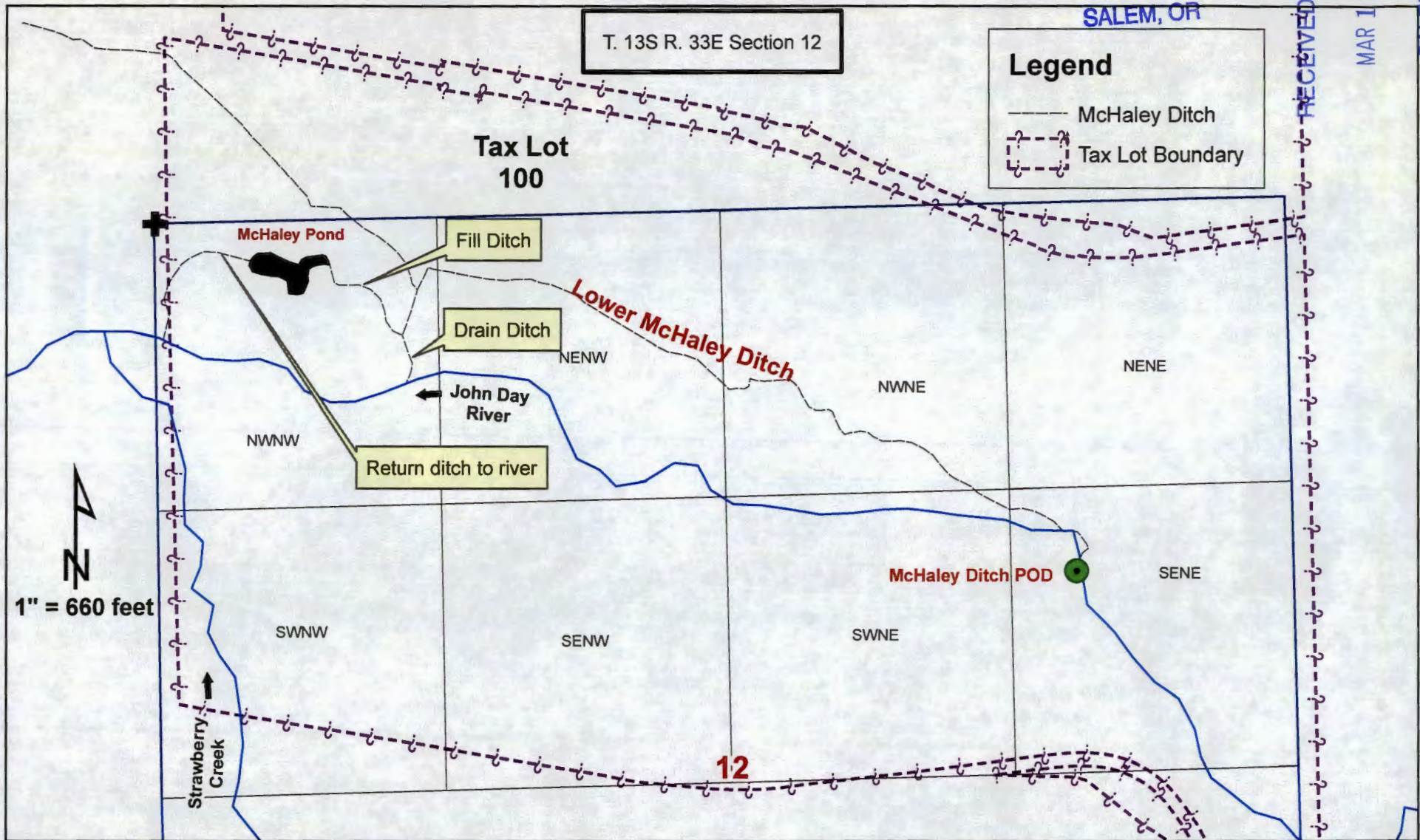

Pond is approximately 200 feet South and 600 feet East of the NW corner of Section 12 of T. 13S R. 33E W.M. being within the NENW of Section 12 of T. 13S R. 33E W.M.

McHaley Ditch POD is approximately 1720 feet South and 4280 feet East of the NW corner of Section 12 of T. 13S R. 33E W.M. being within the SWNE of Section 12 of T. 13S R. 33E W.M.

R-87973