

**Amended Map for Groundwater Application G-17851
Place of Use and Points of Appropriation (Amended 10-28-2014)**

**Water Right in the Name of
Threemile Canyon Farms**
Township 3 North,
Ranges 23 & 24 East (W.M.)

LEGEND

- Point of Appropriation (POA)
- Proposed Place of Use (POU)
- Government Lot
- Tax Lots
- Roads
- Watercourse
- Waterbody

POA LOCATION DESCRIPTIONS

CRD4 Water Well #1
Located 345 feet South and 1,430 feet West from the NE corner of Section 26, Township 3 North, Range 23 East (W.M.)

CRD4 Water Well #2
Located 1,775 feet North and 175 feet West from the SE corner of Section 23, Township 3 North, Range 23 East (W.M.)

DISCLAIMER

This map was prepared for the purpose of identifying the location of a water right only and it is not intended to provide legal dimensions or location of property ownership lines.

Certified Water Rights Examiner Stamp

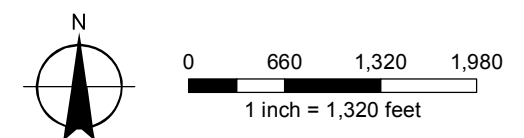
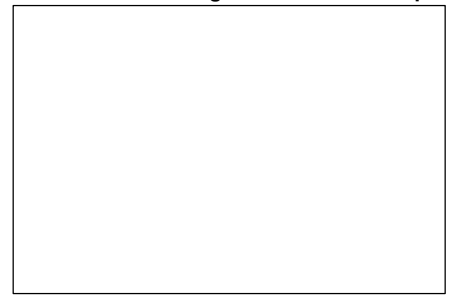

MAP NOTES:

Date: October 28, 2014
Data Sources: ORMAP, US BLM, USGS, ESRI



RECEIVED

APR 25 2014

OWRD

Application for Groundwater Right
Water Right in the Name of Threemile Canyon Farms
Township 3 North, Range 23 East (W.M.)

File Path: P:\Portland\1210 - Threemile Canyon Farms\004 - Consulting Services\Project_GIS\Project_mxd\GIS\COBU_G13820.mxd

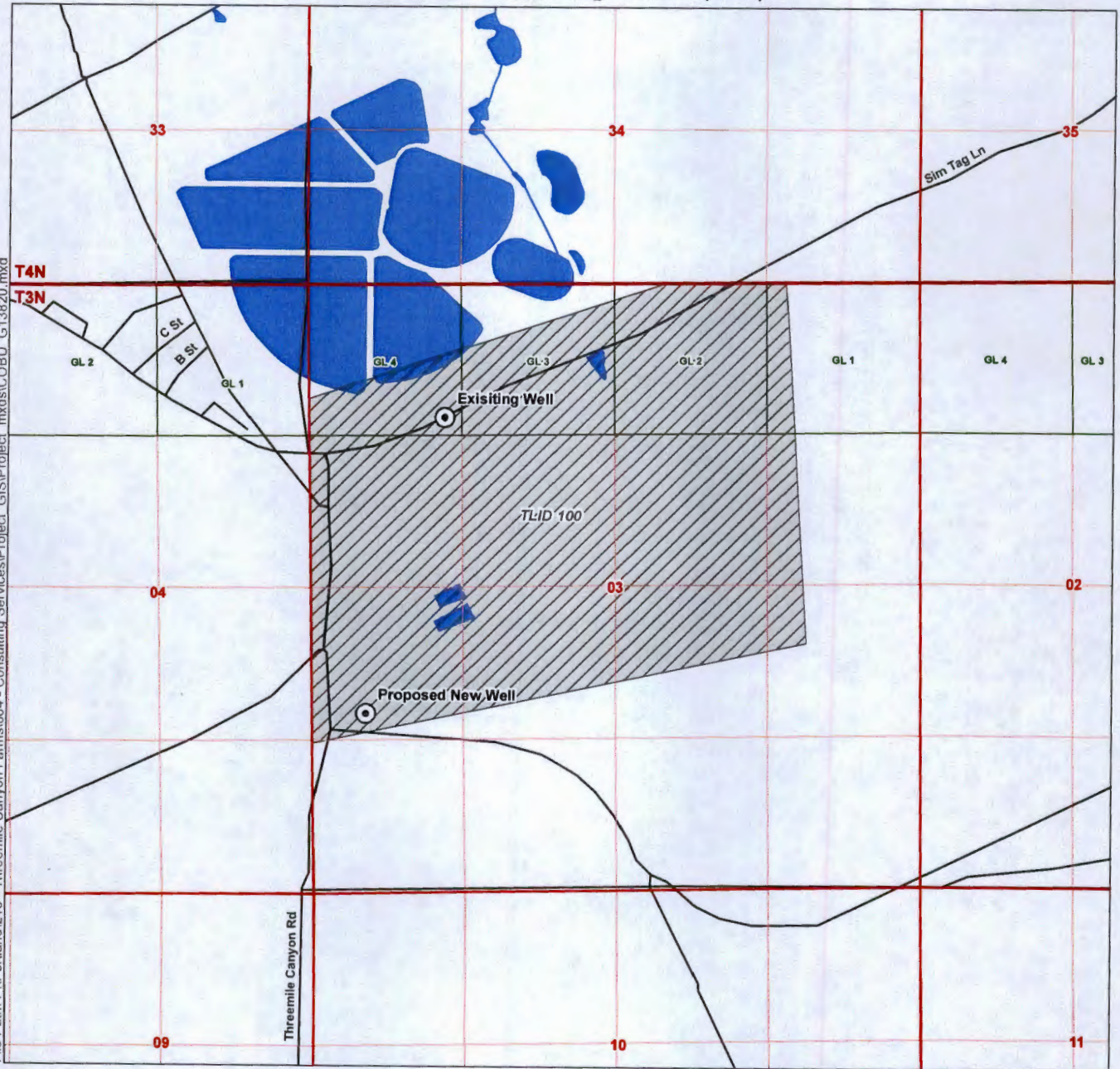

LEGEND

- Well
- Proposed Place of Use
- Government Lot
- Street
- Watercourse
- Waterbody

Existing Well

Located 1,160 feet South and 1,180 feet East from the NW corner of Section 3, Township 3 North, Range 23 East (W.M.)

Proposed New Well

Located 1,560 feet North and 450 feet East from the SW corner of Section 3, Township 3 North, Range 23 East (W.M.)

Certified Water Rights Examiner Stamp

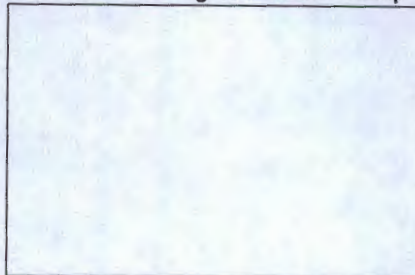

Disclaimer

This map was prepared for the purpose of identifying the location of a water right only and it is not intended to provide legal dimensions or location of property ownership lines.

Map Notes

Date: March 25, 2014
Data Sources: BLM, ESRI
Prepared By: GSI Water Solutions, Inc.

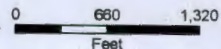

G-1785T

The easement over the Property to the Wildlife Areas is over Threemile Canyon Road and the existing Willow Creek Wildlife Management Area Access Road, as depicted on this map.

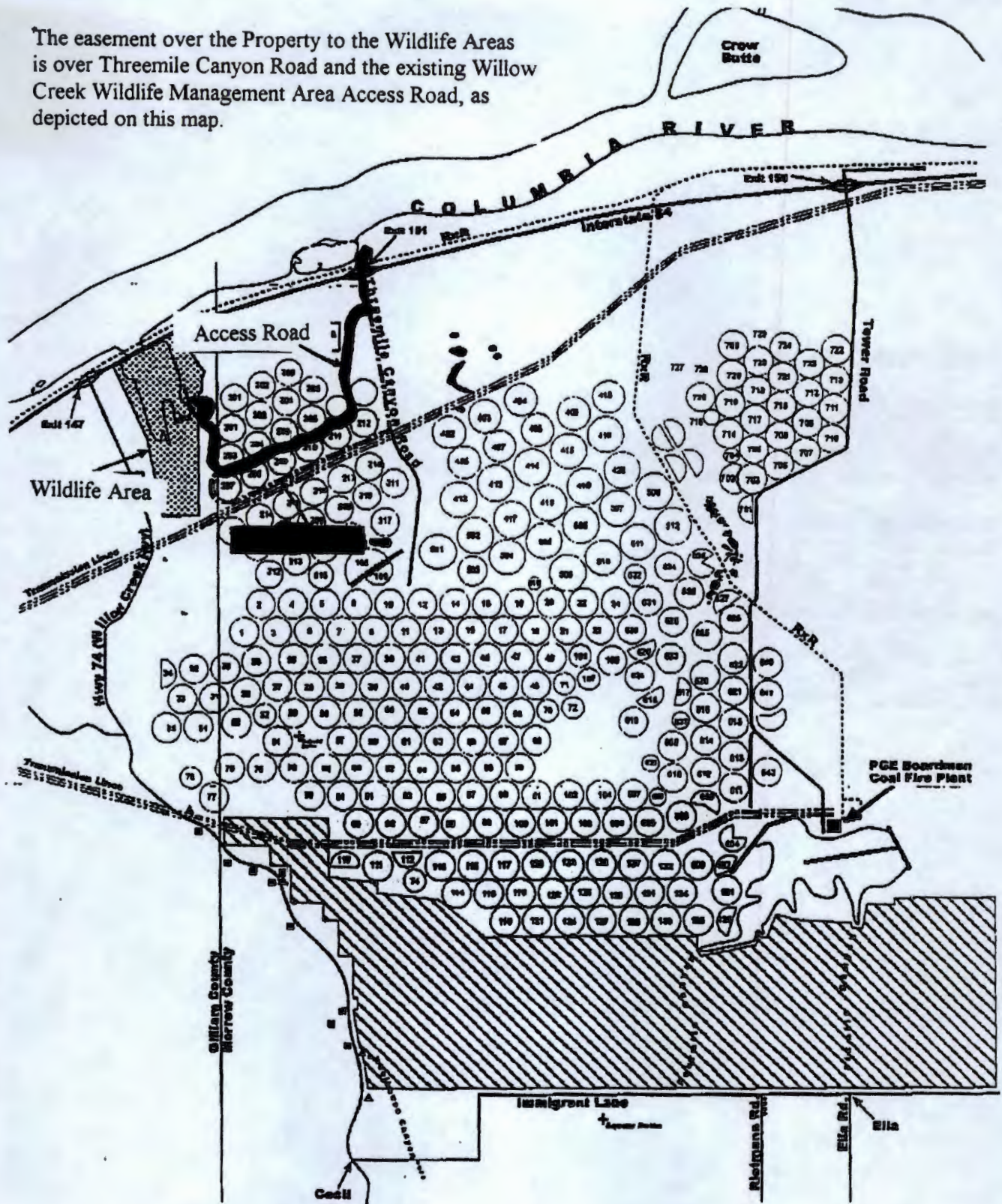

RECEIVED
APR 25 2014
OWRD

G-17051

RECEIVED

NOV 6 2014

Amended Map for Groundwater Application CRD4
Place of Use and Points of Appropriation (Amended 10-28-2014)

Water Right in the Name of
Threemile Canyon Farms
Township 3 North,
Ranges 23 & 24 East (W.M.)

LEGEND

- ⊙ Point of Appropriation (POA)
- ▨ Proposed Place of Use (POU)
- Government Lot
- Tax Lots
- Roads
- ~ Watercourse
- ☁ Waterbody

POA LOCATION DESCRIPTIONS

- CRD4 Water Well #1**
Located 345 feet South and 1,430 feet West from the NE corner of Section 26, Township 3 North, Range 23 East (W.M.)
- CRD4 Water Well #2**
Located 1,775 feet North and 175 feet West from the SE corner of Section 23, Township 3 North, Range 23 East (W.M.)

DISCLAIMER

This map was prepared for the purpose of identifying the location of a water right only and it is not intended to provide legal dimensions or location of property ownership lines.

Certified Water Rights Examiner Stamp

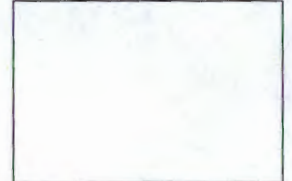

0 660 1,320 1,980
1 inch = 1,320 feet

MAP NOTES:
Date: October 28, 2014
Data Sources: ORMAP, US BLM, USGS, EBN

