

UNION COUNTY

R 38 E

R 39 E

RECEIVED
STATE ENGINEER
STATE OF OREGON

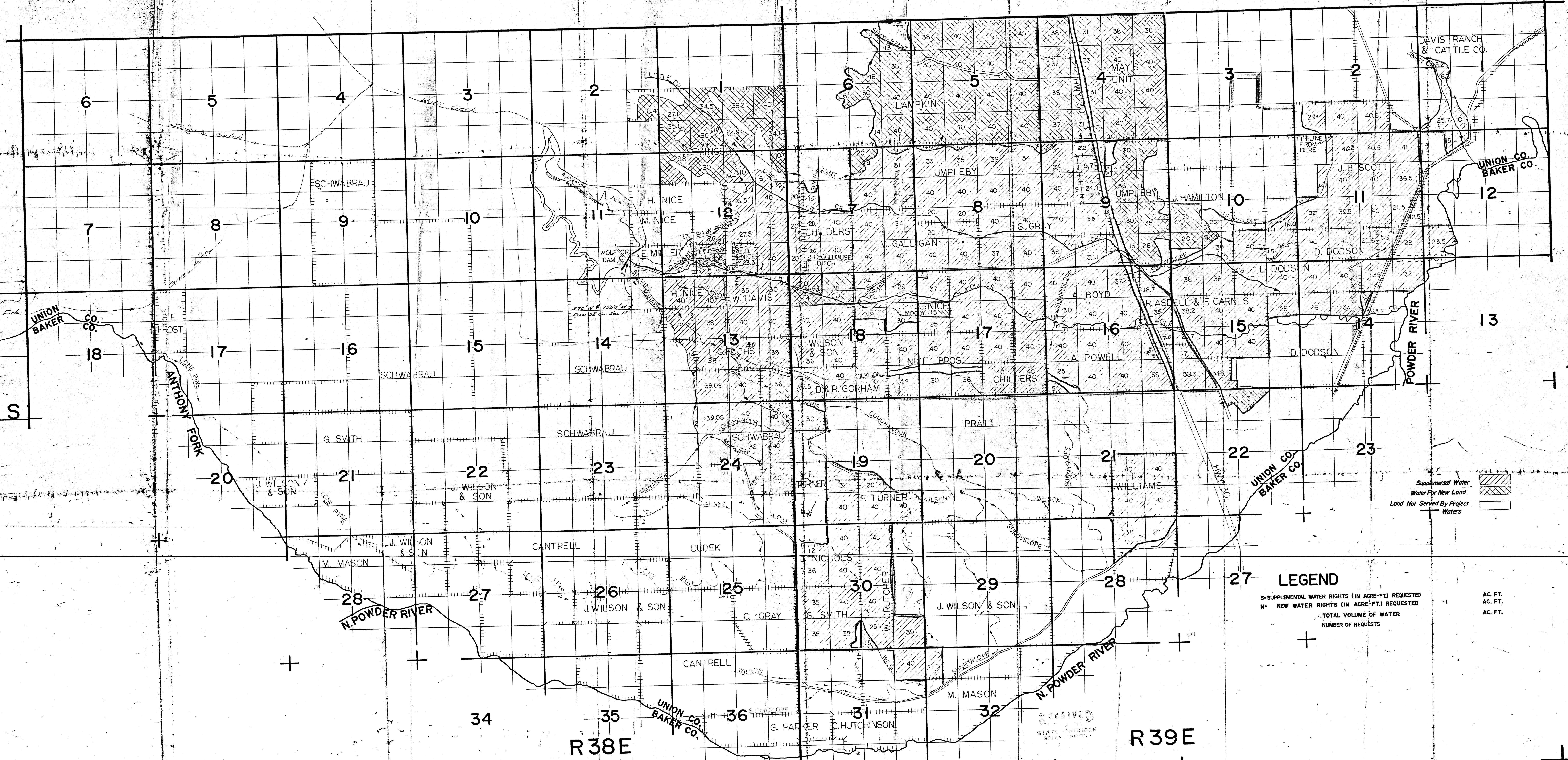

Supplemental Water
Water For New Land
Land Not Served By Project
Waters

LEGEND

- S- SUPPLEMENTAL WATER RIGHTS (IN ACRE-FT.) REQUESTED
- N- NEW WATER RIGHTS (IN ACRE-FT.) REQUESTED
- TOTAL VOLUME OF WATER
- NUMBER OF REQUESTS

AC. FT.
AC. FT.
AC. FT.

Application No. 39222, 39223
Permit No. 5776, 5779

R 39 E

R 38 E