

WATER RIGHTS APPLICATION MAP

TAXLOTS: 3400, SECTION 26; &
 1300, 1301 & 1200 SECTION 35; T2S, R3W, WM
 YAMHILL COUNTY, OREGON
 WILLAMETTE RIVER BASIN

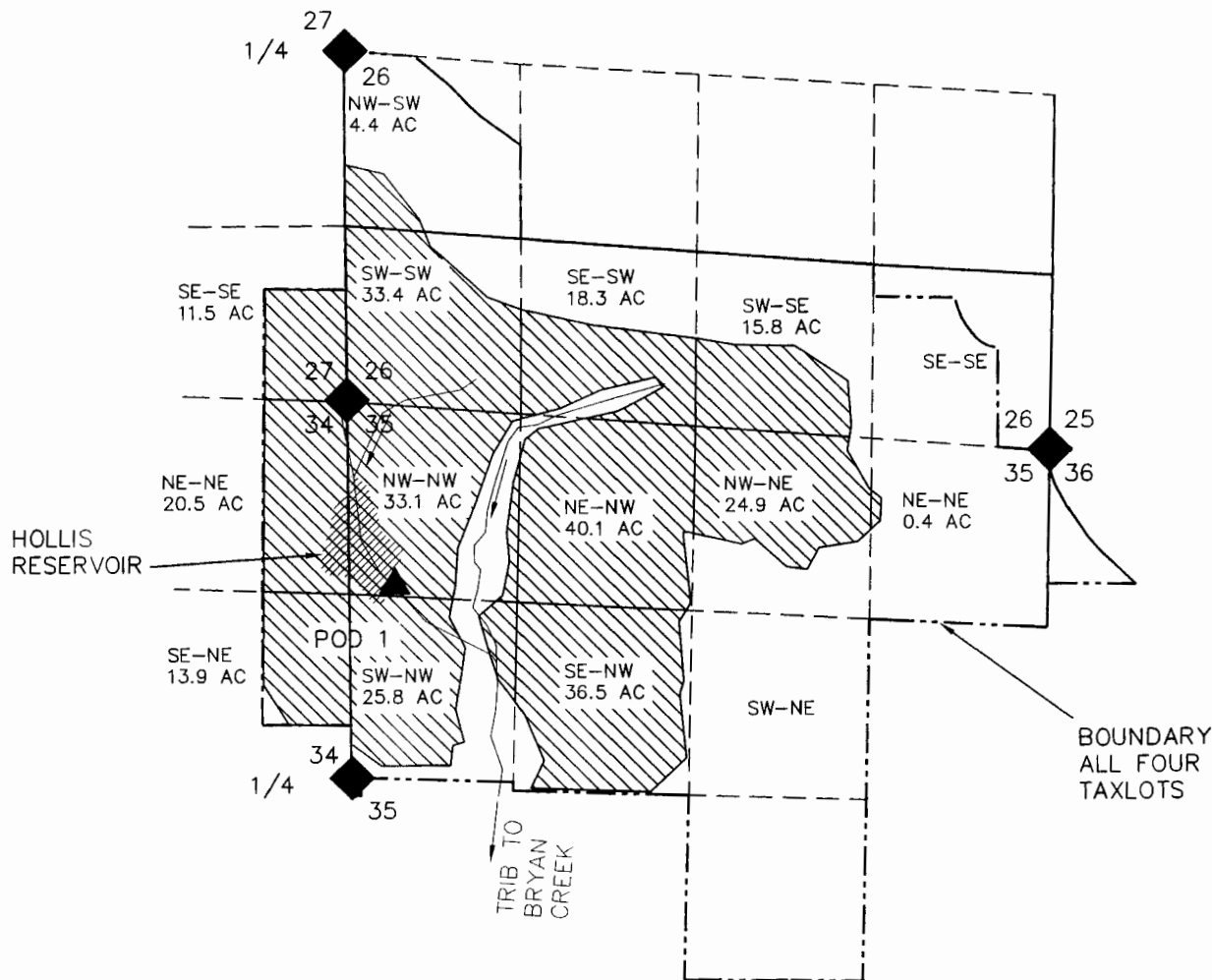
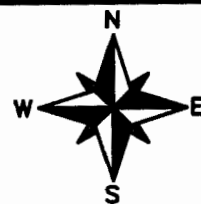

LEGEND:

- ◆ SECTION CORNER or 1/4 CORNER
- ▲ POINT OF DIVERSION (POD)
- PROPERTY LINE
- - - 1/16TH LINE
- ▨ PROPOSED IRRIGATION AREAS

POD 1 IS 1370 FT SOUTH AND 340 FEET EAST OF NE CORNER S35

MAP BASE:
 COUNTY SURVEY RECORD CSP-10277 AND SITE SPECIFIC AERIAL PHOTO

RECEIVED BY OWRD

PREPARED FOR:
 HOLLIS LAND & TIMBER

JUN 11 2014



SALEM, OR

THIS MAP WAS PREPARED FOR THE PURPOSE OF IDENTIFYING THE LOCATION OF A WATER RIGHT ONLY AND IS NOT INTENDED TO PROVIDE LEGAL DIMENSIONS OR LOCATION OF PROPERTY OWNERSHIP LINES.

Project: 313081
 Drawing: 3130811J-WRAppl.dwg
 By: EAU
 Checked by: EAU
 Date: 27MAY2014

