

T17S R44E, Sections 21 and 28, W.M.

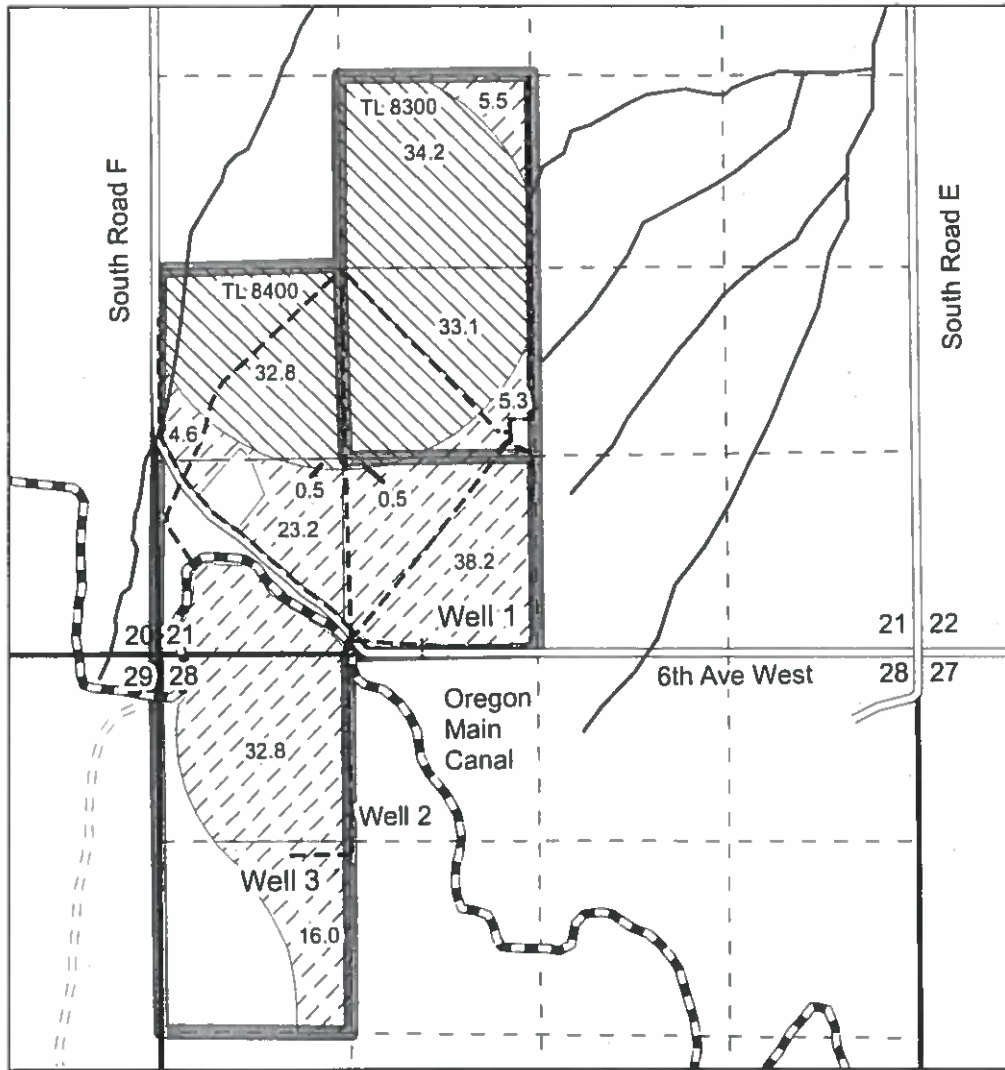

- ! Existing well
- . Proposed well
- Mainlines
- ▬ Canal
- == Dirt Road
- ▬ Road
- Stream
- - - Quarter quarter line
- Section line
- ▨ Proposed primary groundwater right
- ▩ Proposed supplemental groundwater right
- ▬ Tax lot lines

RECEIVED
JAN 22 2015
OWRD

0 660 1,320
 Feet

1 inch = 1,320 feet

Revised 1/22/2015

Well 1 (Malh 53561) is located 1,820 feet east and 30 feet north of the SW corner of section 21, T17S, R44E.

Well 2 (Malh 53995) is located 1,245 feet east and 1,400 feet south of the NW corner of section 28, T17S, R44E.

Well 3 (proposed) is located 1,185 feet east and 1,450 feet south of the NW corner of section 28, T17S, R44E.

This map is not intended to provide legal dimensions or locations of property ownership lines

Application for a Groundwater Permit
 Tax Lots 8300 and 8400
 Grant 4-D Farms
 Malheur County

Map prepared by Nancy Rorick Consulting