

07

Application No.

G14152

Permit No.

G12715 CANCELLED

Certificate No.

FEES PAID

Date	Amount	Receipt No.
8-14-95	314.00	127390
5-5-97	\$15.00	11993
04/16/01	\$25.00	44352
	Cert. Fee	

FEES REFUNDED

Date	Amount	Check No.

ASSIGNED

FILE#: G 14152

RAY D GILLETT
GILLETT, LINDA R

7810 NE EMERSON DR
MADRAS, OR 97741

Stream Index, Page No.

Vol 3 Trout Creek & Misc.

Date filed

Priority

Action suspended until *Purge 5/14/05*

Return to applicant

Date of approval

CONSTRUCTION

Date for beginning *AUG 28 1997*

Date for completion *OCT 01 1998*

Extended to

Date for application of water *OCT 01 1999*

Extended to

PROSECUTION OF WORK

Form "A" filed

Form "B" filed

Form "C" filed

FINAL PROOF

Blank mailed

Proof received

Date certificate issued

ASSIGNED

ASSIGNMENTS

Date	To Whom	Address	Volume	Page
5-5-97	NW Farm Credit Svcs, ACA	POB 607, Redmond, OR 97754	7	3422
<i>and</i>	Kenneth + Jennifer Powell	7810 NE Emerson, Madras, OR 97741	8	888

REMARKS

5/14/04 Canceled Sp. Or. Rec. Vol. 60 p. 37

Purge 5/14/05 duplicate

ASSIGNED

RAY D GILLETT
GILLETT, LINDA R

Application No. *G 14152*

Permit No. *G12715*

Name *7810 NE EMERSON DR*
Address *MADRAS, OR 97741*

Assigned *NW Farm Credit Svcs ACA*
Address *PO Box 607 Redmond 97754*
and *Kenneth + Jennifer Powell*
7810 NE Emerson Madras OR 97741

Beginning construction *AUG 28 1997*

Completion of construction *OCT 01 1998*

Extended to

Complete application of water *OCT 01 1999*

Extended to

Form 111

Water Resources Department

MEMO

4/4, 1996

TO Application G-14152

FROM GW: Gates
(Reviewer's Name)

SUBJECT Scenic Waterway Interference Evaluation

Yes

The source of appropriation is within or above a Scenic Waterway.

No

Yes

Use the Scenic Waterway condition (Condition 7J).

No

PREPONDERANCE OF EVIDENCE FINDING: (Check box only if statement is true)

At this time the Department is unable to find that there is a preponderance of evidence that the proposed use of ground water will measurably reduce the surface water flows necessary to maintain the free-flowing character of a scenic waterway in quantities necessary for recreation, fish and wildlife.

FLOW REDUCTION: (To be filled out only if Preponderance of Evidence box is not checked)

Exercise of this permit is calculated to reduce monthly flows in _____ Scenic Waterway by the following amounts expressed as a proportion of the consumptive use by which surface water flow is reduced.

Jan	Feb	Mar	Apr	May	Jun	Jul	Aug	Sep	Oct	Nov	Dec

14152

Water Right Conditions Tracking Slip

Groundwater/Hydrology Section

FILE ## 61452

ROUTED TO: Marilyn

TOWNSHIP/

RANGE-SECTION: 9S/14E-33

APPLICATION ACCEPTED? yes no
CONDITIONS ATTACHED? yes no

REMARKS OR FURTHER INSTRUCTIONS:

Reviewer: Gates

TO: Water Rights Section

4/4, 1996

FROM: Groundwater/Hydrology Section Gates

Reviewer's Name

SUBJECT: Application G- 14152

GROUNDWATER/SURFACE WATER CONSIDERATIONS

1. PER THE Deschutes Basin rules, one or more of the proposed POA's is/is not within _____ feet/mile of a surface water source (_____) and taps a groundwater source hydraulically connected to the surface water.
2. BASED UPON OAR 690-09 currently in effect, I have determined that the proposed groundwater use
 - a. ___ will, or have the potential for substantial interference with the nearest
 - b. will not surface water source, namely Trout Creek / Deschutes River
 - c. ___ will if properly conditioned, adequately protect the surface water from interference:
 - i. ___ The permit should contain condition #(s) _____;
 - ii. ___ The permit should contain special condition(s) as indicated in "Remarks" below;
 - iii. ___ The permit should be conditioned as indicated in item 4 below; or
 - d. ___ will, with well reconstruction, adequately protect the surface from substantial interference.

GROUNDWATER AVAILABILITY CONSIDERATIONS

3. BASED UPON available data, I have determined that groundwater for the proposed use
 - a. ___ will, or likely be available in the amounts requested without injury to prior rights
 - b. ___ will not and/or within the capacity of the resource; or
 - c. will if properly conditioned, avoid injury to existing rights or to the groundwater resource:
 - i. The permit should contain condition #(s) 7J, 7B;
 - ii. ___ The permit should contain special condition(s) as indicated in "Remarks" below;
 - iii. ___ The permit should be conditioned as indicated in item 4 below; or
4.
 - a. ___ THE PERMIT should allow groundwater production from no deeper than _____ ft. below land surface;
 - b. ___ The permit should allow groundwater production from no shallower than _____ ft. below land surface;
 - c. ___ The permit should allow groundwater production only from the _____ groundwater reservoir between approximately _____ ft. and _____ ft. below land surface;
 - d. ___ Well reconstruction is necessary to accomplish one or more of the above conditions.
 - e. ___ One or more POA's commingle 2 or more sources of water. The applicant must select one source of water per POA and specify the proportion of water to be produced from each source.

REMARKS: _____

(Well Construction Considerations on Reverse Side)

WELL CONSTRUCTION (If more than one well doesn't meet standards, attach an additional sheet.)

5. THE WELL which is the point of appropriation for this application does not meet current well construction standards based upon:
- a. ___ review of the well log;
 - b. ___ field inspection by _____;
 - c. ___ report of CWRE _____;
 - d. ___ other: (specify) _____
-
6. THE WELL construction deficiency:
- a. ___ constitutes a health threat under Division 200 rules;
 - b. ___ commingles water from more than one groundwater reservoir;
 - c. ___ permits the loss of artesian head;
 - d. ___ permits the de-watering of one or more groundwater reservoirs;
 - e. ___ other: (specify) _____
-
7. THE WELL construction deficiency is described as follows: _____
-
8. THE WELL
- a. ___ was, or constructed according to the standards in effect at the time of
 - b. ___ was not original construction or most recent modification.
 - c. ___ I don't know if it met standards at the time of construction.

RECOMMENDATION:

- A. ___ I recommend including the following condition in the permit:
"No water may be appropriated under terms of this permit until the well(s) has been repaired to conform to current well construction standards and proof of such repair is filed with the Enforcement Section of the Water Resources Department."
- B. ___ I recommend withholding issuance of the permit until evidence of well reconstruction is filed with the Enforcement Section of the Water Resources Department.
- C. ___ REFER this review to Enforcement Section for concurrence.

THIS SECTION TO BE COMPLETED BY ENFORCEMENT PERSONNEL

I concur in G/H's recommendation A or B above relating to conditioning or withholding the permit

_____, 199__.
(Signature)

I do not concur in G/H's recommendation A or B above relating to conditioning or withholding the permit for the following reasons: _____

_____, 199__.
(Signature)

STATE OF OREGON
WATER RESOURCES DEPARTMENT

INTEROFFICE MEMO

TO: FILE G- 14152
FROM: SARAH M. GATES
SUBJECT: SURFACE/GROUND WATER CONSIDERATIONS

DATE: 4/4/96

The applicant seeks 110 gpm from a well for irrigation

Township 9S Range 14E Section 33 County Jefferson
1100' S & 550' W from NE corner, sec 33.

Per Division 9 300' 4.7 miles 3.7 miles 1000' trib. to Sagebrush Creek
Deschutes River
Trout Creek
The well is located 1000' from Sagebrush Creek
Elevation of well 2025' river 1300' difference 725'
1420' 1960' 605' 65'

LOG # Jeff 245
Depth of well 176
Casing to 19
Lined to 19
Sealed to 19
Applicant Ray + Linda Gillett
7810 NE Emerson Drive
Madras, OR 97741
503-475-3874

5/17/78 SWL → 100 on 4/7/78 73 1/2: 1994
Depth water first found 100

Perforations/screens	units	31000241 → 6/14/94	99.57	2262 elw
	units	31000078 → 7/26/91	85.00	2008 elw
	units	31000242 → 7/25/86	14.80	1880 elw
	units			

Well Tests (P/A/B/FA) 50 / 10' del / 1 hr

Information sources Madras East + Gateway Quads
Observation wells? 1082

Conceptual model 7' of capping basalt over sandstone conglomerate and tuffs. Groundwater flow is to the North to Trout Creek. Local drainage is connected to same source of water that this well develops. Well develops water from the fine grained deposits of the Deschutes Fm.

Confined, semi-confined, or unconfined?
DIRECT hydraulic connection? YES
Potential to cause substantial interference? NO
Objections? NO
CONDITIONS: Scenic Waterway Condition 7J; 7B

Point Stream elevation of 1925 is 1400' to the north

REVIEW CHECKLIST

FOR G-14152

- Appropriate parts of the stream index
- Estimated number of wells within one-mile radius & identified types.
- Verify that the well log is in application. If not, provide one.
- State observation wells within five-mile radius.
- List groundwater permits within a five-mile radius with extraordinary conditions.

APPLICATIONS WITH PERMIT CONDITIONS: 78, 14E, 33

G13145 7B 75 Trout Creek - no inter
12977 7B 75 ~~State~~ no con.
 ↓
 5 EFF
 111

PERMITTED WELLS WITHIN 1 MILE OF APPLICATION G 14152

PERMIT	T/R/S/QQ	USE	RATE	UNITS
G 8467	9.00S14.00E27NWNW	IR	0.6300	C
G 11583	9.00S14.00E27NWNW	IS	1.6300	C
G 9399	9.00S14.00E27NENE	IR	0.0400	C
G 7384	9.00S14.00E29SWNW	IC	0.2300	C
G 7960	9.00S14.00E29SWNW	IS	0.2300	C
G 11766	9.00S14.00E34SWNW	IC	0.8800	C
G 6989	9.00S14.00E33NWSE	IR	0.0800	C
G 7957	9.00S14.00E33NESE	IR	0.6800	C
G 8179	9.00S14.00E33NESE	IR	0.8300	C
G 8568	9.00S14.00E33NESE	IR	1.5625	C

K. J. Powell

BEFORE THE WATER RESOURCES DIRECTOR OF OREGON

MARION COUNTY

IN THE MATTER OF THE CANCELLATION)
OF CERTAIN PERMITS TO APPROPRIATE) ORDER
WATER UNDER THE PROVISIONS OF ORS)
537.260)

The time within which the appropriations under the following water right permit(s) should have been perfected has expired. The owners of such permit(s) have failed or refused within the period of three months thereafter to submit proof of the completion of such appropriations as required by ORS 537.260. Notices have been addressed to each of the owners of said permit(s) by certified mail in accordance with the provisions of ORS 537.260 and ORS 174.160. The owners of such permit(s) have failed or refused to submit proof of the completion of the appropriations under the terms and conditions of their respective permit(s), although the sixty-day time limits allowed in such notices has elapsed.

PERMITS TO USE GROUNDWATER:

<u>Name</u>	<u>Basin No.</u>	<u>WM Dist.</u>	<u>Application No.</u>	<u>Permit No</u>
Kenneth R. Powell and Jennifer K. Powell	5	11	G-14152	G-12715

Proof of appropriation of water under the terms and conditions of the permit(s) listed has not been made to the satisfaction of the WATER RESOURCES DIRECTOR as required under ORS 537.260. NOW, THEREFORE, it is hereby ORDERED that the permit(s) are canceled in accordance with the provisions of ORS 537.260

Dated at Salem, Oregon this 14 day of May, 2004.

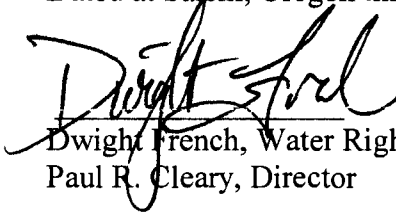
Dwight French, Water Rights Section Manager, for
Paul R. Cleary, Director

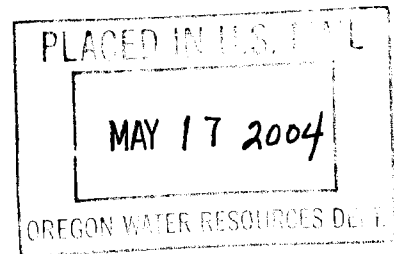

Special Order Volume 60 Page 37

This is a final order in other than contested case. Pursuant to ORS 536.075 and OAR 137-004-080 and OAR 690-01-005 you may either petition the Director for reconsideration of this order or petition for judicial review of this order. As provided in ORS 536.075, this order is subject to judicial review under ORS 183.484. Any petition for judicial review of this order must be filed within the 60 day time period specified by ORS 183.484(2).

Oregon

Water Resources Department

725 Summer St NE Suite A
Salem, OR 97301-1271

ADDRESS SERVICE REQUESTED

PRESORTED
FIRST CLASS

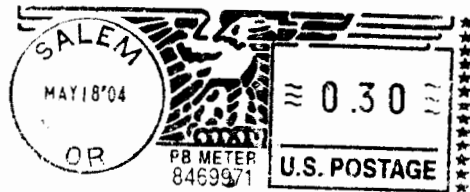

KJ

NOT DELIVERABLE AS ADDRESSED
NO FORWARDING ORDER ON FILE

G-14152
K & J POWELL
7810 NE EMERSON
MADRAS OR 97741

FOE

RECEIVED

MAY 24 2004

WATER RESOURCES DEPT
SALEM, OREGON

BEFORE THE WATER RESOURCES DIRECTOR OF OREGON

MARION COUNTY

IN THE MATTER OF THE CANCELLATION)
OF CERTAIN PERMITS TO APPROPRIATE) ORDER
WATER UNDER THE PROVISIONS OF ORS)
537.260)

The time within which the appropriations under the following water right permit(s) should have been perfected has expired. The owners of such permit(s) have failed or refused within the period of three months thereafter to submit proof of the completion of such appropriations as required by ORS 537.260. Notices have been addressed to each of the owners of said permit(s) by certified mail in accordance with the provisions of ORS 537.260 and ORS 174.160. The owners of such permit(s) have failed or refused to submit proof of the completion of the appropriations under the terms and conditions of their respective permit(s), although the sixty-day time limits allowed in such notices has elapsed.

PERMITS TO USE GROUNDWATER:

<u>Name</u>	<u>Basin No.</u>	<u>WM Dist.</u>	<u>Application No.</u>	<u>Permit No</u>
Kenneth R. Powell and Jennifer K. Powell	5	11	G-14152	G-12715

Proof of appropriation of water under the terms and conditions of the permit(s) listed has not been made to the satisfaction of the WATER RESOURCES DIRECTOR as required under ORS 537.260. NOW, THEREFORE, it is hereby ORDERED that the permit(s) are canceled in accordance with the provisions of ORS 537.260

Dated at Salem, Oregon this 14 day of May, 2004.

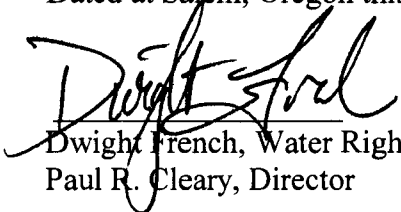
Dwight French, Water Rights Section Manager, for
Paul R. Cleary, Director

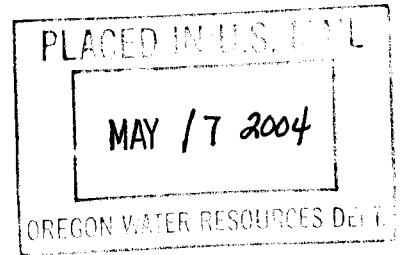

Special Order Volume 60 Page 37

This is a final order in other than contested case. Pursuant to ORS 536.075 and OAR 137-004-080 and OAR 690-01-005 you may either petition the Director for reconsideration of this order or petition for judicial review of this order. As provided in ORS 536.075, this order is subject to judicial review under ORS 183.484. Any petition for judicial review of this order must be filed within the 60 day time period specified by ORS 183.484(2).



Oregon

Theodore R. Kulongoski, Governor

App # G-1452

Water Resources Department

Commerce Building
158 12th Street NE
Salem, OR 97301-4172
503-378-3739
FAX 503-378-8130

February 7, 2003

G 12715
NORTHWEST FARM CREDIT
SERVICES ACA
PO BOX 607
REDMOND, OR 97756

RE: Deschutes Ground Water Mitigation Rules, Division 505
Deschutes Basin Mitigation Bank and Mitigation Credit Rules, Division 521

Dear Water Right Permit Holder:

Our records indicate that you are the holder of a ground water permit issued by the Department after July 17, 1995, in the Deschutes Basin Ground Water Study Area (Study Area). Your permit (or subsequent certificate) was issued with a condition allowing for regulation of use if it was later determined that the use would "measurably reduce" scenic waterway flows in the Deschutes River.

As you may be aware, the Department has been working over the last several years to develop administrative rules that address the impact of ground water use in the Study Area upon surface water flows—specifically those flows designated for the Deschutes Scenic Waterway and Instream Water Rights. Recently, the Department finalized the Deschutes Ground Water Mitigation Rules and Deschutes Basin Mitigation Bank and Mitigation Credit Rules. The rules were adopted by the Water Resources Commission (WRC) on September 13, 2002, and were effective on September 27, 2002. Copies of the rules can be obtained from the Department's web page at:

<http://www.wrd.state.or.us/law/oar1999.shtml>

The primary purpose of the rules is to provide a mechanism for those with pending ground water use applications in the Study Area to mitigate for the impact of their proposed ground water use on surface water flows. The rules do not require those with existing conditioned ground water permits (or subsequent certificates) in the Study Area to mitigate for their ground water uses.

While **only** those requesting new ground water uses from the Department are required to provide mitigation, the rules provide an opportunity for holders of existing conditioned permits to provide mitigation. Holders of existing conditioned permits that provide mitigation will no longer be subject to future regulation for scenic waterway flows.

Department staff are presently working internally to develop the processes and structure to implement the new rules. While you are not required to mitigate for your ground water use, we will be sending you a letter, sometime within the next several months, letting you know what you would need to do if you choose to mitigate for your ground water use. You may also receive additional information updates from the Department in our effort to keep you informed.

If you have any questions about the new administrative rules for the Deschutes Basin and the mitigation opportunity described in the rules; or would like to request a copy of the new rules, please contact Laura Snedaker at (503) 378-8455, extension 331, or by e-mail at Laura.K.Snedaker@wrd.state.or.us.

Sincerely,

Paul R. Cleary
Director

c: Kyle Gorman, South Central Region Manager
Jeremy Giffin, District 11 Watermaster
Deschutes Steering Committee Members



Oregon

Theodore R. Kulongoski, Governor

041 6-11-02
Water Resources Department

Commerce Building
158 12th Street NE
Salem, OR 97301-4172
503-378-3739
FAX 503-378-8130

February 7, 2003

G 12715
KENNETH R., POWELL
POWELL, JENNIFER K.
7810 NE EMERSON
MADRAS, OR 97741

RE: Deschutes Ground Water Mitigation Rules, Division 505
Deschutes Basin Mitigation Bank and Mitigation Credit Rules, Division 521

Dear Water Right Permit Holder:

Our records indicate that you are the holder of a ground water permit issued by the Department after July 17, 1995, in the Deschutes Basin Ground Water Study Area (Study Area). Your permit (or subsequent certificate) was issued with a condition allowing for regulation of use if it was later determined that the use would "measurably reduce" scenic waterway flows in the Deschutes River.

As you may be aware, the Department has been working over the last several years to develop administrative rules that address the impact of ground water use in the Study Area upon surface water flows—specifically those flows designated for the Deschutes Scenic Waterway and Instream Water Rights. Recently, the Department finalized the Deschutes Ground Water Mitigation Rules and Deschutes Basin Mitigation Bank and Mitigation Credit Rules. The rules were adopted by the Water Resources Commission (WRC) on September 13, 2002, and were effective on September 27, 2002. Copies of the rules can be obtained from the Department's web page at:

<http://www.wrd.state.or.us/law/oar1999.shtml>

The primary purpose of the rules is to provide a mechanism for those with pending ground water use applications in the Study Area to mitigate for the impact of their proposed ground water use on surface water flows. The rules do not require those with existing conditioned ground water permits (or subsequent certificates) in the Study Area to mitigate for their ground water uses.

While **only** those requesting new ground water uses from the Department are required to provide mitigation, the rules provide an opportunity for holders of existing conditioned permits to provide mitigation. Holders of existing conditioned permits that provide mitigation will no longer be subject to future regulation for scenic waterway flows.

Department staff are presently working internally to develop the processes and structure to implement the new rules. While you are not required to mitigate for your ground water use, we will be sending you a letter, sometime within the next several months, letting you know what you would need to do if you choose to mitigate for your ground water use. You may also receive additional information updates from the Department in our effort to keep you informed.

If you have any questions about the new administrative rules for the Deschutes Basin and the mitigation opportunity described in the rules; or would like to request a copy of the new rules, please contact Laura Snedaker at (503) 378-8455, extension 331, or by e-mail at Laura.K.Snedaker@wrд.state.or.us.

Sincerely,



Paul R. Cleary
Director

c: Kyle Gorman, South Central Region Manager
Jeremy Giffin, District 11 Watermaster
Deschutes Steering Committee Members



Oregon

Theodore R. Kulongoski, Governor

Water Resources Department

Commerce Building
158 12th Street NE
Salem, OR 97301-4172
503-378-3739
FAX 503-378-8130

March 31, 2003

Certified mail number 1105 2226
Return receipt requested

K & J POWELL
7810 NE EMERSON
MADRAS OR 97741

Reference: Application G14152, Permit G12715

Dear Permit Holder:

This letter is in regard to your water use permit as referenced above. Your permit required you to complete the development of your water use by October 1, 1999.

In order for the Department to consider issuance of a certificate of water right, you are required by law to hire a certified water right examiner to prepare and submit a claim of beneficial use, to include a final proof survey map of the development. The map and claim of beneficial use was to have been submitted to our Department within one year of October 1, 1999. A list of certified water right examiners is enclosed for your use.

If you are not finished with the development of your permit, you need to file for an extension of time to complete your development. An extension form is also enclosed with this letter.

In the event that you are no longer using water as allowed by this permit, you should cancel it so that we may clear our records. A cancellation form is enclosed, if you are interested in this option.

If you have not submitted either a Claim of Beneficial Use or a request for an extension of time of your permit within 60 days of the date of this letter (May 30, 2003) the Department may cancel your permit without further notice.

Please give me a call if you have questions. My phone number is 503-378-8455 extension 274.

Sincerely,

Jerry Sauter
Water Rights Program Analyst

Enclosures (3)

cc: OWRD Watermaster District 11
G DE JARNATT, CWRE DE JARNATT LAND SURVEY INC 63885 NW HWY 97, BEND OR 97701
File G14152

WATER RESOURCES DEPT.
COMMERCE BUILDING
58 12th STREET NE
SALEM, OR 97301-4172

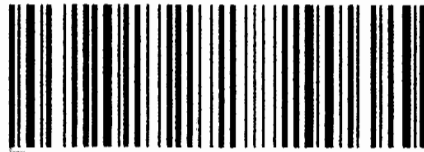

7001 2510 0005 1105 2226

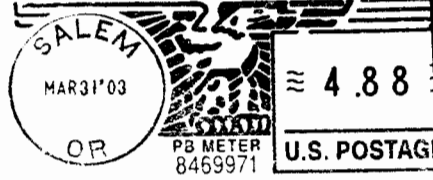

WR JS



NOT DELIVERABLE AS ADDRESSED
NO FORWARDING ORDER ON FILE 04/03/03

POW810 977412006 1N
RETURN TO SENDER

NO FORWARD ORDER ON FILE
UNABLE TO FORWARD
RETURN TO SENDER



014102J51105 2226

K & J POWELL
7810 NE EMERSON
MADRAS OR 97741

RECEIVED

APR 07 2003

WATER RESOURCES DEPT.
SALEM, OREGON



Oregon

John A. Kitzhaber, M.D., Governor

Water Resources Department

Commerce Building
158 12th Street NE
Salem, OR 97301-4172
(503) 378-3739
FAX (503) 378-8130

April 24, 2001

Kenneth And Jennifer Powell
7810 NE Emerson
Madras, OR 97741

Reference: File G-14152

The assignment of Permit G-12715 from Northwest Farm Credits Services to you has been recorded in the records of the Water Resources Department.

Our records have been changed accordingly, and the original Request for Assignment is enclosed. Receipt number 44352 covering the recording fee of \$25 has been sent to Northwest Farm Credits Services.

Sincerely,

Dallas S. Miller
Water Rights Specialist

Enclosures

cc: Watermaster #11
Data Center/OWRD
Gary Deleernatt, CWR
Northwest Farm Credit

SENDER: COMPLETE THIS SECTION

- Complete items 1, 2, and 3. Also complete item 4 if Restricted Delivery is desired.
- Print your name and address on the reverse so that we can return the card to you.
- Attach this card to the back of the mailpiece, or on the front if space permits.

1. Article Addressed to:
G14152JS1105 2226
K & J POWELL
7810 NE EMERSON
MADRAS OR 97741

2. Article Number
(Transfer from service label)

COMPLETE THIS SECTION ON DELIVERY

A. Signature X		<input type="checkbox"/> Agent <input type="checkbox"/> Addressee
B. Received by (Printed Name)	C. Date of Delivery	
D. Is delivery address different from item 1? <input type="checkbox"/> Yes If YES, enter delivery address below: <input type="checkbox"/> No		

3. Service Type

<input checked="" type="checkbox"/> Certified Mail	<input type="checkbox"/> Express Mail
<input type="checkbox"/> Registered	<input type="checkbox"/> Return Receipt for Merchandise
<input type="checkbox"/> Insured Mail	<input type="checkbox"/> C.O.D.

4. Restricted Delivery? (Extra Fee) Yes

7001 2510 0005 1105 2226

**STATE OF OREGON
WATER RESOURCES DEPARTMENT**

RECEIPT # **44352**

158 12TH ST. N.E.
SALEM, OR 97310-0210
378-8455 / 378-8130 (FAX)

INVOICE # _____

RECEIVED FROM: Farm Credit Services

PERMIT	G14152
TRANSFER	

BY: _____

CASH: CHECK: # 66-798 OTHER: (IDENTIFY)

TOTAL REC'D \$ 25.00

0417 WRD MISC CASH ACCT

ADJUDICATIONS	\$
PUBLICATIONS / MAPS	\$
OTHER: (IDENTIFY)	\$
OTHER: (IDENTIFY)	\$

REDUCTION OF EXPENSE

CASH ACCT. \$

PCA AND OBJECT CLASS VOUCHER #

0427 WRD OPERATING ACCT

MISCELLANEOUS

0407 COPY & TAPE FEES	\$
0410 RESEARCH FEES	\$
0408 MISC REVENUE: (IDENTIFY)	\$ <u>25.00</u>
TC162 DEPOSIT LIAB. (IDENTIFY)	\$

Assign.

WATER RIGHTS:

0201 SURFACE WATER	EXAM FEE	0202	RECORD FEE
0203 GROUND WATER	\$	0204	\$
0205 TRANSFER	\$	0206	\$

WELL CONSTRUCTION

0218 WELL DRILL CONSTRUCTOR	EXAM FEE	0219	LICENSE FEE
LANDOWNER'S PERMIT	\$	0220	\$

OTHER (IDENTIFY) _____

0437 WELL CONST. START FEE

0211 WELL CONST START FEE	\$	CARD #
0210 MONITORING WELLS	\$	CARD #

OTHER (IDENTIFY) _____

0539 LOTTERY PROCEEDS

1302 LOTTERY PROCEEDS	\$
-----------------------	----

0467 HYDRO ACTIVITY

0233 POWER LICENSE FEE (FW/WRD)	LIC NUMBER	\$
0231 HYDRO LICENSE FEE (FW/WRD)		\$
HRDRO APPLICATION		\$

RECEIPT # **44352**

DATED: 04/16/01 BY: C. Vance



Farm Credit Services

559 S. Seventh Street
P.O. Box 607
Redmond, OR 97756



U.S. POSTAGE

1380

PB5520470

2000 \$ 00.34 APR 12 2001

1130 MAILED FROM ZIP CODE 97756

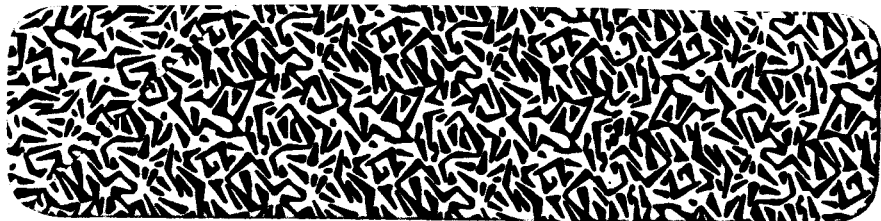

97310%0210





Oregon

Theodore R. Kulongoski, Governor

Water Resources Department

Commerce Building
158 12th Street NE
Salem, OR 97301-4172
503-378-3739
FAX 503-378-8130

March 31, 2003

Certified mail number 1105 2226
Return receipt requested

K & J POWELL
7810 NE EMERSON
MADRAS OR 97741

Reference: Application G14152, Permit G12715

Dear Permit Holder:

This letter is in regard to your water use permit as referenced above. Your permit required you to complete the development of your water use by October 1, 1999.

In order for the Department to consider issuance of a certificate of water right, you are required by law to hire a certified water right examiner to prepare and submit a claim of beneficial use, to include a final proof survey map of the development. The map and claim of beneficial use was to have been submitted to our Department within one year of October 1, 1999. A list of certified water right examiners is enclosed for your use.

If you are not finished with the development of your permit, you need to file for an extension of time to complete your development. An extension form is also enclosed with this letter.

In the event that you are no longer using water as allowed by this permit, you should cancel it so that we may clear our records. A cancellation form is enclosed, if you are interested in this option.

If you have not submitted either a Claim of Beneficial Use or a request for an extension of time of your permit within 60 days of the date of this letter (May 30, 2003) the Department may cancel your permit without further notice.

Please give me a call if you have questions. My phone number is 503-378-8455 extension 274.

Sincerely,

Jerry Sauter
Water Rights Program Analyst

Enclosures (3)

cc: OWRD Watermaster District 11
G DE JARNATT, CWRE DE JARNATT LAND SURVEY INC 63885 NW HWY 97, BEND OR 97701
File G14152



PERMIT STATUS REVIEW BY jil DATE 3/11/03 FILE # C-14152

1. Per Dwight French, do not send "C" DATE NOTICE PACKET if: note on JS list
no Permit is for municipal or quasi-municipal use or in Bonanza study area
(per DF, when in doubt about MU/QM, change database code)

no Extension pending _____ final _____

no Assignment is pending _____

no Cancellation is requested _____ final _____

no Dept. has already sent a certified "Form 100" letter (date _____, # _____)
Was 60 days notice allowed? _____
Was mail deliverable as addressed? _____ date _____
Send cancellation letter _____

no Claim of beneficial use and final proof map (COBU) have been received by Department
Date information received _____

2. IF NONE OF THE ABOVE APPLY

no Send certified "C" date notice packet to permit holder.

"C" DATE 3/11/03
WATERMASTER DISTR # 4 WATERMASTER NAME _____
CWRE or AGENT Larry McParrott

McParrott Land Management
63885 7th Ave, NW
Seattle, WA 98148

STATE OF OREGON

COUNTY OF JEFFERSON

PERMIT TO APPROPRIATE THE PUBLIC WATERS

THIS PERMIT IS HEREBY ISSUED TO

RAY D AND LINDA R GILLETT
7810 NE EMERSON DR
MADRAS, OREGON 97741

(541)475-3874

The specific limits for the use are listed below along with conditions of use.

APPLICATION FILE NUMBER: G-14152

SOURCE OF WATER: A WELL IN DESCHUTES RIVER BASIN

PURPOSE OR USE: IRRIGATION OF 16.5 ACRES

MAXIMUM RATE OF ALLOWED USE: 0.206 CUBIC FOOT PER SECOND

PERIOD OF USE: MARCH 1 THROUGH OCTOBER 31

DATE OF PRIORITY: AUGUST 14, 1995

POINT OF DIVERSION LOCATION: NE 1/4 NE 1/4, SECTION 33, T9S, R14E, W.M.;
1100 FEET SOUTH AND 550 FEET WEST FROM THE NE CORNER OF SECTION 33

The amount of water used for irrigation under this right, together with the amount secured under any other right existing for the same lands, is limited to a diversion of ONE-EIGHTIETH of one cubic foot per second (or its equivalent) and 3.0 acre-feet for each acre irrigated during the irrigation season of each year.

THE PLACE OF USE IS LOCATED AS FOLLOWS:

SW 1/4 SE 1/4 [REDACTED] ACRES
SECTION 28
NE 1/4 NE 1/4 [REDACTED] ACRES
NW 1/4 NE 1/4 [REDACTED] ACRES
SE 1/4 NE 1/4 [REDACTED] ACRES
SECTION 33

TOWNSHIP 9 SOUTH, RANGE 14 EAST, W.M.

Measurement, recording and reporting conditions:

- A. Before water use may begin under this permit, the permittee shall install a meter or other suitable measuring device as approved by the Director. The permittee shall maintain the meter or measuring device in good working order.



Oregon

John A. Kitzhaber, M.D., Governor

Water Resources Department

Commerce Building
158 12th Street NE
Salem, OR 97310-0210
(503) 378-3739
FAX (503) 378-8130

January 9, 1998

RAY D. & LINDA R. GILLETT
7810 NE EMERSON DRIVE
MADRAS, OR 97741

With regard to the pump test requirements for the following well and its associated water right:

APP. #: G-14152 PERMIT: G-12715 USER-ID: 27802 POD-ID: 37709

Recently, while auditing groundwater files for the Deschutes Basin Study, we discovered a number of pump tests that were in the Water Right Application File but not accounted for by our Pump Test Program. I apologize on behalf of the department for this oversight and hope that this has not caused any problems for you.

The Water Resources Department has reviewed and accepted the pump test results you submitted. The Department requires no further testing at this time. However, you will be required to submit a static water level measurement of the well on the ten-year anniversary of the test you conducted. If your permit or certificate includes a condition that requires annual static water level measurements, please continue to make and report these measurements unless otherwise instructed.

We appreciate your cooperation with this program. If you have any questions, please contact me at (503) 378-8455 ext. 289 or Mike Zwart at ext. 207. The Departments toll-free number is 1-800-624-3199.

Sincerely,

R. Craig Kohanek
Pump Test Coordinator

May 12, 1997

NORTHWEST FARM CREDIT SERVICES ACA
PO BOX 607
REDMOND OR 97756

REFERENCE: File G-14152

The assignment of Permit G-12715 from Ray and Linda Gillett to you and Kenneth and Jennifer Powell has been recorded in the records of the Water Resources Department.

Our records have been changed accordingly and the original is enclosed along with our receipt number 11993 covering the recording fee of \$15 you submitted.

Sincerely,

DALLAS S. MILLER
Water Rights Specialist

DSM:jh

Enclosure

cc: Kyle Gorman, Watermaster
Gary DeJarnatt, CWRE
Ray & Linda Gillett
Kenneth & Jennifer Powell



Commerce Building
158 12th Street NE
Salem, OR 97310-0210
(503) 378-3739
FAX (503) 378-8130

**STATE OF OREGON
WATER RESOURCES DEPARTMENT**

RECEIPT # **11993**

158 12TH ST. N.E.
SALEM, OR 97310-0210
378-8455 / 378-8130 (FAX)

INVOICE # _____

RECEIVED FROM: Farm Credit
BY: Services

APPLICATION	G14152
PERMIT	12715
TRANSFER	

CASH: CHECK: # BS-463 OTHER: (IDENTIFY)

TOTAL REC'D \$ 15.

0417 WRD MISC CASH ACCT

ADJUDICATIONS	\$
PUBLICATIONS / MAPS	\$
OTHER: (IDENTIFY)	\$
OTHER: (IDENTIFY)	\$

REDUCTION OF EXPENSE

CASH ACCT.	\$
VOUCHER #	

0427 WRD OPERATING ACCT

PCA AND OBJECT CLASS	VOUCHER #
----------------------	-----------

PCA 66111

0407 MISCELLANEOUS COPY & TAPE FEES	\$
0410 RESEARCH FEES	\$
0408 MISC REVENUE: (IDENTIFY)	\$ <u>15.</u>
TC165 DEPOSIT LIAB. (IDENTIFY)	\$

assignment

WATER RIGHTS:

0201 SURFACE WATER	EXAM FEE	0202	RECORD FEE
0203 GROUND WATER	\$	0204	\$
0205 TRANSFER	\$	0206	\$

WELL CONSTRUCTION

0218 WELL DRILL CONSTRUCTOR	EXAM FEE	0219	LICENSE FEE
LANDOWNER'S PERMIT	\$	0220	\$

OTHER (IDENTIFY) _____

0437 WELL CONST. START FEE

0211 WELL CONST START FEE	\$	CARD #	
0210 MONITORING WELLS	\$	CARD #	

OTHER (IDENTIFY) _____

0539 LOTTERY PROCEEDS

1302 LOTTERY PROCEEDS	\$
-----------------------	----

0467 HYDRO ACTIVITY

0233 POWER LICENSE FEE (FW/WRD)	LIC NUMBER	\$
0231 HYDRO LICENSE FEE (FW/WRD)		\$
HRDRO APPLICATION		\$

RECEIPT # **11993**

DATED: 5-5-97 BY: D. Russell

RECEIVED

MAY - 5 1997

WATER RESOURCES DEPT.
SALEM, OREGON

REQUEST FOR ASSIGNMENT

I, (permit holder/applicant) Ray D. Gillett and Linda R. Gillett, husband and wife

7810 NE Emerson Madras OR 97741(541)4751573
(Mailing Address) (City) (State) (Zip) (Phone)

CHECK ONE

hereby assign all my interest in and to application/permit;

hereby assign all my interest in and to a portion of application/permit (include a map showing portion of application assigned);

hereby assign a portion of my interest in and to the entire application/permit;

Application #G-14152, Permit #G-12715; Or GR Statement #__, GR Certificate of Registration #__ as filed in the office of the Water Resources Director, to:

Northwest Farm Credit Services, ACA
(name of new owner)

559 South 7th Street, PO Box 607 Redmond Deschutes OR 97756 (541)548-2126
(address) (city) (county) (state) (zip) (phone)

AND

Kenneth R. Powell and Jennifer K. Powell
(name of new owner)

7810 NE Emerson Madras Jefferson OR 97741 (541)475-1573
(address) (city) (county) (state) (zip) (phone)

(Note: If there are other owners of the property described in this Application, Permit or Certificate of Groundwater Registration you must attach a list of their names and addresses to this form.)

I hereby certify that I have notified all other owners of the property described in this Application, Permit or Certificate of Registration of this request for assignment.

STATE OF OREGON,)

) ss

County of Marion.)

I certify that the within was received by me on the 5th day of May, 1997, at 8 o'clock A. m., and was recorded in the Miscellaneous Records, Vol. 7 Page 3422

Water Resources Director

*OK
DSM*

5
KJG

Application G-14152

COPY CHECK-OFF SHEET FOR PROPOSED FINAL ORDERS

CC: FILE # G-14152 ✓

WATERMASTER # 11 ✓

REGIONAL MANAGER: South Central Region ✓

ODF&W - Jefferson County: ✓

CWRE (if agent): Gary L DeJarnatt #033 ✓

DEQ ✓

OTHER STATE AGENCY IF NECESSARY:

DIVISION 33 LIST: COLUMBIA RIVER INTERTRIBAL FISH COMMISSION; U.S. FISH & WILDLIFE;
(CHECK ONLY IF APPLICABLE) NORTHWEST POWER PLANNING COUNCIL & NATIONAL MARINE FISHERIES

POWER BUILDER UPDATER; FRONT COUNTER

OTHER ADDRESSES OF PEOPLE WHO PAID THE \$10 FEE:

PEOPLE WITH OBJECTIONS, COMMENTS OR REQUESTED COPY W/O \$10 (SEND THE \$10 LETTER):

CASEWORKER : JKS-007

IR CHECKLIST

Application #: G-14152 Vol _____ Subbasin Lower Deschutes
Basin: 5 - Deschutes WAB: N/A- 010321 POU-WAB 010321
Township 9 S Range 14 E Section 33 1/4 1/4 POD & POU - NENE
POU - NENE & SENE

- 1. Items have been verified on Completeness Checklist. S. 28 - POU - SWSE
- 2. Check file for indicators that the process should not continue until a later date (ie - protest, items (other than oath) missing from the completeness check, letter to file indicating hold, or other)
- 3. A groundwater review has been evaluated for substantial interference with surface water (convert old gw conditions to the 7 series and add to the PFO, if necessary) 7B, 7J & Preponderance

Trout cr trib to Deschutes (mile 88)

- 4. Is the Proposed Use located in or above a Scenic Waterway?
- 5. Is the proposed use located in a TMDL Basin? (Tualatin, Yamhill, Pudding)
- 6. Is the use allowed or limited by the Basin Program? Lower Deschutes OAR(s) 690-505-003(1)(a)

- 7. Is the source withdrawn or limited? - State Engineer, Legislative (ORS 538), etc.
- 8. Basin Maps (metal cabinet) have been checked and River Mile South of 3.0 of Trout Creek has been identified

N/A 9. Water Availability Data has been verified (50% < July 17, 1992/80% [50% storage] > July 17, 1992) Well NOT hydraulically connected to surface water

- 10. Rate 1/80 Duty 3 Season Mar. 1 - Oct. 31
- 11. Use Irrigation Period of Allowed Use Mar. 1 - Oct. 31
- 12. Priority Date(s) August 14, 1995

N/A 13. Is use from a B.O.R. project and if so, is a signed contract in the file? _____

N/A 14. Division 33 (Abv Bonn > July 1, 1992 & Blw Bonn > April 18, 1994 or June 3, 1994) Well NOT hydraulically connected

- 15. Plat cards have been checked and a copy of the map is attached showing the conflict with No Conflict

- 17. Land use approval OK'd needs approval county notified

19. conditions? (BOR, GW, etc.) 7B, 7J & Preponderance

20. Watermaster District #: 11 - Kyle Gorman

- 21. Regional Office (NWR, NCR, ER, SCR, or SWR)

- 22. IR has been saved to m:\tir\sent\app # from m:\tir\work\app #

Allowed
0.206
cfs

110.0 gpm ÷ 448.8 = 0.2451 16.5 Ac 16.5 ÷ 80 = 0.2063
0.245 cfs 0.206 cfs

Name: [Signature] Date: 4-10-96

(E) The maximum economic development of this state, the attainment of the highest and best use of the waters of the natural lakes of the Middle Deschutes River Basin, and the attainment of an integrated and coordinated program for the benefit of the state as a whole will be furthered through utilization of the aforementioned waters only for domestic, livestock, irrigation of lawn or noncommercial garden not to exceed one-half acre in area, power development not to exceed 7 1/2 theoretical horsepower, recreation, wildlife and fish life uses.

(b) Applications for the use of the waters of the Middle Deschutes River Basin shall not be accepted by any state agency for any other use and the granting of applications for such other uses is declared to be prejudicial to the public interest and the granting of applications for such other uses would be contrary to the integrated and coordinated program for the use and control of the water resources of the state.

(c) Structures or works for the utilization of the waters in accordance with the aforementioned classifications are also declared to be prejudicial to the public interest unless planned, constructed, and operated in conformity with the applicable provisions of ORS 536.310 and any such structures or works are further declared to be prejudicial to the public interest which do not give proper cognizance to the multiple-purpose concept.

(2) **Minimum Perennial Streamflows**

For the purpose of maintaining a minimum perennial streamflow sufficient to support aquatic life, no appropriations of water except for domestic or livestock uses shall be made or granted by any state agency or public corporation of the state for the waters of Lake Creek or its tributaries above the confluence of Lake Creek with the Metolius River for flows of Lake Creek below 20 cubic feet per second measured at the mouth of Lake Creek except that this limitation shall not apply to waters legally stored or legally released from storage (priority date - May 24, 1962).

(3) **Water Quality**

Rights to use of water for industrial or mining purposes granted by any state agency shall be issued only on condition that any effluents or return flows from such uses shall not interfere with other beneficial uses of water.

Lower Deschutes River Basin

690-505-003

(1) **Classifications**

(a) The maximum economic development of this state, the attainment of the highest and best use of the waters of the Lower Deschutes River Basin, and the attainment of an integrated and coordinated program for the benefit of the state as a whole will be furthered through utilization of the aforementioned waters only for domestic, livestock, municipal, irrigation, power development, industrial, mining, recreation, wildlife and fish life uses and the waters of the Lower Deschutes River Basin are hereby so classified with the following exceptions:

(A) OAR 690-505-006, Lower Main Stem Deschutes River, adopted April 3, 1964, as modified by the Water Policy Review Board.

(B) The waters of Boulder Lake in Hood River and Wasco Counties are classified only for domestic and livestock uses; power development not to exceed 7-1/2 theoretical horsepower; recreation, wildlife and fish life uses; and irrigation not to exceed 100 acre-feet annually from water stored in the lake.

(C) The maximum economic development of this state, the attainment of the highest and best use of the waters of the other natural lakes of the Lower Deschutes River Basin, and the benefit of the state as a whole will be furthered through utilization of the aforementioned waters only for domestic, livestock, irrigation of lawn or noncommercial garden not to exceed one-half acre in area, power development not to exceed 7-1/2 theoretical horsepower, recreation, wildlife, and fish life uses and the waters of the natural lakes of the Lower Deschutes River Basin are hereby so classified.

(b) Applications for the use of the waters of the Lower Deschutes River Basin shall not be accepted by any state agency for any other use and the granting of applications for such other uses is declared to be prejudicial to the public interest and the granting of applications for such uses would be contrary to the integrated and coordinated program for the use and control of the water resources of the state.

(c) Structures or works for the utilization of the waters in accordance with the aforementioned classifications are also declared to be prejudicial to the public interest unless planned, constructed, and operated in conformity with the applicable provisions of ORS 536.310 and any such structures or works are further declared to be prejudicial to the public interest which do not give cognizance to the multiple-purpose concept.

(2) Minimum Perennial Streamflows

For the purpose of maintaining a minimum perennial streamflow sufficient to support aquatic life, no appropriations of water except for domestic or livestock uses shall be made or granted by any state agency or public corporation of the state for the waters of the White River or its tributaries above the confluence of White River with the Deschutes River for flows of the White River below the specified flows in Table 2, except that this limitation shall not apply to waters legally stored or legally released from storage.

(3) Water Quality

Rights to use of water for industrial or mining purposes granted by any state agency shall be issued only on condition that any effluents or return flows from such uses shall not interfere with other beneficial uses of water.

Upper Crooked River Basin

690-505-004

(1) Classifications

TOWNSHIP 95 RANGE 14E W. M. SECTION 28

NE				NW				SW				SE				APPLICATION NUMBER	PERMIT NUMBER	CERTIFICATE NUMBER
NE	NW	SW	SE	NE	NW	SW	SE	NE	NW	SW	SE	NE	NW	SW	SE			
		32 ⁷						38 ³	37 ⁶			33 ³	08	23 ⁶	24921	23196	51231	
		32 ⁷						38 ³	37 ⁶			33 ³	08	23 ⁶	30083	25821	51232	
				12 ²				48 ⁰²		60			38	10 ⁸	45404	33954	51233	
				<i>Quasi Municipal</i>											48909	36515		
		23 ³											19 ²		49366	36704	55503	
				33 ³				12 ²	5 ⁴	39 ⁸	38 ² 5 ⁸	34 ²	5 ⁴	22 ²	55975	41519	CANCELED	
		23 ²						03	04				19 ²		T-6311	(C-51231)		
		23 ²						02	04				19 ²		T-6311	(C-51232)		

✓ NCR
 ✓ NCR
 ✓ NCR
 per Final Proof Map D-3-9
 (covers files 24921, 30083 & 45404)

TOWNSHIP 95 RANGE 14E W. M. SECTION 33

NE				NW				SW				SE				APPLICATION NUMBER	PERMIT NUMBER	CERTIFICATE NUMBER
NE	NW	SW	SE	NE	NW	SW	SE	NE	NW	SW	SE	NE	NW	SW	SE			
12 ³	0 ³				36	39			15 ²	35 ¹	17 ⁶					24921	23196	51231
12 ³	0 ³				36	39			15 ²	35 ¹	17 ⁶					30083	25921	51232
	8 ²	21 ⁶						10 ⁶	7 ⁶	22				8 ²		45404	33954	51233
				<i>Quasi Municipal</i>											48909	36515		
								04					5 ⁶		6-7512	6-6989	67060	
		11 ²	9 ² 22 ²					32 ²	38 ²	6 ²	3 ² 15 ⁶	36 ²	8 ¹		55975	41519	CANCELED	
													9 ²	15 ²	6-8539	6-7957	2	

Cancelled →

✓ NCR
 ✓ NCR
 ✓ NCR

TO: Water Rights Section 4/4, 1996
 FROM: Groundwater/Hydrology Section Gates
 SUBJECT: Application G- 14152 Reviewer's Name

GROUNDWATER/SURFACE WATER CONSIDERATIONS

1. PER THE Deschutes Basin rules, one or more of the proposed POA's is/is not within _____ feet/mile of a surface water source (_____) and taps a groundwater source hydraulically connected to the surface water.
2. BASED UPON OAR 690-09 currently in effect, I have determined that the proposed groundwater use
 - a. ___ will, or have the potential for substantial interference with the nearest
 - b. will not surface water source, namely Trout Creek / Deschutes River
 - c. ___ will if properly conditioned, adequately protect the surface water from interference:
 - i. ___ The permit should contain condition #(s) _____;
 - ii. ___ The permit should contain special condition(s) as indicated in "Remarks" below;
 - iii. ___ The permit should be conditioned as indicated in item 4 below; or
 - d. ___ will, with well reconstruction, adequately protect the surface from substantial interference.

GROUNDWATER AVAILABILITY CONSIDERATIONS

3. BASED UPON available data, I have determined that groundwater for the proposed use
 - a. ___ will, or likely be available in the amounts requested without injury to prior rights
 - b. ___ will not and/or within the capacity of the resource; or
 - c. will if properly conditioned, avoid injury to existing rights or to the groundwater resource:
 - i. The permit should contain condition #(s) 7J, 7B;
 - ii. ___ The permit should contain special condition(s) as indicated in "Remarks" below;
 - iii. ___ The permit should be conditioned as indicated in item 4 below; or
4.
 - a. ___ THE PERMIT should allow groundwater production from no deeper than _____ ft. below land surface;
 - b. ___ The permit should allow groundwater production from no shallower than _____ ft. below land surface;
 - c. ___ The permit should allow groundwater production only from the _____ groundwater reservoir between approximately _____ ft. and _____ ft. below land surface;
 - d. ___ Well reconstruction is necessary to accomplish one or more of the above conditions.
 - e. ___ One or more POA's commingle 2 or more sources of water. The applicant must select one source of water per POA and specify the proportion of water to be produced from each source.

REMARKS: _____

(Well Construction Considerations on Reverse Side)

WELL CONSTRUCTION (If more than one well doesn't meet standards, attach an additional sheet.)

5. THE WELL which is the point of appropriation for this application does not meet current well construction standards based upon:
- a. ___ review of the well log;
 - b. ___ field inspection by _____;
 - c. ___ report of CWRE _____;
 - d. ___ other: (specify) _____

6. THE WELL construction deficiency:
- a. ___ constitutes a health threat under Division 200 rules;
 - b. ___ commingles water from more than one groundwater reservoir;
 - c. ___ permits the loss of artesian head;
 - d. ___ permits the de-watering of one or more groundwater reservoirs;
 - e. ___ other: (specify) _____

7. THE WELL construction deficiency is described as follows: _____

8. THE WELL
- a. ___ was, or constructed according to the standards in effect at the time of
 - b. ___ was not original construction or most recent modification.
 - c. ___ I don't know if it met standards at the time of construction.

RECOMMENDATION:

- A. ___ I recommend including the following condition in the permit:
"No water may be appropriated under terms of this permit until the well(s) has been repaired to conform to current well construction standards and proof of such repair is filed with the Enforcement Section of the Water Resources Department."
- B. ___ I recommend withholding issuance of the permit until evidence of well reconstruction is filed with the Enforcement Section of the Water Resources Department.
- C. ___ REFER this review to Enforcement Section for concurrence.

THIS SECTION TO BE COMPLETED BY ENFORCEMENT PERSONNEL

I concur in G/H's recommendation A or B above relating to conditioning or withholding the permit
_____, 199__.
(Signature)

I do not concur in G/H's recommendation A or B above relating to conditioning or withholding the permit for the following reasons: _____

_____, 199__.
(Signature)

Water Right Conditions Tracking Slip

Groundwater/Hydrology Section

FILE ## 61452

ROUTED TO: Marilyn

TOWNSHIP/

RANGE-SECTION: 9S/14E-33

APPLICATION ACCEPTED? yes no
CONDITIONS ATTACHED? yes no

REMARKS OR FURTHER INSTRUCTIONS:

Reviewer: Gates

FILE # B-14152

FO CHECKLIST

REVIEW DATE: 8/5/96

WEEK # 48

PFO TO FO CONVERSION

INITIALS: JTG

In preparing the FO, you should check the following:

1. Y/N Were comments or protests received in response to the PFO?
2. X If #1 = "Y", from whom were the comments received and when?
3. A Verify names and addresses on the PFO CC list. ALL commentors (regardless of comment date), affected landowners (were they notified?), and those who paid the \$10 fee should be listed.
4. X Verify payment of recording fees (circle the appropriate option)
 - (1) Issue FO w/permit if fees are paid -- Prepare refund request for excess fees, including standing fees if no protest is filed and no modifications are being made to the PFO
 - (2) Issue FO w/o permit if fees are lacking
5. Y/N Is the file lacking a signed oath of accuracy for the application?
6. Y/N Has ODFW asked for self certification on screening condition?
7. Y/N Is water use prohibited for one or more months of the normal use period?
8. Y/N If #6 = "Y", is short season letter on file? Note: If short season letter is lacking prepare FO with Draft permit giving applicant 60 days to submit letter.
9. Y/N Is further processing possible? If not state reason: _____
10. _____ Notify applicant of additional information or fees required prior to permit issuance (SEND CERTIFIED LETTER & use standard wording from M:\T\FO\TOOLS if possible)
11. _____ Assign permit numbers to files with oath, fees, and no protests or other issues

200
100
14

Route to: (circle one)

DENIAL	FO w/o PERMIT	FO & PERMIT	COMMENTS
LARRY	JERRY	JEREMY	DOUG

MC: 7B/5

Initials JTG

Modify FO as needed to:

12. AWJ Respond to significant comments, issues, or disputes related to the proposed use of water (see notes, if any, listed above)
13. _____ Include or exclude permit conditions and management codes
14. _____ Correct PFO errors (such as POD or POU location (verify from map), Permit format)

Once FO document is completed:

15. AWJ Save WordPerfect document in M:\T\FO\WEEK 48 & delete duplicates
16. AWJ Print final draft of document and submit to team leader for review
17. D/N Team leader review completed

Oregon Water Resources Department
Water Rights Division

Water Rights Application
Number G-14152

Proposed Final Order

Summary of Recommendation: The Department recommends that the attached draft permit be issued with conditions.

Application History

On August 14, 1995, Ray D and Linda R Gillett submitted an application to the Department for the following water use permit:

- Amount of Water: 110.0 gallons per minute (0.24 cfs)
- Use of Water: Irrigation of 16.5 acres
- Source of Water: A well in Deschutes River Basin
- Area of Proposed Use: Jefferson County within Sections 28 and 33, Township 9 South, Range 14 East, W.M.

On April 12, 1996, the Department mailed the applicant notice of its Initial Review, determining that the use of 0.206 cfs of water from one well, within the Lower Deschutes Basin, for Irrigation of 16.5 acres may be allowed from March 1 through October 31, during the Irrigation season. The applicant did not notify the Department to stop processing the application within 14 days of that date.

On April 30, 1996, the Department gave public notice of the application in its weekly notice. The public notice included a request for comments, and information for interested persons about both obtaining future notices and a copy of the proposed final order.

No written comments were received within 30 days.

In reviewing applications, the Department may consider any relevant sources of information, including the following:

- comments by or consultation with another state agency
- any applicable basin program
- any applicable comprehensive plan or zoning ordinance
- the amount of water available
- the rate and duty for the proposed use
- pending senior applications and existing water rights of record
- designations of any critical groundwater areas
- the Scenic Waterway requirements of ORS 390.835
- applicable statutes, administrative rules, and case law

- any general basin-wide standard for flow rate and duty of water allowed
- the need for a flow rate and duty higher than the general standard
- any comments received

Findings of Fact

The Deschutes Basin Program allows the following uses: Irrigation

Senior water rights exist on a well in Deschutes River Basin or on downstream waters.

A well in Deschutes River Basin is above a State Scenic Waterway.

Water is available for further appropriation (at an 80 percent exceedance probability) for the period March 1 through October 31.

The Department finds that 0.206 cfs would be necessary for the proposed use. The amount of water requested, 0.24 cfs (110.0 gallons per minute), shall be restricted to 0.206 cfs.

The Department determined, based upon OAR 690-09, that the proposed groundwater use will not have the potential for substantial interference with the nearest surface water source, namely **Trout Creek**.

The Groundwater Section finds that there is **NOT** a preponderance of evidence that the proposed use of groundwater will measurably reduce the surface water flows necessary to maintain the free-flowing character of a scenic waterway in quantities necessary for recreation, fish and wildlife.

Conclusions of Law

Under the provisions of ORS 537.621, the Department must presume that a proposed use will ensure the preservation of the public welfare, safety and health if the proposed use is allowed in the applicable basin program established pursuant to ORS 536.300 and 536.340 or given a preference under ORS 536.310(12), if water is available, if the proposed use will not injure other water rights and if the proposed use complies with rules of the Water Resources Commission.

The proposed use requested in this application is allowed in the Deschutes Basin Plan.

No preference for this use is granted under the provisions of ORS 536.310(12).

Water is available for the proposed use.

The proposed use will not injure other water rights.

The proposed use complies with rules of the Water Resources Commission.

The proposed use complies with the State Agency Agreement for land use.

No proposed flow rate and duty of water higher than the general basin-wide standard is needed.

For these reasons, the required presumption has been established.

Under the provisions of ORS 537.621, once the presumption has been established, it may be overcome by a preponderance of evidence that either:

- (a) One or more of the criteria for establishing the presumption are not satisfied; or
- (b) The proposed use would not ensure the preservation of the public welfare, safety and health as demonstrated in comments, in a protest . . . or in a finding of the department that shows:
 - (A) The specific aspect of the public welfare, safety and health under ORS 537.525 that would be impaired or detrimentally affected; and
 - (B) Specifically how the identified aspect of the public welfare, safety and health under ORS 537.525 would be impaired or be adversely affected.

In this application, all criteria for establishing the presumption have been satisfied, as noted above. The presumption has not been overcome by a preponderance of evidence that the proposed use would impair or be detrimental to the public interest.

The Department therefore concludes that water is available in the amount necessary for the proposed use; the proposed use will not result in injury to existing water rights; and the proposed use would ensure the preservation of the public welfare, safety and health as described in ORS 537.525.

Recommendation

The Department recommends that the attached draft permit be issued with conditions.

DATED June 25, 1996



Steven P. Applegate

Administrator
Water Rights and Adjudications Division

Protest Rights

Under the provisions of ORS 537.621(7), you have the right to submit a protest against this proposed final order. Your protest must be in writing, and must include the following:

- Your name, address, and telephone number;
- A description of your interest in the proposed final order, and, if you claim to represent the public interest, a precise statement of the public interest represented;
- A detailed description of how the action proposed in this proposed final order would impair or be detrimental to your interest;
- A detailed description of how the proposed final order is in error or deficient, and how to correct the alleged error or deficiency;
- Any citation of legal authority to support your protest, if known; and
- If you are not the applicant, the \$200 protest fee required by ORS 536.050.
- If you are the applicant, a statement of whether or not you are requesting that a contested case hearing be held. If you do not request a hearing, the Department will presume that you do not wish for a hearing to be held.

Your protest must be received in the Water Resources Department no later than **August 9, 1996**.

After the protest period has ended, the Director will either issue a final order or schedule a contested case hearing. The contested case hearing will be scheduled only if a protest has been submitted and if

- upon review of the issues the director finds that there are significant disputes related to the proposed use of water, or
- the applicant requests a contested case hearing within 30 days after the close of the protest period.

JKS-007

DRAFT

This is not a permit!!!
STATE OF OREGON

DRAFT

COUNTY OF JEFFERSON

DRAFT PERMIT TO APPROPRIATE THE PUBLIC WATERS

THIS DRAFT PERMIT IS HEREBY ISSUED TO

RAY D AND LINDA R GILLETT
7810 NE EMERSON DR
MADRAS, OREGON 97741

(541) 475-3874

The specific limits for the use are listed below along with conditions of use.

APPLICATION FILE NUMBER: G-14152

SOURCE OF WATER: A WELL IN DESCHUTES RIVER BASIN

PURPOSE OR USE: IRRIGATION OF 16.5 ACRES

MAXIMUM RATE: 0.206 CFS

PERIOD OF USE: MARCH 1 THROUGH OCTOBER 31

DATE OF PRIORITY: AUGUST 14, 1995

POINT OF DIVERSION LOCATION: NE 1/4 NE 1/4, SECTION 33, TOWNSHIP 9 SOUTH, RANGE 14 EAST, W.M.; 1100 FEET SOUTH & 550 FEET WEST FROM NE CORNER, SECTION 33

The amount of water used for irrigation under this right, together with the amount secured under any other right existing for the same lands, is limited to a diversion of ONE-EIGHTIETH of one cubic foot per second (or its equivalent) and 3.0 acre-feet for each acre irrigated during the irrigation season of each year.

THE PLACE OF USE IS LOCATED AS FOLLOWS:

SW 1/4 SE 1/4 2.0 ACRES
SECTION 28

NE 1/4 NE 1/4 10.5 ACRES

NW 1/4 NE 1/4 2.0 ACRES

SE 1/4 NE 1/4 2.0 ACRES

SECTION 33

TOWNSHIP 9 SOUTH, RANGE 14 EAST, W.M.

Measurement, recording and reporting conditions:

- A. Before water use may begin under this permit, the permittee shall install a meter or other suitable measuring device as approved by the Director. The permittee shall maintain the meter or measuring device in good working order.
- B. The permittee shall allow the watermaster access to the meter or measuring device; provided however, where the meter or measuring device is located within a private structure, the watermaster shall request access upon reasonable notice.
- C. The Director may require the permittee to keep and maintain a record of the amount (volume) of water used and may require the permittee to report water use on a periodic schedule as established by the Director. In addition, the Director may require the permittee to report general water use information, the periods of water use and the place and nature of use of water under the permit. The Director may provide an opportunity for the permittee to submit alternative reporting procedures for review and approval.

If substantial interference with a senior water right occurs due to withdrawal of water from any well listed on this permit, then use of water from the well(s) shall be discontinued or reduced and/or the schedule of withdrawal shall be regulated until or unless the Department approves or implements an alternative administrative action to mitigate the interference. The Department encourages junior and senior appropriators to jointly develop plans to mitigate interferences.

Use of water under authority of this permit may be regulated if analysis of data available after the permit is issued discloses that the appropriation will measurably reduce the surface water flows necessary to maintain the free-flowing character of a scenic waterway in quantities necessary for recreation, fish and wildlife in effect as of the priority date of the right or as those quantities may be subsequently reduced.

STANDARD CONDITIONS

The wells shall be constructed in accordance with the General Standards for the Construction and Maintenance of Water Wells in Oregon. The works shall be equipped with a usable access port, and may also include an air line and pressure gauge adequate to determine water level elevation in the well at all times.

The use shall conform to such reasonable rotation system as may be ordered by the proper state officer.

Application G-14152

Prior to receiving a certificate of water right, the permit holder shall submit the results of a pump test meeting the department's standards, to the Water Resources Department. The Director may require water level or pump test results every ten years thereafter.

Failure to comply with any of the provisions of this permit may result in action including, but not limited to, restrictions on the use, civil penalties, or cancellation of the permit.

This permit is for the beneficial use of water without waste. The water user is advised that new regulations may require the use of best practical technologies or conservation practices to achieve this end.

By law, the land use associated with this water use must be in compliance with statewide land-use goals and any local acknowledged land-use plan.

The use of water shall be limited when it interferes with any prior surface or ground water rights.

The Director finds that the proposed use(s) of water described by this permit, as conditioned, will not impair or be detrimental to the public interest.

Actual construction of the well shall begin within one year from permit issuance, and shall be completed on or before October 1, 1998. Complete application of the water to the use shall be made on or before October 1, 1999.

Issued _____, 199_

DRAFT - THIS IS NOT A PERMIT

Water Resources Department
Director

Application G-14152
Basin 05
JKS-007

Water Resources Department
Volume 3 Trout Creek & Misc.
MGMT.CODE

PERMIT DRAFT
District 11

T.D.
APR 20, 1996
APR 20, 1996

LEON S.

9546 35

PFO CHECK SHEET

APP. NO. 6-14152 DATE OF APP. 8-14-1995

RATE & DUTY: 1/80 @ 3.0

SCENIC: Y- DESCHUTES

TMDL: N

OK-ALLOWED

USE: IRRIGATION OF 16.5 ACRES

AMOUNT: 0.206 cfs

SEASON: MARCH 1 -> OCTOBER 31

ODFW COMMENTS: /

WM: 11 RM: SOUTH CENTRAL REGION

M & R: 11

CWRE IF AGENT: GARY L. DeJANATT #033

AREA SUBMERGED: /

DEPTH OF WATER: /

HEIGHT OF DAM: /

CC LIST: _____

MACROS: 7B, 7J

CONDITIONS: _____

JKS C:\WP51

Will not have the 1000 ft. width creek

1063 Tran Creek @ 1150.

PFO CHECKLIST

Application #: _____
 Basin: 5 WAB: _____
 Township 9S Range 14E Section 28 933 1/4 1/4 _____

 A1. Public Interest Screen Criteria 1. Is the file complete by the Completeness Checklist? 2. Fees or other shortcomings (items needed before a permit and/or FO can be issued) 3. Check file for indicators that the process **should not** continue until a later date (ie - protest, letter to file indicating hold, or other) 4. A groundwater review has been evaluated for substantial interference with surface water (convert old gw conditions to the 7 series and add to the PFO, if necessary) a. Is second groundwater review necessary? (objection) b. Is HB 1033 review complete? 5. Is the source withdrawn or limited? - State Engineer, Legislative (ORS 538), etc. 6. Is the Proposed Use located in or above a Scenic Waterway? - DESCRIBES 7. Is the proposed use located in a TMDL Basin? (Tualatin, Yamhill, Pudding) 8. Is the use allowed or limited by the Basin Program? 9. If source is groundwater, is the well located in a groundwater limited area? (If applicable, include map with POD) 10. Water Availability Data has been verified (50% before July 17, 1992; 80% live flow & 50% storage after July 17, 1992) 11. Rate 1/80 Duty 3.0 Irrigation Season MARCH 1 → OCTOBER 31 12. Period of Allowed Use MARCH 1 → OCTOBER 31 13. Is use from a B.O.R. project and if so, is a signed contract in the file? 14. Division 33 has been addressed - if applicable (Above Bonn after July 17, 1992 & Below Bonn after April 8, 1994 or June 3, 1994) 15. Have conflicts been identified, verified and/or addressed? 16. Is the use Small (≤ 0.1 cfs, ≤ 9.2 AF), Medium (> 0.1 or < 1.5 cfs, > 9.2 or < 100 AF) or Large (≥ 1.5 cfs, ≥ 100 AF)? 0.206 cfs 17. Check TR/IR for permit conditions not included in the Draft Permit attached to the PFO 18. Fill out Accuracy Checklist 19. Spell Check 20. Documents used in determination are attached and highlighted 21. Fill out PFO CC List (a.k.a. the Check-Off Sheet) - don't forget to check for other property owners. a. Does Ken Stahr need to be on the CC list (Rate, Duty and Period of Allowed Use changes) 22. Final PFO report hard copy check (format, margins, etc.) 23. Final PFO has been saved to m:\t\pfo\done\week#\application #

Name: _____

Date: JUNE 19, 1996 (JKS-007)

APRIL 12, 1996

RAY D GILLETT
LINDA R GILLETT
7810 NE EMERSON DR
MADRAS, OREGON 97741

Reference: File G-14152

Dear Applicant:

**THIS IS NOT A PERMIT AND IS
SUBJECT TO CHANGE AT NEXT PHASE OF PROCESS**

This letter is to inform you of the status of your application for water use. Based on the information you have supplied, the Water Resources Department has reached the following conclusions:

Initial Review Determinations:

1. Your application is complete and not defective.
2. The proposed use is not prohibited by law or rule.
3. The use of water for IRRIGATION OF 16.5 ACRES is allowed under OAR 505, the Deschutes Basin Program, [OAR 690-505-003(1)(a)].
4. Based on a ground water review, the Department has determined this well **will not have** the potential for substantial interference with Trout Creek or Deschutes River.
5. The Department has determined that no more than 0.206 CUBIC FOOT PER SECOND (CFS) of water is necessary for IRRIGATION OF 16.5 ACRES. The amount of water requested, 0.245 CFS (110.0 gallons per minute), shall be restricted to 0.206 CFS.
6. At this time the Department is unable to find that there is a preponderance of evidence that the proposed use of ground water will measurably reduce the surface water flows necessary to maintain the free-flowing character of a scenic waterway in quantities necessary for recreation, fish and wildlife.



Commerce Building
158 12th Street NE
Salem, OR 97310-0210
(503) 378-3739
FAX (503) 378-8130

April 12, 1996

7. The use of 0.206 CFS from one well, within the Lower Deschutes Basin, for IRRIGATION OF 16.5 ACRES **is likely available** from March 1 through October 31, during the irrigation season.

Summary of Initial Determinations

The use of 0.206 cubic foot per second of water from one well, within the Lower Deschutes Basin, for Irrigation of 16.5 acres may be allowed from March 1 through October 31, during the irrigation season.

Because of these favorable determinations to your application the Department can now move your application to the next phase of the water rights application review process. This phase is where public interest factors will be evaluated.

Please reference the application number when sending any correspondence regarding the conclusions of this initial review. Comments received within the comment period, will be evaluated at the next phase of the process.

To Proceed With Your Application:

If you choose to proceed with your application, you do not have to notify the Department. Your application will automatically be placed on the Department's Public Notice to allow others the opportunity to comment. After the comment period the Department will complete a public interest review and issue a proposed final order.

Withdrawal Refunds:

If you choose not to proceed, you may withdraw your application and receive a refund (minus a \$50 processing charge per application.) To accomplish this you must notify the Department in writing by **APRIL 26, 1996**. For your convenience you may use the enclosed "STOP PROCESSING" form.

If A Permit Is Issued It Will Likely Include The Following Conditions:

1. You may be required to measure the amount of water used and report that use annually.

April 12, 1996

2. If substantial interference with a senior water right occurs due to withdrawal of water from any well listed on this permit, then use of water from the well(s) shall be discontinued or reduced and/or the schedule of withdrawal shall be regulated until or unless the Department approves or implements an alternative administrative action to mitigate the interference. The Department encourages junior and senior appropriators to jointly develop plans to mitigate interferences.
3. Use of water under authority of this permit may be regulated if analysis of data available after the permit is issued discloses that the appropriation will measurably reduce the surface water flows necessary to maintain the free-flowing character of a scenic waterway in quantities necessary for recreation, fish and wildlife in effect as of the priority date of the right or as those quantities may be subsequently reduced.
4. The priority date for this application is August 14, 1995.

If you have any questions:

Feel free to call me at (503) 378-8455 ext. 267 or 1 (800) 624-3199 if you have any questions. Please have your application number available if you call.

Sincerely,

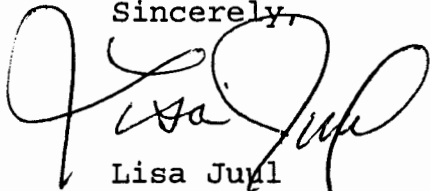

Lisa Juyl
Initial Reviewer
Water Rights Division

cc: Regional Manager, Watermaster, Water Availability
Section
enclosures: Flow Chart of Water Right Process
Stop Processing Form

Oregon Water Resources Department
Water Rights Division

Water Rights Application
Number G-14152

Final Order

Application History

On August 14, 1995, RAY D AND LINDA R GILLETT submitted an application to the Department for a water use permit. The Department issued a Proposed Final Order on June 25, 1996. The protest period closed August 9, 1996, and no protest was filed.

The proposed use would not impair or be detrimental to the public interest.

Order

Application G-14152 therefore is approved as proposed by the Proposed Final Order, and Permit Number G-12715 is issued as limited by the conditions proposed by the Proposed Final Order.

DATED August 28, 1996

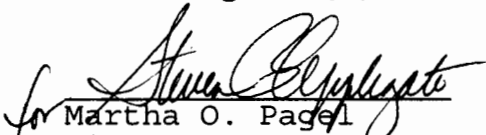
for Martha O. Pagel
Director

Appeal Rights

Under the provisions of ORS 183.484, the applicant may appeal this order by filing a petition for review in the Circuit Court for Marion County or the circuit court for the county in which the applicant resides or has a principal business office. The petition for review must be filed within 60 days after the date this order is served.

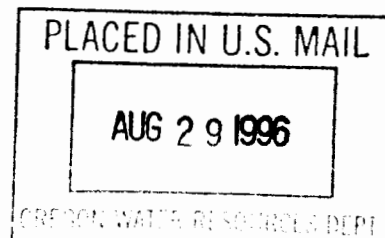

STATE OF OREGON

COUNTY OF JEFFERSON

PERMIT TO APPROPRIATE THE PUBLIC WATERS

THIS PERMIT IS HEREBY ISSUED TO

RAY D AND LINDA R GILLETT
7810 NE EMERSON DR
MADRAS, OREGON 97741

(541) 475-3874

The specific limits for the use are listed below along with conditions of use.

APPLICATION FILE NUMBER: G-14152

SOURCE OF WATER: A WELL IN DESCHUTES RIVER BASIN

PURPOSE OR USE: IRRIGATION OF 16.5 ACRES

MAXIMUM RATE OF ALLOWED USE: 0.206 CUBIC FOOT PER SECOND

PERIOD OF USE: MARCH 1 THROUGH OCTOBER 31

DATE OF PRIORITY: AUGUST 14, 1995

POINT OF DIVERSION LOCATION: NE 1/4 NE 1/4, SECTION 33, T9S, R14E, W.M.;
1100 FEET SOUTH AND 550 FEET WEST FROM THE NE CORNER OF SECTION 33

The amount of water used for irrigation under this right, together with the amount secured under any other right existing for the same lands, is limited to a diversion of ONE-EIGHTIETH of one cubic foot per second (or its equivalent) and 3.0 acre-feet for each acre irrigated during the irrigation season of each year.

THE PLACE OF USE IS LOCATED AS FOLLOWS:

SW 1/4 SE 1/4	2.0 ACRES
SECTION 28	
NE 1/4 NE 1/4	10.5 ACRES
NW 1/4 NE 1/4	2.0 ACRES
SE 1/4 NE 1/4	2.0 ACRES
SECTION 33	
TOWNSHIP 9 SOUTH, RANGE 14 EAST, W.M.	

Measurement, recording and reporting conditions:

- A. Before water use may begin under this permit, the permittee shall install a meter or other suitable measuring device as approved by the Director. The permittee shall maintain the meter or measuring device in good working order.

- B. The permittee shall allow the watermaster access to the meter or measuring device; provided however, where the meter or measuring device is located within a private structure, the watermaster shall request access upon reasonable notice.
- C. The Director may require the permittee to keep and maintain a record of the amount (volume) of water used and may require the permittee to report water use on a periodic schedule as established by the Director. In addition, the Director may require the permittee to report general water use information, the periods of water use and the place and nature of use of water under the permit. The Director may provide an opportunity for the permittee to submit alternative reporting procedures for review and approval.

If substantial interference with a senior water right occurs due to withdrawal of water from any well listed on this permit, then use of water from the well(s) shall be discontinued or reduced and/or the schedule of withdrawal shall be regulated until or unless the Department approves or implements an alternative administrative action to mitigate the interference. The Department encourages junior and senior appropriators to jointly develop plans to mitigate interferences.

Use of water under authority of this permit may be regulated if analysis of data available after the permit is issued discloses that the appropriation will measurably reduce the surface water flows necessary to maintain the free-flowing character of a scenic waterway in quantities necessary for recreation, fish and wildlife in effect as of the priority date of the right or as those quantities may be subsequently reduced.

STANDARD CONDITIONS

The wells shall be constructed in accordance with the General Standards for the Construction and Maintenance of Water Wells in Oregon. The works shall be equipped with a usable access port, and may also include an air line and pressure gauge adequate to determine water level elevation in the well at all times.

The use shall conform to such reasonable rotation system as may be ordered by the proper state officer.

Prior to receiving a certificate of water right, the permit holder shall submit the results of a pump test meeting the department's standards, to the Water Resources Department. The Director may require water level or pump test results every ten years thereafter.

Failure to comply with any of the provisions of this permit may result in action including, but not limited to, restrictions on the use, civil penalties, or cancellation of the permit.

This permit is for the beneficial use of water without waste. The water user is advised that new regulations may require the use of best practical technologies or conservation practices to achieve this end.

By law, the land use associated with this water use must be in compliance with statewide land-use goals and any local acknowledged land-use plan.

The use of water shall be limited when it interferes with any prior surface or ground water rights.

The Director finds that the proposed use(s) of water described by this permit, as conditioned, will not impair or be detrimental to the public interest.

Actual construction of the well shall begin within one year from permit issuance, and shall be completed on or before October 1, 1998. Complete application of the water to the use shall be made on or before October 1, 1999.

Issued August 28, 1996

for Steven C. Pappas
Martha O. Pappas, Director
Water Resources Department

Application G-14152
Basin 05

Water Resources Department
Volume 3, Trout Creek & Misc.
MGMT.CODES 7BG, 7BR, 7JG, 7JR

PERMIT G-12715
District 11

APPLICATION MAP

FOR APPROPRIATION OF WATER FROM WELL #1.
SEC. 28 AND 33, T. 9 S., R. 14 E., W.M.,
JEFFERSON COUNTY, OREGON.



SCALE 1" = 1320'

RECEIVED

AUG 14 1993

Application No. **G14152** DEPT.
SALEM, OREGON

Permit No. **12715**

NO REPRESENTATION IS
INTENDED TO PROVIDE
DIMENSIONS OR LOCATION
OF PROPERTY OWNERSHIP
LINES.

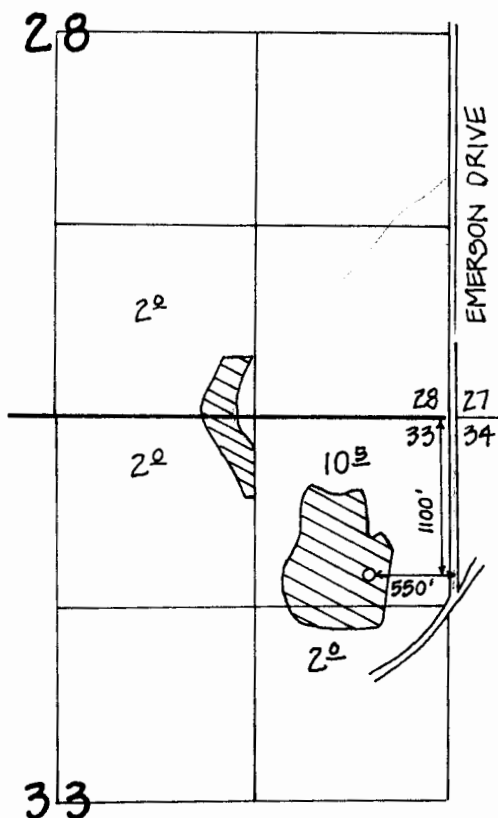
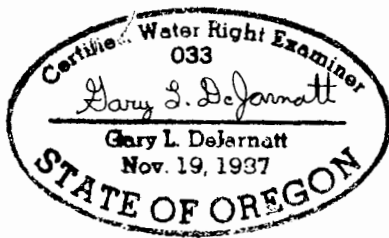

LEGEND:

○ WELL #1

TOTAL = 2⁰ + 2⁰ + 10⁰ + 2⁰ = 16⁰ AC

Application No. **G14152**
Permit No.

DEJARNATT LAND SURVEYS, INC.

63885 N. HWY. 97
BEND, OREGON 97701
(503) 382-4192

JOB # 93026
SHEET 1 OF 1

MAY 28, 1993

August 18, 1995

RAY D GILLETT
GILLETT, LINDA R
7810 NE EMERSON DR
MADRAS, OR 97741

REFERENCE: File(s) G-14152

We have received your application(s) for a water use permit along with your supporting data, documentation, and fees. A receipt is enclosed here unless you were previously issued one. Your application has been assigned the above referenced file number. Please refer to this number whenever you contact us about your application.

Even though your application has been received, filed and assigned an application reference number, no authorization has been granted to develop your water use. The filing of an application does not create a water right. Water may not be used until a water right permit has been issued by the Department.

After an application has been accepted for filing, public notification of the application is made, followed by the mandatory 30-day comment period. Thereafter, applications can be considered for processing as time allows.

At present the Water Resources Department has a backlog of several thousand applications for water use permits which has delayed our application processing time. In general, applications are processed in the order in which they are received. However, Department staff work through Oregon's 18 river basins on a rotation basis often completing work on all applications within a single basin, then proceeding to the next basin.

The processing of an application does not guarantee that a water right permit will be issued. Each application must undergo specialized analysis called a technical review and a public interest review. Until your application is reviewed, it is not possible to determine whether your particular proposed water use will be recommended for a permit.

The Water Resources Commission is considering the adoption of rules to protect stream flows for fish species. This action is being contemplated in response to current and future Endangered Species Act fish listings, including many runs of salmon, steelhead and resident fish throughout the state.



REFERENCE: File(s) - G-14152

The proposed rules, if adopted, could limit the issuance of new water right permits in certain areas of the state. If and when the Commission adopts these rules, new criteria or restrictions may be imposed on water use applications received after:

July 17, 1992, for use of water in the Upper Columbia/Snake Basin (above Bonneville Dam), including the mainstem Columbia and Snake Rivers and the Hood, Deschutes, John Day, Umatilla, Grande Ronde, Powder, Malheur and Owyhee Basins;

April 8, 1994, for use of water in the North Coast, Mid Coast, South Coast, Rogue and Umpqua Basins and the Clackamas Subbasin of the Willamette Basin; and

June 3, 1994, for use of water in all Oregon basins.

When the report on the technical review is completed and sent to you, a 60-day objection period begins during which you, the applicant, or anyone who has expressed an interest in your proposed water use may communicate to us their disagreement with what we have said in our report on your application. After the 60-day objection period, the Department conducts the public interest review and considers any objections which have been made.

After any objections have been considered, there may follow time to allow parties to resolve conflicts over the proposed water use. In addition, a 30-day protest period may be required. Lastly, it may be necessary to schedule a hearing or send the application to the Water Resources Commission for their review.

If your application is recommended for approval and a permit is issued, the use allowed by the permit will be subject to the Basin Program Rules of the Water Resources Commission, instream flow requirements, the demands of prior right holders and other conditions to conform the water use to particular standards.

Please contact a Water Rights Research Assistant of the Water Resources Department if you have any questions. You may write to us at 158 12th ST NE, Salem, Oregon 97310 or you may call 378-3739 in Salem or toll free from within the state 1-800-624-3199.

Sincerely,



Ms. Anita Mc Loud
Water Rights Specialist
Water Rights/Adjudication Division

cc: CWRE

INDEXED

G-14152

310174

MICROFILM

BARGAIN AND SALE DEED

VERA F. GREGSON, Grantor conveys to RAY D. GILLETT and LINDA GILLETT, husband and wife, Grantees, the following described property:

EXHIBIT "A"

The true and actual consideration for this conveyance is gift.

Until a change is requested, send tax statements to the following address: Ray and Linda Gillett, 7810 N.E. Emerson Dr.

"THIS INSTRUMENT WILL NOT ALLOW USE OF THE PROPERTY DESCRIBED IN THIS INSTRUMENT IN VIOLATION OF APPLICABLE LAND USE LAWS AND REGULATIONS. BEFORE SIGNING OR ACCEPTING THIS INSTRUMENT THE PERSON ACQUIRING FEE TITLE TO THE PROPERTY SHOULD CHECK WITH THE APPROPRIATE CITY OR COUNTY PLANNING DEPARTMENT TO VERIFY APPROVED USES."

DATED this 12th day of September, 1990.

Vera F. Gregson
VERA F. GREGSON

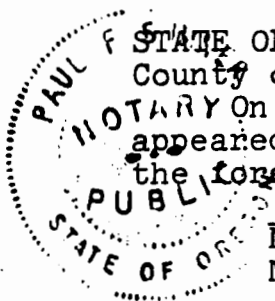

STATE OF OREGON)
County of Jefferson)ss
On this 12th day of September, 1990, personally appeared the above named VERA F. GREGSON, and acknowledged the foregoing instrument to be her voluntary act and deed.

Paul F. Sumner
Notary Public for Oregon
My Commission Expires: 8-23-93

After recording return to

Ray & Linda Gillett
7810 N.E. Emerson Dr
Madras, Or

REC
AUG 24 1995
WATER RES
SALEM, OREGON

EXHIBIT "A"

Parcel 1:

All of the Southeast quarter of the Southeast quarter, Section 28; and the Northeast quarter of the Northeast quarter, Section 33, all in Township 9 South, Range 14 East of the Willamette Meridian, LESS AND EXCEPTING that portion of the Southeast quarter of the Southeast quarter, Section 28, Township 9 South, Range 14 East of the Willamette Meridian, described as follows: Beginning at the Northwest corner of said Southeast quarter of the Southeast quarter and running thence North 89°21'50" East 277.43 feet; thence South 10°52' West 483.18 feet; thence South 33°51' West 332.20 feet to the West line of said Southeast quarter of the Southeast quarter; thence North along said West line 750.64 feet to the point of beginning.

Parcel 2:

That portion of the Southeast quarter of the Northeast quarter, Section 33, Township 9 South, Range 14 East of the Willamette Meridian, Jefferson County, Oregon, being more particularly described as follows: Beginning at the Northwest corner of the Southeast quarter of the Northeast quarter, Section 33, Township 9 South, Range 14 East of the Willamette Meridian, which point is South 0°34'40" East a distance of 1318.97 feet and South 89°47'10" West a distance of 1330.13 feet from the Northeast corner of said Section 33; thence South 0°13'20" East a distance of 1025.95 feet more or less to the Northwesterly right of way line of The Dalles-California State Highway, old route; thence Northeasterly along said right of way line to a point on the North line of the Southeast quarter of the Northeast quarter of said Section 33; thence South 89°47'10" West a distance of 1200 feet more or less to the point of beginning.

A parcel of land in the Southwest quarter of the Northeast quarter, Section 33, Township 9 South, Range 14 East of the Willamette Meridian, Jefferson County, Oregon, being more particularly described as follows: Beginning at the Northeast corner of the Southwest quarter of the Northeast quarter, Section 33, Township 9 South, Range 14, East of the Willamette Meridian, which point is South 0°34'40" East 1318.97 feet and South 89°47'10" West 1330.13 feet from the Northeast corner of said Section 33; thence South 0°13'20" East along the East line of the Southwest quarter of the Northeast quarter of said Section 33, a distance of 410.61 feet; thence North 16°00' West a distance of 426.70 feet to a point on the North line of the Southwest quarter of the Northeast quarter of said Section 33; thence North 89°47'10" East a distance of 116.00 feet to the point of beginning.

A parcel of land in the Northwest quarter of the Northeast quarter, Section 33, Township 9 South, Range 14 East of the Willamette Meridian, Jefferson County, Oregon, being more particularly described as follows: Beginning at the Southeast corner of the Northwest quarter of the Northeast quarter; thence North along the East line of said Northwest quarter of the Northeast quarter 1304.64 feet to the Northeast corner thereof; thence South 89°10' West 280.76 feet; thence South 29°23'10" East 314.73 feet; thence South 14°08' East 199.51 feet; thence South 10°46'10" West 581.40 feet; thence South 16°01'20" East 272.69 feet; thence South 16° East 426.7 feet to the East line of the West half of the Northeast quarter; thence North along said East line 410.61 feet to the point of beginning.

A parcel of land in the Southwest quarter of the Southeast quarter, Section 28, Township 9 South, Range 14, East of the Willamette Meridian, Jefferson County, Oregon, and being more particularly described as follows: Beginning at the Southeast corner of the Southwest quarter of the Southeast quarter and running thence South 89°10' West 280.76 feet; thence North 29°23'10" West 70 feet; thence North 4°32' West 125.68 feet; thence North 34°20'4" East 157.62 feet; thence North 51°34'20" East 164.47 feet; thence North 33°51' East 192.74 feet to the East line of the Southwest quarter of the Southeast quarter; thence South along the said East line 573.90 feet to the point of beginning.

VED

24 1995

SOURCES DEPT.
LEM, OREGON

Description of Water Use

Note to Applicant: This sheet will provide local planning staff with a basic description of your proposed water use. Please fill out this sheet before bringing the attached land use form to your local planning office. It will help local planning offices complete your land use information form quickly.

Note to Local Planning Officials: Please initial this sheet. Do not separate it from the land use information form. If needed, please make a separate copy for your records.

Applicant Name: Ray D. + Linda R. Gillett
 Address: 7810 N.E. EMERSON DR
MADRAS, OR 97741
 Phone: (503) 475-2674

RECEIVED

AUG 14 1995

WATER RESOURCES DEPT.
SALEM, OREGON

Please indicate what you will use the water for. Check all boxes that apply and fill in the blanks with key characteristics of the project

- Irrigation (crop type, golf course, nursery or greenhouse): pasture irrigation of 16⁵ ac
- Livestock (type of livestock, feedlot, slaughterhouse): cow/calf
- Residential (# units, single or multi-family, # lots if partition or subdivision): _____
- Commercial (i.e., retail, office, restaurant, gas station, hotel, service, etc.): _____
- Industrial (i.e., factory, pulp mill, research and development, processing, etc.): _____
- Institutional (i.e., school, library, etc.): _____
- Mining (aggregate, metal, open pit, placer, etc.): _____
- Recreation (park, campsite, pond, etc.): _____
- Fish and Wildlife (pond, hatchery, etc.): _____
- Hydropower (dam, reservoir, power generating or transmitting facilities): _____
- Other (Name and list key characteristics): _____

Indicate sources for the proposed water use below:	Indicate the estimated quantity of water the use will require.
<input type="checkbox"/> Surface Water Name sources: _____ _____ _____	_____ Cubic feet per second. <u>110</u> Gallons per minute. _____ Acre-Feet
<input type="checkbox"/> Reservoir or pond	
<input checked="" type="checkbox"/> Ground Water	



G-14152
RECEIVED
AUG 14 1995

Oregon Water Resources Department
PUMP TEST COVER SHEET

**Well Owner:**

Name RAY D. & LINDA R. Gillett
 Address 7816 N. E. EMERSON DR.
 City, State, Zip MADRAS, OR 97741
 County JEFFERSON

Well Location:

OREGON
 Twnshp 9 S (N or S), Range 14 E (E or W)
 Section 33 1/4, 1/4, 1/4 NE. 1/4 NE.
 Well Depth 176 FT. Date Drilled 5-17-78
 Owner's Well No. (if any) _____
 POD-ID _____

Water Right Information:

Application No. _____ Permit No. _____ Certificate No. _____
 Is this well used for more than one water right? N (Y/N) If Yes, fill out numbers below:
 App. No. _____ Permit No. _____ Cert. No. _____
 App. No. _____ Permit No. _____ Cert. No. _____

Pump Test:

Test conducted by Ray D. Gillett Well Owner? Y (Y/N)
 Company _____
 Address 7816 N. E. EMERSON DR. Date of Test 5/20/94
 City, State, Zip MADRAS, OR 97741

Method of Discharge Measurement Volume/Time 55 gal drum
 Method of Water Level Measurement Electric water level measuring tape
 Depth of Air Line (if used) _____
 Pump Type (Turbine, Submersible, etc.) Submersible
 Was pump test conducted during normal use of the well Y (Y/N)

Description of point from which water level was measured from top of well seal
 Is measuring point above or below ground level? above ground level
 Distance between measuring point and ground level (correction factor) 1 ft

Are you aware of any wells, other than domestic or stock wells, pumping within 1000 feet of the tested well during the test or within 24 hours prior to the test? N (Y/N) If yes, give approximate distances to each and approximate pumping rate of each. If, possible, indicate if they were turned on or off during the test _____

Is there a lake, stream or other surface water body within 1/4 mile of the tested well? N (Y/N)
 If yes, give approximate distance from the well and approximate elevation difference between the surface water and the well head: Approximate distance _____
 Approximate elevation difference _____
 Is well elevation above or below the surface water body? _____

Static Water Level Measurements: (Three measurements at least 20 minutes apart are required in the hour before pumping begins):

Time: <u>7:20</u>	Depth to Water: <u>73.6</u>	(ft/in)
Time: <u>7:40</u>	Depth to Water: <u>73.6</u>	(ft/in)
Time: <u>8:00</u>	Depth to Water: <u>73.6</u>	(ft/in)

Discharge Measurements: (A discharge measurement is required at the start of pumping and once an hour during the test):

Time: <u>8:12</u>	Discharge Rate: <u>132</u>	(gpm)
Time: <u>9:05</u>	Discharge Rate: <u>132</u>	(gpm)
Time: <u>10:05</u>	Discharge Rate: <u>132</u>	(gpm)
Time: <u>11:05</u>	Discharge Rate: <u>132</u>	(gpm)
Time: <u>11:55</u>	Discharge Rate: <u>132</u>	(gpm)

Pump turned on: Date: 5/20/94 Time: 8:00 Pump turned off: Date: 5/20/94 Time: 12 Noon
 Total pumping time: 4 hours, - minutes.

Note: Well must be idle for at least 16 hours prior to the test.

PUMP TEST DATA SHEET

AUG 14 1995

APPLICATION NO. _____

PERMIT NO. _____

WATER RESOURCES DEPT.
S.E. P.O. DIVISION

All water level measurements must either be in 1) feet and inches, or 2) feet and decimal fractions. (Circle one)

DRAWDOWN DATA

RECOVERY DATA

DATE	TIME	TIME SINCE PUMP STARTED (minutes)	DEPTH TO WATER FROM MEASURING PT	CORRECTION FACTOR	DEPTH TO WATER FROM GROUND LEVEL	COMMENTS	DATE	TIME	TIME SINCE PUMP STOPPED (minutes)	DEPTH TO WATER FROM MEASURING PT	CORRECTION FACTOR	DEPTH TO WATER FROM GROUND LEVEL	COMMENTS
5/20/94	8:02	2	94.9	1.0	93.9		5/20/94	12:02	2	85.8	1.0	84.8	
	8:04	4	92.9		91.9			12:04	4	84.0		83.0	
	8:06	6	92.0		91.0			12:06	6	82.2		81.2	
	8:08	8	92.0		91.0			12:08	8	81.0		80.0	
	8:10	10	92.0		91.0			12:10	10	80.3		79.3	
	8:15	15	91.1		90.1			12:15	15	78.7		77.7	
	8:20	20	91.0		90.0			12:20	20	78.0		77.0	
	8:25	25	91.0					12:25	25	77.4		76.4	
	8:30	30	91.0					12:30	30	76.9		75.9	
	8:45	45	91.0					12:45	45	75.8		74.8	
	9:00	1:00	91.0					1:00	60	75.5		74.5	
	9:15	1:15	91.0				✓	1:15	75	75.2		74.2	
	9:30	1:30	91.0										
	9:45	1:45	91.0										
	10:00	2:00	91.0										
	10:15	2:15	91.0										
	10:30	2:30	91.0										
	10:45	2:45	91.0										
	11:00	3:00	91.0										
	11:15	3:15	91.0										
	11:30	3:30	91.0										
	11:45	3:45	91.0										
✓	12:00	4:00	91.0										

RECEIVED

MAY - 5 1997

WATER RESOURCES DEPT.
SALEM, OREGON

Witness my hand this 28th day of April, 1997.

Applicant/permit holder Ray D. Gillett
Ray D. Gillett

Applicant/permit holder Linda R. Gillett
Linda R. Gillett

The completed assignment must be submitted to the Water Resources Department, together with a recording fee of \$10. Additional pages will cost \$5 per page.

WATER RESOURCES DEPARTMENT
158 12th Street NE
SALEM, OREGON 97330-0210

RECEIVED
AUG 14 1995
WATER RESOURCES DEPT.
SALEM, OREGON

WATER
RESOURCES
DEPARTMENT

August 4, 1995

Ray and Linda Gillett
7810 NE Emerson Dr.
Madras, OR 97741

We received an application to use water. We need additional information so we can accept, review and decide if an application may be approved.

Please provide the following:

- The following statement must be signed, dated and included in the application: "I/We certify that the information I have provided in this application is an accurate representation of the proposed water use and is true and correct to the best of my knowledge."

Ray H. Gillett Linda R. Gillett
Signature

The application, supporting data and check no. 1187 in the amount of \$314.00 are being returned. We will complete our analysis when the application and information noted above is received.

Please contact the Application/Permits Section at (503) 378-8455 if you have any questions.

Sincerely,

Anita McLoud
Anita McLoud
Water Rights Specialist

cc: FISCAL
GEN COR



Commerce Building
158 12th Street NE
Salem, OR 97310-0210
(503) 378-3739
FAX (503) 378-8130

PRE-TR APPLICATION PROCESSING OUTLINE

Application File # G14152

MINIMUM REQUIREMENTS TO FILE

OAR 690-11-020

DATE STAMP

<u>DATE</u>	<u>INITIAL</u>	
8/15/95	<i>[Signature]</i>	Name and mailing address of applicant
		Source of water
		Quantity of water
		Map showing location of POD & POU
		Use of water
		Names and addresses of legal owners
		Signature of applicant
		Oath
		Application date stamped per money receipt date
		Land use approved <u>Y</u> pending _____
		If reservoir < 5 AF \$ _____, if > 5 AF \$ _____

HB 2153/HB 2107 APPLICATION -- SEE REVERSE

Route to Data Center (Unless 2153/2107)

DATA CENTER

Stream Code _____
Entered into WRIS _____

SUPPORT SERVICES

9/17/95	<input checked="" type="checkbox"/>	Stamp contents with application number
8/23/95	<input checked="" type="checkbox"/>	Mail ack letter (provided by Data Center) with receipt to applicant, cc to CWRE and file
		Place label on file and calender card

APPLICATION SECTION

Stream Indexed Basin # _____
Plat Carded and copy made YES NO
If dam is over 10 feet or storage exceeds 9.2 AC-FT, route file to Dam Safety Section

TR CASEWORKER

TR Checklist complete	<u>YES</u>	<u>NO</u>
Within Irrigation District	_____	_____
District Notified	_____	_____
District excerpt received	_____	_____

TR Mailed DATE _____

Public Interest Checklist complete _____

Management Codes _____

REMARKS: _____

MINIMUM APPLICATION REQUIREMENTS TO FILE:

HB 2153 - existing, small, EXEMPT ponds

(date & initials) NOTICE OF EXEMPT RESERVOIR form (or letter if prior to April 8, 1994).

Appropriate map (see item 1 on form).

Evidence that reservoir existed before January 1, 1993 (one or more of the following: dated aerial photo, NOTARIZED affidavit, dated map from agency, construction receipts or other documentation).

Items 2, 3, 4, 5, and 6 are completed.

Signature (and title, if applicable)

HB 2153 - non-exempt existing ponds (large, on-channel)

Complete Minimum Requirements to File on reverse, except before routing to Data Center, change priority date to 1/1/1993. Also, confirm the following:

Receipt of evidence that reservoir existed before January 1, 1993 (one or more of the following: dated aerial photo, NOTARIZED affidavit, dated map from agency, construction receipts or other documentation)

HB 2107 - wetland, stream restoration and storm water management

Complete Minimum Requirements to File on reverse EXCEPT DO NOT ROUTE TO DATA CENTER, BUT DO ROUTE TO CAROL. Also confirm the following:

Name/address of adjacent property owner within 1/4 mile

Map with scale not less than 2 in.=1 mi.

CWRE map if > 10 feet dam or > 9.2 AF

Description of proposed use

Condition addressed

Resulting benefits

Public notices (circle) #1 #2

RECEIVED

Application No. G14152

AUG 14 1995

State of Oregon DEPT.
WATER RESOURCES DEPARTMENT OREGON

Application for a Permit to Appropriate Ground Water

Applicant(s) RAY D. + LINDA R. GILLET
(Please print or type - use dark ink)

Mailing Address: 7810 N. E. EMERSON DRIVE

MADRAS OR 97741 (503) 475-3874 (Linda)
City State Zip Daytime Phone No.

I (We) make application for a permit to appropriate the following described ground waters of the State of Oregon:

1. **THE DEVELOPMENT** (number of wells, tile lines, infiltration galleries, etc.): _____
ONE WELL

If development is less than one mile from a natural stream, give the following:

Distance from development to stream: NA

Elevation difference between streambed and development: _____

NOTE: Wells must be constructed according to standards set by the department for the construction and maintenance of water wells. If the well is already constructed, please enclose a copy of the well driller's log with this application, and skip to Section 2 below.

Diameter of well: 8" Depth in feet: 176'

Type and size of well casing: 8" steel .250 wall No. of feet: 20'

Estimated depth to water: 100' in 1978, 73'6" 1994

Type of access port or measuring device: 1" port with threaded plug

Wells to be drilled by: William D Williams

Address: Redmond, OR

If the water well is flowing artesian, describe your water control and conservation works: NA

2. **TOTAL AMOUNT OF WATER** to be applied to beneficial use: _____ cubic feet per second, OR 110 gallons per minute. If water is to be used from more than one ground water source, give the quantity of water from each: _____

3. INTENDED USE(S) OF WATER: IRRIGATION

If for more than one use, give the quantity of water from each source for each use; _____

If for DOMESTIC use, state the number of households to be supplied; _____

If for MUNICIPAL OR QUASI-MUNICIPAL use, state the present population to be served, and an estimate of the future requirements; (List population projections, water needs, anticipated areas to be provided water.)

If for MINING use, state the nature (gold, silver, etc.) of the mines to be served; _____

If for IRRIGATION, or other land area use, state the TOTAL number of acres to be developed under each use;

Irrigation	<u>16.5</u>
Other (describe)	_____

4. DESCRIPTION OF WATER DELIVERY SYSTEM: Include dimensions and type of construction of diversion works, length and dimensions of supply ditches or pipelines, size and type of pump and motor. If for irrigation, describe the type of system (i.e., flood, wheel line, hand line, drip, other).

7 1/2 HP Submersible Pump
1860 ft. 4 inch main line
81 lengths 3 inch handline with 22 lengths in operation at a time

5. PROJECT SCHEDULE: (List month and year)

Proposed date construction work will begin Completed
Proposed date construction work will be completed Completed
Proposed date water use will be completed Completed

NOTE: A map prepared by a Certified Water Right Examiner (CWRE) and a complete legal description of the subject property are required under ORS 537.140 and OAR 690 as a part of your application. The legal description may be copied from your deed, title insurance policy, or land sales contract.

6. a) In the event any deficiencies are noted involving the application map enclosed herein, please return the map with instructions for correction to (check one):

Applicant CWRE _____ Other (Identify in REMARKS section)

b) In the event any deficiencies are noted involving the application, please return the application with instructions for correction to (check one):

Applicant CWRE _____ Other (Identify in REMARKS section)

Preferred ↑

7. Are all lands involved (including the proposed diversion site, place of use, and access for conveying the water) under your ownership? yes. If not, list in the REMARKS section below, or on an attached sheet, the names and mailing addresses of the legal owners of all property involved in the proposed development.

NOTE: Prior to receiving a certificate of water right, the permit holder must submit to the Water Resources Department the results of a pump test meeting the department's standards. The Director will require water level or pump test results every ten years thereafter.

REMARKS: ^① I WAS in partnership with my father in law and he took care of the business end of the partnership. After his death we were going through the business papers he had & found that ~~he~~ he had started an application but had never completed it. I am now trying to get things in order.

NOTE: The permit, when issued, is for the beneficial use of water without waste. By law, the land use associated with this water use must be in compliance with statewide land-use goals and any local acknowledged land-use plan. It is possible the land use you propose may not be allowed if it is not in keeping with the goals and acknowledged plan. Your city or county planning agency can advise you about the land-use plan in your area.

Jay R. Gillett
Signature of Applicant

1/23/95
Date

Lucinda R. Gillett
Signature of Co-Applicant, if any

1/23/95
Date

FOR WATER RESOURCES DEPARTMENT USE ONLY

Dear Applicant:

I certify that I have examined the foregoing application, together with the accompanying information, and am returning it to you for:

In order to retain its tentative priority, this application must be returned with the requested corrections or additions on or before:

_____, 19____.

WITNESS my hand this _____ day of _____, 19____.

Water Resources Director

By: _____

This instrument was first received in the office of the Water Resources Director at Salem, Oregon, on the 14th day of August, 1995, at 8 o'clock, A M.

APPLICATION NO: 614152

Theo-24[®]
(theophylline anhydrous)
Extended-release capsules 100, 200, & 300 mg

8/21/95

*This map is the correct
sections but it needs to
be page 14E. We have
sent the Tax lots on the
enclosed Application Map. If
this doesn't meet your request
please let us know.*

RECEIVED
AUG 24 1995

*Thank you,
Suzie Hillitt*

WATERBURY PHARMACEUTICALS, INC.
SALEM, OREGON



**STATE OF OREGON
WATER RESOURCES DEPARTMENT**

RECEIPT # **127390**

158 12TH ST. N.E.
SALEM, OR 97310-0210
378-8455 / 378-8130 (FAX)

INVOICE # _____

RECEIVED FROM: Ray D Gillett
BY: _____

APPLICATION 614152
PERMIT _____
TRANSFER _____

CASH: CHECK: # A 96-618 OTHER: (IDENTIFY) _____

TOTAL REC'D \$ 314.02

01-00-0 WRD MISC CASH ACCT

842.010	ADJUDICATIONS	\$
831.087	PUBLICATIONS / MAPS	\$
830.650	PARKING FEES Name / month	\$
_____	OTHER: (IDENTIFY)	\$

REDUCTION OF EXPENSE

_____	CASH ACCT.	\$
_____	VOUCHER #	_____

03-00-0 WRD OPERATING ACCT

MISCELLANEOUS

840.001	COPY FEES	\$
850.200	RESEARCH FEES	\$
880.109	MISC REVENUE: (IDENTIFY)	\$
520.000	OTHER (P-6) (IDENTIFY)	\$

WATER RIGHTS:	EXAM FEE		RECORD FEE
842.001 SURFACE WATER	\$	842.002	\$
842.003 GROUND WATER	\$ <u>200.00</u>	842.004	\$ <u>114.02</u>
842.005 TRANSFER	\$	842.006	\$
WELL CONSTRUCTION	EXAM FEE		LICENSE FEE
842.022 WELL DRILL CONSTRUCTOR	\$	842.023	\$
LANDOWNER'S PERMIT		842.024	\$
_____ OTHER (IDENTIFY)			

06-00-0 WELL CONST. START FEE

842.013 WELL CONST START FEE	\$	CARD #	_____
MONITORING WELLS	\$	CARD #	_____
_____ OTHER (IDENTIFY)			

45-00-0 LOTTERY PROCEEDS

864.000 LOTTERY PROCEEDS	\$
--------------------------	----

07-00-0 HYDRO ACTIVITY

	LIC NUMBER	
842.011 POWER LICENSE FEE (FW/WRD)		\$
842.115 HYDRO LICENSE FEE (FW/WRD)		\$
_____ HYDRO APPLICATION		\$

RECEIPT # **127390**

DATED: 8-14-95

BY: [Signature]

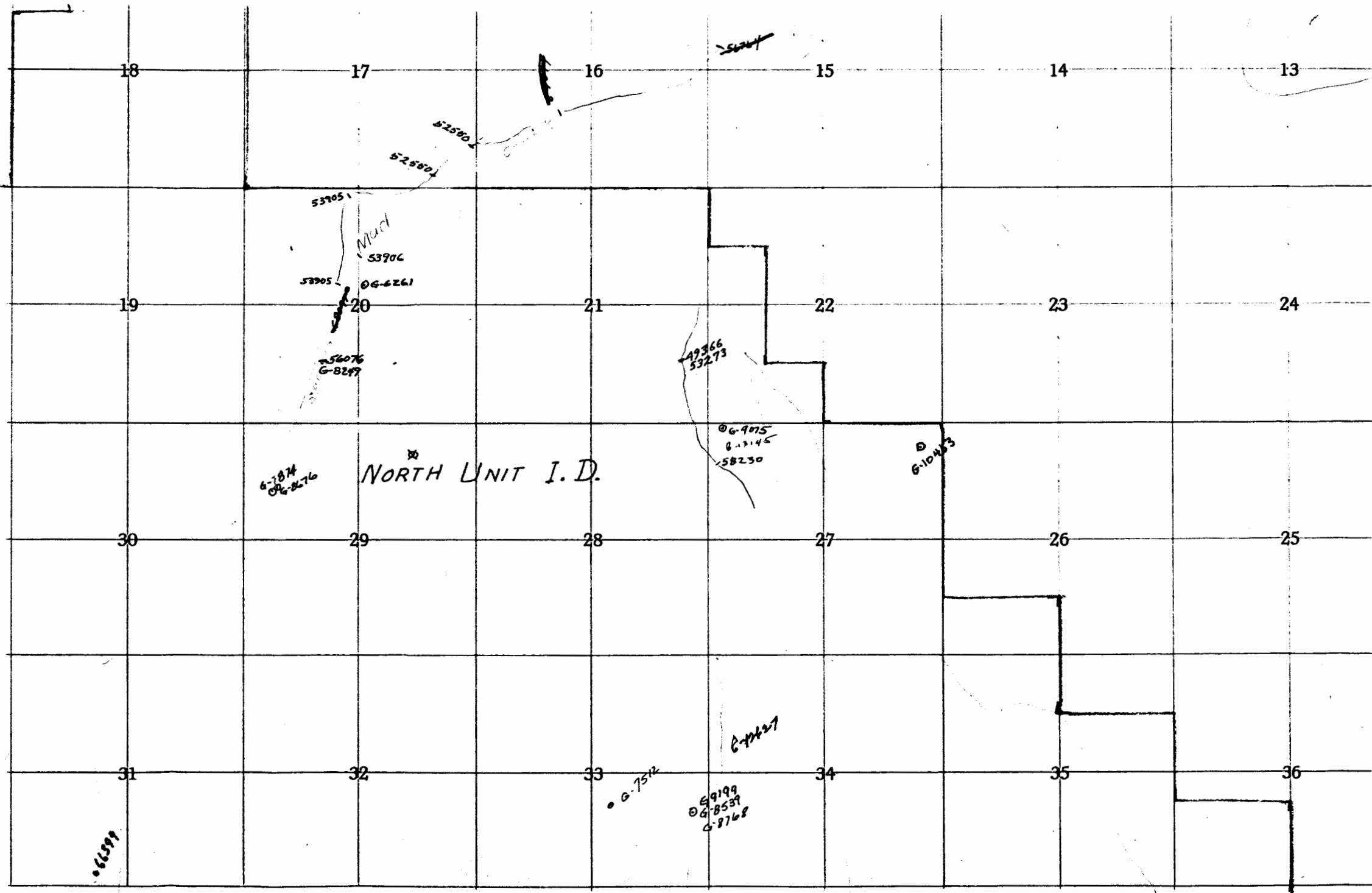

18 17 16 15 14 13

19 20 21 22 23 24

30 29 28 27 26 25

31 32 33 34 35 36

NORTH UNIT I.D.

55705
Mud
53906
53905
OG-6261
56076
G-8299

49366
53273

G-4975
G-7145
58230

G-10413

G-7874
OG-8276

G-7427

G-7512

G-9199
G-8537
G-8768

G-62599

NOTIFY: Irrigation District involved (See letter of March 1, 1957)
Acting Regional Director, U.S. Bureau of Reclamation, Regional Office, Region 1, Boise, Idaho
(Letter to District with copies to others setting out what & where - giving 30 days to protest)

Summary of Water Right Filings in Township 10S, Range 14E

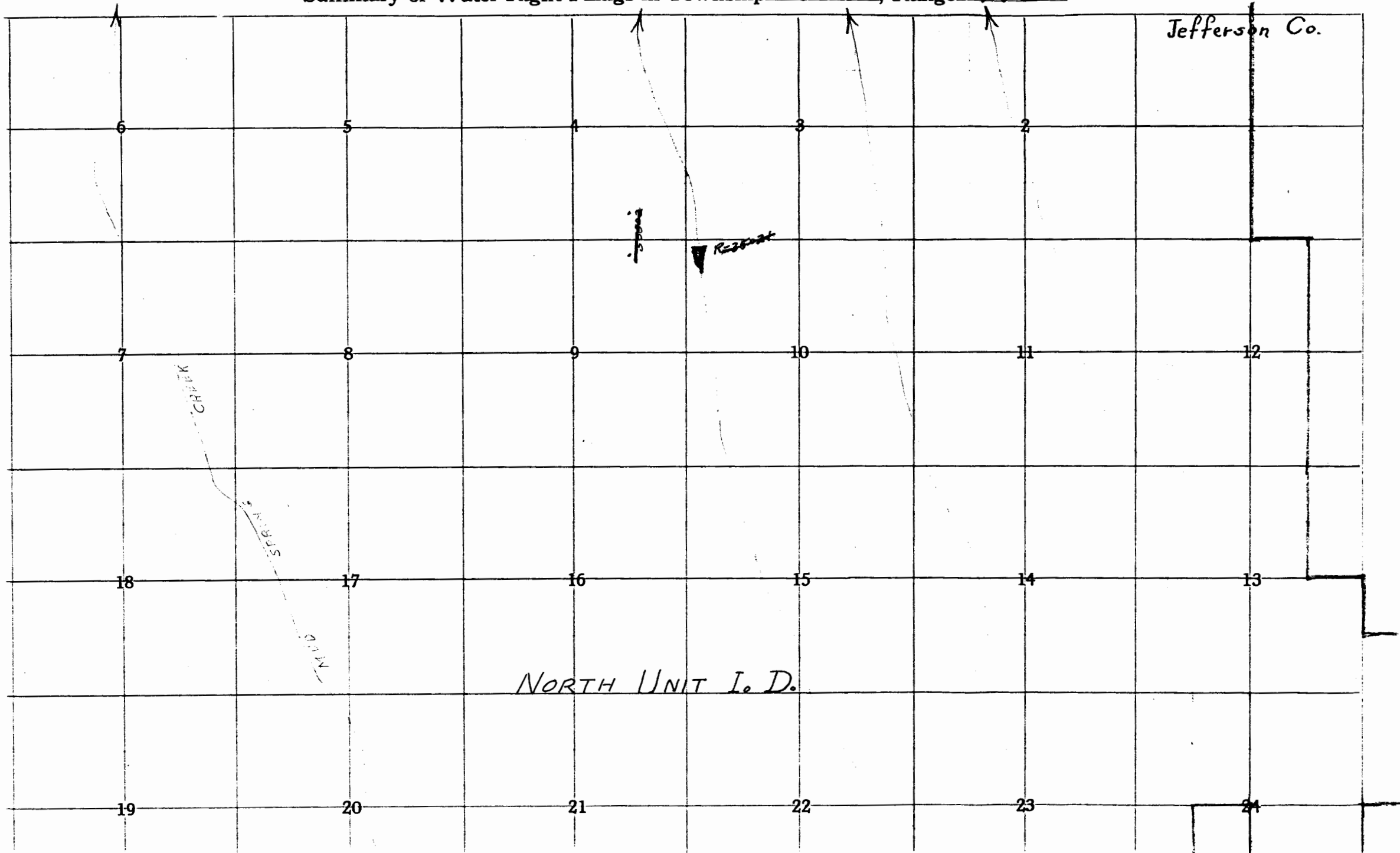

Land Use Information Form: Permits, Licenses, Water Uses in Addition to Classified Uses

RECEIVED

AUG 14 1995

WATER RESOURCES DEPT.
SALEM, OREGON

This information is needed to determine compatibility with local comprehensive plans as required by ORS 197.180. The Water Resources Department will use this and other information to evaluate the request for water use. DO NOT FILL OUT THIS FORM IF water is to be diverted, conveyed, and/or used only on federal lands.

Applicant's Name: Ray D. + Linda R. Gillett
 Address: 7810 W. E. Emerson Dr.
 City: Madras State: OR Zip: 97741
 Phone: (503) 475-2674 WRD Application No.: _____

Please provide information as requested below for all tax lots on or through which water will be diverted or used. (Attach extra sheets as necessary.) Applicants for municipal use may substitute existing and proposed service area boundaries for the tax lot information requested below.

Tax Lot or Local I.D.#	Plan Designation/Zoning (e.g. Rural Residential/RR-5)	Check All That Apply		
		Water Diverted	Water Conveyed	Water Used
100		✓		✓
600				✓

The following section must be completed by all local planning departments responsible for the property(ies) listed above. Please ask the Department for extra forms, as needed.

For Local Government Use Only **Application No. 614152**

Local government planning officials are to complete the remainder of this form and return it to the applicant or the Water Resources Department (3850 Portland Rd. NE, Salem, OR, 97310) within 60 days of the date of receipt as shown below. If the form is not completed within 60 days, the Department may take action to approve the water use.

a) Check the appropriate box below and provide requested information.

Land uses to be served by proposed water uses (including proposed construction) are allowed outright or are not regulated by your comprehensive plan. Cite applicable ordinance section(s): JCZO, Art. 3, Sec. 301(A)(1). Go to section b) on reverse side.

Land uses to be served by proposed water uses (including proposed construction) involve discretionary land use approvals as listed in the table below. **Note: Please attach documentation of applicable local land use approvals which have already been obtained. (Record of Action plus any accompanying findings is sufficient.)**

Type of Land Use Approvals Needed (e.g.: plan amendments, rezones, conditional use permits, etc.)	Cite Most Significant, Applicable Plan Policies & Ordinance Section References	Please check the box that applies:		
		Already Obtained	Already Denied	Being Pursued Satisfactorily

(over)

WRD Applicant Name: _____

Receipt for Request for Land Use Information

This section should be completed by a local government official and returned to the applicant upon request by the applicant for land use information.

City or County: Jefferson County
 Staff Contact: Chuck McLaw Phone: 475-4462
 Signature: Chuck McLaw Date of Information Request: 6-13-95

(For Local Use Continued)

b) Please provide printed name and written signature.

Name: Chuck McEraw

Title: Planning Director

Signature: Chuck McEraw

Date: 6-13-95

Phone: 475-4462

Local governments are invited to express special land use concerns or make recommendations to the Department regarding this proposed use of water below, or on a separate sheet.

Continuations or Additional Comments:

Lined area for providing continuations or additional comments.

Oregon Water Resources Department
3850 Portland Rd. NE
Salem, OR 97310
378 - 3671

Section 28 T.9S. R.13E. W. M.
JEFFERSON COUNTY
1" = 400'

9 13 28

SEE MAP 9 13 21

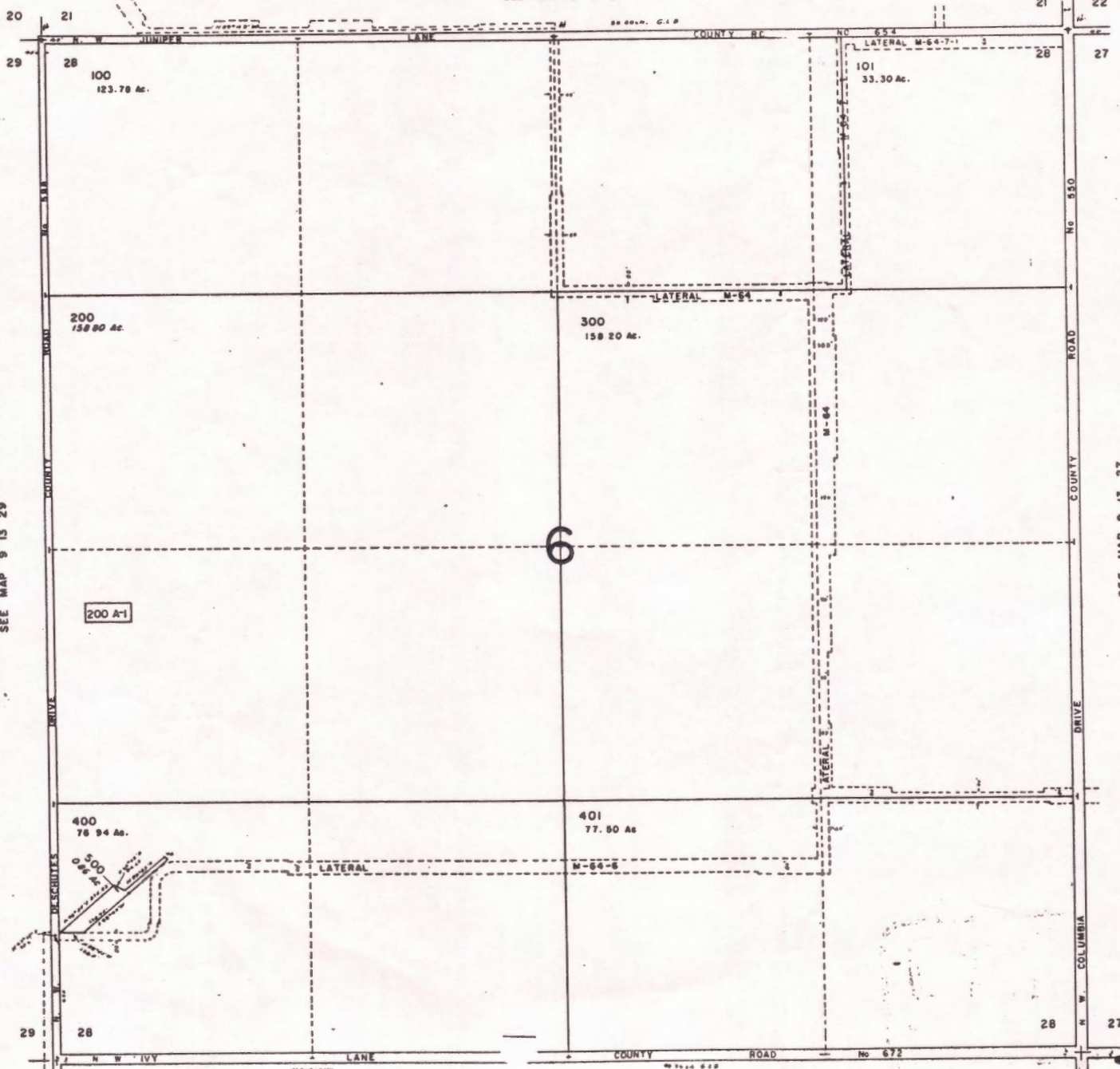

SEE MAP 9 13 29

SEE MAP 9 13 27

SEE MAP 9 13 33

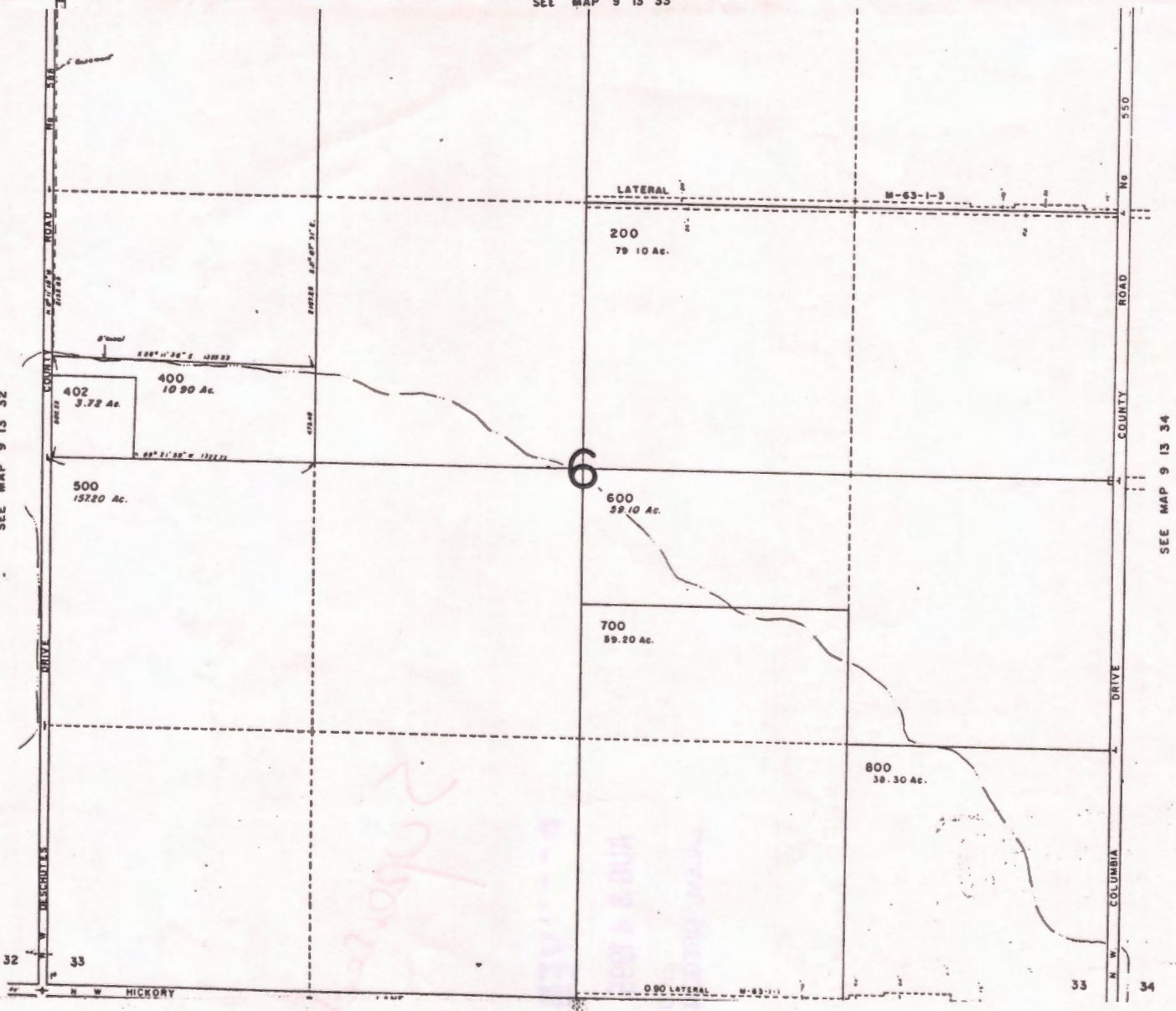

SEE MAP 9 13 32

SEE MAP 9 13 34

RECEIVED
AUG 24 1995
WAYNE COUNTY CLERK
SALEM, OREGON

Handwritten notes in pink ink:
20/30/20
1000 + 1000
1000 + 1000
1000 + 1000

