From: Mary Rohling [mailto:Mary.F.ROHLING@wrd.state.or.us]
Sent: Wednesday, December 20, 2006 1:45 PM
To: 'Timmie Brandt'
Subject: RE:

-->

Timmie,

Thanks, Wris has been updated with the new information.

Mary

From: Timmie Brandt [mailto:Timmie.C.BRANDT@wrd.state.or.us]
Sent: Wednesday, December 20, 2006 1:45 PM
To: Mary.F.ROHLING@wrd.state.or.us
Cc: Timmie.C.BRANDT@wrd.state.or.us
Subject: G-16617 & S-86488 - Address Changes

Please update WRIS with the following information:

Groundwater file G-16617 / No Permit / No Certificate AND
Surface Water file S-86488 / No Permit / No Certificate -

PAT FRENCH E-mail: patf@willamalane.org
WILLAMALANE PARK & RECREATION DIST
250 S 32ND STREET PH#: 541-736-4055
SPRINGFIELD OR 97478 FAX#: 541-736-4025

OLD ADDRESS:
200 S Mill Street
Springfield OR 97477

<>8<>8<>8<>8<>8<>8<>
Timmie C. Brandt
Water Rights Division



Oregon

Theodore R. Kulongoski, Governor

Water Resources Department
North Mall Office Building
725 Summer Street NE, Suite A
Salem, OR 97301-1271
503-986-0900
FAX 503-986-0904

November 30, 2006

WILLAMALANE PARK AND RECREATION DISTRICT
PAT FRENCH
200 S MILL ST
SPRINGFIELD OR 97477

Reference: File S-86488

Willamalane Park and Recreation District:

The application referenced above was withdrawn from the records of the Water Resources Department on November 30, 2006, in Special Order Volume 70 page 651. The application is of no further force or effect. Enclosed please find a check in the amount of \$258.00, which is a refund of unearned fees due to the withdrawal of the application.

If you have any questions, please contact Kerry Kavanagh, at 503-986-0816.

Sincerely,

A handwritten signature in cursive script that reads "E. Timothy Wallin".

E. Timothy Wallin
Water Rights Program Manager

cc: File
Fiscal Section (receipt #78826)
Ken Stahr, OWRD
WM # 2
Jeff Ziller, ODFW

enclosure

BEFORE THE WATER RESOURCES DIRECTOR OF OREGON

LANE COUNTY

IN THE MATTER OF THE WITHDRAWAL) FINAL
OF APPLICATION FOR S-86488) ORDER

The following application for permit is being withdrawn voluntarily by the applicant.

| <u>APPLICANT</u> | <u>APPL.#</u> | <u>BASIN #</u> |
|--|---------------|----------------|
| Willamalane Park and Recreation District | S-86488 | 2 |

It is hereby ORDERED that the application is of no further force or effect.

Dated at Salem, Oregon, on November 30, 2006.

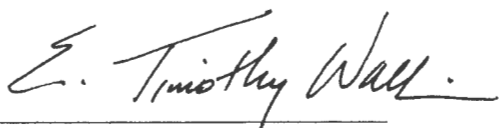

E. Timothy Wallin, Water Rights Program Manager, *for*
Phillip C. Ward, Director

This is a final order in other than contested case. This order is subject to judicial review under ORS 183.484. Any petition for judicial review must be filed within the 60-day time period specified by ORS 183.484(2). Pursuant to ORS 536.075 and ORS 137-004-0080 you may either petition for judicial review or petition the Director for reconsideration of this order. A petition for reconsideration may be granted or denied by the Director, and if no action is taken within 60 days following the date the petition was filed, the petition shall be deemed denied.

STATE OF OREGON REMITTANCE ADVICE

TO SIGN UP FOR DIRECT DEPOSIT PAYMENT SERVICE AND RECEIVE CONVENIENT, ELECTRONIC PAYMENTS, LOG-ON TO <http://egov.oregon.gov/DAS/SCD/SFMS/ach.shtml> ON THE INTERNET. CLICK ON: FORMS AND BROCHURES THEN SELECT DIRECT DEPOSIT (ACH) AUTHORIZATION FORM.

WARRANT NO.
119811984

WATER RESOURCES DEPARTMENT

(503) 986-0926 EXT.

| INVOICE NO. | INVOICE DATE | INVOICE DESCRIPTION | AGY | DOCUMENT | AMOUNT |
|---|--------------|-------------------------------|----------------------|-----------------------|-----------------------|
| | | 78826 - S86488 REVENUE REFUND | 690 | VP024920 | 258.00 |
| | | | | | <i>mailed 12/4/06</i> |
| VENDOR NAME: WILLAMALANE PARK AND RECREATION DISTRICT | | | ISSUE DATE: 11/30/06 | WARRANT AMOUNT 258.00 | |

FOLD ON PERFORATION LINE BELOW BEFORE DETACHING.

DO NOT ACCEPT THIS CHECK UNLESS YOU CAN SEE A TRUE WATERMARK OF CHAIN-LINKED SHARES WHEN HELD TO THE LIGHT

STATE OF OREGON

Dept of Administrative Services
To the State Treasurer, Salem, OR 97301-3898

WATER RESOURCES DEPARTMENT
(503) 986-0926 EXT.

96-10
1232

CHECK DATE
11/30/06



BANK WARRANT NO.
11 9811984

PAY THIS AMOUNT
\$258.00

DOCUMENT NO.
VP024920

*****TWO HUNDRED FIFTY EIGHT AND 00/100 DOLLARS*****

PAY TO THE ORDER OF:

WILLAMALANE PARK AND RECREATION DISTRICT
PAT FRENCH
200 S MILL ST
SPRINGFIELD OR 97477

VOID AFTER 2 YEARS FROM DATE OF ISSUE

John J. French

AUTHORIZED SIGNATURE

THE FACE OF THIS CHECK HAS A COLORED BACKGROUND. EXPLANATION OF ADDITIONAL SECURITY FEATURES INDICATED ON REVERSE SIDE

⑈ 119811984 ⑈ ⑆ 123200101⑆ 10501⑈

WATER RESOURCES DEPARTMENT

725 Summer St. N.E. Ste. A

SALEM, OR 97301-4172

(503) 986-0900 / (503) 986-0904 (fax)

RECEIPT # 78826

INVOICE # _____

RECEIVED FROM: Willamette
BY: Park & Rec District

| | |
|-------------|---------------|
| APPLICATION | <u>864188</u> |
| PERMIT | |
| TRANSFER | |

CASH: CHECK:# 60143 OTHER: (IDENTIFY)

TOTAL REC'D \$ 308.00

1083 TREASURY 4170 WRD MISC CASH ACCT

| | | |
|------|-----------------------|----|
| 0407 | COPIES | \$ |
| | OTHER: (IDENTIFY) | \$ |
| 0243 | I/S Lease | |
| 0244 | Muni Water Mgmt. Plan | |
| 0245 | Cons. Water | |

4270 WRD OPERATING ACCT

| | | | |
|-------------------|--------------------------|------------------|-------------|
| MISCELLANEOUS | | <u>46111</u> | |
| 0407 | COPY & TAPE FEES | | \$ |
| 0410 | RESEARCH FEES | | \$ |
| 0408 | MISC REVENUE: (IDENTIFY) | | \$ |
| TC162 | DEPOSIT LIAB. (IDENTIFY) | | \$ |
| 0240 | EXTENSION OF TIME | | \$ |
| WATER RIGHTS: | | | |
| 0201 | <u>SURFACE WATER</u> | EXAM FEE | RECORD FEE |
| 0203 | GROUND WATER | \$ <u>308.00</u> | 0202 \$ |
| 0205 | TRANSFER | \$ | 0204 \$ |
| WELL CONSTRUCTION | | | |
| 0218 | WELL DRILL CONSTRUCTOR | EXAM FEE | LICENSE FEE |
| | LANDOWNER'S PERMIT | \$ | 0219 \$ |
| | OTHER (IDENTIFY) | | 0220 \$ |

0536 TREASURY 0437 WELL CONST. START FEE

| | | | |
|------|----------------------|----|--|
| 0211 | WELL CONST START FEE | \$ | |
| 0210 | MONITORING WELLS | \$ | |
| | OTHER (IDENTIFY) | | |

0607 TREASURY 0467 HYDRO ACTIVITY LIC NUMBER

| | | | |
|------|----------------------------|--|----|
| 0233 | POWER LICENSE FEE (FW/WRD) | | \$ |
| 0231 | HYDRO LICENSE FEE (FW/WRD) | | \$ |
| | HYDRO APPLICATION | | \$ |

TREASURY OTHER / RDX

| | | |
|-------------|----------|----|
| FUND | TITLE | |
| OBJ. CODE | VENDOR # | |
| DESCRIPTION | | \$ |

RECEIPT: 78826

DATED: 11/23/05 BY: A. Vaughn-Paschke



Willamalane
Park & Recreation District

November 22, 2006

Water Resources Department
725 Summer Street NE Suite A
Salem OR 97301

Attn: Kerry Kavanagh

Re: File #G 16617 and File #86488

Kerry,

As we discussed on the phone, please put our application for ground water rights at Ruff Park, your file #G16617 on administrative hold. We are currently in an appeal process working to acquire the needed Special Use Permit from Lane County. We have been offered a contract for Willamette Valley Project Water by the Bureau of Reclamation, so upon obtaining the Special Use Permit, we will provide the items needed to move forward with the Final Order.

Willamalane had previously requested that file #86488 be put on administrative hold. Willamalane now wishes to withdraw that application and to request any refund of the application fee that might be due to us.

Also, please note for your files that beginning December 19th, Willamalane's new physical location and our mailing address will change to 250 S. 32nd Street, Springfield OR 97478. Items mailed before that date should be sent to our current address.

Thank you for your assistance.

Sincerely,

Pat French
Park Planner

RECEIVED

NOV 24 2006

WATER RESOURCES DEPT
SALEM, OREGON



Willamalane

Park & Recreation District

Administration Center
200 South Mill Street
Springfield, OR 97477-7303

*D-16617
86488*



neopost[®]

049J82034642

\$00.39⁰

11/22/2006

Mailed From 97477

US POSTAGE

WATER RESOURCES DEPARTMENT
725 SUMMER STREET NE SUITE A
SALEM OR 97301

ATTENTION: KERRY KAVANAGH

97301 97301 97301





Oregon

Theodore R. Kulongoski, Governor

Water Resources Department

North Mall Office Building

725 Summer Street NE, Suite A

Salem, OR 97301-1271

503-986-0900

FAX 503-986-0904

July 19, 2006

WILLAMALANE PARK AND RECREATION DISTRICT
ATTN: PAT FRENCH
200 S MILL ST
SPRINGFIELD, OR 97477

Reference: File S-86488

Dear Ms. French:

On July 18, 2006, the Water Resources Department (Department) received your request for an additional administrative hold for 180 days on processing the application referenced above. The request is to allow the Department time to process an associated ground water application. The first administrative hold will expire on July 29, 2006.

Based upon the review of the information you have provided, the Department has determined that a longer administrative hold on the processing of the above referenced application is reasonable and necessary. The Department has approved your request for an additional administrative hold. The Department will not take any action on this application until January 25, 2007. Please let us know if you are ready to proceed sooner.

If you need to request additional time, you will need to show justification for why additional time is reasonable and necessary, and a specific time line, which identifies when you anticipate being ready to continue with the application process.

If you have any questions, please call Kerry Kavanagh at 503-986-0816.

Sincerely,

E. Timothy Wallin
Water Rights Program Manager

cc: Watermaster District # 2
File

Subject: Application #S-86488

X-Security: MIME headers sanitized on kettle.wrd.state.or.us

See <http://www.impsec.org/email-tools/sanitizer-intro.html>
for details. \$Revision: 1.139 \$Date: 2003-09-07 10:14:23-07

Date: Tue, 18 Jul 2006 16:48:17 -0700

X-MS-Has-Attach:

X-MS-TNEF-Correlator:

Thread-Topic: Application #S-86488

Thread-Index: AcaqxKSBHlhtcElRRSaw3sulc4AQzA==

From: "Pat French" <PatF@willamalane.org>

To: KAVANAGH Kerry L <Kerry.L.Kavanagh@state.or.us>

X-Spam-Checker-Version: SpamAssassin 2.63 (2004-01-11) on
kettle.wrd.state.or.us

X-Spam-Status: No, hits=-4.7 required=5.0 tests=BAYES_00,HTML_70_80,
HTML_MESSAGE autolearn=no version=2.63

X-Spam-Level:

-->

Kerry,

Please extend the administrative hold for another 6 months on our application S-86488 so we can be sure to have a final disposition on our ground water application before we finally lay the surface water application to rest.

Thanks.

And thanks for pursuing the additional language for the PFO regarding mitigation with stored water given the condition of Cedar Creek being dry.

Pat

~~~~~

Pat French, Parks Planner

Willamalane Park & Recreation District

200 S. Mill Street, Springfield, OR 97477

patf@willamalane.org

541-736-4055 Fax: 541-736-4025



# Oregon

Theodore R. Kulongoski, Governor

## Water Resources Department

North Mall Office Building  
725 Summer Street NE, Suite A  
Salem, OR 97301-1271  
503-986-0900  
FAX 503-986-0904

February 2, 2006

WILLAMALANE PARK AND RECREATION DISTRICT  
ATTN: PAT FRENCH  
200 S MILL ST  
SPRINGFIELD, OR 97477

Reference: File S-86488

Dear Mr. French:

On January 31, 2006, the Water Resources Department received your letter, dated January 30, 2006, requesting an 180-day administrative hold on processing the above referenced application pending the determination of the ground water application submitted with your letter. The ground water application has been accepted and assigned the application file number G-16617.

Jerry Gainey has recently been reassigned to the certificate processing section of the Department and will no longer be working on your applications. I will be the application caseworker assigned to work on both of your pending applications.

The Department will not take any action on the application until **July 29, 2006**, unless you request we proceed sooner.

If you have any questions, please feel free to call me at 503-986-0816.

Sincerely,

Kerry Kavanagh  
Water Rights Application Caseworker

cc: Watermaster District #2  
File



**Willamalane**  
Park & Recreation District

January 30, 2006

Water Resources Department  
Attn: Jerry Gainey  
725 Summer St NE Suite A  
Salem OR 97301-1266

Reference: File S-86488

Dear Mr. Gainey:

In accordance with the suggestions made in your letter dated January 5, 2006, Willamalane is asking you to put the surface water application, File S-86488, on administrative hold pending the determination of the ground water application submitted with this letter.

Thank you for your ongoing consideration of our attempt to obtain irrigation water.

Sincerely,

Pat French  
Planner

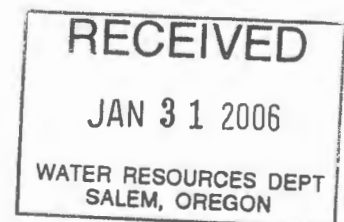



**Willamalane**  
Park & Recreation District

December 21, 2005

Water Resources Department  
Attn: Jerry Gainey  
725 Summer St NE Suite A  
Salem OR 97301-1266

Reference: File S-86488

Dear Mr. Gainey:

We have received your initial review and determination dated December 16, 2005, regarding our surface water rights application. We are pleased that it appears likely we will be granted the requested water rights.

I do have an additional question about the proposed points of diversion. In putting together the water rights application, I had extensive conversations with our local water master, Michael Mattick. Michael had suggested that we might be able to take surface water from Cedar Creek via our current well due to the strong hydrologic connection between ground and surface water where our well is located. He had pointed out that an application for ground water rights would be denied based on this hydrologic connection. Our well is 47' deep and only 140' from the South Fork of Cedar Creek. Willamalane's property is surrounded on two of its three sides by the South Fork of Cedar Creek. The well location (784' N & 288' W of SE Corner Sec 27, T17S R2W) is our preferred point of diversion from the surface water of Cedar Creek. Using this point of diversion keeps our initial costs lower, but also allows us not to disrupt the habitat on the stream bank or to cause potential harm to aquatic habitat.

Could you please address the possibility of using the well as the point of diversion for the surface water from Cedar Creek?

Thank you for your consideration.

Sincerely,

Pat French  
Planner

Cc: Michael Mattick

**RECEIVED**

DEC 22 2005

WATER RESOURCES DEPT  
SALEM, OREGON



# Oregon

Theodore R. Kulongoski, Governor

## Water Resources Department

North Mall Office Building  
725 Summer Street NE, Suite A  
Salem, OR 97301-1271  
503-986-0900  
FAX 503-986-0904

Pat French  
Willamalane Park & Recreation District  
200 S Mill St  
Springfield, Oregon 97477-7303

January 5, 2006

Reference: File S-86488

Dear Mr. French:

On December 22, 2005, I received your letter regarding the possibility of using the well as the point of diversion for the application referenced above. After discussion with staff members, a permit may be issued to use the well as the point of diversion.

If you desire to use the well as the point of diversion, you will be required to submit a completed ground water application to the Department. If it is determined that the well may have the potential for substantial interference with Cedar Creek, the well could be used as the point of diversion as long as a valid contract with the Bureau of Reclamation to use stored water from Willamette Basin Projects (McKenzie River: Blue River and Cougar). The Oregon Department of Fish and Wildlife may require you to measure and divert a certain amount of water down Cedar Creek. Contract water may be used for mitigation due to the well having the potential for substantial interference with Cedar Creek.

If you determine to use the well as the point of diversion, you should request that application S-86488 be put on administrative hold pending the determination of a ground water application. Please provide the requested information no later than February 7, 2006. If the above information is not received by February 7, 2006, we will issue a proposed final order reflecting one of the points of diversion will be from Cedar Creek as reflected in the Summary of Initial Determinations.

If you have any questions, please call me at 503-986-0812.

Sincerely,

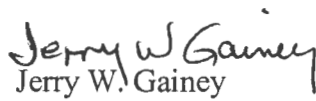
  
Jerry W. Gainey  
Water Rights Application Caseworker

enclosures

cc: Michael Mattick, Watermaster District 2  
File

690-502-0080 - McKenzie River Subbasin

The McKenzie River Subbasin includes the McKenzie River and tributaries above confluence with the Willamette River:

(1) Surface water classification:

(a) The McKenzie River from Clear Lake to Carmen Reservoir, from Tamolitch Falls to Trail Bridge Reservoir and from Trail Bridge Dam to Paradise Campground is designated a state scenic waterway. The McKenzie River and tributaries above Paradise Campground near river mile 73 (Sec 9, T16S, R6E) are classified only for domestic, commercial use for customarily domestic purposes not to exceed 0.01 cfs, livestock and public instream uses;

(b) The South Fork McKenzie River from the Three Sisters Wilderness boundary downstream to Cougar Reservoir and from Cougar Dam downstream to the confluence with the McKenzie River is designated a state scenic waterway. The South Fork McKenzie River and its tributaries are classified only for domestic, commercial use for customarily domestic purposes not to exceed 0.01 cfs, livestock and public instream uses;

(c) Blue River upstream from its confluence with the McKenzie River and tributaries are classified year-round only for domestic, commercial use for customarily domestic purposes not to exceed 0.01 cfs, livestock and public instream uses;

(d) Except as specified in subsections (a), (b), and (c) of this section, all tributaries to the McKenzie River are classified for domestic, livestock, municipal, industrial, irrigation, agricultural, commercial, power, mining, fish life, wildlife, recreation, pollution abatement, wetland enhancement and public instream uses from October 1 through June 30, and only for domestic, commercial use for customarily domestic purposes not to exceed 0.01 cfs, livestock and public instream uses from July 1 through September 30;

(e) Except as specified in subsection (a) of this section, the McKenzie River main stem down-stream from Paradise Campground near river mile 73 (Sec 9, T16S, R6E) is classified only for domestic, livestock, municipal, industrial, agricultural, commercial, power, mining, fish life, wildlife, recreation, pollution abatement, wetland enhancement, off-channel power development in conjunction with storage and public instream uses;

(f) The waters of the natural lakes of the McKenzie River subbasin above 3,000 feet elevation are classified only for domestic, excluding irrigation of lawn and noncommercial garden, commercial use for customarily domestic purposes not to exceed 0.01 cfs, livestock and public instream uses. Storage shall not be allowed on these lakes.



(2) For the purpose of maintaining a minimum perennial streamflow sufficient to support aquatic life and to minimize pollution and of attaining the highest and best use of waters released from storage, no appropriations of water except for domestic or livestock uses or waters to be legally stored or legally released from storage shall be made or granted by any state agency or public corporation of the state for the following waters and as shown in Table 1:

(a) The South Fork McKenzie River or its tributaries above the South Fork McKenzie River -- McKenzie River confluence for natural flows of the South Fork McKenzie River below 200 cubic feet per second, plus waters released from storage of up to 230 cubic feet per second measured at a point between said confluence and 1.0 miles above said confluence;

(b) Blue River or its tributaries above the Blue River -- McKenzie River confluence for natural flows of Blue River below 30 cubic feet per second, plus waters released from storage of up to 350 cubic feet per second measured at a point between said confluence and 1.0 miles above said confluence;

(c) The McKenzie River or its tributaries above USGS -- State Engineer Gage 14162500 (NE 1/4 Section 5, Township 17 South, Range 3 East) near Vida, Oregon, for natural flows of the McKenzie River below 1,400 cubic feet per second plus waters released from storage of up to 580 cubic feet per second measured at the aforementioned gage;

(d) The McKenzie River or its tributaries above the intersection of the McKenzie River and Interstate Highway 5 for natural flows of the McKenzie River below 1,025 cubic feet per second, plus waters released from storage of up to 700 cubic feet per second, measured at the intersection of the McKenzie River and Interstate Highway 5.

### **690-502-0160 - Groundwater Classifications and Conditions**

(1) Use of groundwater from the basalt aquifer within the Cooper-Bull Mountain Critical Groundwater Area shall be as described in the State Engineer's order designating the Cooper-Bull Mountain Critical Groundwater Area dated May 17, 1974.

(2) Groundwater Classification: The groundwater resources of the Willamette Basin are classified for domestic, livestock, irrigation, municipal, industrial, agricultural, commercial, power, mining, recreation, fish life, wildlife, pollution abatement, wetland enhancement and statutorily exempt groundwater uses except as described in OAR 690-502-0170 to 690-502-0210.

### **690-502-0240 - Groundwater-Surface Water Hydraulic Connection**

These rules are in addition to the requirements of OAR chapter 690, division 009. Groundwater in unconfined alluvium within 1/4 mile of the banks of a stream or surface water source is presumed to be in hydraulic connection with the surface water source, unless the applicant or appropriator provides satisfactory information or demonstration to the contrary. This hydraulically connected groundwater shall be classified the same as the surface source. This section shall not apply to those groundwater uses exempted by ORS 537.545. Notwithstanding such classification, permits may be issued for the use of water from a well in an unconfined aquifer that is hydraulically connected to groundwater, within a quarter mile of a stream, provided that surface water impacts are mitigated through storage releases.



**Oregon Water Resources Department**  
 725 Summer Street NE, Suite A  
 Salem Oregon 97301-1271  
 (503) 986-0900  
 www.wrd.state.or.us

# Application for a Permit to Use Surface Water

Please type or print in dark ink. If your application is found to be incomplete or inaccurate, we will return it to you. If any requested information does not apply to your application, insert "n/a." Please read and refer to the instructions when completing your application. A summary of review criteria and procedures that are generally applicable to these applications is available at [www.wrd.state.or.us/OWRD/PUBS/forms.shtml](http://www.wrd.state.or.us/OWRD/PUBS/forms.shtml).

## 1. APPLICANT INFORMATION

### A. Individuals

Applicant: \_\_\_\_\_  
First Last

Mailing address: \_\_\_\_\_

\_\_\_\_\_  
City State Zip

Phone: \_\_\_\_\_  
Home Work Other

\*Fax: \_\_\_\_\_ \*E-Mail address: \_\_\_\_\_

### B. Organizations

*(Corporations, associations, firms, partnerships, joint stock companies, cooperatives, public and municipal corporations)*

Name of organization: Willamalane Park & Recreation District

Name and title of person applying: <sup>MS.</sup> Pat French, planner

Mailing address of organization: 200 S. Mill Street

\_\_\_\_\_  
City State Zip

Phone: 541-736-4055  
Day Evening

\*Fax: 541-736-4025 \*E-Mail address: patf@willamalane.org

\* Optional information

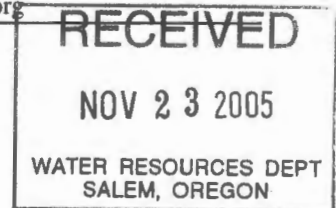

|                         |                  |            |
|-------------------------|------------------|------------|
| For Department Use      |                  |            |
| App. No. <u>S-86488</u> | Permit No. _____ | Date _____ |

2. SOURCE AND PROPERTY OWNERSHIP

**A. The Proposed Source of Water**

Provide the commonly used name of the water body from which water will be diverted, and the name of the stream or lake it flows into. If unnamed, say so:

Source 1: Willamette Basin Project Water Tributary to: Willamette River  
Source 2: \_\_\_\_\_ Tributary to: \_\_\_\_\_  
Source 3: \_\_\_\_\_ Tributary to: \_\_\_\_\_  
Source 4: \_\_\_\_\_ Tributary to: \_\_\_\_\_

**B. Property Ownership**

Do you own all the land where you propose to divert, transport, and use water?

- Yes (Skip to section 3 "Water Use.")
- No (Please check the appropriate box below.)
  - I have a recorded easement or written authorization permitting access.
  - I do not currently have written authorization or easement permitting access.
  - Written authorization or an easement is not necessary, because the only affected lands I do not own are state-owned submersible lands, and this application is for irrigated and/or domestic use only (ORS 274.040).

You must provide the legal description of: (1) the property from which the water is to be diverted, (2) any property crossed by the proposed ditch, canal or other work, and (3) any property on which the water is to be used as depicted on the map.

List the names and mailing addresses of all affected landowners.

---

---

---

---

3. WATER USE

*Please read the instruction booklet for more details on "type of use" definitions, how to express how much water you need and how to identify the water source you propose to use. You must fill out a supplemental form for some uses as they require specific information for that type of use.*

**A. Type(s) of Use(s)**

See list of beneficial uses provided in the instructions.

- If your proposed use is **domestic**, indicate the number of households to be supplied with water: \_\_\_\_\_
- If your proposed use is **irrigation**, please attach **Form I**
- If your proposed use is **mining**, attach **Form R**
- If your proposed use is **municipal or quasi-municipal**, attach **Form M**
- If your proposed use is **commercial/industrial**, attach **Form Q**

**B. Amount of Water**

Provide the amount of water you propose to use from each source, for each use, in cubic feet-per-second (cfs) or gallons-per-minute (gpm). If the proposed use is from storage, provide the amount in acre-feet (af):

*(1 cfs equals 448.8 gpm. 1 acre-foot equals 325,851 gallons or 43,560 cubic feet)*

| Source                   | Type of use | Amount |                              |                              |                                        |
|--------------------------|-------------|--------|------------------------------|------------------------------|----------------------------------------|
| Willamette Basin Project | Irrigation  | 17.25  | <input type="checkbox"/> cfs | <input type="checkbox"/> gpm | <input checked="" type="checkbox"/> af |
|                          |             |        | <input type="checkbox"/> cfs | <input type="checkbox"/> gpm | <input type="checkbox"/> af            |
|                          |             |        | <input type="checkbox"/> cfs | <input type="checkbox"/> gpm | <input type="checkbox"/> af            |
|                          |             |        | <input type="checkbox"/> cfs | <input type="checkbox"/> gpm | <input type="checkbox"/> af            |

**C. Period of Use**

Indicate the time of year you propose to use the water: March 1-October 31  
*(For seasonal uses like irrigation give dates when water use would begin and end, e.g. March 1-October 31.)*

**D. Acreage**

If you will be applying water to land, indicate the total number of acres where water will be applied or used: 6.9 acres  
*(This number should be consistent with your application map.)*

**4. WATER MANAGEMENT**

**A. Diversion**

What method will you use to divert water from the source?

- Pump (give horsepower and pump type): \_\_\_\_\_
- Head-gate (give dimensions): 4' culvert with knife gate
- Other means (describe): ~~4' culvert with knife gate~~

**B. Monitoring**

How will you monitor your diversion to be sure you are within the limits of your water right (allowed rate and duty) and you are not wasting water?

- Weir
- Meter
- Periodic Sampling
- Other means (describe): n/a

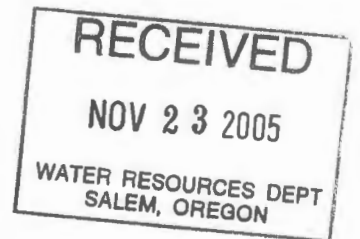

**C. Transport**

How will you transport water to your place of use?

Ditch or canal (give average width and depth):

Width 5-8' Depth 1-5'

Is the ditch or canal to be lined?  Yes  No

Pipe (give diameter and total length):

Diameter 2" Length 2563'

Other (describe) n/a

**D. Application/Distribution Method**

What equipment will you use to apply water to your place of use? 2600' of 2" mainline to sprinklers & drip emitters.

Irrigation or land application method (check all that apply):

- Flood
- Drip
- Hand lines
- Siphon tubes or gated pipe with furrows
- Other, describe n/a
- High-pressure sprinkler
- Water cannons
- Wheel lines
- Low pressure sprinkler
- Center pivot system

Distribution method

- Direct pipe from source
- In-line storage (tank or pond)
- Open canal

**E. Conservation**

What methods will you use to conserve water? Why did you choose this distribution or application method? Have you considered other methods to transport, apply, distribute or use water? For example, if you are using sprinkler irrigation rather than drip irrigation, explain. If you need additional space, attach a separate sheet.

We are using both sprinkler and drip irrigation run by a central controller that uses our weather station to adjust the amount of water that will be used. We water at night rather than during the day. On site, water is piped rather than ditched.

**5. RESOURCE PROTECTION**

**A. Protection Practices**

In granting permission to use water from a stream or lake, the state encourages, and in some instances requires, careful control of activities that may affect the waterway or streamside area. See instruction guide for a list of possible permit requirements from other agencies. Please indicate any of the practices you plan to undertake to protect water resources.

Diversion will be screened to prevent uptake of fish and other aquatic life.

Describe planned actions: We prefer to take water from the well which will minimize potential risk  
to aquatic organisms. If we have to take surface water from Cedar Creek rather than using the well, the intake will  
be screened to prevent uptake of aquatic life.

Excavation or clearing of banks will be kept to a minimum to protect riparian or streamside areas. Describe planned actions: We hope to protect riparian vegetation by taking the water from the existing  
well. If we have to take surface water, we will minimize riparian disturbance and replant native riparian vegetation  
on any disturbed areas.

Operating equipment in a water body will be managed and timed to prevent damage to aquatic life. Describe: Use of the well will prevent damage to aquatic life. If we have to take surface water from Cedar  
Creek, the intake will be screened in compliance with regulations to prevent damage to aquatic organisms.

Water quality will be protected by preventing erosion and run-off of waste or chemical products. Describe: Application of water will be regulated by the controller that uses our weather station data,  
preventing over-application of water, erosion, and run-off of waste products.

Other: n/a

## 6. PROJECT SCHEDULE

*Indicate the anticipated dates that the following construction tasks should begin. If construction has already begun, or is completed, please indicate that date.*

Proposed date construction will begin: July 2006

Proposed date construction will be completed: July 2011

Proposed date beneficial water use will begin: July 1, 2006

## 7. REMARKS

*If you would like to clarify any information you have provided in the application, please do so here and reference the specific application question you are addressing.*

- 1) The well and some of the irrigation equipment is currently in the ground and functioning.
- 2) We are hoping to use the well as the point of diversion due to the hydraulic connection of surface and ground  
water on the property. The well is 47 feet deep and within 140 feet of Cedar Creek. Cedar Creek borders 2 of the 3  
sides of the property. We have conferred with the watermaster in developing this application.

Surface Water/5

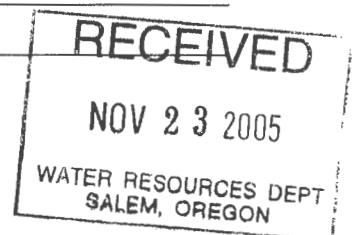

S-86488

## 8. MAP REQUIREMENTS

The Department cannot process your application without accurate information showing the source of water and location of water use. You must include a map with this application form that clearly indicates the township, range, section, and quarter/quarter section of the proposed points of diversion and place of use. The map must provide tax lot numbers. See the map guidelines sheet for detailed map specifications.

## 9. SIGNATURE

By my signature below I confirm that I understand:

- I am asking to use water specifically as described in this application.
- Evaluation of this application will be based on information provided in the application packet.
- I cannot legally use water until the Water Resources Department issues a permit to me.
- If I get a permit, I must not waste water.
- If development of the water use is not according to the terms of the permit, the permit can be canceled.
- The water use must be compatible with local comprehensive land use plans.
- Even if the Department issues a permit to me, I may have to stop using water to allow senior water right holders to get water they are entitled to, and

I swear that all information provided in this application is true and correct to the best of my knowledge:

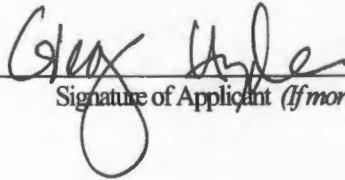

Signature of Applicant (If more than one applicant, all must sign.)

11/21/05  
Date

Before you submit your application be sure you have:

- Answered each question completely.
- Attached a legible map which includes township, range, section, quarter/quarter and tax lot number.
- Included a Land Use Information Form or receipt stub signed by a local official.
- Included the legal description of all the property involved with this application. You may supply a copy of the deed, land sales contract, or title insurance policy, to meet this requirement.
- Included a check payable to the Oregon Water Resources Department for the appropriate amount. The Department's fee schedule can be found at [www.wrd.state.or.us](http://www.wrd.state.or.us) or call (503) 986-0900.



# IR CHECKLIST

Application #: S-86488 Applicant: WILLAMALANE PARK AND RECREATION DISTRICT

Use(s): IRRIGATION USE ON 6.9 ACRES Priority Date: November 23, 2005

If municipal or quasi-municipal:  reviewed by Bill Fujii Y / N / ~~NA~~  Construction will be completed within 20 years.

Is the application complete? Y / N

Prohibited by ORS 538? Y / ~~N~~ If so, do not do an IR; return the application & fees to the applicant.

~~NA~~  GW Review  surface classification triggered  PSI with stream: \_\_\_\_\_

- will not  will likely be available ...without injury... and/or within the capacity of the resource
- will, if properly conditioned, avoid injury to existing ground water rights or to the ground water resource
- The well is located in GWLA or CGWA or T1N R3E Sec 20, 21, 28, 29. (If checked, include a basin map noting POD.)

WM Dist (NWR - 1 2 16 18 20) (NCR - 3 4 5 21) (ER - 6 8 9 10) (SCR - 11 12 17) (SWR - 13 14 15 19)

DIVISION 33 Y / N / NA  Above Bonneville (if checked not allowed April 15 - September 30?)  
(If Y, attach basin map w/ pod)  Below Bonneville  
 Statewide

SW Availability ~~Y~~ NA  80% live  50% storage Stored A2D WID: 2-528

- Use DWF's nonstandard W/A memo if the source is a Drews Reservoir tributary; the Snake River; the Columbia River; the North Umpqua River below Rock Creek; or within the drainages of the Lost River, Chehalem Creek, or Champoege Creek (including Mission & Case Creeks)

Is there a conflict? Y / ~~N~~ / NA \_\_\_\_\_

- If conflict, are rights from a different source?
- If supplemental, check for primary right on same land
- will this be making up a deficiency in rate?

Allowed under Basin Program ~~Y~~ / N Limitations? Y / ~~N~~ DAR 690-502

303D Y / ~~N~~ / NA IN GEOGRAPHIC UMATILLA Y / ~~N~~ BOTTLED WATER Y / ~~N~~  
(cc: DEQ Regional Manager) (cc: CTUIR) (cc: DOA Food Safety Division)

Rate 180 Rate Max 17.25 AF Req 17.25 AF  
Duty 2/2 Season Allowed 3/1-10/31 Req 3/1-10/31

Land use: ~~OK~~ needs approval county notified NA

Storage Contracts:  USBOR  Army Corps of Engineers  Douglas County  NA  
contract # NEED

Agent: Has the applicant authorized someone to act as an agent? Y / ~~N~~

Conditions: \_\_\_\_\_

Small  $\leq 0.1$  CFS,  $\leq 9.2$  AF, Medium  $0.1$  or  $< 1.5$  CFS,  $> 9.2$  or  $< 100$  AF, Large  $\geq 1.5$  CFS,  $\geq 100$  AF  
Use "Medium" when the source is Siltcoos Lake or stored water with a contract.  
Use "Large" when permit has 7I, temp control (including NU) or HC above a SWW, Tenmile Lake, or when the applicant is a government entity  
Use "Large with totalizing flow meter" for IR permits in South Salem Hills or IR over 10 Ac. in Stage Gulch CGWA

Application #: S-86488 Applicant: WILLAMALANE PARK AND RECREATION DISTRICT

Is the stream **withdrawn**? Y / N / NA season allowed \_\_\_\_\_

**Basin Maps** have been checked Y / N **River Mile** \_\_\_\_\_

**SWW ABOVE** WITHIN NA Name \_\_\_\_\_ (If above or within, notify Parks.)

Is the source a **high priority for streamflow restoration**? Y / N / NA

**Letter format** Good Limited Bad Bad w/ HC Opportunity

If **Initial Review is negative**, did you notify the applicant? Y / N / NA

CWRE, representative, etc. to notify? Y / N \_\_\_\_\_  
\_\_\_\_\_  
\_\_\_\_\_

**Addn'l info req'd?** Y / N \_\_\_\_\_  
(If Y, send certified)

**Attachments** included? Y / N / NA \_\_\_\_\_

**Fees**

| Base Fee                       | Water Amount (Q)                                   |
|--------------------------------|----------------------------------------------------|
| \$100 / \$150<br>\$250 / \$300 | 17.25<br>AF<br>1 <sup>st</sup> CFS/AF              |
|                                | 150                                                |
|                                | 8 Addl CFS/AF @ 1 + 8                              |
| <u>150</u><br>(base)           | <u>158</u><br>(Q) = <u>308</u><br>(total exam fee) |

|                   |             |
|-------------------|-------------|
| EXAM FEE REQUIRED | <u>308</u>  |
| EXAM FEE PAID     | <u>-308</u> |
| STILL OWED        | <u>0</u>    |

Name: Jerry Gainey Date: 12/6/2005 Peer Reviewer: Jerry Gainey

The purpose of this checklist is to be used as a working document by Department staff to aid in the production of the related Initial Review, Proposed Final Order, or Final Order. It is not intended to be a complete record of all factors which were considered to produce the document, nor is it intended to serve any purpose other than that stated above. The related Initial Review, Proposed Final Order, or Final Order is intended to stand alone as the record of factors considered in its production.

## Analysis for Application: S86488

### Location: 17S-2W-26-SWSW

Uses: IR 1 P

#### Basins

| BASIN_NUM | BASIN_NAME |
|-----------|------------|
| 2         | Willamette |

Records Found: 1

#### WaterMaster Districts

| WATERDIST | REGION | WMASTER      | ADDRESS                                     | CITY        | ZIP   | PHONE        | EXT | FAX          |
|-----------|--------|--------------|---------------------------------------------|-------------|-------|--------------|-----|--------------|
| 2         | NW     | Mike Mattick | Central Lane Justice Court, 220 North Fifth | Springfield | 97477 | 541-687-3620 |     | 541-746-1861 |

Records Found: 1

#### WAB

| GAGE | BASIN | LINK1                      | LINK2              |
|------|-------|----------------------------|--------------------|
| 528  | 2     | Water Availability:50% 80% | Peak Flow Analysis |

Records Found: 1

#### County

| COUNTY | FIPS  |
|--------|-------|
| Lane   | 41039 |

Records Found: 1

Groundwater Restricted Records Found: 0

#### Divison 33 Area

| DIV33           |
|-----------------|
| In a Div33 area |

Records Found: 1

#### Rule 4D

| RULE4D           |
|------------------|
| In a Rule4D Area |

Records Found: 1

303D Streams Records Found: 0

303D Lakes Records Found: 0

### Location: 17S-2W-27-SESE

Uses: IR 5.9 P

#### Basins

| BASIN_NUM | BASIN_NAME |
|-----------|------------|
| 2         | Willamette |

Records Found: 1

#### WaterMaster Districts

| WATERDIST | REGION | WMASTER      | ADDRESS                                     | CITY        | ZIP   | PHONE        | EXT | FAX          |
|-----------|--------|--------------|---------------------------------------------|-------------|-------|--------------|-----|--------------|
| 2         | NW     | Mike Mattick | Central Lane Justice Court, 220 North Fifth | Springfield | 97477 | 541-687-3620 |     | 541-746-1861 |

Records Found: 1

#### WAB

| GAGE | BASIN | LINK1                      | LINK2              |
|------|-------|----------------------------|--------------------|
| 528  | 2     | Water Availability:50% 80% | Peak Flow Analysis |

Records Found: 1

#### County

| COUNTY | FIPS  |
|--------|-------|
| Lane   | 41039 |

Records Found: 1

**Groundwater Restricted Records Found: 0**

**Divison 33 Area**

DIV33  
In a Div33 area

**Records Found: 1**

**Rule 4D**

RULE4D  
In a Rule4D Area

**Records Found: 1**

**303D Streams Records Found: 0**

**303D Lakes Records Found: 0**

# Platcard Report

## Township 17.0S Range 2.0W Section 26

|                           |                        |                  |                   |  | NE |           |           |    | NW        |           |    |    | SW         |    |    |            | SE |           |            |    |                     |     |
|---------------------------|------------------------|------------------|-------------------|--|----|-----------|-----------|----|-----------|-----------|----|----|------------|----|----|------------|----|-----------|------------|----|---------------------|-----|
| App#<br>Priority          | Permit/<br>Certificate | Claim/<br>Decree | Status<br>dlc/lot |  | NE | NW        | SW        | SE | NE        | NW        | SW | SE | NE         | NW | SW | SE         | NE | NW        | SW         | SE | Govt<br>Lot         | DLC |
| ①<br>05/31/1952           | -                      | GR1369           |                   |  |    |           |           |    |           |           |    |    |            |    |    | 10.0<br>IR |    | 3.0<br>IR | 15.0<br>IR |    |                     |     |
| ①<br>G12530<br>05/09/1991 | G13125<br>76496        |                  |                   |  |    |           |           |    |           |           |    |    | 0.22<br>IR |    |    | 3.78<br>IR |    |           |            |    |                     |     |
|                           | 05/09/1991             |                  |                   |  |    |           |           |    |           |           |    |    |            |    |    | 5.0<br>NU  |    |           |            |    |                     |     |
| ①<br>G15241<br>11/08/2002 | -                      |                  |                   |  | MU | MU        | MU        | MU | MU        | MU        | MU | MU | MU         | MU | MU | MU         | MU | MU        | MU         | MU |                     |     |
| ①<br>G15243<br>11/08/2002 | -                      |                  |                   |  | MU | MU        | MU        | MU | MU        | MU        | MU | MU | MU         | MU | MU | MU         | MU | MU        | MU         | MU |                     |     |
| ①<br>G15244<br>11/08/2002 | -                      |                  |                   |  | MU | MU        | MU        | MU | MU        | MU        | MU | MU | MU         | MU | MU | MU         | MU | MU        | MU         | MU |                     |     |
| ①<br>S26126<br>07/02/1951 | S21246<br>23897        |                  | CN<br>dlc: 53     |  |    |           |           |    |           |           |    |    |            |    |    |            |    |           |            |    | 0.5<br>IS (s)<br>CN |     |
| ①<br>S30462<br>12/06/1955 | S23994<br>28874        |                  | dlc: 68           |  |    | 3.4<br>IR |           |    | 8.6<br>IR | 3.0<br>IR |    |    | 9.8<br>IR  |    |    |            |    |           |            |    |                     |     |
|                           | 12/06/1955             |                  | lot: 3            |  |    |           |           |    |           |           |    |    | 15.6<br>IR |    |    |            |    |           |            |    |                     |     |
|                           | 12/06/1955             |                  | lot: 12           |  |    |           | 0.2<br>IR |    |           |           |    |    |            |    |    |            |    |           |            |    |                     |     |

Page: [1](#) [2](#) [3](#) [Next](#) [Last](#)

[Return to Platcard Query Screen](#)

Run Time: 2 seconds

# Platcard Report

Township 17.0S Range 2.0W Section 26

|  | App#<br>Priority       | Permit/<br>Certificate | Claim/<br>Decree | Status<br>dlc/lot | NE        |    |    |           | NW        |    |    |    | SW |    |           |           | SE        |           |    |    | Govt<br>Lot | DLC |
|--|------------------------|------------------------|------------------|-------------------|-----------|----|----|-----------|-----------|----|----|----|----|----|-----------|-----------|-----------|-----------|----|----|-------------|-----|
|  |                        |                        |                  |                   | NE        | NW | SW | SE        | NE        | NW | SW | SE | NE | NW | SW        | SE        | NE        | NW        | SW | SE |             |     |
|  | ① S30800<br>05/28/1956 | S24292<br>23935        |                  |                   |           |    |    |           |           |    |    |    |    |    | 0.5<br>IR | 2.8<br>IR |           |           |    |    |             |     |
|  | ① S31713<br>07/11/1957 | S25081<br>29636        |                  | dlc: 48           |           |    |    |           |           |    |    |    |    |    | 7.4<br>IR |           |           |           |    |    |             |     |
|  | ① S33074<br>05/04/1959 | S26156<br>28002        |                  | dlc: 67           | 1.7<br>IR |    |    |           |           |    |    |    |    |    |           |           |           |           |    |    |             |     |
|  |                        |                        |                  | lot: 10           | 1.3<br>IR |    |    |           |           |    |    |    |    |    |           |           |           |           |    |    |             |     |
|  | ① S34756<br>03/30/1961 | S27285<br>32000        |                  | dlc: 68           |           |    |    | 5.2<br>IR | 4.0<br>IR |    |    |    |    |    |           |           |           |           |    |    |             |     |
|  | ① S37409<br>02/19/1962 | S27935<br>31795        |                  | dlc: 53           |           |    |    |           |           |    |    |    |    |    | 2.6<br>IR |           |           | 8.0<br>IR |    |    |             |     |
|  | ① S42720<br>08/29/1966 | S31918<br>44632        |                  | lot: 10           | 3.5<br>IR |    |    |           |           |    |    |    |    |    |           |           |           |           |    |    |             |     |
|  | ① S42760<br>09/02/1966 | S31974<br>57164        |                  | dlc: 53           |           |    |    |           |           |    |    |    |    |    |           |           |           |           |    |    | 1.0<br>IR   |     |
|  | ① S43120<br>12/12/1966 | S32219<br>37227        |                  | lot: 10           | 3.6<br>IR |    |    |           |           |    |    |    |    |    |           |           |           |           |    |    |             |     |
|  | ① S45322<br>08/22/1968 | S33833<br>48830        |                  | dlc: 53           |           |    |    |           |           |    |    |    |    |    |           |           | 0.5<br>IR |           |    |    | 10.0<br>IR  |     |

Page: [First](#) [Previous](#) [1](#) [2](#) [3](#) [Next](#) [Last](#)

[Return to Platcard Query Screen](#)

Run Time: 1 seconds

# Platcard Report

Township 17.0S Range 2.0W Section 26



|          |                      |                        |                  |                   | NE        |    |    |    | NW |    |           |    | SW        |            |            |           | SE |    |           |           |             |     |
|----------|----------------------|------------------------|------------------|-------------------|-----------|----|----|----|----|----|-----------|----|-----------|------------|------------|-----------|----|----|-----------|-----------|-------------|-----|
|          | App#<br>Priority     | Permit/<br>Certificate | Claim/<br>Decree | Status<br>dlc/lot | NE        | NW | SW | SE | NE | NW | SW        | SE | NE        | NW         | SW         | SE        | NE | NW | SW        | SE        | Govt<br>Lot | DLC |
| <b>i</b> | S45647<br>12/34/1968 | S33411<br>45769        |                  | dlc: 53           |           |    |    |    |    |    | 2.9<br>IR |    |           | 13.0<br>IR |            |           |    |    |           |           |             |     |
| <b>i</b> | S54619<br>08/06/1976 | S40982<br>53156        |                  | dlc: 48           |           |    |    |    |    |    |           |    |           |            | 0.9<br>IR  | 4.1<br>IR |    |    |           |           |             |     |
|          | 08/06/1976           |                        |                  | dlc: 53           |           |    |    |    |    |    |           |    | 2.8<br>IR | 10.8<br>IR | 20.7<br>IR | 6.3<br>IR |    |    | 8.2<br>IR | 6.6<br>IR |             |     |
| <b>i</b> | S56195<br>07/13/1977 | S42243<br>50246        |                  | dlc: 67           | 2.9<br>IR |    |    |    |    |    |           |    |           |            |            |           |    |    |           |           |             |     |
|          | 07/13/1977           |                        |                  | lot: 10           | 0.5<br>IR |    |    |    |    |    |           |    |           |            |            |           |    |    |           |           |             |     |
| <b>i</b> | S85336<br>11/08/2002 | -                      |                  |                   | MU        | MU | MU | MU | MU | MU | MU        | MU | MU        | MU         | MU         | MU        | MU | MU | MU        | MU        |             |     |
| <b>i</b> | S86488<br>11/23/2005 | -                      |                  |                   |           |    |    |    |    |    |           |    |           |            | 1.0<br>IR  |           |    |    |           |           |             |     |

Subj  
File →

Page: [First](#) [Previous](#) [1](#) [2](#) [3](#)

[Return to Platcard Query Screen](#)

Run Time: 1 seconds

# Platcard Report

Township 17.0S Range 2.0W Section 27

|                           |                        |                  |                   |  | NE |    |    |    | NW        |           |    |    | SW |    |    |    | SE |    |    |    | Govt Lot | DLC |  |
|---------------------------|------------------------|------------------|-------------------|--|----|----|----|----|-----------|-----------|----|----|----|----|----|----|----|----|----|----|----------|-----|--|
| App#<br>Priority          | Permit/<br>Certificate | Claim/<br>Decree | Status<br>dlc/lot |  | NE | NW | SW | SE | NE        | NW        | SW | SE | NE | NW | SW | SE | NE | NW | SW | SE |          |     |  |
| ①<br>-<br>04/01/1955      | -                      | GR937            |                   |  |    |    |    |    | 1.8<br>IR | 1.6<br>IR |    |    |    |    |    |    |    |    |    |    |          |     |  |
| ①<br>-<br>11/30/1950      | -                      | GR3177           |                   |  |    |    |    |    |           |           |    |    |    |    |    |    |    | MU | MU | MU |          |     |  |
| ①<br>G283<br>03/29/1956   | G237<br>45301          |                  |                   |  |    |    |    |    |           |           |    |    | MU |    | MU | MU |    | MU | MU |    |          |     |  |
| ①<br>G3000<br>12/16/1964  | G2795<br>45302         |                  |                   |  |    |    |    |    |           |           |    |    | MU |    | MU | MU |    | MU | MU |    |          |     |  |
| ①<br>G10641<br>02/04/1982 | G9983<br>56427         |                  |                   |  |    |    |    |    |           |           |    |    | MU |    | MU | MU |    | MU | MU |    |          |     |  |
| ①<br>G10642<br>02/04/1982 | G9984<br>56428         |                  |                   |  |    |    |    |    |           |           |    |    | MU |    | MU | MU |    | MU | MU |    |          |     |  |
| ①<br>G10643<br>02/04/1982 | G9985<br>56429         |                  |                   |  |    |    |    |    |           |           |    |    | MU |    | MU | MU |    | MU | MU |    |          |     |  |
| ①<br>G10775<br>07/12/1982 | G9989<br>56430         |                  |                   |  |    |    |    |    |           |           |    |    | MU |    | MU | MU |    | MU | MU |    |          |     |  |
| ①<br>G11217<br>01/20/1984 | G10349<br>-            |                  |                   |  |    |    |    |    |           |           |    |    | MU |    | MU | MU |    | MU | MU |    |          |     |  |
| ①<br>G12555<br>06/04/1991 | G11558<br>-            |                  |                   |  |    |    |    |    |           |           |    |    | MU |    | MU | MU |    | MU | MU |    |          |     |  |

Page:1 2 3 Next Last

[Return to Platcard Query Screen](#)

Run Time: 3 seconds



# Platcard Report

Township 17.0S Range 2.0W Section 27

|                               |                        |                  |                   |  | NE |    |    |           | NW |    |           |    | SW |           |           |           | SE        |    |           |           |             |     |
|-------------------------------|------------------------|------------------|-------------------|--|----|----|----|-----------|----|----|-----------|----|----|-----------|-----------|-----------|-----------|----|-----------|-----------|-------------|-----|
| App#<br>Priority              | Permit/<br>Certificate | Claim/<br>Decree | Status<br>dlc/lot |  | NE | NW | SW | SE        | NE | NW | SW        | SE | NE | NW        | SW        | SE        | NE        | NW | SW        | SE        | Govt<br>Lot | DLC |
| <b>i</b> G15241<br>11/08/2002 | -                      |                  |                   |  | MU | MU | MU | MU        | MU | MU | MU        | MU | MU | MU        | MU        | MU        | MU        | MU | MU        | MU        |             |     |
| <b>i</b> G15243<br>11/08/2002 | -                      |                  |                   |  | MU | MU | MU | MU        | MU | MU | MU        | MU | MU | MU        | MU        | MU        | MU        | MU | MU        | MU        |             |     |
| <b>i</b> G15244<br>11/08/2002 | -                      |                  |                   |  | MU | MU | MU | MU        | MU | MU | MU        | MU | MU | MU        | MU        | MU        | MU        | MU | MU        | MU        |             |     |
| <b>i</b> S30800<br>05/28/1956 | S24292<br>23935        |                  |                   |  |    |    |    |           |    |    |           |    |    |           |           |           | 0.1<br>IR |    |           | 4.4<br>IR |             |     |
| <b>i</b> S31418<br>03/13/1957 | S24794<br>27484        |                  | dlc: 75           |  |    |    |    |           |    |    | 2.8<br>IR |    |    | 8.8<br>IR | 8.8<br>IR |           |           |    |           |           |             |     |
|                               |                        |                  | lot: 11           |  |    |    |    |           |    |    |           |    |    |           | 0.3<br>IR |           |           |    |           |           |             |     |
| <b>i</b> S45647<br>12/31/1968 | S33411<br>45769        |                  | dlc: 51           |  |    |    |    | 3.8<br>IR |    |    |           |    |    |           |           |           |           |    |           |           |             |     |
|                               |                        |                  | dlc: 52           |  |    |    |    | 2.2<br>IR |    |    |           |    |    |           |           |           | 5.8<br>IR |    |           |           |             |     |
| <b>i</b> S48934<br>01/11/1972 | S35827<br>41705        |                  | dlc: 75           |  |    |    |    |           |    |    |           |    |    |           |           | 4.8<br>IR |           |    | 3.7<br>IR |           |             |     |
|                               |                        |                  | lot: 9            |  |    |    |    |           |    |    |           |    |    |           |           |           |           |    | 1.0<br>IR |           |             |     |

Page: [First](#) [Previous](#) [1](#) [2](#) [3](#) [Next](#) [Last](#)

[Return to Platcard Query Screen](#)

Run Time: 2 seconds

# Platcard Report

Township 17.0S Range 2.0W Section 27

|                        |                        |                  |                   |  | NE         |    |           |    | NW |    |    |           | SW         |    |    |           | SE        |           |    |    |             |     |
|------------------------|------------------------|------------------|-------------------|--|------------|----|-----------|----|----|----|----|-----------|------------|----|----|-----------|-----------|-----------|----|----|-------------|-----|
| App#<br>Priority       | Permit/<br>Certificate | Claim/<br>Decree | Status<br>dlc/lot |  | NE         | NW | SW        | SE | NE | NW | SW | SE        | NE         | NW | SW | SE        | NE        | NW        | SW | SE | Govt<br>Lot | DLC |
| ① S48934<br>01/11/1972 | S35827<br>41705        |                  | lot: 10           |  |            |    |           |    |    |    |    |           |            |    |    | 0.6<br>IR |           |           |    |    |             |     |
| ① S49046<br>03/08/1972 | S35935<br>46685        |                  | dlc: 51           |  |            |    | 7.8<br>IR |    |    |    |    | 4.2<br>IR |            |    |    |           |           |           |    |    |             |     |
|                        |                        |                  | dlc: 75           |  |            |    | 3.0<br>IR |    |    |    |    | 5.5<br>IR | 19.1<br>IR |    |    |           |           | 9.2<br>IR |    |    |             |     |
| ① S50652<br>06/12/1973 | S38268<br>45669        |                  | dlc: 52           |  |            |    |           |    |    |    |    |           |            |    |    |           | 8.5<br>IR |           |    |    | 3.0<br>IR   |     |
| ① S70219<br>03/05/1990 | S50988<br>67301        |                  |                   |  | 0.22<br>IR |    |           |    |    |    |    |           |            |    |    |           |           |           |    |    |             |     |
| ① S85336<br>11/08/2002 | -                      |                  |                   |  | MU         | MU | MU        | MU | MU | MU | MU | MU        | MU         | MU | MU | MU        | MU        | MU        | MU | MU | MU          |     |
| ① S86488<br>11/23/2005 | -                      |                  |                   |  |            |    |           |    |    |    |    |           |            |    |    |           |           |           |    |    | 5.9<br>IR   |     |

Page: [First](#) [Previous](#) [1](#) [2](#) [3](#)

[Return to Platcard Query Screen](#)

Run Time: 2 seconds

T.17S. R.2W. W.M.

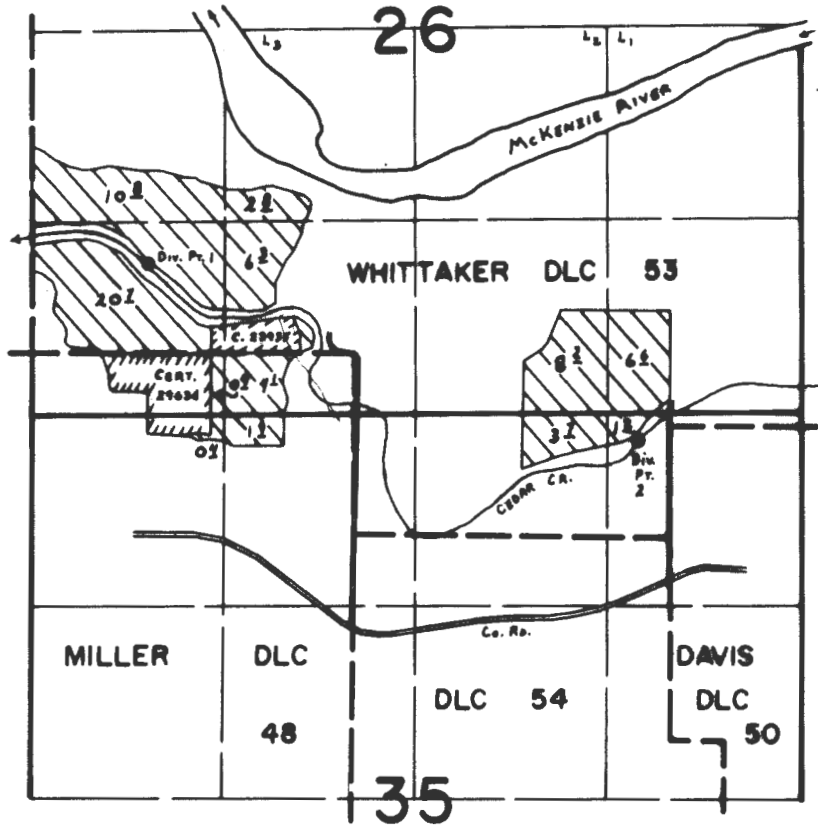

Div. Pts. Loc:

- #1- 620' N. & 1400' W. fr. NE Cor. MILLER DLC 48.
- #2- 90' S. & 210' W. fr. N.W. Cor. DAVIS DLC 50.

**FINAL PROOF SURVEY**  
UNDER

Application No. .54619.. Permit No. ...40982..  
IN NAME OF

**JAMES...L...&...MARJORY...A...GOSSLER**

Surveyed June...21... 1979., by ..G.L..HUGHES....

T.17S. R.2W. W.M.

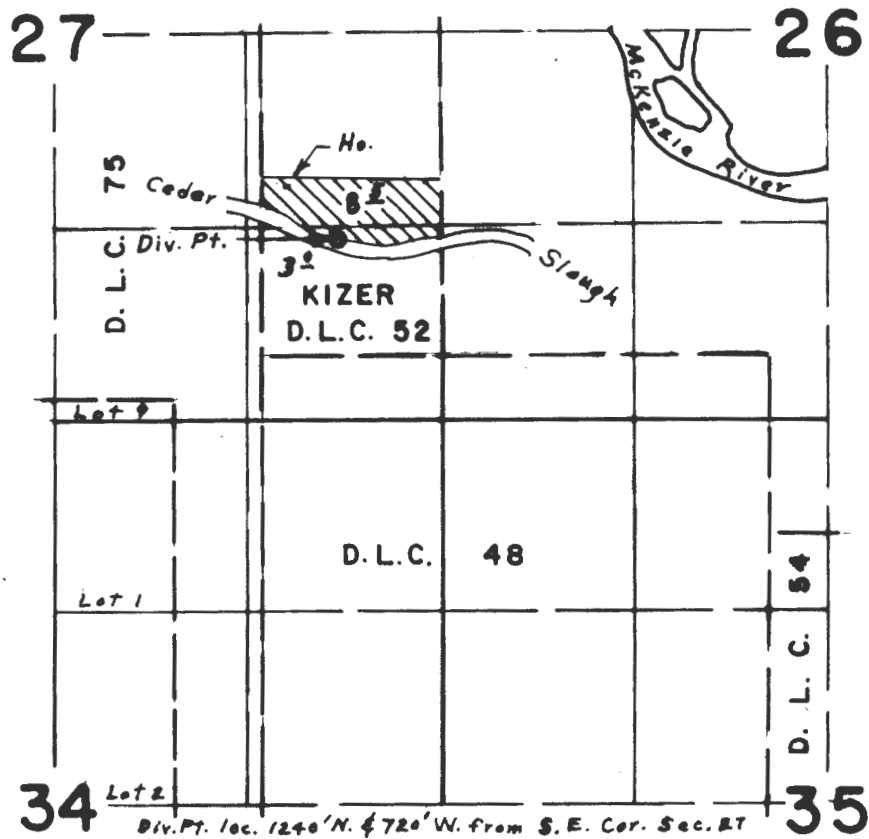

**FINAL PROOF SURVEY**  
UNDER

Application No. 50652 Permit No. 38268  
IN NAME OF

J. C. JOHNSON

Surveyed June 21, 1976, by L. E. Gould

T.17S.R.2W.W.M.

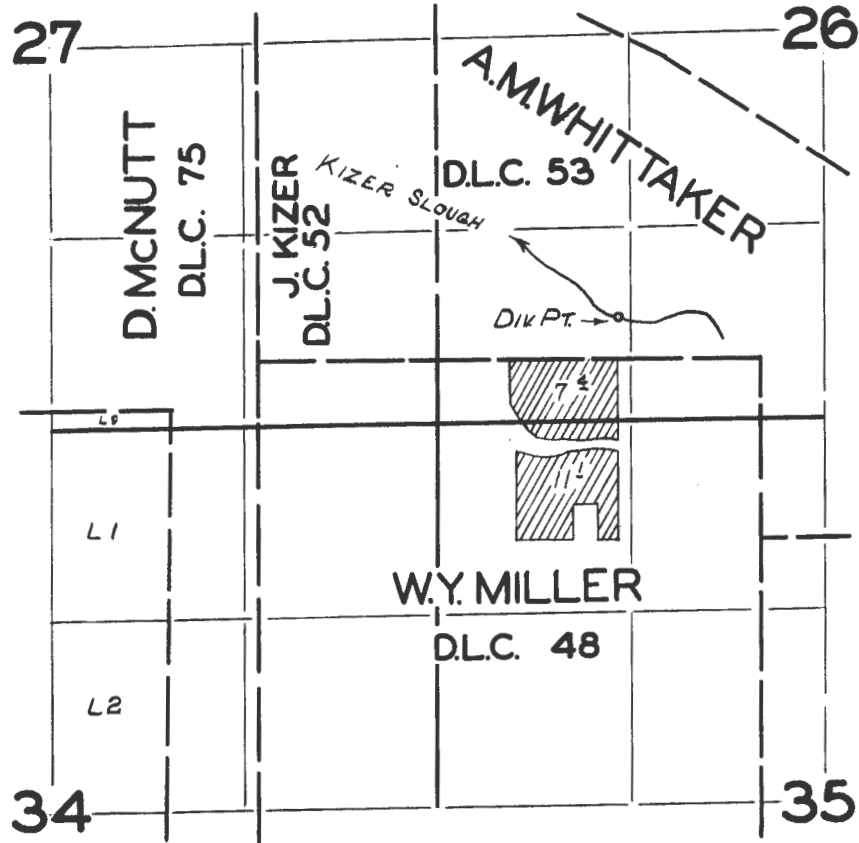

**FINAL PROOF SURVEY**  
UNDER

Application No. 31713..... Permit No. 25081.....  
IN NAME OF

.....KENNETH & ROY PLATT.....

Surveyed May 25... 1961., by C.O. BARTELS.....



WORK COPY



Oregon Water Resources Department

FORM I

FOR IRRIGATION WATER USE

1. Please indicate whether you are requesting a primary or supplemental irrigation water right.

Primary  Supplemental

PER PH WITH MS PAT  
FRENCH (11-23-2005) - SHE  
IS REQUESTING 6.9 ACRES  
PRIMARY WITH THIS  
FORM I. NYM

If supplemental, please indicate the number of acres that will be irrigated for each type of use..

Primary: n/a 6.9 Acres 6.9  
Secondary: n/a Acres

List the permit or certificate number of the primary water right: No. n/a

2. Please list the anticipated crops you will grow and whether you will be irrigating them for a full or partial season:

- 1. Magnolia arboretum  Full season  Partial season (from: Mar 1 to Oct 31)
- 2. \_\_\_\_\_  Full season  Partial season (from: \_\_\_\_\_ to \_\_\_\_\_)
- 3. \_\_\_\_\_  Full season  Partial season (from: \_\_\_\_\_ to \_\_\_\_\_)
- 4. \_\_\_\_\_  Full season  Partial season (from: \_\_\_\_\_ to \_\_\_\_\_)

3. Indicate the maximum total number of acre-feet you expect to use in an irrigation season:

17.25 acre-feet

(1 acre-foot equals 12 inches of water spread over 1 acre, or 43,560 cubic feet, or 325,851 gallons.)

4. How will you schedule your applications of water? Will you be applying water in the evenings, twice a week, daily?

- Daily during daytime hours  Daily during nighttime hours
- Two or three times weekly during daytime  Two or three times weekly during nighttime
- Weekly, during daytime hours  Weekly, during nighttime hours
- Other, explain: \_\_\_\_\_

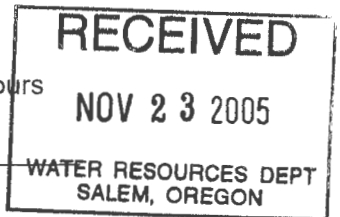

Last revision: October 31, 1996

S-86488



Planning & Development Department  
 200 South Mill Street  
 Springfield, OR 97477-7303  
 (541) 736-4044  
 FAX: (541) 736-4025

**TRANSMITTAL COVER SHEET**

**To:** Oregon Water Resources Department

**Attention:** Herb

**From:** Pat French

**Date:** November 23, 2005

**Subject/Project:** Ruff Park Water Rights Application #86488

|                                               |                                                         |                                                   |
|-----------------------------------------------|---------------------------------------------------------|---------------------------------------------------|
| <b>Transmitted:</b>                           | <b>Action Requested:</b>                                | <input type="checkbox"/> <b>FAX Transmission:</b> |
| <input checked="" type="checkbox"/> Herewith  | <input type="checkbox"/> Approval /and or Signature     | FAX Number: 503-986-0901                          |
| <input type="checkbox"/> Under separate cover | <input type="checkbox"/> Reply                          | Number of pages including cover: <u>  2  </u>     |
| <input type="checkbox"/> By Carrier           | <input checked="" type="checkbox"/> None. For Your Use. |                                                   |

| Copies | Item/Description | Dated |
|--------|------------------|-------|
|        |                  |       |

**Note:**

Herb,

I'm sending the Ruff Park map with the diversion locations noted on it.

Thanks for your assistance.

Pat



# Well and Water Use Location Wallace M. Ruff Jr. Memorial Park

**Ruff Park Boundary**  
**Streams**  
**Section Line**  
**Well Location**  
**Areas of Water Use**



SCALE: 1"=200'

November 2005

66th Street

Application #86488

Cedar Creek

T17S R2W S27 SE/SE

T17S R2W S26 SW/SW

Ruff Park Boundary

859' N & 365' W of SE Corner Sec 27, T17S R2W

Alternate Diversion Point  
(Directly from Cedar Creek)

784' N & 288' W of SE Corner Sec 27, T17S R2W

**Well Location**  
(Preferred diversion point via the well)

6.9 acres to be irrigated

Cedar Creek

Tax Lot: 17-02-27-00-01502



Base data provided by  
Lane Council of  
Governments (LCOG)

# Well and Water Use Location Wallace M. Ruff Jr. Memorial Park

-  Ruff Park Boundary
  -  Streams
  -  Section Line
  -  Well Location
  -  Areas of Water Use
- November 2005

200 0 200 400 600 800 1000 Feet

SCALE: 1"=200'

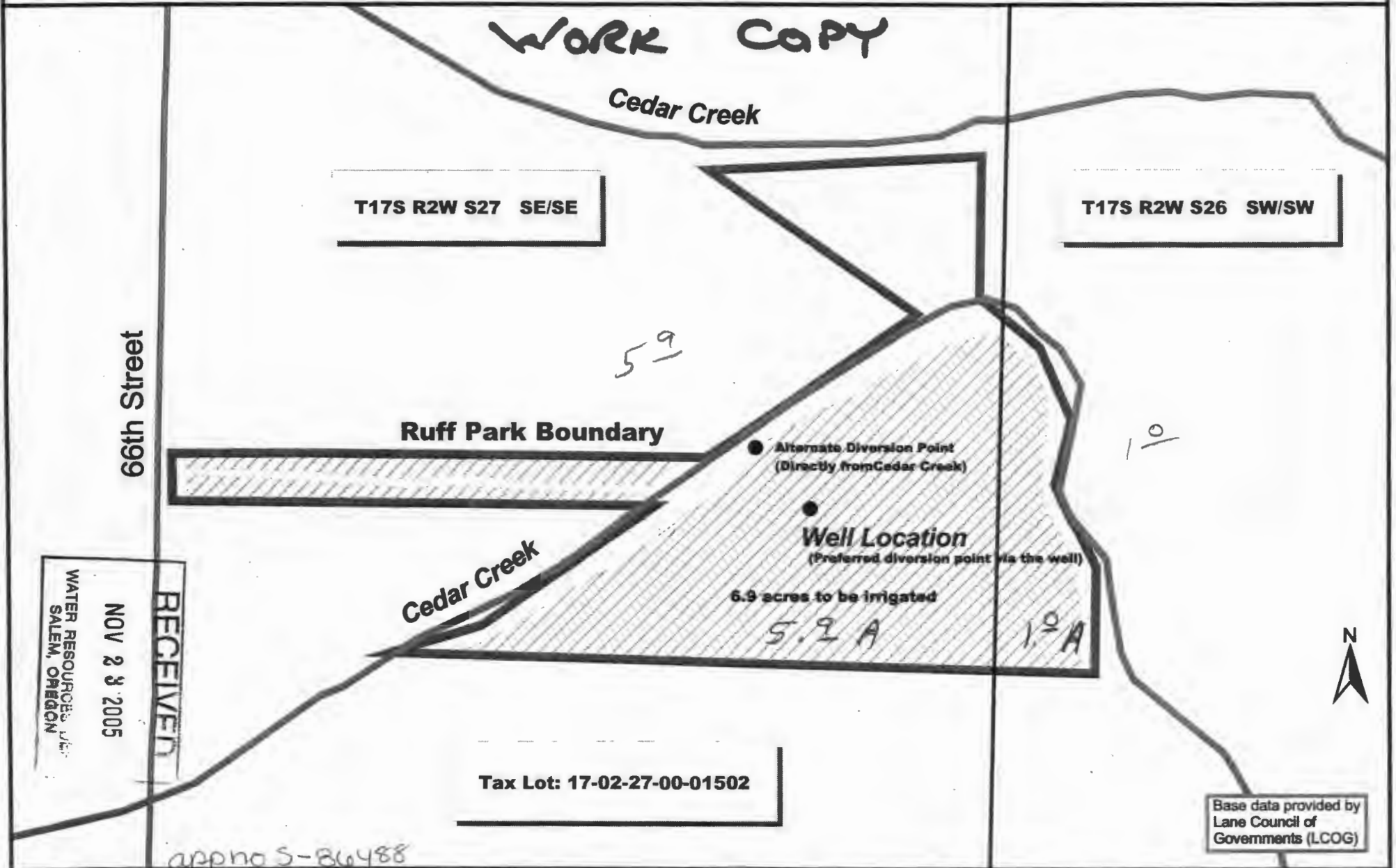



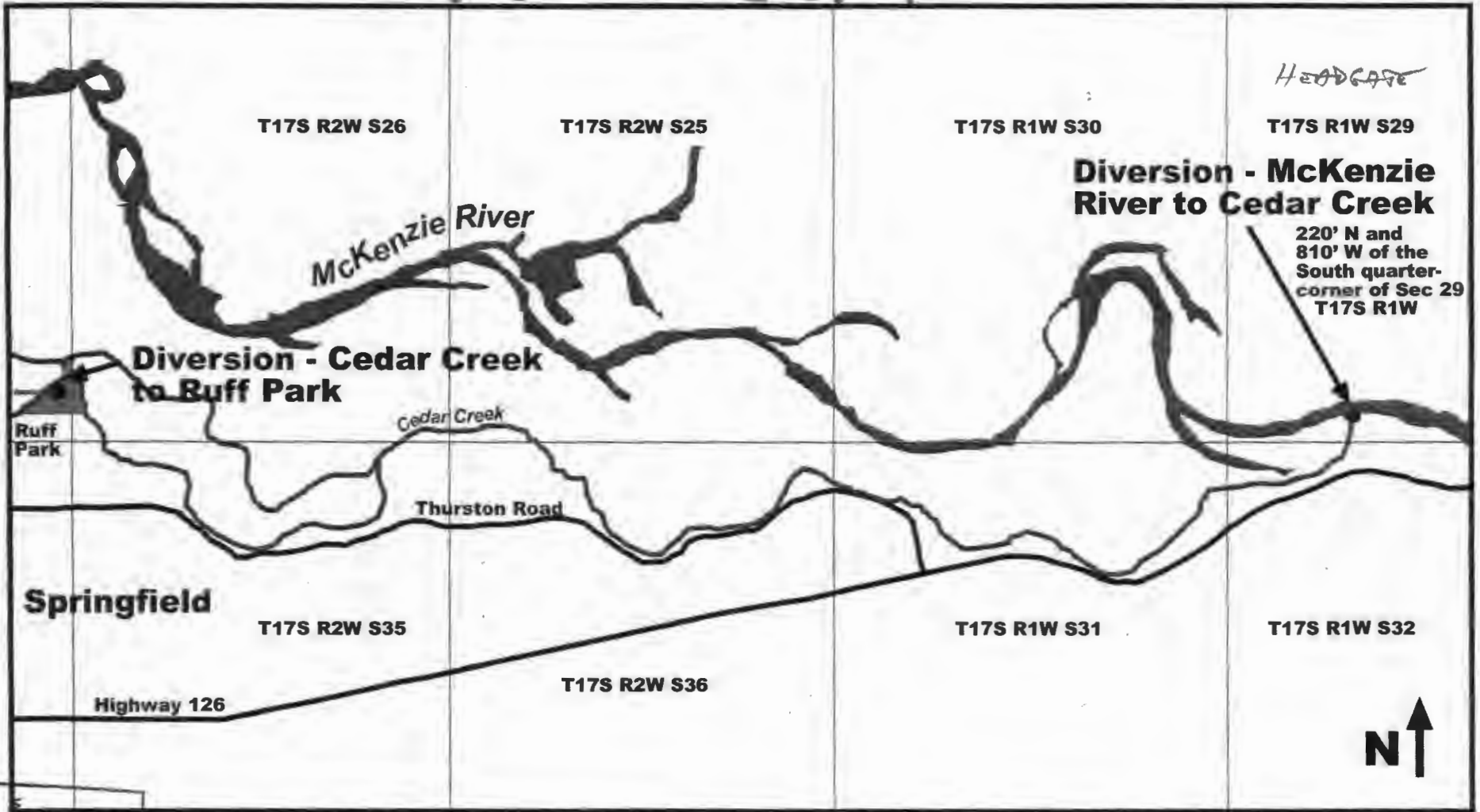

WORK COPY



RECEIVED  
NOV 23 2005  
WATER RESOURCES DEPT  
SALEM, OREGON

app no S-86488

# Well and Water Use Location Wallace M. Ruff Jr. Memorial Park

-  Ruff Park Boundary
-  Streams
-  Section Line
-  Well Location
-  Areas of Water Use

200 0 200 400 600 800 1000 Feet

SCALE: 1"=200'

November 2005

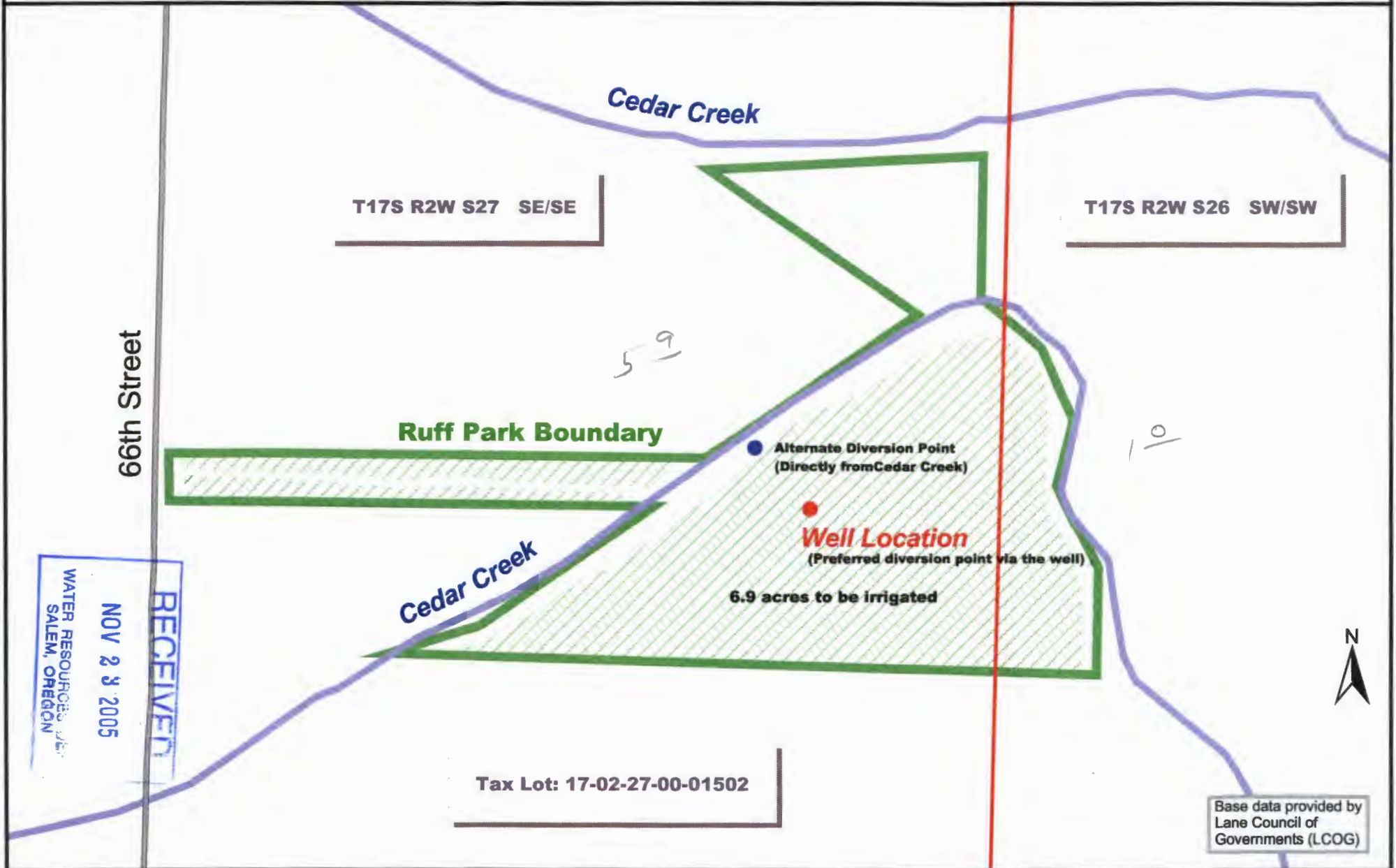

Base data provided by Lane Council of Governments (LCOG)

app no 5-86488



**Willamalane**  
Park & Recreation District  
Administration Center  
200 South Mill Street  
Springfield, OR 97477-7303



OREGON WATER RESOURCES DEPARTMENT  
725 SUMMER STREET NE, SUITE A  
SALEM OR (&301-1271

97301X1266 C007





# Oregon Water Resources Department

## FORM I FOR IRRIGATION WATER USE

1. Please indicate whether you are requesting a primary or supplemental irrigation water right.

Primary     Supplemental

If supplemental, please indicate the number of acres that will be irrigated for each type of use.

Primary:            n/a            Acres            5.7

Secondary:        n/a            Acres

List the permit or certificate number of the primary water right:            No. n/a

2. Please list the anticipated crops you will grow and whether you will be irrigating them for a full or partial season:

- |                              |                                      |                                                                                           |
|------------------------------|--------------------------------------|-------------------------------------------------------------------------------------------|
| 1. <u>Magnolia arboretum</u> | <input type="checkbox"/> Full season | <input checked="" type="checkbox"/> Partial season (from: <u>Mar 1</u> to <u>Oct 31</u> ) |
| 2. _____                     | <input type="checkbox"/> Full season | <input type="checkbox"/> Partial season (from: _____ to _____)                            |
| 3. _____                     | <input type="checkbox"/> Full season | <input type="checkbox"/> Partial season (from: _____ to _____)                            |
| 4. _____                     | <input type="checkbox"/> Full season | <input type="checkbox"/> Partial season (from: _____ to _____)                            |

3. Indicate the maximum total number of acre-feet you expect to use in an irrigation season:

17.25            acre-feet

*(1 acre-foot equals 12 inches of water spread over 1 acre, or 43,560 cubic feet, or 325,851 gallons.)*

4. How will you schedule your applications of water? Will you be applying water in the evenings, twice a week, daily?

- |                                                                   |                                                                                |
|-------------------------------------------------------------------|--------------------------------------------------------------------------------|
| <input type="checkbox"/> Daily during daytime hours               | <input type="checkbox"/> Daily during nighttime hours                          |
| <input type="checkbox"/> Two or three times weekly during daytime | <input checked="" type="checkbox"/> Two or three times weekly during nighttime |
| <input type="checkbox"/> Weekly, during daytime hours             | <input type="checkbox"/> Weekly, during nighttime hours                        |
| <input type="checkbox"/> Other, explain: _____                    |                                                                                |

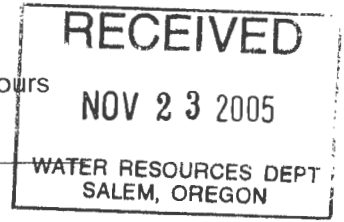

Last revision: October 31, 1996

S-26488

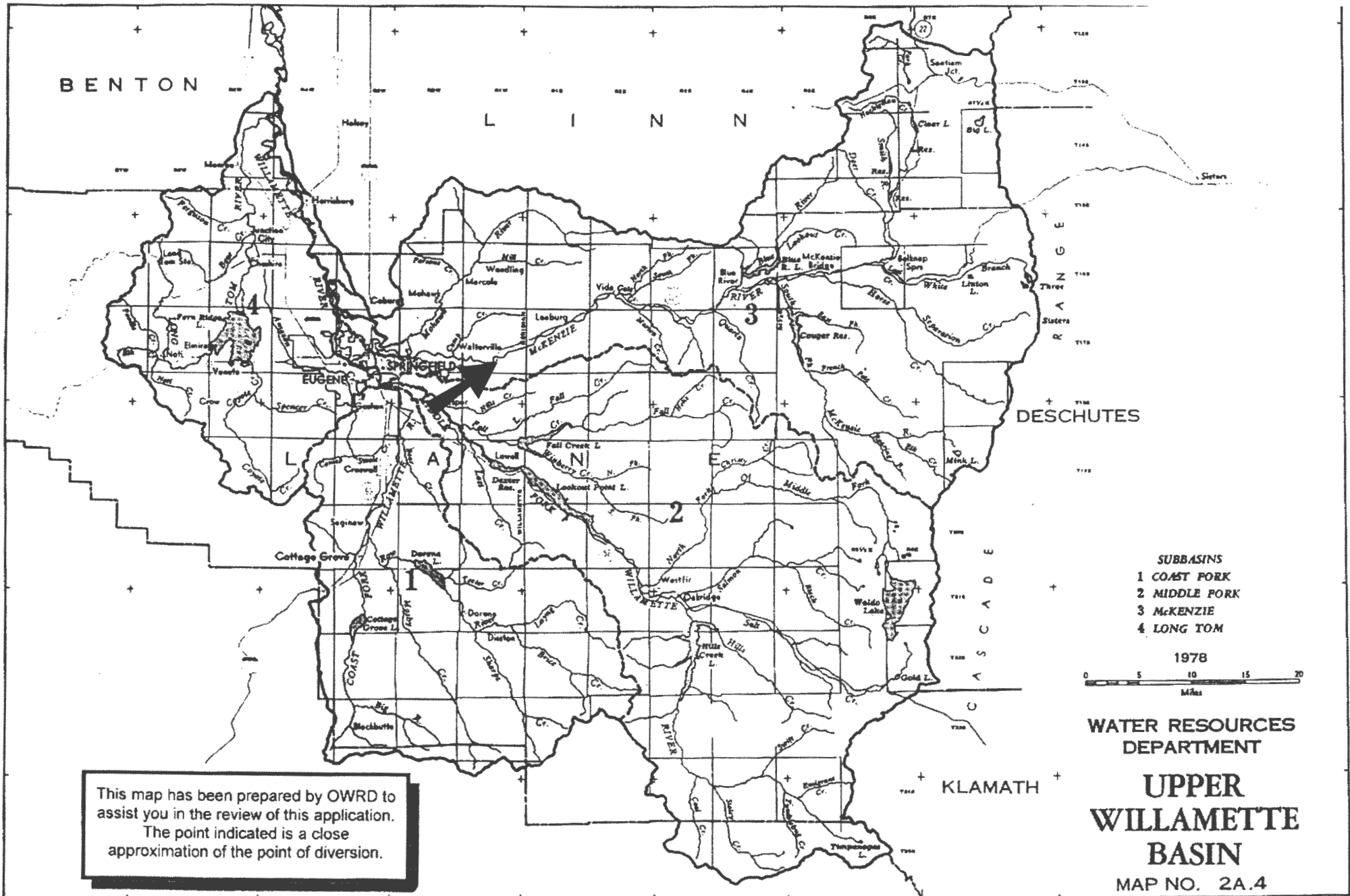

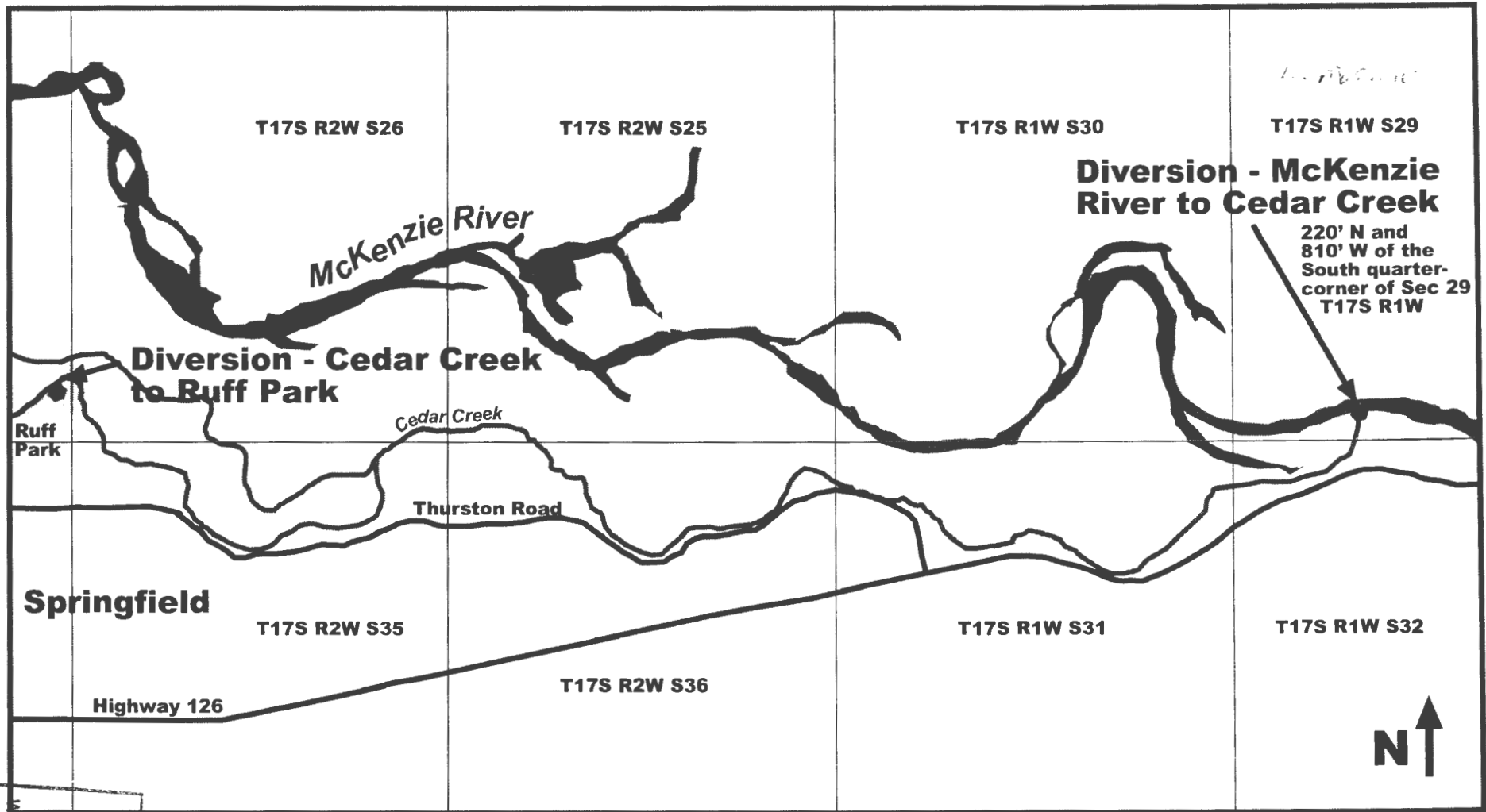

*As Shown*

T17S R2W S26

T17S R2W S25

T17S R1W S30

T17S R1W S29

*McKenzie River*

**Diversion - Cedar Creek to Ruff Park**

**Diversion - McKenzie River to Cedar Creek**

220' N and 810' W of the South quarter-corner of Sec 29 T17S R1W

Ruff Park

*Cedar Creek*

Thurston Road

Springfield

T17S R2W S35

T17S R1W S31

T17S R1W S32

Highway 126

T17S R2W S36



RECEIVED  
 NOV 23 2005  
 WATER RESOURCES DEPT  
 SALEM, OREGON

appno 5-86488



# Mailing List for IR Copies

Application #S-86488

IR Date: December 16, 2005

## Original mailed to:

Applicant: ~~WILLAMALANE PARK AND RECREATION DISTRICT~~, ATTN: PAT FRENCH, 200 S MILL ST, SPRINGFIELD, OR 97477

## Copies sent to:

- 1. WRD - File # S-86488
- 2. WRD - Water Availability: Ken Stahr

## IR, Map, and Fact Sheet Copies sent to:

- 3. WRD - Watermaster # 2 + Div 33 Form
- 4. WRD - Regional Manager: NWR
- 5. ODFW District Biologist: Jeff Ziller + Div 33 Form
- 6. DEQ - John Blanchard + Div 33 Form

|                     |
|---------------------|
| Copies Mailed       |
| By: <u>JCB</u>      |
| (SUPPORT STAFF)     |
| on: <u>12/16/05</u> |
| (DATE)              |

## Copies sent to Other Interested Persons (*CWRE, Agent, Well Driller, Commenter, etc.*)

- 7. \_\_\_\_\_
- 8. \_\_\_\_\_

Caseworker: Jerry Gainey

COPYSH.T.IR

**REMINDER:** Copy *all* IR's for uses in the geographic Umatilla Basin to Confederated Tribes of the Umatilla Indian Reservation, PO Box 638, 73239 Confederated Way, Pendleton, OR 97801.

**REMINDER:** Copy *all* IR's for uses in the Klamath Basin to DEQ and ODFW contacts, regardless of whether they are subject to Division 33. (If they are not subject to Division 33, do not include Division 33 forms.)



# Oregon

Theodore R. Kulongoski, Governor

**Water Resources Department**  
North Mall Office Building  
725 Summer Street NE, Suite A  
Salem, OR 97301-1271  
503-986-0900  
FAX 503-986-0904

December 16, 2005

WILLAMALANE PARK AND RECREATION DISTRICT  
ATTN: PAT FRENCH  
200 S MILL ST  
SPRINGFIELD, OR 97477

Reference: File S-86488

Dear Mr. French:

**THIS IS NOT A PERMIT AND IS  
SUBJECT TO CHANGE AT THE NEXT PHASE OF PROCESSING.**

This letter is to inform you of the preliminary analysis of your water use permit application and to describe your options. In determining whether a water use permit application may be approved, the Department must consider the factors listed below, all of which must be favorable to the proposed use if it is to be allowed. Based on the information you have supplied, the Water Resources Department has made the following preliminary determinations:

Initial Review Determinations:

1. The proposed use is not prohibited by law or rule except where otherwise noted below.
2. The use of water from the Willamette Basin Projects (McKenzie River: Blue River and Cougar), tributaries of Columbia River for irrigation use is allowable under the Willamette Basin Program.
3. Water in the amount of 17.25 acre feet from Willamette Basin Projects (McKenzie River: Blue River and Cougar), is determined to be **available** for further appropriation from water legally stored under Permit R-5363, Certificate 72756.

Summary of Initial Determinations

**The use of 17.25 acre feet from Willamette Basin Projects, tributaries of Columbia River for irrigation use on 6.9 acres is allowable during the full period requested, contingent upon the submission of a valid contract between you and the Bureau of Reclamation.**

Because of these favorable determinations, the Department can now move your application to the next phase of the water rights application review process. This phase is where public interest factors will be evaluated.

Prior to the issuance of a permit, the Department must receive a copy of the following items:

- An approved Special Use Permit as required by the Lane County Planning Department as reflected on the land form submitted with the application.
- A valid contract between you and the Bureau of Reclamation to appropriate stored water from Willamette Basin Projects (McKenzie River; Blue River and Cougar).

Please reference the application number when sending any correspondence regarding the conclusions of this initial review. Comments received within the comment period will be evaluated at the next phase of the process.

To Proceed With Your Application:

If you choose to proceed with your application, you do not have to notify the Department. Your application will automatically be placed on the Department's Public Notice to allow others the opportunity to comment. After the comment period the Department will complete a public interest review and issue a proposed final order.

Withdrawal Refunds:

If you choose not to proceed, you may withdraw your application and receive a refund (minus a \$50 processing charge per application.) To accomplish this you must notify the Department in writing by **Friday, December 30, 2005**. For your convenience you may use the enclosed "STOP PROCESSING" form.

If A Permit Is Issued It Will Likely Include The Following Conditions:

1. Measurement, recording and reporting conditions:
  - A. Before water use may begin under this permit, the water user shall install a totalizing flow meter at the diversion point as approved by the Director. The totalizing flow meter must be installed and maintained as identified in OAR 690-507-645. The water user shall maintain the meter in good working order.
  - B. The water user shall allow the watermaster access to the meter; provided however, where the meter is located within a private structure, the watermaster shall request access upon reasonable notice.

- C. The Director may require the water user to keep and maintain a record of the amount (volume) of water used and may require the water user to report water use on a periodic schedule as established by the Director. In addition, the Director may require the water user to report general water use information the periods of water use and the place and nature of use of water under the permit. The Director may provide an opportunity for the water user to submit alternative reporting procedures for review and approval.
2. You may be required to install fish screens at the point of diversion to meet Oregon Department of Fish and Wildlife specifications for adequate protection of aquatic life.

The water source identified in your application may be affected by an Agricultural Water Quality Management Area Plan. These plans are developed by the Oregon Department of Agriculture (ODA) with the cooperation of local landowners and other interested stakeholders, and help to ensure that current and new appropriations of water are done in a way that does not adversely harm the environment. You are encouraged to explore ODA's Water Quality Program web site at [http://www.oregon.gov/ODA/NRD/water\\_agplans.shtml](http://www.oregon.gov/ODA/NRD/water_agplans.shtml) to learn more about the plans and how they may affect your proposed water use.

If you have any questions:

Questions about the status of your application, processing timelines, or your upcoming Proposed Final Order should be directed to our customer service staff at 503-986-0801. Feel free to call me at if you have any questions regarding the contents of this letter. Please have your application number available if you call. Address all other correspondence to: Water Rights & Adjudication Division, Oregon Water Resources Department, 725 Summer St NE Ste A, Salem OR 97301-1266, Fax: 503-986-0901.

Sincerely,

  
Jerry Gainey

Water Right Application Caseworker

enclosures: Application Process Description and Stop Processing Request Form

S-86488  
WAB 2-528  
POU 2-528  
GW

# APPLICATION FACT SHEET

Mail to: *Applicant, Watermaster, District Biologist (ODFW)*  
If necessary, also mail to : *Regional Water quality manager (DEQ), and DOA*

Application File Number: S-86488

Applicant: WILLAMALANE PARK AND RECREATION DISTRICT

County: Lane

Watermaster: 2

Priority Date: November 23, 2005

Source: WILLAMETTE BASIN PROJECTS, TRIBUTARY OF COLUMBIA RIVER

Use: IRRIGATION USE ON 6.9 ACRES

Quantity: 17.25 ACRE FEET

Basin Name & Number: Willamette, #2

Stream Index Reference: Volume 2 MCKENZIE R

Points of Diversion (POD) Location:

POD 1 (MCKENZIE RIVER): SESW, SECTION 29, T17S, R1W, W.M.; 220 FEET  
NORTH & 810 FEET WEST FROM S1/4 CORNER, SECTION 29

POD 2 (CEDAR CREEK): SESE, SECTION 27, T17S, R2W, W.M.; 869 FEET NORTH  
& 365 FEET WEST FROM SE CORNER, SECTION 27

Place of Use:

SW  $\frac{1}{4}$  SW  $\frac{1}{4}$  1.0 ACRE  
SECTION 26

SE  $\frac{1}{4}$  SE  $\frac{1}{4}$  5.9 ACRES  
SECTION 27

TOWNSHIP 17 SOUTH, RANGE 2 WEST, W.M.

14 DAY STOP PROCESSING DEADLINE DATE: Friday, December 30, 2005

PUBLIC NOTICE DATE: Tuesday, December 20, 2005

30 DAY COMMENT DEADLINE DATE: Thursday, January 19, 2006

# Well and Water Use Location Wallace M. Ruff Jr. Memorial Park

**Ruff Park Boundary**  
**Streams**  
**Section Line**  
**Well Location**  
**Areas of Water Use**



SCALE: 1"=200'

November 2005

**WORK COPY**

**Application #86488**

**Cedar Creek**

**T17S R2W S27 SE/SE**

**T17S R2W S26 SW/SW**

**66th Street**

**Ruff Park Boundary**

**350' N & 365' W of SE Corner Sec 27, T17S R2W**

● **Alternate Diversion Point**  
(Directly from Cedar Creek)

● **754' N & 285' W of SE Corner Sec 27, T17S R2W**

**Well Location**  
(Preferred diversion point to the well)

**6.9 acres to be irrigated**

**Cedar Creek**

**Tax Lot: 17-02-27-00-01502**



Base data provided by  
Lane Council of  
Governments (LCOG)

S-86488

# Well and Water Use Location Wallace M. Ruff Jr. Memorial Park



200 0 200 400 600 800 1000 Feet

SCALE: 1"=200'

November 2005

WORK COPY

T17S R2W S27 SE/SE

T17S R2W S26 SW/SW

66th Street

Ruff Park Boundary

Alternate Diversion Point  
(Directly from Cedar Creek)

Well Location  
(Preferred diversion point via the well)

6.9 acres to be irrigated

Cedar Creek

RECEIVED  
NOV 23 2005  
WATER RESOURCES DEPT.  
SALEM, OREGON

Tax Lot: 17-02-27-00-01502

Base data provided by  
Lane Council of  
Governments (LCOG)

appno S-86488



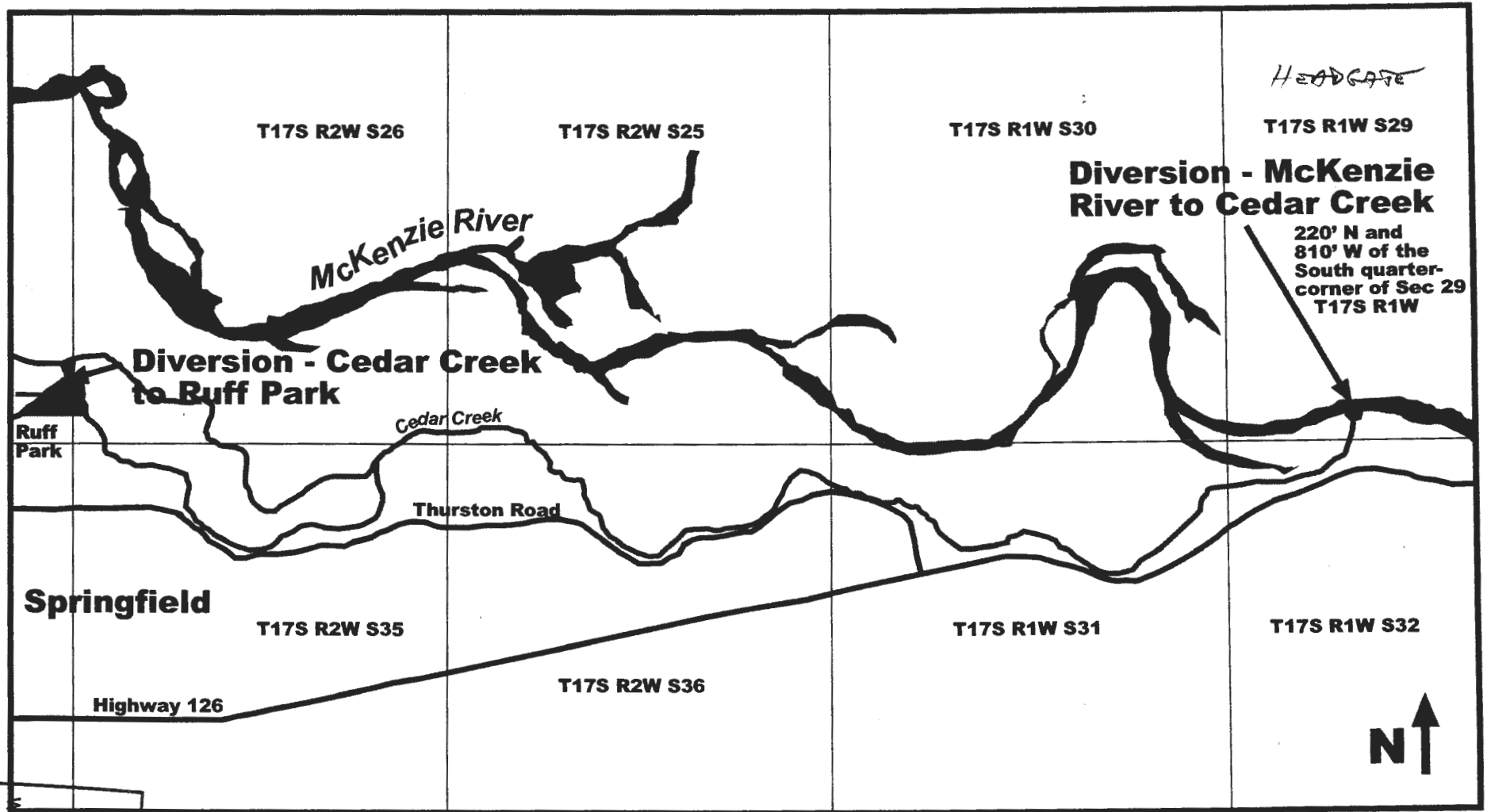

RECEIVED  
 NOV 23 2005  
 WATER RESOURCES DEPT  
 SALEM, OREGON

appno S-86488



# WATERMASTER DIVISION 33 APPLICATION WORK SHEET

Recommendations for Water Right Applications that may affect the Habitat of Sensitive, Threatened or Endangered Fish Species,  
OAR 690-33-310 through 340.

**RECEIVED**

Date: 12/16/2005 Please return to WRD before **January 19, 2006**. Application #: S-86488

DEC 29 2005

Applicant's Name: WILLAMALANE PARK AND RECREATION DISTRICT PAT FRENCH

WATER RESOURCES DEPT  
SALEM, OREGON

SOURCE OF WATER:  GROUNDWATER  SURFACE WATER  STORAGE

DESCRIPTION OF THE SOURCE: COE/BCR project water via Mckonzie R →  
(A spring, well, sump, exempt pond, unnamed stream, etc.) Cedar Cr → a well

1) If from surface water, does the water at the proposed diversion location flow above ground in a defined channel into another water body?

YES  NO  SOMETIMES

If sometimes, describe the time period, Between: \_\_\_\_\_ and \_\_\_\_\_.

2) Does the source ever go dry in the area of the proposed diversion?

YES  NO

3) To your knowledge, has the requested source of water been regulated because of insufficient flow to satisfy existing water rights including instream water rights?

YES  NO

If YES, please explain: Though I have spent considerable time  
in Cedar Creek learning about the water rights

4) Do you agree with the water availability recommended period of use?

YES  NO  I DON'T KNOW

If NO, why do you disagree with the recommended period of use and what period do you recommend? \_\_\_\_\_

5) Did you meet with staff from another agency to discuss this application?

YES  NO

Who: \_\_\_\_\_ Agency: \_\_\_\_\_ Date: \_\_\_\_\_

6) Is mitigation an option?

YES  NO

If YES, please explain: If necessary for something -

Comments: Well 47' deep about 140' from Creek in Alluvium.  
Applicant would prefer to pump SW from hydraulically connected  
well - if possible - I am OK with it if GW is  
Also, we MUST ensure water enters Cedar Cr. in first place





Watermaster Signature: Michael J. Mathick Date: 12-10-05

WRD Contact: Caseworker: Jerry Gainey, Water Rights Division  
503-986-0812/ Fax: 503-986-0901 / e-mail: Jerry.W.GAINEY@wrdd.state.or.us

Owight explained why we could not do this once - but it is what they want to do so we should address it directly.

Notice Cedar Creek  
Irrigation Association  
See LL 814  
@ 1200 Wesport Rd.  
Springfield OR  
97478-9691

# Well and Water Use Location Wallace M. Ruff Jr. Memorial Park

-  Ruff Park Boundary
-  Streams
-  Section Line
-  Well Location
-  Areas of Water Use

200 0 200 400 600 800 1000 Feet

SCALE: 1"=200'

November 2005

*WORK COPY*

Application #86488

T17S R2W S27 SE/SE

T17S R2W S26 SW/SW

66th Street

Ruff Park Boundary

368' N & 365' W of SE Corner Sec 27, T17S R2W

● Alternate Diversion Point  
(Directly from Cedar Creek)

● 784' N & 288' W of SE Corner Sec 27, T17S R2W

**Well Location**  
(Preferred diversion point via the well)

6.9 acres to be irrigated

Cedar Creek

Tax Lot: 17-02-27-00-01502



Base data provided by  
Lane Council of  
Governments (LCOG)

S-86488

No. 3167 P. 2

Nov. 23. 2005 6:46PM

# Standard Application "Completeness" Checklist

Minimum Requirements (OAR 690-310-040)

|                          |                         |
|--------------------------|-------------------------|
| Application <u>86488</u> | County: <u>LANE</u>     |
| Priority Date: _____     | Township: <u>17 S</u>   |
| Use(s): <u>IRRIG</u>     | Range: <u>2 W</u>       |
| Rate: <u>17.25 A-F</u>   | Section: _____          |
|                          | POD ¼¼: <u>SEE MAPS</u> |
|                          | POU ¼¼: <u>SEE MAP</u>  |

Applicant/Organization Name, Mailing Address and Telephone Number. If applicant is other than a private landowner, Organizations section must be completed.

Source listed

Property ownership indicated? If applicant does not own all the land, is the affected landowner's name and mailing address listed? (Including: Lands, not owned by applicant, upon which the source is located .....or..... any Lands, not owned by applicant, which are crossed by the diversion works.) **NOTE: An easement or agreement DOES NOT need to be submitted at this time, however a statement declaring the existence of written authorization or an easement permitting access to land crossed by the proposed ditch canal or other work is required at this time. Easement or agreement will be required before a permit will be issued.**

~~If a groundwater application...is the groundwater development section completed, including copies of well logs?~~

Proposed Use of the water.... Is each proposed use identified?

Has the appropriate "Supplemental Form" for each proposed use been completed, if applicable?

- Form I (Irrigation)
- Form M (Municipal or Quasi-Municipal)
- Form R (Mining)
- Form Q (Commercial or Industrial)
- Spring Description Sheet (If source is a Spring)

Amount of water from each source listed in GPM, CFS or AF?

Acreage being proposed, if applicable.

- Season being requested by applicant.
- Water management section has been completed? If system has not been designed, the applicant may estimate this information.
- Resource protection system completed on Surface Water application?
- Are the dates of construction indicated? Proposed dates for the Beginning of construction, completion of construction, and complete application of water to the proposed use(s) If system already completed, applicant should indicate existing. Applicant may indicate in other than dates, these timelines.
- Is the application signed in ink by the applicant? If the application is in the name of an organization or corporation, the authorized agent with title or authority, must sign the application. If more than one applicant named, both/all must sign or application is incomplete.
- Legal description included? A copy of the deed, land sales contract or title insurance policy can provide this information. We cannot accept a copy of the tax bill.

A completed Land-Use Form or receipt signed by the appropriate planning department officials enclosed? Does the use on land-use form match the proposed use on the application? Date should be within 6 months.

11-23-2005

Does the map meet map requirements of OAR 690-310-050?

ON OH WITH MS. PAT FRENCH  
 RET MAP - SHE WILL FAX  
 MORE DETAILS - APPROVED MAP  
 NEW DESIGN FOR APLIC PURPOSES.  
 JOINT PROJECT  
 WITH WM MIKE  
 MATTICK  
 NJM

- Town, Range, Sec, 1/4 1/4 and Tax Lot #
- Reference corner on map
- 1/4 1/4's clearly identified (2)
- POU clearly identified location of place of use where water is to be used. ie: domestic, industrial stock, irr, etc.
- Scale of the Map, not less than 4" = 1 mile
- North Directional Symbol (not fatal if omitted)
- Location of each diversion point, well or dam
- Location Coordinates for each POD by reference to a recognized public land survey corner
- Number of acres per 1/4 1/4, if Irrigation

Other fees enclosed? YES

Total Paid \$ 308

Base Fee \$ 150  
 plus \$ 150  
 plus \$ 8

STORED ONLY  
 10 AF x 15  
 (A) x 7.25 = (8) MORE

Total Amount of Water Requested: 17.25

Rounds 18 AF AF Total Exam Fee \$ 308

Total Exam Fee \$ 308 Recording Fee \$ ~~XXXXXX~~

Completeness Check by: NJM Date: 11-23-2005

Beginning at the Southwest corner of the John Kizer Donation Land Claim No. 52, in Township 17 South, Range 2 West of the Willamette Meridian, in Lane County, Oregon; run thence South 88° 19' 05" East, along the South line of said John Kizer Donation Land Claim No. 52, a distance of 349.30 feet, to the True Point of Beginning; thence continuing along said South line of Donation Land Claim No. 52, and the North line of the William Miller Donation Land Claim 48, South 88° 19' 05" East, a distance of 1088.56 feet to a point in the center of a slough, said point being referenced by a 5/8 inch iron rod that bears North 88° 19' 05" West 60.98 feet; thence Northerly along the center of said slough, North 2° 40' 55" East, 156.42 feet; thence North 31° 49' 05" West, 147.84 feet; thence North 18° 10' 55" East 110.22 feet; thence North 23° 34' 05" West, 125.40 feet; thence North 51° 49' 05" West, 126.06 feet; thence leaving the center of said slough and run North 00° 51' 50" East, 57.18 feet to a point marked by 5/8 inch iron rod; thence continuing North 00° 51' 50" East, 104.80 feet to a point marked by a 5/8 inch iron rod; thence continuing North 00° 51' 50" East, 30.42 feet to a point in the center of a slough; thence run downstream along the center of said slough, South 86° 24' 20" West, 391.73; thence leaving said slough and run South 52° 10' East, 359.95 feet to a point marked by a 5/8 inch iron rod; said point being in the center of another slough; thence run South 57° 31' 47" West, 329.06 feet; thence South 47° 40' 32" West, 59.26 feet; thence North 88° 19' 05" West, 819.43 feet to a point on the West line of the John Kizer Donation Land Claim No. 52, that bears North 1° 26' 50" East, 292.0 feet from the Southwest corner thereof; thence run South 1° 26' 50" West along said Claim line, 60.0 feet; thence leaving said claim line, and run South 88° 19' 05" East parallel with the South line of said John Kizer Donation Land Claim No. 52, a distance of 756.72 feet to a point in the center of a slough, said point being marked by a 5/8 inch iron rod; thence South 57° 28' 13" West along the center of said slough, 297.21 feet; thence South 69° 41' 14" West, 173.30 feet along said slough to the True Point of Beginning, in Lane County, Oregon. Bearings used herein are based upon the Oregon Co-ordinate System, South Zone, in Lane County, Oregon.

RECEIVED  
NOV 23 2005  
WATER RESOURCES DEPT  
SALEM, OREGON

EXHIBIT   a    
PAGE   1   OF   1

BARGAIN AND SALE DEED

\*\*\*\*\*

Recording Information Required by ORS 205.234

- 1. Name of Transaction: Bargain and Sale Deed
- 2. Name of Parties: Seller: Wallace M. Ruff and Peggy Rice, Trustees of the Wallace M. Ruff Trust  
Buyer: Willamalane Park and Recreation District, an Oregon Park and Recreation District organized under ORS Chapter 266
- 3. Person to Whom Documents to be Returned: Evergreen Land Title Co.  
P.O. Box 931  
Springfield, OR 97477
- 4. True and Actual Consideration: -0- (Donation)
- 5. Please Send Tax Statements to: Willamalane Park and Recreation District  
157 North 4th Street  
Springfield, OR 97477  
Tax Acct. No. \_\_\_\_\_
- 6. Information Required by ORS 205.125: N/A

KNOW ALL MEN BY THESE PRESENTS, that WALLACE M. RUFF and PEGGY RICE, Trustees of the Wallace M. Ruff Trust, hereinafter called Grantor, for the consideration hereinafter stated, does hereby grant, bargain, sell and convey unto WILLAMALANE PARK AND RECREATION DISTRICT, an Oregon Park and Recreation District organized under ORS Chapter 266, hereinafter called Grantee, and unto Grantee's heirs, successors and assigns all of that certain real property with the tenements, hereditaments and appurtenances thereunto belonging or in anywise appertaining, situated in the County of Lane, State of Oregon, described as follows, to-wit:

See Exhibit "A" attached hereto and incorporated by reference as though fully set forth herein.

subject to the following conditions and restrictions:

A. That Willamalane will not sell or transfer the property except to a successor in interest with powers substantially similar to an Oregon Park and Recreation District chartered under ORS Chapter 266 or to a foundation or charitable organization, including, but not limited to the Jack B. Lively Foundation, where the purpose of such organization includes the furtherance of parks and open space in Springfield, Oregon;

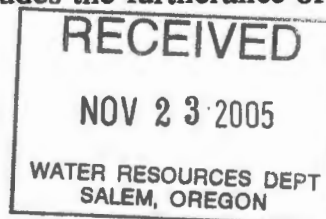

EXHIBIT C  
PAGE 1 OF 2



**For Local Government Use Only**

The following section must be completed by a planning official from each county and city listed unless the project will be located entirely within the city limits. In this case, only the city planning agency must complete this form. Please request additional forms as needed or feel free to copy.

**A. Allowed Use**

Check the appropriate box below and provide requested information.

- Land uses to be served by proposed water uses (including proposed construction) are allowed outright or are not regulated by your comprehensive plan. Cite applicable ordinance section(s): \_\_\_\_\_ Go to section B "Approval" below.
- Land uses to be served by proposed water uses (including proposed construction) involve discretionary land use approvals as listed in the table below.

| Type of Land Use Approval Needed (e.g. plan amendments, rezones, conditional use permits, etc.) | Cite Most Significant, Applicable Plan Policies & Ordinance Section References | Check the item that applies: Land Use Approval:                      |                                                                                                 |
|-------------------------------------------------------------------------------------------------|--------------------------------------------------------------------------------|----------------------------------------------------------------------|-------------------------------------------------------------------------------------------------|
| SPECIAL USE PERMIT                                                                              | LC16.212(4)(J)                                                                 | <input type="checkbox"/> Obtained<br><input type="checkbox"/> Denied | <input checked="" type="checkbox"/> Being pursued<br><input type="checkbox"/> Not being pursued |
|                                                                                                 |                                                                                | <input type="checkbox"/> Obtained<br><input type="checkbox"/> Denied | <input type="checkbox"/> Being pursued<br><input type="checkbox"/> Not being pursued            |
|                                                                                                 |                                                                                | <input type="checkbox"/> Obtained<br><input type="checkbox"/> Denied | <input type="checkbox"/> Being pursued<br><input type="checkbox"/> Not being pursued            |
|                                                                                                 |                                                                                | <input type="checkbox"/> Obtained<br><input type="checkbox"/> Denied | <input type="checkbox"/> Being pursued<br><input type="checkbox"/> Not being pursued            |

**Note:** Please attach documentation of applicable local land use approvals which have already been obtained. (Record of Action/land use decision and accompanying findings are sufficient.)

**B. Approval**

Please provide printed name and written signature.

Name: THOM LANFEAR Date: 11-18-05  
 Title: ASSOCIATE PLANNER Phone: 541-682-4054  
 Signature: Thom Lanfeare

**C. Additional Comments**

Local governments are invited to express special land use concerns or make recommendations to the Department regarding this proposed LC of water below, or on a separate sheet.

---

---

---

---

---

---

---

---

---

---

**Note:** If this form cannot be completed while the applicant waits, sign and detach the receipt stub as instructed below. You will have 30 days from the Water Resources Department's notice date to return the completed Land Use Information Form or WRD may presume the land use associated with the proposed use of water is compatible with local comprehensive plans.

**Receipt for Request for Land Use Information**

Name of applicant: \_\_\_\_\_

This receipt must be signed by a local government representative and returned to the applicant at the time they present this form. This receipt must be included with the application filed with the Water Resources Department if the local government cannot provide the requested land use information while the applicant waits.

City or County: \_\_\_\_\_  
 Staff contact: \_\_\_\_\_ Phone: \_\_\_\_\_  
 Signature: \_\_\_\_\_ Date: \_\_\_\_\_





## Oregon Water Resources Department Land Use Information Form

This information is needed to determine compatibility with local comprehensive plans as required by ORS 197.180. WRD will use this and other information to evaluate the water use application. THIS FORM IS NOT REQUIRED IF: 1) water is to be diverted, conveyed, and/or used only on federal lands; or 2) the application is for a water right transfer, allocation of conserved water, or exchange and all of the following apply: a) only the place of use is proposed for change, b) there are no structural changes, c) the use of water is for irrigation, and d) the use is located in an irrigation district or exclusive farm use zone.

### To Be Completed By Applicant

This section must be completed by the individual or group that is filing an application with the Water Resources Department. Attach a copy of the map from the application to this form.

**A. Applicant**

Name: Willamalane Park & Recreation District  
 Address: 200 S. Mill Street  
 City: Springfield State: OR Zip: 97477 Day Phone: 541-736-4055

**B. Land and Location**

Please provide information as requested below for all tax lots on or through which water will be diverted, conveyed, or used. Check "diverted" if water is diverted (taken) from its source on tax lot, "conveyed" if water is conveyed (transported) on tax lot, and "used" if water will be put to beneficial use on tax lot. More than one box may be checked. (Attach extra sheets as necessary.) Applicants for municipal use, or irrigation uses within irrigation districts, may substitute existing and proposed service area boundaries for the tax lot information requested below.

| Tax Lot I.D.  | Plan Designation (e.g. Rural Residential/RR-5) | Water to be: (check all that apply)          |                                              |                                          | Proposed Land Use |
|---------------|------------------------------------------------|----------------------------------------------|----------------------------------------------|------------------------------------------|-------------------|
| 1702270001502 | Ag - EFU30                                     | <input checked="" type="checkbox"/> Diverted | <input checked="" type="checkbox"/> Conveyed | <input checked="" type="checkbox"/> Used | Public Park       |
|               |                                                | <input type="checkbox"/> Diverted            | <input type="checkbox"/> Conveyed            | <input type="checkbox"/> Used            |                   |
|               |                                                | <input type="checkbox"/> Diverted            | <input type="checkbox"/> Conveyed            | <input type="checkbox"/> Used            |                   |
|               |                                                | <input type="checkbox"/> Diverted            | <input type="checkbox"/> Conveyed            | <input type="checkbox"/> Used            |                   |
|               |                                                | <input type="checkbox"/> Diverted            | <input type="checkbox"/> Conveyed            | <input type="checkbox"/> Used            |                   |
|               |                                                | <input type="checkbox"/> Diverted            | <input type="checkbox"/> Conveyed            | <input type="checkbox"/> Used            |                   |

List counties and cities where water is proposed to be diverted, conveyed, or used. Lane County

**C. Description of Proposed Use**

Indicate the type of application to be filed with the Water Resources Department.  
 Water Use Permit     Water Right Transfer     Allocation of Conserved Water     Exchange

Indicate the intended use of water and describe the key characteristics of the project.  
 Commercial     Industrial     Instream     Irrigation  
 Municipal     Quasi-municipal     Domestic (indicate number of households) \_\_\_\_\_  
 Other \_\_\_\_\_

Briefly describe: Irrigation of magnolias and related landscaping

Indicate the source of the water to be used.  
 Reservoir/Pond     Ground Water     Surface Water    Willamette Basin Project Water  
(source)

Indicate the estimated quantity of water the use will require: 17.25  CFS     GPM     Acre-Feet

Last revised: 04/06/04

**Receipt for Request for Land Use Information**

State of Oregon  
 Water Resources Department  
 725 Summer Street NE, Suite A  
 Salem, OR 97301-1271  
 (503) 986-0900

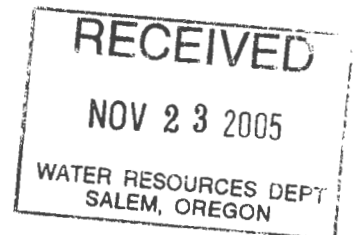



**Willamalane**

Park & Recreation District

Administration Center  
200 South Mill Street  
Springfield, OR 97477-7303

S-26488



WATER RESOURCES DEPARTMENT  
ATTN: JERRY GAINES  
725 SUMMER ST NE SUITE A  
SALEM OR 97301-1266

97301+1266

