



Form B

Application No. 23069

**NOTICE OF COMPLETION OF CONSTRUCTION**

I, Jess T. Iler, the holder of Permit No. 18205 to appropriate the public waters of the state of Oregon, completed the construction of the works described therein on the 10 day of June, 19 45

Remarks: \_\_\_\_\_  
If the works have less capacity than described in the permit, or you have definitely abandoned part of the proposed development, you should so state in order that our records may not be unnecessarily encumbered.

IN WITNESS WHEREOF, I have hereunto set my hand this 3 day of August, 19 45  
Jess T. Iler (Signature of Applicant) Canyon City Oregon (Address)

Fill out, detach, and mail to the State Engineer, Salem, Oregon, when construction work is completed.

Form C

**IMPORTANT**—This form is a notice to the State Engineer that permittee is ready to make final proof to the extent to which the water has actually been applied to the intended use under the terms of the permit. Permittee is cautioned that Certificate of Water Right will be issued based on the extent of the quantity and use as determined by the final proof inspection and survey which will be made in response to the filing of this Form C.

NOTE: In the case of an irrigation permit, this Form C should not be mailed to the State Engineer until all of the land described in the permit, which it is intended to irrigate under this permit at any time, has actually been irrigated.  
Fill out, detach, and mail to the State Engineer, Salem, Oregon, when all of the water has been applied.

Application No. 23069

**NOTICE OF COMPLETE APPLICATION OF WATER TO A BENEFICIAL USE**

I, Jess T. Iler, the holder of Permit No. 18205 to appropriate the public waters of the state of Oregon, completely applied the waters to a beneficial use in accordance with the terms of said permit, on the 10th day of June, 19 45

Remarks: \_\_\_\_\_

IN WITNESS WHEREOF, I have hereunto set my hand this 3 day of August, 19 45  
Jess T. Iler (Signature of Applicant) Canyon City Oregon (Address)

# T.14S. R.31E. W.M.

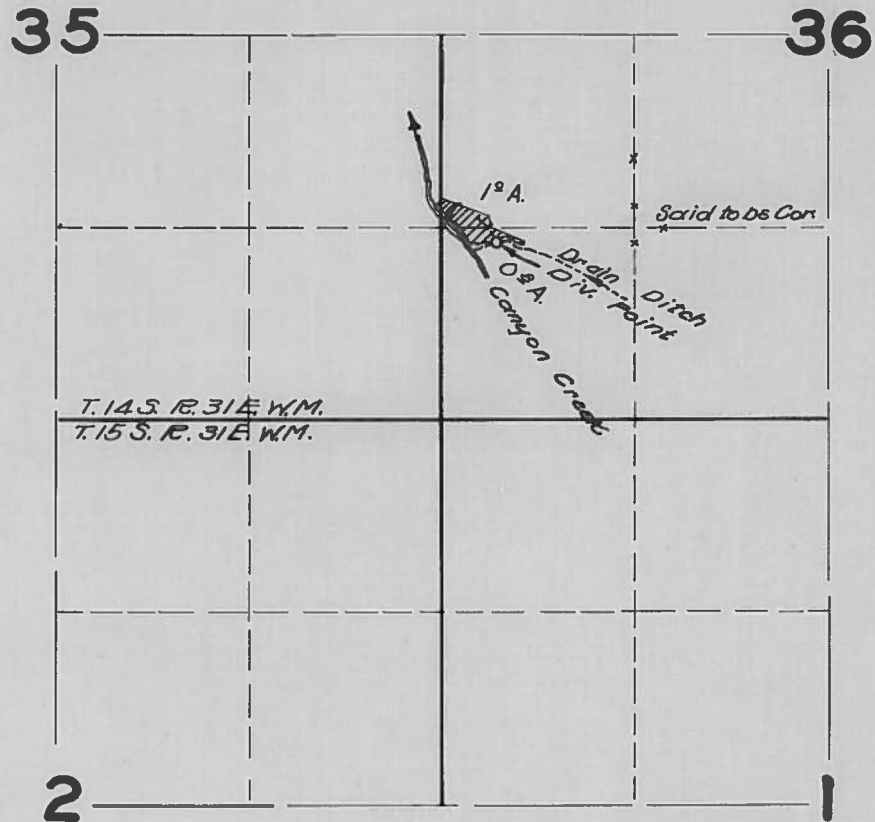

## FINAL PROOF SURVEY UNDER

Application No. **23069** Permit No. **18205**  
IN NAME OF

.....**JESS T. ILER**.....

Surveyed **OCT. 20 1949**, by **H.L. COFFMAN**

Application No. 23069

County GRANT

### Proof of Appropriation of Water

1. Name Jess T. Iler 2. Address Canyon City, Oregon

3. Source of supply Canyon Creek

Tributary of John Day

4. Amount of water 0.045 c.f.s. 5. Priority date March 8, 1948

6. Use Irrigation

7. Location of point of diversion, S.W. 1/4 SW 1/4 Sec. 36, Twp. 14 S., Range 31 E., W. M. (Legal Subdivision)

8. The description of land given below corresponds to that found in your permit covering land to be irrigated, or, if for other purposes, the place of use.

Township	Range	Section	Forty-acre Tract	No. Acres Described in Permit	No. Acres Actually Irrigated
14 S.	31 E.	36	NW 1/4 SW 1/4	5	1.0
14 S.	31 E.	36	SW 1/4, SW 1/4	0	0.0
					1.0

This appropriation shall be limited to 1/40th of one cubic foot per second for each acre irrigated prior to June 1st and thereafter 1/80th of one cubic foot per second or its equivalent for each acre irrigated and shall be limited to a diversion of not to exceed 1 acre foot per acre for each acre irrigated during any month prior to June 1st and shall be further limited to a total diversion of not to exceed 4 acre feet per acre for each acre irrigated during the irrigation season from April 1st to September 30th of each year, and shall be subject to such reasonable rotation system as may be ordered by the proper state officer.

Surveyed Oct 30-49

DESCRIPTION OF WORKS

9. (a) If a dam has been constructed, give description: Height, 60 ft.; length on top, 650 ft.; length on bottom, ..... ft.; material used and character of construction, Earth Fill Across Dry Creek Channel, Crest Level with Surrounding ground.

(b) Give description of headgate: Width, ..... ft.; depth, ..... ft.; material used and character of construction, .....

(c) Size of canal: Width on top (at waterline), 10 ft.; width on bottom, 10 ft.; depth of water, ..... ft.; grade, 0.8 ft. fall per 100 ft. Actual capacity, ..... sec.-ft.

Give general description: Ditches convey water to field for flood irrig.

(d) Pipe line: Description of intake, Ditch leading from Div. Dam, water for irrig. is said to be overflow from field south.

Length of pipe, ..... ft.; size at intake, ..... in.; size at ..... ft. from intake, ..... in.; size at place of use, ..... in. Difference in elevation between intake and place of use, ..... ft.

Is grade uniform? ..... Actual capacity of pipe line, ..... sec.-ft.

Give general description: (Material: Steel, wrought, cast iron, wood stave, etc.)

(e) Pumping plant: Give size and type of pump, .....

Suction lift, ..... ft.; discharge lift, ..... ft. Type of motor used .....

Horsepower rating, ..... H. P. Actual capacity of pump, ..... sec.-ft.

10. During what months is water beneficially used? Spring - Summer

11. State character of soil Sandy loam

Kind of crops raised Hay & Pasture

12. Does the accompanying map, filed with your application, show correctly the point of diversion, area of land irrigated, or place of use? No

13. If not, wherein is such map in error? Div. Point does not appear to be in location given on face of Permit

14. Domestic use: Give number of families actually using water at this time .....

15. If for power, mining, municipal, manufacturing, storage or any other purpose than irrigation, give extent and method of such use .....

**AFFIDAVIT OF APPROPRIATOR**

STATE OF OREGON,

County of \_\_\_\_\_ } ss.

I, Jess T. Iler, being first duly sworn, depose and say that I have read the above and foregoing proof of appropriation of water; that I know the contents thereof, and that the facts therein stated are true.

IN WITNESS WHEREOF, I have hereunto set my hand this 12 day of May, 1945

Jess T. Iler

Subscribed and sworn to before me this \_\_\_\_\_ day of \_\_\_\_\_, 194\_\_\_\_\_

Notary Public for Oregon

[Notarial Seal]

My commission expires \_\_\_\_\_

**AFFIDAVIT OF WITNESSES**

STATE OF OREGON,

County of \_\_\_\_\_ } ss.

We, \_\_\_\_\_, and \_\_\_\_\_

of \_\_\_\_\_, being first duly sworn, depose and say that we are well acquainted with the facts and conditions set forth in the foregoing statement relative to proof of appropriation of water under Permit No. \_\_\_\_\_; that we and each of us have been over and upon each tract described in said proof, and from such personal inspection have knowledge that all necessary ditches, dams and other diversion and distributing works have been constructed, and water used as stated therein; that we have carefully read such proof of appropriation, and that each and every statement contained therein is true to the best of our knowledge and belief.

Subscribed and sworn to before me this \_\_\_\_\_ day of \_\_\_\_\_, 194\_\_\_\_\_

Notary Public for Oregon

[Notarial Seal]

My commission expires \_\_\_\_\_

STATE OF OREGON  
STATE ENGINEER  
MAY 12 1945  
RECEIVED

DESCRIPTION OF WORKS

REPORT OF PERSON MAKING INSPECTION

(For use by Representative of State Engineer)

I, H. S. Coffman, do hereby certify that I have made an inspection of the works described herein and in Permit No. 18205, on the 20th day of October, 1949, and found the foregoing statements and descriptions of works to be accurate. In my opinion the appropriation has been completed to the extent of (Quantity of water in second-feet or acre-feet) and I recommend the issuance of water right certificate for this amount.

NOTICE TO INSPECTORS

If conditions do not justify the above report by you, please return the proof without your signature, with a full report by letter.

H. S. Coffman (Name)

Field Eng. (Title)

RECEIVED MAY 15 1950 STATE ENGINEER SALEM, OREGON

- (a) Pipe line: Description of intake, discharge, etc.
Length of pipe, ft.; size at intake, in.
Difference in elevation between intake and discharge, ft.
Actual capacity of pipe line, cfs.
Give general description:
VERIDVAM OF WITNESSES
Pumping plant: Give size and type of pump, horsepower rating, actual capacity of pump.
During what months is water beneficially used?
State character of soil.
Kind of crop raised.
Date of ripening of crop.
In witness whereof, I have hereunto set my hand and seal of office this 20th day of October, 1949.
County of
STATE OF OREGON
If for power, mining, municipal, manufacturing, storage or any other purpose than irrigation, give extent and method of such use.
VERIDVAM OF APPROPRIATOR

# T.14S. R.31E. W.M.

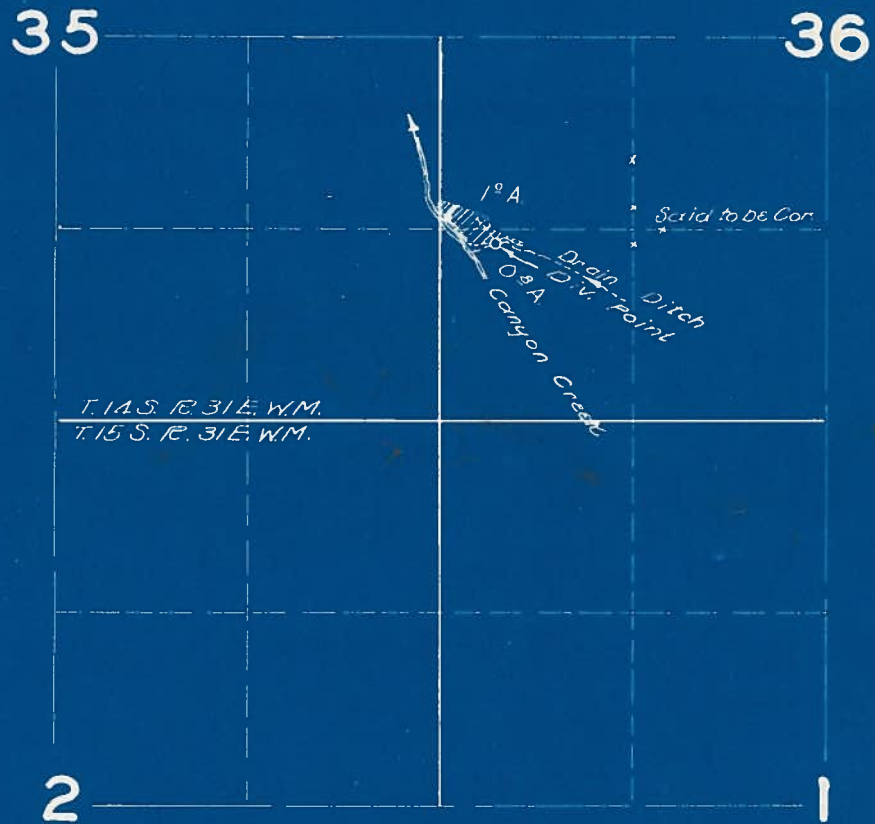

## FINAL PROOF SURVEY UNDER

Application No. **23069** Permit No. **18205**  
IN NAME OF

JESS T. ILER

Surveyed OCT. 20 1949, by H.L. COFFMAN



May 26, 1950

Mr. Jess T. Iler  
Canyon City, Oregon

Dear Mr. Iler:

Your final proof of appropriation of water under Permit No. 18205 has been received in this office and found acceptable. Receipt is also acknowledged of the certificate recording fee of \$1.00, for which Receipt No. 9558 is enclosed.

The matter of final confirmation of your right by issuance of a water right certificate will be given consideration with the next group which will be issued at a later date. When the certificate is issued, it will be mailed to your county clerk for recording and then delivered by him to you.

Very truly yours,



CHAS. E. STRICKLIN  
State Engineer

May 9, 1950

Mr. Jess T. Iler  
Canyon City, Oregon

Dear Mr. Iler:

If you will sign and date the enclosed final proof on its second sheet and return the proof to this office, together with the statutory certificate recording fee of \$1.00, a certificate confirming the right under your Permit No. 18205, granting the right to the use of 0.045 second-foot of water from Canyon Creek, tributary of John Day River, for irrigation of 1.8 acres of land, may be issued.

These figures indicate the extent and limit of your water right as provided by law, and mark the completed right.

In the interest of economy and due to the fact that your completed project was examined by a representative of this office, it is not considered necessary that your signature be made before a notary public, nor that the signatures of witnesses be affixed to the proof.

Very truly yours,



CHAS. E. STRICKLIN  
State Engineer

Enclosure  
Form 114

August 9, 1948

Mr. Jess T. Iler  
Canyon City, Oregon

Dear Mr. Iler:

This will acknowledge receipt of Forms B and C, being notices of the completion of construction and complete application of water under your Permit No. 18205.

Pursuant to your reports and in line with the general practice of this office, a survey will be made at a later date for the purpose of checking the acreage actually irrigated. After this survey, proof may be made by you and certificate issued covering the lands which the survey shows to have been irrigated, and any lands described in your permit that have not been irrigated will be automatically eliminated from your water right.

In the meantime, the permit which you hold will be valid evidence of your water right.

Very truly yours,

CHAS. E. STRICKLIN  
State Engineer

By  
Ed K. Humphrey, Assistant

EKH:mjo

23069

Mr. Jess T. Iler  
Canyon City, Oregon

July 30, 1948

Dear Mr. Iler:

Herewith you will find Application No. 23069, Permit  
No. 18205, together with blueprint.

23069

April 12, 1948

Mr. Jeas T. Iler  
Canyon City, Oregon

Dear Mr. Iler:

This is to notify you that your completed Application No. 23069 for a permit to appropriate water from Canyon Creek for irrigation now appears to be in satisfactory form and is being placed in line for approval and issuance of a permit.

Very truly yours,

CHAS. E. STRICKLIN  
State Engineer

By  
Ed K. Humphrey, Assistant

EKH:mjo

March 12, 1948

Mr. Jess I. Iler  
Canyon City, Oregon

Dear Mr. Iler:

This will acknowledge receipt of your letter of March 5 transmitting your application for a permit to appropriate 0.08 cubic foot of water per second from Canyon Creek for the irrigation of 5 acres, together with an accompanying sketch and fees in the amount of \$15 for which our Receipt No. 4529 is enclosed.

The application has been filed and given No. 23069. It has been checked over and some discrepancies are noted.

The location of the point of diversion should be described under Item 4 by giving its north or south and east or west distances from a certain Government survey corner and should indicate the forty-acre tract, section, township and range in which this point is located.

The ditch or pipe line to be used should be described under Item 7.

The forty-acre tract in which the land to be irrigated is situated should be noted under Item 8.

Items 11, 12, 13 and 14 should be filled in, and the application should be signed.

It is essential that the map accompanying your application be drawn to scale, at least 4 inches equals 1 mile, on tracing cloth or tracing paper, showing all of the important items of your proposed appropriation, including the location of the required reference monument by a distance and bearing tie to a recognized Government survey corner, as explained on Pages 6 and 8 of the enclosed copy of the Rules and Regulations of the State Engineer.

Mr. Jess I. Iler

-2-

March 12, 1948

For your convenience in completing your application and furnishing the required map as explained above, I am returning the application herewith endorsed so that, to retain its priority, it must be returned to this office on or before April 12, 1948.

Very truly yours,

CHAS. E. STRICKLIN  
State Engineer

By  
Ed K. Humphrey, Assistant

EKH:dh  
Enc. 3

RECEIVED  
MAR 8 1948  
STATE ENGINEER  
SALEM, OREGON

Canyon City Oregon  
March 5 1948.

State Engineer  
Water Resources Dept.  
Salem, Oregon  
Gentlemen:

Have filled out the inclosed application for water use, this tract is an addition to an earlier meadow covered by an application # 8025 granted to Bud Hinton dated June 24, 1927. This new meadow will be watered from the overflow from the old meadow.

The greater part of my meadows are watered from Berry Creek a tributary of Canyon Creek, which is covered by a mining permit granted to A. C. Hall dated 1880. I do not know if this has been transferred to irrigation use and is still legal.

Inclosed find check for 15.00 to cover examination fee and irrigation fee. If there are additional charges I will mail check upon receipt of billing for same. Yours truly  
P. F. Hend



35

26

Ref. Monument

Overflow

Permit # 8025 issued to Bud Hunter

T 14 S	R 31 E	W 9 M
T 15 S	R 31 E	W 9 M

10 feet

u.c. feet elevation

2

Application No. 23069  
Permit No.

Reference monument placed by cement highway markers at intersection of 9 3/4 section line, highway and creek.  
 Permit # 23069 is to be irrigated with the overflow from  
 an upper meadow under permit # 8025 by means of overflow da

RECEIVED

APR 9 1948

STATE ENGINEER  
SALEM, OREGON

9.

Scale 4 inch to 1 mile

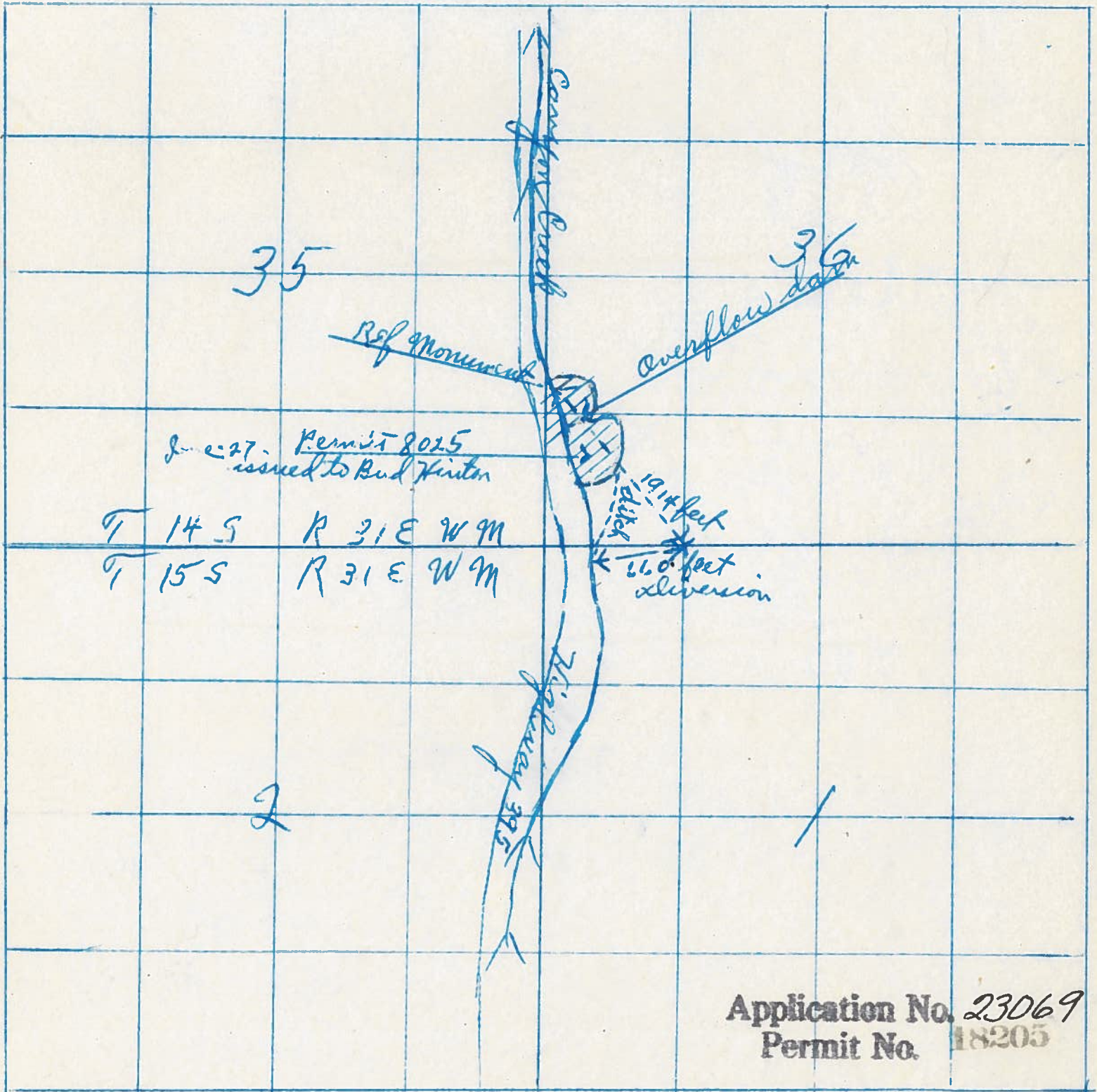

Application No. 23069  
Permit No. 18205

Reference monument placed by cement highway marker at intersection of 9.574 section line, highway and creek. Permit # 23069 is to be irrigated with the overflow from upper meadows under permit # 8025 by means of overflow dam.

Township # 14 S

Range No. 31 E. W. 41

RECEIVED  
MAR 8 1948  
STATE ENGINEER  
SALEM, OREGON

33

34

26

25

35

36

Township No 15 S

③

This 5 acres under application

Campora Creek

Permit # 8025  
① 5.7 acres

Township # 14 S

Range No. 31 E. 40. 111

26

25

33

34

35

36

Township No. 15 S

3

This area under application

4

Range # 31 E. 40. 111  
1

