

48" CONCRETE MH SECTIONS WITH PUMP MOUNTED INSIDE. TOP OF PIPE 96.0'

SITE PLAN
SCALE: 1" = 30'

ASSUMED DATUM

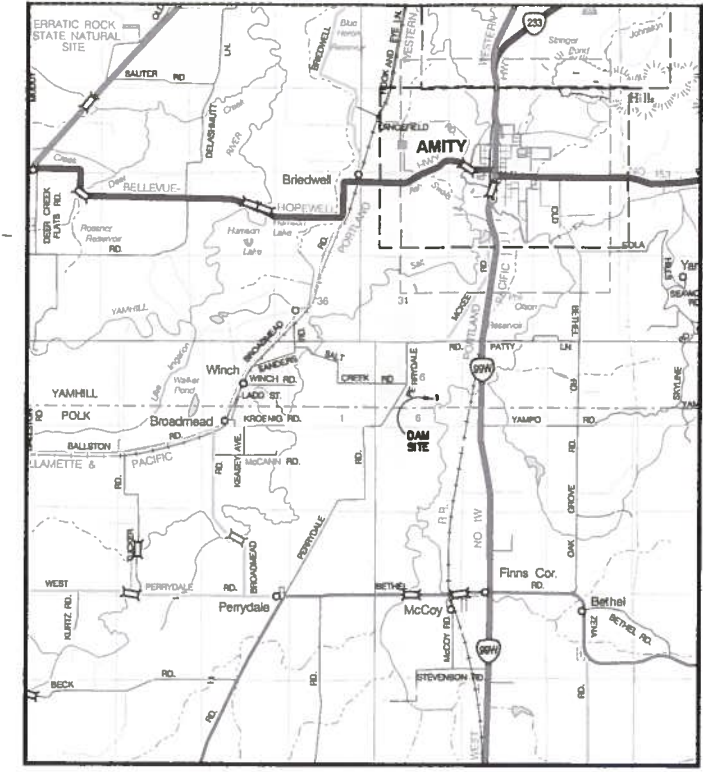

VICINITY MAP
SCALE 1" = 1 MILE

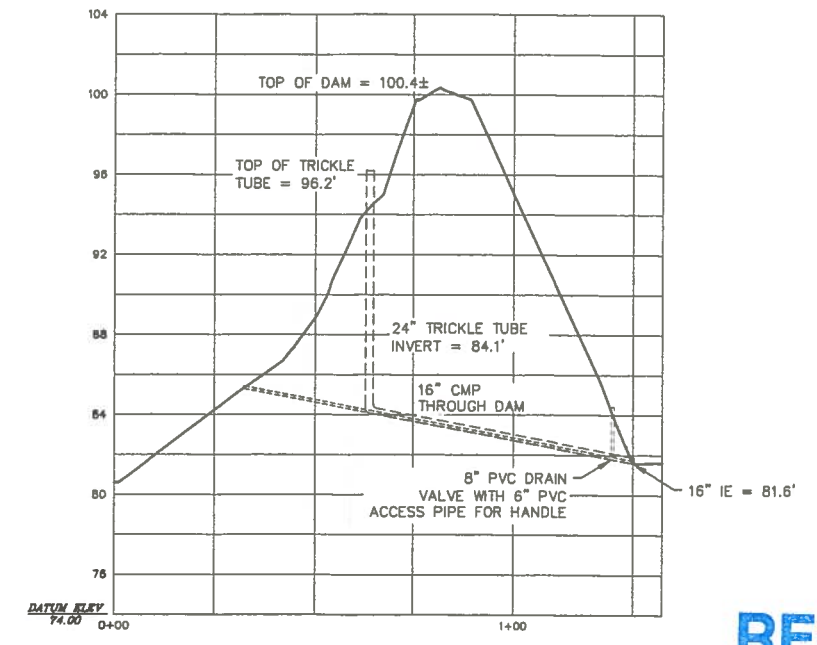
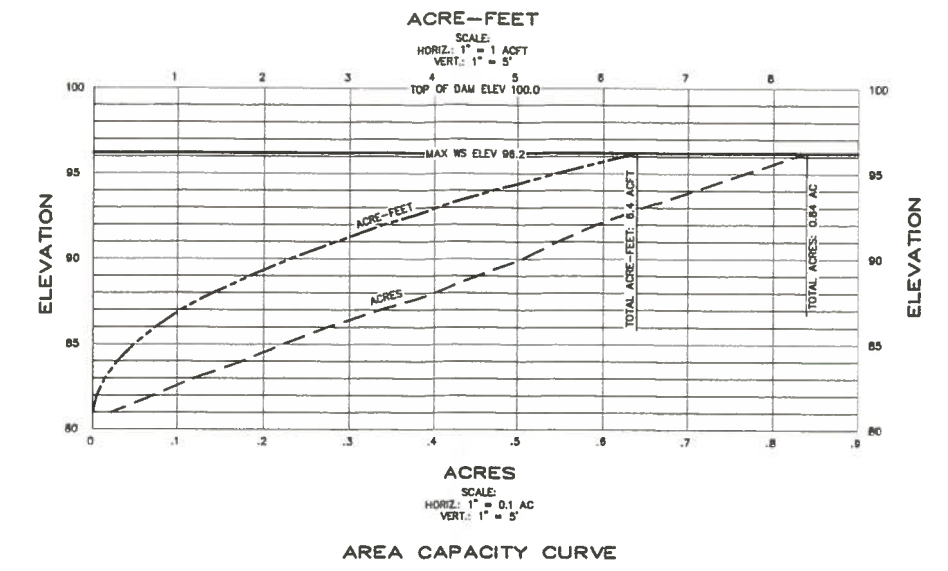

RECEIVED

OCT 17 2014

WATER RESOURCES DEPT
SALEM, OREGON

APPLICATION R-80384 PERMIT R-12390

	DAVID COELHO		
	DAM AND RESERVOIR AMITY, OREGON		
Scale: 1" = 30' Design: PHD/JB Drawn: PHD/JB Chkd: CFB/JB	Date: 7-16-2014 Boatwright Engineering, Inc. 2513 12th Street SE, SALEM, OREGON 97302 TEL: (503) 383-9225 • FAX: (503) 383-1051	Revised: Job No. 13-24 Sheet 1 of 1	YAMHILL COUNTY, OREGON
EXPIRES 12/31/15			

DRAWING OF RECORD

PHD 10/21/13

R-80384

T6S, R4W, WM

YAMHILL COUNTY

TAX LOT:
6 4 06 300

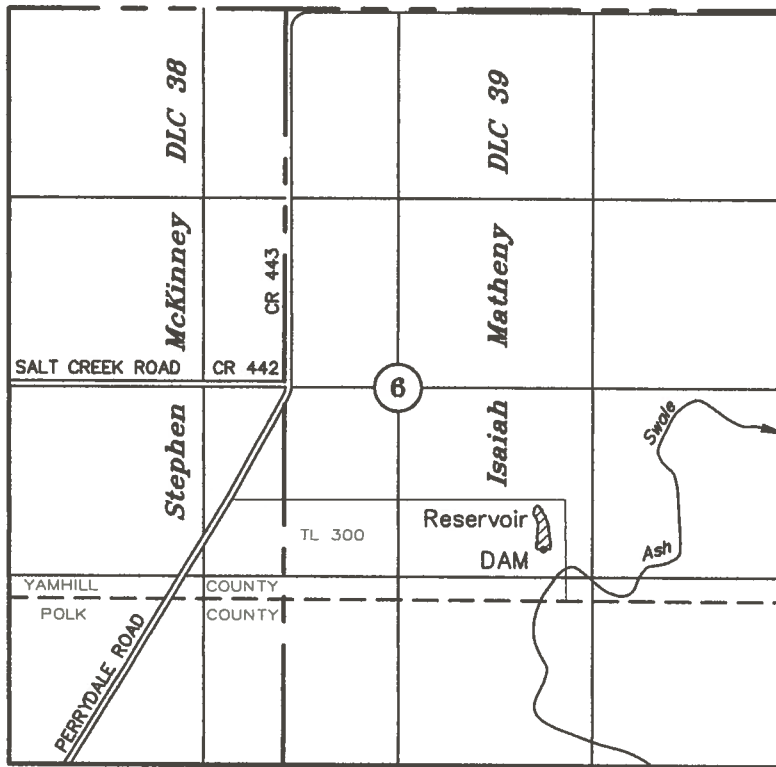

DAM: 3692' S AND 1776' E OF THE NE CORNER ISAIAH MATHENY DLC 39

APPLICATION TO APPROPRIATE SURFACE WATER FOR STORAGE

Alternate Review

UNDER

Application No. R- Permit No. R-

IN THE NAME OF

Deolinda A. Coelho Revocable Living Trust

September 29, 2014

SCALE: 1" = 1320'

RECEIVED

OCT 17 2014

WATER RESOURCES DEPT
SALEM, OREGON

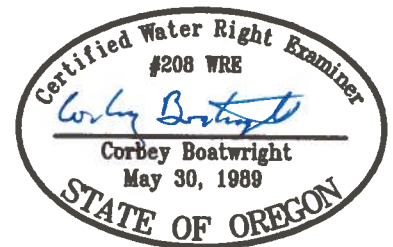

EXPIRES 12-31-15

NOTE: This map is not intended to provide legal dimensions or locations of property ownership lines.

R-8900