

Application No. 6427

Permit No. 4015

Certificate No. 2803

Ch. Pt. of Div. Sp. Or. Vol. 12, p 207

Name Ft. Vanoy Orchards

By Grants Pass, Ore.

Address Grants Pass, Ore.

Date filed

Action suspended until

Returned to applicant

.....

Date completed

Date of approval

CONSTRUCTION

Date for beginning

Date for completion

Extended to

Date for application of water

Extended to

PROSECUTION OF WORK

Form "A" filed

Form "B" filed

Form "C" filed

FINAL PROOF

Blank mailed

Proof received

Date certificate issued

Receipt for recording fee No.

Stream Index, Page No.

Application Record, Book No.

FEEES PAID

Date	Amount	Receipt No.
.....
.....
Total

FEEES REFUNDED

Date	Amount	Check No.
.....

ASSIGNMENTS

Date	To whom	Address	Volume	Page
.....
.....
.....

REMARKS

*Pt. of div 60 Rods east of NW Cor. of Sec. 21
 thence So. 10 rods and being within
 NW 1/4 NW 1/4, Sec 21, T. 36 S. R. 6 W. W. M
 T 8366 Δ POD*

5-6427

**BEFORE THE WATER RESOURCES DEPARTMENT
OF THE
STATE OF OREGON**

In the Matter of Transfer Application) **FINAL ORDER APPROVING CHANGE**
T-8366, Josephine County) **IN POINTS OF DIVERSION**
)
)

ORS 540.505 to 540.580 establishes the process in which a water right holder may submit a request to transfer the point of diversion, place of use, or character of use authorized under an existing water right. OAR Chapter 690, Division 380 implements the statutes and provides the Department's procedures and criteria for evaluating transfer applications.

Applicant

Ken-Wal Farms, Inc.
5630 Upper River Road
Grants Pass, Oregon 97526

Findings of Fact

1. On November 30, 1999, Ken-Wal Farms, Inc. filed a transfer application to change the points of diversion under Certificates 2803, 3247, 8942, 8943 and 15340. The Department assigned the application number T-8366.

2. The first right to be transferred is as follows:

Certificate: 2803 in the name of Fort Vannoy Orchards
Use: Irrigation of 70.0 acres
Priority Date: March 10, 1919
Quantity: 0.88 cubic foot per second (cfs)
Rate/Duty: 1/80 cfs per acre
Source: Rogue River tributary to the Pacific Ocean
Authorized Point of Diversion:

Township	Range		Meridian	Sec	¼ ¼		Survey Coordinates
36	S	6 W	W.M.	21	NW	NW	POD 1 – 10 Rods South & 60 Rods East from NW Corner, Section 21
36	S	6 W	W.M.	15	SW	SE	POD 2 – North 71 Degrees East 3150 Feet from SW Corner, Section 15

This is a final order in other than contested case. This order is subject to judicial review under ORS 183.484. Any petition for judicial review must be filed within the 60 day time period specified by ORS 183.484(2). Pursuant to ORS 536.075 and OAR 137-004-0080 you may either petition for judicial review or petition the Director for reconsideration of this order. A petition for reconsideration may be granted or denied by the Director, and if no action is taken within 60 days following the date the petition was filed, the petition shall be deemed denied.

Authorized Place of Use:

Township		Range		Meridian	Sec	¼ ¼		POD	Acres
36	S	6	W	W.M.	16	SW	SW	1	27.0
36	S	6	W	W.M.	16	SE	SW	1	5.0
36	S	6	W	W.M.	16	NE	SW	1	1.0
36	S	6	W	W.M.	16	NW	SW	1	7.0
36	S	6	W	W.M.	17	SE	SE	2	10.0
36	S	6	W	W.M.	20	NE	NE	1	10.0
36	S	6	W	W.M.	21	NW	NW	1	10.0

3. Application T-8366 proposes to move the authorized point of diversion approximately 1/16th mile downstream in the source to:

Township		Range		Meridian	Sec	¼ ¼		Survey Coordinates	
36	S	6	W	W.M.	21	NW	NW	POD 1 (Rogue River) – 515 Feet South & 890 Feet East from NW Corner, Section 21	

4. The portion of the second right to be transferred is as follows:

Certificate: 3247 in the name of H. Wood, A.H. Fetters and H.B. Wyman

Use: Irrigation of 39.5 acres

Priority Date: March 27, 1919

Quantity: 0.49 cfs

Rate/Duty: 1/80 cfs per acre

Source: Rogue River, tributary to the Pacific Ocean

Authorized Point of Diversion:

Township		Range		Meridian	Sec	¼ ¼		Survey Coordinates	
36	S	6	W	W.M.	21	NE	NW	15 Rods South & 100 Rods East from SW Corner, Section 16	

Authorized Place of Use:

Township		Range		Meridian	Sec	¼ ¼		Acres
36	S	6	W	W.M.	16	NW	SW	10.0
36	S	6	W	W.M.	16	NE	SW	4.5
36	S	6	W	W.M.	16	SW	SW	12.0
36	S	6	W	W.M.	16	SE	SW	5.0
36	S	6	W	W.M.	21	NE	NW	2.0
36	S	6	W	W.M.	21	NW	NW	3.5
36	S	6	W	W.M.	21	NW	NW	2.5*

* Applicant submitted an affidavit to diminish from primary irrigation to supplemental irrigation. See Finding of Fact #12.

5. Application T-8366 proposes to move the authorized point of diversion approximately 1/8th mile downstream in the source to:

Township	Range	Meridian	Sec	¼ ¼	Survey Coordinates
36	S	6	W	W.M.	21 NW NW POD 1 (Rogue River) – 515 Feet South & 890 Feet East from NW Corner, Section 21

6. The portion of the third right to be transferred is as follows:

Certificate: 8942 in the name of Fort Vannoy Irrigation District

Use: Irrigation of 179.0 acres

Priority Date: June 21, 1930

Quantity: 2.24 cfs

Rate/Duty: 1/80 cfs per acre

Source: Rogue River, tributary to the Pacific Ocean

Authorized Point of Diversion:

Township	Range	Meridian	Sec	¼ ¼	Survey Coordinates
36	S	6	W	W.M.	14 NE SW POD 1 – South 61 Degrees East 1580 Feet from E¼ Corner, Section 15
36	S	6	W	W.M.	15 SW SE POD 2 –North 71 Degrees East 3150 Feet from SW Corner, Section 15

Authorized Place of Use:

Township	Range	Meridian	Sec	¼ ¼	POD	Acres	
36	S	6	W	W.M.	16 NW NE	1	6.2
36	S	6	W	W.M.	16 SW NE	1	29.8
36	S	6	W	W.M.	16 SE NE	1	2.2
36	S	6	W	W.M.	16 NE NW	1	18.0
36	S	6	W	W.M.	16 SE NW	1	21.5
36	S	6	W	W.M.	16 NE SW	1	8.5
36	S	6	W	W.M.	16 NE SW	1	5.5*
36	S	6	W	W.M.	16 NW SW	1	8.0*
36	S	6	W	W.M.	16 NW SW	2	7.0*
36	S	6	W	W.M.	16 SW SW	2	0.3
36	S	6	W	W.M.	16 SW SW	2	39.0*
36	S	6	W	W.M.	16 SW SW	2	0.7**
36	S	6	W	W.M.	16 SE SW	2	10.0*
36	S	6	W	W.M.	20 NE NE	1	10.0*
36	S	6	W	W.M.	21 NE NW	1	0.5
36	S	6	W	W.M.	21 NE NW	1	2.0*
36	S	6	W	W.M.	21 NW NW	1	13.5*
36	S	6	W	W.M.	21 NW NW	1	0.5**

* Applicant submitted an affidavit to diminish from primary irrigation to supplemental irrigation. See Finding of Fact #12.

** Applicant submitted an affidavit to cancel a portion of the water right. See Finding of Fact #13.

7. Application T-8366 proposes to move the authorized point of diversion approximately 2.0 miles downstream in the source to:

Township		Range		Meridian	Sec	¼ ¼		Survey Coordinates
36	S	6	W	W.M.	21	NW	NW	POD 1 (Rogue River) – 515 Feet South & 890 Feet East from NW Corner, Section 21

8. The portion of the fourth right to be transferred is as follows:

Certificate: 8943 in the name of Fort Vannoy Irrigation District
Use: Supplemental Irrigation of 45.7 acres
Priority Date: April 6, 1922
Quantity: 0.57 cfs
Rate/Duty: 1/80 cfs per acre
Source: Dutcher Creek, tributary to Vannoy Creek, tributary to the Rogue River
Authorized Point of Diversion:

Township		Range		Meridian	Sec	¼ ¼		Survey Coordinates
36	S	6	W	W.M.	16	NW	NE	POD 1 – 910 Feet South & 1090 Feet East from N¼ Corner, Section 16
36	S	6	W	W.M.	16	SE	NW	POD 2 – 627 Feet North & 20 Feet West from SE Corner, NW¼, Section 16

Authorized Place of Use:

Township	Range		Meridian	Sec	¼ ¼		POD	Acres	
36	S	6	W	W.M.	16	NW	NE	1	5.0
36	S	6	W	W.M.	16	NW	NE	2	1.2
36	S	6	W	W.M.	16	NE	NW	1	12.6
36	S	6	W	W.M.	16	NE	NW	2	5.4
36	S	6	W	W.M.	16	SE	NW	2	21.5

9. Application T-8366 proposes to move the authorized point of diversion approximately 1/4th mile downstream in the source to:

Township		Range		Meridian	Sec	¼ ¼		Survey Coordinates
36	S	6	W	W.M.	17	SE	SE	POD 2 (Dutcher Creek/Drain Creek) – 895 Feet North & 160 Feet West from SE Corner, Section 17

10. The portion of the fifth right to be transferred is as follows:

Certificate: 15340 in the name of Ada Weston
Use: Irrigation of 11.7 acres
Priority Date: May 31, 1945
Quantity: 0.15 cfs
Rate/Duty: 1/80 cfs per acre
Source: Drain Creek, tributary to Vannoy Creek, tributary to the Rogue River

Authorized Point of Diversion:

Township		Range		Meridian	Sec	¼ ¼		Survey Coordinates
36	S	6	W	W.M.	16	NW	NE	1130 Feet South & 340 Feet East from N¼, Section 16

Authorized Place of Use:

Township		Range		Meridian	Sec	¼ ¼		Acres
36	S	6	W	W.M.	16	NW	NE	1.7*
36	S	6	W	W.M.	16	NE	NW	10.0

* Applicant submitted an affidavit to diminish from primary irrigation to supplemental irrigation. See Finding of Fact #12.

11. Application T-8366 proposes to move the authorized point of diversion approximately 1/8th mile downstream in the source to:

Township		Range		Meridian	Sec	¼ ¼		Survey Coordinates
36	S	6	W	W.M.	17	SE	SE	POD 2 (Dutcher Creek/Drain Creek) – 895 Feet North & 160 Feet West from SE Corner, Section 17

12. Affidavits of partial diminution of a water right were received on August 31, 2000 from the Crouse Family Trust and Ken Wahl Farms, Inc. The portion of the water rights to be diminished are:

Certificate: 3247 in the name of H. Wood, A.H. Feters and H.B. Wyman

Use: Irrigation of 2.5 acres

Priority Date: March 27, 1919

Quantity: 0.03 cfs

Rate/Duty: 1/80 cfs per acre

Source: Rogue River, tributary to the Pacific Ocean

Authorized Place of Use:

Township		Range		Meridian	Sec	¼ ¼		Acres
36	S	6	W	W.M.	21	NW	NW	2.5

Certificate: 8942 in the name of Fort Vannoy Irrigation District

Use: Irrigation of 72.5 acres

Priority Date: June 21, 1930

Quantity: 0.91 cfs

Rate/Duty: 1/80 cfs per acre

Source: Rogue River, tributary to the Pacific Ocean

Authorized Place of Use:

Township		Range		Meridian	Sec	¼ ¼		POD	Acres
36	S	6	W	W.M.	16	NE	SW	1	5.5
36	S	6	W	W.M.	16	NW	SW	1	8.0
36	S	6	W	W.M.	16	NW	SW	2	7.0
36	S	6	W	W.M.	16	SW	SW	2	39.0
36	S	6	W	W.M.	20	NE	NE	1	10.0

Township		Range		Meridian	Sec	¼ ¼		POD	Acres
36	S	6	W	W.M.	21	NE	NW	1	2.0
36	S	6	W	W.M.	21	NW	NW	1	13.5

Certificate: 15340 in the name of Ada Weston

Use: Irrigation of 1.7 acres

Priority Date: May 31, 1945

Quantity: 0.02 cfs

Rate/Duty: 1/80 cfs per acre

Source: Drain Creek, tributary to Vannoy Creek, tributary to the Rogue River

Authorized Place of Use:

Township		Range		Meridian	Sec	¼ ¼		Acres
36	S	6	W	W.M.	16	NW	NE	1.7

13. Affidavits attesting to the abandonment and requesting cancellation of a portion of a water right were received on August 31, 2000 from the Crouse Family Trust. The portions of the water right to be cancelled are:

Certificate: 8942 in the name of Fort Vannoy Irrigation District

Use: Irrigation of 1.2 acres

Priority Date: June 21, 1930

Quantity: 0.015 cfs

Rate/Duty: 1/80 cfs per acre

Source: Rogue River, tributary to the Pacific Ocean

Authorized Place of Use:

Township		Range		Meridian	Sec	¼ ¼		Acres
36	S	6	W	W.M.	16	SW	SW	0.7
36	S	6	W	W.M.	21	NW	NW	0.5

14. Notice of the application for transfer was published pursuant to ORS 540.520. Protests were filed by Fort Vannoy Irrigation District and Herman Baertschiger, Jr. Pursuant to ORS 540.520(7), a hearing was conducted, the protests were dismissed, and Application T-8366 was approved.

15. In approving the application, the Water Resources Commission concluded that:

- a) The consent of the District is not statutorily required in order for the transfer to be approved.
- b) The water rights proposed for transfer are water rights subject to transfer and have been used in the five years preceding the filing of the transfer application.
- c) The changes proposed in the transfer application, changing and consolidating points of diversion will not cause injury to existing water rights.

16. Pursuant to ORS 540.525, the Oregon Department of Fish and Wildlife requested inclusion of a condition requiring installation of proper fish screens.

17. A diversion structure and ditch sufficient to use the full amount of water allowed under the existing rights are present.
18. The proposed change will not result in enlargement of the right.

Conclusions of Law

The proposed change in points of diversion in application T-8366 is consistent with the requirements of ORS 537.705 and 540.505 to 540.580 and OAR 690-380-5000.

Now, therefore, it is ORDERED:

1. The change in points of diversion proposed in application T-8366 is approved.
2. Water right certificates 2803, 3247, 8942, 8943 and 15340 are cancelled. The rights described in Findings of Fact #12 are diminished from primary irrigation to supplemental irrigation. The rights described in the Findings of Fact #13 as abandoned are cancelled. New certificates will be issued describing the portions of the rights not involved in this transfer and not cancelled by this order.
3. When satisfactory proof of the completed changes is received, new certificates confirming the rights transferred will be issued. The right to the use of the water is restricted to beneficial use at the place of use described and is subject to all other conditions and limitations contained in Certificates 2803, 3247, 8942, 8943 and 15340, any related decree, and the diminishments described in the Findings of Fact.
4. The proposed change shall be completed on or before October 1, 2006.
5. A Claim of Beneficial Use prepared by a Certified Water Rights Examiner shall be submitted by the applicant to the Department by October 1, 2007.
6. The quantity of water diverted at the new points of diversion shall not exceed the quantity of water lawfully available at the original point of diversion.
7. Prior to diverting water, the water user shall install and maintain a headgate, an in-line flow meter, weir, or other suitable device for measuring and recording the quantity of water diverted. The type and plans of the headgate and measuring device must be approved by the Department prior to beginning construction and shall be installed under the general supervision of the Department.
8. The water user shall install and maintain a fish screen or fish by-pass device, as appropriate, at the new point of diversion. The type and plans of the screen or by-pass device must be approved by the Oregon Department of Fish and Wildlife prior to beginning of construction, and shall be installed under the supervision of the Department of Fish and Wildlife.

Dated at Salem, Oregon this 29th day of July, 2005.

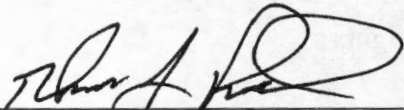
Phillip C. Ward, Director

Mailing date: AUG 03 2005

T.S. 412

Twp. 36 S R 6 W

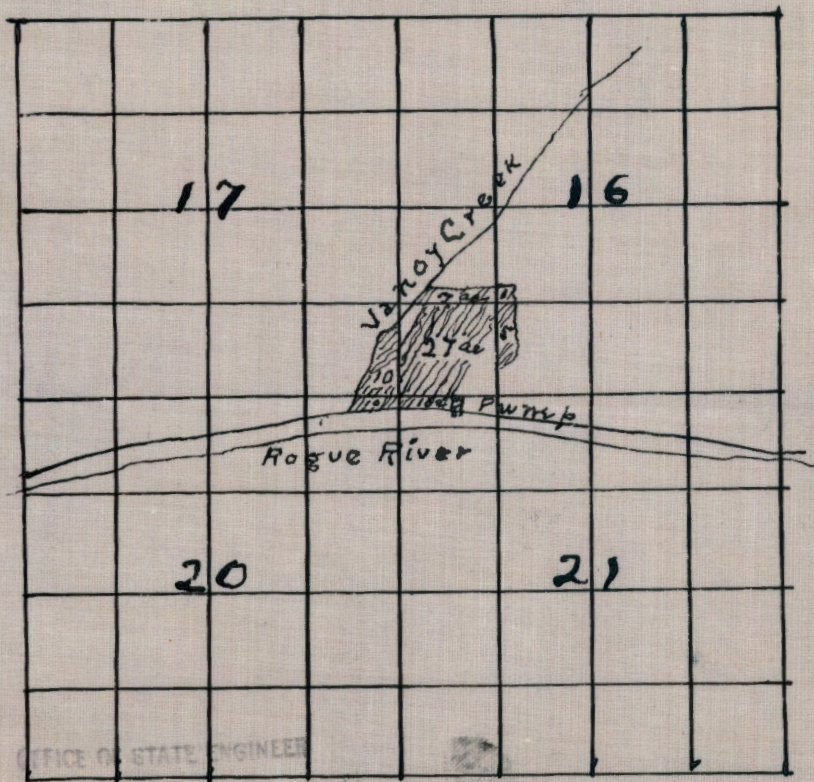

OFFICE OF STATE ENGINEER

RECEIVED

MAR 10 1919

SALEM, OREGON

Application No. 6427
 Permit No. 4015

0131

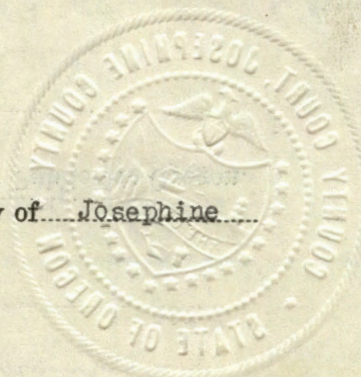

Division No. 1

Permit No. 4915

County of Josephine

Application No. 6427

Proof of Appropriation of Water

(In accordance with the provisions of Chapter 216, Laws of Oregon for 1909, and the regulations of the State Water Board thereunder.)

From Rogue River Orchards Tributary of Pacific Ocean

1. Name Ft. Vanoy Orchards

2. Postoffice address Route 2, Grants Pass, Oregon

3. For what purpose is water used? Irrigation (0.68 sec. ft.)

4. Did you begin the actual construction of the Ft Vanoy Orchards Pumping plant. Ditch,

(or other distributing works described in said permit), on or before March 18, 1920?

Yes

5. Give the date of completion of such construction work May 1, 1919

6. When was all the water completely applied to the proposed use? May 10, 1919

7. The description of land given below corresponds to that found in your permit covering land to be irrigated, or, if for other purposes, the place of use. In the blank column on the right, headed "No. acres actually irrigated," fill in the number of acres you have irrigated in each of the tracts described.

Township	Range	Section	Forty-acre Tract	No. Acres Described in Permit	No. Acres Actually Irrigated
36 S	6 W	20	NE $\frac{1}{4}$ NE $\frac{1}{4}$	10	10
		17	SE $\frac{1}{4}$ SE $\frac{1}{4}$	10	10
		21	NW $\frac{1}{4}$ NW $\frac{1}{4}$	10	10
		16	SW $\frac{1}{4}$ SW $\frac{1}{4}$	27	27
			SE $\frac{1}{4}$ SW $\frac{1}{4}$	5	5
			NE $\frac{1}{4}$ SW $\frac{1}{4}$	1	1
			NW $\frac{1}{4}$ SW $\frac{1}{4}$	7	7
			in Josephine County		10

8. During what months is water beneficially used? *May, June, July, August, September and October*
9. State the character of the soil and kind of crops raised *Sandy loam. Orchard, alfalfa, potatoes*
10. Does the accompanying blue print of the map filed with your permit show correctly the location of diverting works and area of land where water is used? *Yes*
11. If not, state wherein such map is in error
12. If the dimensions of your ditch or dam do not correspond to those described in your permit, state what changes have been made, giving dimensions of ditch (or other distributing works)
13. If water is used for power, mining, domestic, municipal, storage, manufacturing, or any other purpose than irrigation, give the extent and method of such use

STATE OF OREGON,
 County of *Josephine* } ss.

I, *C. H. Eismann, president & manager*, being first duly sworn, depose and say that I have read the above and foregoing proof of appropriation of water; that I know the contents thereof; and that the facts therein stated are true.

IN WITNESS WHEREOF, I have hereunto set my hand this *8th* day of *May*, 19*20*.

C. H. Eismann
 President and Manager

Subscribed and sworn to before me this *8th* day of *May*, 19*20*.

E. L. Colburn, Clerk
 Notary Public for Oregon

(Notarial Seal)

My commission expires _____
By Eva Adair
 Deputy Clerk



PROOF OF APPROPRIATION

Permit No. 4015

1.00 fee paid

Receipt 3039

OFFICE OF STATE WATER BOARD

RECEIVED

MAY 1 1920

SALEM, OREGON.

Approved: _____

Priority date - March 10, 1919



NOTICE OF COMPLETE APPLICATION OF WATER TO A BENEFICIAL USE

I, J. Vanoy Orchards, the holder of Application No. 6427, being Permit No. 4015, issued by the State Engineer of the State of Oregon

(Reservoir or enlargement)

for the appropriation of 1.4 cu. ft. second-feet of the waters of Rogue River in accordance with the tenor of such permit and the limitations indorsed thereon by the State Engineer, completely applied the water to a beneficial use, on the 12th day of May, 1919, being the time limitation as fixed in said permit or extended by the State Water Board for the complete application of water to a beneficial use.

Remarks:

If all the water granted in the permit had not been fully applied to beneficial use, you should so state, so that delinquent appropriators may have

notice.

IN WITNESS WHEREOF, I have hereunto set my hand this 12th day of May, 1919.

R.R. no 2 Grants Pass, Oregon (Present address)

J. Vanoy Orchards C.H. Eismann (Signature of applicant)

Fill out, detach, and mail to the Secretary, State Water Board, Salem, Oregon.

NOTICE OF COMPLETION OF CONSTRUCTION

I, J. Vanoy Orchards, the holder of Application No. 6427, being Permit No. 4015, issued by the State Engineer of the State of Oregon

(Reservoir or enlargement)

for the appropriation of 1.4 cu. ft. second-feet of the waters of Rogue River in accordance with the tenor of such permit and the limitations indorsed thereon by the State Engineer, have completed the construction of the works described therein the 10th day of May, 1919, being within the time limitation as fixed in said permit or extended by the State Water Board for the completion of construction work.

Remarks:

If the works have a less capacity than as described in the permit, or you have definitely abandoned your plan of irrigating any of the lands described

in your permit, you should so state in order that our records may not be unnecessarily encumbered.

IN WITNESS WHEREOF, I have hereunto set my hand this 10th day of May, 1919.

R.R. no 2 Grants Pass, Oregon (Present address)

J. Vanoy Orchards C.H. Eismann (Signature of applicant)

Fill out, detach, and mail to the Secretary, State Water Board, Salem, Oregon. Form D should be used in reporting progress of work if more than one year has been allowed for completion.

NOTICE OF BEGINNING OF CONSTRUCTION

I, J. Vanoy Orchards, the holder of Application No. 6427, being Permit No. 4015, issued by the State Engineer of the State of Oregon

(Reservoir or enlargement)

for the appropriation of 1.4 cu. ft. second-feet of the waters of Rogue River in accordance with the tenor of such permit and the limitations indorsed thereon by the State Engineer, began the actual construction of the works described therein on the 1st day of May, 1919, being within the time limitation as fixed in said permit for the beginning of construction work.

Base line pump completed. Two men employed.

The appropriator should state the manner of beginning construction work, number of men and teams employed, the amount of work completed up to the date of this

statement, and any additional information which may tend to show the beginning of work in good faith.

IN WITNESS WHEREOF, I have hereunto set my hand this 1st day of May, 1919.

R.R. no 2 Grants Pass, Oregon (Present address)

J. Vanoy Orchards C.H. Eismann (Signature of applicant)

Fill out, detach, and mail to the Secretary, State Water Board, Salem, Oregon.

C.H. Eismann, Pres.

"IT'S THE CLIMATE"

OFFICE OF
WATER MASTER
DISTRICT No. 16
STATE OF OREGON
GRANTS PASS
OREGON

May 10, 1920.

Secretary State Water Board,
Salem, Oregon.

Dear Sir:

Enclosed find the proof of appropriation of water for the Ft. Vanoy Orchards, together with my check for \$1.00 for recording fee.

I have inspected the Ft. Vanoy project and find that they have carried out the terms of their permit, the same being Permit No. 4015, and would recommend that a certificate be granted them.

Yours very truly,

M. L. Opdycke

June 10, 1919.

Ft Vanoy Orchards
Route 2,
Grants Pass, Oregon.

Gentlemen:

I am enclosing blank for proof of appropriation of water under permit No. 4015.

I note that you have until October 1, 1922 in which to completely apply the water to the proposed use under this permit. If all the water which you contemplate using under your permit has not been used, you should withhold the enclosed proof until the expiration of the time allowed for the completion of your right, or until such time as you have applied all the water which you intend to use. However, if all the water which you desire to use under this permit has been used, you should fill out the enclosed proof and return to this office, together with \$1.00 to cover recording fee, and the matter will be presented to the Board at its next meeting for approval and issuance of final water right certificate.

Yours very truly,

R. W. Potter,
Secretary.

GB.

6427

March 21, 1919

Ft. Vancy Orchards (an incorporation)
Mr. C H Esmann, President,
Grants Pass, R.F.D. #2,
Oregon.

Dear Sir:- Herewith you will find Application No. 6427, being Permit No. 4015, in the name of Ft. Vancy Orchards, together with tracing. This application has been approved and recorded in this office.

March 10, 1919

Mr. M L Opdycke , Watermaster,
Grants Pass, Oregon.

Dear Sir:-

Enclosed please find my official receipt No. 6513 for \$13.50, which amount was transmitted with your letter of the 8th inst. together with Application for permit to appropriate water in the name of the Ft. Vancy Orchards. I am also in receipt of two tracings.

This application has been numbered 6427 and placed on file in this office and will be taken up for approval as soon as the same can be reached and you will be further advised.

Very respectfully,

Percy A Cupper,

State Engineer.

RJS-LA

M. L. OPDYCKE, Water Master

OFFICE OF
WATER MASTER
DISTRICT No. 16
STATE OF OREGON
GRANTS PASS
OREGON

OFFICE OF STATE ENGINEER
RECEIVED
MAR 10 1919
SALEM, OREGON

March 8, 1919.

Mr. Percy A. Cupper,
State Engineer,
Salem, Oregon.

6427

Dear Sir:

Enclosed find water application of Ft. Vanoy Orchards.
This application is for pumping water from Rogue River and
the entire plant will be installed this coming summer.

If there is any error in the application or any
question about the same I trust that you will take the matter
up with me so that I can have it immediately corrected.

Yours very truly,

M. L. Opdycke

2 tracings

OK

May 11, 1920.

Mr. M. L. Opdycke,
Grants Pass, Oregon.

Dear Sir:

Proof of appropriation of water under permit No 4015
of the Ft Vancay Orchards, together with \$1.00 recording fee,
has been received and filed in this office.

This proof appears to be in proper form and will be
presented to the Board at its next meeting for approval and
issuance of final water right certificate.

Yours very truly,

Asst. Secretary.

Encl.