

RECEIVED
NOV 12 2014
OWRD

T6S, R4W, WM
YAMHILL COUNTY

TAX LOT:
6 4 06 300

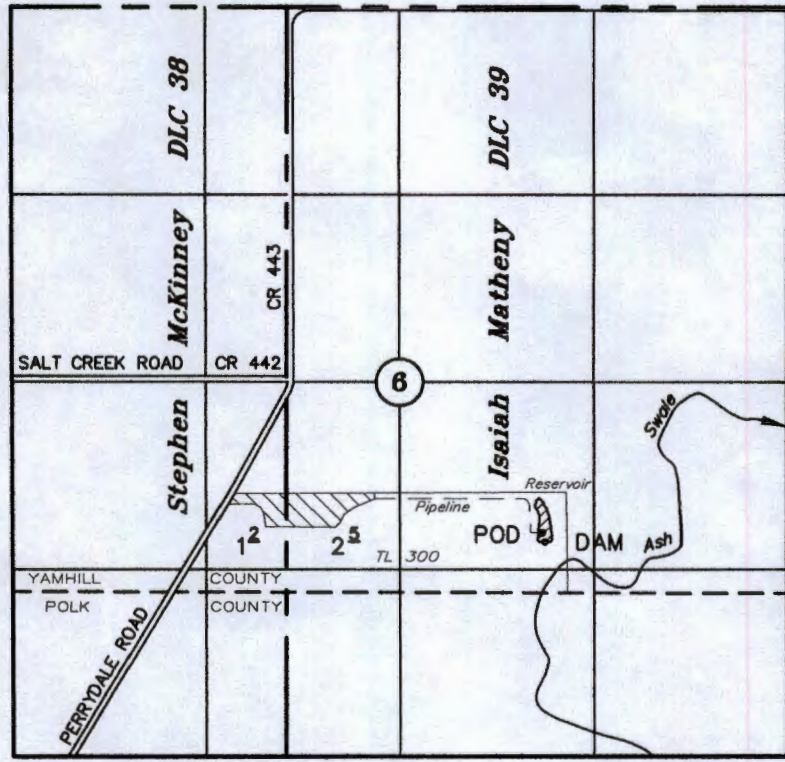

DAM: 3692' S AND 1776' E OF THE NE CORNER ISAIAH MATHENY DLC 39
POD: 3629' S AND 1760' E OF THE NE CORNER ISAIAH MATHENY DLC 39

APPLICATION FOR A PERMIT TO USE SURFACE WATER
(STORED WATER ONLY)

UNDER

Application No. S-88030 Permit No. S-

IN THE NAME OF

Deolinda A. Coelho Revocable Living Trust

September 29, 2014
SCALE: 1" = 1320'

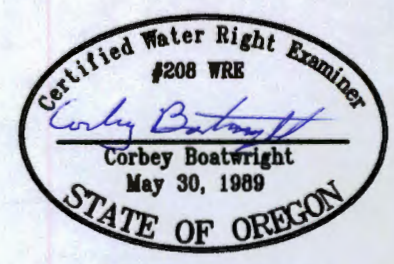

NOTE: This map is not intended to provide legal dimensions or locations of property ownership lines.

EXPIRES 12-31-15

S-88030

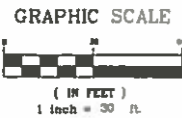
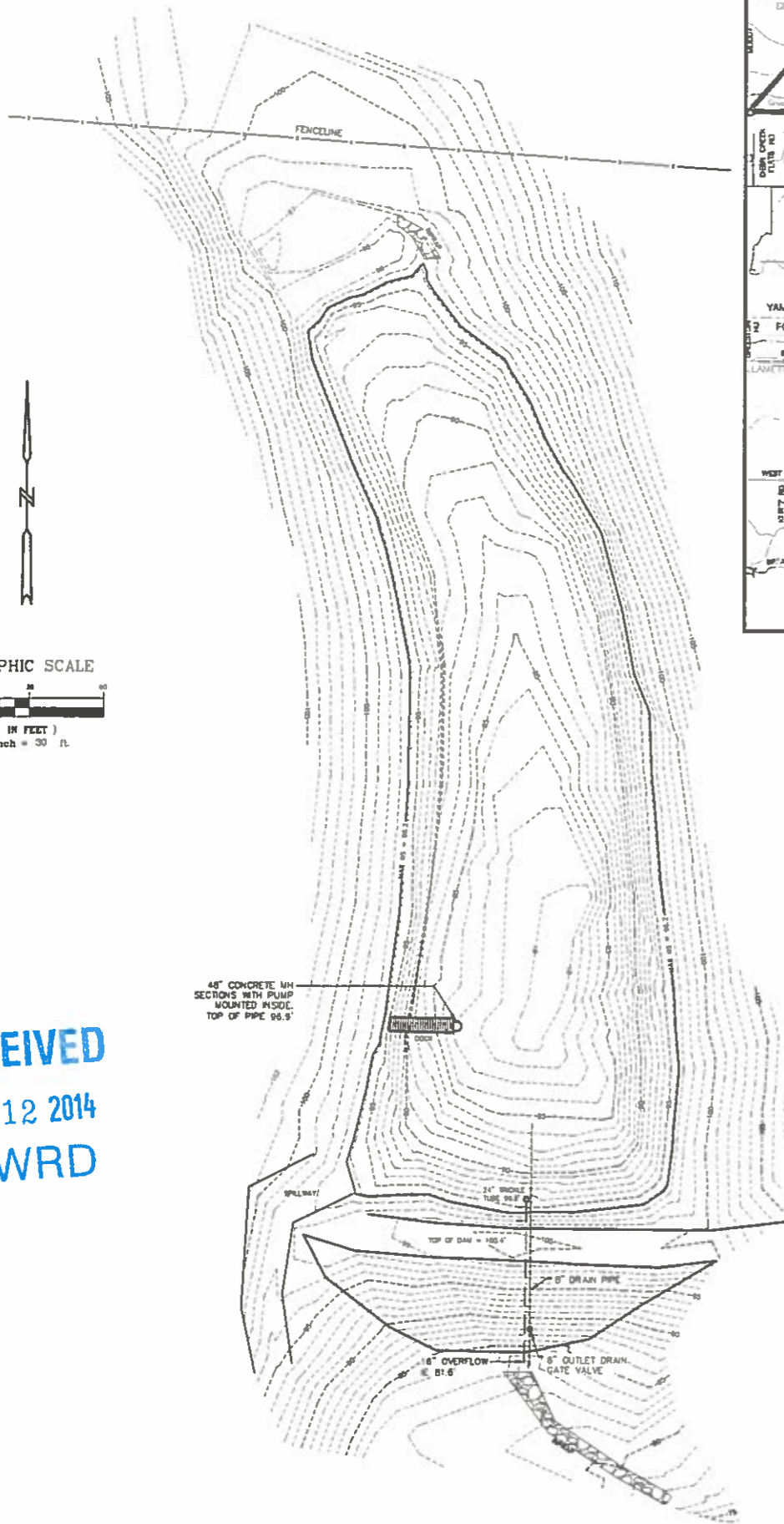

RECEIVED
NOV 12 2014
OWRD

SITE PLAN
SCALE: 1" = 30'

ASSUMED DATUM

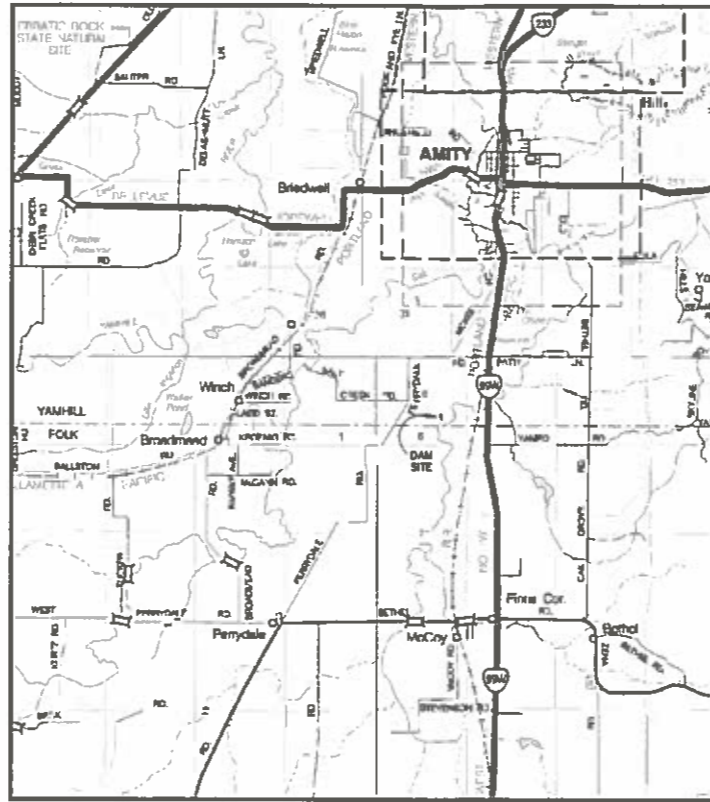

VICINITY MAP
SCALE 1" = 1 MILE

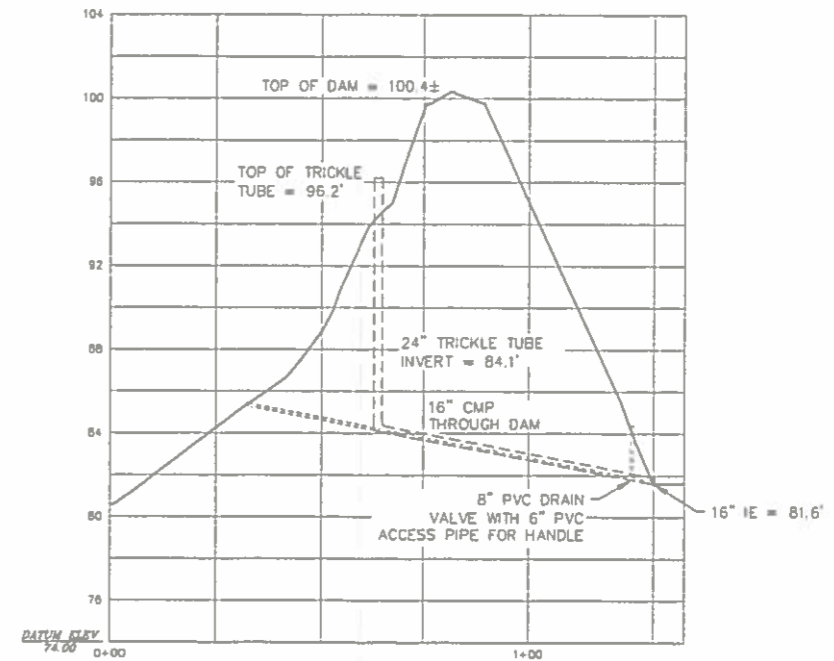
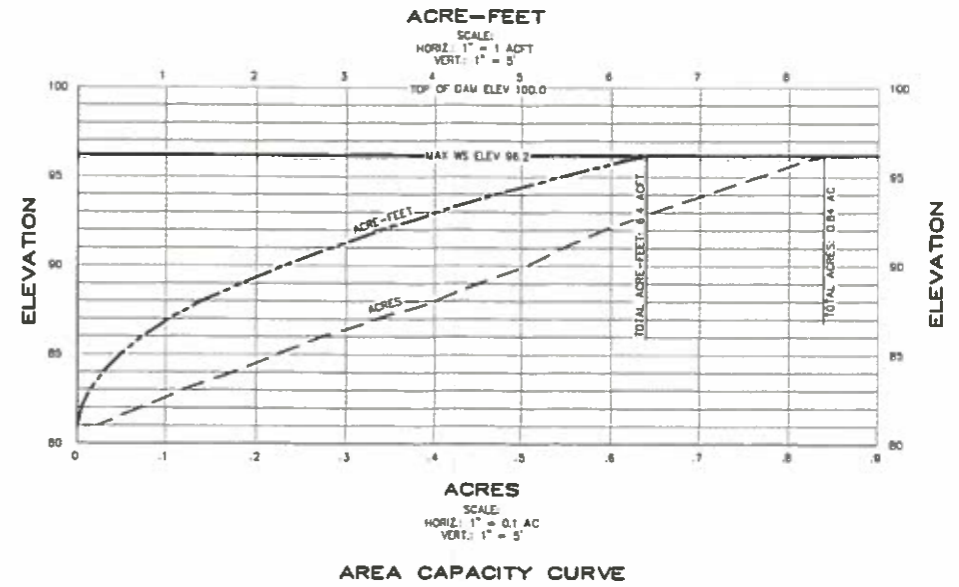

TYPICAL DAM SECTION
NOT TO SCALE

APPLICATION R-80384 PERMIT R-12390

DRAWING OF RECORD

PHD 10/21/13

<p>DAVID COELHO DAM AND RESERVOIR AMITY, OREGON</p>		
<p>Design: PHD/JB</p>	<p>Date: 7-16-2014</p>	<p>Revised:</p>
<p>Drawn: PHD/JB</p>	<p>Job No. 13-24</p>	<p>Sheet</p>
<p>Chkd: CFB/JB</p>	<p>2613 12th Street SE, SALEM, OREGON 97302</p>	<p>1 of 1</p>
<p>EXPIRES 12/31/15</p>	<p>10: (503) 343-8225 • FAX: (503) 343-1051</p>	

5-88050