

Application No. 15893

Permit No. 11735

Certificate No. 13431

Stream Index, Page No. 1-16

FEEES PAID

Date	Amount	Receipt No.
6/25/35	11.75	18832
Total		
2/4/41	\$1 Cert. Fee	27250

Name Walter H. Cason

By \_\_\_\_\_

Address Blaine, Oregon

Date filed June 25, 1935

Priority June 25, 1935

Action suspended until \_\_\_\_\_

Returned to applicant \_\_\_\_\_

Date of approval 8-15-35

CONSTRUCTION

Date for beginning 8-15-36

Date for completion 10-1-37

Extended to 10/1/39

Date for application of water 10-1-38

Extended to 10/1/39

PROSECUTION OF WORK

Form "A" filed \_\_\_\_\_

Form "B" filed Sept. 25, 1935

Form "C" filed Feb. 14, 1940

FINAL PROOF Mar. 18, 1940 GN

Blank mailed Oct. 2, 1935 Nov. 2, 1937 - CC.

Proof received \_\_\_\_\_

Date certificate issued May 1, 1941

*ALL Cancelled - sp. or Rec. Vol. 33 p. 481*

ASSIGNMENTS

Date	To Whom	Address	Volume	Page

REMARKS

*0.56 a.f. from unnamed stream for irrigation 45 acres*  
*3/15/37 final proof to SD*  
*5/21/36 - form 102.*  
*11-16-36 - form 102.*  
*10-11-37 - Card for B.*  
*10-2-39 - Card for B&C*

*OK for entry proof*

*proof in folder*



Form C

Application No. 15893

NOTICE OF COMPLETE APPLICATION OF WATER TO A BENEFICIAL USE

I, Walter W Cason, the holder of Permit No. 11735 to appropriate the public waters of the state of Oregon, completely applied the waters to a beneficial use in accordance with the terms of said permit, on the 1 day of May, 1938

Remarks: Will not be able to irrigate 45 acres  
If all of the water granted in the permit has not been fully applied to beneficial use, you should so state.  
not water enough in dry season

IN WITNESS WHEREOF, I have hereunto set my hand this 11 day of Feb, 1940

Chas Baker  
(Signature of Witness)  
Tillamook Ore  
(Address)

Walter W. Cason  
(Signature of Applicant)  
Blaine, Ore  
(Address)

Fill out, detach, and mail to the State Engineer, Salem, Oregon, when all of the water has been applied.

Form B

NOTICE OF COMPLETION OF CONSTRUCTION

I, WALTER W CASON, the holder of Application No. 15893, being Permit No. 11735, issued by the State Engineer of the State of Oregon

(Reservoir or Enlargement) for the appropriation of 3 second-feet of the waters of unnamed stream in accordance with the tenor of such permit and the limitations endorsed thereon by the State Engineer, have completed the construction of the works described therein the 9 day of June, 1935, being within the time limitation as fixed in said permit or as extended by the State Engineer for the completion of construction work.

Remarks: Permitted  
If the works have a less capacity than as described in the permit, or you have definitely abandoned your plan of irrigating any of the lands described in your permit, you should so state in order that our records may not be unnecessarily encumbered.

IN WITNESS WHEREOF, I have hereunto set my hand this \_\_\_\_\_ day of \_\_\_\_\_, 1935

\_\_\_\_\_  
(Present Address)

Walter W Cason  
(Signature of Applicant)

Fill out, detach, and mail to the State Engineer, Salem, Oregon.

All Canceled Sp. Or. Vol. 33 P. 781

Entered 7-23-80

Mark Records C# 13431

- |  |  |  |                   |
|--|--|--|-------------------|
| <input checked="" type="checkbox"/>            | <u>    </u> Index Cards                | <input checked="" type="checkbox"/> <u>SRA</u> | Str. Index map    |
| <u>    </u>                                    | <u>    </u> Decree-vault V <u>    </u> | <input checked="" type="checkbox"/> <u>SRA</u> | Str. Index list   |
| <u>    </u>                                    | <u>    </u> Decree -safe P <u>    </u> | <u>    </u>                                    | Name Chainindex   |
| <input checked="" type="checkbox"/> <u>SRA</u> | <u>    </u> Cert. of W/R               | <u>    </u>                                    | X Ref. Chainindex |
| <input checked="" type="checkbox"/> <u>SRA</u> | <u>    </u> Plat Cards                 | <input checked="" type="checkbox"/> <u>SRA</u> | Permit File       |
| <u>    </u>                                    | <u>    </u>                            |  |                   |

Orders to:

- |  |  |  |               |
|--|--|--|---------------|
| <input checked="" type="checkbox"/> <u>SRA</u> | <u>    </u> Order Book                 | <u>    </u>                                    | Adj. Folder   |
| <u>    </u>                                    | <u>    </u> County Clerk               | <input checked="" type="checkbox"/> <u>SRA</u> | Permit Folder |
| <input checked="" type="checkbox"/> <u>SRA</u> | <u>    </u> Watermaster # <u>1</u>     | <u>    </u>                                    |               |
| <input checked="" type="checkbox"/> <u>SRA</u> | <u>    </u> Party Submitting Affidavit | <input checked="" type="checkbox"/> <u>SRA</u> | Watermaster   |
|  |  |  | Div.          |



378-3066 or  
1-800-452-7813

August 7, 1980

Publishers Paper Co.  
419 Main Street  
Oregon City, OR 97045

Gentlemen:

REFERENCE: File Nos. 4507, 15893

Enclosed are copies of the Water Resources Director's orders entered July 23, 1980, canceling the water rights evidenced by the certificates recorded at page 3750, Volume 5 and page 13431, Volume 11, State Record of Water Right Certificates, as authorized by your affidavits.

Our records have been changed and the water rights evidenced by the certificates will be of no further force or effect.

Sincerely,

SAMUEL R. ALLISON  
Supervisor  
Transfer Section

SRA:wpc

cc: Clayton Gardner, Watermaster

1793A



BEFORE THE WATER RESOURCES DIRECTOR OF OREGON

TILLAMOOK COUNTY

IN THE MATTER OF CANCELLATION)  
OF A WATER RIGHT IN THE NAME )  
OF WALTER W. CASON )  
-----

ORDER

On July 17, 1980, Publishers Paper, Co. submitted an affidavit that Publishers Paper Co. is the owner of a certain water right and the lands to which the water right is appurtenant; that Publishers Paper Co. has abandoned any and all interest in and to the said water right and requests the same be canceled.

The water right in question is described by the certificate recorded at page 13431, Volume 11, State Record of Water Right Certificates, in the name of Walter W. Cason, and is for the use of not to exceed 0.29 cubic foot per second of water from an unnamed stream, tributary of East Creek, with a date of priority of June 25, 1935, for irrigation of a certain 19.4 acres in NE 1/4 NW 1/4, 1.2 acres in SE 1/4 NW 1/4, and 2.1 acres in NW 1/4 NW 1/4 Section 28, Township 3 South, Range 8 West, W.M.

ORS 540.621 provides that: "Whenever the owner of a perfected and developed water right certifies under oath to the Water Resources Director that the water right has been abandoned by him and that he desires cancellation thereof, the Water Resources Director shall enter an order canceling the water right."

NOW, THEREFORE, it hereby is ORDERED that the said water right, described by the certificate recorded at page 13431, Volume 11, State Record of Water Right Certificates, is canceled.

It is FURTHER ORDERED that the said certificate of water right is canceled.

Dated at Salem, Oregon, this 23rd day of July, 1980.

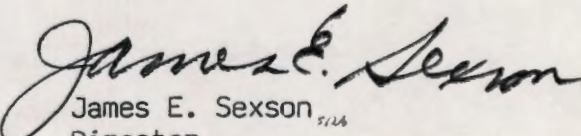
  
James E. Sexson, 5/126  
Director



STATE OF OREGON

COUNTY OF TILLAMOOK

CERTIFICATE OF WATER RIGHT

This Is to Certify, That WALTER W. CASON

of Blaine, State of Oregon, has made proof to the satisfaction of the STATE ENGINEER of Oregon, of a right to the use of the waters of Unnamed Stream a tributary of East Creek for the purpose of Irrigation under Permit No. 11735 of the State Engineer, and that said right to the use of said waters has been perfected in accordance with the laws of Oregon; that the priority of the right hereby confirmed dates from June 25, 1935;

that the amount of water to which such right is entitled and hereby confirmed, for the purposes aforesaid, is limited to an amount actually beneficially used for said purposes, and shall not exceed 0.29 cubic foot per second,

or its equivalent in case of rotation, measured at the point of diversion from the stream. The point of diversion is located in the NW 1/4 NE 1/4, Section 28, Township 3 South, Range 8 West, W. M.

The amount of water used for irrigation, together with the amount secured under any other right existing for the same lands, shall be limited to one-eightieth of one cubic foot per second per acre, or its equivalent for each acre irrigated and shall be further limited to a diversion of not to exceed 2 1/2 acre feet per acre for each acre irrigated during the irrigation season,

and shall conform to such reasonable rotation system as may be ordered by the proper state officer. A description of the place of use under the right hereby confirmed, and to which such right is appurtenant, is as follows:

- 19.4 acres in the NE 1/4 NW 1/4
1.2 acres in the SE 1/4 NW 1/4
2.1 acres in the NW 1/4 NW 1/4
Section 28
Township 3 South, Range 8 West, W. M.

Cancel all, No RR

The right to the use of the water for the purposes aforesaid is restricted to the lands or place of use herein described.

WITNESS the signature of the State Engineer, affixed this 1st day of May, 1934

CHAS. E. STRICKLIN
State Engineer

RECEIVED  
JUL 17 1980  
WATER RESOURCES DEPT  
SALEM, OREGON

CERTIFICATE OF ABANDONMENT

TO: Water Resources Director  
Water Resources Department  
Mill Creek Office Park  
555 13th Street NE  
Salem, OR 97310

STATE OF OREGON            )  
  ) ss.  
County of Clackamas        )

I, RAYMOND M. LUTHY, hereby swear that I am Timberlands Manager of PUBLISHERS PAPER CO., a Delaware corporation, and am authorized to execute this certificate on behalf of said corporation;

Publishers Paper Co. is the legal owner and sole occupant of the lands to which the water right described in the following described Certificate of Water Right is appurtenant:

That certain Certificate of Water Right issued to Walter W. Cason on May 1, 1941 and recorded in the State Record of Water Right Certificate, Volume 11, page 13431, a copy of which Certificate is attached hereto and incorporated herein by this reference.

Said water right has been abandoned and said corporation desires cancellation thereof in accordance with ORS 540.621.

PUBLISHERS PAPER CO.

By Raymond M Luthy  
Raymond M. Luthy  
Timberlands Manager

SUBSCRIBED AND SWORN TO before me this 16<sup>th</sup> day of July 1980.



Leslie Williams  
Notary Public for Oregon  
My commission expires: 7/27/82



RECEIVED  
JUL 17 1980  
WATER RESOURCES DEPT  
SALEM, OREGON

# CERTIFICATE OF WATER RIGHT

This Is to Certify, That **WALTER H. GASON**

of **Blaine**, State of **Oregon**, has made proof to the satisfaction of the STATE ENGINEER of Oregon, of a right to the use of the waters of **Unnamed Stream** a tributary of **East Creek** for the purpose of **Irrigation**

under Permit No. **J1735** of the State Engineer, and that said right to the use of said waters has been perfected in accordance with the laws of Oregon; that the priority of the right hereby confirmed dates from **June 25, 1935;**

that the amount of water to which such right is entitled and hereby confirmed, for the purposes aforesaid, is limited to an amount actually beneficially used for said purposes, and shall not exceed **0.29** cubic foot per second,

or its equivalent in case of rotation, measured at the point of diversion from the stream. The point of diversion is located in the **NW $\frac{1}{4}$ NE $\frac{1}{4}$** , Section 28, Township 3 South, Range 8 West, W. M.

The amount of water used for irrigation, together with the amount secured under any other right existing for the same lands, shall be limited to one-eightieth of one cubic foot per second per acre, or its equivalent for each acre irrigated and shall be further limited to a diversion of not to exceed **2 $\frac{1}{2}$**  acre feet per acre for each acre irrigated during the irrigation season,

and shall conform to such reasonable rotation system as may be ordered by the proper state officer. A description of the place of use under the right hereby confirmed, and to which such right is appurtenant, is as follows:

- 19.4 acres in the NE $\frac{1}{4}$ NW $\frac{1}{4}$
  - 1.2 acres in the SE $\frac{1}{4}$ NW $\frac{1}{4}$
  - 2.1 acres in the NW $\frac{1}{4}$ NW $\frac{1}{4}$
- Section 28  
Township 3 South, Range 8 West, W. M.

The right to the use of the water for the purposes aforesaid is restricted to the lands or place of use herein described.

WITNESS the signature of the State Engineer, affixed

this 1st day of May, 1974

**CHAS. E. STRICKLIN**  
State Engineer

P-11735



SECTION

TOWNSHIP 35, RANGE 8W, W. M.

North

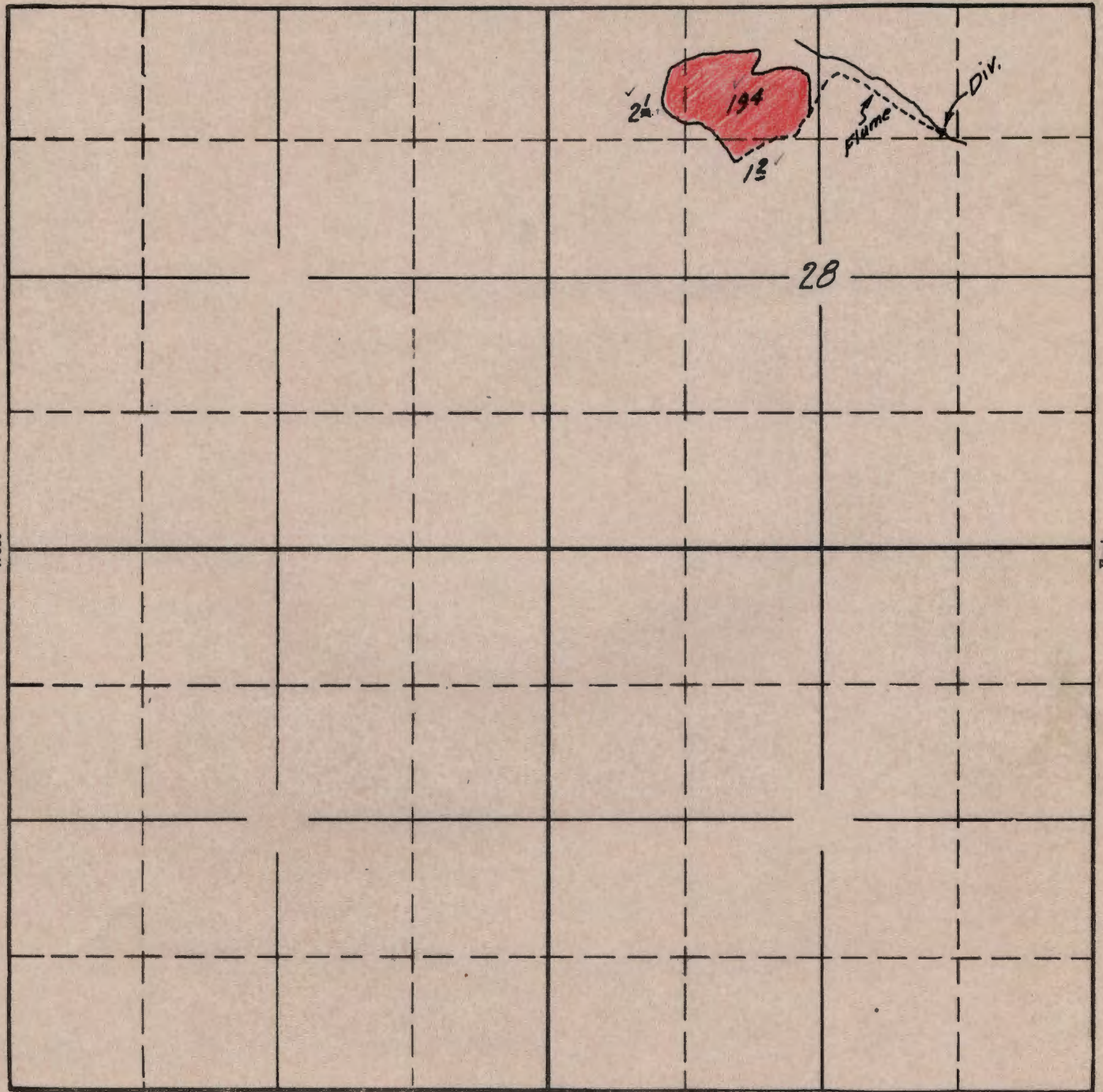

South

*Surveyed June 25, 1940 C.A.C.*

APPLICATION No. 15893  
PERMIT No. 11735



SECTION

\_\_\_\_\_

\_\_\_\_\_

\_\_\_\_\_

\_\_\_\_\_

TOWNSHIP **35**, RANGE **8W**, W. M.

North

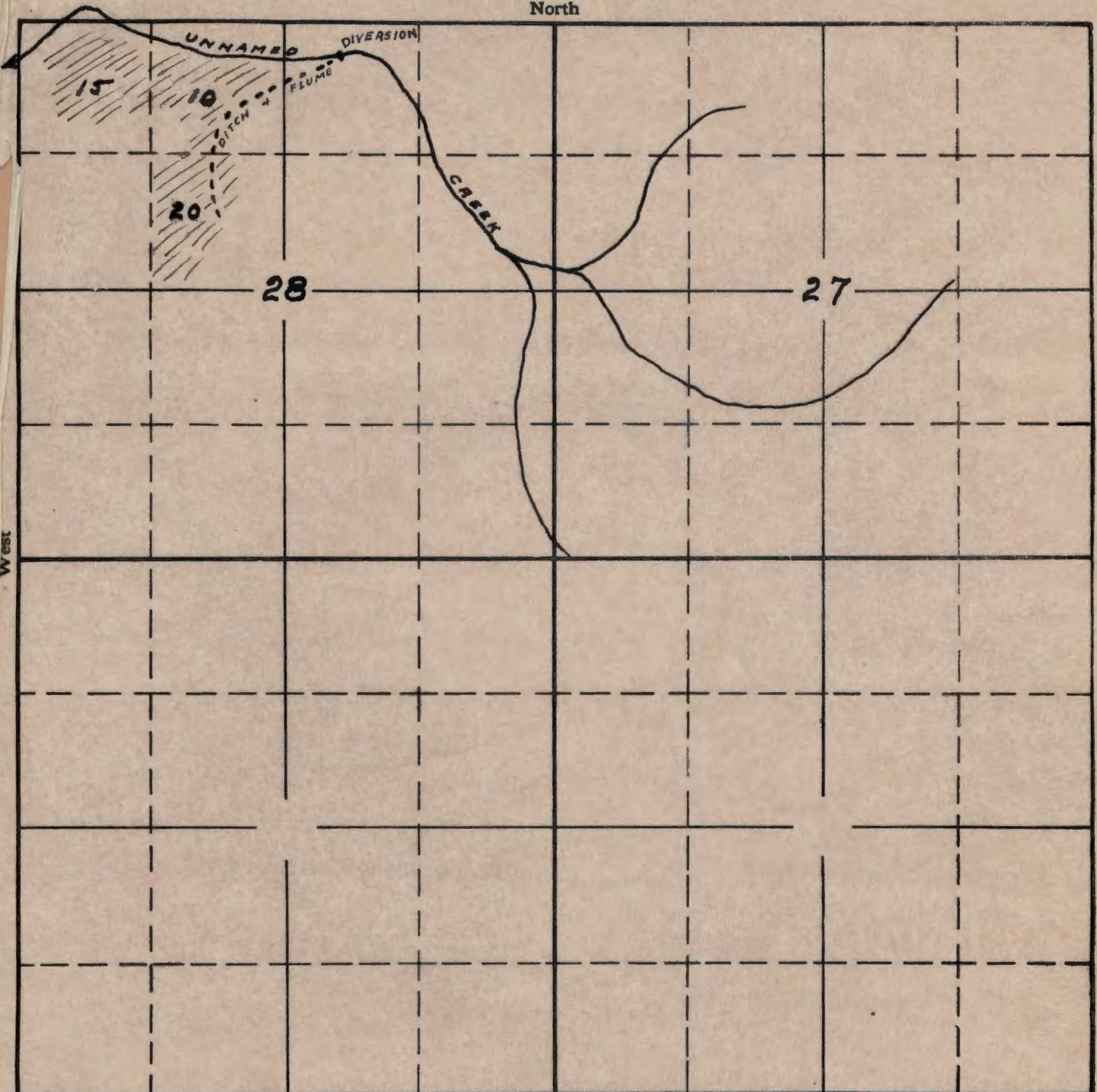

South

*1-16-OK*

APPLICATION No. **15093**  
 PERMIT No. **11735**



PERMIT No. 11735

13431

APPLICATION No. 15895

COUNTY Tillamook

PROOF OF APPROPRIATION OF WATER

- 1. Name Walter W. Casson 2. Address Blaine, Oregon
- 3. Source of supply Unnamed stream  
Tributary of East Creek at the point of diversion from the stream.
- 4. Amount of water 0.56 sec. ft. measured Priority date June 25, 1935
- 6. Use Irrigation
- 7. Location of point of diversion, NW 1/4 NE 1/4 Sec. 28, Twp. 3 S., Range 8 W., W. M. (Legal Subdivision)

8. The description of land given below corresponds to that found in your permit covering land to be irrigated, or, if for other purposes, the place of use. In the blank column on the right, headed "No. acres actually irrigated," fill in the number of acres you have irrigated in each of the tracts described:

Township	Range	Section	Forty-acre Tract	No. Acres Described in Permit	No. Acres Actually Irrigated
3 S.	8 W.	28	NE 1/4 NW 1/4	10	194 # 8-1937
			SE 1/4 NW 1/4	20	12
			NW 1/4 NW 1/4	15	22.7 ac
<p>*** 1/80th of one cubic foot per second or its equivalent for each acre irrigated and shall be further limited to a diversion of not to exceed 2 1/2 acre feet per acre for each acre irrigated during the irrigation season, ***</p>					This column must be filled in if water is used for irrigation.

(Attach separate sheet if necessary)



DESCRIPTION OF WORKS

9. (a) If a dam has been constructed, give description: Height, 1.5 ft.; length on top, 4.5 ft.; length on bottom \_\_\_\_\_ ft.; material used and character of construction, gravel & dirt
- (b) Give description of headgate: Width, \_\_\_\_\_ ft.; depth, \_\_\_\_\_ ft.; material used and character of construction, \_\_\_\_\_
- (c) Size of canal: Width on top (at waterline) \_\_\_\_\_ ft.; width on bottom, \_\_\_\_\_ ft.; depth of water, \_\_\_\_\_ ft.; grade, \_\_\_\_\_ ft. fall per 1,000 ft. Actual capacity, \_\_\_\_\_ sec.-ft. Give general description: \_\_\_\_\_
- (d) Pipe line: Description of intake, 1980 ft of Flume 2' x 16" 74 x 12  
as per map attached  
 Length of pipe, \_\_\_\_\_ ft.; size at intake, \_\_\_\_\_ in.; size at \_\_\_\_\_ ft. from intake, \_\_\_\_\_ in.; size at place of use \_\_\_\_\_ in. Difference in elevation between intake and place of use, \_\_\_\_\_ ft. Is grade uniform? \_\_\_\_\_ Actual capacity of pipe line, \_\_\_\_\_ sec.-ft. Give general description: Grade not uniform flowing  
 (Material: Steel, wrought, cast iron, wood stave, etc.)  
0.2' per sec. in places
- (e) Pumping plant: Give size and type of pump, \_\_\_\_\_ Suction lift, \_\_\_\_\_ ft.; discharge lift, \_\_\_\_\_ ft. Type of motor used \_\_\_\_\_ Horse power rating, \_\_\_\_\_ H. P. Actual capacity of pump, \_\_\_\_\_ sec.-ft.
10. During what months is water beneficially used? May June July Aug - Sept.
11. State character of soil Sandy Loam  
 Kind of crops raised Hay & Pasture
12. Does the accompanying map, filed with your application, show correctly the point of diversion, area of land irrigated, or place of use? yes See proof map
13. If not, wherein is such map in error? \_\_\_\_\_
14. Domestic use: Give number of families actually using water at this time none
15. If for power, mining, municipal, manufacturing, storage or any other purpose than irrigation, give extent and method of such use ✓



AFFIDAVIT OF APPROPRIATOR

STATE OF OREGON,

County of Tillamook } ss.

I, Walter W. Cason, being first duly sworn, depose and say that I have read the above and foregoing proof of appropriation of water; that I know the contents thereof, and that the facts therein stated are true.

IN WITNESS WHEREOF, I have hereunto set my hand this 23rd day of October, 1937.

Walter W. Cason

Subscribed and sworn to before me this 23rd day of October, 1937.

Geneva Abrams

Notary Public for Oregon

My commission expires Nov. 23-1940

[NOTARIAL SEAL]

AFFIDAVIT OF WITNESSES

STATE OF OREGON,

County of Tillamook } ss.

We, Marion Hook, and Edna C. Johnson of Blaine, Oregon, being first duly sworn, depose and say that

we are well acquainted with the facts and conditions set forth in the foregoing statement relative to proof of appropriation of water under Permit No. ....; that we and each of us have been over and upon each tract described in said proof, and from such personal inspection have knowledge that all necessary ditches, dams and other diversion and distributing works have been constructed, and water used as stated therein; that we have carefully read such proof of appropriation, and that each and every statement contained therein is true to the best of our knowledge and belief.

Marion Hook

Edna C. Johnson

Subscribed and sworn to before me this 23rd day of October, 1937.

Geneva Abrams

Notary Public for Oregon

My commission expires Nov. 23-1940

[NOTARIAL SEAL]



REPORT OF PERSON MAKING INSPECTION

(For use by representative of State Engineer)

I, Chester A. Cummings, do hereby certify that I have made an inspection of the works described herein and in Permit No. 11735, on the 25th day of June, 19340, and found the foregoing statements and descriptions of works to be accurate. In my opinion the appropriation has been completed to the extent of \_\_\_\_\_ and I recommend the issuance of a water right certificate for this amount. (Quantity of water in second-feet or acre-feet)

NOTE TO INSPECTORS

If conditions do not justify the above report by you, please return the proof without your signature, with a full report by letter.

Chester A. Cummings  
(Name)

(Title)

PROOF OF APPROPRIATION

Permit No. \_\_\_\_\_

Recording fee paid

Receipt No. \_\_\_\_\_

RECEIVED  
OCT 25 1937  
STATE ENGINEER  
SALEM, OREGON





SECTION

TOWNSHIP 35, RANGE 8W, W. M.

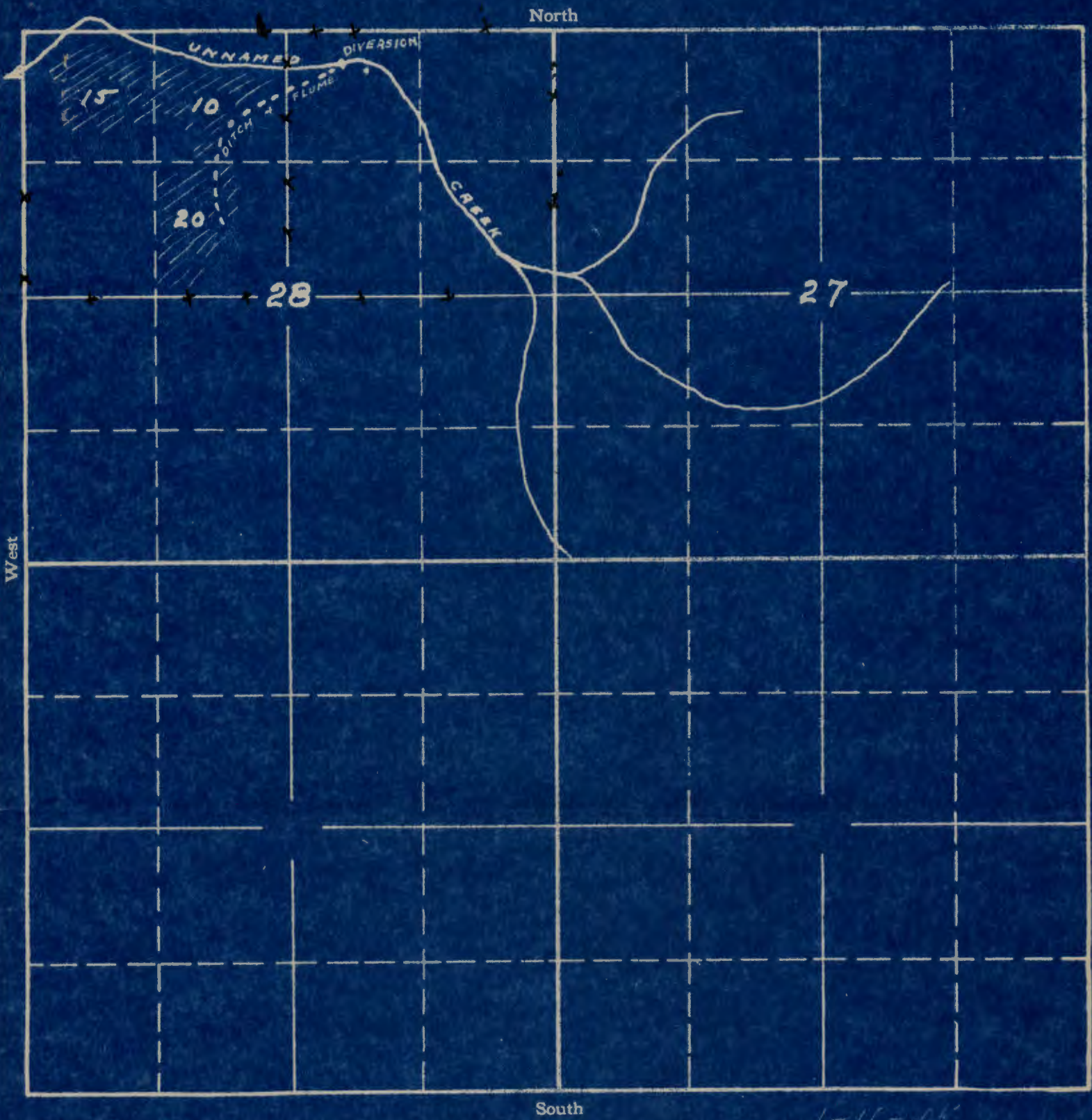

1-16-05

APPLICATION No. 15893

PERMIT No. 11735



Blaine Oreg. Feb. 5 - 1941

Form 103 mailed  
3/4/41

Chas. E. Stricklin  
State Engineer  
Salem Oregon

RECEIVED  
MAR 4 1941  
STATE ENGINEER  
SALEM, OREGON

Dear Sir:-

I enclosed find check for one dollar  
for recording fee on our waterright Permit  
No. 11735. The file No is 15893.

Thanking you very much for your interest  
and cooperation in helping us get this water  
right.

yours truly

Walter W. Cason



January 29, 1941

Mr. Walter W. Gason  
Blaine, Oregon

Dear Mr. Gason:

If you will submit the \$1.00 certificate recording fee, your water right under Permit No. 11735 will be confirmed by issuance of a certificate granting a right to the use of 0.29 second-foot of water for the irrigation of 22.7 acres in line with the survey made by Mr. Cummings of this office.

Very truly yours,

CHAS. E. STRICKLIN  
State Engineer

By

RE

Ed K. Humphrey, Assistant



February 16, 1940

Mr. Walter W. Cason  
Blaine, Oregon

Dear Sir:

This acknowledges receipt of Form C, being a notice of the complete application of water under Permit No. 11735.

The matter of issuance of the certificate under this permit will be given consideration after a representative from this office can make an inspection of the project covered by the permit, which probably will not be until spring, for the purpose of checking the irrigated acreage, location, etc., preparatory to final proof, which proof can cover only the acreage which has actually been irrigated. In the meantime, the permit which you hold will be valid and sufficient evidence of the water right.

Very truly yours,

CHAS. E. STRICKLIN  
State Engineer

By

RE

Ed K. Humphrey, Assistant



January 23, 1940

Mr. W. W. Cason  
Elaine, Oregon

Dear Sir:

Pursuant to the request contained in your letter of January 17th which was received in this office January 23rd, I am enclosing herewith a copy of our letter of December 14, 1939.

If you have not irrigated all of the land described in your permit which you intend to irrigate and if you wish to complete your appropriation, the only way you can place your permit in good standing is by submitting an application for an extension of time executed before a notary public, on the enclosed form as explained in our letter of December 14th.

Very truly yours,

CHAS. E. STRICKLIN  
State Engineer

By

Ed K. Humphrey, Assistant

EKH:RE  
encls.



15893

Blaine, Oreg Jan 17-1940

Charles E. Stricklin.

Salem, Oreg

RECEIVED

JAN 23 1940

STATE ENGINEER  
SALEM, OREGON

Dear Sir:

Will you please send me a copy of the letter  
sent me Dec 14. I think I wrote on the  
other side, maybe I didn't understand  
its meaning.

Very Truly yours

W. W. Cason



January 16, 1940

Mr. Walter W. Cason  
Blaine, Oregon

Dear Sir:

Action under your Permit No. 11735 has been suspended awaiting your advice as explained in our letter of December 14, 1939.

The time for completion as provided by the terms of this permit and the law under which it was issued, expired October 1, 1939.

Very truly yours,

CHAS. E. STRICKLIN  
State Engineer

By

EKH:RE

Ed K. Humphrey, Assistant



December 14, 1939

Mr. Walter W. Cason  
Blaine, Oregon

Dear Sir:

This will acknowledge receipt of your letter dated November 7th which was received in this office December 13th, relative to final proof under your Permit No. 11735.

As provided by Oregon law, final proof may be made under an irrigation permit covering the number of acres which have actually been irrigated so that if proof is made under a permit to irrigate 45 acres when only 30 acres have been irrigated, the other 15 acres described in the permit are automatically eliminated from the right and a certificate is issued covering the thirty acres which have actually been irrigated.

The time for complete application of water as extended under your permit, expired October 1, 1939 and if you had irrigated all of the land which you intend to irrigate on or before that date, you should so notify this office by filling in and submitting the enclosed Form C as explained to you in our letters of October 26th and November 28th. After receipt of this report, a survey will be made of your land by a representative of this office for the purpose of ascertaining the number of acres actually irrigated, on his next trip which will probably be made next spring.

If you have not irrigated all of the land which you intend to irrigate under your permit and if you desire an extension of time in which to complete your appropriation, you should execute before a notary public and submit to this office the enclosed application for an extension of time.

Very truly yours,

CHAS. E. STRICKLIN  
State Engineer

By

EKH:RE  
encls.

Ed K. Humphrey, Assistant



11-7-39  
W.W. Casson

15893

State Engineer

Salem Oregon

Dear Sir,

RECEIVED

DEC 13 1939

STATE ENGINEER  
SALEM, OREGON

In regard to my water right I am  
Ready to prove up but I don't just under  
stand this stream does not afford water  
Enough to irrigate the land stated in  
The application but from now on until  
probably 1st of July will have enough,  
if gets as low as much in the flow.  
now I want to finish but am asking your  
advise if you are in a position the stream  
bears so much in season I hope  
you can get my meaning.

Very Truly  
W.W. Casson



November 28, 1939

Mr. Walter W. Cason  
Blaine, Oregon

Dear Sir:

If it is your intention to complete your water right under Permit No. 11735 and if you have irrigated all of the lands described under the permit which you intend to irrigate, you should fill out and submit the enclosed Forms B and C as explained in our letter of October 26th.

If you have not completed your project, you should submit an application for an extension of time by executing before a notary public and submitting to this office the enclosed blank since the time for completion under this permit expired October 1, 1939. If you have reconsidered the matter of your proposed appropriation and do not intend to complete it, your advice to that effect and your authorization to cancel the permit will be appreciated.

Very truly yours,

CHAS. E. STRICKLIN  
State Engineer

By

EKH:RE  
encls.

Ed K. Humphrey, Assistant



October 26, 1939

Mr. Walter W. Cason  
Blaine, Oregon

Dear Sir:

This will acknowledge receipt of your letter of October 12th with which you enclosed your Permit No. 11735.

Relative to your statement that you are ready to make final proof, if you have completed construction and completely applied the water to the use described in your permit, namely, the irrigation of 45 acres or if you have irrigated all of the land under your permit which you intend to irrigate, you should fill out and mail to this office the enclosed Forms B and C.

If it is your intention to construct a dam and store water for future use, you will wish to file an application for a permit to construct a reservoir and store water and to appropriate the stored water, and for your convenience in so doing, I am enclosing blanks herewith, together with a four-section plat and a copy of the Rules and Regulations of the State Engineer. Definite instructions for filling out the applications and preparing the map which must accompany them will be found in the Rules and Regulations in which you will also find a complete list of the statutory fees.

I am also enclosing herewith your permit which should be held by you as evidence of your water right prior to the issuance of certificate.

Very truly yours,

CHAS. E. STRICKLIN  
State Engineer

By

EKH:RE  
encls.

Ed K. Humphrey, Assistant



Oct. 12 - 1939

Blaine Ore

State Engineer

Salem Ore

15892

RECEIVED

OCT 16 1939

STATE ENGINEER  
SALEM, OREGON

Dear Sir:-

I am sending you permit no. 11835.  
Work all complete and ready for  
Final proof, as the project stands  
It is rather complicated in winter I  
have too much water and during irrigating  
season not enough. but I am anxious  
to get water right secured.

Very Truly yours

W.W. Cason

P.S. I have a location a dam and storage  
of water for Irrigation in dry season  
if this comes under your head please advise  
me.



July 19, 1938.

Mr. Walter W. Cason,  
Blaine, Oregon.

Dear Sir:

This acknowledges receipt of your letter of July 7 in which you request an extension of time under your Permit No. 11735.

It appears from the statements contained in your letter and from the inspection made by Mr. Cummings of this office that you are showing reasonable diligence in the prosecution of work. The time limits for the completion of construction and complete application of water are therefore being extended until October 1, 1939.

Very truly yours,

CHAS. E. STRICKLIN,  
State Engineer.

By  
Ed K. Humphrey, Assistant.

LN



Blaine Oreg. July 7, 1938.

Mr. Chas. E. Stricklin, State Engineer  
Salem Oregon.

RECEIVED  
JUL 15 1938  
STATE ENGINEER  
SALEM, OREGON

Dear Sir:-

Would you please give me a years  
extension on my water right as I'll have to  
change <sup>some of</sup> my ditches as the ground in some  
places washes and slides so much and I  
want to put in some more flume too  
My file No is 15893. And my permit No  
is 11735-

Yours truly

Walter W. Cason  
Blaine  
Oreg.

Extend one year

Cummings has inspected  
and recommends extension



November 2, 1937.

Mr. Walter W. Cason,  
Blaine, Oregon.

Dear Sir:

This acknowledges receipt of the final  
proof blank under your Permit No. 11735.

Before a certificate can be issued in  
confirmation of this right, it is necessary that  
an inspection of the development be made by a  
representative of this office. This inspection  
will be made in the near future.

Yours very truly,

CHAS. E. STRICKLIN,  
State Engineer.

By  
Ed K. Humphrey, Assistant.



May 27, 1936.

Mr. W. W. Cason,  
Blaine, Oregon.

Dear Sir:

This is in reply to your letter of May 22 pertaining to your Permit No. 11735.

The law provides that the State Engineer shall limit the right under a certificate to that number of acres which has actually been irrigated when proof is made. Therefore, if you have not yet irrigated all of the lands which you expect to, you should not make proof at this time.

The time limit for the completion of construction expires under this permit on October 1, 1937, and for complete application of water on October 1, 1938, so that it appears you should have sufficient time to completely apply the water to all of the lands desired.

I am suspending action under your permit until October 1, 1937, but if you are able to irrigate all of the lands in the meantime, you should submit proof so that a certificate can be issued.

Very truly yours,

CHAS. E. STRICKLIN,  
State Engineer.

By  
V. S. Bovelle, Assistant.

VSB:LN



Plains, Oreg May 22-36

Mr Chas. E. Stricklin

RECEIVED  
MAY 26 1936

STATE ENGINEER  
SALEM, OREGON

Salmon

Dear Sir,

In answer to yours of 21<sup>st</sup> the reason is

In your letter of Oct. 23<sup>rd</sup> states actual no. of acres irrigated must be given in irrigation season. By stepping or chaining, well I did not have that last year (1935) as the water supply was low. So I thought that I would wait until this year and see just how the water checked out. From last year.

This is a small mountain stream high in rainy season and gets low in dry season. Really it I don't think is going to carry as much in dry season as I thought. Now if you advise I will go ahead and fill out the bank and send it in we have it practically made out now.

Hoping this will be satisfactory and expect an early reply.

Very Truly yours

W. W. Cason

Plains  
Oregon



15893

August 16, 1935

Mr. Walter W. Cason  
Blaine, Oregon

Dear Sir:

Herewith you will find Application No. 15893, Permit No. 11755, together with blue print.

This application has been approved and recorded in this office.



July 11, 1935.

Mr. Walter W. Cason,  
Blaine, Oregon.

Dear Sir:

Your letter dated July 5th has been received and the proper corrections have been made to your Application No. 15893. The application is now considered to be in satisfactory form and is being placed in line for approval and issuance of a permit.

Very truly yours,

CHAS. E. STRICKLIN,  
State Engineer.

By V. S. Bovellev, Assistant.



CHAS. E. STRICKLIN, STATE ENGINEER  
STATE HYDROELECTRIC COMMISSION  
HYDROELECTRIC COMMISSION OF OREGON

STATE OF OREGON  
OFFICE OF THE  
STATE ENGINEER  
WATER RESOURCES DEPARTMENT  
SALEM

ADDRESS ALL COMMUNICATIONS  
CHAS. E. STRICKLIN, STATE ENGINEER  
SALEM, OREGON

AND REFER TO FILE NO. 15893

July 2, 1935.

Mr. Walter W. Cason,  
Blaine, Oregon.

Dear Sir:

The map showing the point of diversion and place of use under your Application No. 15893 has been received, but it would appear that the lands which you have shaded do not agree with the lands described in your application.

The application indicates that 15 acres are to be irrigated in the SW $\frac{1}{4}$ NW $\frac{1}{4}$  of Section 28, while the map indicates that land will be irrigated in the NW $\frac{1}{4}$ NW $\frac{1}{4}$  of said section but not in the SW $\frac{1}{4}$ NW $\frac{1}{4}$ . I am therefore returning the map with the request that you kindly advise regarding the location of the 15 acres in question. If it will be necessary to correct the application I will be glad to do so upon your request.

As soon as the map is returned with this information the matter of issuing a permit will be given consideration.

Very truly yours,

CHAS. E. STRICKLIN,  
State Engineer

By

*V. E. Bovel*  
V. E. Bovel, Assistant.

RECEIVED  
JUL 11 1935  
STATE ENGINEER  
SALEM, OREGON

*Blaine Ore July 5, 1935*

VSBS:LN  
encl.

*Mr Charles E. Stricklin.*

*Dear Sir.*

*I see we made the error in the application  
& map is correct and I am sending the  
map back and you can make the proper  
change Very Truly Yours W.W. Cason*

*Correction made  
Appl OK*



July 2, 1935.

Mr. Walter W. Cason,  
Blaine, Oregon.

Dear Sir:

The map showing the point of diversion and place of use under your Application No. 15893 has been received, but it would appear that the lands which you have shaded do not agree with the lands described in your application.

The application indicates that 15 acres are to be irrigated in the SW $\frac{1}{4}$ NW $\frac{1}{4}$  of Section 28, while the map indicates that land will be irrigated in the NW $\frac{1}{4}$ NW $\frac{1}{4}$  of said section but not in the SW $\frac{1}{4}$ NW $\frac{1}{4}$ . I am therefore returning the map with the request that you kindly advise regarding the location of the 15 acres in question. If it will be necessary to correct the application I will be glad to do so upon your request.

As soon as the map is returned with this information the matter of issuing a permit will be given consideration.

Very truly yours,

CHAS. E. STRICKLIN,  
State Engineer.

By  
V. S. Bovelle, Assistant.

VSB:LN  
encl.



June 26, 1935.

Mr. Walter W. Cason,  
Blaine, Oregon.

Dear Sir:

This acknowledges receipt of your application for permit to appropriate water from an unnamed stream for the irrigation of 45 acres, together with your remittance in the sum of \$11.75 as fees. Receipt No. 18852 is enclosed.

The application, which has been filed and given No. 15893, appears to be in satisfactory form, but since the map submitted with it does not give all of the desired information, a new sketch has been prepared from your map, which is being returned for some additional information. The location of the lands to be irrigated should be shown by shading that portion of Section 28 upon which the water is to be used.

As soon as the map is returned with this information, the matter of issuing a permit will be given consideration.

Very truly yours,

CHAS. E. STRICKLIN,  
State Engineer.

By  
V. S. Bovelie, Assistant.

VSB:LN  
encls.



May 20, 1935

Mr. Walter W. Cason  
Blaine, Oregon

Dear Sir:

Your application for permit to appropriate 3 second-feet of water from an unnamed stream for irrigation purposes has been received, but due to your failure to remit the statutory examination fee of \$5.00, it has been impossible to file it. It has been checked over, however, and is being returned for some additional information.

The location of the point of diversion as described under Item 4, does not appear to agree entirely with that shown on the map. If the center of Section 28, is as I have indicated, the point of diversion would appear to be approximately 600 feet East and 300 feet South of the North quarter corner of Section 28, but if the entire plat is to indicate Section 29, the point of diversion would appear to be approximately 150 feet South and 1370 feet East from the Northwest corner of the NW $\frac{1}{4}$  of Section 28.

The smallest legal subdivision or forty-acre tract within which the point of diversion will lie and within which the flume will terminate must be shown under Items 4 and 5. The number of acres which are to be irrigated in each smallest legal subdivision or forty-acre tract must be listed under Item 8, and the location must be shown on the map.

The fees required for an application of this nature are \$5.00 for examination and \$6.75 for recording for 45 acres, which is at the rate of 15 cents per acre. When the application is submitted with the proper fees it will be filed and if found to be in satisfactory form will be placed in line for approval and issuance of a permit.

Very truly yours

CHAS. E. STRICKLIN  
State Engineer

By  
V. S. Bovellev, Ass't.

VSB EL







DESCRIPTION OF WORKS

9. (a) If a dam has been constructed, give description: Height, .....ft.; length on top, .....ft.; length on bottom .....ft.; material used and character of construction, .....

(b) Give description of headgate: Width, .....ft.; depth, .....ft.; material used and character of construction, .....

(c) Size of canal: Width on top (at waterline) .....ft.; width on bottom, .....ft.; depth of water, .....ft.; grade, .....ft. fall per 1,000 ft. Actual capacity, ..... sec.-ft.

Give general description: .....

(d) Pipe line: Description of intake, .....

Length of pipe, .....ft.; size at intake, .....in.; size at .....ft. from intake, .....in.; size at place of use, .....in. Difference in elevation between intake and place of use, .....ft.

Is grade uniform? ..... Actual capacity of pipe line, ..... sec.-ft.

Give general description: .....

(Material: Steel, wrought, cast iron, wood stave, etc.)

(e) Pumping plant: Give size and type of pump, .....

Suction lift, .....ft.; discharge lift, .....ft. Type of motor used .....

Horse power rating, ..... H. P. Actual capacity of pump, ..... sec.-ft.

10. During what months is water beneficially used? .....

11. State character of soil .....

Kind of crops raised .....

12. Does the accompanying map, filed with your application, show correctly the point of diversion, area of land irrigated, or place of use? .....

13. If not, wherein is such map in error? .....

14. Domestic use: Give number of families actually using water at this time .....

15. If for power, mining, municipal, manufacturing, storage or any other purpose than irrigation, give extent and method of such use .....



AFFIDAVIT OF APPROPRIATOR

STATE OF OREGON,

County of .....

} ss.

I, ....., being first duly sworn, depose and say that I have read the above and foregoing proof of appropriation of water; that I know the contents thereof, and that the facts therein stated are true.

IN WITNESS WHEREOF, I have hereunto set my hand this ..... day of ....., 193.....

Subscribed and sworn to before me this ..... day of ....., 193.....

[NOTARIAL SEAL]

My commission expires .....

Notary Public for Oregon

AFFIDAVIT OF WITNESSES

STATE OF OREGON,

County of .....

} ss.

We, ....., and .....

of ....., being first duly sworn, depose and say that we are well acquainted with the facts and conditions set forth in the foregoing statement relative to proof of appropriation of water under Permit No.....; that we and each of us have been over and upon each tract described in said proof, and from such personal inspection have knowledge that all necessary ditches, dams and other diversion and distributing works have been constructed, and water used as stated therein; that we have carefully read such proof of appropriation, and that each and every statement contained therein is true to the best of our knowledge and belief.

Subscribed and sworn to before me this ..... day of ....., 193.....

[NOTARIAL SEAL]

My commission expires .....

Notary Public for Oregon



REPORT OF PERSON MAKING INSPECTION

(For use by representative of State Engineer)

[NOTARIAL SEAL]

My Commission Expires

I, \_\_\_\_\_, do hereby certify that I have made an inspection of the works described herein and in Permit No. \_\_\_\_\_, on the \_\_\_\_\_ day of \_\_\_\_\_, 193\_\_\_\_, and found the foregoing statements and descriptions of works to be accurate. In my opinion the appropriation has been completed to the extent of \_\_\_\_\_ and I recommend the issuance of a water right certificate for this amount.

(Quantity of water in second-feet or acre-feet)

NOTE TO INSPECTORS

(Name)

If conditions do not justify the above report by you, please return the proof without your signature, with a full report by letter.

(Title)

PROOF OF APPROPRIATION

Permit No. \_\_\_\_\_

Recording fee paid

Receipt No. \_\_\_\_\_

ATTEST: \_\_\_\_\_

[NOTARIAL SEAL]

My Commission Expires



SECTION

TOWNSHIP 35, RANGE 8W, W. M.

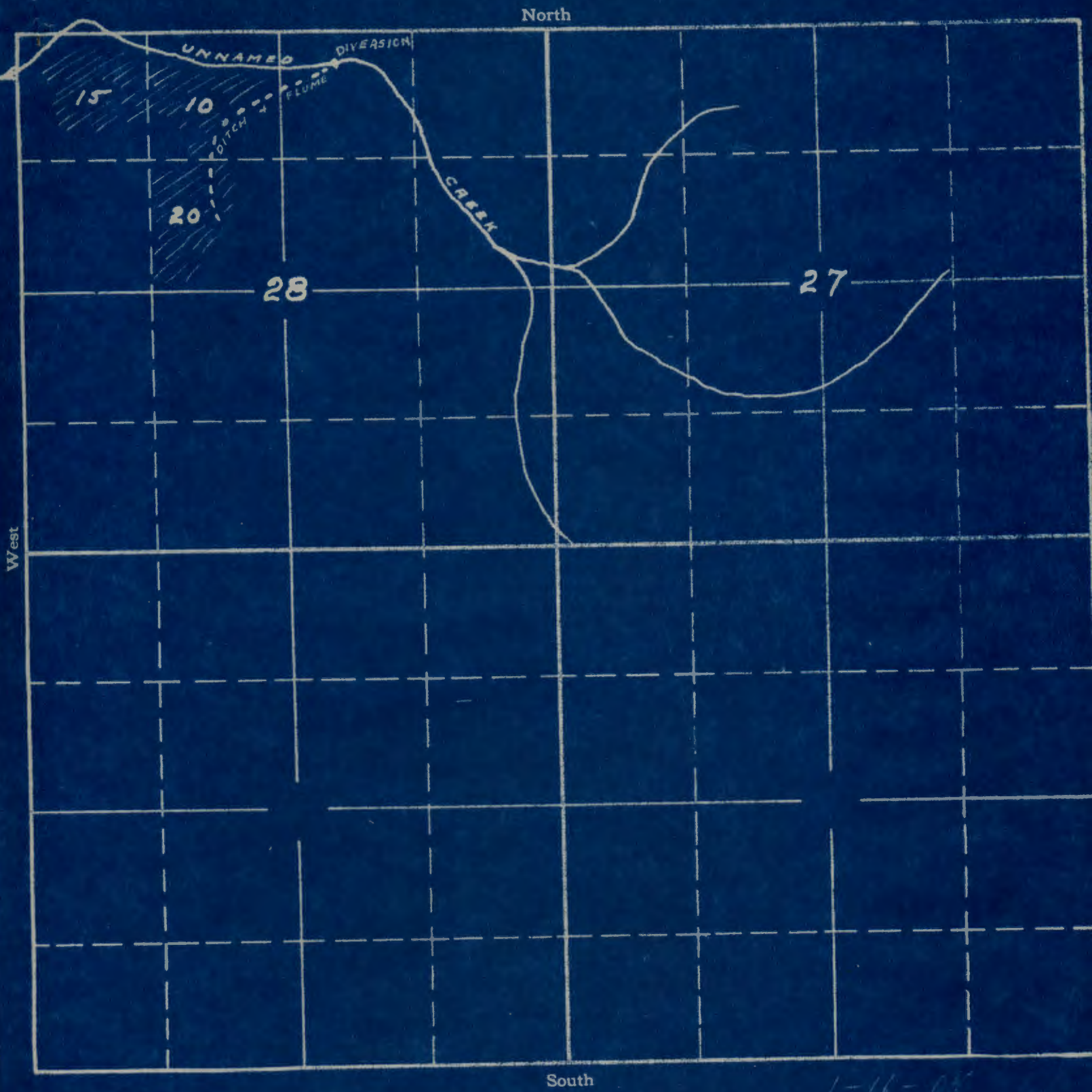

1-10-05

APPLICATION No. 15893  
PERMIT No. 11735



SECTION

28

TOWNSHIP 3 South RANGE 8 West, W. M.

EAST CREEK

North

28 I.P.

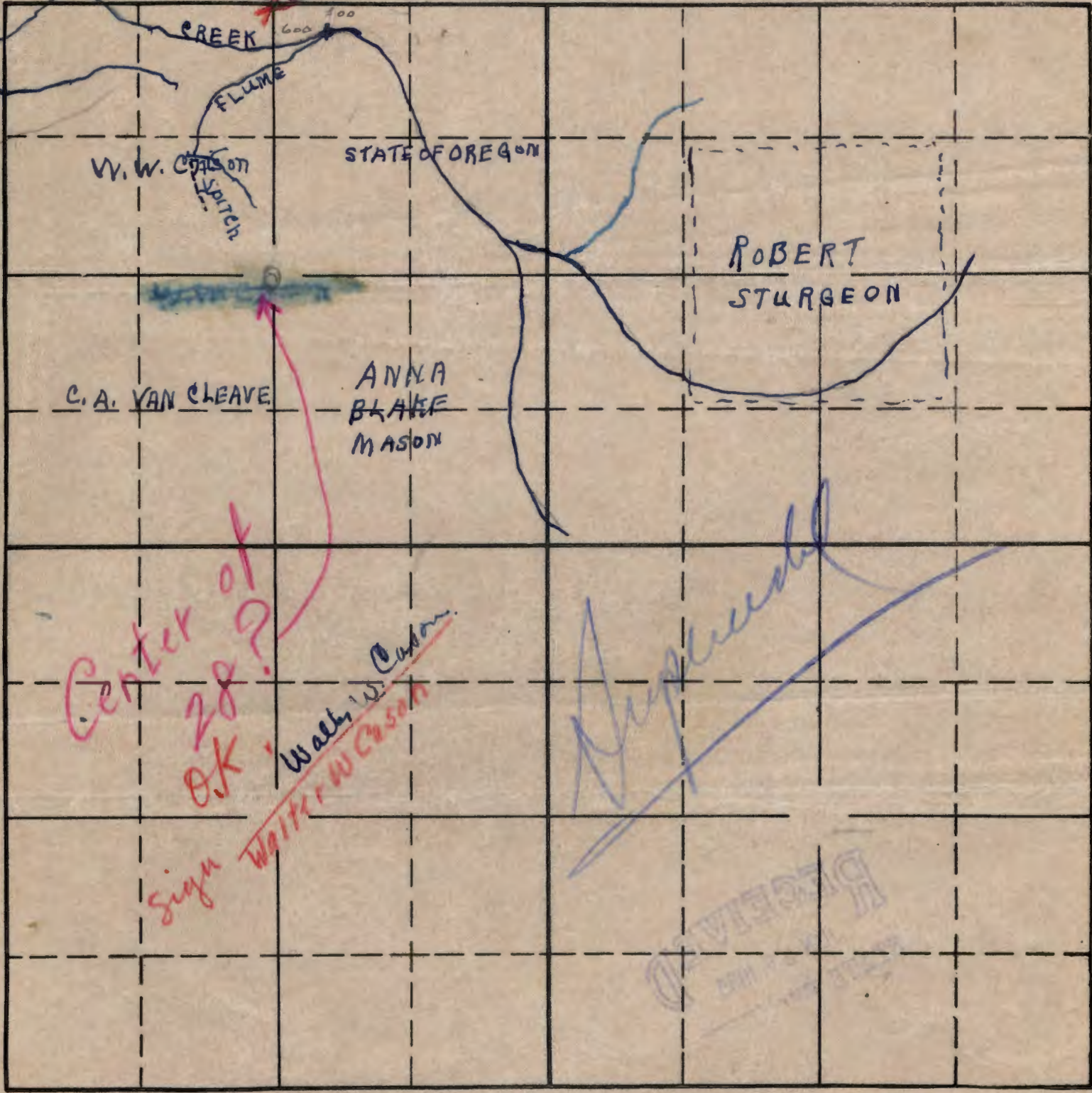

West

East

Center of 28?  
OK  
sign walk W. W. Coalson

*[Handwritten signature]*

RECEIVED

South

1-16-15893

APPLICATION No.

PERMIT No.

STATE OF OREGON  
DEPARTMENT OF WATER RESOURCES  
Salem, Oregon



**\*APPLICATION FOR A PERMIT**

**To Appropriate the Public Waters of the State of Oregon**

I, WALTER W. CASOM  
(Name of applicant)  
of BLAINE  
(Postoffice), County of TILLAMOOK,  
State of OREGON, do hereby make application for a permit to appropriate the  
following described public waters of the State of Oregon, **SUBJECT TO EXISTING RIGHTS:**

If the applicant is a corporation, give date and place of incorporation .....

1. The source of the proposed appropriation is unnamed stream  
(Name of stream), a tributary of EAST CREEK NESTUCA RIVER

2. The amount of water which the applicant intends to apply to beneficial use is 3, three  
cubic feet per second.  
(If water is to be used from more than one source, give quantity from each)

\*\*3. The use to which the water is to be applied is irrigation  
(Irrigation, power, mining, manufacturing, domestic supplies, etc.)

4. The point of diversion is located 900 ft. south and 1370 ft. east from the N. E.  
(N. or S.) (E. or W.)  
corner of the NORTH WEST QUARTER OF SECTION 28 RANGE  
(Section or subdivision)  
3, SOUTH 8 WEST  
(If preferable, give distance and bearing to section corner)

(If there is more than one point of diversion, each must be described. Use separate sheet if necessary)

being within the NORTH EAST Quarter of Sec. 28, Tp. 3 South  
(Give smallest legal subdivision) (N. or S.)  
R. WEST, W. M., in the county of TILLAMOOK Ditch 3 1/2 ft wide 16 in deep  
(E. or W.)

5. The flume (Main ditch, canal or pipe line) to be 19.50 feet 300 ditch  
(Miles feet)  
in length, terminating in the NORTH WEST Quarter of Sec. 28, Tp. 3 SOUTH  
(Smallest legal subdivision) (N. or S.)  
R. 8 WEST, W. M., the proposed location being shown throughout on the accompanying map.  
(E. or W.)

**DESCRIPTION OF WORKS**

**DIVERSION WORKS—**

6. (a) Height of dam 1 foot 6 inches, length on top 8 feet, length at bottom  
8 feet; material to be used and character of construction loose rock and  
(Loose rock, concrete, masonry,  
earth  
rock and brush, timber crib, etc., wasteway over or around dam)

(b) Description of headgate timber, two case, 8 inches by  
(Timber, concrete, etc., number and size of openings)  
12 inches

(c) If water is to be pumped give general description .....

(Size and type of pump)

(Size and type of engine or motor to be used, total head water is to be lifted, etc.)

\* A different form of application is provided where storage works are contemplated.

\*\* Applications for permits to appropriate water for the generation of electricity, with the exception of municipalities, must be made to the Hydroelectric Commission. Either of the above forms may be secured, without cost, together with instructions by addressing the State Engineer, Salem, Oregon.



CANAL SYSTEM OR PIPE LINE—

7. (a) Give dimensions at each point of canal where materially changed in size, stating miles from headgate. At headgate: width on top (at water line) 8 inches ~~feet~~; width on bottom 8 inches ~~feet~~; depth of water 1 feet; grade 5 feet fall per one thousand feet.

(b) At 30 feet ~~miles~~ from headgate: width on top (at water line) 12 inches ~~feet~~; width on bottom 12 inches ~~feet~~; depth of water 11 inches ~~feet~~; grade 5 feet fall per one thousand feet.

(c) Length of pipe, \_\_\_\_\_ ft.; size at intake, \_\_\_\_\_ in.; size at \_\_\_\_\_ ft. from intake \_\_\_\_\_ in.; size at place of use \_\_\_\_\_ in.; difference in elevation between intake and place of use, \_\_\_\_\_ ft. Is grade uniform? \_\_\_\_\_ Estimated capacity, \_\_\_\_\_ sec. ft.

8. Location of area to be irrigated, or place of use all in NORTHWEST  $\frac{1}{4}$  of 28.

Township	Range	Section	Forty-acre Tract	Number Acres To Be Irrigated
3 SOUTH	8 WEST	28		✓

(If more space required, attach separate sheet)

(a) Character of soil hill land - loam - not rocky

(b) Kind of crops raised hay and pasture, for dairy cattle

POWER OR MINING PURPOSES—

9. (a) Total amount of power to be developed \_\_\_\_\_ theoretical horsepower.

(b) Quantity of water to be used for power \_\_\_\_\_ sec. ft.

(c) Total fall to be utilized \_\_\_\_\_ feet.  
(Head)

(d) The nature of the works by means of which the power is to be developed \_\_\_\_\_

(e) Such works to be located in \_\_\_\_\_ of Sec. \_\_\_\_\_  
(Legal subdivision)

Tp. \_\_\_\_\_, R. \_\_\_\_\_, W. M. \_\_\_\_\_  
(No. N. or S.) (No. E. or W.)

(f) Is water to be returned to any stream? \_\_\_\_\_  
(Yes or No)

(g) If so, name stream and locate point of return \_\_\_\_\_  
\_\_\_\_\_, Sec. \_\_\_\_\_, Tp. \_\_\_\_\_, R. \_\_\_\_\_, W. M. \_\_\_\_\_  
(No. N. or S.) (No. E. or W.)

(h) The use to which power is to be applied is \_\_\_\_\_

(i) The nature of the mines to be served \_\_\_\_\_



MUNICIPAL OR DOMESTIC SUPPLY—

10. (a) To supply the city of .....

..... County, having a present population of .....  
(Name of)  
and an estimated population of ..... in 193.....

(b) If for domestic use state number of families to be supplied .....

(Answer questions 11, 12, 13, and 14 in all cases)

11. Estimated cost of proposed works, \$ 4.50

12. Construction work will begin on or before FEBRUARY 15, 1935

13. Construction work will be completed on or before JULY 15, 1935

14. The water will be completely applied to the proposed use on or before JULY 30, 1935

x Walter W. Cason

(Signature of applicant)

Signed in the presence of us as witnesses:

(1) Paul W. Johnson, Tillamook Oregon  
(Name) (Address of witness)

(2) Edna C. Johnson, Tillamook Oreg.  
(Name) (Address of witness)

Remarks: There are no other families living in this section or above above here on this watershed of this creek. There will be about 4.5 acres irrigated by this flume.

STATE OF OREGON, }  
County of Marion, } ss.

This is to certify that I have examined the foregoing application, together with the accompanying maps and data, and return the same for .....

In order to retain its priority, this application must be returned to the State Engineer, with corrections on or before ....., 193.....

WITNESS my hand this ..... day of ....., 193.....

STATE ENGINEER

RECEIVED  
JUN 25 1935  
STATE ENGINEER  
SALEM, OREGON



RECEIVED  
MAY 15 1935  
STATE ENGINEER  
SALEM, OREGON

STATE OF OREGON, }  
County of Marion. } ss.

PERMIT

This is to certify that I have examined the foregoing application and do hereby grant the same, subject to existing rights and the following limitations and conditions:

The right herein granted is limited to the amount of water which can be applied to beneficial use and shall not exceed ..... cubic feet per second measured at the point of diversion from the stream, or its equivalent in case of rotation with other water users, from .....

The use to which this water is to be applied is .....

If for irrigation, this appropriation shall be limited to ..... of one cubic foot per second .....

and shall be subject to such reasonable rotation system as may be ordered by the proper state officer.

The priority date of this permit is .....

Actual construction work shall begin on or before ..... and shall thereafter be prosecuted with reasonable diligence and be completed on or before .....

Complete application of the water to the proposed use shall be made on or before .....

WITNESS my hand this ..... day of ....., 1935

STATE ENGINEER

Permits for power development are subject to the payment of annual fees as provided in sections 1 and 2, chapter 74, Session Laws of 1933.

Application No. 15892

Permit No. ....

PERMIT

TO APPROPRIATE THE PUBLIC  
WATERS OF THE STATE  
OF OREGON

Division No. .... District No. ....

This instrument was first received in the  
office of the State Engineer at Salem, Oregon,  
on the 25th day of June  
1935, at 8:00 o'clock A. M.

Returned to applicant: .....

Corrected application received: .....

Approved: *[Signature]*

Recorded in book No. .... of .....

Permits on page .....

STATE ENGINEER

Drainage Basin No. 1 Page 16

Fees Paid .....