

Human Consumption Application

34S-1W-15-SE/NW Taxlot 204

POD 1970' South & 2015' East of the NW corner of Section 15

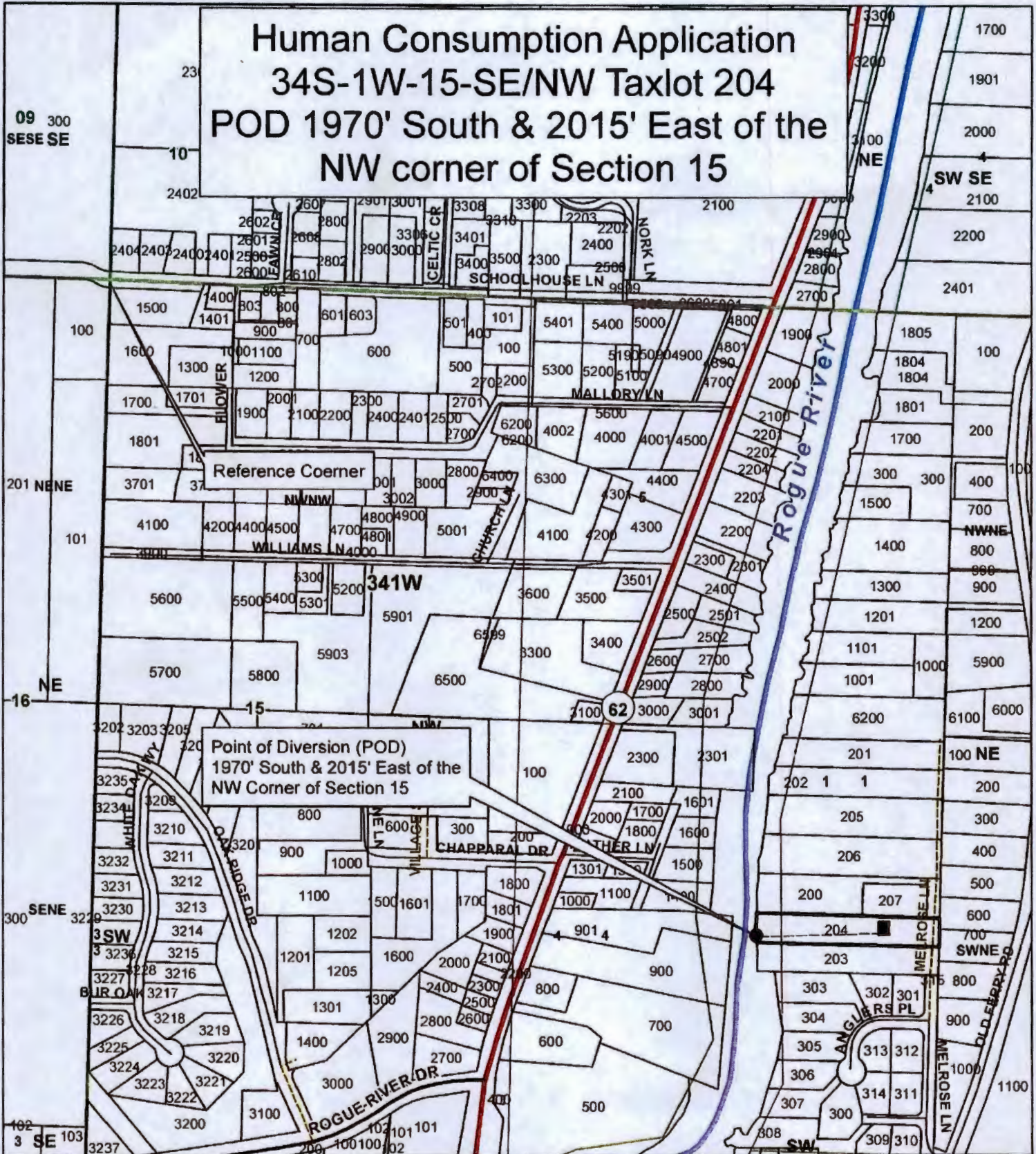

Point of Diversion (POD)
1970' South & 2015' East of the
NW Corner of Section 15

Legend

- Townships
- Taxlot 204
- Sections
- Quarter Sections
- Quarter Quarter Sections
- Taxlots
- POD
- pipe line
- House (Human Consumption)

1 inch = 400 feet

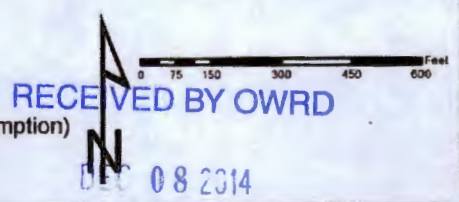

JACKSON COUNTY
WATERMASTER

Prepared by Travis Kelly

This map is based on a digital database compiled by Jackson County from a variety of sources. Jackson County cannot accept responsibility for errors, omissions, or positional accuracy. There are no warranties, expressed or implied.

Date: 11/24/2014, 34S-1W-15-204.inxd, Kelly/TN

S-88037

SALEM, OR