

**Oregon Water Resources Department  
Water Right Services Division**

Water Rights Application  
Number G-17738

**Final Order**

*Appeal Rights*

This is a Final Order in other than contested case. This order is subject to judicial review under ORS 183.484. Any petition for judicial review must be filed within the 60 day time period specified by ORS 183.484(2). Pursuant to ORS 536.075 and OAR 137-004-0080 you may either petition for judicial review or petition the Director for reconsideration of this order. A petition for reconsideration may be granted or denied by the Director, and if no action is taken within 60 days following the date the petition was filed, the petition shall be deemed denied.

This statement of judicial review rights does not create a right to judicial review of this order, if judicial review is otherwise precluded by law. Where no changes have been made to a Proposed Final Order on a water right application and no protests have been filed during the protest period, the Final Order is not subject to judicial review.

*Findings of Fact*

On November 19, 2013, Jake Madison and Madison Ranches submitted an application to the Department for a water use permit. The Department issued a Proposed Final Order on November 11, 2014. The protest period closed December 26, 2014, and no protest was filed.

On December 23, 2014, the applicant submitted written authorization permitting access to lands not owned by them as requested in the Proposed Final Order.

*Conclusions of Law*

The proposed use would not impair or be detrimental to the public interest pursuant to ORS 537.621(2).

**Order**

Application G-17738 therefore is approved as proposed by the Proposed Final Order, and Permit G-17345 is issued as limited by the conditions proposed by the Proposed Final Order.

**DATED February 9, 2015**

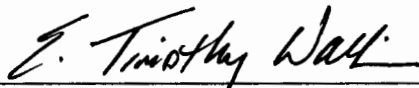

---

E. Timothy Wallin, Water Rights Program Manager  
for Thomas M. Byler, Director

*This document was prepared by Kim French. If you have any questions about any of the statements contained in this document I am most likely the best person to answer your questions. You can reach me at 503-986-0816.*

*If you have previously filed a protest and want to know its status, please contact Patricia McCarty at 503-986-0820.*

*If you have other questions about the Department or any of its programs please contact our Customer Service Group at 503-986-0801.*

*Address all other correspondence to: Water Rights Section, Oregon Water Resources Department, 725 Summer St NE Ste A, Salem OR 97301-1266, Fax: 503-986-0901.*

STATE OF OREGON

COUNTY OF UMATILLA

PERMIT TO APPROPRIATE THE PUBLIC WATERS

THIS PERMIT IS HEREBY ISSUED TO

MADISON RANCHES  
JAKE MADISON  
29299 MADISON RD  
ECHO, OR 97826

The specific limits and conditions of the use are listed below.

APPLICATION FILE NUMBER: G-17738

SOURCE OF WATER: WELL 1 THROUGH WELL 7 IN COLUMBIA RIVER BASIN

PURPOSE OR USE: PRIMARY IRRIGATION OF 1128.9 ACRES AND SUPPLEMENTAL IRRIGATION OF 8013.5 ACRES

MAXIMUM RATE: 22.3 CUBIC FEET PER SECOND

PERIOD OF USE: MARCH 1 THROUGH OCTOBER 31

DATE OF PRIORITY: NOVEMBER 19, 2013

WELL LOCATION:

WELL 1: SE  $\frac{1}{4}$  SW  $\frac{1}{4}$ , SECTION 1, T4N, R25E, W.M.; 1230 FEET NORTH AND 1330 FEET EAST FROM SW CORNER, SECTION 1

WELL 2: SE  $\frac{1}{4}$  SW  $\frac{1}{4}$ , SECTION 1, T4N, R25E, W.M.; 120 FEET NORTH AND 2500 FEET EAST FROM SW CORNER, SECTION 1

WELL 3: NW  $\frac{1}{4}$  SE  $\frac{1}{4}$ , SECTION 1, T4N, R25E, W.M.; 1500 FEET NORTH AND 2660 FEET EAST FROM SW CORNER, SECTION 1

WELL 4: SW  $\frac{1}{4}$  NE  $\frac{1}{4}$ , SECTION 1, T4N, R25E, W.M.; 2878 FEET NORTH AND 3120 FEET EAST FROM SW CORNER, SECTION 1

WELL 5: NW  $\frac{1}{4}$  NE  $\frac{1}{4}$ , SECTION 12, T4N, R25E, W.M.; 740 FEET SOUTH AND 1860 FEET WEST FROM NE CORNER, SECTION 12

WELL 6: NW  $\frac{1}{4}$  NE  $\frac{1}{4}$ , SECTION 12, T4N, R25E, W.M.; 150 FEET SOUTH AND 1780 FEET WEST FROM NE CORNER, SECTION 12

WELL 7: NE  $\frac{1}{4}$  SE  $\frac{1}{4}$ , SECTION 1, T4N, R25E, W.M.; 2500 FEET NORTH AND 100 FEET WEST FROM SE CORNER, SECTION 1

The amount of water used for irrigation under this right, together with the amount secured under any other right existing for the same lands, is limited to a diversion of ONE-FORTIETH of one cubic foot per second and 4.5 acre-feet for each acre irrigated during the irrigation season of each year.

THE PLACE OF USE IS LOCATED AS FOLLOWS:

<u>OO</u>	<u>PRIMARY</u>	<u>SUPPLEMENTAL</u>
NW ¼ NW ¼		4.55 ACRES
SECTION 1		
TOWNSHIP 2 NORTH, RANGE 27 EAST, W.M.		
NE ¼ NE ¼		31.3 ACRES
NW ¼ NE ¼		31.3 ACRES
SW ¼ NE ¼		31.2 ACRES
SE ¼ NE ¼		31.2 ACRES
NE ¼ NW ¼		31.3 ACRES
NW ¼ NW ¼		31.3 ACRES
SW ¼ NW ¼		31.2 ACRES
SE ¼ NW ¼		31.2 ACRES
NE ¼ SW ¼		31.3 ACRES
NW ¼ SW ¼		31.3 ACRES
SW ¼ SW ¼		31.2 ACRES
SE ¼ SW ¼		31.2 ACRES
NE ¼ SE ¼		31.3 ACRES
NW ¼ SE ¼		31.3 ACRES
SW ¼ SE ¼		31.2 ACRES
SE ¼ SE ¼		31.2 ACRES
SECTION 5		
NE ¼ NE ¼		31.3 ACRES
NW ¼ NE ¼		31.3 ACRES
SW ¼ NE ¼		31.2 ACRES
SE ¼ NE ¼		31.2 ACRES
NE ¼ NW ¼		35.5 ACRES
NW ¼ NW ¼		35.5 ACRES
SW ¼ NW ¼		25.7 ACRES
SE ¼ NW ¼		25.7 ACRES
SECTION 6		
NE ¼ NE ¼		40.0 ACRES
NW ¼ NE ¼		40.0 ACRES
SW ¼ NE ¼		40.0 ACRES
SE ¼ NE ¼		40.0 ACRES
SECTION 7		
TOWNSHIP 2 NORTH, RANGE 28 EAST, W.M.		

<u>OO</u>	<u>PRIMARY</u>	<u>SUPPLEMENTAL</u>
NE ¼ NE ¼		31.3 ACRES
NW ¼ NE ¼		31.3 ACRES
SW ¼ NE ¼		31.2 ACRES
SE ¼ NE ¼		31.2 ACRES
NE ¼ NW ¼		40.0 ACRES
NW ¼ NW ¼		40.0 ACRES
SW ¼ NW ¼		40.0 ACRES
SE ¼ NW ¼		40.0 ACRES
NE ¼ SW ¼		40.0 ACRES
NW ¼ SW ¼		40.0 ACRES
SW ¼ SW ¼		40.0 ACRES
SE ¼ SW ¼		40.0 ACRES
NE ¼ SE ¼		40.0 ACRES
NW ¼ SE ¼		40.0 ACRES
SW ¼ SE ¼		40.0 ACRES
SE ¼ SE ¼		40.0 ACRES

## SECTION 8

NE ¼ NW ¼	40.0 ACRES
NW ¼ NW ¼	40.0 ACRES
SW ¼ NW ¼	40.0 ACRES
SE ¼ NW ¼	40.0 ACRES
NE ¼ SW ¼	6.1 ACRES
NW ¼ SW ¼	6.1 ACRES

## SECTION 17

TOWNSHIP 2 NORTH, RANGE 28 EAST, W.M.

NE ¼ NE ¼	31.25 ACRES
NW ¼ NE ¼	31.25 ACRES
SW ¼ NE ¼	31.25 ACRES
SE ¼ NE ¼	31.25 ACRES
NE ¼ NW ¼	31.25 ACRES
NW ¼ NW ¼	31.25 ACRES
SW ¼ NW ¼	31.25 ACRES
SE ¼ NW ¼	31.25 ACRES
NE ¼ SW ¼	0.6 ACRE
NW ¼ SW ¼	0.6 ACRE
SW ¼ SW ¼	31.7 ACRES
SE ¼ SW ¼	32.8 ACRES

## SECTION 24

TOWNSHIP 3 NORTH, RANGE 26 EAST, W.M.

<u>OO</u>	<u>PRIMARY</u>	<u>SUPPLEMENTAL</u>
NE ¼ NW ¼		26.0 ACRES
NW ¼ NW ¼		25.0 ACRES
SW ¼ NW ¼		32.3 ACRES
SE ¼ NW ¼		33.4 ACRES
NE ¼ SW ¼		23.9 ACRES
NW ¼ SW ¼		23.0 ACRES
NE ¼ SE ¼	21.6 ACRES	
SE ¼ SE ¼	19.8 ACRES	

## SECTION 25

TOWNSHIP 3 NORTH, RANGE 26 EAST, W.M.

NE ¼ NE ¼		2.19 ACRES
SW ¼ NE ¼		18.48 ACRES
SE ¼ NE ¼		16.7 ACRES
SE ¼ NW ¼		0.07 ACRE
NE ¼ SW ¼		26.88 ACRES
NW ¼ SW ¼		22.13 ACRES
SW ¼ SW ¼		33.77 ACRES
SE ¼ SW ¼		36.99 ACRES
NE ¼ SE ¼		37.83 ACRES
NW ¼ SE ¼		39.58 ACRES
SW ¼ SE ¼		24.42 ACRES
SE ¼ SE ¼		31.14 ACRES

## SECTION 1

SE ¼ SW ¼		25.3 ACRES
SW ¼ SE ¼		26.9 ACRES

## SECTION 2

NE ¼ NE ¼		36.4 ACRES
NW ¼ NE ¼		37.1 ACRES
SW ¼ NE ¼		11.8 ACRES
SE ¼ NE ¼		37.5 ACRES
NE ¼ NW ¼		36.5 ACRES
NW ¼ NW ¼		1.2 ACRES
SW ¼ NW ¼		33.8 ACRES
SE ¼ NW ¼		36.6 ACRES
NE ¼ SW ¼		34.3 ACRES
NW ¼ SW ¼		26.1 ACRES
SW ¼ SW ¼		29.4 ACRES
SE ¼ SW ¼		40.0 ACRES
NE ¼ SE ¼		34.0 ACRES
NW ¼ SE ¼		40.0 ACRES
SW ¼ SE ¼		33.2 ACRES
SE ¼ SE ¼		20.3 ACRES

## SECTION 11

TOWNSHIP 3 NORTH, RANGE 27 EAST, W.M.

<u>OO</u>	<u>PRIMARY</u>	<u>SUPPLEMENTAL</u>
NE ¼ NE ¼		19.8 ACRES
NW ¼ NE ¼		33.24 ACRES
SW ¼ NE ¼		33.1 ACRES
SE ¼ NE ¼		37.8 ACRES
NE ¼ NW ¼		32.82 ACRES
NW ¼ NW ¼		27.2 ACRES
SW ¼ NW ¼		29.0 ACRES
SE ¼ NW ¼		35.7 ACRES
NE ¼ SW ¼		28.8 ACRES
NW ¼ SW ¼		39.8 ACRES
SW ¼ SW ¼		29.9 ACRES
SE ¼ SW ¼		18.9 ACRES
NE ¼ SE ¼		32.6 ACRES
NW ¼ SE ¼		6.4 ACRES

## SECTION 12

NE ¼ NE ¼	29.8 ACRES
NW ¼ NE ¼	32.2 ACRES
SW ¼ NE ¼	33.4 ACRES
SE ¼ NE ¼	36.1 ACRES
NE ¼ NW ¼	35.6 ACRES
NW ¼ NW ¼	37.5 ACRES
SW ¼ NW ¼	34.2 ACRES
SE ¼ NW ¼	21.0 ACRES
NE ¼ SW ¼	0.5 ACRE
NW ¼ SW ¼	35.5 ACRES
SW ¼ SW ¼	10.1 ACRES
NE ¼ SE ¼	32.3 ACRES
NW ¼ SE ¼	30.4 ACRES
SW ¼ SE ¼	35.6 ACRES
SE ¼ SE ¼	29.0 ACRES

## SECTION 13

NE ¼ NE ¼	33.9 ACRES
NW ¼ NE ¼	39.2 ACRES
SW ¼ NE ¼	32.3 ACRES
SE ¼ NE ¼	33.6 ACRES
NE ¼ NW ¼	30.4 ACRES
NW ¼ NW ¼	21.0 ACRES
SW ¼ NW ¼	9.7 ACRES
SE ¼ NW ¼	32.5 ACRES
NE ¼ SW ¼	40.0 ACRES
NW ¼ SW ¼	15.5 ACRES
SE ¼ SW ¼	3.9 ACRES
NE ¼ SE ¼	39.6 ACRES
NW ¼ SE ¼	16.6 ACRES
SE ¼ SE ¼	12.7 ACRES

## SECTION 14

TOWNSHIP 3 NORTH, RANGE 27 EAST, W.M.

<u>OO</u>	<u>PRIMARY</u>	<u>SUPPLEMENTAL</u>
NW ¼ NW ¼		13.6 ACRES
SW ¼ NW ¼		15.5 ACRES
	SECTION 15	
NE ¼ NE ¼		33.9 ACRES
NW ¼ NE ¼		12.7 ACRES
SW ¼ NE ¼		13.4 ACRES
SE ¼ NE ¼		38.0 ACRES
NE ¼ NW ¼		37.7 ACRES
NW ¼ NW ¼		25.53 ACRES
SW ¼ NW ¼		24.53 ACRES
SE ¼ NW ¼		37.4 ACRES
NE ¼ SW ¼		30.7 ACRES
NW ¼ SW ¼		31.4 ACRES
SW ¼ SW ¼		32.5 ACRES
SE ¼ SW ¼		31.9 ACRES
	SECTION 16	
NE ¼ NE ¼		34.52 ACRES
NW ¼ NE ¼		27.61 ACRES
SW ¼ NE ¼		28.52 ACRES
SE ¼ NE ¼		34.52 ACRES
NE ¼ NW ¼		33.34 ACRES
NW ¼ NW ¼		32.58 ACRES
SW ¼ NW ¼		34.5 ACRES
SE ¼ NW ¼		38.56 ACRES
NE ¼ SW ¼		3.26 ACRES
NW ¼ SW ¼		2.13 ACRES
	SECTION 17	
NE ¼ NE ¼		31.25 ACRES
NW ¼ NE ¼		31.25 ACRES
SW ¼ NE ¼		31.25 ACRES
SE ¼ NE ¼		31.25 ACRES
NE ¼ NW ¼		31.25 ACRES
NW ¼ NW ¼		31.25 ACRES
SW ¼ NW ¼		31.25 ACRES
SE ¼ NW ¼		31.25 ACRES
NE ¼ SE ¼		37.7 ACRES
NW ¼ SE ¼		18.3 ACRES
SW ¼ SE ¼		18.0 ACRES
SE ¼ SE ¼		37.3 ACRES
	SECTION 19	
TOWNSHIP 3 NORTH, RANGE 27 EAST, W.M.		



<u>OO</u>	<u>PRIMARY</u>	<u>SUPPLEMENTAL</u>
NE ¼ NE ¼	1.3 ACRES	
NW ¼ NE ¼	32.5 ACRES	
SW ¼ NE ¼	8.8 ACRES	31.3 ACRES
SE ¼ NE ¼	2.1 ACRES	
NE ¼ NW ¼	24.1 ACRES	
SE ¼ NW ¼	4.4 ACRES	31.3 ACRES
NE ¼ SW ¼	3.0 ACRES	31.2 ACRES
NW ¼ SW ¼		6.9 ACRES
SW ¼ SW ¼		6.9 ACRES
SE ¼ SW ¼	22.1 ACRES	
NE ¼ SE ¼	2.2 ACRES	
NW ¼ SE ¼	9.0 ACRES	31.2 ACRES
SW ¼ SE ¼	36.0 ACRES	
SE ¼ SE ¼	2.5 ACRES	

## SECTION 20

NE ¼ NE ¼		26.1 ACRES
NW ¼ NE ¼		24.7 ACRES
SW ¼ NE ¼		34.0 ACRES
SE ¼ NE ¼		35.0 ACRES
NE ¼ SE ¼	31.3 ACRES	1.9 ACRES
NW ¼ SE ¼	8.8 ACRES	2.0 ACRES
SW ¼ SE ¼	13.5 ACRES	
SE ¼ SE ¼	24.9 ACRES	

## SECTION 23

NE ¼ NE ¼		17.5 ACRES
NW ¼ NE ¼		33.9 ACRES
SW ¼ NE ¼		28.7 ACRES
SE ¼ NE ¼		17.5 ACRES

## SECTION 24

NE ¼ NW ¼		3.8 ACRES
NW ¼ NW ¼		12.4 ACRES
SW ¼ NW ¼		20.5 ACRES
NE ¼ SW ¼		7.9 ACRES
NW ¼ SW ¼		40.0 ACRES
SW ¼ SW ¼		36.9 ACRES
SE ¼ SW ¼		5.7 ACRES

## SECTION 25

TOWNSHIP 3 NORTH, RANGE 27 EAST, W.M.

<u>OO</u>	<u>PRIMARY</u>	<u>SUPPLEMENTAL</u>
NE ¼ NE ¼	23.6 ACRES	13.5 ACRES
NW ¼ NE ¼	23.8 ACRES	1.5 ACRES
SW ¼ NE ¼		3.5 ACRES
SE ¼ NE ¼		40.0 ACRES
NE ¼ NW ¼		5.15 ACRES
NW ¼ NW ¼		21.25 ACRES
SW ¼ NW ¼		28.25 ACRES
SE ¼ NW ¼		11.45 ACRES
NE ¼ SW ¼		31.25 ACRES
NW ¼ SW ¼		31.25 ACRES
SW ¼ SW ¼		31.25 ACRES
SE ¼ SW ¼		31.25 ACRES
NE ¼ SE ¼		29.02 ACRES
SE ¼ SE ¼		24.13 ACRES

## SECTION 26

NW ¼ NW ¼	20.2 ACRES
SW ¼ NW ¼	19.3 ACRES
NE ¼ SW ¼	9.1 ACRES
NW ¼ SW ¼	18.1 ACRES
SW ¼ SW ¼	17.7 ACRES
SE ¼ SW ¼	9.7 ACRES
NE ¼ SE ¼	12.2 ACRES
NW ¼ SE ¼	36.3 ACRES
SW ¼ SE ¼	37.5 ACRES
SE ¼ SE ¼	12.7 ACRES

## SECTION 27

NE ¼ NE ¼	37.4 ACRES
NW ¼ NE ¼	5.8 ACRES
SW ¼ NE ¼	5.8 ACRES
SE ¼ NE ¼	36.5 ACRES
NE ¼ SE ¼	38.1 ACRES
NW ¼ SE ¼	7.0 ACRES
SW ¼ SE ¼	6.9 ACRES
SE ¼ SE ¼	37.2 ACRES

## SECTION 28

TOWNSHIP 3 NORTH, RANGE 27 EAST, W.M.

<u>OO</u>	<u>PRIMARY</u>	<u>SUPPLEMENTAL</u>
NE ¼ NE ¼	15.6 ACRES	
NW ¼ NE ¼	39.4 ACRES	
SW ¼ NE ¼	39.0 ACRES	
SE ¼ NE ¼	13.0 ACRES	
NE ¼ NW ¼	22.7 ACRES	
NW ¼ NW ¼	28.9 ACRES	
SW ¼ NW ¼	37.7 ACRES	
SE ¼ NW ¼	26.3 ACRES	
NE ¼ SW ¼	26.9 ACRES	
NW ¼ SW ¼	36.5 ACRES	
SW ¼ SW ¼	36.0 ACRES	
SE ¼ SW ¼	25.4 ACRES	
NE ¼ SE ¼	25.8 ACRES	
NW ¼ SE ¼	39.1 ACRES	
SW ¼ SE ¼	36.3 ACRES	
SE ¼ SE ¼	20.3 ACRES	

## SECTION 29

NE ¼ NE ¼	26.7 ACRES
NW ¼ NE ¼	38.0 ACRES
SW ¼ NE ¼	36.2 ACRES
SE ¼ NE ¼	26.1 ACRES
NE ¼ NW ¼	1.9 ACRES
SE ¼ NW ¼	1.6 ACRES
NE ¼ SW ¼	7.9 ACRES
NW ¼ SW ¼	38.4 ACRES
SW ¼ SW ¼	37.4 ACRES
SE ¼ SW ¼	7.0 ACRES
NE ¼ SE ¼	27.6 ACRES
NW ¼ SE ¼	37.8 ACRES
SW ¼ SE ¼	34.0 ACRES
SE ¼ SE ¼	24.1 ACRES

## SECTION 30

TOWNSHIP 3 NORTH, RANGE 27 EAST, W.M.

<u>OO</u>	<u>PRIMARY</u>	<u>SUPPLEMENTAL</u>
NE ¼ NE ¼		34.75 ACRES
NW ¼ NE ¼		20.75 ACRES
SW ¼ NE ¼		13.15 ACRES
SE ¼ NE ¼		34.25 ACRES
SW ¼ NW ¼		5.95 ACRES
SE ¼ NW ¼		10.35 ACRES
NE ¼ SW ¼		39.45 ACRES
NW ¼ SW ¼		36.15 ACRES
SW ¼ SW ¼		28.1 ACRES
SE ¼ SW ¼		36.2 ACRES
NE ¼ SE ¼		39.65 ACRES
NW ¼ SE ¼		33.75 ACRES
SW ¼ SE ¼		20.45 ACRES
SE ¼ SE ¼		37.35 ACRES

## SECTION 34

NW ¼ NE ¼		3.4 ACRES
SW ¼ NE ¼		1.8 ACRES
NE ¼ NW ¼		31.25 ACRES
NW ¼ NW ¼		31.25 ACRES
SW ¼ NW ¼		31.25 ACRES
SE ¼ NW ¼		31.25 ACRES
NW ¼ SW ¼		22.6 ACRES
SW ¼ SW ¼		17.2 ACRES

## SECTION 35

NE ¼ NW ¼		1.88 ACRES
SW ¼ NW ¼		3.35 ACRES
NW ¼ SW ¼		4.35 ACRES
SW ¼ SW ¼		1.14 ACRES
SE ¼ SE ¼		4.0 ACRES

## SECTION 36

TOWNSHIP 3 NORTH, RANGE 27 EAST, W.M.

NE ¼ NW ¼		28.69 ACRES
NW ¼ NW ¼		25.0 ACRES
SW ¼ NW ¼		22.03 ACRES
SE ¼ NW ¼		35.0 ACRES
NE ¼ SW ¼		25.0 ACRES
NW ¼ SW ¼		19.19 ACRES
SW ¼ SW ¼		28.83 ACRES
SE ¼ SW ¼		28.7 ACRES

## SECTION 6

TOWNSHIP 3 NORTH, RANGE 28 EAST, W.M.

<u>OO</u>	<u>PRIMARY</u>	<u>SUPPLEMENTAL</u>
NE ¼ NW ¼		34.7 ACRES
NW ¼ NW ¼		31.9 ACRES
SW ¼ NW ¼		29.2 ACRES
SE ¼ NW ¼		23.5 ACRES
NE ¼ SW ¼		31.1 ACRES
NW ¼ SW ¼		24.0 ACRES
SW ¼ SW ¼		22.8 ACRES
SE ¼ SW ¼		30.1 ACRES
	SECTION 7	
NE ¼ NW ¼		35.6 ACRES
NW ¼ NW ¼		34.0 ACRES
SW ¼ NW ¼		33.5 ACRES
SE ¼ NW ¼		17.4 ACRES
NE ¼ SW ¼		20.0 ACRES
NW ¼ SW ¼		39.1 ACRES
SW ¼ SW ¼		0.9 ACRES
SE ¼ SW ¼		28.5 ACRES
	SECTION 18	
NE ¼ NW ¼		3.8 ACRES
SE ¼ NW ¼		0.6 ACRES
	SECTION 19	
NW ¼ SW ¼		1.1 ACRES
SW ¼ SW ¼		0.9 ACRES
NE ¼ SE ¼		20.4 ACRES
NW ¼ SE ¼		11.8 ACRES
SW ¼ SE ¼		16.7 ACRES
SE ¼ SE ¼		28.0 ACRES
	SECTION 30	
NE ¼ SW ¼		35.7 ACRES
NW ¼ SW ¼		15.9 ACRES
SW ¼ SW ¼		9.1 ACRES
SE ¼ SW ¼		37.0 ACRES
NW ¼ SE ¼		9.0 ACRES
SW ¼ SE ¼		9.0 ACRES
	SECTION 31	
NE ¼ SW ¼		31.3 ACRES
NW ¼ SW ¼		31.3 ACRES
SW ¼ SW ¼		31.2 ACRES
SE ¼ SW ¼		31.2 ACRES
NE ¼ SE ¼		6.7 ACRES
NW ¼ SE ¼		31.3 ACRES
SW ¼ SE ¼		31.2 ACRES
SE ¼ SE ¼		31.2 ACRES

## SECTION 32

TOWNSHIP 3 NORTH, RANGE 28 EAST, W.M.

Measurement devices, and recording/reporting of annual water use conditions:

- A. Before water use may begin under this permit, the permittee shall install a totalizing flow meter at each point of appropriation. The permittee shall maintain the device in good working order.
- B. The permittee shall allow the watermaster access to the device; provided however, where any device is located within a private structure, the watermaster shall request access upon reasonable notice.
- C. The permittee shall keep a complete record of the volume of water diverted each month, and shall submit a report which includes water-use measurements to the Department annually or more frequently as may be required by the Director. Further, the Director may require the permittee to report general water-use information, including the place and nature of use of water under the permit.
- D. The Director may provide an opportunity for the permittee to submit alternative measuring and reporting procedures for review and approval.

Dedicated Measuring Tube: Wells with pumps shall be equipped with a minimum 3/4-inch diameter, unobstructed, dedicated measuring tube pursuant to figure 200-5 in OAR 690-200. If a pump has been installed prior to the issuance of this permit, and if static water levels and pumping levels can be measured using an electrical tape, then the installation of the measuring tube can be delayed until such time that water levels cannot be measured or the pump is repaired or replaced.

The wells shall allow ground water production only from the alluvial ground water reservoir above the Columbia River Basalts.

The permittee shall construct two minimum six-inch diameter observation wells to penetrate the same aquifer as the production wells. The wells shall meet the Department's minimum well-construction standards, and shall be cased and sealed to the same depth as the production wells. The wells shall be constructed at a location approved by the Department for the purpose of instrumentation with continuous water-level monitoring equipment. The landowner or permittee shall provide access to Department staff to install and maintain the monitoring equipment. The wells shall not be used for any other purpose while the Department is monitoring water levels. The wells shall be completed and the monitoring equipment installed prior to water use.

Prior to using water from any well listed on this permit, the permittee shall ensure that the well has been assigned an OWRD Well Identification

Number (Well ID tag), which shall be permanently attached to the well. The Well ID shall be used as a reference in any correspondence regarding the well, including any reports of water use, water level, or pump test data.

#### **STANDARD CONDITIONS**

Failure to comply with any of the provisions of this permit may result in action including, but not limited to, restrictions on the use, civil penalties, or cancellation of the permit.

If the number, location, source, or construction of any well deviates from that proposed in the permit application or required by permit conditions, this permit may be subject to cancellation, unless the Department authorizes the change in writing.

If substantial interference with surface water or a senior water right occurs due to withdrawal of water from any well listed on this permit, then use of water from the well(s) shall be discontinued or reduced and/or the schedule of withdrawal shall be regulated until or unless the Department approves or implements an alternative administrative action to mitigate the interference. The Department encourages junior and senior appropriators to jointly develop plans to mitigate interferences.

The well(s) shall be constructed and maintained in accordance with the General Standards for the Construction and Maintenance of Water Supply Wells in Oregon. The works shall be equipped with a usable access port adequate to determine water-level elevation in the well at all times.

If the riparian area is disturbed in the process of developing a point of appropriation, the permittee shall be responsible for restoration and enhancement of such riparian area in accordance with ODFW's Fish and Wildlife Habitat Mitigation Policy OAR 635-415. For purposes of mitigation, the ODFW Fish and Wildlife Habitat Mitigation Goals and Standards, OAR 635-415, shall be followed.

The use may be restricted if the quality of downstream waters decreases to the point that those waters no longer meet state or federal water quality standards due to reduced flows.

Where two or more water users agree among themselves as to the manner of rotation in the use of water and such agreement is placed in writing and filed by such water users with the watermaster, and such rotation system does not infringe upon such prior rights of any water user not a party to such rotation plan, the watermaster shall distribute the water according to such agreement.

Prior to receiving a certificate of water right, the permit holder shall submit to the Water Resources Department the results of a pump test meeting the Department's standards for each point of appropriation

(well), unless an exemption has been obtained in writing under OAR 690-217. The Director may require water-level or pump-test data every ten years thereafter.

This permit is for the beneficial use of water without waste. The water user is advised that new regulations may require the use of best practical technologies or conservation practices to achieve this end.

By law, the land use associated with this water use must be in compliance with statewide land-use goals and any local acknowledged land-use plan.

Completion of construction and application of the water shall be made within five years of the date of permit issuance. If beneficial use of permitted water has not been made before this date, the permittee may submit an application for extension of time, which may be approved based upon the merit of the application.

Within one year after making beneficial use of water, the permittee shall submit a claim of beneficial use, which includes a map and report, prepared by a Certified Water Rights Examiner.

Issued February 9 , 2015



E. Timothy Wallin, Water Rights Program Manager  
for Thomas M. Byler, Director



PROPOSED POINTS OF APPROPRIATION

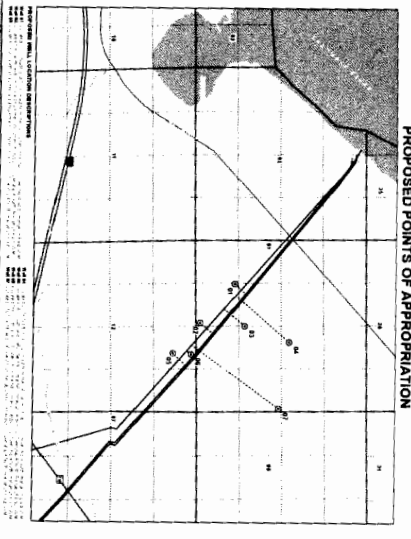

TOWNSHIP 2 NORTH, RANGES 27 & 28 EAST (W.M.)  
TOWNSHIP 3 NORTH, RANGES 26, 27, & 28 EAST (W.M.)

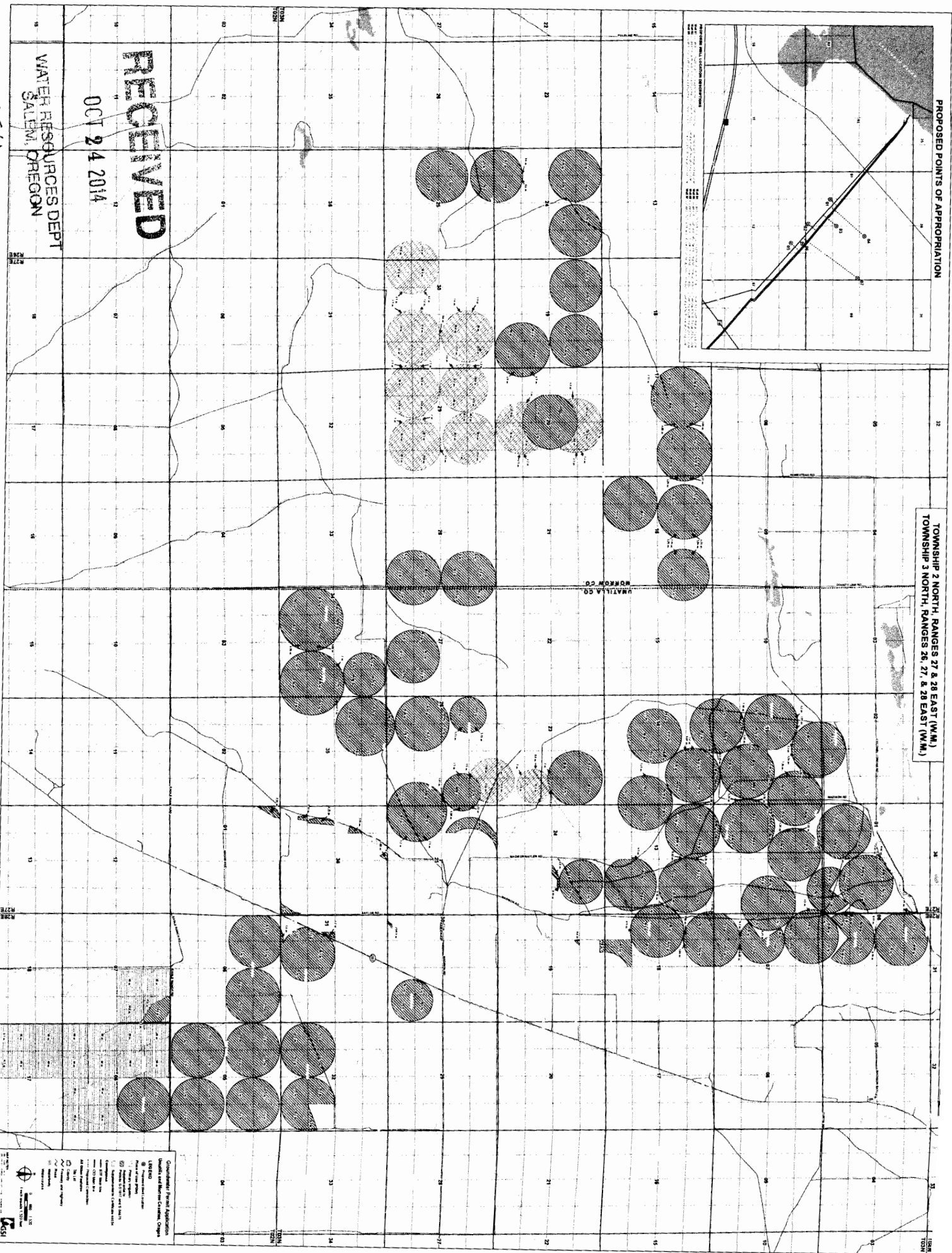

RECEIVED

OCT 24 2014

WATER RESOURCES DEPT  
SALEM, OREGON

G 17354

Geographical Point Application  
 District and Bureau Offices, Oregon

Legend

- 1. Proposed Point of Appropriation
- 2. Existing Point of Appropriation
- 3. Proposed Point of Appropriation
- 4. Proposed Point of Appropriation
- 5. Proposed Point of Appropriation
- 6. Proposed Point of Appropriation
- 7. Proposed Point of Appropriation
- 8. Proposed Point of Appropriation
- 9. Proposed Point of Appropriation
- 10. Proposed Point of Appropriation
- 11. Proposed Point of Appropriation
- 12. Proposed Point of Appropriation
- 13. Proposed Point of Appropriation
- 14. Proposed Point of Appropriation
- 15. Proposed Point of Appropriation
- 16. Proposed Point of Appropriation
- 17. Proposed Point of Appropriation
- 18. Proposed Point of Appropriation
- 19. Proposed Point of Appropriation
- 20. Proposed Point of Appropriation
- 21. Proposed Point of Appropriation
- 22. Proposed Point of Appropriation
- 23. Proposed Point of Appropriation
- 24. Proposed Point of Appropriation
- 25. Proposed Point of Appropriation
- 26. Proposed Point of Appropriation
- 27. Proposed Point of Appropriation
- 28. Proposed Point of Appropriation
- 29. Proposed Point of Appropriation
- 30. Proposed Point of Appropriation
- 31. Proposed Point of Appropriation
- 32. Proposed Point of Appropriation
- 33. Proposed Point of Appropriation
- 34. Proposed Point of Appropriation
- 35. Proposed Point of Appropriation
- 36. Proposed Point of Appropriation
- 37. Proposed Point of Appropriation
- 38. Proposed Point of Appropriation
- 39. Proposed Point of Appropriation
- 40. Proposed Point of Appropriation
- 41. Proposed Point of Appropriation
- 42. Proposed Point of Appropriation
- 43. Proposed Point of Appropriation
- 44. Proposed Point of Appropriation
- 45. Proposed Point of Appropriation
- 46. Proposed Point of Appropriation
- 47. Proposed Point of Appropriation
- 48. Proposed Point of Appropriation
- 49. Proposed Point of Appropriation
- 50. Proposed Point of Appropriation
- 51. Proposed Point of Appropriation
- 52. Proposed Point of Appropriation
- 53. Proposed Point of Appropriation
- 54. Proposed Point of Appropriation
- 55. Proposed Point of Appropriation
- 56. Proposed Point of Appropriation
- 57. Proposed Point of Appropriation
- 58. Proposed Point of Appropriation
- 59. Proposed Point of Appropriation
- 60. Proposed Point of Appropriation
- 61. Proposed Point of Appropriation
- 62. Proposed Point of Appropriation
- 63. Proposed Point of Appropriation
- 64. Proposed Point of Appropriation
- 65. Proposed Point of Appropriation
- 66. Proposed Point of Appropriation
- 67. Proposed Point of Appropriation
- 68. Proposed Point of Appropriation
- 69. Proposed Point of Appropriation
- 70. Proposed Point of Appropriation
- 71. Proposed Point of Appropriation
- 72. Proposed Point of Appropriation
- 73. Proposed Point of Appropriation
- 74. Proposed Point of Appropriation
- 75. Proposed Point of Appropriation
- 76. Proposed Point of Appropriation
- 77. Proposed Point of Appropriation
- 78. Proposed Point of Appropriation
- 79. Proposed Point of Appropriation
- 80. Proposed Point of Appropriation
- 81. Proposed Point of Appropriation
- 82. Proposed Point of Appropriation
- 83. Proposed Point of Appropriation
- 84. Proposed Point of Appropriation
- 85. Proposed Point of Appropriation
- 86. Proposed Point of Appropriation
- 87. Proposed Point of Appropriation
- 88. Proposed Point of Appropriation
- 89. Proposed Point of Appropriation
- 90. Proposed Point of Appropriation
- 91. Proposed Point of Appropriation
- 92. Proposed Point of Appropriation
- 93. Proposed Point of Appropriation
- 94. Proposed Point of Appropriation
- 95. Proposed Point of Appropriation
- 96. Proposed Point of Appropriation
- 97. Proposed Point of Appropriation
- 98. Proposed Point of Appropriation
- 99. Proposed Point of Appropriation
- 100. Proposed Point of Appropriation