

**Water Right Application Map**  
**Roger Vehrs**  
**Primary Galesville Reservoir 28 Acres**  
**Douglas County**  
**Scale 1" = 1,000'**  
**T.27S. R.6W. Sections 5 and 6**

RECEIVED BY OWRD

FEB 10 2015

SALEM, OR

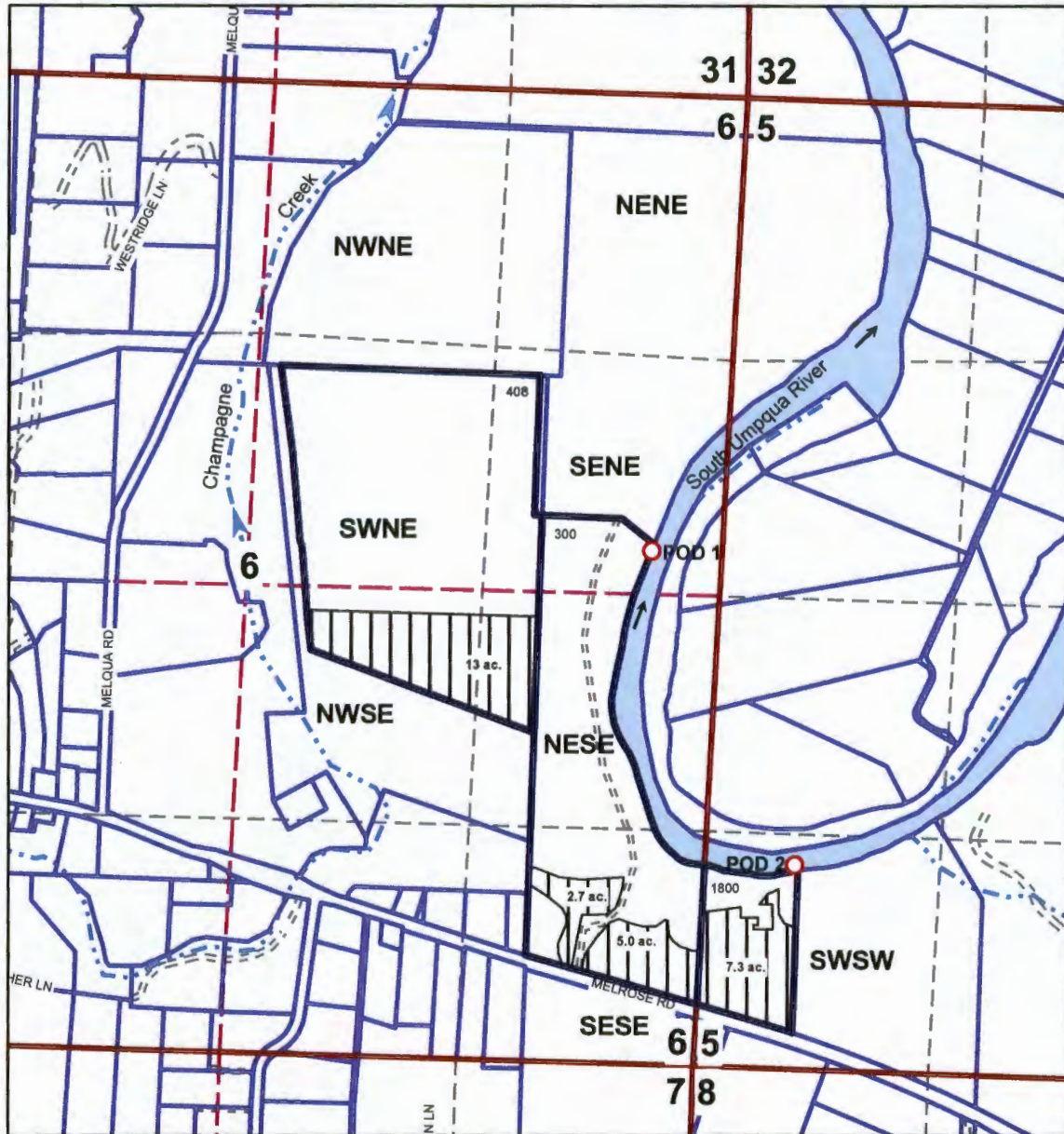

POD 1 location is 250 ft. north and 390 ft. west from the east corner of Section 6

POD 2 location is 1125 ft. north and 500' east from the southwest corner of Section 5

S-88057

**RECEIVED**

FEB 11 2015

WATER RESOURCES DEPT  
SALEM, OREGON

**REVISED**  
**Water Right Application Map**  
**Roger Vehrs**  
**Primary Galesville Reservoir 28 Acres**  
**Douglas County**  
**Scale 1" = 1,000'**  
**T.27S. R.6W. Sections 5 and 6**

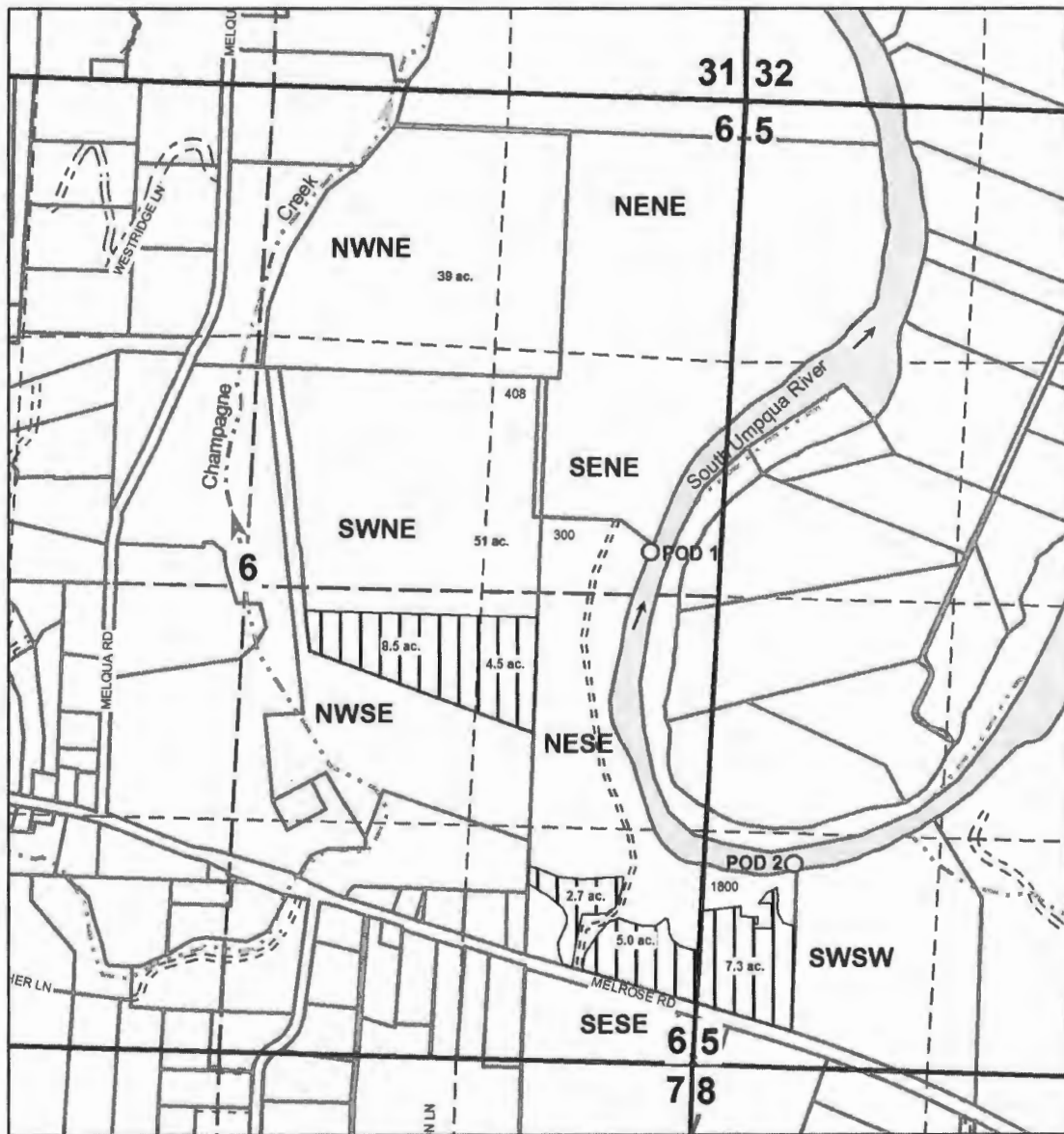

POD 1 location is 250 ft. north and 390 ft. west from the east corner of Section 6

POD 2 location is 1125 ft. north and 500' east from the southwest corner of Section 5

P-88001



**Roger Vehrs Water Rights  
 Primary Galesville Reservoir 118 Acres  
 Douglas County  
 Scale 1" = 1,000'**

**T.27S. R.6W. Sections 5 and 6**

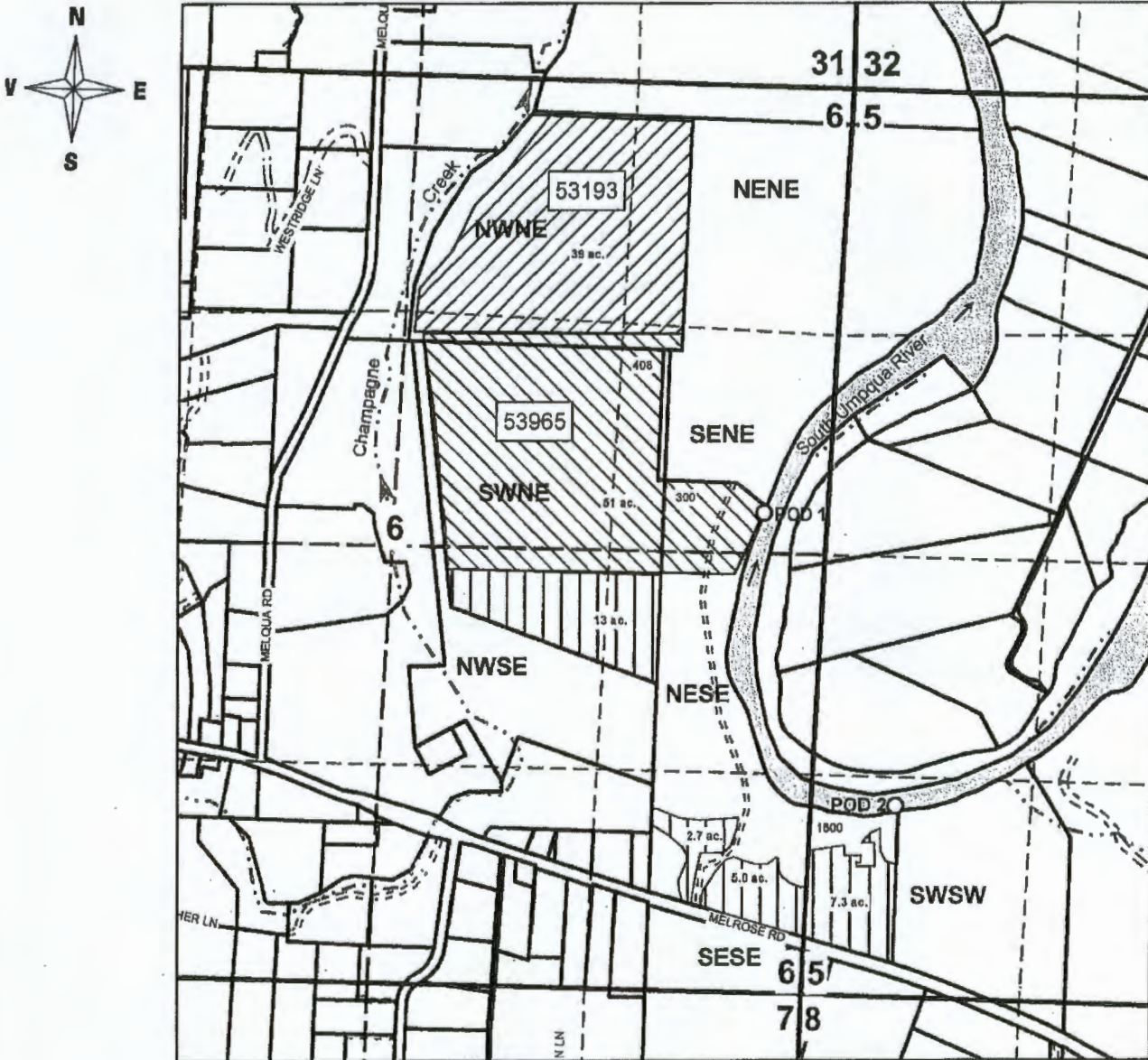

POD 1 location is 250 ft. north and 390 ft. west from the east corner of Section 6

POD 2 location is 1125 ft. north and 500' east from the southeast corner of Section 6

**RECEIVED**

FEB 13 2015

WATER RESOURCES DEPT  
 SALEM, OREGON

S-88057