

Name Jay H. Joseph

By _____

Address Route 1, Box 176
Halfway, Oregon 97854

Date filed 23 February 1977

Priority February 23, 1977

Action suspended until _____
P

Return to applicant _____

Date of approval JUN 30 1977

CONSTRUCTION

Date for beginning JUN 30 1978

Date for completion OCT 1 1978

Extended to _____

Date for application of water OCT 1 1979

Extended to _____

PROSECUTION OF WORK

Form "A" filed Started

Form "B" filed _____

Form "C" filed _____

FINAL PROOF

Blank mailed _____

Proof received _____

Date certificate issued _____

Application No. G 7818

Permit No. G 7225

Certificate No. _____

Stream Index, Page No. 9-49

FEEES PAID

Date	Amount	Receipt No.
<u>2-23-77</u>	<u>40.20</u>	<u>58448</u>

Cert. Fee _____

FEEES REFUNDED

Date	Amount	Check No.
<u>19</u>	<u>40.118</u>	<u>1</u>

CANCELLED

APR 30, 1986

ASSIGNMENTS

Date	To Whom	Address	Volume	Page
_____	_____	_____	_____	_____

REMARKS

CARD FOR B OCT 24 1978

Card for C OCT 24 1979

SURVEY REGARDLESS 5-12-80

PC Card Sent; OCT 7 1985

SURVEY REGARDLESS NO FORM 'B' OR 'C' FILED

RECEIVED
FEB 20 1987
WATER RESOURCES DEPT
SALEM, OREGON

179-53R
2KK-170 (old)
7225

RECEIVED
OCT - 2 1985

Permit No. G-.....

WATER RESOURCES DEPT
SALEM, OREGON

APPLICATION FOR A PERMIT

To Appropriate the Ground Waters of the State of Oregon

I, Jay H. Joseph (Name of applicant)
of RR. I Box 240 Halfway (Postoffice Address), county of Baker
state of Oregon 97154, do hereby make application for a permit to appropriate the
following described ground waters of the state of Oregon, SUBJECT TO EXISTING RIGHTS:

If the applicant is a corporation, give date and place of incorporation

1. Give name of nearest stream to which the well, tunnel or other source of water development is
situated Dry Creek (Name of stream)
tributary of Pine Creek

2. The amount of water which the applicant intends to apply to beneficial use is cubic
feet per second or 250 gallons per minute.

3. The use to which the water is to be applied is Supplemental irrigation

4. The well or other source is located 150 ft. S and 230 ft. W from the NE
corner of SE 1/4 SE 1/4 Sec 2 T 25 R 46 E W M
(Section or subdivision)

(If preferable, give distance and bearing to section corner).

(If there is more than one well, each must be described. Use separate sheet if necessary)

being within the SE 1/4 SE 1/4 of Sec. 2, Twp. 25, R. 46 E
W. M., in the county of Baker

5. The Pipe line (Canal or pipe line) to be 1/2 miles
in length, terminating in the NE 1/4 NE 1/4 of Sec. 11, Twp. 2
R. 46, W. M., the proposed location being shown throughout on the accompanying map.

6. The name of the well or other works is Joseph well

DESCRIPTION OF WORKS

7. If the flow to be utilized is artesian, the works to be used for the control and conservation of the
supply when not in use must be described.

8. The development will consist of one well (Give number of wells, tunnels, etc.) having a
diameter of 10 inches and an estimated depth of 120 feet. It is estimated that 16
feet of the well will require 1/4 steel casing. Depth to water table is estimated 40
(Kind) (Feet)

Cancel Autho
9/24/85 LMT

East Pine Creek Wells

9, Vol. 3

G 7225

CANAL SYSTEM OR PIPE LINE—

9. (a) Give dimensions at each point of canal where materially changed in size, stating miles from headgate. At headgate: width on top (at water line) feet; width on bottom feet; depth of water feet; grade feet fall per one thousand feet.

(b) At miles from headgate: width on top (at water line) feet; width on bottom feet; depth of water feet; grade feet fall per one thousand feet.

(c) Length of pipe, 2640 ft.; size at intake 4 in.; in size at 400 ft. from intake 4 in.; size at place of use 3" and 4" in.; difference in elevation between intake and place of use, 6 to 7 ft. Is grade uniform? yes. Estimated capacity, 250 g.p.m. sec. ft.

10. If pumps are to be used, give size and type 6 in Berkeley S2ALL submersible

Give horsepower and type of motor or engine to be used 7 1/2 Horsepower 18

11. If the location of the well, tunnel, or other development work is less than one-fourth mile from a natural stream or stream channel, give the distance to the nearest point on each of such channels and the difference in elevation between the stream bed and the ground surface at the source of development Well is 750 ft from Dry Creek ground surface at well is 1.2 ft higher than creek bed

12. Location of area to be irrigated, or place of use

Table with 5 columns: Township N. or S., Range E. or W. of Willamette Meridian, Section, Forty-acre Tract, Number Acres To Be Irrigated. Handwritten entries include Township 8, Range 46, Section 1, Tract NW 1/4 SN 1/4 (14 acres), SW 1/4 SW 1/4 (10 acres), Section 2, Tract SE 1/4 SE 1/4 (35 acres), Section 11, Tract NE 1/4 NE 1/4 (5 acres), Total 64 acres.

(If more space required, attach separate sheet)

Character of soil clay to heavy loam, class I and II Kind of crops raised Corn alfalfa Grass

MUNICIPAL SUPPLY—

13. To supply the city of
in county, having a present population of
and an estimated population of in 19.....

ANSWER QUESTIONS 14, 15, 16, 17 AND 18 IN ALL CASES

- 14. Estimated cost of proposed works, \$ 8,000
- 15. Construction work will begin on or before has started
- 16. Construction work will be completed on or before March 1, 1978
- 17. The water will be completely applied to the proposed use on or before Oct 1, 1978

18. If the ground water supply is supplemental to an existing water supply, identify any application for permit, permit, certificate or adjudicated right to appropriate water, made or held by the applicant. Permit # 10,213, cert # 35415, Cert # 10235, Cert # 10231

Jay H. Joseph
(Signature of applicant)

Remarks:

STATE OF OREGON, }
County of Marion, } ss.

This is to certify that I have examined the foregoing application, together with the accompanying maps and data, and return the same for

In order to retain its priority, this application must be returned to the State Engineer, with corrections on or before, 19.....

WITNESS my hand this day of, 19.....

STATE ENGINEER
By ASSISTANT

STATE OF OREGON, }
County of Marion, } ss.

PERMIT

This is to certify that I have examined the foregoing application and do hereby grant the same, SUBJECT TO EXISTING RIGHTS and the following limitations and conditions:

The right herein granted is limited to the amount of water which can be applied to beneficial use and shall not exceed 0.56 cubic feet per second measured at the point of diversion from the well or source of appropriation, or its equivalent in case of rotation with other water users, from a well

The use to which this water is to be applied is supplemental irrigation

If for irrigation, this appropriation shall be limited to 1/80th of one cubic foot per second or its equivalent for each acre irrigated and shall be further limited to a diversion of not to exceed 3 acre feet per acre for each acre irrigated during the irrigation season of each year; provided further that the right allowed herein shall be limited to any deficiency in the available supply of any prior right existing for the same land and shall not exceed the limitation allowed herein,

and shall be subject to such reasonable rotation system as may be ordered by the proper state officer.

The well shall be cased as necessary in accordance with good practice and if the flow is artesian the works shall include proper capping and control valve to prevent the waste of ground water.

The works constructed shall include an air line and pressure gauge or an access port for measuring line, adequate to determine water level elevation in the well at all times.

The permittee shall install and maintain a weir, meter, or other suitable measuring device, and shall keep a complete record of the amount of ground water withdrawn.

The priority date of this permit is February 23, 1977

Actual construction work shall begin on or before June 30, 1978 and shall thereafter be prosecuted with reasonable diligence and be completed on or before October 1, 1978

Complete application of the water to the proposed use shall be made on or before October 1, 1979

WITNESS my hand this 30th day of June 1977

James E. Nelson
Water Resources Director

Application No. G. 7818
Permit No. G. 7225

PERMIT

TO APPROPRIATE THE GROUND
WATERS OF THE STATE
OF OREGON

This instrument was first received in the
office of the State Engineer at Salem, Oregon,
on the 23 day of February
1977 at 11 o'clock A. M.

Returned to applicant:

Approved:

Recorded in book No. _____ of
Ground Water Permits on page _____

STATE ENGINEER
Drainage Basin No. 7 page 49

RECEIVED

OCT - 2 1985

WATER RESOURCES DEPT
SALEM, OREGON

INFO- JAY JOSEPH - THE WELL WAS DRILLED WITH ^{FOR DOMESTIC} WITH
A LARGE CASING WITH THE IDEA USING FOR
IRRIGATION. AT SOME TIME THE BOTTOM
APPROX. 50 FT APPARENTLY COLLAPSED. JOSEPH
NEVER IRRIGATED BECAUSE WHEN THEY
PUMPED WITH AN IRRIGATION SIZE PUMP IT
WENT DRY IN A FEW HOURS. THEY STILL
USE THE WELL FOR DOMESTIC, L¹/₂ G AND STOCK
THE SAME AS THEY DID BEFORE GETTING
THIS PERMIT. MR. JOSEPH SIGNED THE
CANCEL. AUTHO.

Shirley Zell
WRB
9/24/85

RECEIVED

TOWNSHIP 8 S.

RANGE 46 E.W.M.

OCT - 2 1985

WATER RESOURCES DEPT
SALEM, OREGON

North

RECEIVED

FEB 23 1977

WATER RESOURCES DEPT
SALEM, OREGON

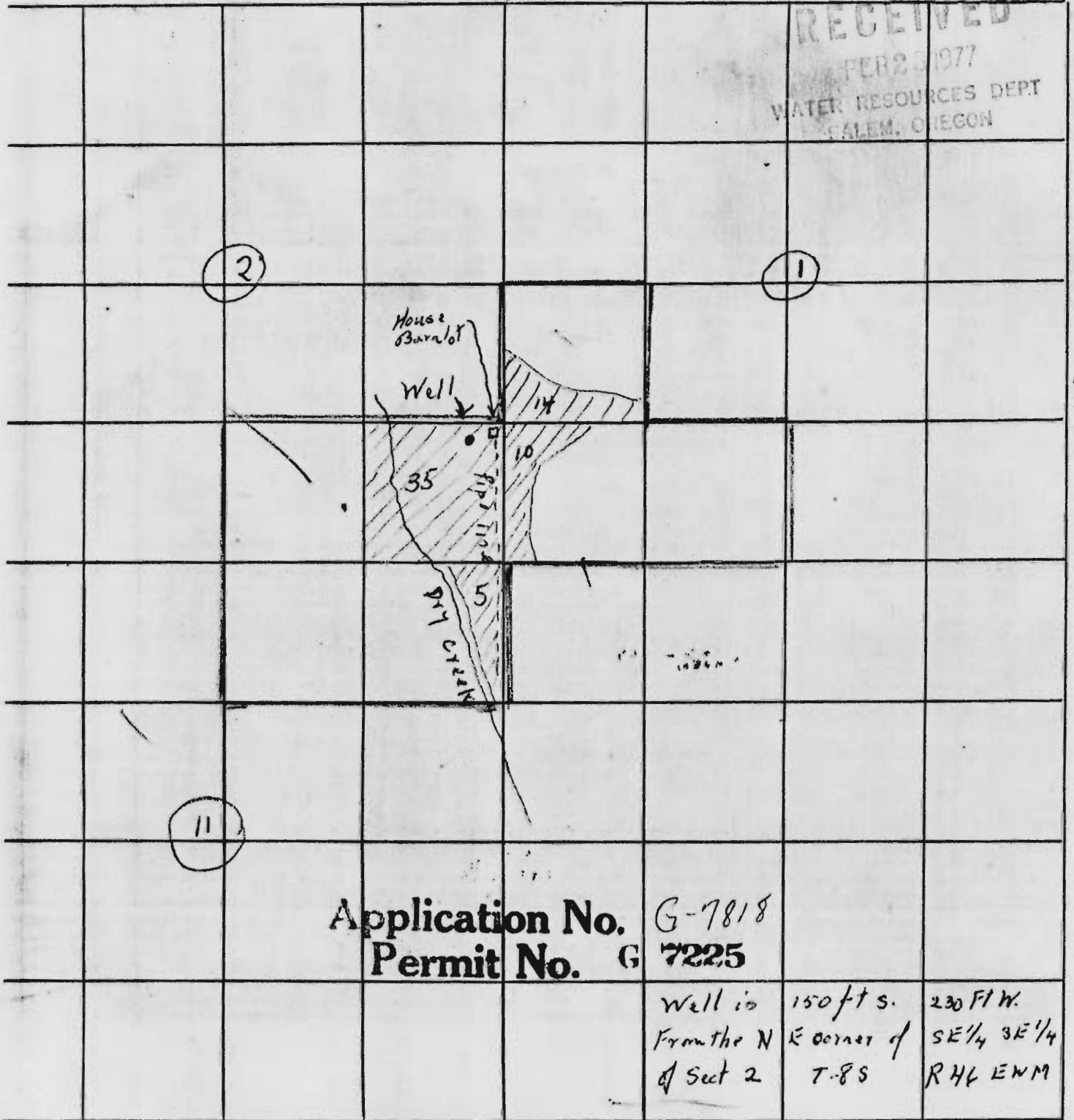

Application No. G-7818
Permit No. G 7225

Well is 150 ft s. 230 Ft W.
From the N E corner of SE 1/4 SE 1/4
of Sect 2 T-8S R46 EWM

MAP TO ACCOMPANY APPLICATION OF:

Name Jay H Joseph

County Baker

Date 2-15-77

Scale 4" to 1 Mile

Note:

MAP PREPARED FROM:

DRAWN BY: Jay H Joseph

SIGNED BY APPLICANT: Jay H Joseph

I hereby authorize the cancellation of my Application G-7818,
Permit G-7225, which defines a right to the use of
0.56 cubic feet per second of water from a well
for supplemental irrigation

Sincerely,

Jay H Joseph ✓
Signature

9/24/85
Date

July 13, 1977

Jay H. Joseph
Route 1, Box 176
Halfway, OR 97854

G 7818

G 7225

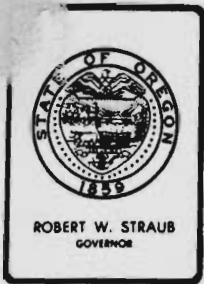

Water Resources Department

1178 CHEMEKETA STREET N.E., SALEM, OREGON 97310 PHONE 378-3066

April 14, 1977

G-7818

Jay H. Joseph
Route 1, Box 176
Halfway, Oregon 97854

Dear Mr. Joseph:

We have received your map, fees of \$40.20 and application for a permit to use 250 gallons per minute of water from a well for irrigation of 64.0 acres. For reference, your application is numbered G-7818.

Your application is satisfactory and a permit will be issued in 30 to 60 days.

Sincerely,

Vestal R. Garner
Water Rights Engineer

DN/VRG:cjw
Enclosure: Receipt No. 58448

TOWNSHIP 8 S.

RANGE 46 E.W.M.

North

RECEIVED

FEB 23 1977

WATER RESOURCES DEPT
SALEM, OREGON

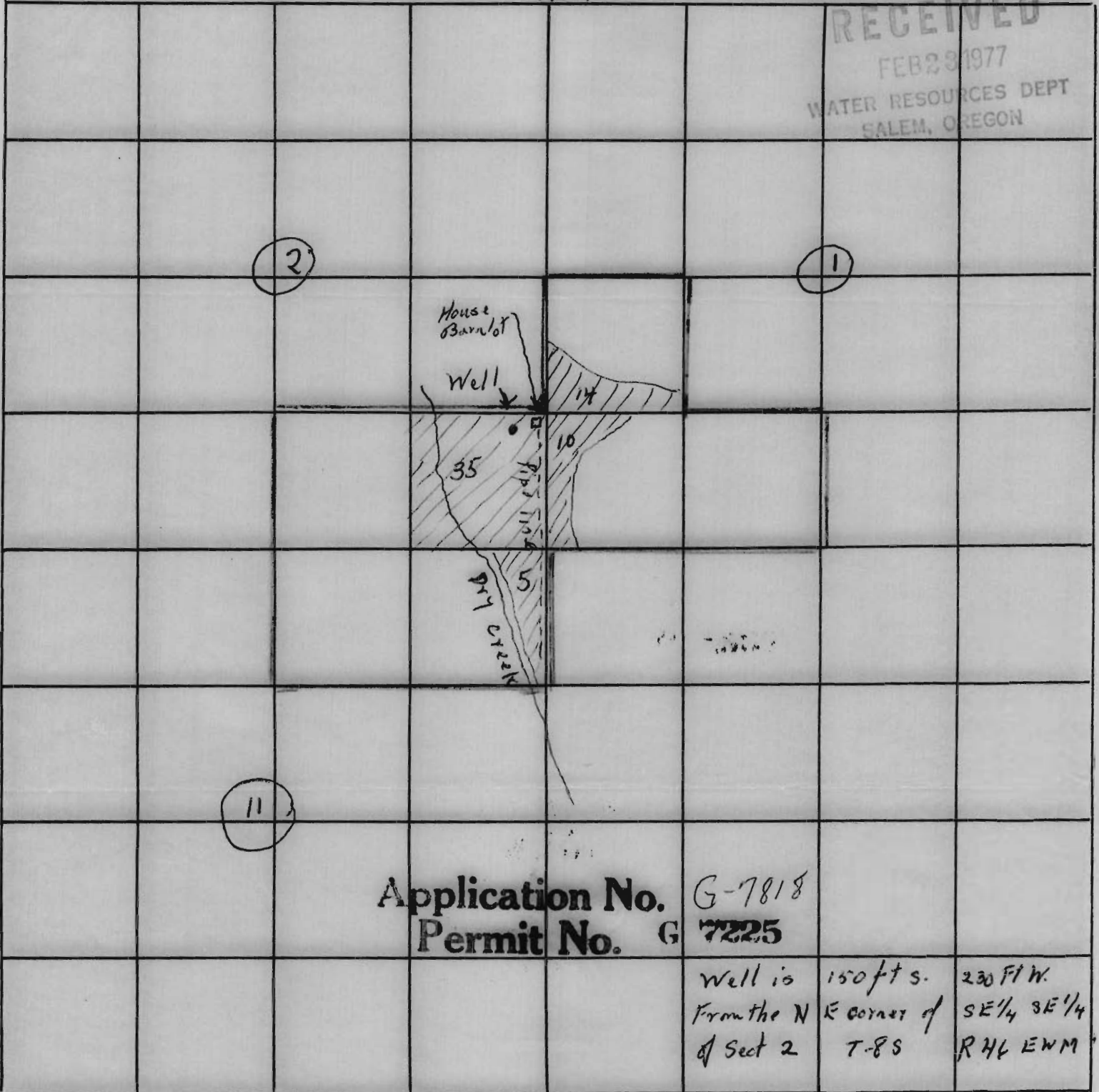

MAP TO ACCOMPANY APPLICATION OF:

Name Jay H Joseph

County Baker

Date 2-15-77

Scale 4" to 1 Mile