



Oregon Water Resources Department
 725 Summer Street NE, Suite A
 Salem Oregon 97301-1266
 (503) 986-0900
 www.wrd.state.or.us

Certificate of Water Right Ownership Update

NOTICE TO SELLERS & BUYERS:

By law, all water belongs to the public (ORS 537.110). In almost every instance, a permit or water right certificate from the Water Resources Department is needed before using, diverting or storing water (ORS 537.130). However, most domestic wells do not require water rights. A certificate of water right stays with the land. In order to keep track of water right ownership, the Department requests that this form be submitted to the Department. *If for multiple rights, a separate form for each right will be required.*

Water that has been used for a long time in one place or that involves a water structure (like a dam) that already exists is no guarantee that there is a water right which would allow the water use to continue.

If you have any questions about this form or water right requirements, please contact your local watermaster or call the Water Resources Department at 503-986-0900.

Note: Please type or print legibly when filling in the following information. Use additional paper if necessary.

PROPERTY SELLER INFORMATION

Applicant(s): Clayton Lawrence
First Last
 Mailing Address: Route 1, Box 274
Eugene Oregon
City State Zip
 Phone: _____
Home Work Other

PROPERTY BUYER INFORMATION

Applicant(s): Larry Denny
First Last
 Mailing Address: 2318 Lakeview Drive
Bradley CA 93426-9624
City State Zip
 Phone: 805-472-9036
Home Work Other

PROPERTY DESCRIPTION (attach additional pages if necessary):

County: Lane Township: 17 S Range: 5 W Section: 24
 Tax Lot Number(s): _____
 Street address of water right property: 89160 Fir Butte Rd., Eugene, OR 97402
 Water Right Information (attach copy of water right permit or certificate & final proof map):
 Application #: 27318 Permit #: 21480 Certificate or Page #: v. 17, p. 24326
 Will all the lands associated with this water right be owned by the buyer? Yes No
 Name of individual completing this form: Larry Denny Phone: 805-472-9036
 Signature: [Signature] Date: 7/1/14

Please be sure to attach a copy of your property deed or legal description of the property. RECEIVED BY OWRD

RECEIVED BY OWRD

STATE OF OREGON

SEP 08 2014

COUNTY OF LANE

CERTIFICATE OF WATER RIGHT SALEM, OR

This Is to Certify, That CLAYTON A. LAWRENCE

of Rt. 1, Box 274, Eugene, State of Oregon, has made proof to the satisfaction of the STATE ENGINEER of Oregon, of a right to the use of the waters of Amazon Diversion Canal a tributary of Fern Ridge Reservoir for the purpose of irrigation of 8.1 acres under Permit No. 21480 of the State Engineer, and that said right to the use of said waters has been perfected in accordance with the laws of Oregon; that the priority of the right hereby confirmed dates from June 12, 1952,

that the amount of water to which such right is entitled and hereby confirmed, for the purposes aforesaid, is limited to an amount actually beneficially used for said purposes, and shall not exceed 0.10 cubic foot per second,

or its equivalent in case of rotation, measured at the point of diversion from the stream. The point of diversion is located in the SW $\frac{1}{4}$ NE $\frac{1}{4}$ and SE $\frac{1}{4}$ NW $\frac{1}{4}$ both as projected within E. A. Breeding DLC #55, Section 24, Township 17 South, Range 5 West, W.M.

The amount of water used for irrigation, together with the amount secured under any other right existing for the same lands, shall be limited to one-eightieth of one cubic foot per second per acre, or its equivalent for each acre irrigated and shall be further limited to a diversion of not to exceed 2 $\frac{1}{2}$ acre feet per acre for each acre irrigated during the irrigation season of each year,

and shall conform to such reasonable rotation system as may be ordered by the proper state officer.

A description of the place of use under the right hereby confirmed, and to which such right is appurtenant, is as follows:

5.1 acres SW $\frac{1}{4}$ NE $\frac{1}{4}$, as projected within E. A. Breeding DLC #55
 3.0 acres SE $\frac{1}{4}$ NW $\frac{1}{4}$, as projected within E. A. Breeding DLC #55
 Section 24
 Township 17 South, Range 5 West, W.M.

The right to the use of the water for the purposes aforesaid is restricted to the lands or place of use herein described.

WITNESS the signature of the State Engineer, affixed

this 10th day of October, 1958.

LEWIS A. STANLEY

State Engineer

Recorded in State Record of Water Right Certificates, Volume 17, page 24326

RECEIVED BY OWRD

SEP 08 2014

SALEM, OR

T.17S.R.5W.W.M.

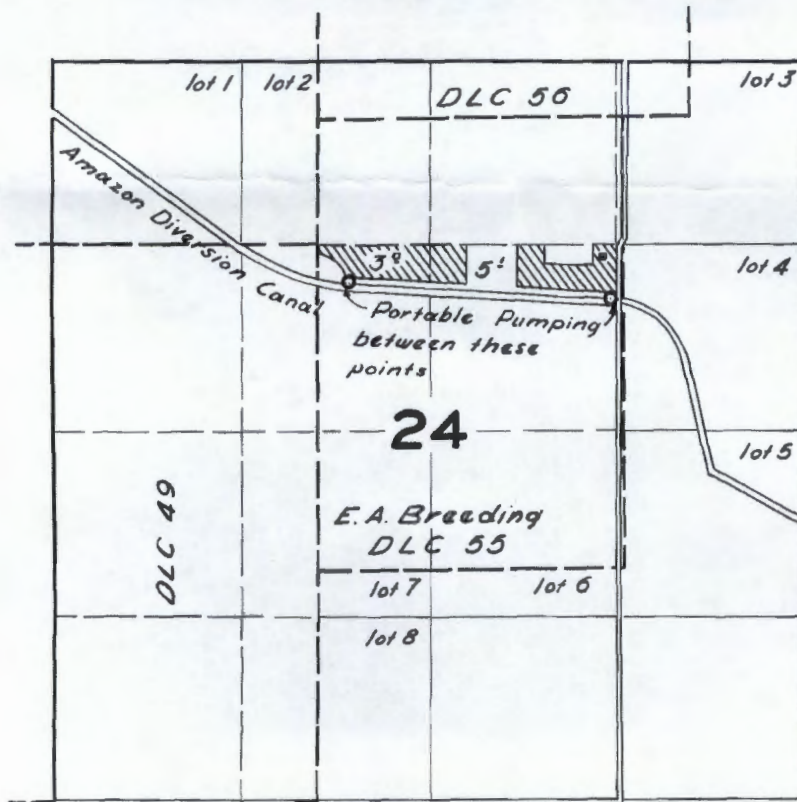

FINAL PROOF SURVEY
UNDER

Application No. 27318 Permit No. 21480
IN NAME OF

CLAYTON A. LAWRENCE

Surveyed 30 Apr. 1957, by *[Signature]*

Beginning at the Northeast Corner of the Richard D. Baskett Donation Land Claim Number 49, Township 17 South, Range 5 West of the Willamette Meridian; thence South $0^{\circ}02'45''$ West 347.00 feet along the east line of said donation land claim to a point on the southerly right of way line of the Amazon Diversion Canal; thence following around a 1532.39-foot radius curve to the left along said right of way line to the end of said curve, the long chord of which bears South $81^{\circ}19'40''$ East 250.10 feet; thence South $86^{\circ}01'$ East 1362.83 feet along the southerly right of way of said canal to a point, said point being the true point of beginning; thence South $86^{\circ}01'$ East 468.47 feet along the southerly right of way line of said canal to the beginning of a 472.96 foot radius curve to the right; thence following around said 472.96 foot radius curve to the right along said right of way line to a point in the center of County Road No. 497, the long chord of which bears South $82^{\circ}00'30''$ East 661.1 feet; thence South $0^{\circ}02'45''$ West 74.16 feet along the center of County Road No. 497 to a point; thence North $83^{\circ}56'45''$ West 535.78 feet to a point; thence North $0^{\circ}02'45''$ East 59.44 feet to the true point of beginning, all in the E. A. Breeding Donation Land Claim Number 55, Section 24, Township 17 South, Range 5 West of the Willamette Meridian, Lane County, Oregon.

Also:

Beginning at the Northeast corner of the Richard D. Baskett Donation Land Claim Number 49, Township 17 South, Range 5 West of the Willamette Meridian; thence North $89^{\circ}15'30''$ West 336.99 feet along the north line of said donation land claim to a point on the northerly right of way line of the Amazon Diversion Canal; thence following around a 1332.39 foot radius curve to the left along said right of way line to a point, the long chord of which bears South $66^{\circ}42'40''$ East 366.72 feet; thence continuing around said 1332.39 foot radius curve to the left to the end of said curve, the long chord of which bears South $60^{\circ}18'30''$ East 264.75 feet; thence South $86^{\circ}01'$ East 1349.06 feet along the northerly right of way line of said canal to a point; thence North

Beginning at a point in the center of County Road #497, 2139.6 feet South $89^{\circ}27'$ East from the Northeast corner of the Richard D. Baskett Donation Land Claim #49, Township 17 South Range 5 West of the Willamette Meridian, said point being the northeast corner of the Pearl B. and Luther Lester Land, from said beginning point run south along the center of said road 628.3 feet to the center line of a proposed road from the west; thence North $89^{\circ}27'$ West along the center of said proposed road 532.6 feet, thence North 628.3 feet, thence South $89^{\circ}27'$ East 532.6 feet to the place of beginning, being a part of the E. A. Breeding Land Claim #55, in Section 24, said township and range, in Lane County, Oregon.

$0^{\circ}02'45''$ East 258.19 feet to a point; thence North $89^{\circ}15'30''$ West 1607.00 feet to the point of beginning, all in the E. A. Breeding Donation Land Claim Number 55 and the Richard D. Baskett Donation Land Claim Number 49, Section 24, Township 17 South, Range 5 West of the Willamette Meridian, Lane County, Oregon.

TO HAVE AND TO HOLD the above described land and premises unto the said MARY E. PARKER and J. W. G. PARKER, husband and wife, their heirs and assigns forever.

I, WALTER W. BROWN, the City of Eugene, Oregon, Mayor, do hereby certify that the above described land and premises are owned by the City of Eugene, Oregon, and that the same are subject to the provisions of the City of Eugene, Oregon, Ordinance No. 100, passed by the Mayor and Recorder of said City, on the 21st day of January, 1914.

RECEIVED BY OWRD

SEP 08 2014

SALEM, OR