

**STATE OF OREGON
EXEMPT USE WELL MAP**

(as required by ORS 537.545 & OAR 690.190)
This map is supplemental to the WATER SUPPLY WELL REPORT

Oregon Water Resources Department
725 Summer St NE, Salem, OR 97301
(503)986-0900



LOCATION OF WELL

Latitude: 45.40609242
Longitude: -118.79841640
Datum: WGS84
Township/Range/Section/Quarter-Quarter Section:
WM 2.00S 32.00E 10 NWSE
Address of Well:
64450 E. BIRCH CR RD PILOT ROCK OR

Well Label: L115141
Well Log: UMAT 57394
Printed: Sep 03, 2014

DISCLAIMER: This map is intended to represent the approximate location of the exempt use well provided by the land owner. It is not intended to be construed as survey accurate in any manner.



RECEIVED BY OWRD

G-19026

MAR 30 2015

SALEM, OR

Township 2 South, Range 32 East, W.M.

Umatilla County

NE ¼ SE ¼ of Section 10

NW ¼ SE ¼ of Section 10

SE ¼ NE ¼ of Section 10

SW ¼ NE ¼ of Section 10

RECEIVED BY OWRD

MAR 30 2015

SALEM, OR

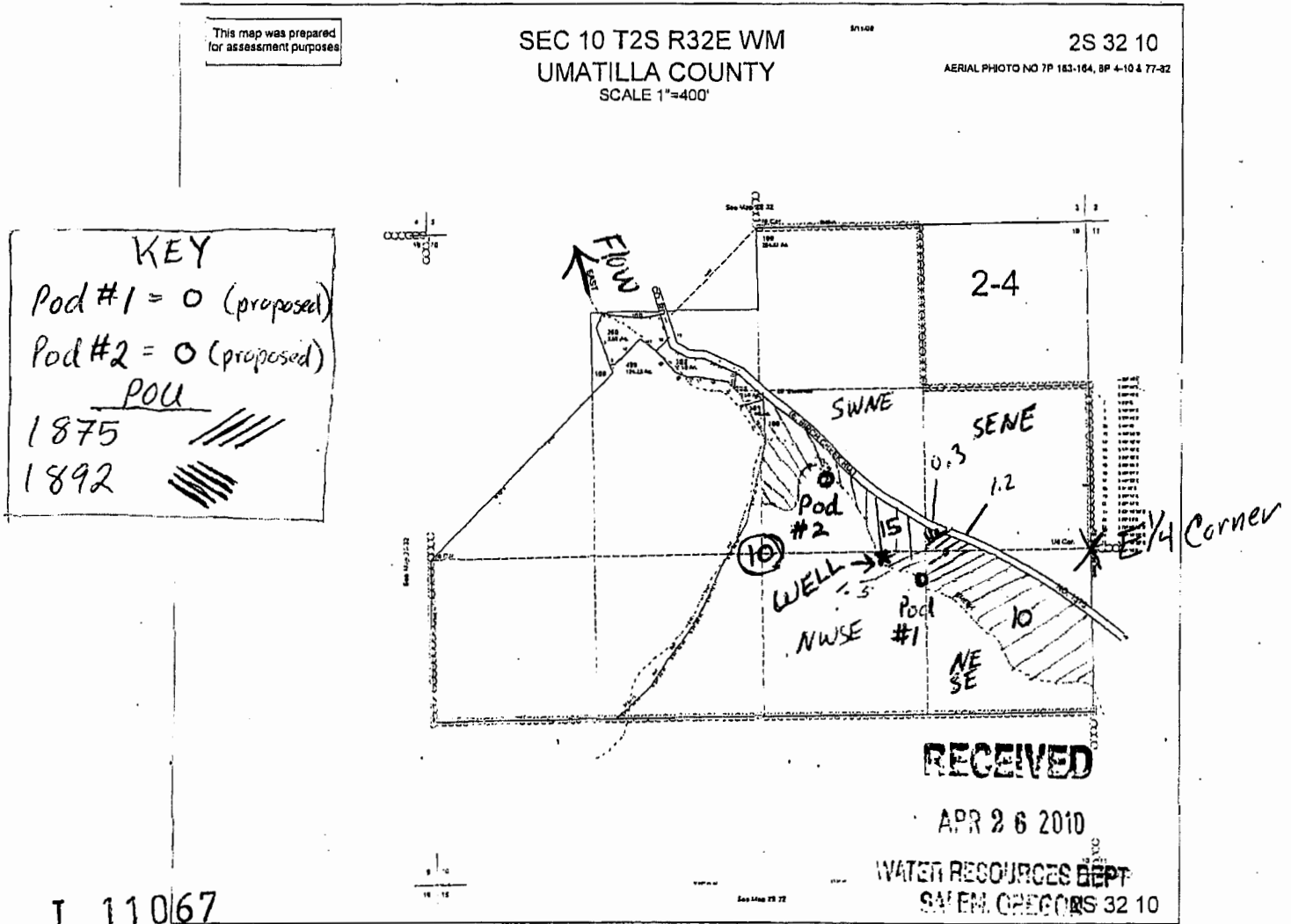

T 11067

Acres broken out by Pod & Priority date

Proposed Pod #1 Location (TL100)

GPS: N. 45.40550

W. -118.79739 (NWSE Sec. 10)
T. 2S., R. 32E. W.M.

Proposed Pod #2 Location (TL100)

GPS N. 45.40783

W. -118.80042 (SWNE Sec. 10)
T. 2S., R. 32E., W.M.

# Acres	¼¼	Priority	Pod #	TL #
10	NESE	1875	#1	100
1.5	NWSE	1875	#1	↓
1.2	SENE	1875	#1	
0.3	SENE	1892	#1	
15.0	SWNE	1892	#2	

* See Attachment #4 & #5 for Authorized Pod Map.

Well is Located "X" - 950' East & 140' South from the Center 1/4 corner Section 10
NOTE: Well to be used for supplemental use to irrigate all 28 acres as depicted by hatching.

GROUNDWATER APPLICATION MAP

in names of
ADOLPH & MARY WEINKE

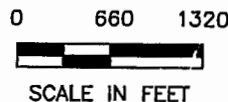
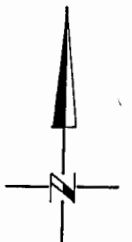

THIS MAP WAS PREPARED FOR THE PURPOSE OF IDENTIFYING THE LOCATION OF A WATER RIGHT ONLY AND IS NOT INTENDED TO PROVIDE LEGAL DIMENSIONS OR LOCATION OF PROPERTY OWNERSHIP LINES.