

Application for a Permit to Store Water in a Reservoir in the Name of Chris and Joan Horton

Polk County
Section 4, Township 10 South, Range 5 West (W.M.)

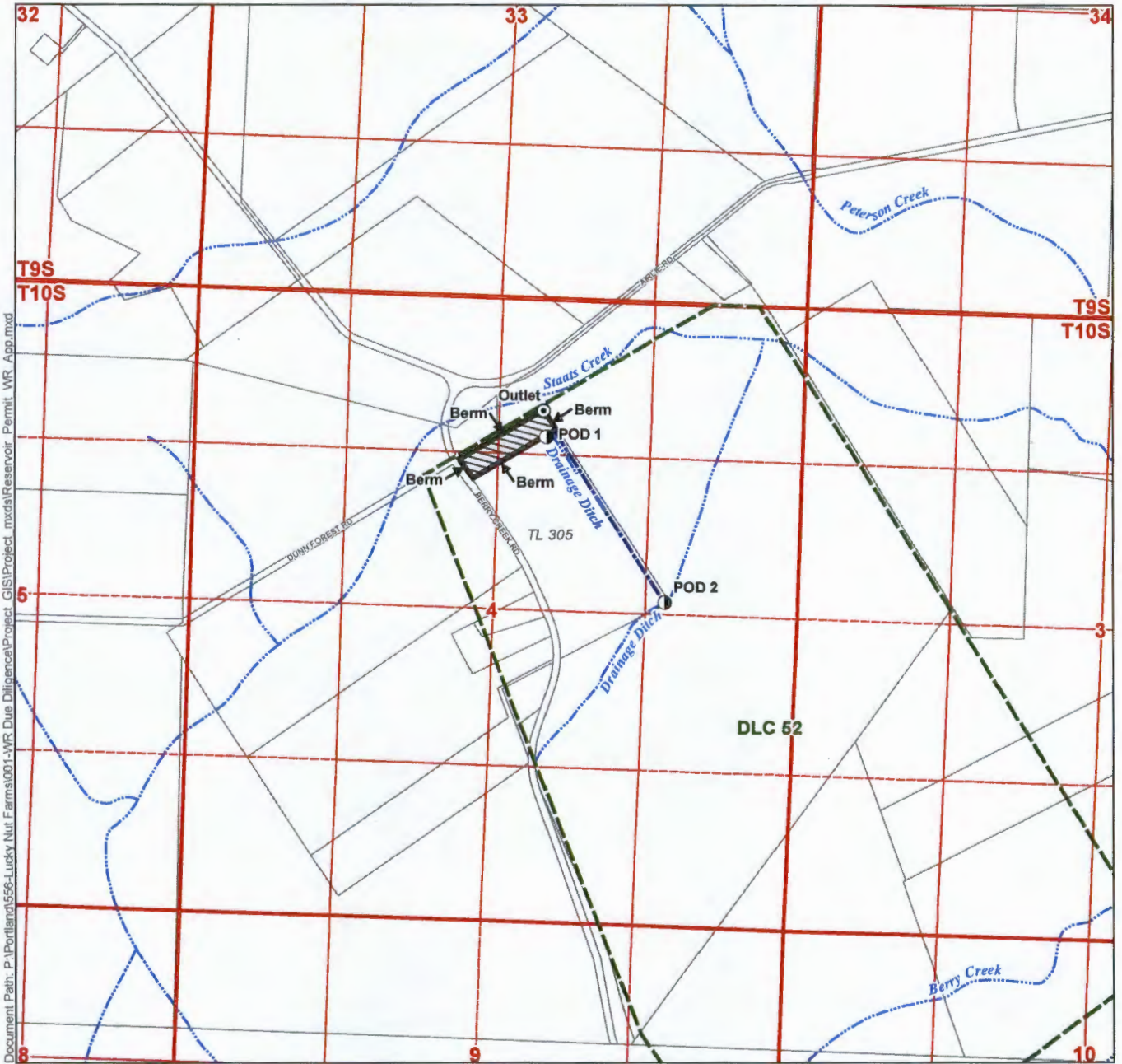

Document Path: P:\Portland\556-Lucky Nut Farms\001-WR Due Diligence\Project_GIS\Project_mxd\Reservoir_Permit_WR_App.mxd

LEGEND

-  Proposed Reservoir/
Proposed Place of Use (POU)
-  Conveyance Pipe
-  Donation Land Claim (DLC)
-  Proposed Point of Diversion (POD)
-  Tax Lots
-  Watercourses
-  Outlet

Center of Proposed Reservoir

Located 1,280 feet South and 2,555 feet West from the NE corner of Section 4, Township 10 South, Range 5 West (W.M.)

POD 1

Located 1,200 feet South and 2,230 feet West from the NE corner of Section 4, Township 10 South, Range 5 West (W.M.)

POD 2

Located 2,605 feet South and 1,155 feet West from the NE corner of Section 4, Township 10 South, Range 5 West (W.M.)

Disclaimer

This map was prepared for the purpose of identifying the location of a water right only and it is not intended to provide legal dimensions or location of property ownership lines.

Map Notes

Date: March 9, 2015

Date Sources: OWRD, US BLM, USGS, ESRI
Prepared By: GSI Water Solutions, Inc.

RECEIVED BY OWRD

APR 10 2015

SALEM, OR



0 660 1,320
1 inch = 1,320 feet



R-88073