

T.26S. R.6W. W.M.

Section 23

Douglas County

Scale 1" = 400'

Application/Permit Map
Scott and Cindy McGinnis

RECEIVED BY OWRD

APR 27 2015

SALEM, OR

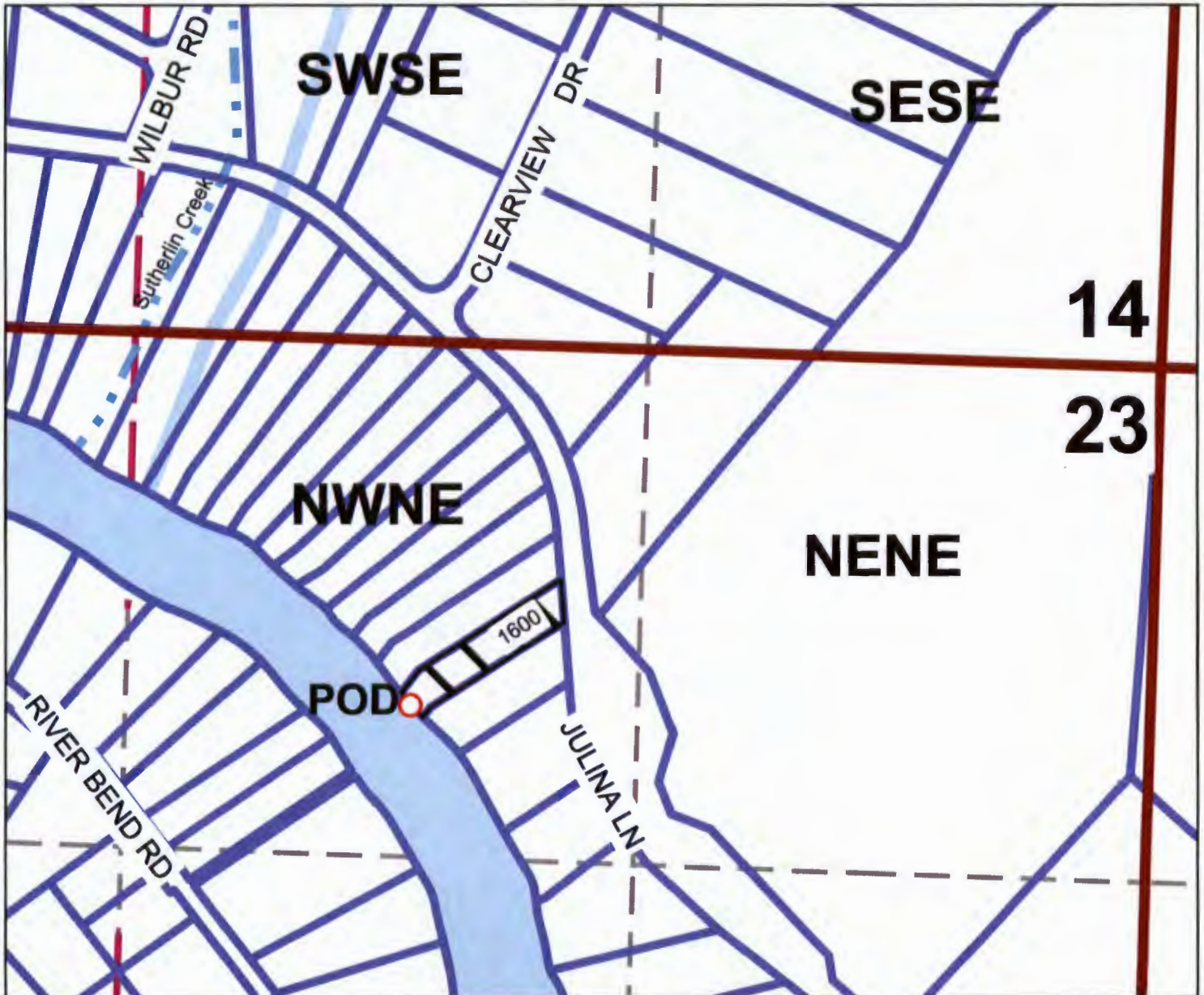

Point of Diversion is 900 ft. South and 1900 ft. West from the
Northeast corner of Section 23.

S-88075