

Nye Ditch Point of Diversion 32S-3E-28-NE/SW

**Nye Ditch Point of Diversion from Mill Creek
32S-3E-28-NE/SW
1860' North and 2690' East
from the SW corner of section 28**

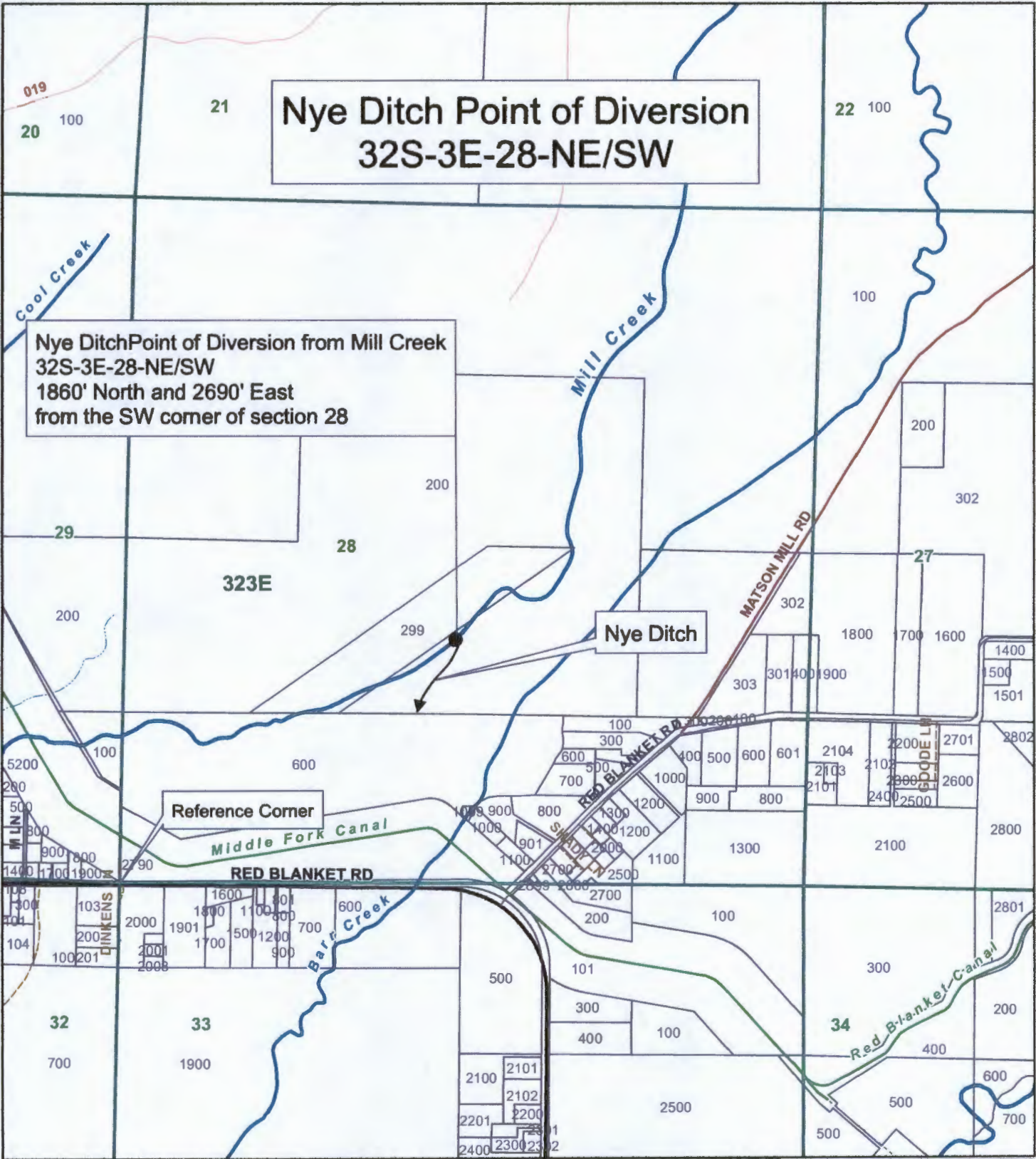

Legend

- Taxlots
- Sections
- Townships
- Nye Ditch
- Nye Ditch POD



1 inch = 1,000 feet

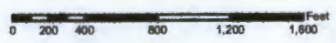

RECEIVED BY OWRD

**JACKSON COUNTY
WATERMASTER**

Prepared by Travis Kelly

This map is based on a digital database compiled by Jackson County from a variety of sources. Jackson County cannot accept responsibility for errors, omissions, or positional accuracy. There are no warranties, expressed or implied.

MAY 26 2015

SALEM, OR

S-8809

File: 04/23/2013_32-3E-28 NE-SW Nye Ditch POD.mxd, Kelly/TN

Human Consumption Place of Use Map 33S-2E-16-NE/NE Tax Lot 100

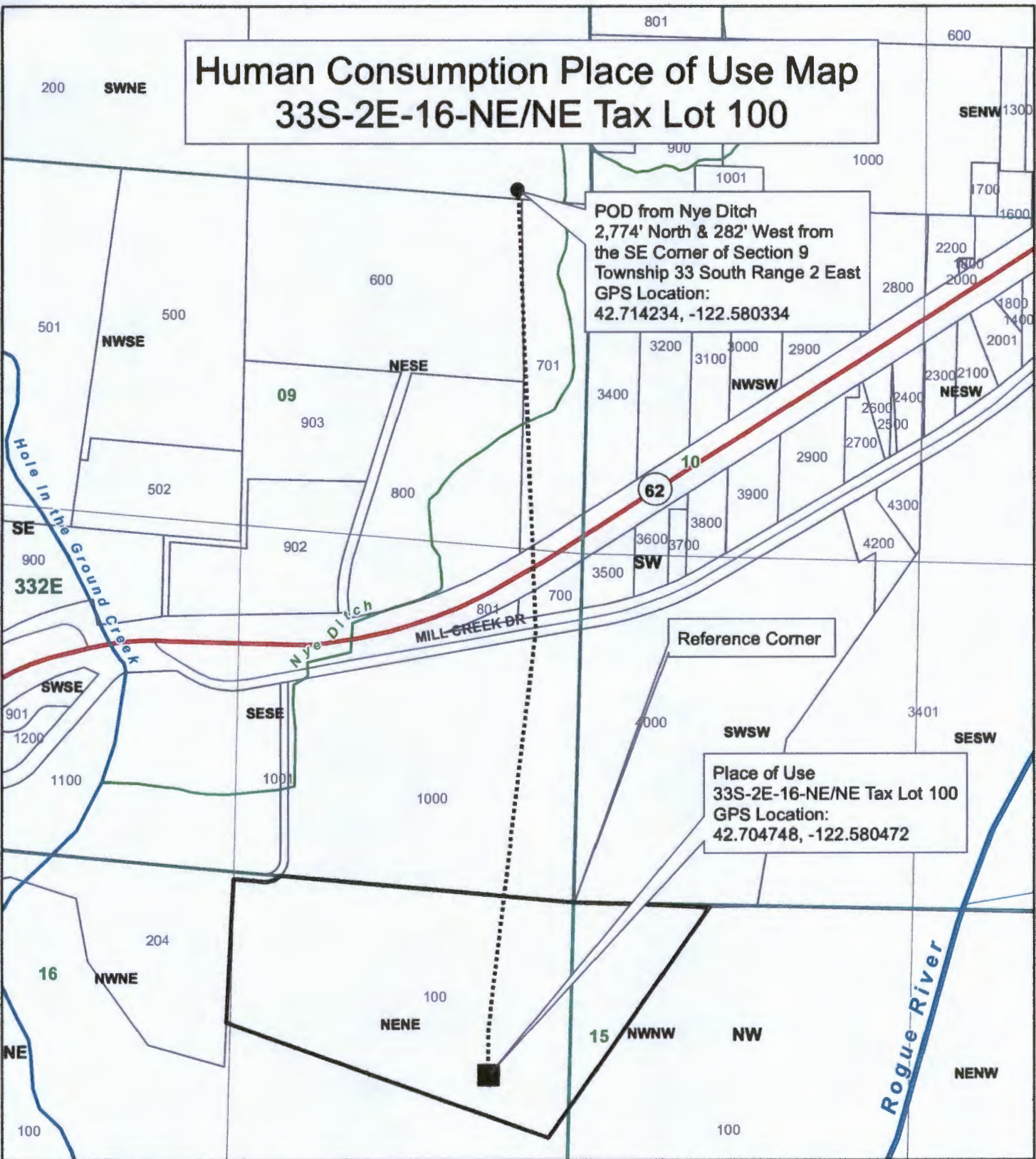

POD from Nye Ditch
2,774' North & 282' West from
the SE Corner of Section 9
Township 33 South Range 2 East
GPS Location:
42.714234, -122.580334

Place of Use
33S-2E-16-NE/NE Tax Lot 100
GPS Location:
42.704748, -122.580472

- Legend**
- Taxlot 100
 - Quarter Sections
 - Taxlots
 - Quarter Quarter Sections
 - Home Site
 - POD from Nye Ditch
 - Townships
 - 6" PVC Transport Pipe
 - Sections

1 inch = 500 feet



JACKSON COUNTY
WATERMASTER

Prepared by Travis Kelly

This map is based on a digital database compiled by Jackson County from a variety of sources. Jackson County cannot accept responsibility for errors, omissions, or positional accuracy. There are no warranties, expressed or implied.

RECEIVED BY NWRD

Date: 05/15/2015, 33-2E-16-NE-NE Taxlot 100 Michael Hamilton Human_Consumption.mxd, Kelly TN

S-88091

MAY 26 2015

SALEM, OR