

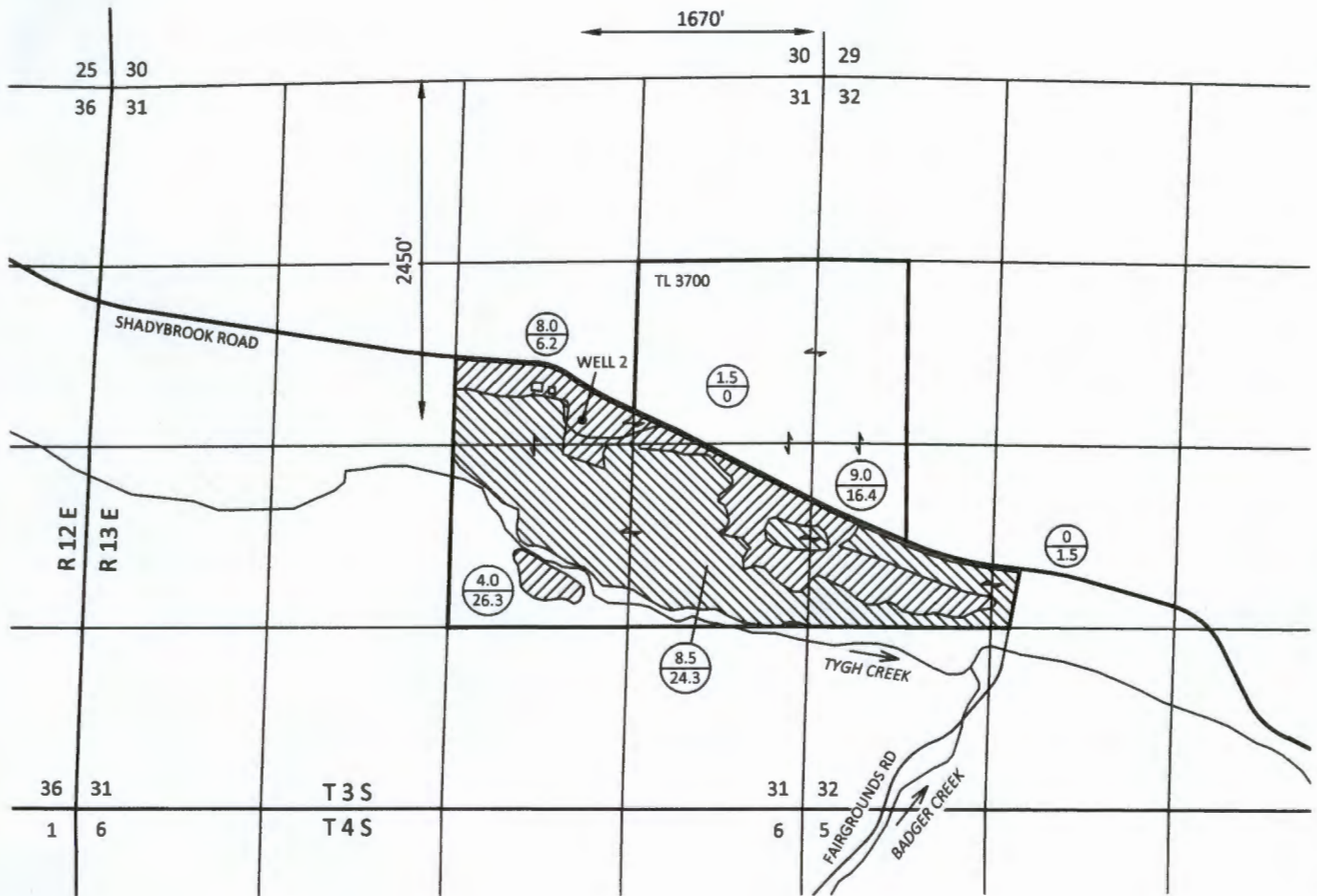



GROUNDWATER USE PERMIT APPLICATION MAP
Sections 31 & 32, T3S, R13E, W.M.,
Wasco County, Oregon
Justesen Brothers



EXPLANATION

-  PROPOSED PRIMARY PLACE OF USE
31.0 AC
-  PROPOSED SUPPLEMENTAL PLACE OF USE
74.7 AC
-  PROPOSED PRIMARY ACRES
PROPOSED SUPPLEMENTAL ACRES
-  WELL (WASC 52268)

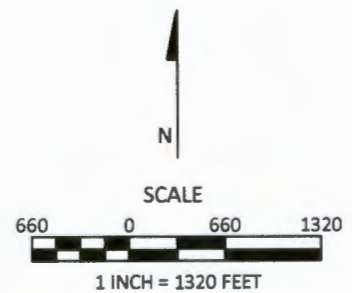

SKOOKUM
 WATER ASSOCIATES INC

P.O. BOX 80174
 PORTLAND, OR 97280
 (503) 319-8926

RECEIVED BY OWRD

JUN 15 2015

SALEM, OR

This map is not intended to provide legal dimensions or locations of property ownership lines

May 20, 2015

Figure 1

G-18103