



Oregon Water Resources Department
 725 Summer Street NE, Suite A
 Salem Oregon 97301
 (503) 986-0900
 www.wrd.state.or.us

Application for a Permit to Store Water in a Reservoir

(Alternate Review)

Alternate Review Process (ORS 537.409): You may use this form for any reservoir storing less than 9.2 acre-feet or with a dam less than 10 feet high.

Use a separate form for each reservoir

Please type or print in dark ink. If your application is found to be incomplete or inaccurate, we will return it to you. If any requested information does not apply, insert "n/a". A summary of review criteria and procedures that are generally applicable to these applications is available at www.wrd.state.or.us/OWRD/PUBS/forms.shtml.

1. APPLICANT INFORMATION

Applicant: Andersen Ranches = Larry D. Andersen
First Last
 Mailing Address: 1015 E. Rainier St.
Othello WA 99344
City State Zip
 Phone: 509-488-9045 541-443-2117
Home Work Other
 Fax: _____ E-Mail Address*: _____

* By providing an e-mail address, consent is given to receive all correspondence from the department electronically. (paper copies of the final order documents will also be mailed.)

2. AGENT INFORMATION

The agent is authorized to represent the applicant in all matters relating to this application.

Agent: _____
First Last
 Mailing Address: _____

City State Zip
 Phone: _____
Home Work Other
 Fax: _____ E-Mail Address*: _____

* By providing an e-mail address, consent is given to receive all correspondence from the department electronically. (paper copies of the final order documents will also be mailed.)

RECEIVED BY OWRD

3. LOCATION AND SOURCE

A. Reservoir Name: Webb Slough #1 JUL 06 2015

B. Source: Provide the name of the water body or other source from which water will be diverted, and the name of the stream or lake it flows into. Indicate if source is run-off, seepage, or an unnamed stream or spring.
 Source: Webb Slough Tributary to: Butter Creek

C. County in which diversion occurs: Umatilla

RECEIVED BY OWRD

App. No. <u>R-98110</u>	For Department Use Permit No. _____	Date <u>JUL 17 2015</u>
-------------------------	--	-------------------------

SALEM, OR

D. Reservoir Location

Township (N or S)	Range (E or W)	Section	quarter/quarter	tax lot number
T2S	R30E	10	NWSE	900

E. Dam: Maximum height of dam: 9 feet. If excavated, write "zero feet".

F. Quantity: Amount of water to be stored in the reservoir at maximum capacity. List volume in acre-feet: 3.70

Is this project fully or partially funded by the American Recovery and Reinvestment Act? (If dollars) Yes No

247' South
93' West
from Center of
2S 30E
Section 10

4. WATER USE

Indicate the proposed use(s) of the stored water. NOTE: You may wish to consider filing "use" for your reservoir. Multipurpose use does not limit the types of future uses for the stored water. Multipurpose covers all uses including: stockwater, fish and wildlife, aesthetics, domestic, irrigation, agriculture, fire protection and pollution abatement. If any use will be out of reservoir use, regardless of the type of storage listed, a secondary application must be filed to appropriate the stored water.

Multipurpose

RECEIVED BY OWRD

5. PROPERTY OWNERSHIP

JUL 06 2015

Please provide a copy of the recorded deed(s).

Do you own all the land where you propose to divert, transport, and use water?

Yes (please check appropriate box below then skip to section 5)

There are no encumbrances

This land is encumbered by easements, right of way, roads of way, roads or other encumbrances

No (Please check the appropriate box below)

I have a recorded easement or written authorization permitting access.

I do not currently have written authorization or easement permitting access.

Written authorization or an easement is not necessary, because the only affected lands I do not own are state-owned submersible lands, and this application is for irrigated and/or domestic use only (ORS 274.040). (Do not check this box if you described your use as "Multipurpose" in #3 above.)

List the names and mailing addresses of all affected landowners:

RECEIVED BY OWRD

JUL 17 2015

R-20110

SALEM2OR

6. ENVIRONMENTAL IMPACT

- A. Channel: Is the reservoir: in-stream or off channel?
- B. Wetland: Is the project in a wetland? Yes No Don't know
- C. Existing: Is this an existing reservoir? Yes No
If yes, how long has it been in place? _____ years.
- D. Fish Habitat: Is there fish habitat upstream of the proposed structure? Yes No Don't know
If yes, how much? _____ miles.
- E. Partnerships: Have you been working with other agencies? Yes No
Indicate agency, staff and phone numbers of those involved. Also indicate any agencies that are cost sharing in this project.

7. WITHIN A DISTRICT

Check here if the point of diversion or place of use are located within or served by an irrigation or other water district.

Irrigation District Name	Address	
City	State	Zip

8. DESCRIPTION

Provide a description of the design and operation of the proposed diversion, including a description of how live flow will be passed outside the authorized storage season. Use this space for narrative. You may also provide narrative and sketches on separate pages.

RECEIVED BY OWRD
JUL 06 2015
SALEM, OR

RECEIVED BY OWRD
JUL 17 2015
SALEM, OR

R 0810

If the diversion involves a dam, use this space for sketches of the diversion (e.g. cross-section of the dam with its dimensions, dimension and placement of outlet pipe, means of passing live flow outside of the authorized storage season, and means for providing fish passage).

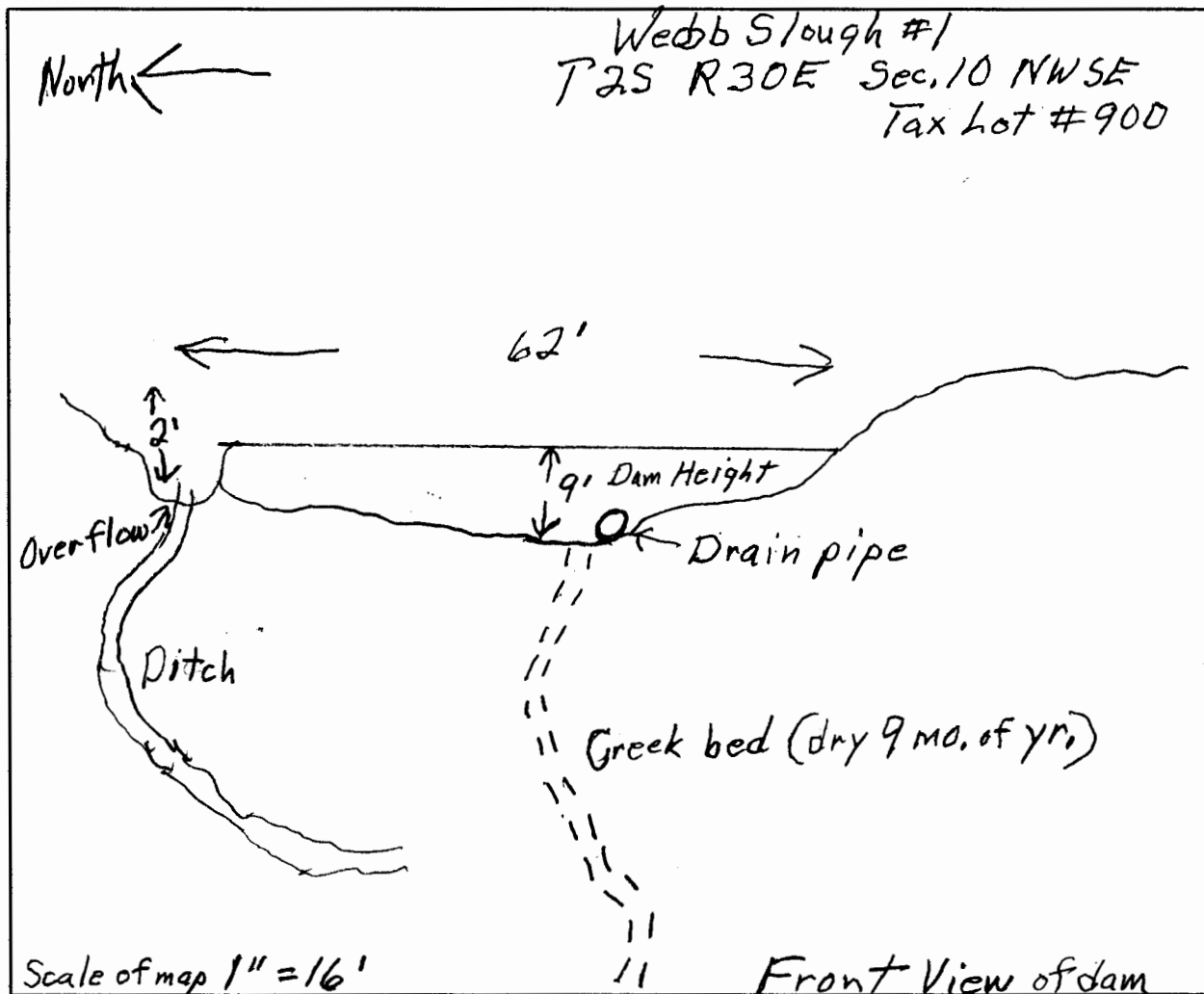

9. SIGNATURE

I swear that all statements made and information provided in this application are true and correct to the best of my knowledge.

Larry J. Cluden
Landowner Signature

6-18-15
Date

Before you submit your application be sure you have:

- Answered each question completely.
- Included a legible map that includes Township, Range, Section, quarter-quarter and tax lot number.
- The map must meet map requirements to be accepted.
- Included a land use form or receipt stub signed by a local planning official.
- Included a check payable to Oregon Water Resources Department for the appropriate amount.

RECEIVED BY OWRD

JUL 06 2015

RECEIVED BY OWRD SALEM, OR

JUL 17 2015 4

SALEM, OR

R-8910

WATERMASTER ALTERNATE RESERVOIR APPLICATION REVIEW SHEET

Recommendations for Water Right Applications under the Alternate Reservoir review process (ORS 537.409)

In lieu of the water right application process set forth in ORS 537.140 to 537.211, an owner of a reservoir may submit an alternate reservoir application for a reservoir that has a storage capacity less than 9.2 acre-feet or a dam or impoundment structure less than 10 feet in height. ORS 537.409 describes the criteria used to evaluate alternate reservoir applications.

The review shall be limited to issues pertaining to: a) water availability, b) potential detrimental impact to existing fishery resources; and c) potential injury to existing water rights. (ORS 537.409 (6))

Within 60 days after the department provides public notice...any person may submit detailed, legally obtained information in writing, requesting the department to deny the application for a permit on the basis that the reservoir: (a) Would result in injury to an existing water right; or (b) Would pose a significant detrimental impact to existing fishery resources. (ORS 537.409 (5))

The review of alternate reservoirs is limited to these criteria only.

Application #: R- Applicant's Name: *Larry Andersen - Webb Slough #1*

1) Does the proposed reservoir have the potential to injure existing water rights? NO YES

Explain: *No water should continue to be stored once regulation is taking place to meet senior water right holders needs*

2) Can conditions be applied to mitigate the potential injury to existing water rights? NO YES

If YES, which conditions are recommended:
Ponds should be constructed in a manner that allows flows to be bypassed.

3) Did you meet with staff from another agency to discuss this application? NO YES

Who: Agency: Date:
Who: Agency: Date:

Watermaster signature: *Greg Silbermagl* Date: *4/20/2015*

WRD Contact: Caseworker: Water Rights Division, 503-986-0900 / Fax 503-986-0901

RECEIVED BY OWRD
JUL 17 2015
SALEM, OR
RECEIVED BY OWRD
JUL 06 2015
SALEM, OR

NOTE: This completed form must be returned to the applicant

R-88110

ODFW Alternate Reservoir Application Review Sheet

This portion to be completed by the applicant

Applicant Name/Address/Phone/Email: Larry D. Andersen-Andersen Ranches
1015 E. Rainier St. Othello, WA 99344 509-488-9045

Reservoir Name: Webb Slough #1 Source: Webb Slough Volume (AF): _____

Twp Rng Sec QQ: T25 R30E Sec 10 Basin Name: _____ in-channel
 off-channel

Note: It is unlikely that ODFW will be able to complete this form while you wait, nevertheless we recommend making an appointment to submit the form so as to provide any necessary clarifications. See pg. 6 of Instructions for contact information.

This portion to be completed by Oregon Department of Fish and Wildlife (ODFW) District staff

- 1) Is the proposed project and AO¹ off channel? YES NO
 (if yes then proceed to #4; if no then proceed to #2)
- 2) Is the proposed project or AO located where NMF² are or were historically present?..... YES NO
 (if yes then proceed to #3; if no then proceed to #4)
- 3) If NMF are or were historically present:
- a. Is there an ODFW-approved fish-passage plan?..... YES NO
- b. Is there an ODFW-approved fish-passage waiver or exemption?..... YES NO

If fish passage is required under ORS 509.580 through .910, then either 3(a) or 3(b) must be "Yes" to move forward with the application. If responses to 3(a) and 3(b) are "No", then the proposed reservoir does not meet the requirements of Oregon Fish Passage Law and shall not be constructed as proposed.

- 4) Would the proposed project pose any other significant detrimental impact to an existing fishery resource locally or downstream?..... YES NO
 Explain below (for example, list STE species or other existing fishery resources that would be impacted negatively.)

Any diversion or appropriation of water for storage during the period _____ through _____ poses a significant detrimental impact to existing fishery resources. (For example, if diversion of water for storage during a certain time period would cause a significant detrimental impact to an existing fishery resource, then ODFW should recommend conditions or limitations.) If NMF fish are present at the project site or point of water diversion then the applicant should be advised that a fish screen consistent with screening criteria will be required.

This proposed pond or reservoir contemplates impounding water in the Columbia Basin above Bonneville Dam. ODFW has determined that additional diversions of water in this area pose a significant detrimental impact to existing fishery resources during the period April 15 through September 30.

RECEIVED BY OWRD RECEIVED BY OWRD

JUL 17 2015

JUL 03 2015

¹ AO = Artificial Obstruction means any dam, diversion, culvert or other human-made device placed in waters of this state that precludes or prevents the migration of native migratory fish. ORS 509.580 (1)

² NMF = Native Migratory Fish Species in Oregon as defined by OAR 635 - 412 - 0005 (32)

R-0010

If YES, can conditions be applied to mitigate the significant detrimental impact to an existing fishery resource?
 NO (explain) YES (select from Menu of Conditions on next page)

b51a Period of use Oct. 1 - April 14

Dam shall be constructed to
pass water during non-storage period
as per Div. 33 rules.

RECEIVED BY OWRD

JUL 06 2015

SALEM, OR

ODFW Signature: William B. Duke Print Name: William B. Duke
ODFW Title: Umatilla District fish Biologist Date: 4/14/2015

NOTE: This completed form must be returned to the applicant.

RECEIVED BY OWRD

JUL 17 2015

SALEM, OR

Land Use Information Form



Oregon Water Resources Department
725 Summer Street NE, Suite A
Salem, Oregon 97301-1266
(503) 986-0900
www.wrd.state.or.us

Applicant: Andersen Ranches = Larry D. Andersen
First Last

Mailing Address: 1015 E. Rainier St.

Othello WA 99344 Daytime Phone: 509-488-9045
City State Zip

A. Land and Location

Please include the following information for all tax lots where water will be diverted (taken from its source), conveyed (transported), and/or used or developed. Applicants for municipal use, or irrigation uses within irrigation districts may substitute existing and proposed service-area boundaries for the tax-lot information requested below.

Township	Range	Section	¼ ¼	Tax Lot #	Plan Designation (e.g., Rural Residential/RR-5)	Water to be:	Proposed Land Use:
T2S	R30E	10	NWSE	900	EFU	<input type="checkbox"/> Diverted <input type="checkbox"/> Conveyed <input type="checkbox"/> Used	
						<input type="checkbox"/> Diverted <input type="checkbox"/> Conveyed <input type="checkbox"/> Used	
						<input type="checkbox"/> Diverted <input type="checkbox"/> Conveyed <input type="checkbox"/> Used	
						<input type="checkbox"/> Diverted <input type="checkbox"/> Conveyed <input type="checkbox"/> Used	

List all counties and cities where water is proposed to be diverted, conveyed, and/or used or developed:

RECEIVED BY OWRD

JUL 06 2015

B. Description of Proposed Use

Type of application to be filed with the Water Resources Department:

SALEM, OR

- Permit to Use or Store Water
 Water Right Transfer
 Permit Amendment or Ground Water Registration Modification
 Limited Water Use License
 Allocation of Conserved Water
 Exchange of Water

Source of water: Reservoir/Pond
 Ground Water
 Surface Water (name) Webb Slough

Estimated quantity of water needed: 400 gal. per day for 30 days
 cubic feet per second
 gallons per minute
 acre-feet

Intended use of water:
 Irrigation
 Commercial
 Industrial
 Domestic for household(s)
 Municipal
 Quasi-Municipal
 Instream
 Other Cattle Drinking water

Briefly describe:

Pond for Cattle + Wildlife drinking water

Note to applicant: If the Land Use Information Form cannot be completed while you wait, please have a local government representative sign the receipt at the bottom of the next page and include it with the application filed with the Water Resources Department.

RECEIVED BY OWRD

See bottom of Page 3. →

JUL 17 2015

SALEM, OR
10

R-8810

For Local Government Use Only

The following section must be completed by a planning official from each county and city listed unless the project will be located entirely within the city limits. In that case, only the city planning agency must complete this form. This deals only with the local land-use plan. Do not include approval for activities such as building or grading permits.

Please check the appropriate box below and provide the requested information

- Land uses to be served by the proposed water uses (including proposed construction) are allowed outright or are not regulated by your comprehensive plan. Cite applicable ordinance section(s): UCDC 152.05(d)(A) Family-Raising
- Land uses to be served by the proposed water uses (including proposed construction) involve discretionary land-use approvals as listed in the table below. (Please attach documentation of applicable land-use approvals which have already been obtained. Record of Action/land-use decision and accompanying findings are sufficient.) **If approvals have been obtained but all appeal periods have not ended, check "Being pursued."**

Type of Land-Use Approval Needed (e.g., plan amendments, rezones, conditional-use permits, etc.)	Cite Most Significant, Applicable Plan Policies & Ordinance Section References	Land-Use Approval:	
		<input type="checkbox"/> Obtained <input type="checkbox"/> Denied	<input type="checkbox"/> Being Pursued <input type="checkbox"/> Not Being Pursued
		<input type="checkbox"/> Obtained <input type="checkbox"/> Denied	<input type="checkbox"/> Being Pursued <input type="checkbox"/> Not Being Pursued
		<input type="checkbox"/> Obtained <input type="checkbox"/> Denied	<input type="checkbox"/> Being Pursued <input type="checkbox"/> Not Being Pursued
		<input type="checkbox"/> Obtained <input type="checkbox"/> Denied	<input type="checkbox"/> Being Pursued <input type="checkbox"/> Not Being Pursued
		<input type="checkbox"/> Obtained <input type="checkbox"/> Denied	<input type="checkbox"/> Being Pursued <input type="checkbox"/> Not Being Pursued

Local governments are invited to express special land-use concerns or make recommendations to the Water Resources Department regarding this proposed use of water below, or on a separate sheet.

RECEIVED BY OWRD

JUL 06 2015

SALEM, OR

Name: CAROL JOHANSON Title: Planner
 Signature: *Carol Johanson* Phone: 541-278-6252 Date: 5-1-2015
 Government Entity: Washtenaw County

Note to local government representative: Please complete this form or sign the receipt below and return it to the applicant. If you sign the receipt, you will have 30 days from the Water Resources Department's notice date to return the completed Land Use Information Form or WRD may presume the land use associated with the proposed use of water is compatible with local comprehensive plans.

Receipt for Request for Land Use Information

Applicant name: _____
 City or County: _____ Staff contact: _____
 Signature: _____ Phone: _____ Date: JUL 17 2015

A-0010

1 SALEM, OR

Alternate Reservoir Application Completeness Checklist

This is the checklist used by WRD staff

Application _____ County _____
Priority Date _____ Township _____ Range _____ Section _____ Taxlot _____
Use _____ Caseworker _____
Amount (AF) _____ Watermaster _____

Minimum Requirements (ORS 537.409)

- Completed Watermaster review sheet** signed and dated by Watermaster.
Will the reservoir injure an existing water right? YES NO
If YES, can conditions be applied to mitigate the injury? YES NO **If NO, return the application.**
Did the watermaster determine when water is available for the proposed use? YES NO
The Watermaster review sheet must have been completed within the last 6 months.
If the watermaster determined that water is NOT available, return the application.
- Completed ODFW review sheet** signed and dated by ODFW representative.
Will the reservoir pose a significant detrimental impact to an existing fishery resource? YES NO
If YES, can conditions be applied to mitigate the impact? YES NO **If NO, return the application.**
The ODFW review sheet must have been completed within the last 6 months.
- Completed Land-Use Form** or receipt signed by the appropriate planning department official enclosed?
Does the use on land-use form match the proposed use on the application? Must be an original "wet" signature within the last 12 months.
- Landowner Name, Mailing Address** and Telephone Number.
- Source** and tributary listed. **NO WELLS-MUST HAVE GW APP TO USE A WELL AS A SOURCE !!**
- Reservoir Location**- Township, Range, Section, Quarter Quarter, Taxlot
- Dam height**, if applicable
- Total Quantity** of Storage Requested: 3.70
- Proposed Use of the water....**Cannot accept application for use of this stored water at the same time (E2)
- Property ownership indicated?** If applicant does not own all the land is the affected landowner's name and mailing address listed? (Including: lands not owned by applicant, upon which the source is locatedor..... that are crossed by the diversion works. This includes any roads or rights-of-way.)
- Provide the **legal description** of all the property involved with this application. You may include a copy of your deed land sales contract or title insurance to meet this requirement
- Environmental Impact** section completed?
- Application signed by the landowner(s)?** All parties noted as applicants must sign the application.
Must be an original "wet" signature.
- Acceptable map ** Indicates requirements of standards set forth by the Commission and causes fatal flaw if not provided by the applicant.**
- Reservoir Location - noting Township, Range, Section, 1/4 1/4 and Tax Lot number(s)*
- Scale of the Map (not less than 1" = 1320') **
- Reference corner on map
- North Directional Symbol **
- 1/4's clearly identified
- Reservoir clearly identified **
- Dam or POD (If off channel) Location coordinates referenced to a government land survey corner* If no dam, use coordinates to center of reservoir.**
- Fees enclosed**? Examination: Base Fee\$ _____ Permit Recording Fee\$ _____
plus\$ _____
plus\$ _____

RECEIVED BY OWRD

JUL 17 2015

SALEM, OR

Total Paid \$ _____ Total Fees \$ _____
Completeness Check by: _____ Date: _____

Revised 2011-3-3

430 0379

WARRANTY DEED

RECEIVED

FEB 14 2003

UMATILLA COUNTY RECORDS

KNOW ALL MEN BY THESE PRESENTS, That MAYANNA S. KOPP

hereinafter called grantor, for the consideration hereinafter stated, to grantor paid by ANDERSEN RANCHES

hereinafter called grantee, does hereby grant, bargain, sell and convey unto the said grantee and grantee's heirs, successors and assigns, that certain real property, with the tenements, hereditaments and appurtenances thereunto belonging or appertaining, situated in the County of UMATILLA and State of Oregon, described as follows, to-wit:

SEE EXHIBIT A WHICH IS MADE A PART HEREOF BY THIS REFERENCE

***** this transfer is part of an IRC Section 1031 Tax deferred Exchange on behalf of the Grantee

To Have and to Hold the same unto the said grantee and grantee's heirs, successors and assigns forever. And said grantor hereby covenants to and with said grantee and grantee's heirs, successors and assigns, that grantor is lawfully seized in fee simple of the above granted premises, free from all encumbrances except in one

Subject to any and all easements, restrictions and covenants of record

and that grantor will warrant and forever defend the said premises and every part and parcel thereof against the lawful claims and demands of all persons whomsoever, except those claiming under the above described encumbrances.

The true and actual consideration paid for this transfer, stated in terms of dollars, is \$469,500.00. *****

*However, the actual consideration consists of or includes other property or value given or promised which is (the whole/part of the) consideration (indicate which). * (The sentence between the symbols *, if not applicable should be deleted. See ORS 93.030.)

In construing this deed and where the context so requires, the singular includes the plural and all grammatical changes shall be implied to make the provisions hereof apply equally to corporations and to individuals.

In Witness Whereof, the grantor has executed this instrument this 10th day of February 2003; if a corporate grantor, it has caused its name to be signed and seal affixed by its officers, duly authorized thereto by order of its board of directors.

THIS INSTRUMENT WILL NOT ALLOW USE OF THE PROPERTY DESCRIBED IN THIS INSTRUMENT IN VIOLATION OF APPLICABLE LAND USE LAWS AND REGULATIONS, BEFORE SIGNING OR ACCEPTING THIS INSTRUMENT, THE PERSON ACQUIRING FEE TITLE TO THE PROPERTY SHOULD CHECK WITH THE APPROPRIATE CITY OR COUNTY PLANNING DEPARTMENT TO VERIFY APPROVED USES AND TO DETERMINE ANY LIMITS ON LAWSUITS AGAINST FARMING OR FOREST PRACTICES AS DEFINED IN ORS 30.930.

Mayanna S. Kopp
MAYANNA S. KOPP

RECEIVED BY OWRD RECEIVED BY OWRD

JUL 17 2015 JUL 06 2015

SALEM, OR SALEM, OR

STATE OF OREGON
County of UMATILLA } ss.

BE IT REMEMBERED, That on this 10th day of FEBRUARY, 2003, before me, the undersigned, a Notary Public in and for said County and State, personally appeared the within named MAYANNA S. KOPP

known to me to be the identical individual described in and who executed the within instrument and acknowledged to me that she executed the same freely and voluntarily.

IN TESTIMONY WHEREOF, I have hereunto set my hand and affixed my official seal the day and year last above



Amy G. Freeman
Notary Public for Oregon.
My Commission expires 11-19-04

MAYANNA S. KOPP
PO BOX N
PILOT ROCK, OR 97868

Grantor's Name and Address
ANDERSEN RANCHES
64434 GURDANE ROAD
PILOT ROCK, OREGON 97868

Grantee's Name and Address
After recording return to:
PIONEER ESCROW, INC.
132 SE COURT
PENDLETON, OR 97801



2003-4300379 1 of 3

STATE State of Oregon }
County County of Umatilla }

I do This instrument was received and recorded on 02-14-03 at 3:15

In the record of instrument code type DE-WD

Record Instrument Number 2003-4300379
Fee 38.00

Office of County Records

Name [Signature]
By [Signature] Records Officer

Space Reserved for Recorder's Use

Until a change is requested, all tax statements shall be sent to the following address.

SAME AS GRANTEE

126 SE Court, Pend. OR, 97801

13