

T.3S. R.2E. Section 27, W.M.

RECEIVED

AUG 07 2015





WATER RESOURCES DEPT
SALEM, OREGON

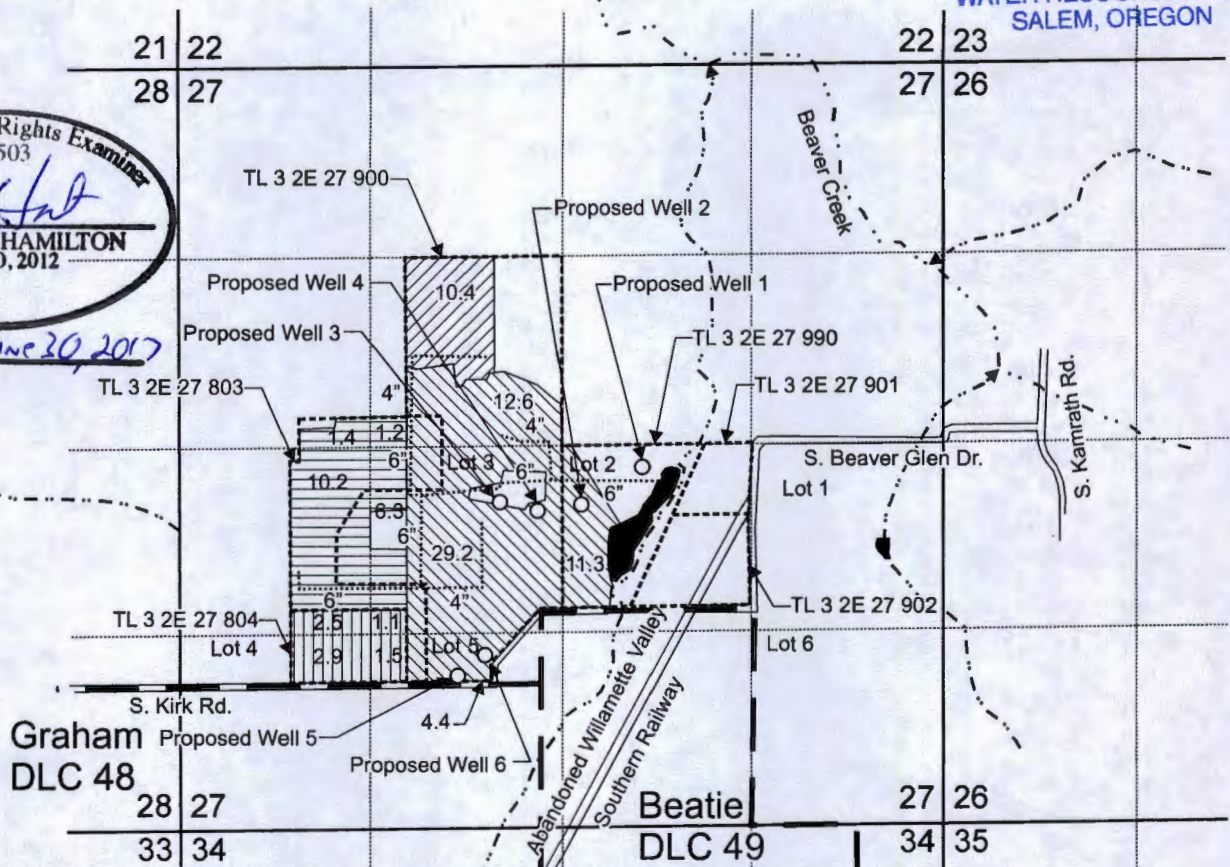

Certified Water Rights Examiner
85503
Doa Ham
DOANN M. HAMILTON
May 10, 2012

RENEWS June 30, 2017

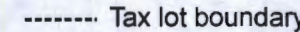
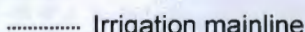

Proposed Well 1 is located 2,460 feet north and 2,055 feet west from the SE corner, Section 27.
 Proposed Well 2 is located 2,200 feet north and 2,475 feet west from the SE corner, Section 27.
 Proposed Well 3 is located 2,270 feet north and 2,175 feet east from the SW corner, Section 27.
 Proposed Well 4 is located 2,210 feet north and 2,435 feet east from the SW corner, Section 27.
 Proposed Well 5 is located 1,070 feet north and 1,890 feet east from the SW corner, Section 27.
 Proposed Well 6 is located 1,215 feet north and 2,070 feet east from the SW corner, Section 27.

-  Area (10.4 Acres) to be supplementally irrigated (primary irrigation under Certificate 27941).
-  Area (57.4 Acres) to be supplementally irrigated (primary irrigation under Certificate 20351 and supplementally irrigated by Certificate 27941).
-  Area (19.1 Acres) to be supplementally irrigated (primary irrigation under Certificate 47384).
-  Area (8.0 Acres) to be supplementally irrigated (primary irrigation under Certificate 55068).

-  Tax lot boundary
-  Irrigation mainline
-  Donation Land Claim boundary

Scale: 1" = 1,320'



This map was prepared for the purpose of identifying the location of a water right only and is not intended to provide legal dimensions or location of property ownership lines.

Groundwater Permit Application Map

John Childs
T.3S. R.2E. Section 27, W.M.

Pacific Hydro-Geology Inc.

06/2015

ChildsGWAppMap.cdr





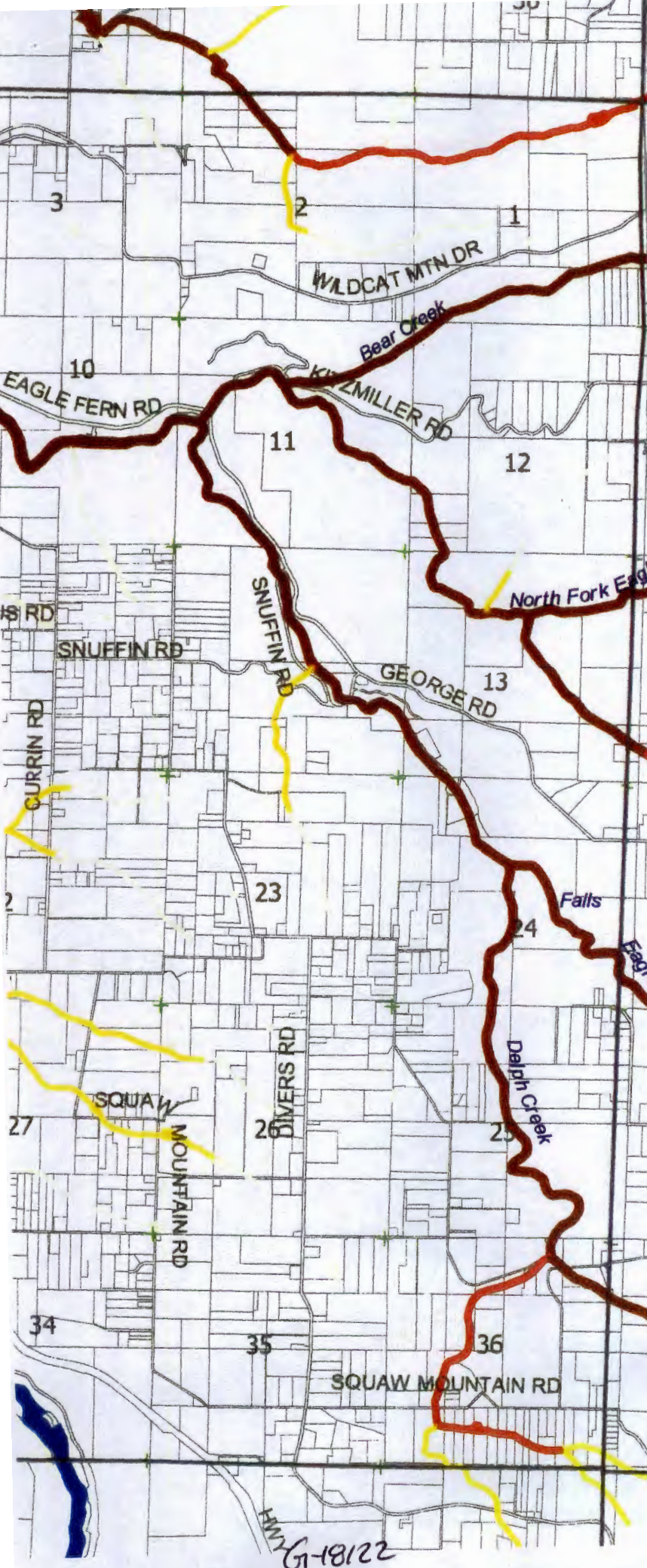

G-18122

Clackamas County

River & Stream Corridor Areas (RSCA)

RURAL AREA ESTACADA MAP 5



-  Urban Growth Boundary
-  Principal Rivers
- River and Stream Classifications**
-  Large
-  Medium
-  Small
-  Not Subject to RSCA Regulations
- Incorporated Areas**

RECEIVED

AUG 07 2015

WATER RESOURCES DEPT
SALEM, OREGON

Information Source:
Water Protection
Rules Classification
(WPRC) maps.

Origin:
Oregon Department of

HWY 19122

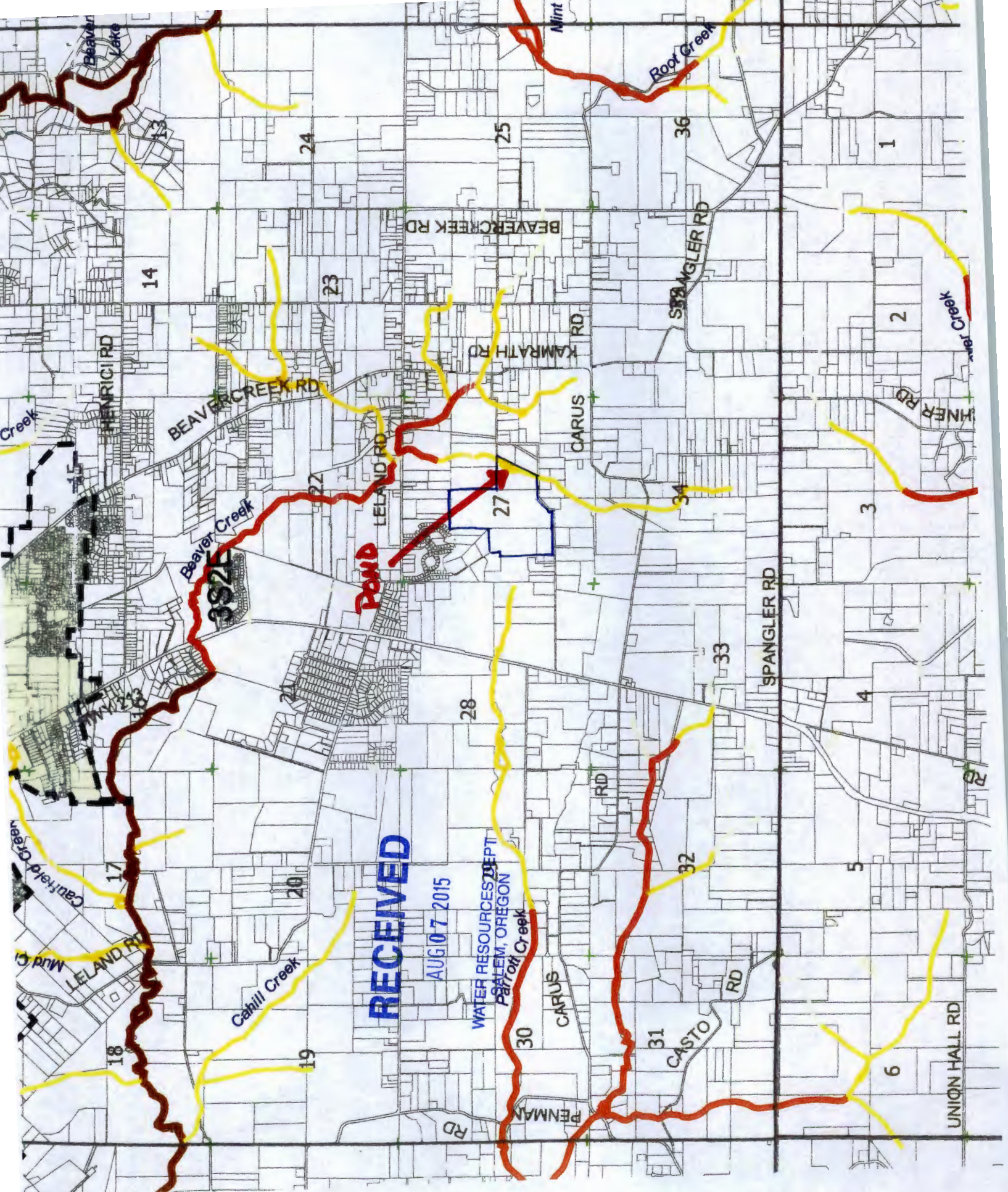

RECEIVED

AUG 07 2015

WATER RESOURCES DEPT
SALEM, OREGON

POND

3925

Beaver Creek

BEAVER CREEK RD

BEAVER CREEK RD

Root Creek

Mint

Beaver Lake

14

24

25

36

1

23

KAMRATH RD

SPANGLER RD

2

Inner Rd

27

LELAND RD

CARUS RD

3

3925

27

34

SPANGLER RD

4

28

RD

33

5

Cahill Creek

17

20

RECEIVED

AUG 07 2015

WATER RESOURCES DEPT
SALEM, OREGON

Cahill Creek

Cahill Creek

28

30

CARUS RD

32

5

Mud Cr

LELAND RD

18

19

RD

PENMAN

31

CASTO RD

6

UNION HALL RD

22R122



G-18/22



AUG 07 2015

WATER RESOURCES DEPT
SALEM, OREGON



G-18122

RECEIVED

AUG 07 2015

WATER RESOURCES DEPT
SALEM, OREGON