

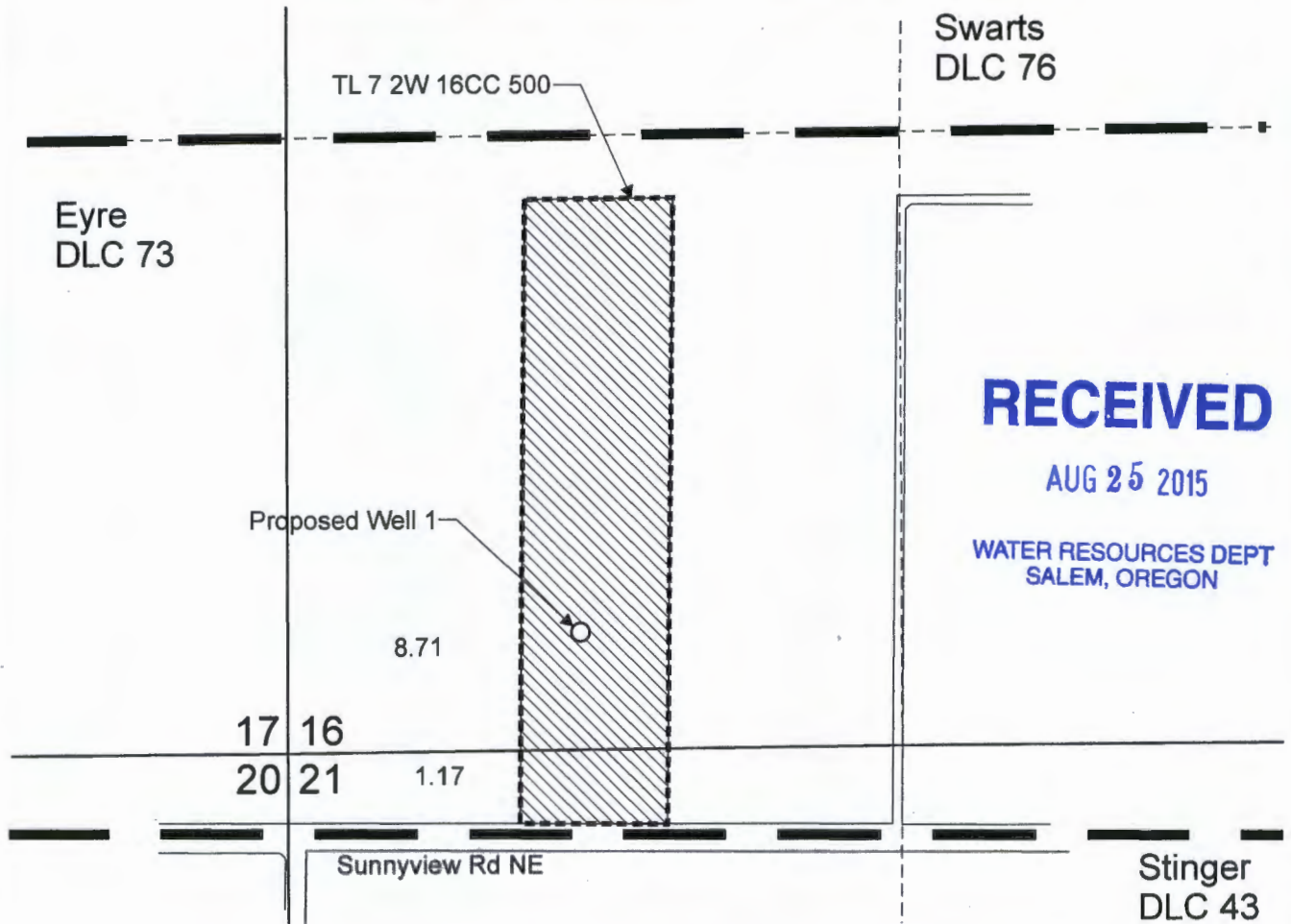

T.7S. R.2W. Sec. 16 & 21, W.M.



Proposed Well 1 is located 260 feet north and 630 feet east from the SW corner, Section 16.

 Area (9.88 Acres) to be irrigated.

----- Tax lot boundary

— . Donation Land Claim boundary



RENEWS June 30, 2017

Scale: 1" = 400'

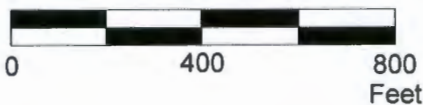

This map was prepared for the purpose of identifying the location of a water right only and is not intended to provide legal dimensions or location of property ownership lines.



Water Right Application Map

Clifton Eldred
T.7S. R.2W. Sec. 16 & 21, W.M.

Pacific Hydro-Geology Inc.

08/2015

G-10135