

T20S, R46E, Sections 11 and 12, W.M.

RECEIVED
SEP 25 2015
OWRD

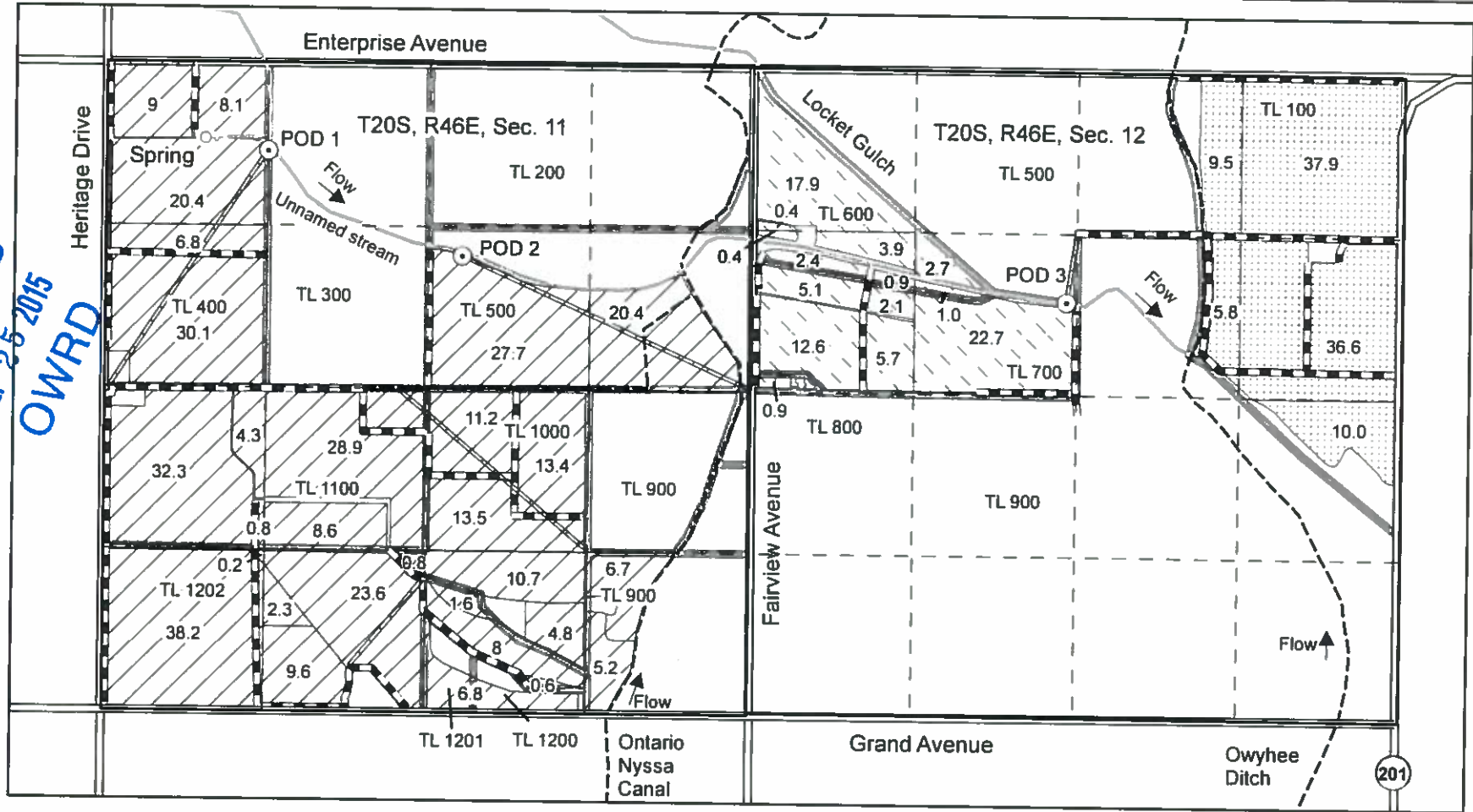

- Spring
 - ⊙ POD
 - - - Quarter Quarter
 - Section Line
 - - - Canal
 - ▬ Irrigation Ditch
 - ▬ Pipe line
 - ▬ Road
 - ▬ Stream
- Proposed supplemental surface water right**
- Irrigate with POD 1 (primary 75691)
 - Irrigate with POD 2 (primary 75691)
 - Irrigate with POD 3 (primary 75699)
 - ▬ Tax Lot Lines

This map is not intended to provide legal dimensions or locations of property ownership lines.

0 660 1,320 Feet

1 inch = 1,320 feet

N

POD 1 proposed (confluence Waste Ditch / unnamed drain) is located in T20S, R46E, NW NW Section 11, 1310 feet east and 710 feet south from the NW corner of section 11.

POD 2 authorized (Waste Ditch) is located in T20S, R46E, SW NE Section 11, 1490 feet south and 140 feet east from the N ¼ corner of section 11.

POD 3 authorized (Locket Gulch) is located in T20S, R46E, SE NW Section 12, 1880 feet south and 2550 feet east from the NW corner of section 12.

The spring is located 850 feet east and 610 feet south of the NW of section 11.

Surface Water Permit Application
 Tax lots 100, 600, 700, 800 in Section 11
 Tax lots 400, 500, 900, 1000, 1100, 1200, 1201, 1202 in Section 12
 James Farmer, Charles Warren Farmer, Margaret M. Farmer
 Map prepared by Nancy Rorick Consulting