

SECTIONS 7 & 8, T34S, R5W, W.M.
JOSEPHINE COUNTY

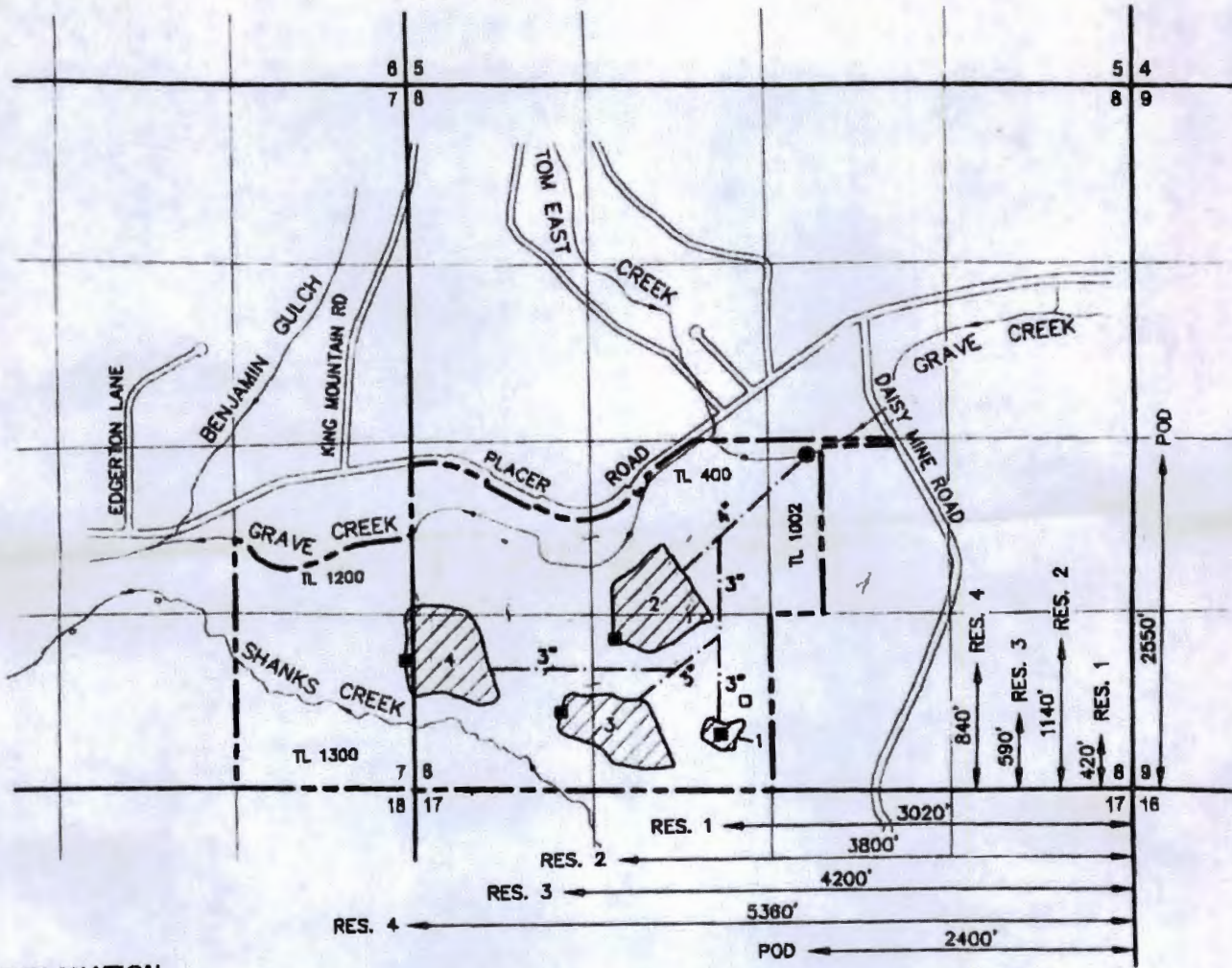
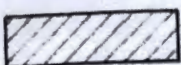

- POINT OF DIVERSION (POD)
- DAM OR CENTER OF RESERVOIR
-  PROPOSED RESERVOIR AND NUMBER
- SECTION LINE
- - - PROPERTY LINE
- CREEK OR INTERMITTENT STREAM
- PAVED ROAD
- - - UNPAVED ROAD
- - - PROPOSED PIPELINE AND SIZE

NOTE:
RESERVOIRS WILL BE LOCATED OFF CHANNEL.

AUGUST 7, 2013

THIS MAP IS NOT INTENDED TO PROVIDE LEGAL DIMENSIONS OR LOCATIONS OF PROPERTY OWNERSHIP LINES

SKOOKUM

P.O. BOX 80174
PORTLAND, OR 97280
(503) 319-8926

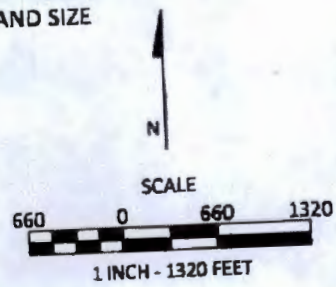

Sunny Valley Sand and Gravel Inc.
Reservoir Application Map
Westlake Consultants, Inc.

RECEIVED

SEP 19 2015

WATER RESOURCES DEPT
SALEM, OREGON

U-1612

