

RECEIVED  
JUN 26 1975  
STATE ENGINEER  
SALEM, OREGON

**PROPOSED  
FOREST GROVE  
WATER SERVICE AREA**

STATE & FEDERAL HIGHWAYS  
COUNTY ROADS, PAVED  
COUNTY ROADS, UNPAVED  
RAILWAYS  
INCORPORATED CITIES

Red figures represent house numbering system divided into twenty blocks per mile. 100 numbers to block.  
**Application No. 48359**  
**Permit No. 37837**

ROAD MAP  
OF  
**WASHINGTON COUNTY**  
OREGON  
AUG. 1968

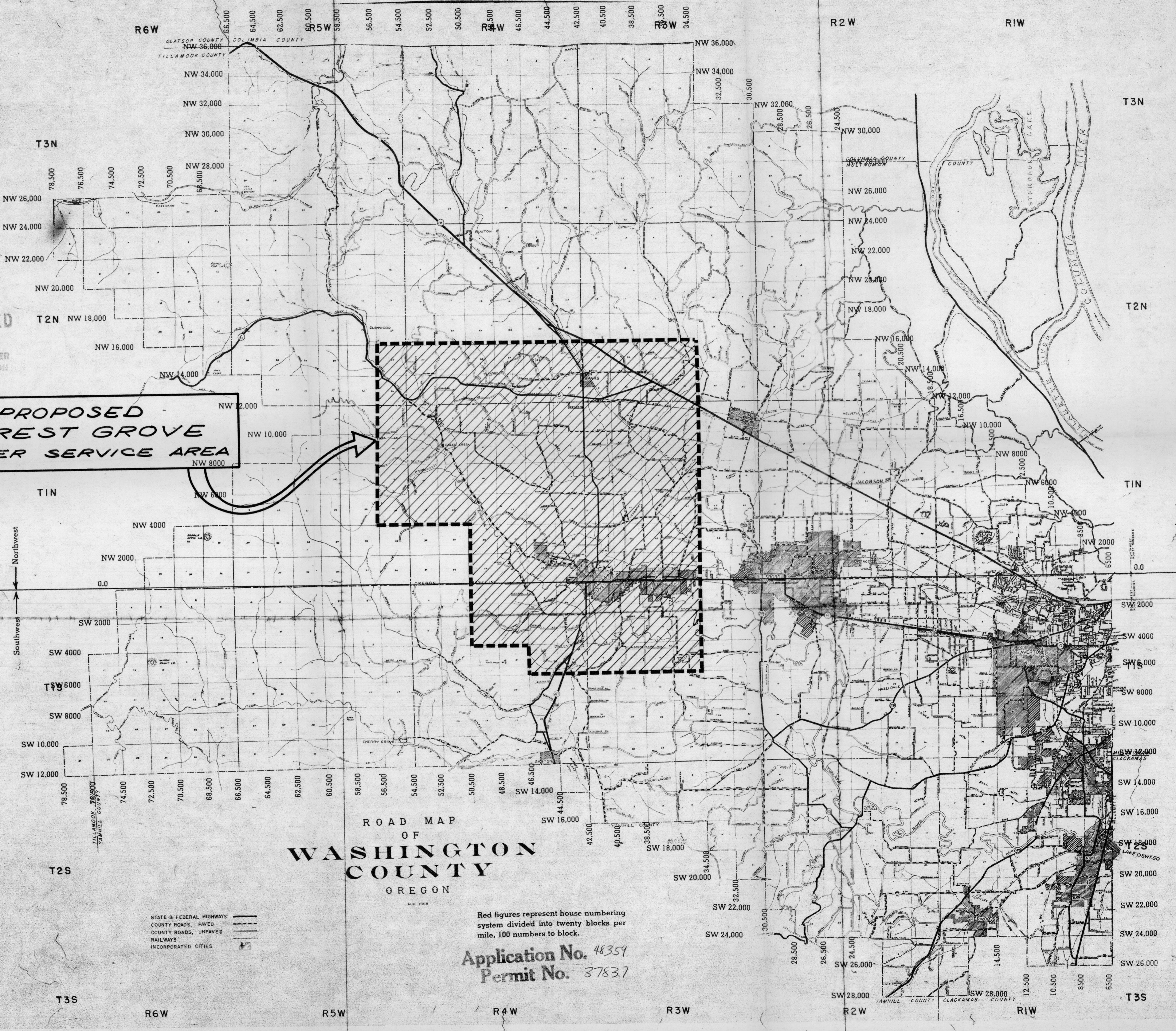

G:\01\0509\104\01-0509-104-OR-PLACE OF USE MAP.dwg BW May/9/2002 10:14:20

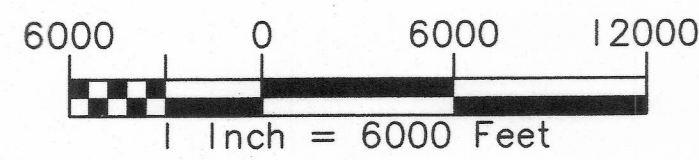
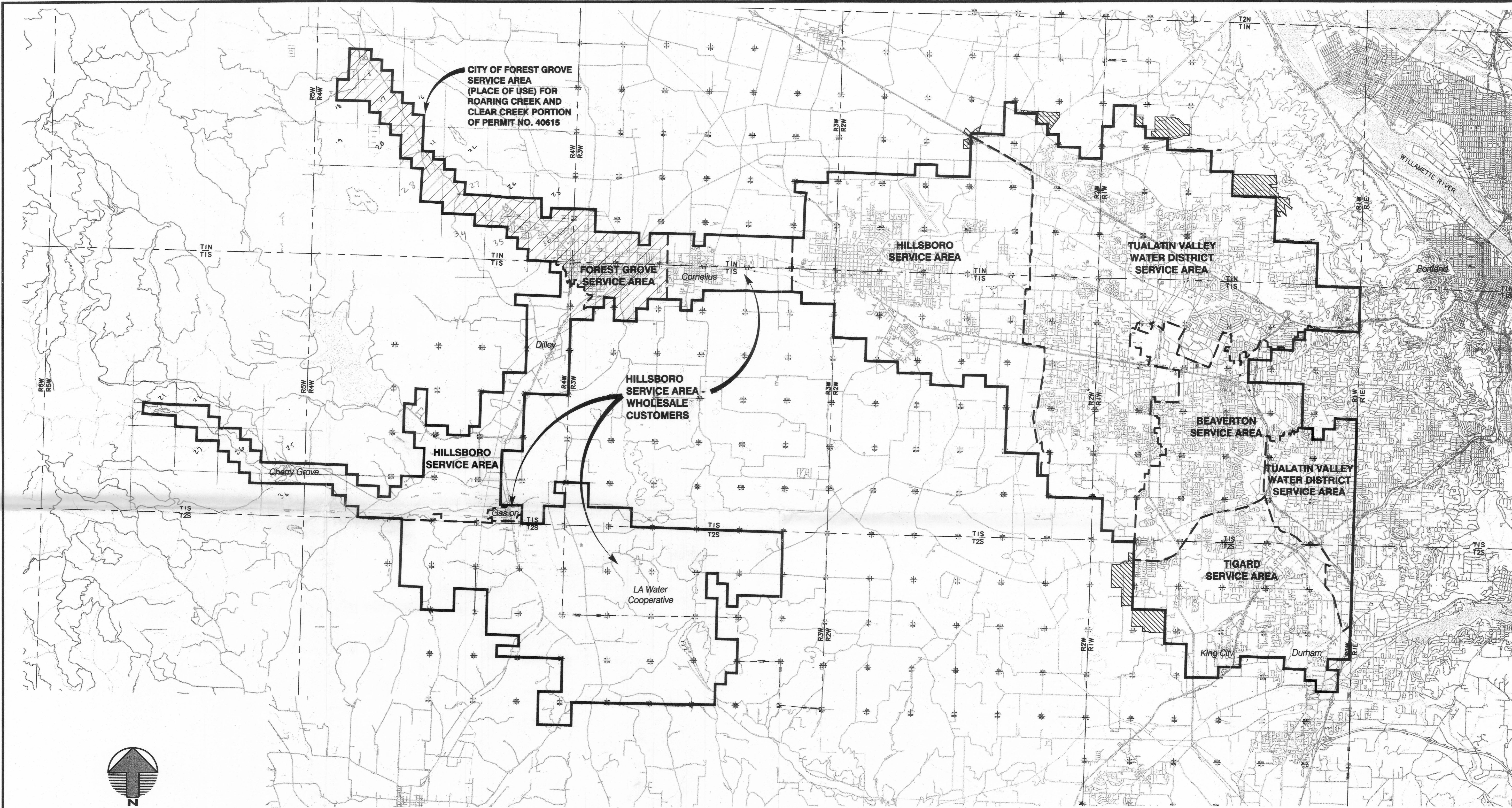

LEGEND	
CURRENT PLACE OF USE BOUNDARY	
METRO URBAN RESERVE AREA	
SERVICE AREA BOUNDARY	

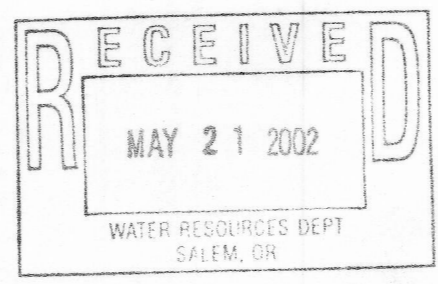

COBU Map #0100

PLACE OF USE FINAL PROOF FOR PERFECTION OF TUALATIN RIVER PERMITS FOR:

HILLSBORO	APPLICATION: 51643	PERMIT: 46423
BEAVERTON	APPLICATION: 60357	PERMIT: 45455
FOREST GROVE	APPLICATION: 54203	PERMIT: 40615

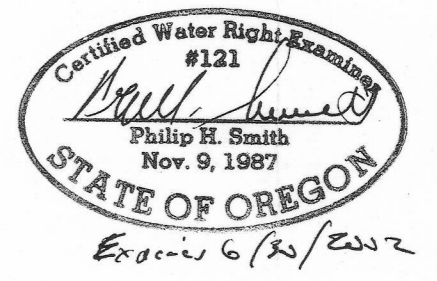

THIS MAP IS FOR THE PURPOSE OF IDENTIFYING THE LOCATION OF THE WATER RIGHT BOUNDARIES ONLY AND IS NOT INTENDED TO PROVIDE LEGAL DIMENSIONS OR LOCATIONS OF PROPERTY LINES.

JOINT WATER COMMISSION  
(Cities of Hillsboro, Forest Grove, Beaverton and the Tualatin Valley Water District)

PLACE OF USE MAP



RECEIVED  
JUN 26 1975  
STATE ENGINEER  
SALEM, OREGON

**PROPOSED  
FOREST GROVE  
WATER SERVICE AREA**

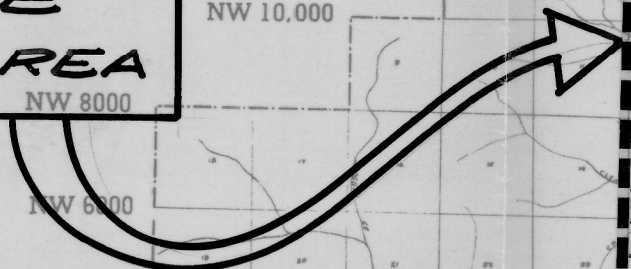

ROAD MAP  
OF  
**WASHINGTON  
COUNTY**  
OREGON  
AUG. 1968

STATE & FEDERAL HIGHWAYS  
COUNTY ROADS, PAVED  
COUNTY ROADS, UNPAVED  
RAILWAYS  
INCORPORATED CITIES

Red figures represent house numbering  
system divided into twenty blocks per  
mile, 100 numbers to block.

Application No. 48359  
Permit No. 37837

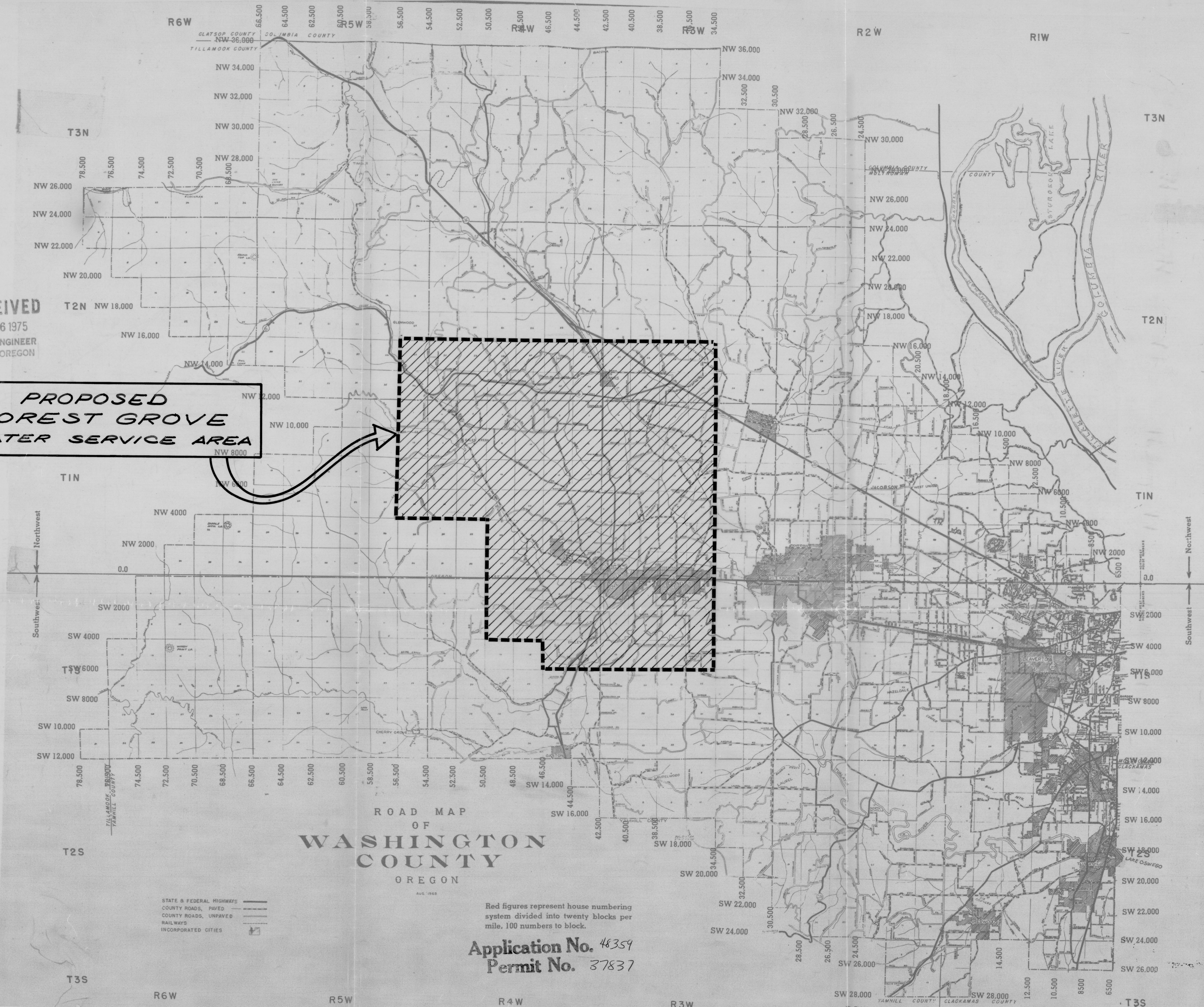



CITY OF FOREST GROVE  
 OREGON  
 OCTOBER 1969  
 OFFICE OF THE CITY ENGINEER  
 WATER DISTRIBUTION SYSTEM

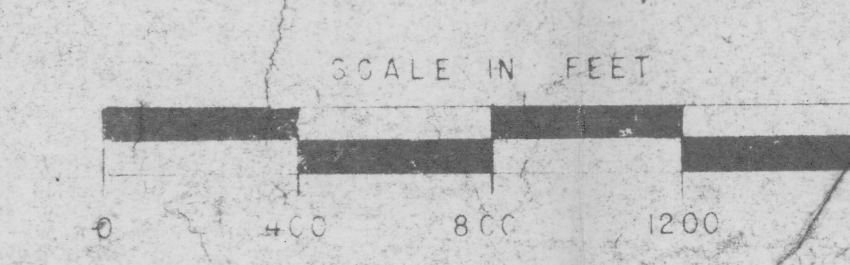

RECEIVED  
 JAN 13 1971  
 ST A ENGINEER  
 SALEM OREGON

Application No. 48359  
 Permit No. 37837