

T.5S., R.3W., W.M.
YAMHILL COUNTY

RECEIVED

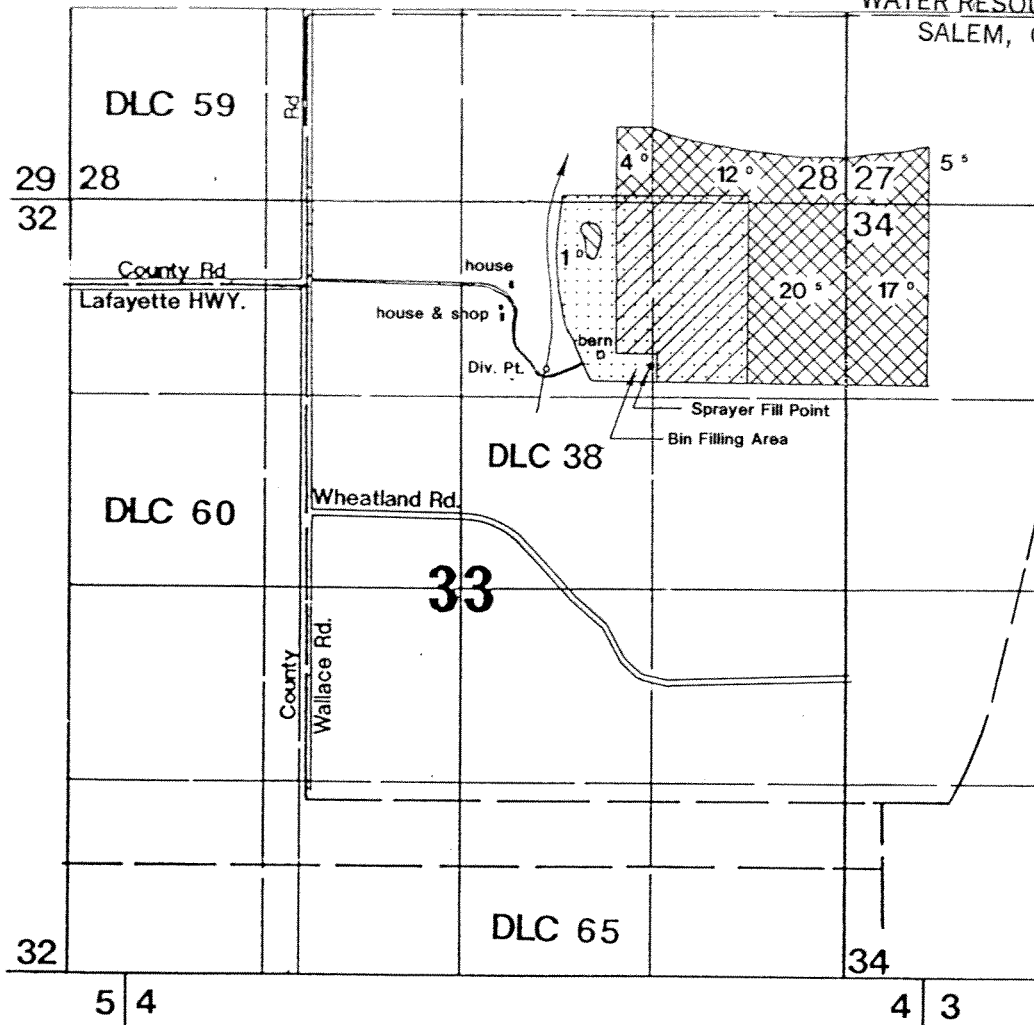



SEP 15 1992

WATER RESOURCES DEPT.
SALEM, OREGON



Div. Pt. of Pmt. No. 17090 described as "NW 1/4, NE 1/4, as projected in D. Matheny DLC 38, Sec. 33, T 5 S, R 3 W, WM"

Div. Pt. of Pmt No. 17090 to be consolidated w/ Div. Pt. shown for this Application being 560 ft. South & 1660 ft. East of the NE Corner of the Adam Matheny DLC No. 60.

-  IRRIGATION ONLY
-  IRRIGATION & SPRAY
-  SPRAY ONLY
-  IRRIGATION PERMIT NO. 17090

**APPLICATION TO
APPROPRIATE SURFACE WATER**

Application No. 71485 Permit No. 51600

**Roy E. Smith
Ethel M. Beaty**

SEPTEMBER 8, 1992
SCALE 1" = 1320'

NOTE: This map is for the purpose of identifying the location of water rights and has no intent to dimension or locate property ownership lines.

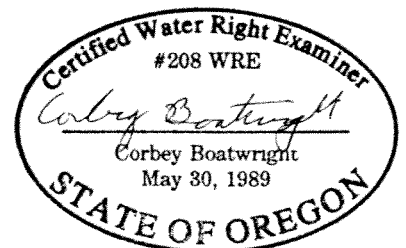

T.5S., R.3W., W.M.
YAMHILL COUNTY

RECEIVED

SEP 15 1992



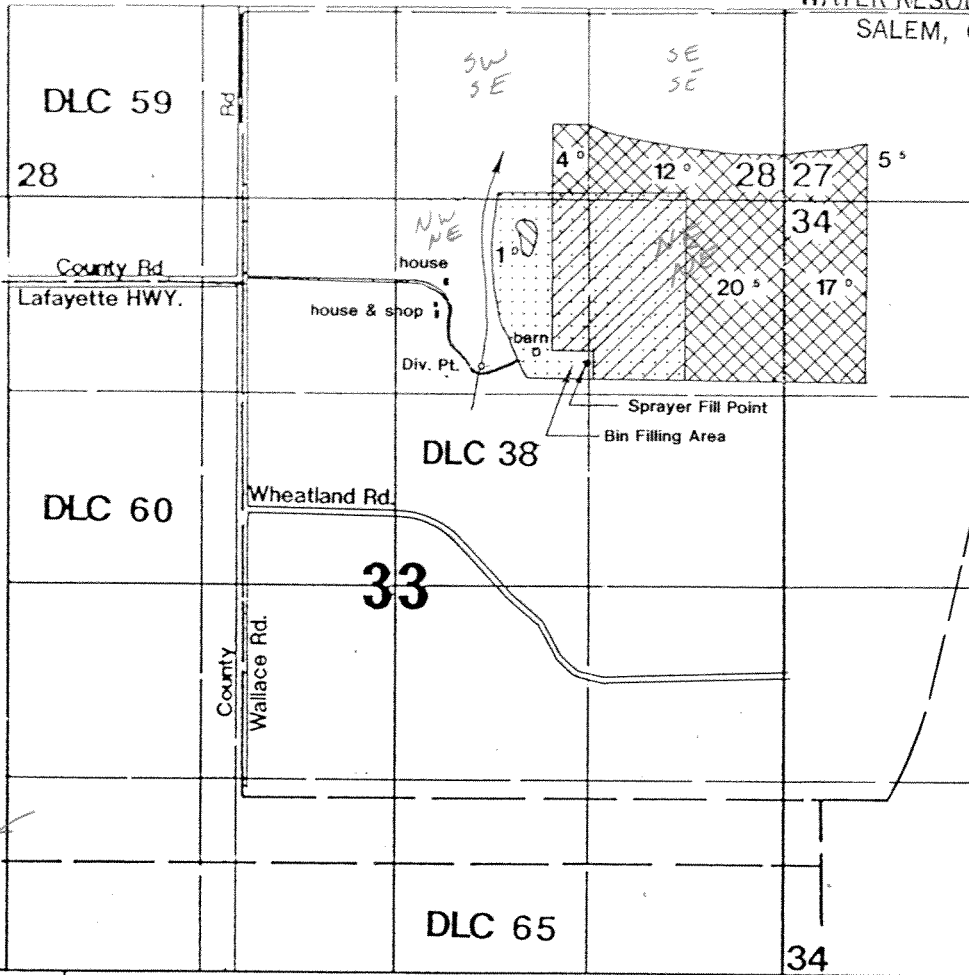

WATER RESOURCES DEPT.
SALEM, OREGON



33
NE NE 10° 21676 ✓
30 6256 ?
NW NE 10° 21676 ✓
02 6256 ?
28
SE SE ∅
SW SE 05 66366 ✓
60 65094 ✓
34
NW NW 53 29021 ✓
32
6° GR 119 ?
12 6256 ?
15 37044 ✓
16 62681 ✓
15 612437 ✓
16 73069 supp TR being hant

Div. Pt. of Pmt. No. 17090 described as "NW 1/4, NE 1/4, as projected in D. Matheny DLC 38, Sec. 33, T 5 S, R 3 W, WM"
Div. Pt. of Pmt No. 17090 to be consolidated w/ Div. Pt. shown for this Application being 560 ft. South & 1660 ft. East of the NE Corner of the Adam Matheny DLC No. 60.

needs transfer

-  IRRIGATION ONLY
-  IRRIGATION & SPRAY
-  SPRAY ONLY
-  IRRIGATION PERMIT NO. 17090

**APPLICATION TO
APPROPRIATE SURFACE WATER**

Application No. 71485 Permit No. _____

**Roy E. Smith
Ethel M. Beaty**

SEPTEMBER 8, 1992
SCALE 1" = 1320'

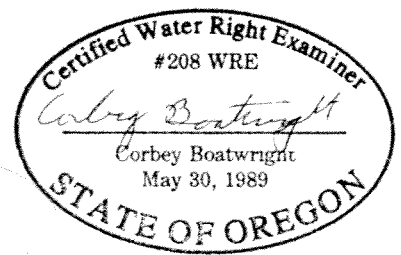

NOTE: This map is for the purpose of identifying the location of water rights and has no intent to dimension or locate property ownership lines.

27
SW SW 245 29021 ✓
22 GR 119 ?
02 40652 ✓

T.5S., R.3W., W.M.
YAMHILL COUNTY

RECEIVED

SEP 15 1992

WATER RESOURCES DEPT.
SALEM, OREGON

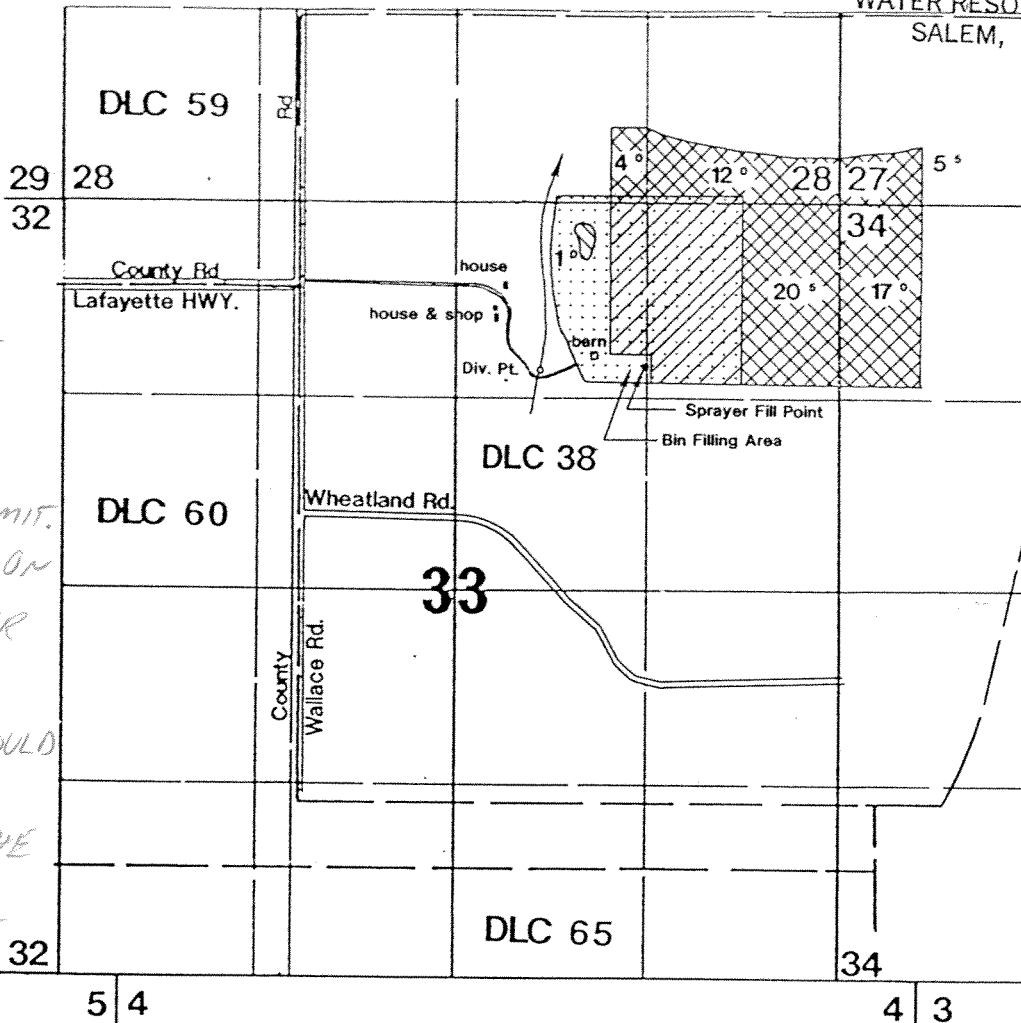



THE AG USE IS NOT LIMITED TO THE ACREAGES LISTED ON PERMIT. THE ACREAGES ON PERMIT REFER TO IRRIGATION. THE PERMIT SHOULD HAVE SAID "AG USE" IN THE 1/4 1/4 LISTING TO BE MORE CLEAR.

Div. Pt. of Pmt. No. 17090 described as "NW 1/4, NE 1/4, as projected in D. Matheny DLC 38, Sec. 33, T 5 S, R 3 W, WM"

Div. Pt. of Pmt No. 17090 to be consolidated w/ Div. Pt. shown for this Application being 560 ft. South & 1660 ft. East of the NE Corner of the Adam Matheny DLC No. 60.

RJK PER DISCUSSIONS w/ JAKE & LARRY MANN 4/15/99

-  IRRIGATION ONLY
-  IRRIGATION & SPRAY
-  SPRAY ONLY
-  IRRIGATION PERMIT NO. 17090

APPLICATION TO APPROPRIATE SURFACE WATER

Application No. 71485 Permit No. 51600

**Roy E. Smith
Ethel M. Beaty**

SEPTEMBER 8, 1992
SCALE 1" = 1320'

NOTE: This map is for the purpose of identifying the location of water rights and has no intent to dimension or locate property ownership lines.

