

# Walport Groundwater Application

Proposed Place of use:  
 37S-4W-31-SW/SE: 16 acres  
 37S-4W-31-SE/SE: 10.5 acres  
 38S-4W-6-NW/NE: 8.6 acres  
 38S-4W-6-NE/NE: 1 acre

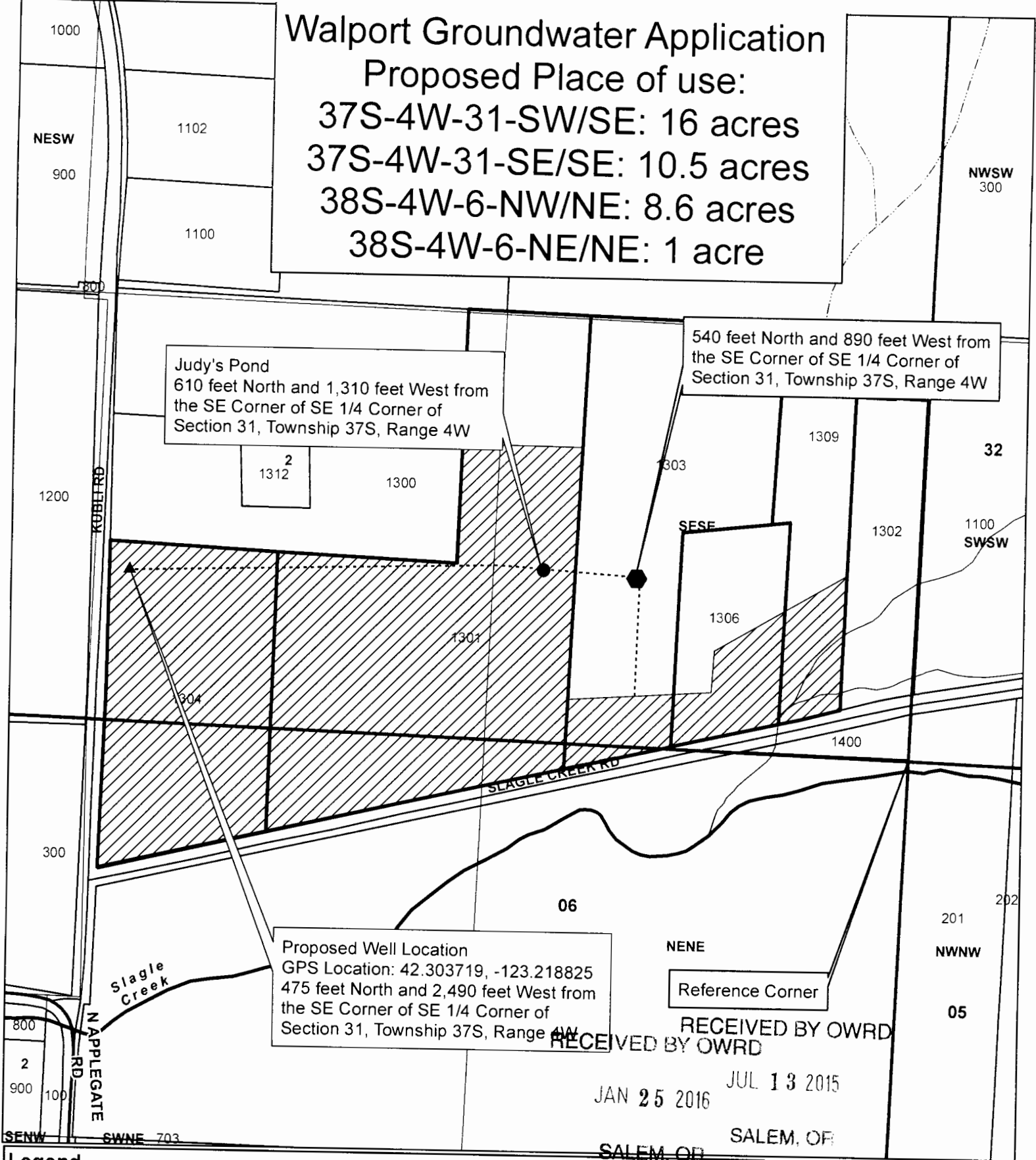

Proposed Well Location  
 GPS Location: 42.303719, -123.218825  
 475 feet North and 2,490 feet West from  
 the SE Corner of SE 1/4 Corner of  
 Section 31, Township 37S, Range 4W

540 feet North and 890 feet West from  
 the SE Corner of SE 1/4 Corner of  
 Section 31, Township 37S, Range 4W

Judy's Pond  
 610 feet North and 1,310 feet West from  
 the SE Corner of SE 1/4 Corner of  
 Section 31, Township 37S, Range 4W

Reference Corner

RECEIVED BY OWRD  
 RECEIVED BY OWRD

JAN 25 2016

JUL 13 2015

SALEM, OR

SALEM, OR

### Legend

- Pipeline
- Place of Use
- Amy's Pond
- Proposed Well Location
- Taxlots: 1301, 1303, 1304, 1306, 1309
- Townships
- Sections
- Quarter Quarter Section

1 inch = 400 feet

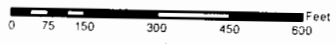

JACKSON COUNTY  
 WATERMASTER

Prepared by Travis Kelly

This map is based on a digital database compiled by Jackson County from a variety of sources. Jackson County cannot accept responsibility for errors, omissions, or positional accuracy. There are no warranties, expressed or implied.

6-10238