



Oregon Water Resources Department

RM-202
Registration No.
(Dept. Use Only)

Registration of Reclaimed Municipal Water Use

"Reclaimed water" means water that has been used for municipal purposes and after such use has been treated in a sewage treatment system and that, as a result of treatment, is suitable for a direct beneficial purpose or a controlled use that could not otherwise occur. (ORS 537.131 and 537.132)

MAR 26 2015

NOTE: Please type or print in dark ink. If your registration is found to be incomplete or inaccurate, we will return it to you. If any requested information does not apply to your registration, insert "n/a." SALEM, OR

AUG 18 2014

Registrant(s) King City Civic Association
(owner of the land where reclaimed water is to be used)

Mailing Address 15245 SW 116th Ave.
King City OR 97224 503-710-1210
City State Zip Daytime Telephone No.

- 1. Municipal Discharge Permit
NPDES Permit No. 101141 Effective Date _____ Expiration Date _____
WPCF Permit No. _____ Effective Date _____ Expiration Date _____
Date use of Reclaimed Water began, or is scheduled to begin 5/14/14
Annual Period of Use: from May 1st to Oct.31

- 2. Supplier of the Municipal Water which produces the Reclaimed Water
If more than one supplier is used, please provide a list in the Remarks section on page 4.
Name of Supplier Clean Water Services
Address 16580 SW 85th ave. Tigard, Or. 97224
Telephone No. 503-681-3600 Fax No. _____
Original Source of Municipal Supply City of Tigard

- 3. Supplier of Reclaimed Water
Name of Supplier Clean Water Services
Name of Facility Durham Advanced Wastewater Treatment Facility
Street Address of Facility 16580 SW 85th ave. Tigard, Or 97224
Name of Facility Owner Clean Water Services
Address of Facility Owner 2550 SW Hillspoor, Or 97123
Telephone No. of Supplier 503-681-3600 Telephone No. of Facility 503-547-8150
Fax No. 503-547-8151

- 4. User of Reclaimed Water _____

Name of Water User King City Golf Course

Address 15245 SW 116th Ave

Telephone No. 503-639-0486 Fax No. 503-639-8815

- 5. Agreement/Contract _____

Period of Agreement and Contract 5/1/14 to 10/31/19

Term of Agreement Contract can be renewed for additional 5 yrs

Special Limitations _____

- 6. Total Amount of Reclaimed Water _____

Enter the amount to be applied to beneficial use:

_____ cubic feet per second, OR 300 gallons per minute

If reclaimed water is to be used from more than one treatment facility, give the quantity from each.

- 7. Intended Use(s) of Reclaimed Water _____

Irrigation on Golf Course

(If for more than one use, give the quantity of reclaimed water from each treatment facility for each use.)

If for **IRRIGATION**, or other land application, state the **TOTAL** number of acres to receive reclaimed water under each use;

Irrigation 42.6 acres

Other (describe) _____

(Temperature Control, Mitigation, Wetland, etc.)

- 8. Description of Delivery System _____

Include dimensions and type of construction of diversion works, length and dimensions of supply ditches or pipelines, size and type of pump and motor. If for irrigation, describe the type of system (i.e., flood, wheel line, hand line, drip, other).

Rainbird golf irrigation system.

RECEIVED BY OWRD

MAR 26 2015

SALEM, OR

- 9. Existing Water Rights _____

Please provide a description of all the existing water rights appurtenant to the lands where the reclaimed water will be applied.

Application No. _____ Permit No. _____

Certificate No. 43690 Decree vol & pg _____

(Only one number needs to be provided. Attach a separate list if more than one water right is involved.)

- 10. Property Ownership

Do you own all the land where you propose to divert, transport and use water?

- Yes (Skip to section no. 11 "Historic Disposal Method")
- No (Please check the appropriate box below and, in the **Remarks** section, list the names and addresses of all affected landowners.**)
 - I have a recorded easement or written authorization permitting access.
 - I do not currently have written authorization or an easement permitting access.

**If more than 25 landowners are involved, a list is not required. Contact WRD for instructions.

- 11. Historic Disposal Method

Has the reclaimed water being registered in this process been discharged into a natural watercourse for 5 or more years? RECEIVED BY OWRD

- No (Skip to section no. 12 "Signature") MAR 26 2015
- Yes (Please answer the following questions)



a) Name of the receiving natural watercourse: SALEM, OR

b) Description of the location where the discharge historically entered the natural watercourse: _____

c) Does the amount of reclaimed water proposed for use under this registration represent 50% or more of the total average daily flow of the natural watercourse? Yes No

- 12. Signature

I/We certify that the information provided in this application is an accurate representation of the proposed reclaimed water use and is true and correct to the best of my knowledge:

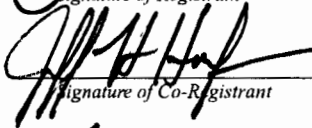
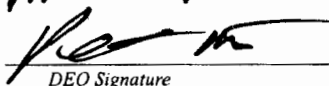
	5-15-2014		5/21/14
Signature of Registrant	Date	Supplier's Signature	Date
	GOLF COURSE	SUPER INTENDENT	5-15-14
Signature of Co-Registrant	Title		Date
	3/16/15		
DEQ Signature	Date		

NOTE: This registration must be accompanied by a map which shows the location of the treatment plant, approximate location of conveyance system (pipelines, canals, etc.) and place of use. The map must be drawn to scale with the scale stated on the map. The land area where the reclaimed water is to be applied shall be identified on the map. Topographic maps with the facilities and place of use shown will meet the map requirement.

King City

ATTACHMENT A1

Location and Site Characteristics Maps

RECEIVED BY OWR:

MAR 26 2015

SALEM, OR

ATTACHMENT A1

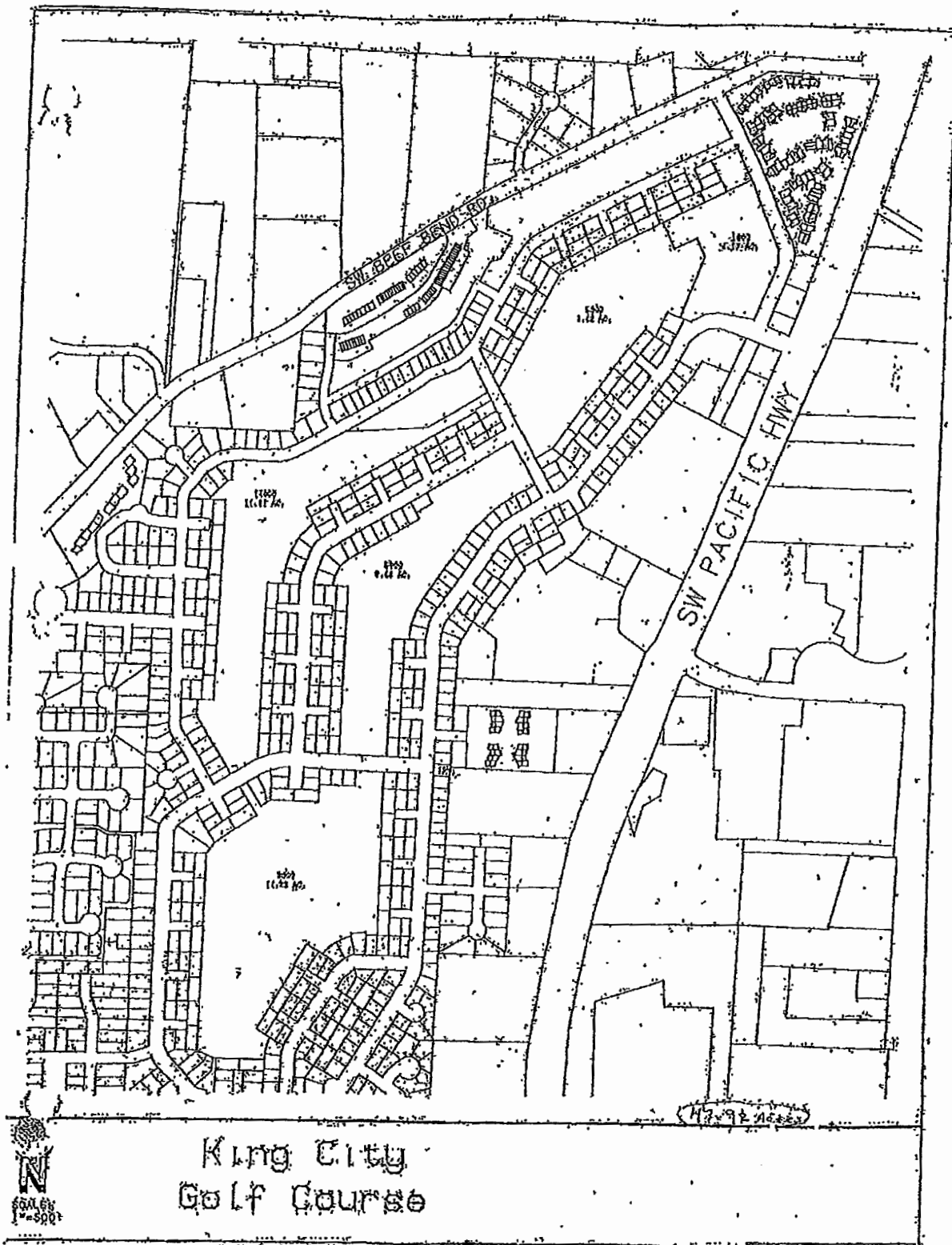

RECEIVED BY MAIL

MAR 26 2007

SALEM, OH

ATTACHMENT A1

(Housing Units)
60th Course
Salem - 1 year
(Yes - 1 year)

Make Access
300

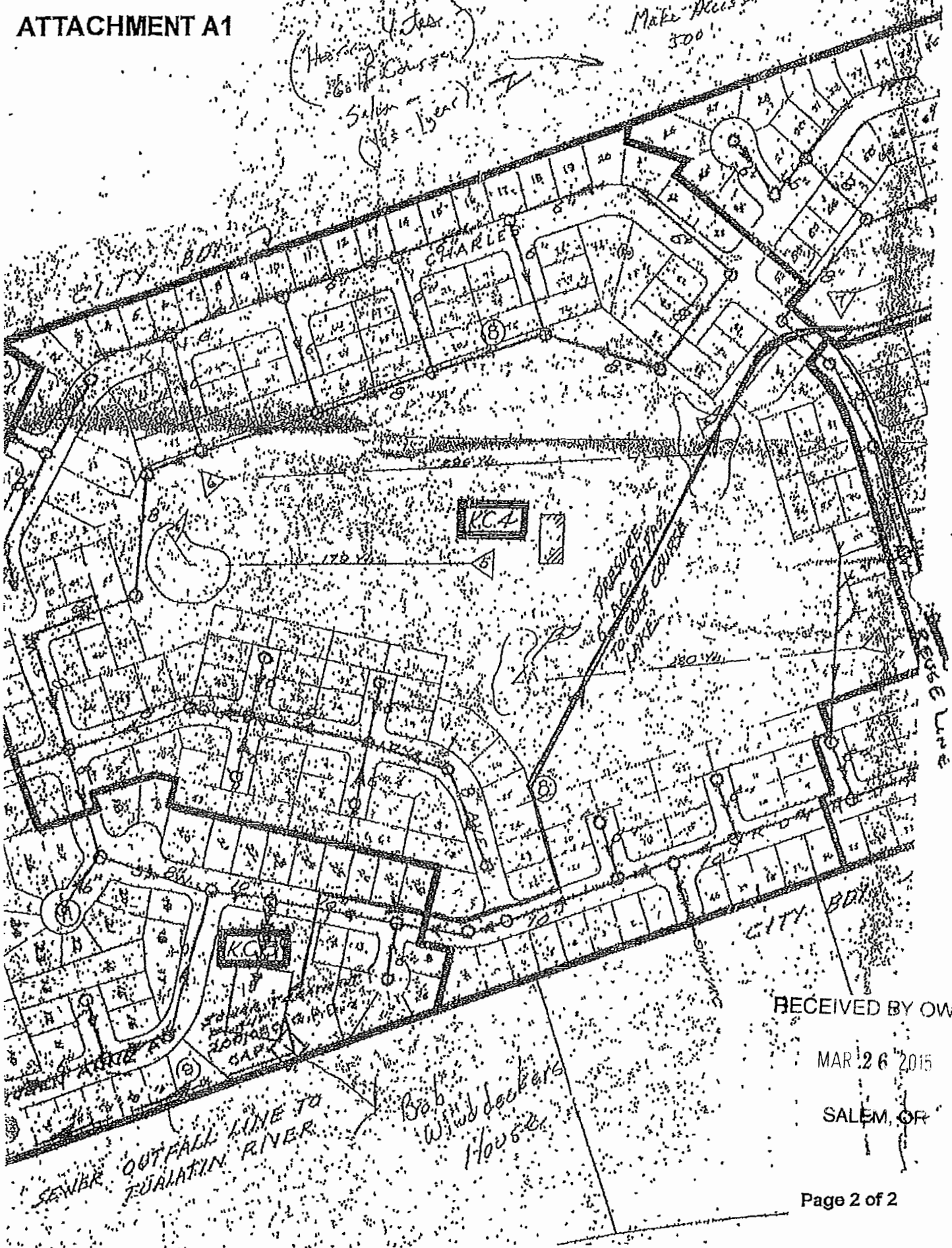

RECEIVED BY OWRD

MAR 26 2015

SALEM, OR

ATTACHMENT A2

Soils Interpretations and Fertilizer Guide

RECEIVED BY OWRD

MAR 26 2015

SALEM, OR

Steve Parrett

Water Resources Department

725 Summer St NE # A,

Salem, OR 97301

RECEIVED BY OWRD

MAR 26 2015

SALEM, OR

Steve,

Please find the three reclaimed municipal water use forms we talked about. Let me know if you have any questions,

Thank you,

A handwritten signature in black ink, appearing to read 'Pat Heins', with a long, sweeping horizontal stroke extending to the right.

Pat Heins

NWR DEQ

Reclaimed Water Registration Checklist

RM (assigned by Kerri) - 202 County Washington Registrant (User of Water) King City Civ: C Assoc.
Place of Use: Township 2S Range 1W Section 10 QQ's NE SW | SE SW
Amount 0.06 CFS Use IRR on Golf Course Acres (if for IR) 42.6 AC WM Dist. # 18
Supplier Clean Water Serv. DEQ Muni WW Permit # (Source) NPDES # 101141
Point of Diversion: Township 2S Range 1W Section 13 QQ NW NW
Contract Length in Years 5 yr.
Agent (if any) N/A

Property ownership: Does the Registrant own all the land for the proposed project? (Y) N
If No:

The affected landowner's name and mailing address must be listed

The **map** must meet the following minimum requirements.

- Township, Range, Section
- Streams and road identified if they cross through the map
- Place of use, 1/4-1/4's and tax lot clearly identified
- Even map scale not less than 4" = 1 mile (1" = 1320 ft.)
- Location of *each* diversion point (WW Treatment Plant)
- North Directional Symbol
- Number of acres per 1/4-1/4 if for irrigation, nursery, or agriculture
- Legend

N/A on New Form

**A map showing the wastewater treatment facility, transmission system, and place of use at a scale of 4" = >1 mile is fine only if a second map is provided showing the place of use at not less than 4" = 1 mile.*

Signature of *all* Registrants and Reclaimed Water Supplier

DEQ section (17) is completely filled out and signed.

Existing Water Rights None

***Do not send registration back to applicant if it is not complete, ALL registrations go to Kerri Cope.**

Reviewed by: KHC Date: 4/12/16

***Remember there is no fee for Reclaimed Water Registrations**

Google Maps King City Public Golf Course



Oregon Water Resources Department
Water Rights Mapping Tool

OWRD Only
Return

15355 SW Royalty Pkwy
Contact Us

Search

Identify Non-Water Right Features

Distance: 1 Feet

General	Rules	Hydrography
TRSQQ:	WM2.00S1.00W10NESW	
DLC:	-	
Latitude:	45.4084833891	
Longitude:	-122.7981460053	
Buffer (ft):	1	
Elevation (ft):	211	
Basin Name:	Willamette	
County:	Washington	
WM District:	18	
WM Region:	NORTHWEST	
ODFW Region, District:	Northwest Region, NWW-D-Coast Range Unit	
Irrigation District AOI:	-	
Irrigation District, Other:	-	
Dams (Permit):	-	
Water Rights:	Platcard for WM2.00S1.00W10	
Well Logs:	Logs for WM2.00S1.00W10	

Tax Lots

Tools

Layers

Bookmarks

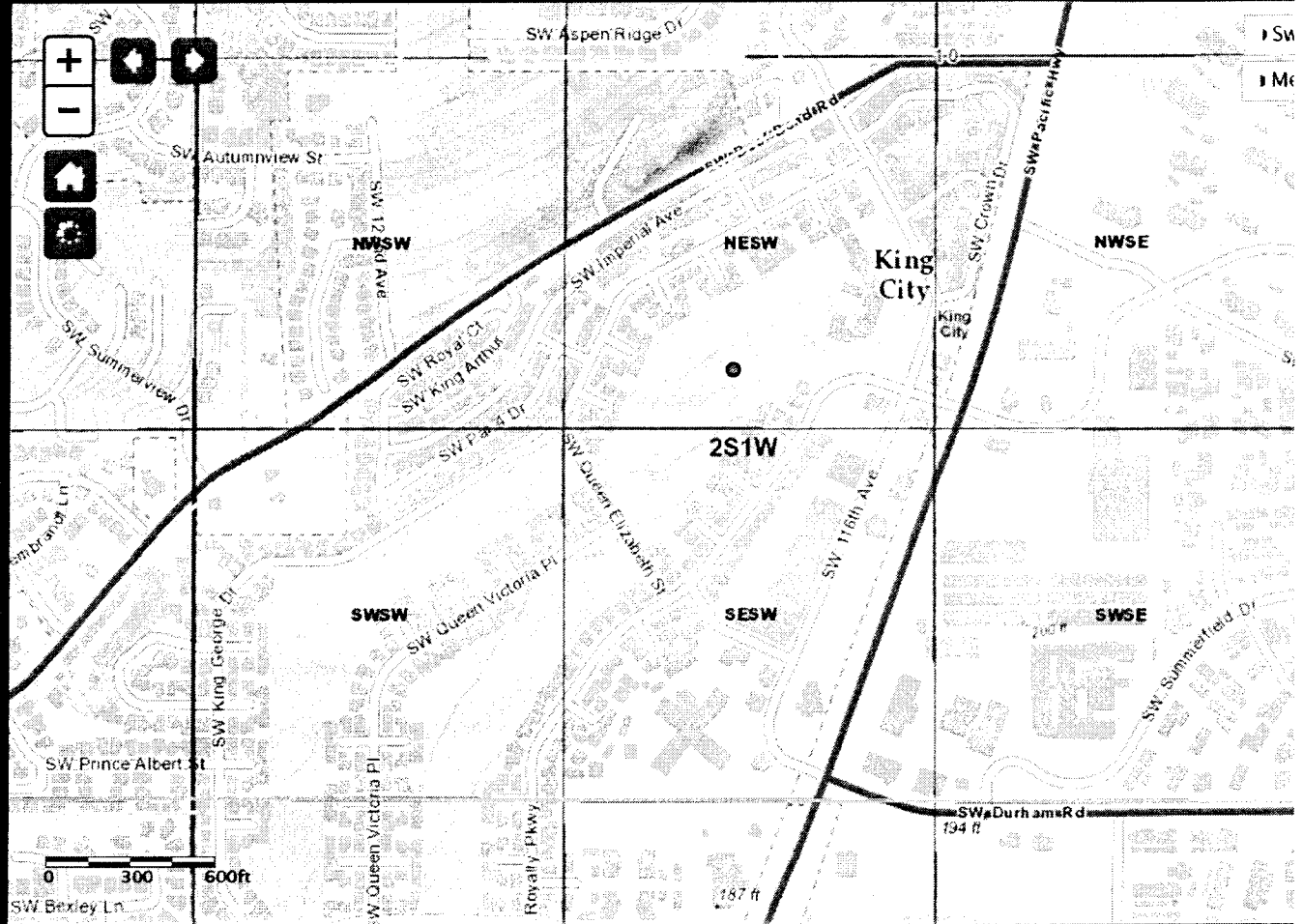

POD POU Irrigation Districts AOI WR By Time

All Fields Search...

#	ID (select)	WRIS	Zoom	Water Right	Water Type	First Name	Last Name	Company	Use Desc.	Priority Date	Supp.	Duty

Search took 0 sec