

APR 14 2016

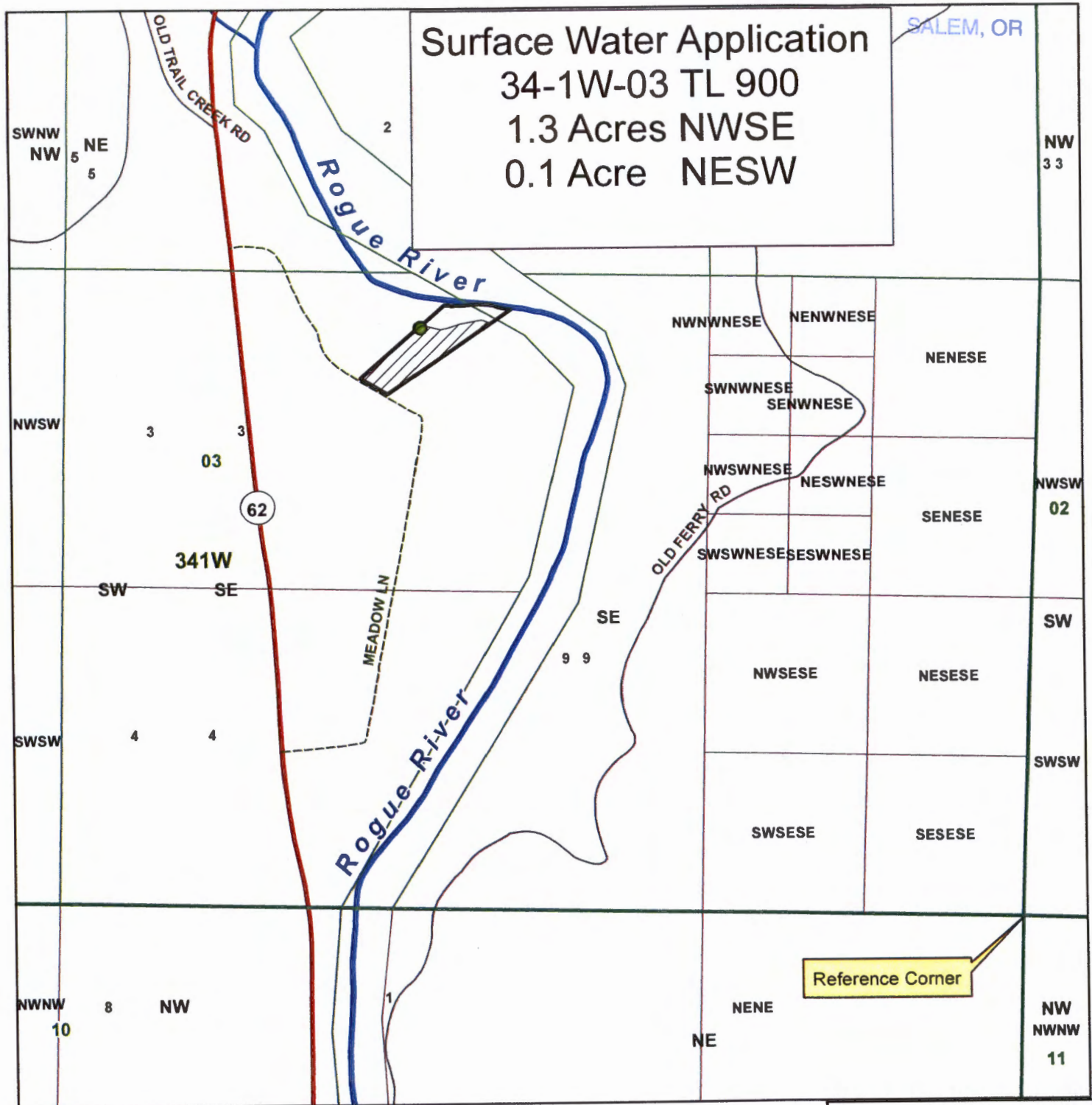

Legend

- TL 900
- Point of Diversion
- Place of Use
- Townships
- Sections
- Quarter Sections
- Quarter Quarter Sections

Point of Diversion is
2554 ft West and 2463 ft North
of SE Corner of Section 3

1 inch = 553 feet

0 110 220 440 660 880 Feet

RECEIVED BY OWRD

MAY 02 2016

SALEM, OR

JACKSON COUNTY
WATERMASTER

Prepared by Shavon Haynes

This map is based on a digital database compiled by Jackson County from a variety of sources. Jackson County cannot accept responsibility for errors, omissions, or positional accuracy. There are no warranties, expressed or implied.

Date: 04/07/2016; 34-1W-03 tl 900.mxd; haynes

S-00m