



Oregon Water Resources Department
 725 Summer Street NE, Suite A
 Salem Oregon 97301-1266
 (503) 986-0900
 www.wrd.state.or.us

Certificate of Water Right Ownership Update

NOTICE TO SELLERS & BUYERS:

By law, all water belongs to the public (ORS 537.110). In almost every instance, a permit or water right certificate from the Water Resources Department is needed before using, diverting or storing water (ORS 537.130). However, most domestic wells do not require water rights. A certificate of water right stays with the land. In order to keep track of water right ownership, the Department requests that this form be submitted to the Department. **If for multiple rights, a separate form for each right will be required.**

Water that has been used for a long time in one place or that involves a water structure (like a dam) that already exists is no guarantee that there is a water right which would allow the water use to continue.

If you have any questions about this form or water right requirements, please contact your local watermaster or call the Water Resources Department at 503-986-0900.

Note: Please type or print legibly when filling in the following information. Use additional paper if necessary.

PROPERTY SELLER INFORMATION

Applicant(s): Steven Clausen; Kimberly Stolz & David Clausen
heirs First of max Arthur Clausen. * max Clausen address Last
 Mailing Address: personal rep: Lilli K. Clausen
93488 Promise Lane, Coos Bay, OR 97420
City State Zip
 Phone: 541-267-3704 (Lilli) 541-261-5496 cell 541-297-6233
Home Work Steve-cell Other Lilli

PROPERTY BUYER INFORMATION

RECEIVED BY OWRD

Applicant(s): Randolph Growers LLC
Rebecca First Ruddell Last
 Mailing Address: 8620 Booth Rd
Klamath Falls OR 97603 SALEM, OR
City State Zip
 Phone: 541-882-1582 SAME SAME
Home Work Other

PROPERTY DESCRIPTION (attach additional pages if necessary):

County: COOS Township: 28S Range: 14 W Section: (4)

Tax Lot Number(s): TL 400

Street address of water right property: φ situs address

Water Right Information (attach copy of water right permit or certificate & final proof map):

Primary Application #: G11468 Permit #: G10591 Certificate or Page #: 65884
 Supplemental: 56569 Permit 44930
 Will all the lands associated with this water right be owned by the buyer? Yes No

Name of individual completing this form: Rebecca S. Ruddell Phone: 541-882-1582

Signature: Rebecca S. Ruddell Date: _____

Please be sure to attach a copy of your property deed or legal description of the property.

EXHIBIT "A"

Beginning at the Northeast corner of the SE 1/4 of the NE 1/4 of Section 4, Township 28 South, Range 14 West of the Willamette Meridian, Coos County, Oregon; thence West along the 1/16th line 358 feet; thence South 22° West 810 feet; thence South 76° East 100 feet; thence South 10° West 195 feet; thence South 76° East to the boundary of the property heretofore conveyed to Delbert Ruddell being Tax Lot 1-1 in said Section 4; thence Northeasterly (Northwesterly by deed) along the Westerly boundary of said Ruddell property to the Section line between Sections 3 and 4 in Township 28 South, Range 14 West of the Willamette Meridian, Coos County, Oregon; thence North along said Section line to the place of beginning.

TOGETHER WITH an easement for ingress and egress, including the terms and provisions thereof, as disclosed in document recorded August 31, 1984 bearing Microfilm Reel No. 84-04-2182, Records of Coos County, Oregon.

RECEIVED BY OWRD

OCT 22 2015

SALEM, OR

STATE OF OREGON
COUNTY OF COOS
CERTIFICATE OF WATER RIGHT

THIS CERTIFICATE ISSUED TO

MAX CLAUSEN
4215 HIGHWAY 101 SOUTH
COOS BAY, OREGON 97420

confirms the right to use the waters of a SUMP in the COQUILLE RIVER BASIN for the purpose of IRRIGATING, TEMPERATURE CONTROL, AND FLOOD HARVESTING OF 8.0 ACRES OF CRANBERRIES.

The right has been perfected under Permit G-10591. The date of priority is DECEMBER 26, 1985. The right is limited to not more than 1.0 CUBIC FOOT PER SECOND; BEING 0.2 CFS FOR IRRIGATION, 1.0 CFS FOR TEMPERATURE CONTROL AND 0.4 CFS FOR FLOOD HARVESTING OF CRANBERRIES, or its equivalent in case of rotation, measured at the sump.

The sump is located as follows:

SE 1/4 NE 1/4, SECTION 4, T 28 S, R 14 W, W.M.; 360 FEET NORTH AND 575 FEET WEST FROM THE E 1/4 CORNER OF SECTION 4.

The amount of water used for irrigation of cranberries, together with the amount secured under any other right existing for the same lands, shall be limited to ONE-FORTIETH of one cubic foot per second per acre, or its equivalent for each acre irrigated and shall be further limited to a diversion of not to exceed 3.0 acre-feet per acre for each acre irrigated during the irrigation season of each year. For the irrigation of any other crop this right is limited to one-eightieth of one cubic foot per second per acre, or its equivalent for each acre irrigated and shall be further limited to a diversion of not to exceed 2.5 acre-feet per acre for each acre irrigated during the irrigation season of each year.

The right shall conform to such reasonable rotation system as may be ordered by the proper state officer.

A description of the place of use under the right, and to which such right is appurtenant, is as follows:

SE 1/4 NE 1/4 8.0 ACRES
SECTION 4
TOWNSHIP 28 SOUTH, RANGE 14 WEST, W.M.

The right to the use of the water for the above purpose is restricted to beneficial use on the lands or place of use described.

WITNESS the signature of the Water Resources Director, affixed
MAY 31, 1991.

/s/ WILLIAM H. YOUNG

William H. Young

Recorded in State Record of Water Right Certificates numbered 65884
G-11468.MS

RECEIVED BY OWRD

OCT 22 2015

SALEM, OR

T. 28 S., R. 14 W., W.M.

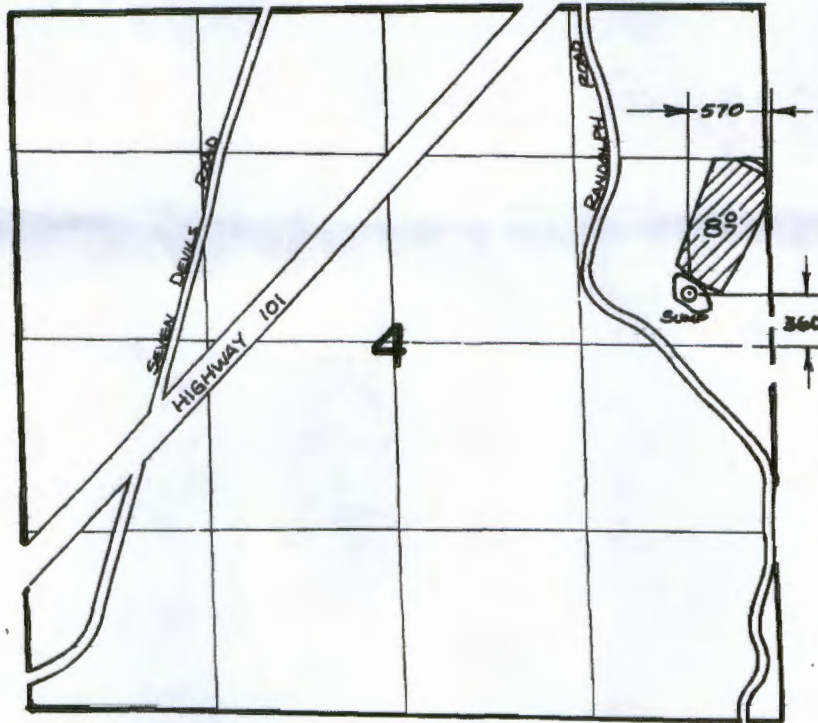

RECEIVED BY OWRD
 OCT 22 2015
 SALEM, OR

SCALE : 4" = 1 MILE

FINAL PROOF SURVEY UNDER

Application No. G.11468 Permit No. G.10591
 IN NAME OF

MAX CLAUSEN

Surveyed 8/23 1988, by M. SCHMORDE

Application No. 56569

Permit No. 44930

STATE OF OREGON WATER RESOURCES DEPARTMENT

Application for Permit to Appropriate Surface Water

RECEIVED
 FEB 21 1978
 WATER RESOURCES DEPT.
 OREGON

I, Chrome Reservoir Water Dist. (Harold Russell, agent)
(Name of Applicant)

of Rt. 2, Box 2160
(Mailing Address)

Bandon
(City)

State of Oregon

97411
(Zip Code)

Phone No. 347-3629

do hereby

make application for a permit to appropriate the following described waters of the State of Oregon:

1. The source of the proposed appropriation is Cut Creek & Chrome Pond

a tributary of Pacific Ocean

2. The point of diversion is to be located 2110 ft. N and 2850 ft. W
(N. or S.) (E. or W.)

from the SE corner of Sec. 32, T 27 S R 14 W
(Public Land Survey Corner)

(If there is more than one point of diversion, each must be described)

being within the NE $\frac{1}{4}$ of the SW $\frac{1}{4}$ of

Sec. 32 Tp. 27 S R. 14 W, W.M., in the county of Coos
(N. or S.) (E. or W.)

3. Location of area to be irrigated, or place of use if other than irrigation.

Township	Range	Section	List $\frac{1}{4}$ of Section	List use and/or number of acres to be irrigated
T 27 S	R 14 W	33	SE $\frac{1}{4}$ of SE $\frac{1}{4}$	15.6 Ac
T 28 S	R 14 W	3	NW $\frac{1}{4}$ of NW $\frac{1}{4}$	6.1 Ac
T 28 S	R 14 W	3	SW $\frac{1}{4}$ of NW $\frac{1}{4}$	12.0 Ac
T 28 S	R 14 W	4	NE $\frac{1}{4}$ of NE $\frac{1}{4}$	13.6 Ac
T 28 S	R 14 W	4	SE $\frac{1}{4}$ of NE $\frac{1}{4}$	19.7 Ac
T 28 S	R 14 W	4	SW $\frac{1}{4}$ of NE $\frac{1}{4}$	5.2 Ac
T 28 S	R 14 W	4	NE $\frac{1}{4}$ of SE $\frac{1}{4}$	3.5 Ac
T 28 S	R 14 W	4	NW $\frac{1}{4}$ of SE $\frac{1}{4}$	2.2 Ac
T 28 S	R 14 W	4	SW $\frac{1}{4}$ of SW $\frac{1}{4}$	7.5 Ac
T 28 S	R 14 W	3	NE $\frac{1}{4}$ of SW $\frac{1}{4}$	2.6 Ac.
T 28 S	R 14 W	9	NW $\frac{1}{4}$ of NW $\frac{1}{4}$	1.5 Ac
T 28 S	R 14 W	5	SE $\frac{1}{4}$ of SE $\frac{1}{4}$	0.5 Ac
T 28 S	R 14 W	8	NE $\frac{1}{4}$ of NE $\frac{1}{4}$	7.85 Ac
T 28 S	R 14 W	8	SE $\frac{1}{4}$ of NE $\frac{1}{4}$	4.0 Ac
Supp. Flood Harvest, Supp. Temp. Control, & Supp. Irrigation for-----				101.85 Acres

RECEIVED BY OWRD

OCT 22 2015

SALEM, OR

1.00 Supp Flood Harves
1.25 Supp Irr, Temp
Control
(each)

4. The amount of water which the applicant intends to apply to beneficial use is
cubic feet per second..... from Chrome Pond
(If water is to be used from more than one source, give quantity from each)

5. The use to which the water is to be applied is Supplemental Irrigation, Supp. Flood
Harvest, & Supp. Temperature Control.

6. DESCRIPTION OF WORKS

Include dimensions and type of construction of diversion dam and headgate, length and dimensions of supply ditch or pipeline, size and type of pump and motor, type of irrigation system to adequately describe the proposed distribution system.

Cut Creek runs through existing Chrome Pond, which contains about
10 acre feet of water. Pumping station is located at Chrome Pond.

Apply for water right for 3 c.f.s. of the 5 c.f.s. running through
the pond.

12,000 L.F. of PVC plastic pipe (8")

6,300 L.F. of PVC plastic pipe (4")

75 H.P. electric pump delivers 900 G.P.M.

Supplemental irrigation water delivered to existing sums of each
individual, and from there to their bogs, which all have existing
solid set systems.

RECEIVED BY OWRD

OCT 22 2015

SALEM, OR

If for domestic use state number of families to be supplied..... N/A

7. Construction work will begin on or before..... 8-1-77

8. Construction work will be completed on or before..... 9-1-77

9. The water will be completely applied to the proposed use on or before..... 9-1-77

Application No. 56569

Permit No. 44930

Remarks: Chrome Pond is the result of the removal of a large amount of chrome bearing sand. This sand was removed in the 1940's by the U.S. Gov't. It wasn't created to store water. It has no embankments, etc. It is a large depression created by the removal of sand, and so holds water from Cut Creek. We are not 'storing' water, but using water that has been 'trapped' by the depression.

David Russell
Signature of Applicant

This is to certify that I have examined the foregoing application, together with the accompanying maps and data, and return the same for.....

In order to retain its priority, this application must be returned to the Water Resources Director with corrections on or before, 19.....

RECEIVED BY OWRD

WITNESS my hand this day of, 19.....

OCT 22 2015

Water Resources Director

SALEM, OR

By

THIS APPLICATION PREPARED BY THE APPLICANT FROM INFORMATION FURNISHED BY

THIS APPLICATION PREPARED BY: *John Dault, N. Bend Field Office*
FROM INFORMATION FURNISHED BY THE APPLICANT.

THIS APPLICATION PREPARED BY

^{DRS} 8th day of ~~February~~ ^{SEP} September, 19 ⁰⁸ 77, at ⁰⁸ 11:00 o'clock A.M.

Application No. 56569

Permit No. 44930

Application No. 56569

Permit No. 44930

Permit to appropriate the Public Waters of the State of Oregon

This is to certify that I have examined the foregoing application and do hereby grant the same SUBJECT TO EXISTING RIGHTS INCLUDING THE EXISTING FLOW POLICIES ESTABLISHED BY THE WATER POLICY REVIEW BOARD and the following limitations and conditions:

The right herein granted is limited to the amount of water which can be applied to beneficial use and shall not exceed 3.50 cubic feet per second measured at the point of diversion from the stream, or its equivalent in case of rotation with other water users, from Cut Creek and Chrome Pond to be constructed under application No. R-57815, permit No. R-8147

The use to which this water is to be applied is supplemental irrigation, harvesting of cranberries and temperature control being 1.0 cfs for harvesting, 1.25 cfs for supplemental irrigation and 1.25 cfs for temperature control

If for irrigation, this appropriation shall be limited to 1/40th of one cubic foot per second or its equivalent for each acre irrigated and shall be further limited to a diversion of not to exceed 3.0 acre feet per acre for each acre irrigated during the irrigation season of each year. The permittee shall record and submit annually to the Water Resources Department all pertinent data pertaining to use of water for temperature control on forms furnished.

RECEIVED BY OWRD

OCT 22 2015

SALEM, OR

and shall be subject to such reasonable rotation system as may be ordered by the proper state officer.

The priority date of this permit is September 8, 1977 for 3.0 cfs and February 21, 1978 for 0.5 cfs

Actual construction work shall begin on or before July 14, 1981 and shall thereafter be prosecuted with reasonable diligence and be completed on or before October 1, 1982

Complete application of the water to the proposed use shall be made on or before October 1, 1983

WITNESS my hand this 14th day of July, 1980

James E. Seaman
Water Resources Director

T. 27 S. R. 14 W. WM

33

34

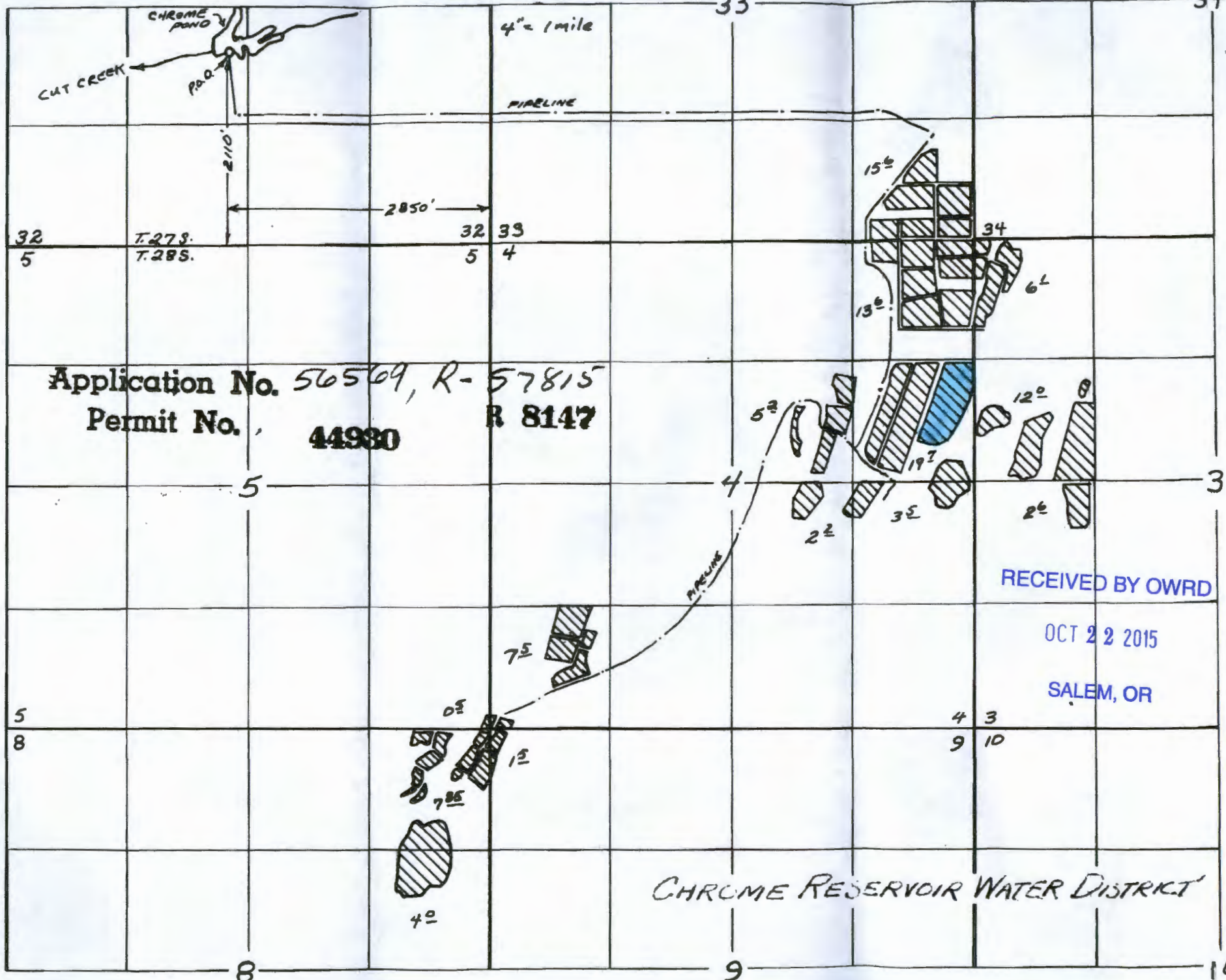

Application No. 56569, R-57815
 Permit No. 44980 R 8147

RECEIVED BY OWRD

OCT 22 2015

SALEM, OR

CHROME RESERVOIR WATER DISTRICT

Scale 1"=1320' T274285 R14W

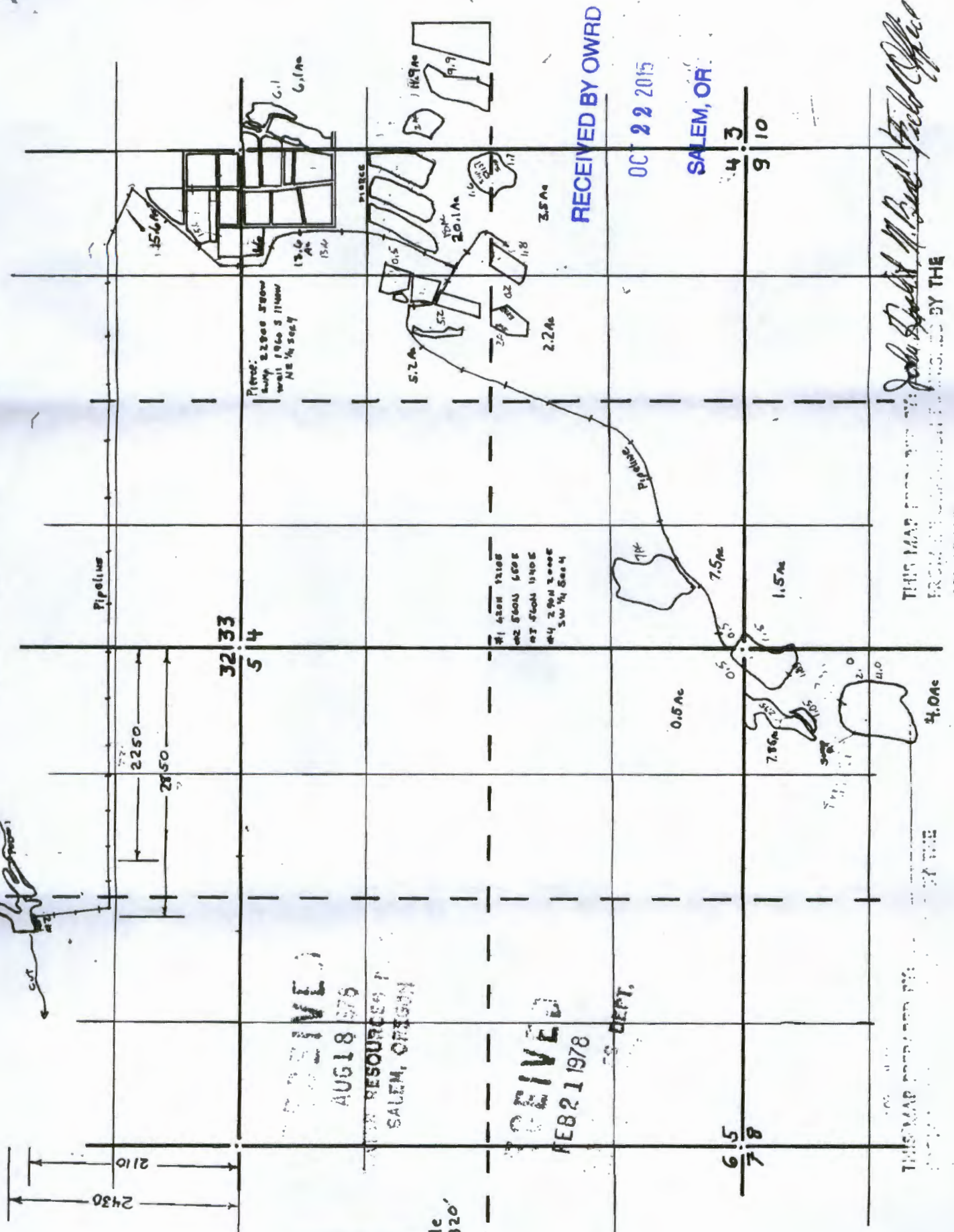

Superseded

Scale 1"=1320'

RECEIVED
AUG 18 1976
LAND RESOURCES
SALEM, OREGON

RECEIVED
FEB 21 1978
DEPT.

RECEIVED BY OWRD

OCT 22 2015

SALEM, OR

6 5
7 8

4 3
9 10

THIS MAP PREPARED BY THE
BUREAU OF LAND MANAGEMENT BY THE
AFFIDAVIT.

THIS MAP PREPARED BY THE
BUREAU OF LAND MANAGEMENT BY THE
AFFIDAVIT.

John Robert M. Bush, Field Office