



Oregon Water Resources Department
 725 Summer Street NE, Suite A
 Salem Oregon 97301-1266
 (503) 986-0900
 www.wrd.state.or.us

Certificate of Water Right Ownership Update

NOTICE TO SELLERS & BUYERS:

By law, all water belongs to the public (ORS 537.110). In almost every instance, a permit or water right certificate from the Water Resources Department is needed before using, diverting or storing water (ORS 537.130). However, most domestic wells do not require water rights. A certificate of water right stays with the land. In order to keep track of water right ownership, the Department requests that this form be submitted to the Department. **If for multiple rights, a separate form for each right will be required.**

Water that has been used for a long time in one place or that involves a water structure (like a dam) that already exists is no guarantee that there is a water right which would allow the water use to continue.

If you have any questions about this form or water right requirements, please contact your local watermaster or call the Water Resources Department at 503-986-0900.

Note: Please type or print legibly when filling in the following information. Use additional paper if necessary.

PROPERTY SELLER INFORMATION

Applicant(s): ETzel Family Trust
First Last
 Mailing Address: 14271 Fern Ridge Rd. S.E.
Stayton Oregon 97383
City State Zip
 Phone: _____
Home Work Other

RECEIVED

DEC 02 2015

PROPERTY BUYER INFORMATION

Applicant(s): Doerfler F.L.P. By: Dail Doufley
First Last
 Mailing Address: 13510 Doerfler Rd. S.E.
Silverton Oregon 97381
City State Zip
 Phone: 503-362-3111 503-362-6108
Home Work Other

PROPERTY DESCRIPTION (attach additional pages if necessary):

County: Marion Township: 95 Range: 1W Section: 2 WM
 Tax Lot Number(s): TK-1100 TK-501 TK-500

Street address of water right property: 14271 Fern Ridge Rd. S.E.

Water Right Information (attach copy of water right permit or certificate & final proof map):

Application #: G 2321 Permit #: G 2147 Certificate or Page #: Vol-27
Page 35369
 Will all the lands associated with this water right be owned by the buyer? Yes No

Name of individual completing this form: David Doerfler Phone: 503-362-3111
 Signature: Dail Doufley Date: 11-20-15

Please be sure to attach a copy of your property deed or legal description of the property.

Schedule 1

Page 1 of 3

LEGAL DESCRIPTION OF SUBLESSOR'S PROPERTY

Street address: 14271 FERN RIDGE ROAD
City: STAYTON
State: Oregon
Zip: 97383

All that real property located in the State of Oregon, County of MARION, described as follows:

The Sublessor's property of which the Subleased Property is a part is legally described as follows:

ON THE FOLLOWING PAGE:

SITE ID: See Section 3 of Memorandum of Sublease

GROUND LESSOR'S PROPERTY: See "Property Legal Description"

DESCRIPTION OF SUBLESSOR'S PROPERTY: See "Premises Description" if available

Project Vertical Number: 482

RECEIVED

DEC 02 2015

WATER RESOURCES DEPT
SALEM, OREGON

AUG 25 2000

EXHIBIT "A"

Exhibit "A" attached to and made a part of the Memorandum of Lease entered into by and between ALBIN G. ETZEL & MARCELLA T. ETZEL FAMILY TRUST, as Landlord, and GTE MOBILNET OF OREGON LIMITED PARTNERSHIP, as Tenant, and dated May 25, 1993

CELL SITE DESCRIPTION
FOR
GTE MOBILNET (STAYTON-SUBLIMITY)

BEGINNING AT A POINT WHICH BEARS S89°23'48"E 1.437.16 FEET AND N0°36'12"E 360.82' FROM THE SOUTHWEST CORNER OF SECTION 1, T9S. R1W. WILLAMETTE MERIDIAN, MARION COUNTY, OREGON, THENCE N82°02'09"W 50.00 FEET; THENCE N07°57'51"E 50.00 FEET; THENCE S82°02'09"E 50.00 FEET; THENCE S07°57'51"W 50.00 FEET TO THE POINT OF BEGINNING.

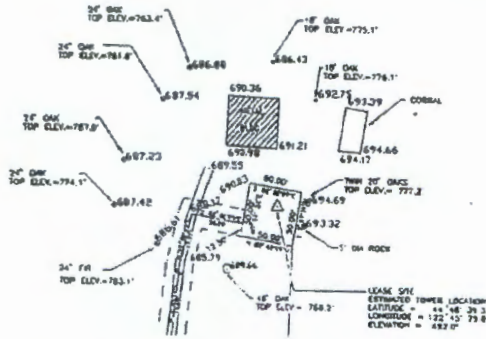

Site: Sublimity

Initial: _____
Initial: _____

Project Vertical Number: 482

AUG 25 2000

RECEIVED
DEC 02 2015
WATER RESOURCES DEPT
SALEM, OREGON

Property Description



Beginning at the quarter Section corner between Sections 2 and 11, in Township 9 South, Range 1 West of the Willamette Meridian, Marion County, Oregon; thence North along the quarter Section line of Section 2, 21.00 chains to the Southwest corner of the one acre conveyed by John Grier and wife to the Directors of School District No. 77 for a public burying ground by Deed recorded November 26, 1879, in Book 24, Page 340, Deed Records; thence East along the South line of said tract, 2.33 chains to the Southeast corner of said tract; thence North 5.00 chains to the Northeast corner of said tract; thence West 2.33 chains to said quarter Section line; thence North along said line, 3.25 chains to the Southwest corner of a 60.00 acre tract, conveyed to Alois Hassler and wife by Deed recorded May 9, 1919 in Book 150, Page 308, Deed Records; thence East along the South line of said tract, 160.00 rods to the Southeast corner; thence North on the East line of said tract 60.00 rods, more or less, to the North line of the Felix M. Taylor and wife Donation Land Claim; thence East along said line 40.00 chains to the Northeast corner of said Donation Land Claim; thence South along the East line of said Donation Land Claim 177.00 rods to the Southeast corner of said Donation Land Claim; thence West 320.00 rods to the place of beginning.

SAVE AND EXCEPT that portion of the above-described premises previously conveyed to the State of Oregon by Deed recorded December 14, 1955 in Book 483, Page 13, Deed Records for Marion County, Oregon.

ALSO SAVE AND EXCEPT: Beginning at an iron pipe at the Northwest corner of the John Hause Donation Land Claim No. 49, in Township 9 South, Range 1 West of the Willamette Meridian in Marion County, Oregon, said point of beginning also being the Northeast corner of the Felix M. Taylor Donation Land Claim in Township and Range; thence running South 89°57' West along the North line of said Taylor Claim, 2462.31 feet to an iron pipe; thence North 89°58' West continuing along said North line, 195.43 feet to the Northeast corner of that certain tract of land conveyed to Alois Hassler and wife by Deed recorded in Book 150, Page 308, Marion County Deed Records, as said Hassler tract is fence and used; thence South 02°19' East along the East line of the said Hassler tract as fence and used, 996.37 feet to an iron pipe at the Southeast corner thereof; thence North 89°57' East 2608.04 feet to an iron pipe in the West line of the aforesaid Hause Claim; thence North 00°32'30" East along said West line 995.27 feet to the point of beginning.

CC#: 11251	<p>RECEIVED</p> <p>DEC 02 2015</p> <p>WATER RESOURCES DEPT SALEM, OREGON</p>		
WO#: 5070236			
NAME: ETZEL			
DRAWN BY: RLS			
EXHIBIT B	PacifiCorp		
	<table border="1" style="width: 100%;"> <tr> <td>SCALE: NONE</td> <td>SHEET OF</td> <td>ROW#</td> </tr> </table>	SCALE: NONE	SHEET OF
SCALE: NONE	SHEET OF	ROW#	