



Oregon Water Resources Department
 725 Summer Street NE, Suite A
 Salem Oregon 97301-1266
 (503) 986-0900
 www.wrd.state.or.us

Certificate of Water Right Ownership Update

NOTICE TO SELLERS & BUYERS:

By law, all water belongs to the public (ORS 537.110). In almost every instance, a permit or water right certificate from the Water Resources Department is needed before using, diverting or storing water (ORS 537.130). However, most domestic wells do not require water rights. A certificate of water right stays with the land. In order to keep track of water right ownership, the Department requests that this form be submitted to the Department. ***If for multiple rights, a separate form for each right will be required.***

Water that has been used for a long time in one place or that involves a water structure (like a dam) that already exists is no guarantee that there is a water right which would allow the water use to continue.

If you have any questions about this form or water right requirements, please contact your local watermaster or call the Water Resources Department at 503-986-0900.

Note: Please type or print legibly when filling in the following information. Use additional paper if necessary.

PROPERTY SELLER INFORMATION

Applicant(s): Boardman Tree Farm, LLC
First Last
 Mailing Address: 1500 SW First Ave., Suite 940
Portland OR 97201
City State Zip
 Phone: _____
Home Work Other
541-667-9220

PROPERTY BUYER INFORMATION

RECEIVED BY OWRD

Applicant(s): Greg te Velde
First Last
 Mailing Address: 5850 Ave. 160
Tipton CA 93272 SALEM, OR
City State Zip
 Phone: _____
Home Work Other
559-799-9111

PROPERTY DESCRIPTION (attach additional pages if necessary): 14, 15, 16, 17, 20, 21, 22, 23, 26

County: Morrow Township: 3 North Range: 26 East Section: 27, 28, 29
 Tax Lot Number(s): 500, 1401, 1506

Street address of water right property: 77200 Poleline Road, Boardman, OR 97818

Water Right Information (attach copy of water right permit or certificate & final proof map):

Application #: S-50951 Permit #: S-37150 Certificate or Page #: 80062

Will all the lands associated with this water right be owned by the buyer? Yes No See attached map

Name of individual completing this form: Shonee D. Langford Phone: 503-540-4261

Signature: *Shonee D. Langford* Date: 10/30/15

Please be sure to attach a copy of your property deed or legal description of the property.

STATE OF OREGON
COUNTY OF MORROW
CERTIFICATE OF WATER RIGHT

THIS CERTIFICATE ISSUED TO

CONNECTICUT GENERAL LIFE INSURANCE COMPANY and
FIRST INTERSTATE BANK OF OREGON
c/o BOB O'ROURKE
P.O. BOX 490
PENDLETON, OREGON 97801-0490

confirms the right to use the waters of the COLUMBIA RIVER, a
tributary of the PACIFIC OCEAN, for IRRIGATION OF 4410.3 ACRES.

This right was perfected under Permit 37150. The date of priority is
JULY 25, 1973. The amount of water to which this right is entitled is
limited to an amount actually beneficially used and shall not exceed
68.97 CUBIC FEET PER SECOND or its equivalent in case of rotation,
measured at the point of diversion from the source.

The point of diversion is located as follows:

LOT 7 (NE¼ NW¼), SECTION 2, T 4 N, R 25 E, W.M.; 150 FEET
SOUTH AND 2990 FEET WEST FROM THE NORTHEAST CORNER, SECTION 2.

The amount of water used for irrigation, together with the amount
secured under any other right existing for the same lands, is limited
to ONE-FORTIETH of one cubic foot per second per acre, or its
equivalent for each acre irrigated and shall be further limited to a
diversion of not to exceed 4¼ acre-feet for each acre irrigated during
the irrigation season of each year.

The use shall conform to such reasonable rotation system as may be
ordered by the proper state officer.

A description of the place of use to which this right is appurtenant is as follows:

SW¼ NW¼ 33.0 ACRES
 SE¼ NW¼ 30.6 ACRES
 NE¼ SW¼ 30.3 ACRES
 NW¼ SW¼ 30.9 ACRES
 SW¼ SW¼ 33.3 ACRES
 SE¼ SW¼ 32.9 ACRES

SECTION 14

NE¼ NW¼ 32.6 ACRES
 NW¼ NW¼ 28.2 ACRES
 SW¼ NW¼ 31.9 ACRES
 SE¼ NW¼ 34.6 ACRES
 NE¼ SW¼ 36.7 ACRES
 NW¼ SW¼ 32.4 ACRES
 SW¼ SW¼ 31.7 ACRES
 SE¼ SW¼ 33.2 ACRES
 NE¼ SE¼ 23.7 ACRES
 NW¼ SE¼ 33.3 ACRES
 SW¼ SE¼ 36.5 ACRES
 SE¼ SE¼ 28.5 ACRES

SECTION 15

NE¼ NE¼ 32.6 ACRES
 NW¼ NE¼ 29.1 ACRES
 SW¼ NE¼ 31.0 ACRES
 SE¼ NE¼ 36.8 ACRES
 NE¼ NW¼ 31.2 ACRES
 NW¼ NW¼ 29.4 ACRES
 SW¼ NW¼ 33.7 ACRES
 SE¼ NW¼ 34.6 ACRES
 NE¼ SW¼ 36.7 ACRES
 NW¼ SW¼ 32.3 ACRES
 SW¼ SW¼ 31.4 ACRES
 SE¼ SW¼ 33.8 ACRES
 NE¼ SE¼ 33.8 ACRES
 NW¼ SE¼ 31.3 ACRES
 SW¼ SE¼ 32.1 ACRES
 SE¼ SE¼ 38.0 ACRES

SECTION 16

NE¼ NE¼ 29.2 ACRES
 NW¼ NE¼ 31.3 ACRES
 SW¼ NE¼ 33.0 ACRES
 SE¼ NE¼ 35.6 ACRES
 NE¼ NW¼ 30.4 ACRES
 NW¼ NW¼ 33.6 ACRES
 SW¼ NW¼ 36.8 ACRES
 SE¼ NW¼ 28.4 ACRES
 NE¼ SW¼ 33.2 ACRES
 NW¼ SW¼ 36.0 ACRES
 SW¼ SW¼ 38.4 ACRES
 SE¼ SW¼ 31.6 ACRES
 NE¼ SE¼ 31.4 ACRES
 NW¼ SE¼ 35.7 ACRES
 SW¼ SE¼ 33.0 ACRES
 SE¼ SE¼ 35.2 ACRES

SECTION 17

NE¼ NE¼ 30.6 ACRES
 NW¼ NE¼ 37.6 ACRES
 SW¼ NE¼ 36.0 ACRES
 SE¼ NE¼ 33.2 ACRES
 NE¼ NW¼ 32.4 ACRES
 NW¼ NW¼ 34.8 ACRES
 SW¼ NW¼ 38.0 ACRES
 SE¼ NW¼ 34.4 ACRES
 NE¼ SW¼ 32.8 ACRES
 NW¼ SW¼ 31.6 ACRES
 SW¼ SW¼ 36.4 ACRES
 SE¼ SW¼ 34.4 ACRES
 NE¼ SE¼ 32.8 ACRES
 NW¼ SE¼ 38.4 ACRES
 SW¼ SE¼ 35.2 ACRES
 SE¼ SE¼ 33.3 ACRES

SECTION 18

TOWNSHIP 3 NORTH,
RANGE 26 EAST, W.M.

RECEIVED BY OWRD

NE¼ NE¼ 34.4 ACRES
 NW¼ NE¼ 39.2 ACRES
 SW¼ NE¼ 35.2 ACRES
 SE¼ NE¼ 32.2 ACRES
 NE¼ NW¼ 34.0 ACRES
 NW¼ NW¼ 28.4 ACRES
 SW¼ NW¼ 34.8 ACRES
 SE¼ NW¼ 36.8 ACRES
 NE¼ SW¼ 34.4 ACRES
 NW¼ SW¼ 28.4 ACRES
 SW¼ SW¼ 32.8 ACRES
 SE¼ SW¼ 32.8 ACRES
 NE¼ SE¼ 31.2 ACRES
 NW¼ SE¼ 38.4 ACRES
 SW¼ SE¼ 2.8 ACRES
 SE¼ SE¼ 14.3 ACRES

SECTION 19

NE¼ NE¼ 33.0 ACRES
 NW¼ NE¼ 37.0 ACRES
 SW¼ NE¼ 35.1 ACRES
 SE¼ NE¼ 37.6 ACRES
 NE¼ NW¼ 33.6 ACRES
 NW¼ NW¼ 36.4 ACRES
 SW¼ NW¼ 38.0 ACRES
 SE¼ NW¼ 33.2 ACRES
 NE¼ SW¼ 34.8 ACRES
 NW¼ SW¼ 36.0 ACRES
 SW¼ SW¼ 38.7 ACRES
 SE¼ SW¼ 11.8 ACRES
 NE¼ SE¼ 31.8 ACRES
 NW¼ SE¼ 37.6 ACRES
 SW¼ SE¼ 0.7 ACRES
 SE¼ SE¼ 35.0 ACRES

SECTION 20

NE¼ NE¼ 34.5 ACRES
 NW¼ NE¼ 32.8 ACRES
 SW¼ NE¼ 31.5 ACRES
 SE¼ NE¼ 36.4 ACRES
 NE¼ NW¼ 38.0 ACRES
 NW¼ NW¼ 32.7 ACRES

SW¼ NW¼ 34.9 ACRES
 SE¼ NW¼ 33.8 ACRES
 NW¼ SW¼ 28.6 ACRES
 SW¼ SW¼ 28.4 ACRES

SECTION 21

NE¼ NE¼ 25.7 ACRES
 NW¼ NE¼ 35.8 ACRES
 SW¼ NE¼ 36.0 ACRES
 SE¼ NE¼ 28.5 ACRES
 NE¼ NW¼ 35.7 ACRES
 NW¼ NW¼ 34.3 ACRES
 SW¼ NW¼ 32.1 ACRES
 SE¼ NW¼ 34.0 ACRES
 NE¼ SE¼ 25.7 ACRES
 NW¼ SE¼ 33.3 ACRES
 SW¼ SE¼ 34.6 ACRES
 SE¼ SE¼ 29.7 ACRES

SECTION 22

NE¼ NE¼ 32.6 ACRES
 NW¼ NE¼ 33.5 ACRES
 SW¼ NE¼ 31.0 ACRES
 SE¼ NE¼ 31.0 ACRES
 NE¼ NW¼ 30.5 ACRES
 NW¼ NW¼ 29.4 ACRES
 SW¼ NW¼ 30.9 ACRES
 SE¼ NW¼ 33.2 ACRES
 NE¼ SW¼ 30.4 ACRES
 NW¼ SW¼ 27.6 ACRES
 SW¼ SW¼ 31.2 ACRES
 SE¼ SW¼ 34.4 ACRES
 NE¼ SE¼ 34.9 ACRES
 NW¼ SE¼ 30.3 ACRES
 SW¼ SE¼ 28.6 ACRES
 SE¼ SE¼ 30.4 ACRES

SECTION 23

TOWNSHIP 3 NORTH,
 RANGE 26 EAST, W.M.

RECEIVED BY OWRD

NE¼ NW¼ 0.8 ACRE
NW¼ NW¼ 0.6 ACRE
SECTION 26

NE¼ NE¼ 0.6 ACRE
NW¼ NW¼ 1.2 ACRES
SECTION 29

NE¼ NE¼ 0.4 ACRE
NW¼ NE¼ 0.8 ACRE
SECTION 27

NE¼ NW¼ 0.8 ACRE
NW¼ NW¼ 0.8 ACRE
SECTION 30

NW¼ NW¼ 0.2 ACRE
SECTION 28

TOWNSHIP 3 NORTH,
RANGE 26 EAST, W.M.

This certificate is issued to correct a scrivener's error contained in the certificate recorded at page 79850, State Record of Water Right Certificates. Certificate 79850 incorrectly identified the quarter quarter listing for certain lands in Section 21, Township 3 North, Range 26 East, W.M.. This certificate supersedes Certificate 79850.

Certificate 79850 describes that portion of the water right confirmed by Certificate 68261, State Record of Water Right Certificates, NOT modified by the provisions of an order of the Water Resources Director approving Transfer Application 7890.

The issuance of this superseding certificate does not confirm the status of the water right in regard to the provisions of ORS 540.610 pertaining to forfeiture or abandonment.

The right to the use of the water for the above purpose is restricted to beneficial use on the lands or place of use described. The use confirmed herein may be made only at times when sufficient water is available to satisfy all prior rights, including rights for maintaining instream flows.

WITNESS the signature of the Water Resources

Director, affixed APR 28 2003.

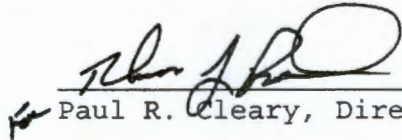
Paul R. Cleary, Director

Recorded in State Record of Water Right Certificates numbered 80062.

RECEIVED BY OWRD

NOV 23 2015

SALEM, OR

TOWNSHIP 3 NORTH, RANGE 26 B 27 EAST, W. M.

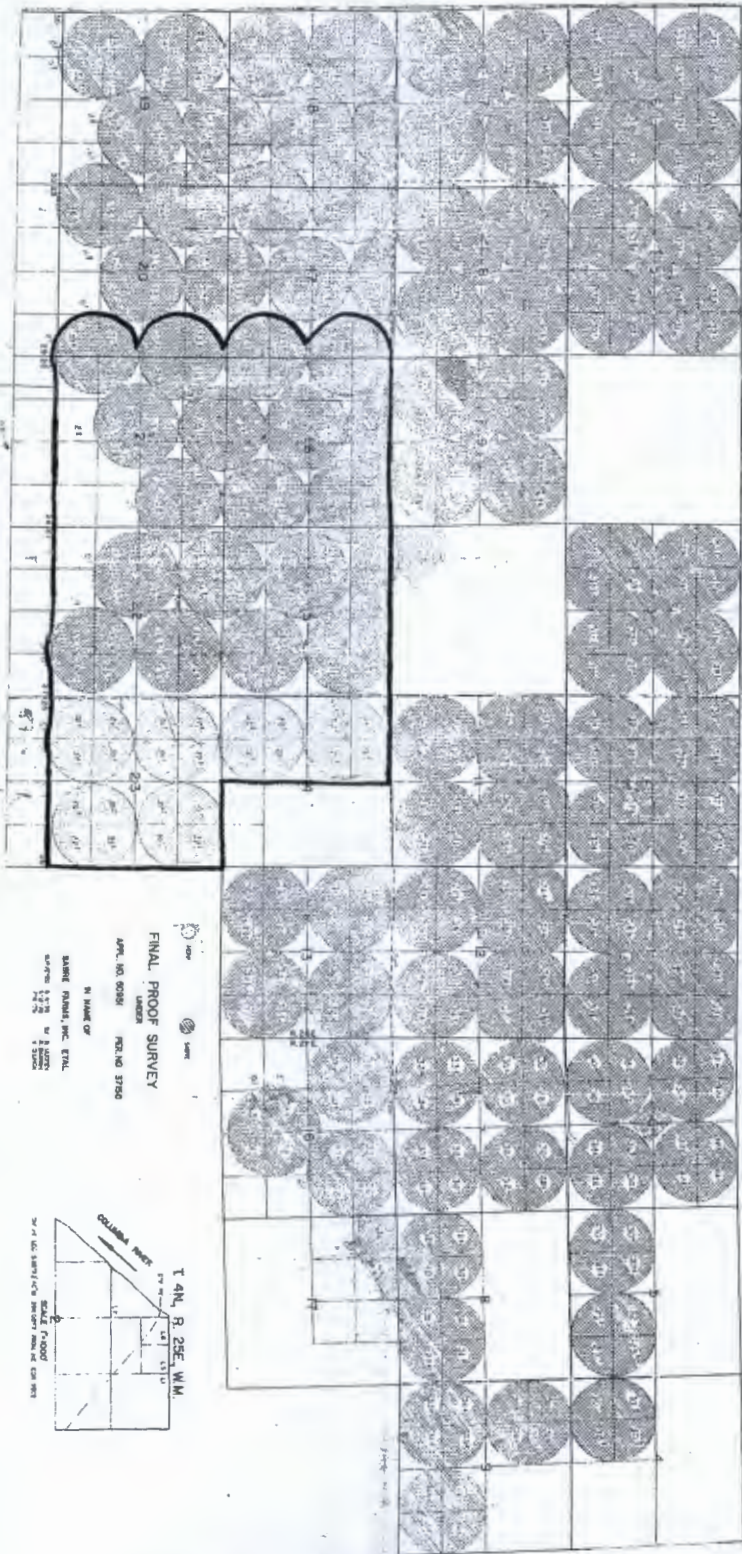

□ Property sold includes water rights within (this area), being a portion of Certificate 80062. (Lines shown are NOT property boundaries)

RECEIVED BY OWRD

NOV 23 2015

SALEM, OR