

RECEIVED

APR 18 1997

STATE OF OREGON
COUNTY OF POLK
CERTIFICATE OF WATER RIGHT

WATER RESOURCES DEPT.
SALEM, OREGON

THIS CERTIFICATE ISSUED TO

FRANK B. DOLL
10995 DOLL ROAD
MONMOUTH, OREGON 97361

confirms the right to use the waters of LUCKIAMUTE RIVER, a tributary of WILLAMETTE RIVER, for the purpose of IRRIGATING 11.6 ACRES.

The right has been perfected under Permit 45906. The date of priority is AUGUST 18, 1980. The right is limited to not more than 0.15 CUBIC FOOT PER SECOND or its equivalent in case of rotation, measured at the point of diversion from the source.

The point of diversion is located as follows:

LOT 3 (NW 1/4 SE 1/4), SECTION 24, T 9 S, R 6 W, W.M.; 1160 FEET SOUTH AND 840 FEET EAST FROM NE CORNER DLC 49.

The amount of water used for irrigation, together with the amount secured under any other right existing for the same lands, shall be limited to ONE-EIGHTIETH of one cubic foot per second per acre, or its equivalent for each acre irrigated and shall be further limited to a diversion of not to exceed 2.5 acre-feet per acre for each acre irrigated during the irrigation season of each year.

The right shall conform to such reasonable rotation system as may be ordered by the proper state officer.

A description of the place of use under the right, and to which such right is appurtenant, is as follows:

SW 1/4 NE 1/4	2.2 ACRES
AS PROJECTED WITHIN DLC 48	
LOT 2 (SW 1/4 NE 1/4)	5.5 ACRES
LOT 1 (SE 1/4 NE 1/4)	0.6 ACRE
NE 1/4 SE 1/4	1.0 ACRE
LOT 3 (NW 1/4 SE 1/4)	2.3 ACRES
SECTION 24	
TOWNSHIP 9 SOUTH, RANGE 6 WEST, W.M.	

The right to the use of the water for the above purpose is restricted to beneficial use on the lands or place of use described. The right is subject to minimum flows established by the Water Resources Commission with an effective date prior to this right.

WITNESS the signature of the Water Resources Director, affixed this date AUGUST 18, 1989.

/s/ WILLIAM H. YOUNG

Water Resources Director

Recorded in State Record of Water Right Certificates numbered 62149

60511.SB

RECEIVED

APR 18 1997

WATER RESOURCES DEPT.
SALEM, OREGON

T. 9 S., R. 6 W., W.M.

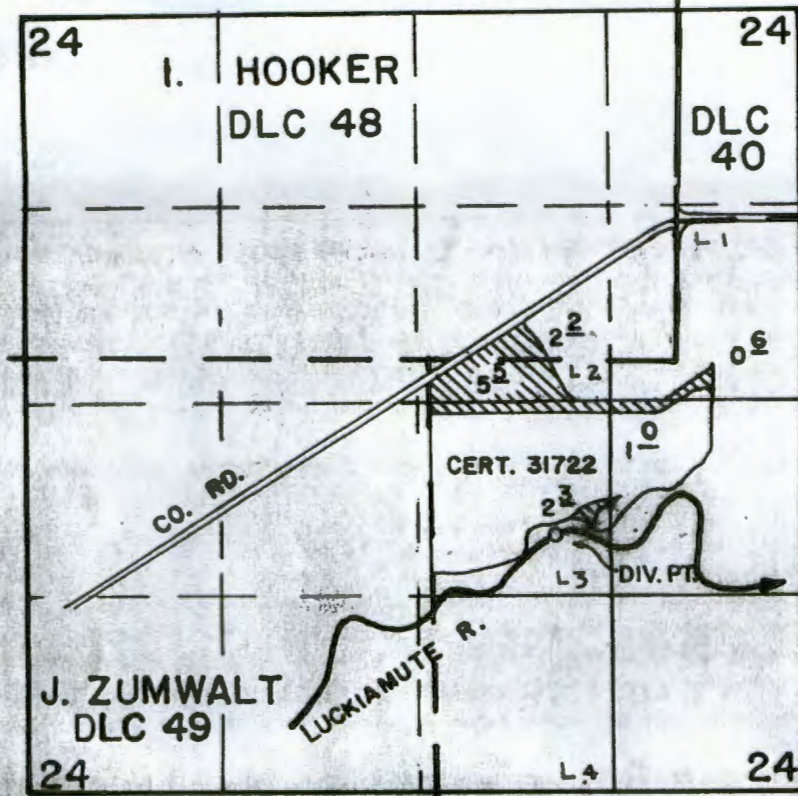

SCALE
1" = 1320'

DIV. PT. LOC. 1180' S & 840' E OF NE COR. DLC 49

FINAL PROOF SURVEY
UNDER

Application No. 60511 Permit No. 45906
IN NAME OF

FRANK B. DOLL

Surveyed AUG 9 1984, by J. DOLL

RECEIVED

AUG 18 1981
WATER RESOURCES DEPT
SALEM, OREGON

J-11-5
L O R

A
31.5
(E-191)

A
10.3

C
3.4

D
5.4



new application

current right

G
29.6

H
73.9

24 19
25 30

A
19.5

8" = 1 mile



See J-12
Low Elev.

Application No. 60511
Permit No. 45906

* 24478

RECEIVED

APR 18 1997

WATER RESOURCES DEPT
SALEM, OREGON

Permit to appropriate the Public Waters of the State of Oregon

This is to certify that I have examined the foregoing application and do hereby grant the same SUBJECT TO EXISTING RIGHTS INCLUDING THE EXISTING FLOW POLICIES ESTABLISHED BY THE WATER POLICY REVIEW BOARD and the following limitations and conditions:

The right herein granted is limited to the amount of water which can be applied to beneficial use and shall not exceed 0.69 cubic feet per second measured at the point of diversion from the stream, or its equivalent in case of rotation with other water users, from Luckiamute River

The use to which this water is to be applied is irrigation

If for irrigation, this appropriation shall be limited to 1/80th of one cubic foot per second or its equivalent for each acre irrigated and shall be further limited to a diversion of not to exceed 2 1/2 acre-feet per acre for each acre irrigated during the irrigation season of each year,

RECEIVED
APR 18 1997
WATER RESOURCES DEPT.
SALEM, OREGON

and shall be subject to such reasonable rotation system as may be ordered by the proper state officer.

The priority date of this permit is August 18, 1980

Actual construction work shall begin on or before September 10, 1982 and shall thereafter be prosecuted with reasonable diligence and be completed on or before October 1, 1983

Complete application of the water to the proposed use shall be made on or before October 1, 1984

WITNESS my hand this 10th day of September, 1981

James E. Dixon
Water Resources Director

0114

RECEIVED

STATE OF OREGON WATER RESOURCES DEPARTMENT

AUG 18 1980

Application for Permit to Appropriate Surface Water

WATER RESOURCES DEPT. SALEM, OREGON

I, FRANK B. DOLL

(Name of Applicant)

of 10995 DOLL ROAD, MONMOUTH

(Mailing Address)

(City)

State of OREGON 97361 Phone No. 838-2925 do hereby

(Zip Code)

make application for a permit to appropriate the following described waters of the State of Oregon:

1. The source of the proposed appropriation is LUCKIAMUTE RIVER, a tributary of WILLAMETTE RIVER

2. The point of diversion is to be located 1070 ft. S and 800 ft. E from the CENTER corner of SEC. 24, T9S, R6W AND WITHIN LOT 3

(N. or S.)

(E. or W.)

(Public Land Survey Corner)

(If there is more than one point of diversion, each must be described)

being within the NW 1/4 of the SE 1/4 of Sec. 24 Tp. 9S R. 6W, W. M., in the county of POLK

(N. or S.)

(E. or W.)

3. Location of area to be irrigated, or place of use if other than irrigation.

Township	Range	Section	List 1/4 1/4 of Section	List use and/or number of acres to be irrigated
9S	6W	24	NE 1/4, SE 1/4	4.0
			SE 1/4, NE 1/4	12.5
			SW 1/4, NE 1/4	18.5
			NW 1/4, SE 1/4	6.0
			SE 1/4 NW 1/4	0.5
			NE 1/4, SW 1/4	14.0
				55.5 acres

RECEIVED

APR 18 1997

4. The amount of water which the applicant intends to apply to beneficial use is 0.81 cubic feet per second OR 310.8 g.p.m. (If water is to be used from more than one source, give quantity from each)

5. The use to which the water is to be applied is IRRIGATION **RECEIVED**

APR 18 1997

WATER RESOURCES DEPT.
SALEM, OREGON

6. DESCRIPTION OF WORKS

Include dimensions and type of construction of diversion dam and headgate, length and dimensions of supply ditch or pipeline, size and type of pump and motor, type of irrigation system to adequately describe the proposed distribution system.

20 H.P. PUMP TO 6" & 5" MAINLINE AND THEN TO 4" & 3" LATERALS

If for domestic use state number of families to be supplied

7. Construction work will begin on or before COMPLETED

8. Construction work will be completed on or before

9. The water will be completely applied to the proposed use on or before

Application No. 60511

Permit No. 45906

Remarks:

RECEIVED

APR 18 1997

WATER RESOURCES DEPT.
SALEM, OREGON

Frank B. Dill
Signature of Applicant

This is to certify that I have examined the foregoing application, together with the accompanying maps and data, and return the same for.....

In order to retain its priority, this application must be returned to the Water Resources Director with corrections on or before, 19.....

WITNESS my hand this day of....., 19.....

Water Resources Director

By

This instrument was first received in the office of the Water Resources Director at Salem, Oregon, on the

18th day of AUGUST, 1980, at 1:00 o'clock P.M.

Application No. 60511.....

Permit No. 45906.....