

Limited Water use License Application Map
Atterrage LLC
T. 23S. R. 7W., Sections 19 and 20 W.M.
Douglas County
Scale: 1" = 500'

RECEIVED BY OWRD

JUN 03 2016

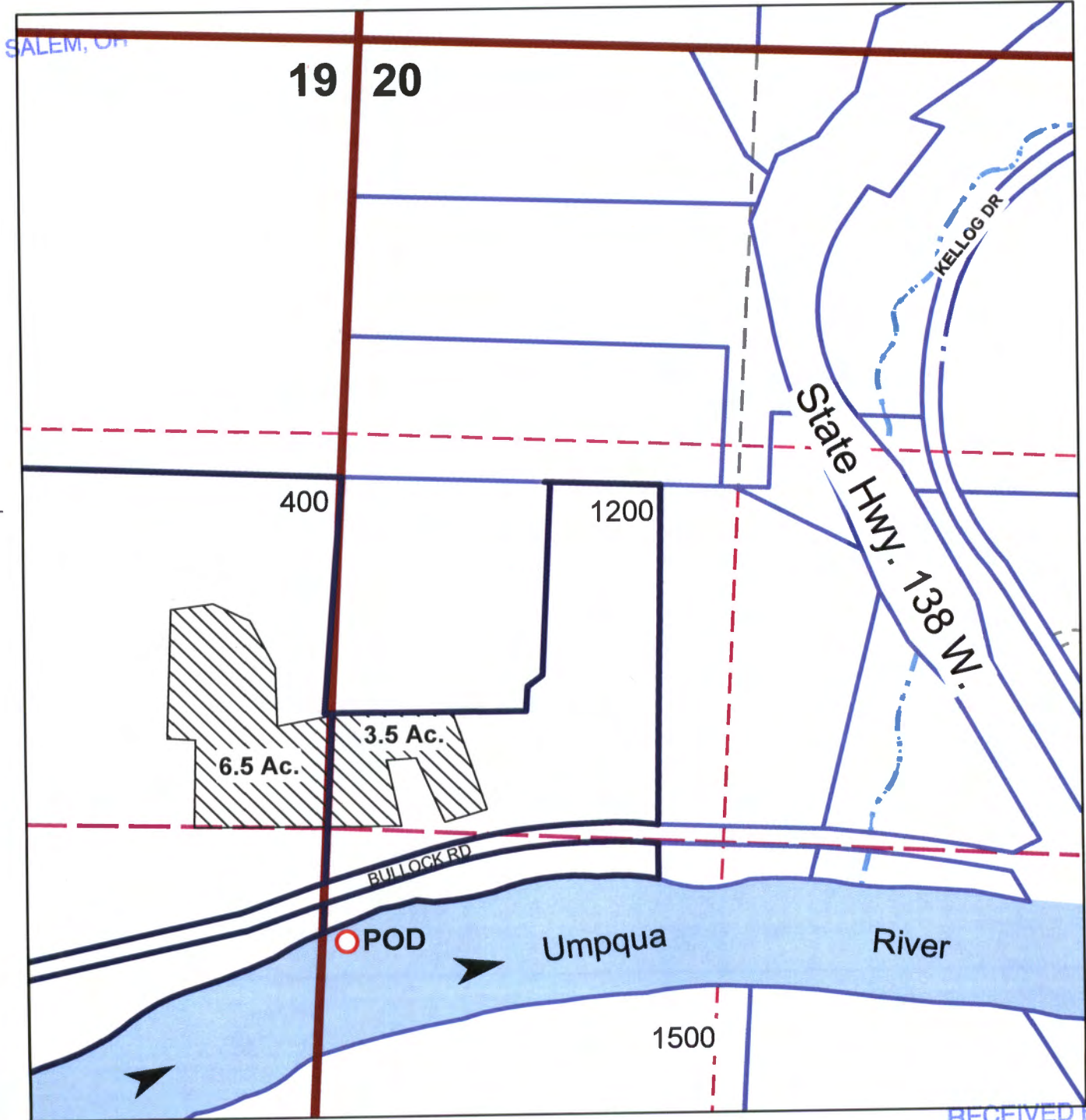

Point of Diversion is 3,000 ft. south and 80 ft. east from the northwest quarter corner of Section 20.

RECEIVED BY OWRD

MAY 23 2016

SALEM, OR

5-88739