

Groundwater Application for Luke Hewko

Map ID: 39S-1E-3-tax Lot 300

Proposed Place of Use:

NW/NW: 1.8 Acres of Nursery Uses
 NE/NW: 31.13 Acres of Nursery Uses
 NW/NE: 1.1 Acres of Nursery Uses
 SW/NE: 0.1 Acres of Nursery Uses
 SE/NW: 2.0 Acres of Nursery Uses

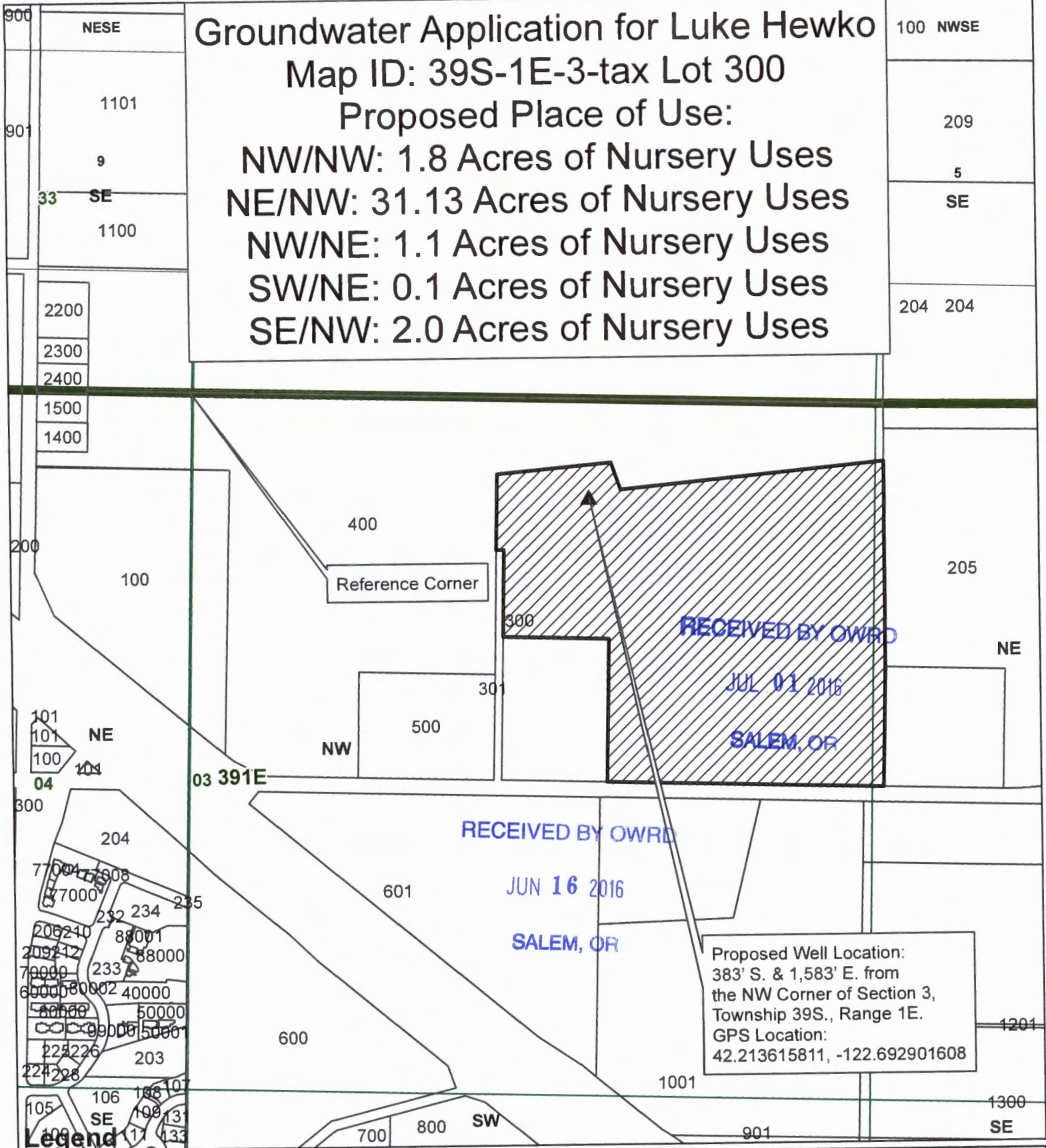

Legend

- ▲ Proposed Well
- ▨ Place of Use
- ▭ Taxlot 300
- ▭ Taxlots
- ▭ Townships
- ▭ Sections
- ▭ Quarter Sections
- ▭ Quarter Quarter Sections

1 inch = 500 feet

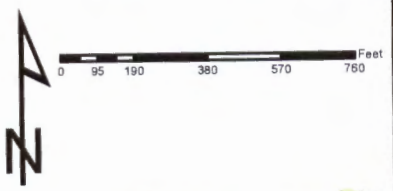

JACKSON COUNTY
WATERMASTER

Prepared by Travis Kelly

This map is based on a digital database compiled by Jackson County from a variety of sources. Jackson County cannot accept responsibility for errors, omissions, or positional accuracy. There are no warranties, expressed or implied.

Date: 6/01/2016 39-1E-3-tax lot 300 groundwater Hewko.mxd kellyt

GWB332