

TO: Water Rights Section

April 10, 2001
199

FROM: Groundwater/Hydrology Section Don Miller

Reviewer's Name

SUBJECT: Application G- 15322

GROUNDWATER/SURFACE WATER CONSIDERATIONS

- 1. PER THE Hood Basin rules, one or more of the proposed POA's is not within _____ feet/mile of a surface water source (_____) and taps a groundwater source hydraulically connected to the surface water.
- 2. BASED UPON OAR 690-09 currently in effect, I have determined that the proposed groundwater use ~~will~~ will, or have the potential for substantial interference with the nearest (b) X will not surface water source, namely _____; or
 - c. _____ will if properly conditioned, adequately protect the surface water from interference:
 - i. _____ The permit should contain condition #(s) _____;
 - ii. _____ The permit should contain special condition(s) as indicated in "remarks" below;
 - iii. _____ The permit should be conditioned as indicated in item 4 below; or
 - d. _____ will, with well reconstruction, adequately protect the surface from substantial interference.

GROUNDWATER AVAILABILITY CONSIDERATIONS

- 3. BASED UPON available data, I have determined that groundwater for the proposed use (a) X will, or
 - b. _____ will not and/or within the capacity of the resource; or
 - c. _____ will if properly conditioned, avoid injury to existing rights or to the groundwater resource:
 - i. _____ The permit should contain condition #(s) _____;
 - ii. _____ The permit should contain special condition(s) as indicated in "Remarks" below;
 - iii. _____ The permit should be conditioned as indicated in item 4 below; or
- 4.
 - a. _____ THE PERMIT should allow groundwater production from no deeper than _____ ft. below land surface;
 - b. _____ The permit should allow groundwater production from no shallower than _____ ft. below land surface;
 - c. _____ The permit should allow groundwater production only from the _____ groundwater reservoir between approximately _____ ft. and _____ ft. below land surface;
 - d. _____ Well reconstruction is necessary to accomplish one or more of the above conditions.
 - e. _____ One or more POA's commingle 2 or more sources of water. The applicant must select one source of water per POA and specify the proportion of water to be produced from each source.

REMARKS: _____

(Well Construction Considerations on Reverse Side)

G-15322

WELL CONSTRUCTION (If more than one well doesn't meet standards, attach an additional sheet.)

5. THE WELL which is the point of appropriation for this application does not meet current well construction standards based upon:
- a. ___ review of the well log;
 - b. ___ field inspection by _____;
 - c. ___ report of CWRE _____;
 - d. ___ other: (specify) _____
6. THE WELL construction deficiency:
- a. ___ constitutes a health threat under Division 200 rules;
 - b. ___ commingles water from more than one groundwater reservoir;
 - c. ___ permits the loss of artesian head;
 - d. ___ permits the de-watering of one or more groundwater reservoirs;
 - e. ___ other: (specify) _____
7. THE WELL construction deficiency is described as follows: _____
8. THE WELL
- a. ___ was, or constructed according to the standards in effect at the time of
 - b. ___ was not original construction or most recent modification.
 - c. ___ I don't know if it met standards at the time of construction.

RECOMMENDATION:

- A. ___ I recommend including the following condition in the permit:
"No water may be appropriated under terms of this permit until the well(s) has been repaired to conform to current well construction standards and proof of such repair is filed with the Enforcement Section of the Water Resources Department."
- B. ___ I recommend withholding issuance of the permit until evidence of well reconstruction is filed with the Enforcement Section of the Water Resources Department.
- C. ___ REFER this review to Enforcement Section for concurrence.

THIS SECTION TO BE COMPLETED BY ENFORCEMENT PERSONNEL

I concur in G/H's recommendation A or B above relating to conditioning or withholding the permit

_____, 199____
(Signature)

I do not concur in G/H's recommendation A or B above relating to conditioning or withholding the permit for the following reasons: _____

_____, 199____
(Signature)

Water Right Conditions
Tracking Slip

Groundwater/Hydrology Section

FILE # ~~3~~ ~~2~~ ~~1~~ G-15322

ROUTED TO: WR'S

TOWNSHIP/

RANGE-SECTION: 15/10E-17

CONDITIONS ATTACHED? ~~Yes~~ No

REMARKS OR FURTHER INSTRUCTIONS:

Reviewer: D Miller

TO: Groundwater/Hydrology Files

Date 4/9/01

FROM: Donn Miller

SUBJECT: Groundwater Application G-15322

Phone: _____

Name: Fowler Timber Co

Applicant(s) seek 448 gpm (1 cfs) from ONE well(s) in the

Proposed use Irrigation 80 AC
HOOD River basin
East Fork H.R. sub basin
Evans CK sub basin

Pertinent 7 1/2-minute quads Dog River

Well WRD# HOOD 50199 T 15 R 10E S 17 QD CC County HOOD

Legal Description N 1000' N x 200' E from SW Corner Section 17

Well is 100 ft from Griswell CK (river/stream)

Well is 2100 ft from Evans CK (river/stream)

Well elevation 2275 ft River/stream elevation @ 2270, @ 2160 ft

Well elevation-river/stream elevation 5, 115

Well depth 246' SWL 105 on 5/8/00

Sealed to 24' Depth first water found 172

Cased to 246 Perforations/screens 238-246

Lined to - Perforations/screens

Well tests and types 55 gpm / Air test / 1/2 hr

Confined or unconfined? confined Hydrologically connected? NO, maybe

Potential to cause substantial interference? NO, NO

Well WRD# _____ T _____ R _____ S _____ QD _____ County _____

Legal Description _____

Well is _____ ft from _____ (river/stream)

Well is _____ ft from _____ (river/stream)

Well elevation _____ ft River/stream elevation _____ ft

Well elevation-river/stream elevation _____

Well depth _____ SWL _____ on _____

Sealed to _____ Depth first water found _____

Cased to _____ Perforations/screens _____

Lined to _____ Perforations/screens _____

Well tests and types _____

Confined or unconfined? _____ Hydrologically connected? _____

Potential to cause substantial interference? _____

Conditioned water rights in area: NOT really

Other nearby water rights of record: yes

Density of nearby wells of record: low

Comments SWL is far below level of nearby Griswell CK. Shallow well seal may cause loss of artesian pressure.

References used: USGS WRI-Rpt 81-1108

NO PERMITTED WELLS WITHIN 1 MILE OF APPLICATION G 15322

CONDITIONED WELLS WITHIN 5 MILES OF APPLICATION G 15322

\$RECNO	APPLICATION	PERMIT	LOC-QQ	CONDITION-CODE
1	G 13839	G 12078	2.00N10.00E36NENE	4IG
1	G 13839	G 12078	2.00N10.00E36NENE	4IR
1	G 13839	G 12078	2.00N10.00E36NENE	4IG
1	G 13839	G 12078	2.00N10.00E36NENE	4IR
2	G 13734	G 12068	1.00N10.00E12NWNW	7BG
2	G 13734	G 12068	1.00N10.00E12NWNW	7BR
2	G 13734	G 12068	1.00N10.00E12NWNW	7DG
2	G 13734	G 12068	1.00N10.00E12NWNW	7DR
2	G 13734	G 12068	1.00N10.00E12NWNW	7BG
2	G 13734	G 12068	1.00N10.00E12NWNW	7BR
2	G 13734	G 12068	1.00N10.00E12NWNW	7DG
2	G 13734	G 12068	1.00N10.00E12NWNW	7DR

APPLICATION G 15322 FALLS WITHIN THESE QUAD(S)

PARKDALE

1675 II
HOOD RIVER
1:52,500

UNITED STATES
DEPARTMENT OF THE INTERIOR
GEOLOGICAL SURVEY

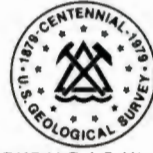

RECEIVED

MAY 15 2000

STATE OF OREGON
WATER SUPPLY WELL REPORT
(As required by ORS 537.765)

hood
50149

WATER RESOURCES DEPT
SALEM, OREGON

WELL I.D. # 131742
START CARD # 122176

Instructions for completing this report are on the last page of this form.

(1) OWNER: Well Number 1
Name BRAD FOWLER
Address 1321 ALAMEDA RD.
City HOOD RIVER State ORE Zip 97031

(2) TYPE OF WORK
 New Well Deepening Alteration (repair/recondition) Abandonment

(3) DRILL METHOD:
 Rotary Air Rotary Mud Cable Auger
 Other

(4) PROPOSED USE:
 Domestic Community Industrial Irrigation
 Thermal Injection Livestock Other

(5) BORE HOLE CONSTRUCTION:
Special Construction approval Yes No Depth of Completed Well 246 ft.
Explosives used Yes No Type Amount

HOLE SEAL

Diameter	From	To	Material	From	To	Sacks or pounds
12"	0	24	Bentonite	0	24	21 SACKS

How was seal placed: Method A B C D E
 Other Redded chips
Backfill placed from ft. to ft. Material
Gravel placed from ft. to ft. Size of gravel

(6) CASING/LINER:

Diameter	From	To	Gauge	Steel	Plastic	Welded	Threaded
8"	+1	246	1.200	<input checked="" type="checkbox"/>	<input type="checkbox"/>	<input checked="" type="checkbox"/>	<input type="checkbox"/>

Liner:

Diameter	From	To	Gauge	Steel	Plastic	Welded	Threaded
				<input type="checkbox"/>	<input type="checkbox"/>	<input type="checkbox"/>	<input type="checkbox"/>

(7) PERFORATIONS/SCREENS:

Perforations Method
 Screens Type slotted Material steel

From	To	Slot size	Number	Diameter	Thickness	Casing	Liner
238	246	.130			1/2"	<input type="checkbox"/>	<input type="checkbox"/>

(8) WELL TESTS: Minimum testing time is 1 hour
 Pump Bailor Air Flowing Artesian
Yield gal/min Drawdown Drill stem at Time
55 240 1 1/2 hr.

Temperature of water 40 Depth Artesian Flow Found
Did any strata contain water not suitable for intended use? Yes By whom Too little
 Salty Muddy Odor Colored Other
Depth of water

(9) LOCATION OF WELL by legal description:
County Hood River Latitude Longitude
Township 1 N or S Range 10 E or W. WM.
Section 17 SW 1/4 SW 1/4
Tax Lot 1301 Lot Block Subdivision
Street Address of Well (or nearest address) INTERSECTION OF COOPER SPUR AND COOPER CREEK RD.

(10) STATIC WATER LEVEL:
105 ft. below land surface. Date 5/8/00
Artesian pressure lb. per square inch. Date

(11) WATER BEARING ZONES:
Depth at which water was first found 172'

From	To	Estimated Flow Rate	SWL
172	246	55	105'

(12) WELL LOG:
Ground Elevation 2390

Material	From	To	SWL
Brown clay with GRAVEL	0	12	
TAN CLAY w/ GRAVEL	12	19	
TAN SANDY CLAY	19	28	
GRAVEL	28	54	
TAN SANDY CLAY with GRAVEL	54	68	
Red-GRAY CINDERS	68	111	
DARK BROWN SANDY CLAY	111	116	
TAN CLAY w/ CINDERS	116	172	
BROKEN GRAY BASALT w/B	172	212	105'
COARSE SAND w/ CINDERS	212	250	
BROKEN GRAY BASALT	230	250	

Date started 3/24 Completed 5/7/00

(unbonded) Water Well Constructor Certification:
I certify that the work I performed on the construction, alteration, or abandonment of this well is in compliance with Oregon water supply well construction standards. Materials used and information reported above are true to the best of my knowledge and belief.
WVC Number
Signed Date

(bonded) Water Well Constructor Certification:
I accept responsibility for the construction, alteration, or abandonment work performed on this well during the construction dates reported above. All work performed during this time is in compliance with Oregon water supply well construction standards. This report is true to the best of my knowledge and belief.
WVC Number 1732
Signed Lindsey Hayward Date 5/9/00

RECEIVED

SEP 23 2000

STATE OF OREGON
WATER WELL REPORT
 (as required by ORS 537.765)

3
 HOOD
 584

RECEIVED

NOV - 9 1994

1S/10E/2066
 60292

WATER RESOURCES DEPT. (START CARD) #

SALEM, OREGON

(1) OWNER: Well Number 60292
 Name MIKE RICE
 Address 8885 Cooper Spur RD.
 City Parkdale State OR Zip 97041

(9) LOCATION OF WELL by legal description:
 County Hood River Latitude _____ Longitude _____
 Township 15N N or S. Range 10 E or W. WM. _____
 Section 20 N.W. 1/4 N.W. 1/4 _____
 Tax Lot _____ Lot _____ Block _____ Subdivision _____
 Street Address of Well (or nearest address) 8885 Cooper Spur RD

(2) TYPE OF WORK:
 New Well Deepen Recondition Abandon

(10) STATIC WATER LEVEL:
114 ft. below land surface. Date 9-28-94
 Artesian pressure _____ lb. per square inch. Date _____

(3) DRILL METHOD:
 Rotary Air Rotary Mud Cable
 Other _____

(11) WATER BEARING ZONES:

(4) PROPOSED USE:
 Domestic Community Industrial Irrigation
 Thermal Injection Other _____

Depth at which water was first found 15'

(5) BORE HOLE CONSTRUCTION:
 Special Construction approval Yes No. Depth of Completed Well 146 ft.
 Explosives used Yes No Type _____ Amount _____

From	To	Estimated Flow Rate	SWL
15'	16'	1/2 gpm	15
130'	146'	25 gpm	114

HOLE		SEAL		Amount sacks or pounds
Diameter	From To	Material	From To	
10"	0' 18'	CEMENT-BENTONITE	0' 19'	24
6"	18' 146'			

(12) WELL LOG:
 Ground elevation _____

How was seal placed: Method A B C D E
 Other _____

Material	From	To	SWL
Soil	0	1	
Sandstone Brown med w/clay	1	10	
Sandstone 11 11 gneiss	10	40	
Clay red-brown w/sgm gravel	40	45	
gravel - red	45	50	
Sandstone multi color w/clay	50	56	
Clay - yellow w/sand	56	60	
Clay - red w/sgm gravel	60	73	
Sandstone lt brown w/clay	73	90	
11 multi color fine	90	105	
gravel - multi color	105	109	
Sandstone multi - fine	109	133	
Sandstone (med black w/clay)	133	146	

Backfill placed from _____ ft. to _____ ft. Material _____

Gravel placed from _____ ft. to _____ ft. Size of gravel _____

(6) CASING/LINER:

Diameter	From	To	Gauge	Steel	Plastic	Welded	Threaded
Casing: 6"	+1.5	118.5	1250	<input checked="" type="checkbox"/>	<input type="checkbox"/>	<input checked="" type="checkbox"/>	<input type="checkbox"/>
Liner: 4 1/2"	106	146	1250	<input type="checkbox"/>	<input checked="" type="checkbox"/>	<input checked="" type="checkbox"/>	<input type="checkbox"/>

Final location of shoe(s) _____

(7) PERFORATIONS/SCREENS:
 Perforations Method _____
 Screens Type _____ Material _____

From	To	Slot size	Number	Diameter	Tele/pipe size	Casing	Liner
						<input type="checkbox"/>	<input type="checkbox"/>

(8) WELL TESTS: Minimum testing time is 1 hour

Yield gal/min	Drawdown	Drill stem at	Time
14	0		1 hr.

Date started 9-16 Completed 10-3-94

(unbonded) Water Well Constructor Certification:
 I certify that the work I performed on the construction, alteration, or abandonment of this well is in compliance with Oregon well construction standards. Materials used and information reported above are true to my best knowledge and belief.

Temperature of Water 50° Depth Artesian Flow Found _____

WWC Number _____
 Signed _____ Date _____

Was a water analysis done? Yes By whom _____
 Did any strata contain water not suitable for intended use? Too little
 Salty Muddy Odor Colored Other _____

(bonded) Water Well Constructor Certification:
 I accept responsibility for the construction, alteration, or abandonment work performed on this well during the construction dates reported above. All work performed during this time is in compliance with Oregon well construction standards. This report is true to the best of my knowledge and belief.

Depth of strata: _____

WWC Number 1613
 Signed Greg M. Byrd Date 11-6-94

#3
STATE OF OREGON
WATER WELL REPORT
 (as required by ORS 537.765)

#000
 264

OCT 29 1990

WATER RESOURCES DEPT.
SALEM, OREGON

15/10E/20 bb

21731

(START CARD) #

(1) OWNER: Well Number: 1
 Name Virginia Jarvis
 Address 7510 SW Miles PL.
 City Portland State OR Zip 97219

(2) TYPE OF WORK:
 New Well Deepen Recondition Abandon

(3) DRILL METHOD
 Rotary Air Rotary Mud Cable
 Other

(4) PROPOSED USE:
 Domestic Community Industrial Irrigation
 Thermal Injection Other

(5) BORE HOLE CONSTRUCTION:
 Special Construction approval Yes No Depth of Completed Well 245 ft.
 Yes No
 Explosives used Type _____ Amount _____

HOLE		SEAL		Amount	
Diameter	From To	Material	From To	sacks or pounds	
10"	top 40'	cement	20' 40'	10 sack	
6"	40' 245'	bentonite	top 20'	13 sack	

How was seal placed: Method A B C D E
 Other bentonite-dry
 Backfill placed from _____ ft. to _____ ft. Material _____
 Gravel placed from _____ ft. to _____ ft. Size of gravel _____

(6) CASING/LINER:

Diameter	From	To	Gauge	Steel	Plastic	Welded	Threaded
Casing: 6"	top	240'	.250	<input checked="" type="checkbox"/>	<input type="checkbox"/>	<input checked="" type="checkbox"/>	<input type="checkbox"/>
Liner:				<input type="checkbox"/>	<input type="checkbox"/>	<input type="checkbox"/>	<input type="checkbox"/>

Final location of shoe(s) 240

(7) PERFORATIONS/SCREENS:
 Perforations Method Air perforator
 Screens Type _____ Material _____

From	To	Slot size	Number	Diameter	Tele/pipe size	Casing	Liner
220	240	1/8x2	60	6"		<input checked="" type="checkbox"/>	<input type="checkbox"/>

(8) WELL TESTS: Minimum testing time is 1 hour
 Pump Bailer Air Flowing Artesian
 Yield gal/min 15 Drawdown 100% Drill stem at 240 Time 1 hr.

Temperature of water _____ Depth Artesian Flow Found _____
 Was a water analysis done? Yes By whom _____
 Did any strata contain water not suitable for intended use? Too little
 Salty Muddy Odor Colored Other _____
 Depth of strata: _____

(9) LOCATION OF WELL by legal description:
 County Hood River Latitude _____ Longitude _____
 Township IS Nor S, Range 10E E or W, WM. _____
 Section 20 NW NW NW
 Tax Lot 700 Lot _____ Block _____ Subdivision _____
 Street Address of Well (or nearest address) 8994 Cooper Spur Parkdale, OR 97041

(10) STATIC WATER LEVEL:
196' ft. below land surface. Date 10-23-90
 Artesian pressure _____ lb. per square inch. Date _____

(11) WATER BEARING ZONES:
 Depth at which water was first found 219'

From	To	Estimated Flow Rate	SWL
219	245	15	196

(12) WELL LOG: Ground elevation 2800'

Material	From	To	SWL
top soil.....	0	2	
brown clay & gravel.....	2	12	
brown clay and claystone	12	40	
brown sandstone.....	40	52	
red & gray cinders,			
porous.....	52	57	
red & gray cinders.....	57	219	
red & gray cinders, caving			
water bearing.....	219	245	196'

Date started 10-22-90 Completed 10-23-90

(unbonded) Water Well Constructor Certification:
 I certify that the work I performed on the construction, alteration, or abandonment of this well is in compliance with Oregon well construction standards. Materials used and information reported above are true to my best knowledge and belief.
 WWC Number _____
 Signed _____ Date _____

(bonded) Water Well Constructor Certification:
 I accept responsibility for the construction, alteration, or abandonment work performed on this well during the construction dates reported above. all work performed during this time is in compliance with Oregon well construction standards. This report is true to the best of my knowledge and belief.
 WWC Number 731
 Signed Charles J. Moore Date 10-26-90

HOOD N R I V E R V

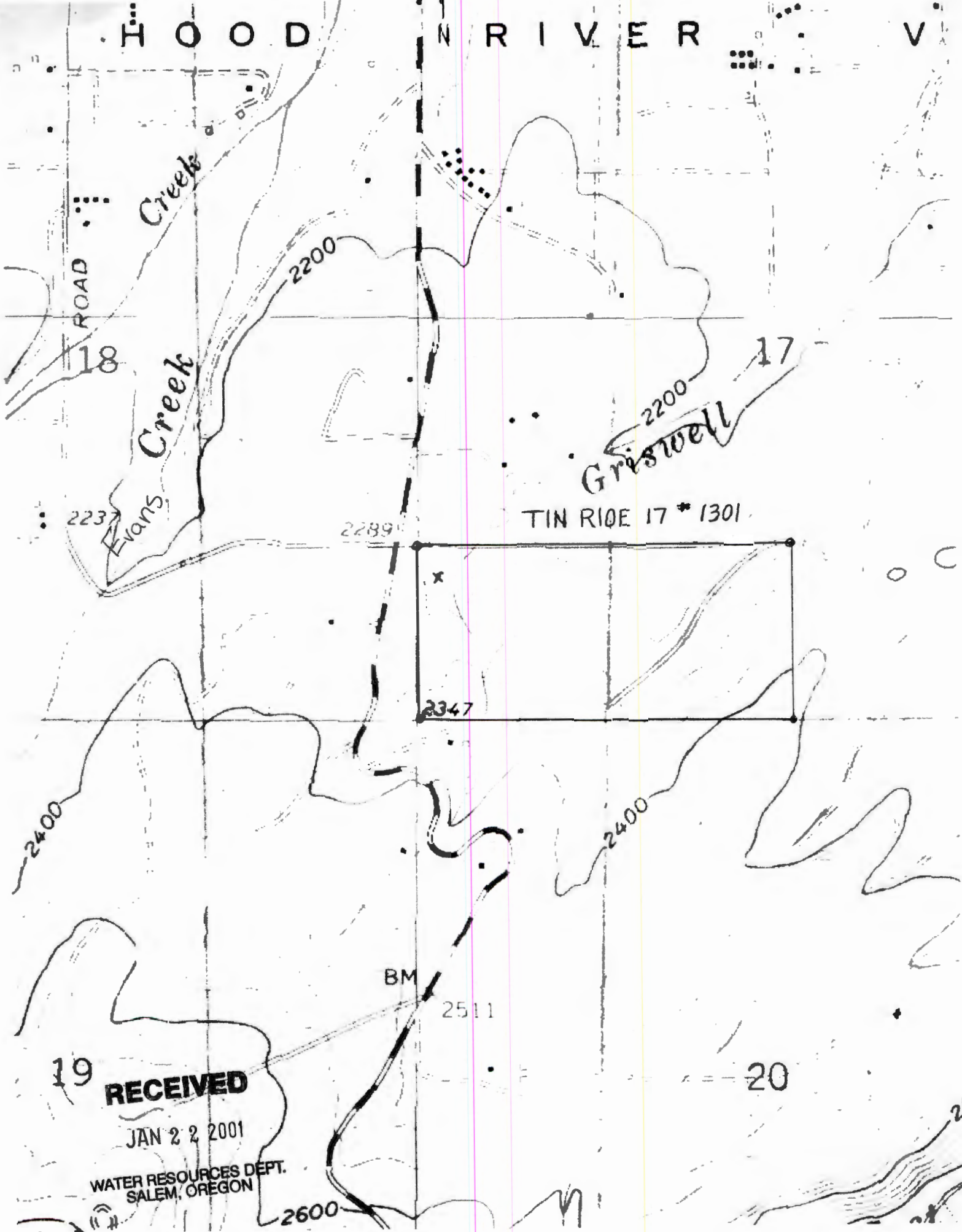

X = Well location



x = well location

TIA^S RIOE 17 #1301

RECEIVED

JAN 22 2001

WATER RESOURCES DEPT.
SALEM, OREGON

CH OUT
7/16
Hackett