

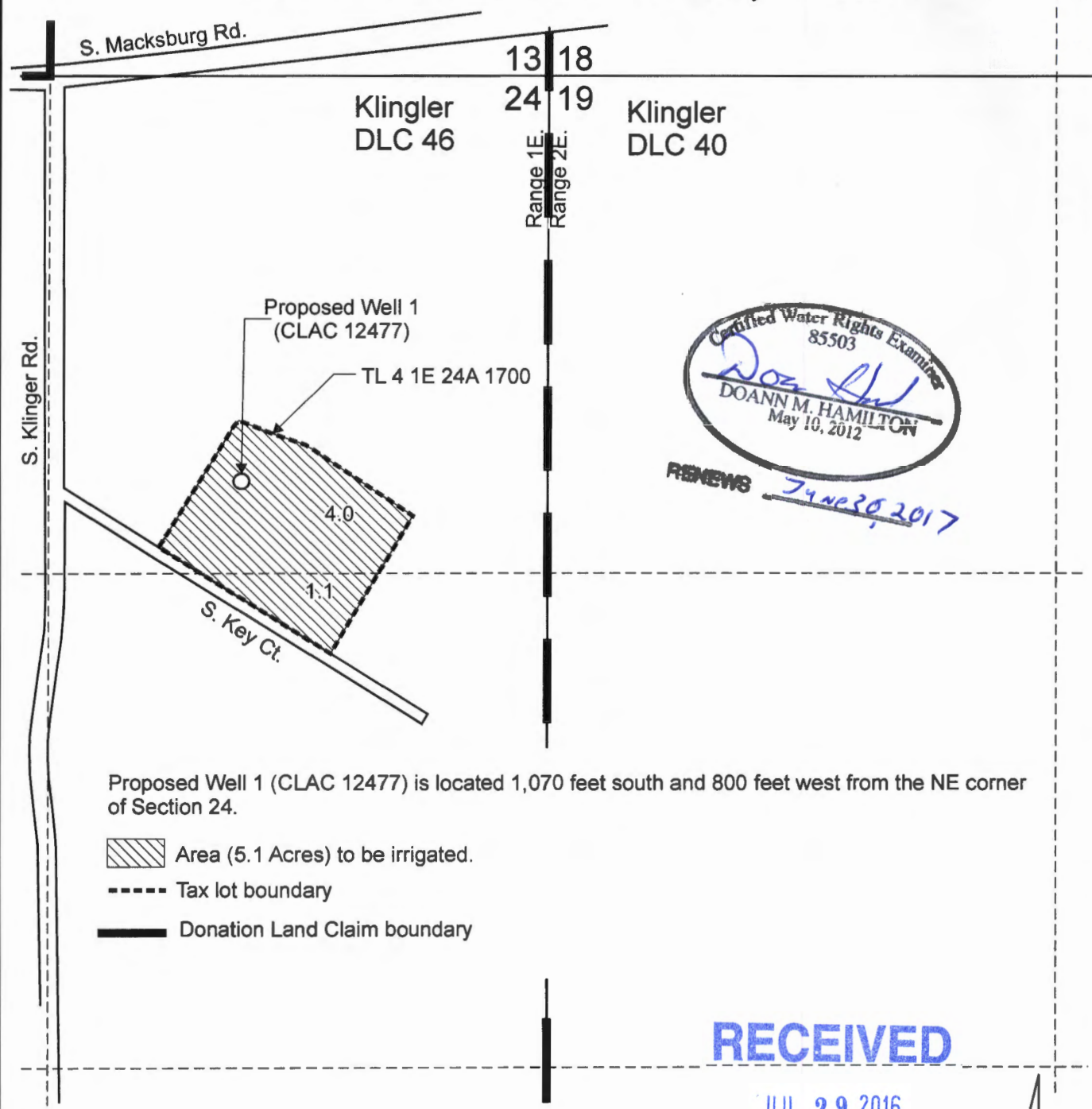



T.4S. R.1E. Section 24, W.M.



Certified Water Rights Examiner
85503
Doz
DOANN M. HAMILTON
May 10, 2012
RENEWS June 30, 2017

Proposed Well 1 (CLAC 12477) is located 1,070 feet south and 800 feet west from the NE corner of Section 24.

-  Area (5.1 Acres) to be irrigated.
-  Tax lot boundary
-  Donation Land Claim boundary

RECEIVED

JUL 29 2016

WATER RESOURCES DEPT
SALEM, OREGON

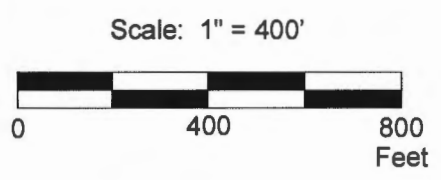

This map was prepared for the purpose of identifying the location of a water right only and is not intended to provide legal dimensions or location of property ownership lines.

Ground Water Application Map

Peter Munro
T.4S. R.1E. Section 24, W.M.

Pacific Hydro-Geology Inc.

06/2016

MunroGVappMap.cdr

CH8152



© Clackamas County 2014

S KEY CT

RECEIVED

JUL 29 2016

WATER RESOURCES DEPT
SALEM, OREGON

G10352