

# T.5S. R.2W., W.M

RECEIVED

SEP 29 1998

WATER RESOURCES DEPT  
SALEM, OREGON

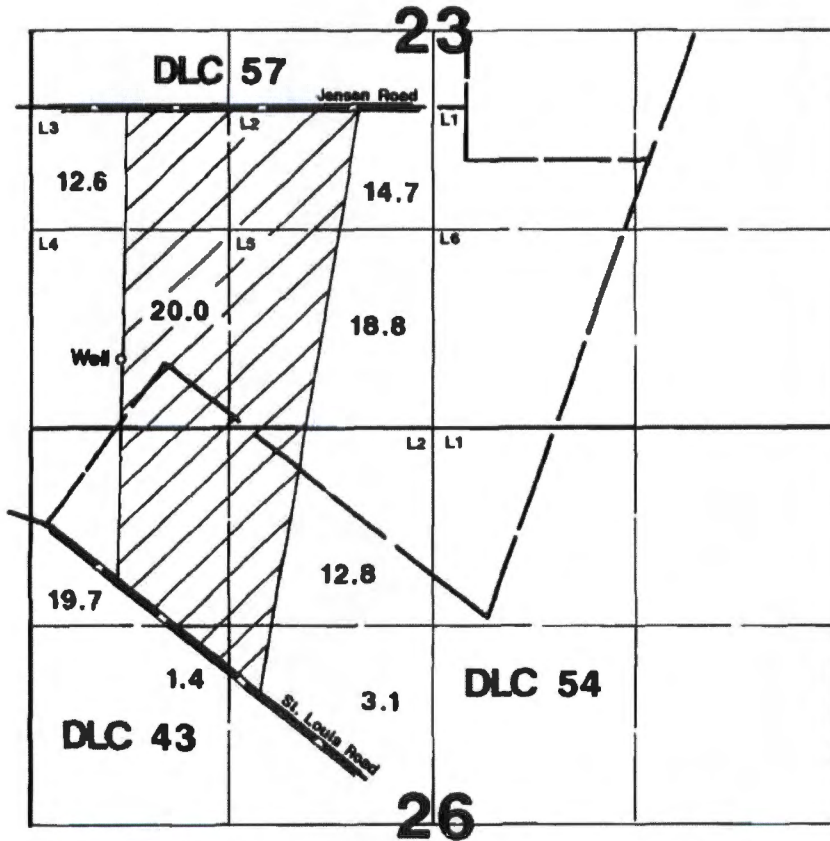

1" = 1320'

Area Irrigated

Well is located 430'N & 610'E from the SW corner of Section 23.

## Final Proof Survey

Application #: G-12472 Permit #: G-11892

In Name Of

### Paul Jensen-JB Sod & Seed

Surveyed on September 22, 1998 by JM Schuette

This Map Was Prepared For The Purpose Of Identifying The Location Of A Water Right Only And Is Not Intended To Provide Legal Dimensions Or Location Of Property Ownership Lines.

RECEIVED BY OWRD

SEP 12 2016

SALEM, OR

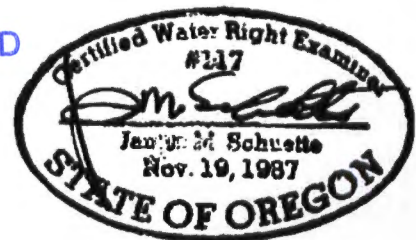

G-18383

# T.5S. R.2W., W.M

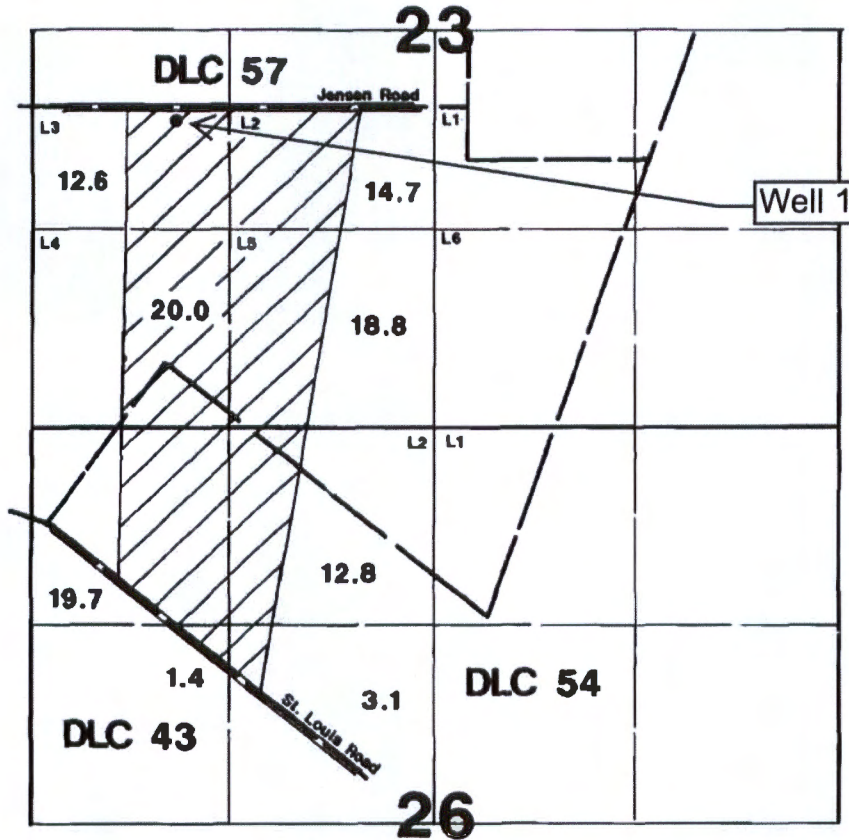

  
Area Irrigated  
Tax Lot 2000

Well Location: 1600' N 5' E from NNE corner of DLC 54 in T5S, R2W, W.M.

RECEIVED BY OWRD

SEP 12 2016

SALEM, OR