

G-10284

# T15S, R16E, SECTION 24 & T15S, R17E, SECTION 19, WM

CROOK COUNTY, OREGON

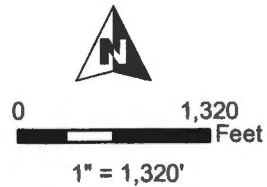
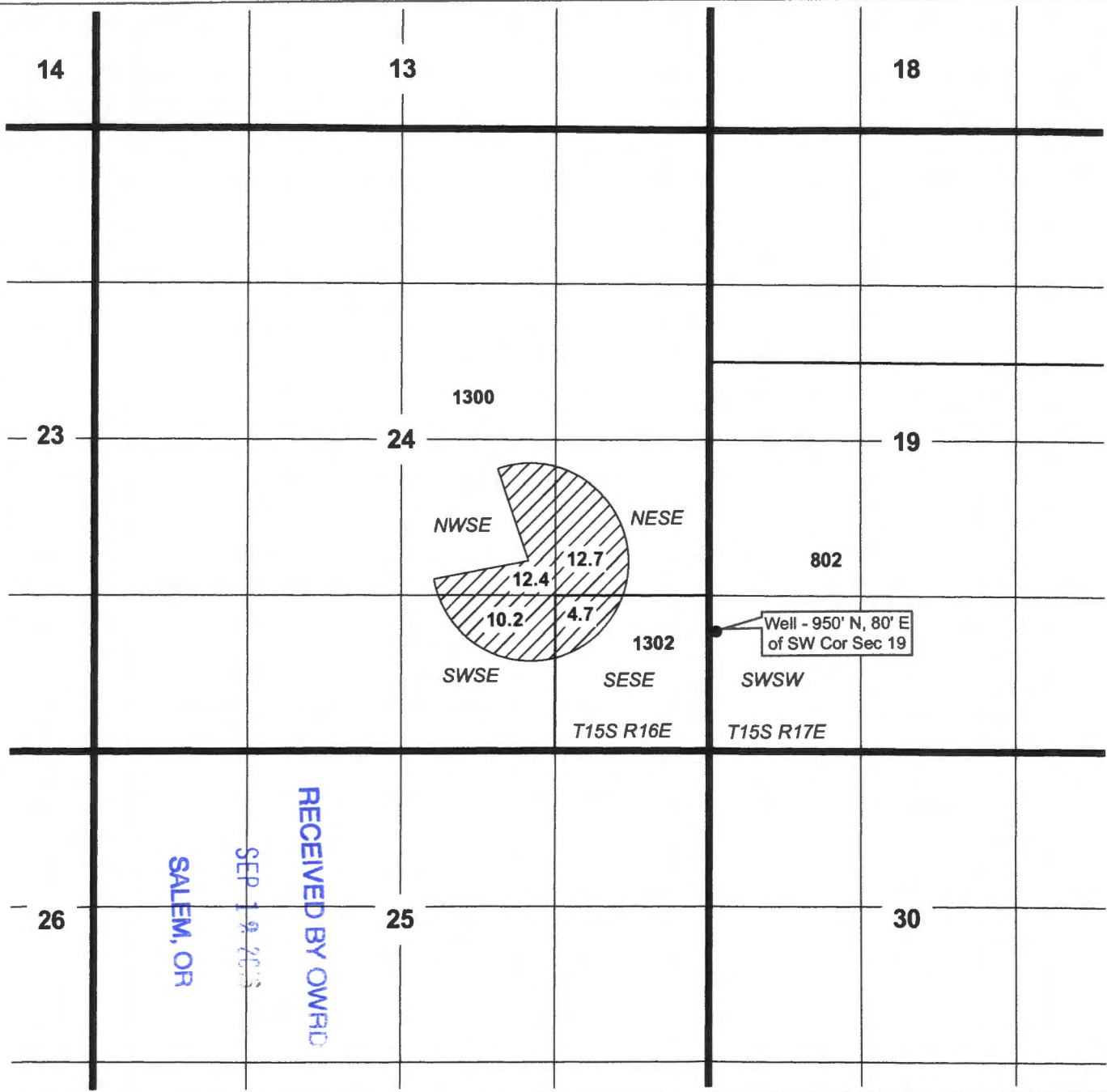

### Legend

-  Place of Use
-  Well

RECEIVED BY OWRID  
 SEP 19 2015  
 SALEM, OR



RENEWAL DATE 12/31/2016

**GROUNDWATER APPLICATION**  
 Les Schwab Tire Centers of Oregon

NOTE: THIS MAP IS NOT INTENDED TO  
 PROVIDE LEGAL DIMENSIONS OR LOCATIONS  
 OF PROPERTY OWNERSHIP LINES.

AUGUST 11, 2016

**WATER RIGHT SERVICES, LLC**  
 PO BOX 1830, BEND, OR 97709  
 CCB# 197121 [www.oregonwater.us](http://www.oregonwater.us)  
 541-389-2837 [JOHNSHORT@USA.COM](mailto:JOHNSHORT@USA.COM)