

Application for new water rights:
 - Township 5N, Range 30E, Sections 1, 11, 12, 13, 14, 15;
 - Township 5N, Range 31E, Sections 5, 7, 8, 17, 18;
 - Umatilla County

Point of Diversion located 2,920' N and 150' E from the SW corner of Section 8, T5N, R30E

Legend

- Place of Use
- Point of Diversion
- Pipeline
- Ground water wells*
- Tax lot
- Sections
- Quarter/quarter
- Roads
- Streams

* Groundwater wells are permitted in G-17272 and are not subject to this application.

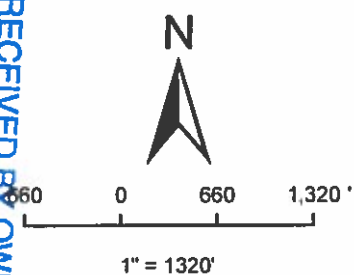

**FIGURE 1A
 Application for
 New Water Right**

No.	Date	By	Revisions
1	06/17/16	RMS	DRAFT

Rupp Ranches
 176 Kranichwood Street
 Richland, WA 99352
 509-737-0547

Disclaimer: This map is not intended to provide legal dimension or locations of property ownership lines.

AKANA
 Plan + Design + Engineer + Manage



6400 SE Lake Road, Ste 270
 Portland, Oregon 97222
 (503) 652-9090

Application for new water rights:
 - Township 5N, Range 30E, Sections 1, 11, 12, 13, 14, 15;
 - Township 5N, Range 31E, Sections 5, 7, 8, 17, 18;
 - Umatilla County

Point of Diversion located 2,920' N and 150' E from the SW corner of Section 8, T5N, R30E

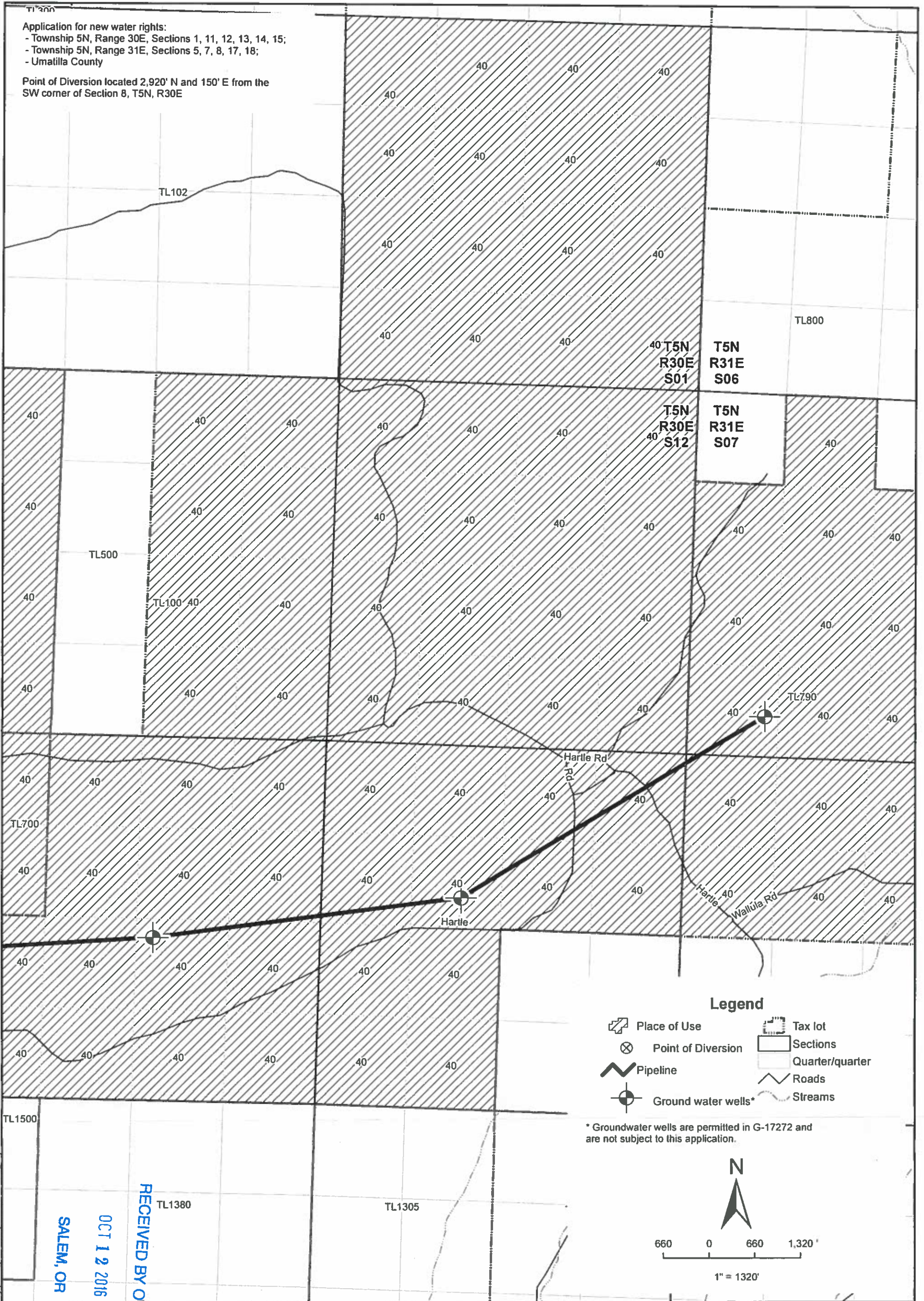

Legend

- Place of Use
- Point of Diversion
- Pipeline
- Ground water wells*
- Tax lot
- Sections
- Quarter/quarter
- Roads
- Streams

* Groundwater wells are permitted in G-17272 and are not subject to this application.

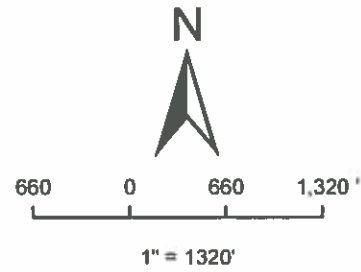

P:\PDX PROJECTS\2015115-196 Rupp Irrigation System\GIS\03 figures

RECEIVED BY OWRD
 OCT 12 2016
 SALEM, OR



6400 SE Lake Road, Ste 270
 Portland, Oregon 97222
 (503) 652-9090

FIGURE 1B
Application for
New Water Right

1	06/17/16	RMS	DRAFT
No.	Date	By	Revisions

Rupp Ranches
 176 Kranichwood Street
 Richland, WA 99352
 509-737-0547

Disclaimer: This map is not intended to provide legal dimension or locations of property ownership lines.

S-88299

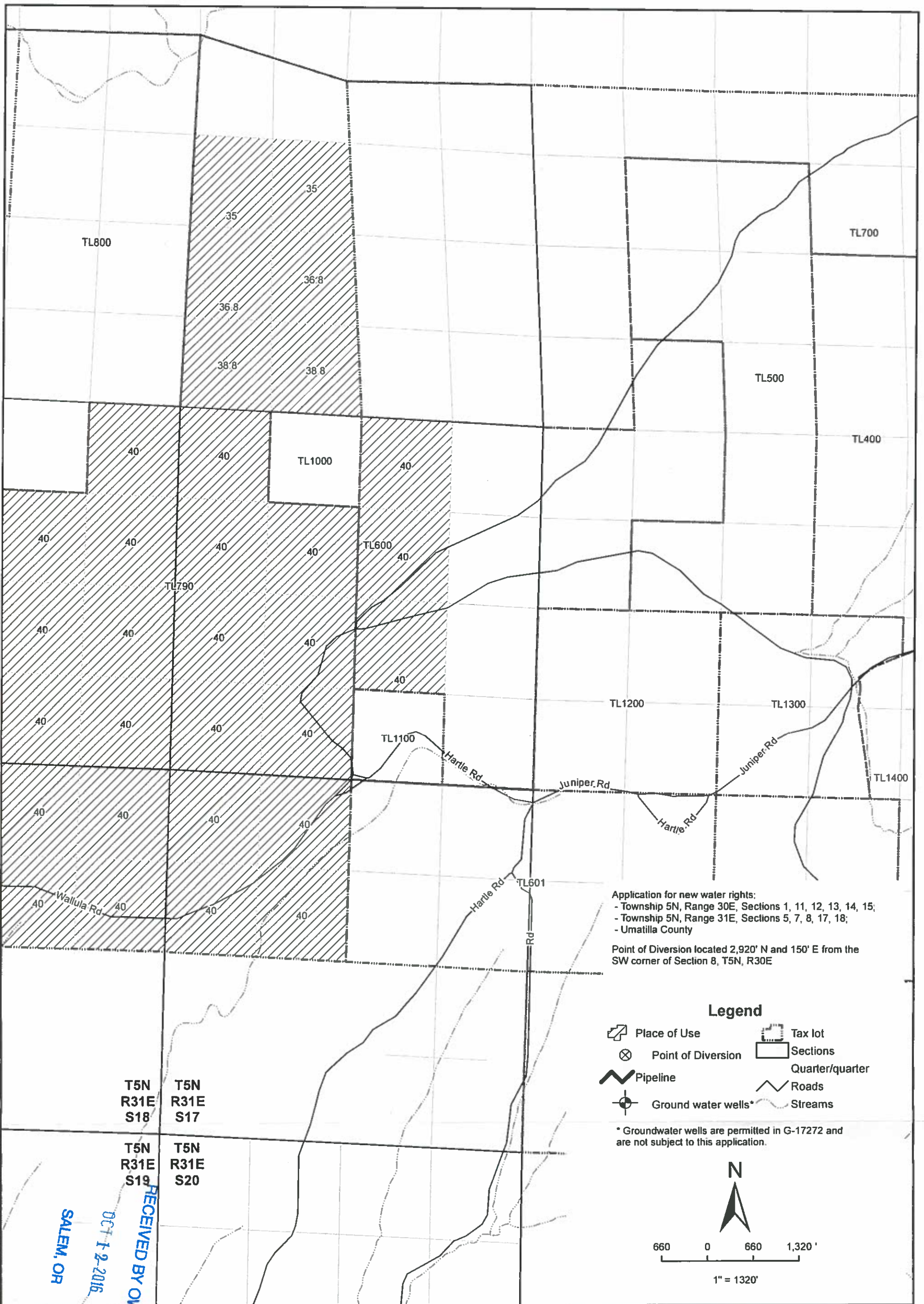

Application for new water rights:
 - Township 5N, Range 30E, Sections 1, 11, 12, 13, 14, 15;
 - Township 5N, Range 31E, Sections 5, 7, 8, 17, 18;
 - Umatilla County

Point of Diversion located 2,920' N and 150' E from the SW corner of Section 8, T5N, R30E

- Legend**
- Place of Use
 - Point of Diversion
 - Pipeline
 - Ground water wells*
 - Tax lot
 - Sections
 - Quarter/quarter
 - Roads
 - Streams

* Groundwater wells are permitted in G-17272 and are not subject to this application.

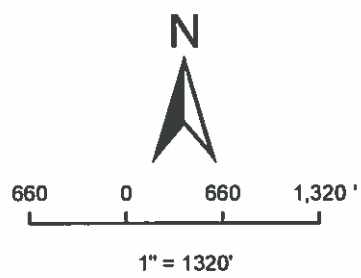

P:\PDX PROJECTS\2015\15-196 Rupp Irrigation System\GIS\03 figures

SALEM, OR
 OCT 1-2-2016
 RECEIVED BY OWRD

AKANA
 Plan + Design + Engineer + Manage



6400 SE Lake Road, Ste 270
 Portland, Oregon 97222
 (503) 652-9090

FIGURE 1C
 Application for
 New Water Right

1	06/17/16	RMS	DRAFT
No.	Date	By	Revisions

Rupp Ranches
 176 Kranichwood Street
 Richland, WA 99352
 509-737-0547

Disclaimer: This map is not intended to provide legal dimension or locations of property ownership lines.

S-88299