

# Application for a Permit to Use Ground Water



Oregon Water Resources Department  
725 Summer Street NE, Suite A  
Salem, Oregon 97301-1266  
(503) 986-0900  
[www.wrd.state.or.us](http://www.wrd.state.or.us)

## Water-Use Permit Application Processing

### 1. Completeness Determination

The Department evaluates whether the application and accompanying map contain all of the information required under OAR 690-310-0040 and OAR 690-310-0050 ([www.oregon.gov/owrd/law](http://www.oregon.gov/owrd/law)). The Department also determines whether the proposed use is prohibited by statute. If the Department determines that the application is incomplete, all fees have not been paid, or the use is prohibited by statute, the application and all fees submitted are returned to the applicant.

### 2. Initial Review

The Department reviews the application to determine whether water is available during the period requested, whether the proposed use is restricted or limited by rule or statute, and whether other issues may preclude approval of or restrict the proposed use. An Initial Review (IR) containing preliminary determinations is mailed to the applicant. The applicant has 14 days from the mailing date to withdraw the application from further processing and receive a refund of all fees paid minus \$200. The applicant may put the application on hold for up to 180 days and may request additional time if necessary.

### 3. Public Notice

Within 7 days of the mailing of the initial review, the Department gives public notice of the application in the weekly notice published by the Department at [www.oregon.gov/owrd](http://www.oregon.gov/owrd). The public comment period is 30 days from publication in the weekly notice.

### 4. Proposed Final Order Issued

The Department reviews any comments received, including comments from other state agencies related to the protection of sensitive, threatened or endangered fish species. Within 60 days of completion of the IR, the Department issues a Proposed Final Order (PFO) explaining the proposed decision to deny or approve the application. A PFO proposing approval of an application will include a draft permit, and may request additional information or outstanding fees required prior to permit issuance.

### 5. Public Notice

Within 7 days of issuing the PFO, the Department gives public notice in the weekly notice. Notice includes information about the application and the PFO. Protest must be received by the Department within 45 days after publication of the PFO in the weekly notice. Anyone may file a protest. The protest filing fee is \$350.00 for the applicant and \$700.00 for non-applicants. Protests are filed on approximately 10% of Proposed Final Orders. If a protest is filed, the Department will attempt to settle the protest but will schedule a contested case hearing if necessary.

### 6. Final Order Issued

If no protests are filed, the Department issues a Final Order consistent with the PFO. If the application is approved, a permit is issued that specifies the details of the authorized use and any terms, limitations or conditions that the Department deems appropriate.

RECEIVED

NOV 28 2016

OWRD  
SALEM, OREGON

WR

# Minimum Requirements Checklist

Minimum Requirements (OAR 690-310-0040, OAR 690-310-0050 & ORS 537.615)

## Include this checklist with the application

Check that each of the following items is included. The application will be returned if all required items are not included. If you have questions, please call the Water Rights Customer Service Group at (503) 986-0900.

- SECTION 1: applicant information and signature
- SECTION 2: property ownership
- SECTION 3: well development
- SECTION 4: water use
- SECTION 5: water management
- SECTION 6: storage of groundwater in a reservoir
- SECTION 7: use of stored groundwater from the reservoir
- SECTION 8: project schedule
- SECTION 9: within a district
- SECTION 10: remarks

### Attachments:

- Land Use Information Form with approval and signature (*must be an original*) or signed receipt
- Provide the legal description of: (1) the property from which the water is to be diverted, (2) any property crossed by the proposed ditch, canal or other work, and (3) any property on which the water is to be used as depicted on the map. Example: A copy of the deed, land sales contract or title insurance policy.
- Fees - Amount enclosed: \$ 2800 - attached Lake Co. M0510007 & M0510008  
See the Department's Fee Schedule at [www.oregon.gov/owrd](http://www.oregon.gov/owrd) or call (503) 986-0900.

### Provide a map and check that each of the following items is included:

- Permanent quality and drawn in ink
- Even map scale not less than 4" = 1 mile (example: 1" = 400 ft, 1" = 1320 ft, etc.)
- North Directional Symbol
- Township, Range, Section, Quarter/Quarter, Tax Lots
- Reference corner on map
- Location of each well, and/or dam if applicable, by reference to a recognized public land survey corner (distances north/south and east/west). Each well must be identified by a unique name and/or number.
- Indicate the area of use by Quarter/Quarter and tax lot clearly identified
- Number of acres per Quarter/Quarter and hatching to indicate area of use if for primary irrigation, supplemental irrigation, or nursery
- Location of main canals, ditches, pipelines or flumes (if well is outside of the area of use)
- Other \_\_\_\_\_

RECEIVED

NOV 28 2010

WR

OWBD  
SALEM, OREGON

# Application for a Permit to Use Ground Water



Oregon Water Resources Department  
725 Summer Street NE, Suite A  
Salem, Oregon 97301-1266  
(503) 986-0900  
www.wrd.state.or.us

RECEIVED

NOV 28 2016

SWCD  
SALMON, OREGON

## SECTION 1: APPLICANT INFORMATION AND SIGNATURE

### Applicant Information

NAME Danny I. and Laurita I. Cron		PHONE (HOM) 541 947-5164	
PHONE (WK) SAME	CELL	FAX SAME	
ADDRESS 26277 Plush Adel Rd.			
CITY Plush	STATE OR	ZIP 97637	E-MAIL*

### Organization Information

NAME Ranch as above		PHONE	FAX
ADDRESS			CELL
CITY	STATE	ZIP	E-MAIL*

### Agent Information – The agent is authorized to represent the applicant in all matters relating to this application.

AGENT BUSINESS NAME		PHONE	FAX
ADDRESS			CELL
CITY	STATE	ZIP	E-MAIL*

Note: Attach multiple copies as needed

\* By providing an e-mail address, consent is given to receive all correspondence from the department electronically. (paper copies of the final order documents will also be mailed.)

### By my signature below I confirm that I understand:

- I am asking to use water specifically as described in this application.
- Evaluation of this application will be based on information provided in the application.
- I cannot use water legally until the Water Resources Department issues a permit.
- Oregon law requires that a permit be issued before beginning construction of any proposed well, unless the use is exempt. Acceptance of this application does not guarantee a permit will be issued.
- If I get a permit, I must not waste water.
- If development of the water use is not according to the terms of the permit, the permit can be cancelled.
- The water use must be compatible with local comprehensive land-use plans.
- Even if the Department issues a permit, I may have to stop using water to allow senior water-right holders to get water to which they are entitled.



I (we) affirm that the information contained in this application is true and accurate.

Danny L. Cron  
Applicant Signature  
Laurita I. Cron  
Applicant Signature

Danny L. Cron  
Print Name and title if applicable  
Laurita L. Cron  
Print Name and title if applicable

11/21/2016  
Date  
11/21/2016  
Date

For Department Use		
App. No. <u>G1-18412</u>	Permit No. _____	Date _____

**SECTION 2: PROPERTY OWNERSHIP**

Please indicate if you own all the lands associated with the project from which the water is to be diverted, conveyed, and used.

RECEIVED

NOV 28 2016

CWRD  
SALEM, OREGON

Yes

There are no encumbrances.

This land is encumbered by easements, rights of way, roads or other encumbrances.

No

I have a recorded easement or written authorization permitting access.

I do not currently have written authorization or easement permitting access.

Written authorization or an easement is not necessary, because the only affected lands I do not own are state-owned submersible lands, and this application is for irrigation and/or domestic use only (ORS 274.040).

Water is to be diverted, conveyed, and/or used only on federal lands.

List the names and mailing addresses of all affected landowners (*attach additional sheets if necessary*).

**You must provide the legal description of: 1. The property from which the water is to be diverted, 2. Any property crossed by the proposed ditch, canal or other work, and 3. Any property on which the water is to be used as depicted on the map.**

**SECTION 3: WELL DEVELOPMENT**

WELL NO	NAME OF NEAREST SURFACE WATER	IF LESS THAN 1 MILE:	
		DISTANCE TO NEAREST SURFACE WATER	ELEVATION CHANGE BETWEEN NEAREST SURFACE WATER AND WELL HEAD
* 116	Fish Creek	320' M/L	10' M/L
** 117	Fish Creek	1000' M/L	5' M/L
NOTE: FISH CREEK SELDOM HAS ANY WATER IN IT BEING TOTALLY DRY THE PAST 4 YEARS AND CHANNEL TOTALLY DISAPPEARS ON OUT RANCH -			

Please provide any information for your existing or proposed well(s) that you believe may be helpful in evaluating your application. For existing wells, describe any previous alteration(s) or repair(s) not documented in the attached well log or other materials (*attach additional sheets if necessary*).

\* Well #116 was well #1 of Permit 6-17483 with Well Report LAKE 52694 - both Permit & Report attached -

\*\* Proposed Well #117 is about 1/2 mile northerly of existing Well #116 near the end of existing buried Mainline and near SVE PLOT - location recommended by Well Driller -

G-18412  
Revised 2/1/2012

**SECTION 3: WELL DEVELOPMENT, CONTINUED**

G-18412

Total maximum rate requested: (each well will be evaluated at the maximum rate unless you indicate well-specific rates and annual volumes in the table below). **2,77 cfs.**

The table below must be completed for each source to be evaluated or the application will be returned. If this is an existing well, the information may be found on the applicable well log. (If a well log is available, please submit it in addition to completing the table.) If this is a proposed well, or well-modification, consider consulting with a licensed well driller, geologist, or certified water right examiner to obtain the necessary information.

OWNER'S WELL NAME OR NO.	PROPOSED	EXISTING	WELL ID (WELL TAG) NO * OR WELL LOG ID**	FLOWING ARTESIAN	CASING DIAMETER	CASING INTERVALS (IN FEET)	PERFORATED OR SCREENED INTERVALS (IN FEET)	SEAL INTERVALS (IN FEET)	MOST RECENT STATIC WATER LEVEL & DATE (IN FEET)	PROPOSED USE			
										SOURCE AQUIFER***	TOTAL WELL DEPTH	WELL-SPECIFIC RATE (GPM)	ANNUAL VOLUME (ACRE-FEET)
* 116	<input type="checkbox"/>	<input checked="" type="checkbox"/>	Lake 52694	<input type="checkbox"/>	16	78	117' to 357'	78	11	Basalt	431	540	288.75
** 117	<input checked="" type="checkbox"/>	<input type="checkbox"/>		<input type="checkbox"/>	16	78		78	11	Basalt	500	703	375.91
	<input type="checkbox"/>	<input type="checkbox"/>		<input type="checkbox"/>									
	<input type="checkbox"/>	<input type="checkbox"/>		<input type="checkbox"/>									
	<input type="checkbox"/>	<input type="checkbox"/>		<input type="checkbox"/>									
	<input type="checkbox"/>	<input type="checkbox"/>		<input type="checkbox"/>									
	<input type="checkbox"/>	<input type="checkbox"/>		<input type="checkbox"/>									
	<input type="checkbox"/>	<input type="checkbox"/>		<input type="checkbox"/>									

\* Licensed drillers are required to attach a Department-supplied Well Tag, with a unique Well ID or Well Tag Number to all new or newly altered wells. Landowners can request a Well ID for existing wells that do not have one. The Well ID is intended to serve as a unique identification number for each well.  
 \*\* A well log ID (e.g. MARI 1234) is assigned by the Department to each log in the agency's well log database. A separate well log is required for each subsequent alteration of the well.  
 \*\*\* Source aquifer examples: Troutdale Formation, gravel and sand, alluvium, basalt, bedrock, etc.

\* SEE attached well report LAKE 52694 ←  
 \*\* Would anticipate similar to existing No. 116 ←  
 Revised 2/1/2012 Ground Water/5

RECEIVED  
 NOV 28 2016  
 OWRD  
 SALEM, OREGON

**SECTION 4: WATER USE**

USE	PERIOD OF USE	ANNUAL VOLUME (ACRE-FEET)
Supplemental Irr.	March 1 - Oct. 31	664.66

**Exempt Uses:** Please note that 15,000 gallons per day for single or group **domestic** purposes and 5,000 gallons per day for a single **industrial or commercial** purpose are exempt from permitting requirements.

**For irrigation use only:**

Please indicate the number of primary and supplemental acres to be irrigated (*must match map*).

Primary: \_\_\_\_\_ Acres      Supplemental: 427.7 ACRES "SEE ATTACHED CERTIFICATE NUMBERS"  
 List the Permit or Certificate number of the underlying primary water right(s): 9454, 38459, 38461, 89765  
 Indicate the maximum total number of acre-feet you expect to use in an irrigation season: 664.66

- If the use is **municipal or quasi-municipal**, attach **Form M**
- If the use is **domestic**, indicate the number of households: \_\_\_\_\_
- If the use is **mining**, describe what is being mined and the method(s) of extraction: \_\_\_\_\_

RECEIVED  
 NOV 28 2016  
 OWRD  
 SALEM, OREGON

**SECTION 5: WATER MANAGEMENT**

**A. Diversion and Conveyance**

What equipment will you use to pump water from your well(s)?

- Pump (give horsepower and type): EXISTING WELL #116 IS A 60HP TURBINE RATED AT 500 GPM - WOULD THINK PROPOSED #117 TO BE SIMILAR -
- Other means (describe): \_\_\_\_\_

Provide a description of the proposed means of diversion, construction, and operation of the diversion works and conveyance of water. TIE INTO EXISTING BURIED MAIN LINES WITH NEW BURIED MAIN LINES -

**B. Application Method**

What equipment and method of application will be used? (e.g., drip, wheel line, high-pressure sprinkler)

THE REQUESTED SUPPLEMENTAL WELLS WILL SUPPLY THREE EXISTING LOW PRESSURE CENTER PIVOTS -

**C. Conservation**

Please describe why the amount of water requested is needed and measures you propose to: prevent waste; measure the amount of water diverted; prevent damage to aquatic life and riparian habitat; prevent the discharge of contaminated water to a surface stream; prevent adverse impact to public uses of affected surface waters. THIS IS THE AMOUNT OF WATER NEEDED TO SUPPLY OUT PIVOTS IN LOW WATER YEARS FROM OUR STORED WATER

**SECTION 6: STORAGE OF GROUND WATER IN A RESERVOIR**

N/A

If you would like to store ground water in a reservoir, complete this section (*if more than one reservoir, reproduce this section for each reservoir*).

Reservoir name: \_\_\_\_\_ Acreage inundated by reservoir: \_\_\_\_\_

Uses):

Volume of Reservoir (acre-feet): \_\_\_\_\_ Dam height (feet, if excavated, write "zero"): \_\_\_\_\_

*Note: If the dam height is greater than or equal to 10.0' above land surface AND the reservoir will store 9.2 acre feet or more, engineered plans and specifications must be approved prior to storage of water.*

**SECTION 7: USE OF STORED GROUND WATER FROM THE RESERVOIR**

N/A

If you would like to use stored ground water from the reservoir, complete this section (if more than one reservoir, reproduce this section for each reservoir).

Annual volume (acre-feet):

USE OF STORED GROUND WATER	PERIOD OF USE

**SECTION 8: PROJECT SCHEDULE**

Date construction will begin: WELL No. 116 was started in 2015 and completed in 2016 - upon approval we will drill well No. 117 -

Date construction will be completed: 2018

Date beneficial water use will begin: 2019

**SECTION 9: WITHIN A DISTRICT** N/A

Check here if the point of diversion or place of use are located within or served by an irrigation or other water district.

Irrigation District Name	Address	
City	State	Zip

**SECTION 10: REMARKS**

SEE ATTACHED SHEET -

Use this space to clarify any information you have provided in the application (attach additional sheets if necessary).

RECEIVED

NOV 28 2016

OWLD  
SALEM, OREGON

WR

G-18412

**Section 10: Remarks**

Our request for supplemental Ground Water is to provide irrigation water to our three pivots in low water years. Our primary source of irrigation water is stored water from Priday Reservoir by Certificate #'s 9453 & 38458. There was not enough water to come into said Priday Reservoir to allow any irrigation water in 2014 and 2015 due to drought. There is a well by Permit G-9263 for Supplemental irrigation. The well appears to pump about 350 gpm or enough for about one fourth of the irrigated ground under pivot irrigation.

In 2015 we were granted permission to drill 2 drought related wells by Permit G-17483. One of the 2 wells was drilled and found to produce 540 gpm. The well driller recommended drilling northerly of the other well granted approval. The second location requested is about ½ mile northerly near the end of our buried mainline and near power.

**Attachments:**

1.) Permit G-17483

2.) Well log for Well#1 of Permit G-17483 being Lake 52694

RECEIVED

NOV 28 2016

OWPD  
SALEM, OREGON

G-18412



# Land Use

# Information Form



Oregon Water Resources Department  
725 Summer Street NE, Suite A  
Salem, Oregon 97301-1266  
(503) 986-0900  
www.wrd.state.or.us

## NOTE TO APPLICANTS

In order for your application to be processed by the Water Resources Department (WRD), this Land Use Information Form must be completed by a local government planning official in the jurisdiction(s) where your water right will be used and developed. The planning official may choose to complete the form while you wait, or return the receipt stub to you. Applications received by WRD without the Land Use Form or the receipt stub will be returned to you. Please be aware that your application will not be approved without land use approval.

**This form is NOT required if:**

- 1) Water is to be diverted, conveyed, and/or used only on federal lands; **OR**
- 2) The application is for a water right transfer, allocation of conserved water, exchange, permit amendment, or ground water registration modification, and **all** of the following apply:
  - a) The existing and proposed water use is located entirely within lands zoned for exclusive farm-use or within an irrigation district;
  - b) The application involves a change in place of use only;
  - c) The change does not involve the placement or modification of structures, including but not limited to water diversion, impoundment, distribution facilities, water wells and well houses; **and**
  - d) The application involves irrigation water uses only.

## NOTE TO LOCAL GOVERNMENTS

The person presenting the attached Land Use Information Form is applying for or modifying a water right. The Water Resources Department (WRD) requires its applicants to obtain land-use information to be sure the water rights do not result in land uses that are incompatible with your comprehensive plan. Please complete the form or detach the receipt stub and return it to the applicant for inclusion in their water right application. You will receive notice once the applicant formally submits his or her request to the WRD. The notice will give more information about WRD's water rights process and provide additional comment opportunities. You will have 30 days from the date of the notice to complete the land-use form and return it to the WRD. If no land-use information is received from you within that 30-day period, the WRD may presume the land use associated with the proposed water right is compatible with your comprehensive plan. Your attention to this request for information is greatly appreciated by the Water Resources Department. If you have any questions concerning this form, please contact the WRD's Customer Service Group at 503-986-0801.

RECEIVED

NOV 28 2010

OWRD  
SALEM, OREGON

G-18412

# Land Use Information Form



**Oregon Water Resources Department**  
725 Summer Street NE, Suite A  
Salem, Oregon 97301-1266  
(503) 986-0900  
www.wrd.state.or.us

Applicant: Danny and Laurita  
First
Last
Cron

Mailing Address: 26277 Plush Adel Rd.

Plush City OR State 97637 Zip Daytime Phone: 541 947-5164

## A. Land and Location

Please include the following information for all tax lots where water will be diverted (taken from its source), conveyed (transported), and/or used or developed. Applicants for municipal use, or irrigation uses within irrigation districts may substitute existing and proposed service-area boundaries for the tax-lot information requested below.

Township	Range	Section	¼ ¼	Tax Lot #	Plan Designation (e.g., Rural Residential/RR-5)	Water to be:			Proposed Land Use:
37	24			1500		<input checked="" type="checkbox"/> Diverted	<input checked="" type="checkbox"/> Conveyed	<input checked="" type="checkbox"/> Used	IRR
37	24			1400		<input checked="" type="checkbox"/> Diverted	<input checked="" type="checkbox"/> Conveyed	<input checked="" type="checkbox"/> Used	IRR
37	24			1501		<input checked="" type="checkbox"/> Diverted	<input checked="" type="checkbox"/> Conveyed	<input checked="" type="checkbox"/> Used	IRR
37	24					<input type="checkbox"/> Diverted	<input type="checkbox"/> Conveyed	<input type="checkbox"/> Used	

List all counties and cities where water is proposed to be diverted, conveyed, and/or used or developed:

Lake County

## B. Description of Proposed Use

Type of application to be filed with the Water Resources Department:

- Permit to Use or Store Water   
  Water Right Transfer   
  Permit Amendment or Ground Water Registration Modification  
 Limited Water Use License   
  Allocation of Conserved Water   
  Exchange of Water

Source of water:  Reservoir/Pond   
 Ground Water   
 Surface Water (name) \_\_\_\_\_

Estimated quantity of water needed: 2.77   
 cubic feet per second   
 gallons per minute   
 acre-feet

Intended use of water:  Irrigation   
 Commercial   
 Industrial   
 Domestic for \_\_\_\_\_ household(s)  
 Municipal   
 Quasi-Municipal   
 Instream   
 Other \_\_\_\_\_

Briefly describe:

Supplemental Irrigation of existing lands.

RECEIVED

NOV 28 2016

CWRD  
SALEM, OREGON

G-18412

**Note to applicant:** If the Land Use Information Form cannot be completed while you wait, please have a local government representative sign the receipt at the bottom of the next page and include it with the application filed with the Water Resources Department. **See bottom of Page 3.** →

RECEIVED

NOV 28 2010

CWPD  
SALEM, OREGON

G-10412

Revised 3/4/2010

Ground Water/10

WR

## For Local Government Use Only

The following section must be completed by a planning official from each county and city listed unless the project will be located entirely within the city limits. In that case, only the city planning agency must complete this form. This deals only with the local land-use plan. Do not include approval for activities such as building or grading permits.

**Please check the appropriate box below and provide the requested information**

- Land uses to be served by the proposed water uses (including proposed construction) are allowed outright or are not regulated by your comprehensive plan. Cite applicable ordinance section(s): Lake County Zoning Ordinance Article 3. (A-2 use)
- Land uses to be served by the proposed water uses (including proposed construction) involve discretionary land-use approvals as listed in the table below. (Please attach documentation of applicable land-use approvals which have already been obtained. Record of Action/land-use decision and accompanying findings are sufficient.) **If approvals have been obtained but all appeal periods have not ended, check "Being pursued."**

Type of Land-Use Approval Needed (e.g., plan amendments, rezones, conditional-use permits, etc.)	Cite Most Significant, Applicable Plan Policies & Ordinance Section References	Land-Use Approval:	
		<input type="checkbox"/> Obtained <input type="checkbox"/> Denied	<input type="checkbox"/> Being Pursued <input type="checkbox"/> Not Being Pursued
		<input type="checkbox"/> Obtained <input type="checkbox"/> Denied	<input type="checkbox"/> Being Pursued <input type="checkbox"/> Not Being Pursued
		<input type="checkbox"/> Obtained <input type="checkbox"/> Denied	<input type="checkbox"/> Being Pursued <input type="checkbox"/> Not Being Pursued
		<input type="checkbox"/> Obtained <input type="checkbox"/> Denied	<input type="checkbox"/> Being Pursued <input type="checkbox"/> Not Being Pursued
		<input type="checkbox"/> Obtained <input type="checkbox"/> Denied	<input type="checkbox"/> Being Pursued <input type="checkbox"/> Not Being Pursued

Local governments are invited to express special land-use concerns or make recommendations to the Water Resources Department regarding this proposed use of water below, or on a separate sheet.

  
 NOV 28 2010  
 CIVIC CENTER, OREGON

Name: Darwin Johnson Title: Planning Director  
 Signature: [Signature] Phone: 541-944-6036 Date: 21 Nov 2010  
 Government Entity: Lake County Planning Dept.

**Note to local government representative:** Please complete this form or sign the receipt below and return it to the applicant. If you sign the receipt, you will have 30 days from the Water Resources Department's notice date to return the completed Land Use Information Form or WRD may presume the land use associated with the proposed use of water is compatible with local comprehensive plans.

**Receipt for Request for Land Use Information**

Applicant name: \_\_\_\_\_  
 City or County: \_\_\_\_\_ Staff contact: \_\_\_\_\_  
 Signature: \_\_\_\_\_ Phone: \_\_\_\_\_ Date: \_\_\_\_\_

Date \_\_\_\_\_

(For staff use only)



Oregon Water Resources Department  
725 Summer Street NE, Suite A  
Salem, Oregon 97301-1266  
(503) 986-0900  
www.wrd.state.or.us

**WE ARE RETURNING YOUR APPLICATION FOR THE FOLLOWING REASON(S):**

- SECTION 1: \_\_\_\_\_
- SECTION 2: \_\_\_\_\_
- SECTION 3: \_\_\_\_\_
- SECTION 4: \_\_\_\_\_
- SECTION 5: \_\_\_\_\_
- SECTION 6: \_\_\_\_\_
- SECTION 7: \_\_\_\_\_
- SECTION 8: \_\_\_\_\_
- SECTION 9: \_\_\_\_\_
- Land Use Information Form \_\_\_\_\_
- Provide the legal description of: (1) the property from which the water is to be diverted, (2) any property crossed by the proposed ditch, canal or other work, and (3) any property on which the water is to be used as depicted on the map.
- Fees \_\_\_\_\_

RECEIVED  
NOV 28 2016  
OVRD  
SALEM, OREGON

**MAP**

- Permanent quality and drawn in ink
- Even map scale not less than 4" = 1 mile (example: 1" = 400 ft, 1" = 1320 ft, etc.)
- North Directional Symbol
- Township, Range, Section, Quarter/Quarter, Tax Lots
- Reference corner on map
- Location of each well, and/or dam if applicable, by reference to a recognized public land survey corner (distances north/south and east/west). Each well must be identified by a unique name and/or number.
- Indicate the area of use by Quarter/Quarter and tax lot clearly identified
- Number of acres per Quarter/Quarter and hatching to indicate area of use if for primary irrigation, supplemental irrigation, or nursery
- Location of main canals, ditches, pipelines or flumes (if well is outside of the area of use)
- Other \_\_\_\_\_

G-18412

WARRANTY DEED - STATUTORY FORM

11221447510007

INDIVIDUAL GRANTOR

Danny L. Cron and Laurita L. Cron, as tenants by the entirety Grantor, conveys and warrants to Danny L. Cron an undivided three-quarter interest and to Laurita L. Cron an undivided one-quarter interest, as tenants in common Grantee, the following described real property free of encumbrances except as specifically set forth herein situated in Lake County, Oregon, to-wit:

Lake County Tax Lots 1300, 1400, 1500, 1501, 1600, 1900, 2600, 2700 on Map 375 24E and Tax Lots 300, 500, 600 on Map 375 24E 15; Said real property being more particularly described on the attached "Exhibit A".

(IF SPACE INSUFFICIENT, CONTINUE DESCRIPTION ON REVERSE S.D.E.)

The property is free from encumbrances except

Subject to all those items of record and those apparent upon the land, if any.

The true consideration for this conveyance is \$ NONE (Here comply with the requirements of ORS 91.005) THE PURPOSE OF THIS DEED IS TO RESOLVE POTENTIAL complications with our Wills.

Dated this 23 day of April 2004

THIS INSTRUMENT WILL NOT ALLOW USE OF THE PROPERTY DESCRIBED IN THIS INSTRUMENT IN VIOLATION OF APPLICABLE LAND USE LAWS AND REGULATIONS. BEFORE SIGNING OR ACCEPTING THIS INSTRUMENT, THE PERSON ACQUIRING FEE TITLE TO THE PROPERTY SHOULD CHECK WITH THE APPROPRIATE CITY OR COUNTY PLANNING DEPARTMENT TO VERIFY APPROVED USES AND TO DETERMINE ANY LIMITS ON LAWSUITS AGAINST FARMING OR FOREST PRACTICES AS DEFINED IN ORS 30.930.

X Danny L. Cron
X Laurita L. Cron

STATE OF OREGON, County of Lake ss. April 23 2004
This instrument was acknowledged before me on
by Danny L. Cron and Laurita L. Cron



Stacie Geaney
Notary Public for Oregon
My commission expires 8-24-04

WARRANTY DEED

Danny L. Cron and Laurita L. Cron GRANTOR
Danny L. Cron & Laurita L. Cron GRANTEE
26277 Plush Adel Road
Plush, ORE 97637
GRANTEE'S ADDRESS ZIP

After recording return to:

Dan Cron
26277 Plush Adel Rd
Plush, ORE 97637

NAME, ADDRESS, ZIP

Until a change is requested, all tax statements shall be sent to the following address:

Dan Cron
26277 Plush Adel Rd
Plush, ORE 97637

NAME, ADDRESS, ZIP

STATE OF OREGON,

County of ...

I certify that the within instrument was received for record on the ... day of ... 2004, at ... o'clock ... M., and recorded in book/reel/volume No. ... or page ... or as fee/file instrument/microfilm/reception No. ... Record of Deeds of said County.

Witness my hand and seal of County affixed.

NAME TITLE

By ... Deputy

SPACE RESERVED FOR RECORDER'S USE

RECEIVED

NOV 28 2010

CLERK OF COUNTY SALEM, OREGON

EXHIBIT "A"

The following described parcels located in the County of Lake, State of Oregon:

Township 37 South, Range 24 East of the Willamette Meridian

Section 8: Government Lots 1, 2, 6, 7, and 8

Section 9: Government Lot 11; the S 1/2 of the NE 1/4 of the SW 1/4; the W 1/2 of the SW 1/4; the SE 1/4 of the SW 1/4; the N 1/2 of the SW 1/4 of the SE 1/4; Government Lots 1, 2, 3, 4, and 5

Section 16: The NW 1/4 and the NE 1/4

Section 21: The W 1/2 of the SW 1/4

Section 15: The W 1/2 of the NW 1/4; the SE 1/4 of the NW 1/4; the SW 1/4 EXCEPT the SW 1/4 of the SW 1/4 of the SW 1/4; the S 1/2 of Government Lot 4; the SE 1/4 of the SE 1/4; the W 1/2 of the SE 1/4 EXCEPT the NE 1/4 of the SW 1/4 of the SE 1/4 and ALSO EXCEPT the SE 1/4 of the NW 1/4 of the SE 1/4.

All Water Rights that go with the above described parcels.

ALSO All Grazing Permits that go with the above described parcels.

State of Oregon } Reel 51  
County of Lake } ss. File 7

I hereby certify that the within instrument was received and filed for record on the 23 day of April 20 04 at 2:10 o'clock P. M. and recorded on page 740 in book 261 record of Deed of said County  
Stacie Seamy  
County Clerk  
By \_\_\_\_\_ Deputy

RECEIVED

NOV 28 2013

CLERK  
SARAH GILSON

STATE OF OREGON WATER SUPPLY WELL REPORT

LAKE 52694

WELL I.D. LABEL# L 120022

START CARD # 1029089

2/25/2016

ORIGINAL LOG #

(as required by ORS 537.765 & OAR 690-205-0210)

(1) LAND OWNER

Owner Well I.D.

First Name DANNY L. Last Name CRON
Company LAURITA L. CRON
Address 26277 PLUSH ADEL RD.
City PLUSH State OR Zip 97637

(2) TYPE OF WORK

[X] New Well [ ] Deepening [ ] Conversion

[ ] Alteration (complete 2a & 10) [ ] Abandonment (complete 5a)

(2a) PRE-ALTERATION

Casing: Dia + From To Gauge Stl Plstc Wld Thrd
Material From To Amt sacks/lbs
Seal:

(3) DRILL METHOD

[X] Rotary Air [ ] Rotary Mud [ ] Cable [ ] Auger [ ] Cable Mud
[ ] Reverse Rotary [ ] Other

(4) PROPOSED USE

[ ] Domestic [X] Irrigation [ ] Community
[ ] Industrial/ Commercial [ ] Livestock [ ] Dewatering
[ ] Thermal [ ] Injection [ ] Other

(5) BORE HOLE CONSTRUCTION

Special Standard [ ] (Attach copy)

Depth of Completed Well 431.00 ft.

BORE HOLE

SEAL

Table with columns: Dia, From, To, Material, From, To, Amt, lbs. Rows include Bentonite Chips and Cement.

How was seal placed: Method [ ] A [ ] B [X] C [ ] D [ ] E

[X] Other POURED DRY

Backfill placed from ft. to ft. Material

Filter pack from ft. to ft. Material Size

Explosives used: [ ] Yes Type Amount

(5a) ABANDONMENT USING UNHYDRATED BENTONITE

Proposed Amount Actual Amount

(6) CASING/LINER

Table with columns: Casing, Liner, Dia, From, To, Gauge, Stl, Plstc, Wld, Thrd. Includes graphical representation of casing sections.

Shoe [ ] Inside [ ] Outside [ ] Other Location of shoe(s)

Temp casing [ ] Yes Dia From To

(7) PERFORATIONS/SCREENS

Perforations Method plasma cutter

Screens Type Material

Table with columns: Perf/, Casing/ Screen, Dia, From, To, width, length, # of slots, Telc/ pipe size.

(8) WELL TESTS: Minimum testing time is 1 hour

[ ] Pump [ ] Bailer [X] Air [ ] Flowing Artesian

Table with columns: Yield gal/min, Drawdown, Drill stem/Pump depth, Duration (hr). Row 1: 750, 220, 2.

Temperature 63 °F Lab analysis [ ] Yes By

Water quality concerns? [ ] Yes (describe below) TDS amount

Table with columns: From, To, Description, Amount, Units. Includes date stamp: NOV 28 2016

(9) LOCATION OF WELL (legal description)

County LAKE Twp 37.00 S N/S Range 24.00 E E/W WM
Sec 16 NW 1/4 of the NW 1/4 Tax Lot 1500
Tax Map Number Lot
Lat ' " or DMS or DD
Long ' " or DMS or DD
[ ] Street address of well [X] Nearest address

26277 PLUSH ADEL RD.
PLUSH, OR.

(10) STATIC WATER LEVEL

Table with columns: Date, SWL(psi), SWL(ft). Row 1: 2/12/2016, 11.

WATER BEARING ZONES

Depth water was first found 65.00

Table with columns: SWL Date, From, To, Est Flow, SWL(psi), SWL(ft). Row 1: 2/12/2016, 65, 425, 750, 11.

(11) WELL LOG

Ground Elevation

Table with columns: Material, From, To. Lists geological layers like topsoil, sandy clay, basalt, etc.

Date Started 12/14/2015 Completed 2/11/2016

(unbonded) Water Well Constructor Certification

I certify that the work I performed on the construction, deepening, alteration, or abandonment of this well is in compliance with Oregon water supply well construction standards.

License Number 1940 Date 2/25/2016

Signed BENJAMIN FRY (E-filed)

(bonded) Water Well Constructor Certification

I accept responsibility for the construction, deepening, alteration, or abandonment work performed on this well during the construction dates reported above.

License Number 1355 Date 2/25/2016

Signed ARTHUR L FRY (E-filed)

Contact Info (optional)





STATE OF OREGON

COUNTY OF LAKE

PERMIT TO APPROPRIATE THE PUBLIC WATERS

THIS PERMIT IS HEREBY ISSUED TO

DANNY L CRON  
LAURITA L CRON  
26277 PLUSH ADEL RD  
PLUSH, OR 97637

**This permit expires on October 31, 2015, or when the Governor's March 16, 2015 declaration of drought emergency for Lake County is terminated, whichever comes first.**

**The permittee assumes all liability associated with use of water under the permit in the event claims of injury or claims for compensation are filed.**

**If injury to existing rights or detriment to the public interest is observed, the Department may regulate water use under this permit to mitigate such injury or detriment, or cancel this permit if mitigation is not possible.**

The specific limits and conditions of the use are listed below.

APPLICATION FILE NUMBER: G-18119

SOURCE OF WATER: WELL 1 AND WELL 2 IN FISH CREEK BASIN

PURPOSE OR USE: SUPPLEMENTAL IRRIGATION OF 427.7 ACRES

MAXIMUM RATE: 2.0 CUBIC FEET PER SECOND

PERIOD OF USE: PERMIT ISSUANCE THROUGH OCTOBER 31

DATE OF PRIORITY: JULY 23, 2015

WELL LOCATIONS:

WELL 1: NW ¼ NW ¼, SECTION 16, T37S, R24E, W.M.; 80 FEET SOUTH AND 1330 FEET WEST FROM N¼ CORNER, SECTION 16

WELL 2: NE ¼ NW ¼, SECTION 16, T37S, R24E, W.M.; 50 FEET SOUTH AND 1170 FEET WEST FROM N¼ CORNER, SECTION 16

This right is limited to any deficiency in the available supply of any prior right existing for the same land.

RECEIVED  
NOV 28 2015  
OWRD  
SALEM, OREGON

The use shall conform to such reasonable rotation system as may be ordered by the proper state officer.

The amount of water used for irrigation under this right, together with the amount secured under any other right existing for the same lands, is limited to a diversion of ONE-EIGHTIETH of one cubic foot per second and 3.0 acre-feet for each acre irrigated during the irrigation season of each year.

THE PLACE OF USE IS LOCATED AS FOLLOWS:

- NE ¼ NE ¼ 30.9 ACRES
- SE ¼ NE ¼ 38.6 ACRES
- NE ¼ SE ¼ 33.0 ACRES
- SE ¼ SE ¼ 16.5 ACRES

SECTION 8

- NW ¼ NW ¼ 41.0 ACRES
- SW ¼ NW ¼ 40.0 ACRES
- SE ¼ NW ¼ 0.4 ACRES
- NE ¼ SW ¼ 27.4 ACRES
- NW ¼ SW ¼ 38.2 ACRES
- SW ¼ SW ¼ 38.0 ACRES
- SE ¼ SW ¼ 36.8 ACRES

SECTION 9

- NE ¼ NW ¼ 37.9 ACRES
- NW ¼ NW ¼ 29.7 ACRES
- SW ¼ NW ¼ 3.9 ACRES
- SE ¼ NW ¼ 15.4 ACRES

SECTION 16

TOWNSHIP 37 SOUTH, RANGE 24 EAST, W.M.

RECEIVED  
 NOV 28 2016  
 OWRD  
 SALEM, OREGON

Measurement, recording and reporting conditions:

- A. Before water use may begin under this permit, the permittee shall install a totalizing flow meter at each point of appropriation. The permittee shall maintain the meter in good working order.
- B. The permittee shall keep a complete record of the amount of water used each month, and shall submit a report which includes the recorded water use measurements to the Department by November 15, 2015. Further, the Director may require the permittee to report general water-use information, including the place and nature of use of water under the permit.
- C. The permittee shall allow the watermaster access to the meter; provided however, where any meter is located within a private

structure, the watermaster shall request access upon reasonable notice.

- D. The Director may provide an opportunity for the permittee to submit alternative measuring and reporting procedures for review and approval.

Prior to use, the well(s) shall be configured to allow strictly clean water (no oil) static water level measurements with an electric-tape. That can include measurement access via an unobstructed vertical discharge pipe that allows the groundwater level to fluctuate freely within the discharge pipe (no valves, etc.). Otherwise, a dedicated measuring tube must be installed prior to use. The tube must be unobstructed, have a diameter of 3/4 inch (0.75 inch) or greater, and pursuant to figure 200-5 in OAR 690-200.

The static ground water level at the well(s) must be measured to the nearest 0.10 foot (one-inch), recorded and reported to the Department within 7 days prior to groundwater production under this permit, and subsequently measured to the nearest 0.10 foot (one-inch), recorded and reported to the Department at the end of groundwater production. The last measurement must be reported to the Department by November 15, 2015.

All well(s) under this permit shall comply with existing well construction standards. Groundwater production shall occur solely from the predominantly volcanic-basalt rocks and sediment unit below the predominantly basin-fill sediment unit by having at minimum continuous casing and continuous seal from land surface to a depth below the predominantly basin-fill sediment unit (five-feet or more in the the underlying predominantly volcanic-basalt rocks and sediment unit).

Within one month from the start of use of water from any well listed on this permit, the permittee shall ensure that the well has been assigned an OWRD Well Identification Number (Well ID tag), which shall be permanently attached to the well. The Well ID shall be used as a reference in any correspondence regarding the well, including any reports of water use, water level, or pump test data.

#### **STANDARD CONDITIONS**

Failure to comply with any of the provisions of this permit may result in action including, but not limited to, restrictions on the use, civil penalties, or cancellation of the permit.

If the number, location, source, or construction of any well deviates from that proposed in the permit application or required by permit conditions, this permit may be subject to cancellation, unless the Department authorizes the change in writing.

If substantial interference with a senior water right occurs due to withdrawal of water from any well listed on this permit, then use of water from the well(s) shall be discontinued or reduced and/or the schedule of withdrawal shall be regulated until or unless the Department approves or implements an alternative administrative action to mitigate the interference. The Department encourages junior and senior appropriators to jointly develop plans to mitigate interferences.

The well(s) shall be constructed in accordance with the General Standards for the Construction and Maintenance of Water Wells in Oregon. The works shall be equipped with a usable access port, and may also include an air line and pressure gauge adequate to determine water level elevation in the well at all times.

This permit is for the beneficial use of water without waste. The water user is advised that new regulations may require the use of best practical technologies or conservation practices to achieve this end.

By law, the land use associated with this water use must be in compliance with statewide land-use goals and any local acknowledged land-use plan.

Issued July 31, 2015

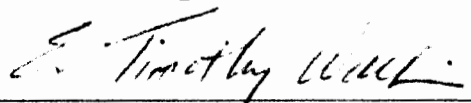

for Thomas M. Byler, Director

*Note: The Director may require the applicant to submit a plan and evidence showing conservation and water use curtailment measures have been taken before use is made of an emergency use permit.*

*Issuance of this permit does not confirm the validity of any underlying right or claim.*

RECEIVED  
NOV 28 2015  
CWPD  
SALEM, OREGON



STATE OF OREGON

COUNTY OF

CERTIFICATE OF WATER RIGHT

This is to Certify, That E. A. FRIDAY AND HELEN L. PRIDAY

of Lakeview, State of Oregon has a right to the use of the waters of Fish Creek

for the purpose of Irrigation of 121.5 acres

and that said right has been confirmed by decree of the Circuit Court of the State of Oregon for Lake County, and the said decree entered of record at Salem, in the Order Record of the STATE ENGINEER, in Volume 10, at page 227; that the priority of the right thereby confirmed dates from 1907

that the amount of water to which such right is entitled, for the purposes aforesaid, is limited to an amount actually beneficially used for said purposes, and shall not exceed one-fortieth of a cubic foot per second per acre of land irrigated prior to June 15th, and one-eightieth of a cubic foot per second per acre of land irrigated after June 15th, of each year, with a total limitation during each irrigation season of three acre feet per acre.

A description of the lands irrigated under such right, and to which the water is appurtenant (or, if for other purposes, the place where such water is put to beneficial use), is as follows:

- 27.0 acres in SE 1/4 NE 1/4
- 35.0 acres in NE 1/4 SE 1/4
- 16.5 acres in SE 1/4 SE 1/4
- Section 8,
- 5.0 acres in NW 1/4 SW 1/4
- 20.0 acres in SW 1/4 SW 1/4
- 20.0 acres in SE 1/4 SE 1/4
- Section 9,
- T. 37 S., R. 24 E., W. 4.

(NOTE: Direct flow of Fish Creek and water stored in Friday Reservoir.)

And said right shall be subject to all other conditions and limitations contained in said decree.

The right to the use of the water for irrigation purposes is restricted to the lands or place of use herein described.

WITNESS the signature of the State Engineer,

affixed this 31st day of December, 1931

CHAS. E. STRICKLIN

State Engineer.

RECEIVED

NOV 28 2016

CIVIL DIVISION SALEM, OREGON

Recorded in State Record of Water Right Certificates, Volume 9, page 9454.

STATE OF OREGON  
COUNTY OF LAKE

CERTIFICATE OF WATER RIGHT

This Is to Certify, That JERRY BARRY, JR.

of P. O. Box 5, Lakeview, State of Oregon, has made proof to the satisfaction of the STATE ENGINEER of Oregon, of a right to the use of the waters of Friday Reservoir enlarged under application number R-34473, permit number R-2582 a tributary of Fish Creek, North Warner Valley for the purpose of supplemental irrigation of 401.5 acres under Permit No. 27163 of the State Engineer, and that said right to the use of said waters has been perfected in accordance with the laws of Oregon; that the priority of the right hereby confirmed dates from January 30, 1961

that the amount of water to which such right is entitled and hereby confirmed, for the purposes aforesaid, is limited to an amount actually beneficially used for said purposes, and shall not exceed 1,204.5 acre feet stored water only

or its equivalent in case of rotation, measured at the point of diversion from the stream. The point of diversion is located in the SW 1/4 Sec. 21, T. 37 S., R. 24 E., N. M. Diversion point located: 1120 feet East and 130 feet North from SW Corner, Section 21.

The amount of water used for irrigation, together with the amount secured under any other right existing for the same lands, shall be limited to a diversion of ~~not to exceed~~ 1,204.5 acre feet for each acre irrigated during the irrigation season of each year and shall be further limited to a total diversion of not to exceed 1,204.5 acre feet per year,

and shall conform to such reasonable rotation system as may be ordered by the proper state officer.

A description of the place of use under the right hereby confirmed, and to which such right is appurtenant, is as follows:

12.6 acres Lot 1 (NW 1/4 NE 1/4)  
18.3 acres Lot 2 (NE 1/4 NE 1/4)  
38.6 acres Lot 6 (SW 1/4 NE 1/4)  
33.0 acres Lot 7 (NE 1/4 SE 1/4)  
16.5 acres Lot 8 (SE 1/4 SE 1/4)  
Section 8

40.0 acres Lot 11 (NW 1/4 NW 1/4)  
6.0 acres Lot 11 (SW 1/4 NW 1/4)  
0.4 acre Lot 2 (SW 1/4 NW 1/4)  
27.4 acres Lot 3 (NE 1/4 SW 1/4)  
38.2 acres NW 1/4 SW 1/4  
38.0 acres SW 1/4 SW 1/4  
36.8 acres SE 1/4 SW 1/4  
1.5 acres Lot 4 (NW 1/4 SE 1/4)  
3.7 acres SW 1/4 SE 1/4  
Section 9

RECEIVED

NOV 28 2016

OWEN  
SALES, OREGON



0.7 acre NW 1/4 NE 1/4  
37.9 acres NW 1/4 NW 1/4  
29.7 acres NW 1/4 NE 1/4  
3.9 acres SW 1/4 NW 1/4  
15.4 acres SW 1/4 NE 1/4  
Section 16

0.5 acre NE 1/4 NE 1/4  
Section 17  
T. 37 S., R. 24 E., W. 1 E.

RECEIVED  
NOV 28 2016  
OWSD  
SALEM, OREGON

The right to the use of the water for the purposes aforesaid is restricted to the lands or place of use herein described.

WITNESS the signature of the State Engineer, affixed  
this 18 day of August, 19 72

CHRIS L. WHEELER  
State Engineer

Recorded in State Record of Water Right Certificates, Volume 30, page 38459

STATE OF OREGON  
 COUNTY OF LAKE

CERTIFICATE OF WATER RIGHT

This Is to Certify, That JERRY BARRY, JR.

of P. O. Box 5, Lakeview, State of Oregon, has made proof to the satisfaction of the STATE ENGINEER of Oregon, of a right to the use of the waters of Fish Creek a tributary of Hart Lake for the purpose of irrigation of 280.0 acres under Permit No. 24627 of the State Engineer, and that said right to the use of said waters has been perfected in accordance with the laws of Oregon; that the priority of the right hereby confirmed dates from February 4, 1957

that the amount of water to which such right is entitled and hereby confirmed, for the purposes aforesaid, is limited to an amount actually beneficially used for said purposes, and shall not exceed 7.0 cubic feet per second

or its equivalent in case of rotation, measured at the point of diversion from the stream. The point of diversion is located in the SW<sup>1</sup>/<sub>4</sub>, SW<sup>1</sup>/<sub>4</sub>, Section 16, SE<sup>1</sup>/<sub>4</sub>, NE<sup>1</sup>/<sub>4</sub>, Section 17, T. 37 S., R. 24 E., W. 1/2. Diversion points located: 1630 feet South and 250 feet East; 580 feet North and 70 feet West; both from W<sup>1</sup>/<sub>2</sub> Corner, Section 16.

The amount of water used for irrigation, together with the amount secured under any other right existing for the same lands, shall be limited to one-fortieth of one cubic foot per second per acre, or its equivalent for each acre irrigated and shall be further limited to a diversion of not to exceed 3 acre feet per acre for each acre irrigated during the irrigation season of each year,

and shall conform to such reasonable rotation system as may be ordered by the proper state officer. A description of the place of use under the right hereby confirmed, and to which such right is appurtenant, is as follows:

- 12.6 acres Lot 1 (NE<sup>1</sup>/<sub>4</sub>, NE<sup>1</sup>/<sub>4</sub>)
- 18.3 acres Lot 2 (NE<sup>1</sup>/<sub>4</sub>, NE<sup>1</sup>/<sub>4</sub>)
- 11.6 acres Lot 6 (SE<sup>1</sup>/<sub>4</sub>, NE<sup>1</sup>/<sub>4</sub>)
- Section 8
- 40.0 acres Lot 11 (NW<sup>1</sup>/<sub>4</sub>, NW<sup>1</sup>/<sub>4</sub>)
- 8.0 acres Lot 11 (SW<sup>1</sup>/<sub>4</sub>, NW<sup>1</sup>/<sub>4</sub>)
- 0.4 acre Lot 2 (SE<sup>1</sup>/<sub>4</sub>, NW<sup>1</sup>/<sub>4</sub>)
- 27.4 acres Lot 3 (NE<sup>1</sup>/<sub>4</sub>, SW<sup>1</sup>/<sub>4</sub>)
- 33.2 acres NW<sup>1</sup>/<sub>4</sub>, SW<sup>1</sup>/<sub>4</sub>
- 18.0 acres SW<sup>1</sup>/<sub>4</sub>, SW<sup>1</sup>/<sub>4</sub>
- 16.8 acres SE<sup>1</sup>/<sub>4</sub>, SW<sup>1</sup>/<sub>4</sub>
- 1.5 acres Lot 4 (NW<sup>1</sup>/<sub>4</sub>, SE<sup>1</sup>/<sub>4</sub>)
- 3.7 acres SW<sup>1</sup>/<sub>4</sub>, SE<sup>1</sup>/<sub>4</sub>
- Section 9

RECEIVED  
 NOV 28 2013  
 STATE OF OREGON

0.7 acre NW $\frac{1}{4}$  NE $\frac{1}{4}$   
37.9 acres NE $\frac{1}{4}$  NW $\frac{1}{4}$   
29.7 acres NW $\frac{1}{4}$  NW $\frac{1}{4}$   
3.9 acres SW $\frac{1}{4}$  NW $\frac{1}{4}$   
15.4 acres SE $\frac{1}{4}$  NW $\frac{1}{4}$   
Section 16

0.9 acre NE $\frac{1}{4}$  NE $\frac{1}{4}$   
Section 17  
T. 37 S., R. 24 E., W. E.

RECEIVED  
NOV 28 2013  
SALES

The right to the use of the water for the purposes aforesaid is restricted to the lands or place of use herein described.

WITNESS the signature of the State Engineer, affixed

this 18 day of August, 1972

CHRIS L. WHEELER  
State Engineer

Recorded in State Record of Water Right Certificates, Volume 30, page 384<sub>61</sub>

STATE OF OREGON

COUNTY OF LAKE

CERTIFICATE OF WATER RIGHT

THIS CERTIFICATE ISSUED TO

DANNY L CRON AND LAURITA L CRON  
26277 PLUSH-ADEL RD  
PLUSH OREGON 97637

confirms the right to use the waters of PRIDAY RESERVOIR, CONSTRUCTED UNDER PERMIT R-2582, for IRRIGATION of 33.0 ACRES.

This right was perfected under Permit S-45719. The date of priority is MARCH 10, 1981. The amount of water to which this right is entitled is limited to an amount actually used beneficially, and shall not exceed 99.0 ACRE FEET or its equivalent in case of rotation, measured at the point of diversion.

The point of diversion is located as follows:

Twp	Rng	Mer	Sec	Q-Q	Measured Distances
37 S	24 E	WM	21	SW SW	130 FEET NORTH AND 1120 FEET EAST FROM SW CORNER, SECTION 21

The amount of water used for irrigation, together with the amount secured under any other right existing for the same lands, is limited to a diversion of not to exceed 3.0 acre-feet for each acre irrigated during the irrigation season of each year.

A description of the place of use is as follows:

Twp	Rng	Mer	Sec	Q-Q	GLot	Acres
37 S	24 E	WM	9	NW NW	11	1.0
37 S	24 E	WM	9	SW NW	1	32.0

The right to the use of the water for the above purpose is restricted to beneficial use on the lands or place of use described.

**JAN 23 2015**

Issued \_\_\_\_\_

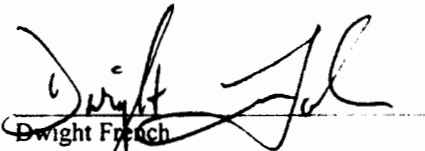

Dwight French  
Water Right Services Division Administrator, for  
Thomas M. Byler, Director  
Oregon Water Resources Department

RECEIVED  
NOV 28 2015  
OFFICE  
SALES, OREGON

**NOTICE OF RIGHT TO PETITION FOR RECONSIDERATION OR JUDICIAL REVIEW**

This is an order in other than a contested case. This order is subject to judicial review under ORS 183.484 and ORS 536.075. Any petition for judicial review must be filed within the 60-day time period specified by ORS 183.484(2). Pursuant to ORS 183.484, ORS 536.075 and OAR 137-004-0080, you may petition for judicial review and petition the Director for reconsideration of this order. A petition for reconsideration may be granted or denied by the Director, and if no action is taken within 60 days following the date the petition was filed, the petition shall be deemed denied. In addition, under ORS 537.260 any person with an application, permit or water right certificate subsequent in priority may jointly or severally contest the issuance of the certificate within three months after issuance of the certificate.

17 70111

# T.37S.R.24E.W.M.

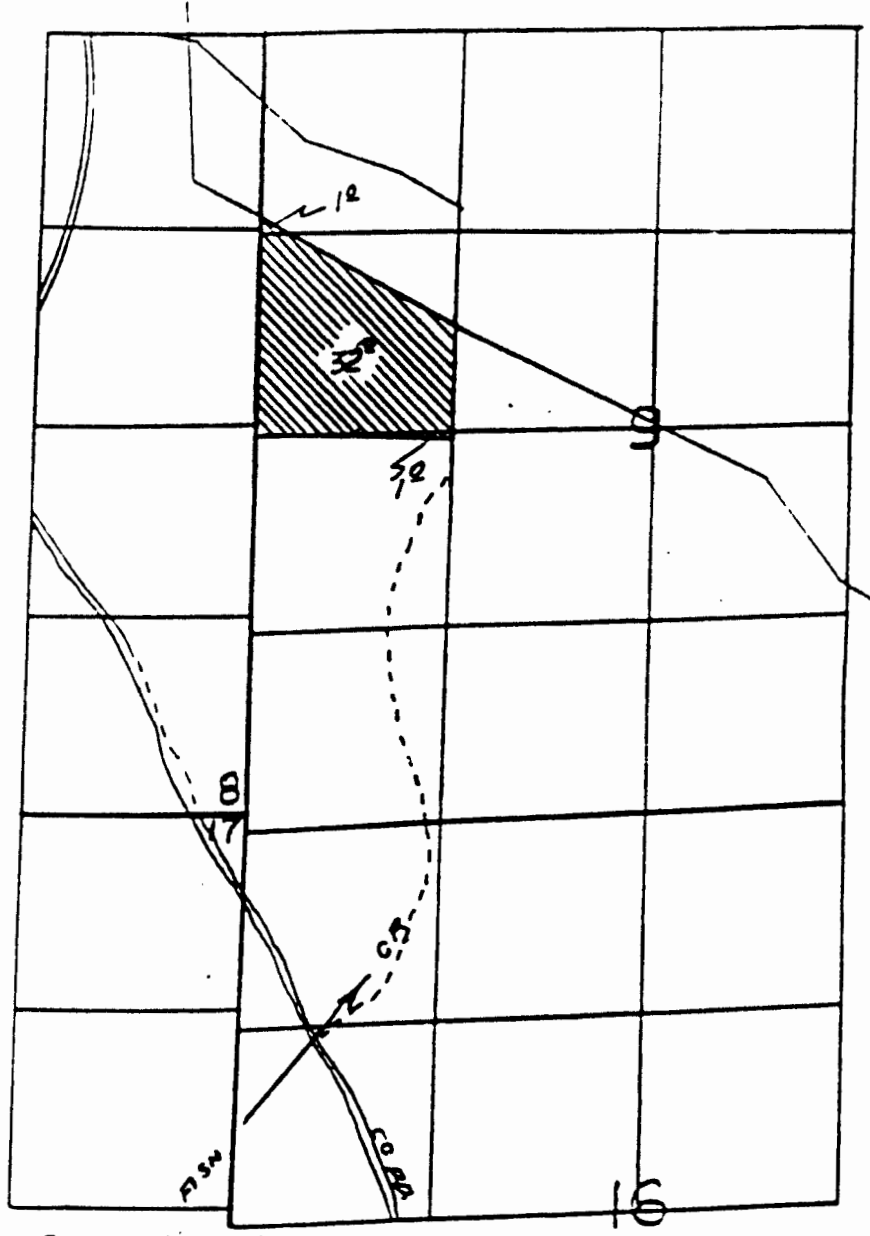
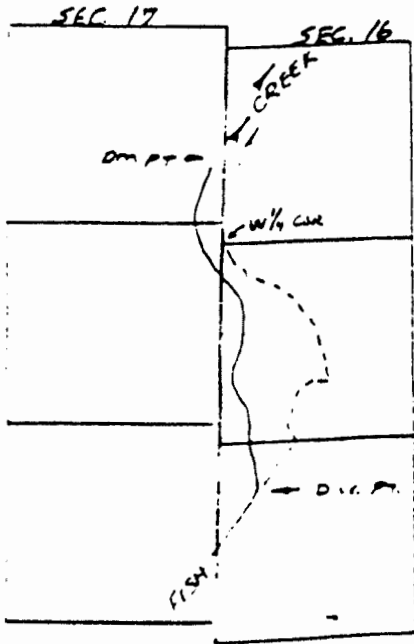

Scale - 4" = 1 M.

Application No. 61334  
 Permit No. 45719

All information on this map furnished by applicant

Lawrence Ryan  
 Applicant:

RECEIVED

NOV 28 2015

618418  
 CIVIL ENGINEER  
 SALEM, OREGON  
 VISIT PAGE 3

see letter to  
 of water  
 numbered 3976.5  
 dated 1/23/2015

RECEIVED

NOV 20 1984

WATER RESOURCES DEPT  
 SALEM, OREGON

STATE OF OREGON

COUNTY OF LAKE

CERTIFICATE OF WATER RIGHT

This is to Certify, That E. A. FRIDAY

of Lakeview, State of Oregon has a right to the use of the waters of Fish Creek

for the purpose of storage of 1000 acre feet in Friday Reservoir for irrigation

and that said right has been confirmed by decree of the Circuit Court of the State of Oregon for Lake County, and the said decree entered of record at Salem, in the Order Record of the STATE ENGINEER, in Volume 10, at page 227; that the priority of the right thereby confirmed dates from 1907

that the amount of water to which such right is entitled, for the purposes aforesaid, is limited to an amount actually beneficially used for said purposes, and shall not exceed one-fortieth of a cubic foot per second per acre of land irrigated prior to June 15th, and one-eightieth of a cubic foot per second per acre of land irrigated after June 15th, of each year, with a total limitation during each irrigation season of three acre feet per acre.

A description of the lands irrigated under such right, and to which the water is appurtenant (or, if for other purposes, the place where such water is put to beneficial use), is as follows:

- 27.0 acres in SE-NE
- 35.0 acres in NE-SE
- 18.5 acres in SE-SE
- Section 8,
- 5.0 acres in NW-SW
- 20.0 acres in SW-SW
- 20.0 acres in SE-SW
- Section 9,
- Township 37 South, Range 24 East, W. M.

And said right shall be subject to all other conditions and limitations contained in said decree.

The right to the use of the water for irrigation purposes is restricted to the lands or place of use herein described.

WITNESS the signature of the State Engineer,

affixed this 21st day

of December, 1931

Storage

CHAS. F. STICKLIN

State Engineer.

Recorded in State Record of Water Right Certificates, Volume 9, page 9455.

RECEIVED

NOV 28 2010

SALEM, OREGON

G-18412

STATE OF OREGON

COUNTY OF LAKE

CERTIFICATE OF WATER RIGHT

This Is to Certify, That JERRY BERRY, JR.

of P. O. Box 5, Lakeview, State of Oregon, has made proof

to the satisfaction of the STATE ENGINEER of Oregon, of a right to store the waters of Fish Creek, tributary of Hart Lake, appropriated under application number 34587, permit number 27163, in enlargement of Friday Reservoir

irrigation for the purposes of

under Reservoir Permit No. R-2582 of the State Engineer, and that said right to store said waters has been perfected in accordance with the laws of Oregon; that the priority of the right hereby confirmed dates from November 23, 1960

that the amount of water entitled to be stored each year under such right, for the purposes aforesaid, shall not exceed 1500 acre feet

The reservoir is located in

NE 1/4 SW 1/4
SW 1/4 SW 1/4
SE 1/4 SW 1/4
NE 1/4 SE 1/4
SW 1/4 SE 1/4
SE 1/4 SE 1/4

Section 21

Lot 1 (NE 1/4 NE 1/4)
Lot 2 (NW 1/4 NE 1/4)
SW 1/4 NE 1/4
Lot 3 (NE 1/4 NW 1/4)
Lot 4 (NW 1/4 NW 1/4)

SE 1/4 NW 1/4
NW 1/4 SE 1/4

Section 28

T. 37 S., R. 24 E., S. H.

WITNESS the signature of the State Engineer, affixed this date. August 18, 1972

CHRIS L. WINDLER

State Engineer

Recorded in State Record of Water Right Certificates, Volume 30, page 38458

RECEIVED

NOV 28 2013

SALES

G-18412



**Oregon Water Resources Department**  
**Apply for a Permit to Appropriate Ground Water and/or Store Ground Water**

- [Main](#)
- [Help](#)
- [Return](#)
- [Contact Us](#)

Today's Date: Friday, November 18, 2016

Base Application Fee for use of Ground, Surface and optionally Stored Water.		\$1,150.00
Number of proposed cubic feet per second (cfs) to be appropriated. (1 cfs = 448.83 gallons per minute)	3	\$900.00
Number of proposed Use's for the appropriated water. (i.e. Irrigation, Supplemental Irrigation, Pond Maintenance, Industrial, Commercial, etc) *	1	
Number of proposed Ground Water points of appropriation. (i.e. number of wells) (include all injection wells, if applicable) **	2	\$300.00
Number of Acre Feet to be stored in a reservoir/pond from Ground Water.	0	
Number of Acre Feet to be appropriated from reservoir/pond (Only Applies to reservoir/pond constructed under Ground Water Application)	0	
Number of reservoirs.	0	
Permit Recording Fee. ***		\$450.00
* the 1st Water Use is included in the base cost. ** the 1st Ground Water point of appropriation is included in the base cost. *** the Permit Recording Fee is not required when the application is submitted but, must be paid before a permit will be issued. It is fully refundable if a permit is not issued. If the recording fee is not paid prior to issuance of the Final Order, permit issuance will be delayed.	Recalculate	
Estimated cost of Permit Application		\$2,800.00

OWRD Fee Schedule

Fee Calculator Version B20130709

1/18/16

RECEIVED

NOV 28 2016

OWRD  
SALEM, OREGON