

T.3S. R.2W. Sec. 35 & T.4S. R.2W. Sec. 2, W.M.

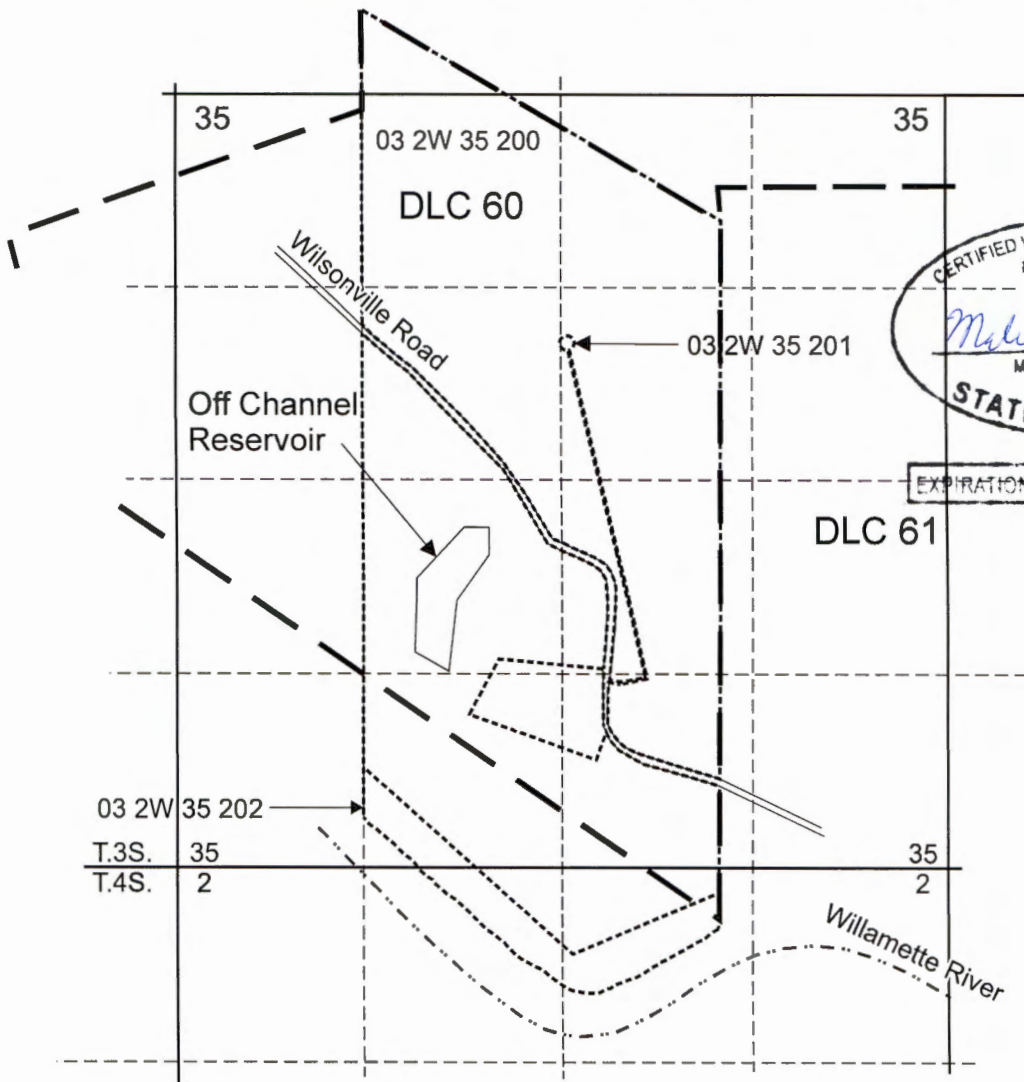

CERTIFIED WATER RIGHTS EXAMINER
#60772WRE
Malia R. Kupillas
MALIA R. KUPILLAS
JUNE 08, 1998
STATE OF OREGON

EXPIRATION DATE 6/30/2017

Proposed Reservoir is located within NESW and SESW, Section 35.

Center of reservoir is located 1,840 feet north and 860 feet west from the N1/4 Corner, Section 2.

Volume of stored water in Proposed Reservoir is 9.0 Acre Feet.

----- Tax lot boundary

RECEIVED

JAN 17 2017

OWRD

Scale: 1" = 1,320'



This map was prepared for the purpose of identifying the location of a water right only and is not intended to provide legal dimensions or location of property ownership lines.



Alternate Reservoir Application Map

Doration Farms, LLC C/O Harry Miller
T.3S. R.2W. Sec. 35, &
T.4S. R.2W. Sec. 2, W.M.

Pacific Hydro-Geology Inc.

2016-bgp

Doration_Miller

Doration