

RECEIVED
STATE ENGINEER
SALEM, OREGON

T3S R45E W.M.

Boundary of
Proposed use

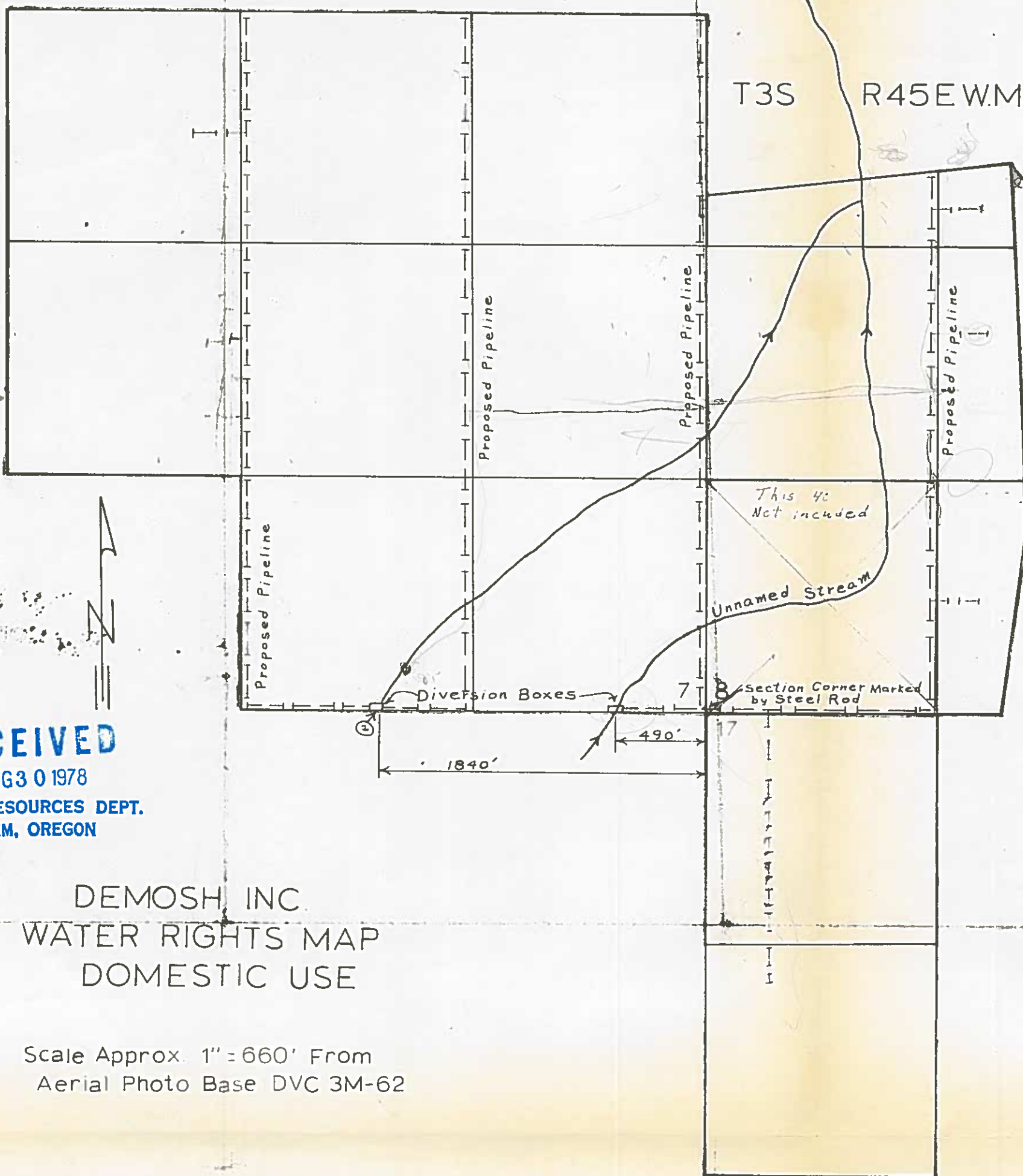

RECEIVED

AUG 30 1978

WATER RESOURCES DEPT.
SALEM, OREGON

DEMOSH, INC.
WATER RIGHTS MAP
DOMESTIC USE

Scale Approx. 1" = 660' From
Aerial Photo Base DVC 3M-62

Application No. 218348
36249

FC