

T.2N. R.1W. Sec. 9, 10, 15 & 16, W.M.

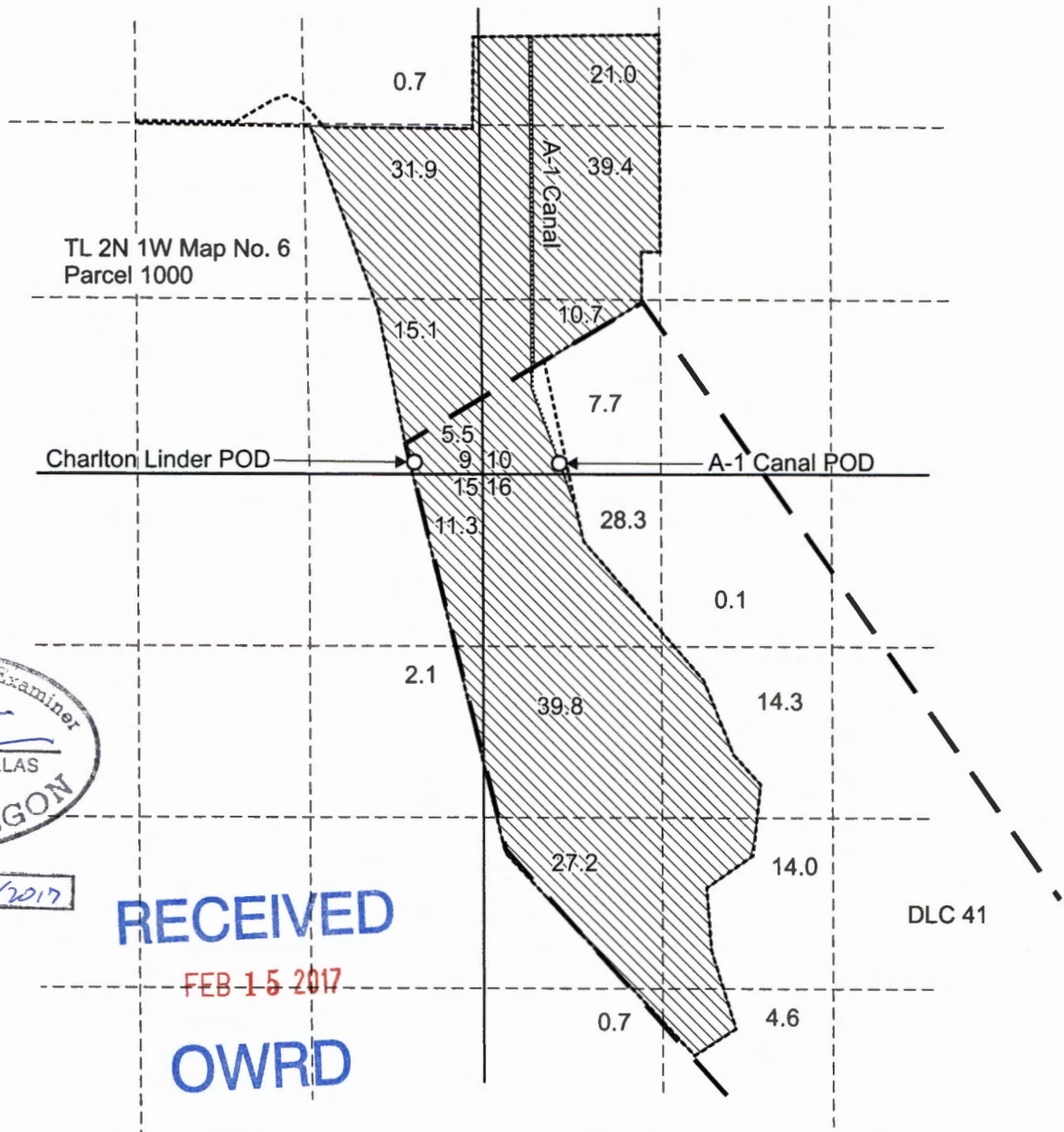

TL 2N 1W Map No. 6
Parcel 1000

Charlton Linder POD

A-1 Canal POD

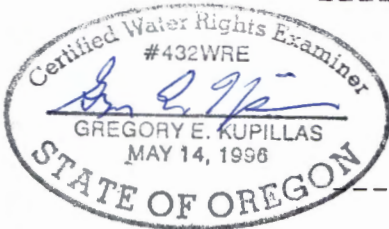

EXPIRATION DATE: 6/30/2017

RECEIVED

FEB 15 2017

OWRD

DLC 41

A-1 Canal point of diversion (POD) is located 80 feet north and 585 feet east from the SW Corner, Section 10.

Charlton Linder POD is located 90 feet north and 520 feet west from the SE Corner, Section 9.

 Area (274.4 Acres) proposed for irrigation use

 Tax Lot Boundary

Scale: 1" = 1,320'



This map was prepared for the purpose of identifying the location of a water right only and is not intended to provide legal dimensions or location of property ownership lines.

Water Right Application Map

Pacific Hydro-Geology Inc.

David and Kristi Fazio
T.2N. R.1W. Sec. 9, 10, 15 & 16, W.M.

2017 - bgp

P-00710