

APRIL 26, 2016 ONE YEAR LIMITED LICENSE APPLICATION MAP

RECEIVED

MAR 03 2017

te VELDE

T3N, R26E, W.M., MORROW COUNTY

OWRD

USE FOR CONSTRUCTION OF A DAIRY

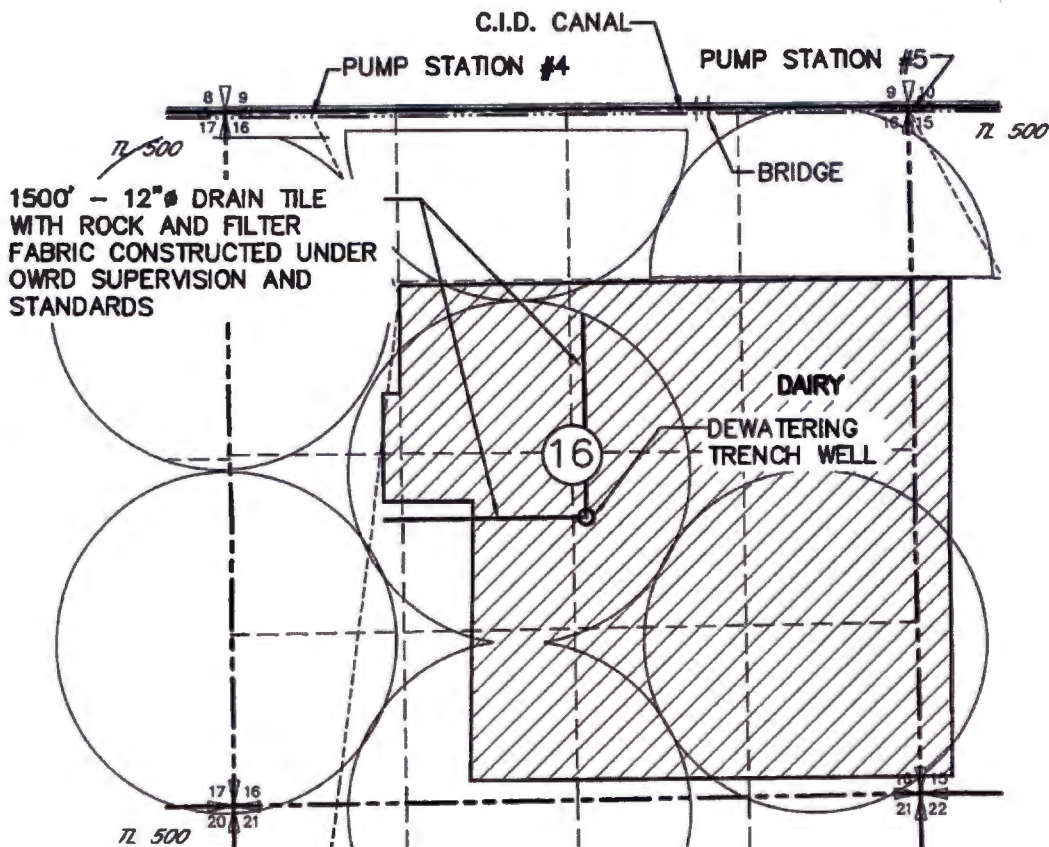

PROPOSED PLACE OF USE FOR THE CONSTRUCTION OF A DAIRY

DRAINS P.O.A.

TRENCH WELL LOCATED 3150'S AND 2550'W FROM THE NE COR SEC 16



RECEIVED BY OWRD

NOV 07 2016

SALEM, OR



NOTE: THE PURPOSE OF THIS MAP IS TO IDENTIFY THE APPROXIMATE LOCATION OF THE WATER RIGHT. IT IS NOT INTENDED TO PROVIDE INFORMATION RELATIVE TO THE LOCATION OF PROPERTY OWNERSHIP BOUNDARY LINES. PIPE LOCATIONS AND SIZES WERE PROVIDED BY FARM OPERATIONAL PERSONNEL AND ARE APPROXIMATE LOCATIONS AND SIZES.

DRAWING: \\kirkstan\public\Project\30-08-016 - Permit Water Rights Consulting\00 Misc Engineering\Cor\te VELDE\30-08-016 te VELDE LL.dwg
PRINTED BY: rwillard on 04/28/16 04:40 AM

WILLOW CREEK DAIRY FIVE YEAR
 LIMITED LICENSE APPLICATION MAP
 T3N, R26E, W.M., MORROW COUNTY
 USE FOR CONSTRUCTION & OPERATION OF A DAIRY

RECEIVED

MAR 03 2017

OWRD

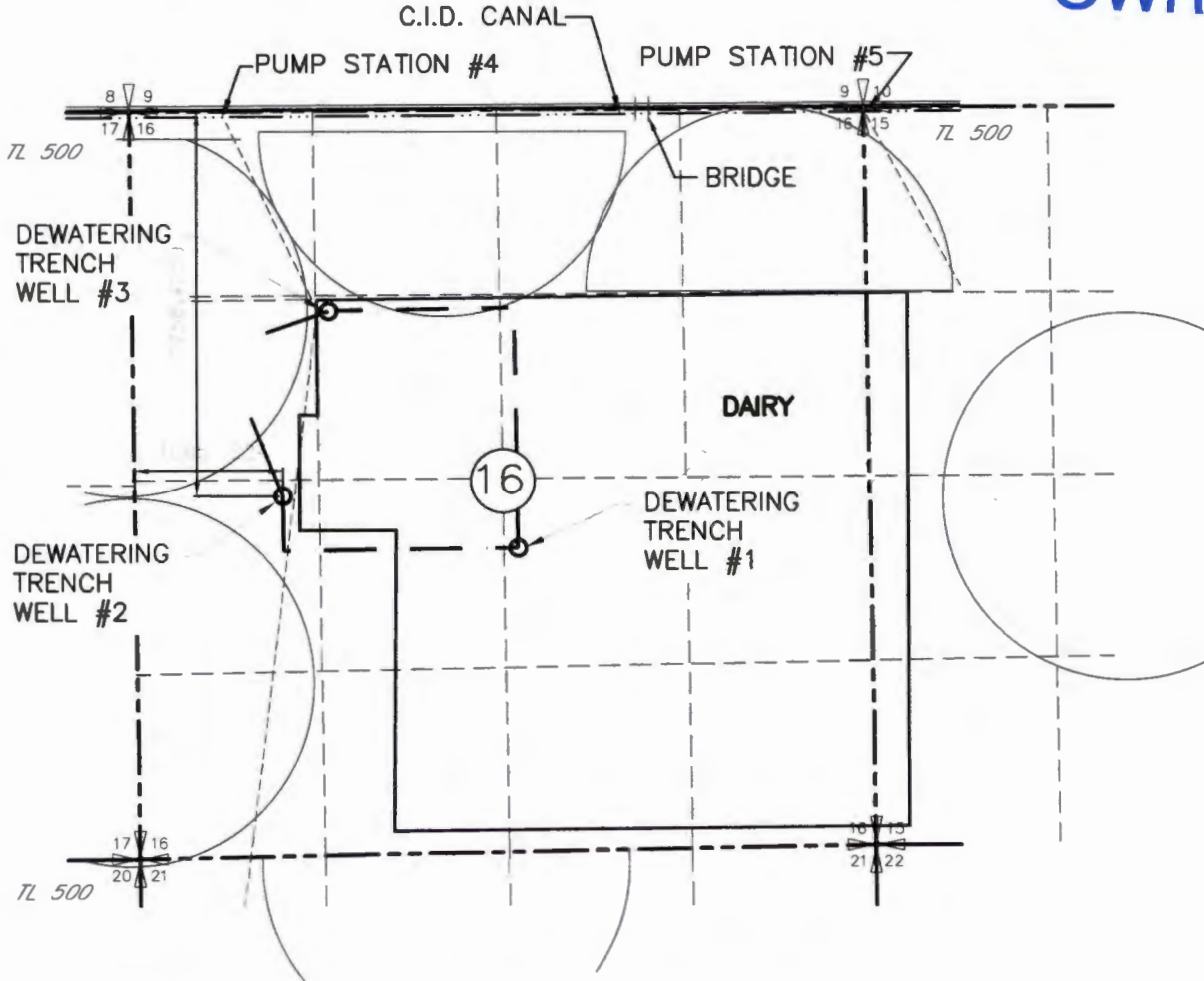

— — 12"Ø DRAIN TILE WITH ROCK AND FILTER FABRIC
 CONSTRUCTED UNDER OWRD SUPERVISION AND STANDARDS

DRAINS P.O.A.

- TRENCH WELL #1 LOCATED 3150'S AND 2550'W FROM THE NE COR SEC 16
- TRENCH WELL #2 LOCATED 2760'S AND 1070'E FROM THE NW COR SEC 16
- TRENCH WELL #3 LOCATED 1440'S AND 1400'E FROM THE NW COR SEC 16

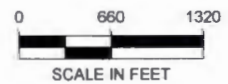

PROPOSED PLACE OF USE FOR THE
 CONSTRUCTION AND OPERATION OF A DAIRY

LL-1690

RECEIVED

MAR 03 2017

OWRD

DRAWING FOR INFORMATION PURPOSE ONLY

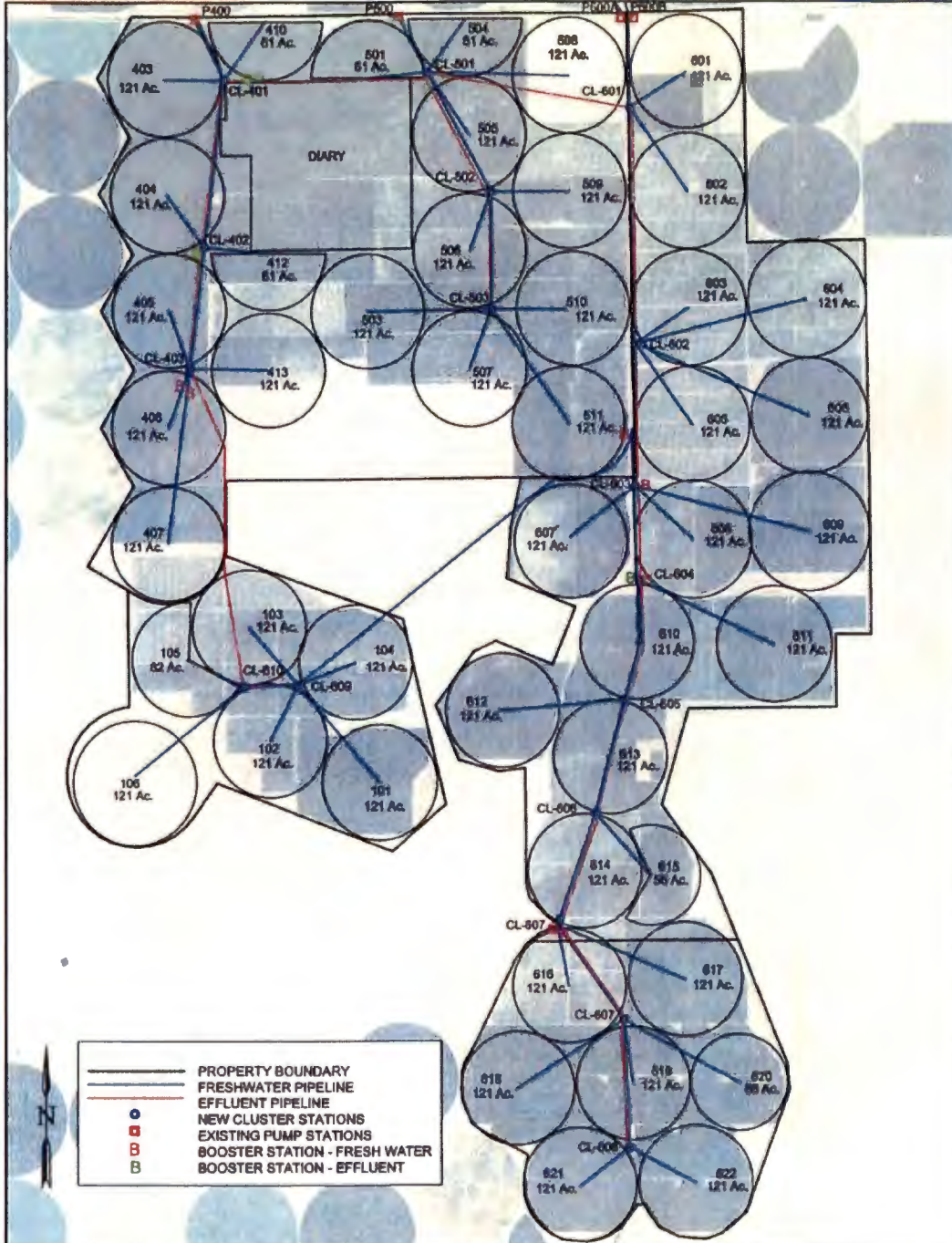

	PROPERTY BOUNDARY
	FRESHWATER PIPELINE
	EFFLUENT PIPELINE
	NEW CLUSTER STATIONS
	EXISTING PUMP STATIONS
	BOOSTER STATION - FRESH WATER
	BOOSTER STATION - EFFLUENT

<table border="1"> <thead> <tr> <th>NO.</th> <th>REVISION DESCRIPTION</th> <th>DATE</th> </tr> </thead> <tbody> <tr><td>4</td><td></td><td></td></tr> <tr><td>3</td><td></td><td></td></tr> <tr><td>2</td><td></td><td></td></tr> <tr><td>1</td><td></td><td></td></tr> </tbody> </table>		NO.	REVISION DESCRIPTION	DATE	4			3			2			1			WILLOW CREEK DAIRY SANDLAKE FARM DEVELOPMENT PIVOTS AND PIPELINES	
NO.	REVISION DESCRIPTION	DATE																
4																		
3																		
2																		
1																		
FILE PATH: \\C:\Clients\Willow Creek Dairy - 507\BTF South Farm\Maps\BTF South Farm DWG		 IRZ Consulting, LLC 500 N 1ST, HERMISTON, OREGON 97838 OFFICE (541) 567-0252 FAX (541) 567-4239																
		DESIGNED: TOM BUCHHO, T2 DRAWN: SAJVA SHARMA SCALE: NTS DATE: 03-10-2015 DRAWING NO: 518-15-001	SHEET: M1															

COPYRIGHT AND REUSE OF THIS DRAWING IS RESERVED BY IRZ CONSULTING, LLC

LL-1690