

T7S. R.1W. Section 6, W.M.

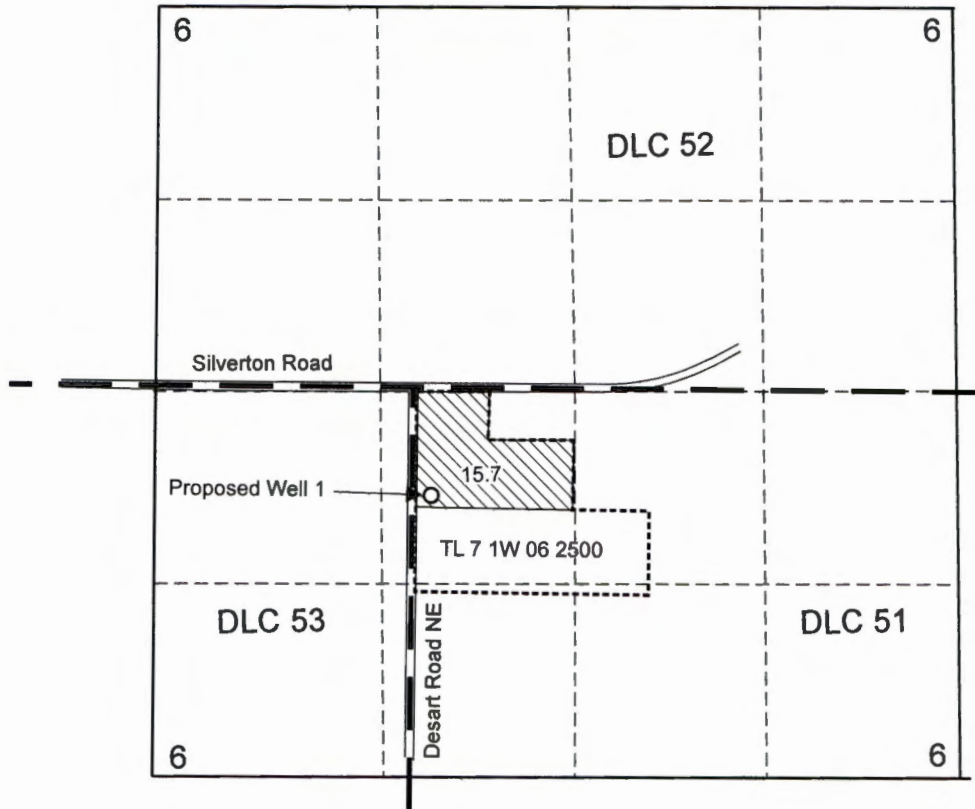

RECEIVED

MAR 28 2017

OWRD



EXPIRATION DATE: 6/30/2017

Proposed Well 1 is located 1,930 feet north and 1,890 feet east from the SE corner, Section 6.

 Area (15.7 acres) proposed for irrigation use.

----- Tax lot boundary

Scale: 1" = 1,320'



This map was prepared for the purpose of identifying the location of a water right only and is not intended to provide legal dimensions or location of property ownership lines.



Water Right Application Map

King Family Farms / David King and Mark King
T.7S. R.1W. Section 6, W.M.

Pacific Hydro-Geology Inc.

2017 - bgp

King.cdr

12-19-2016